

1/4

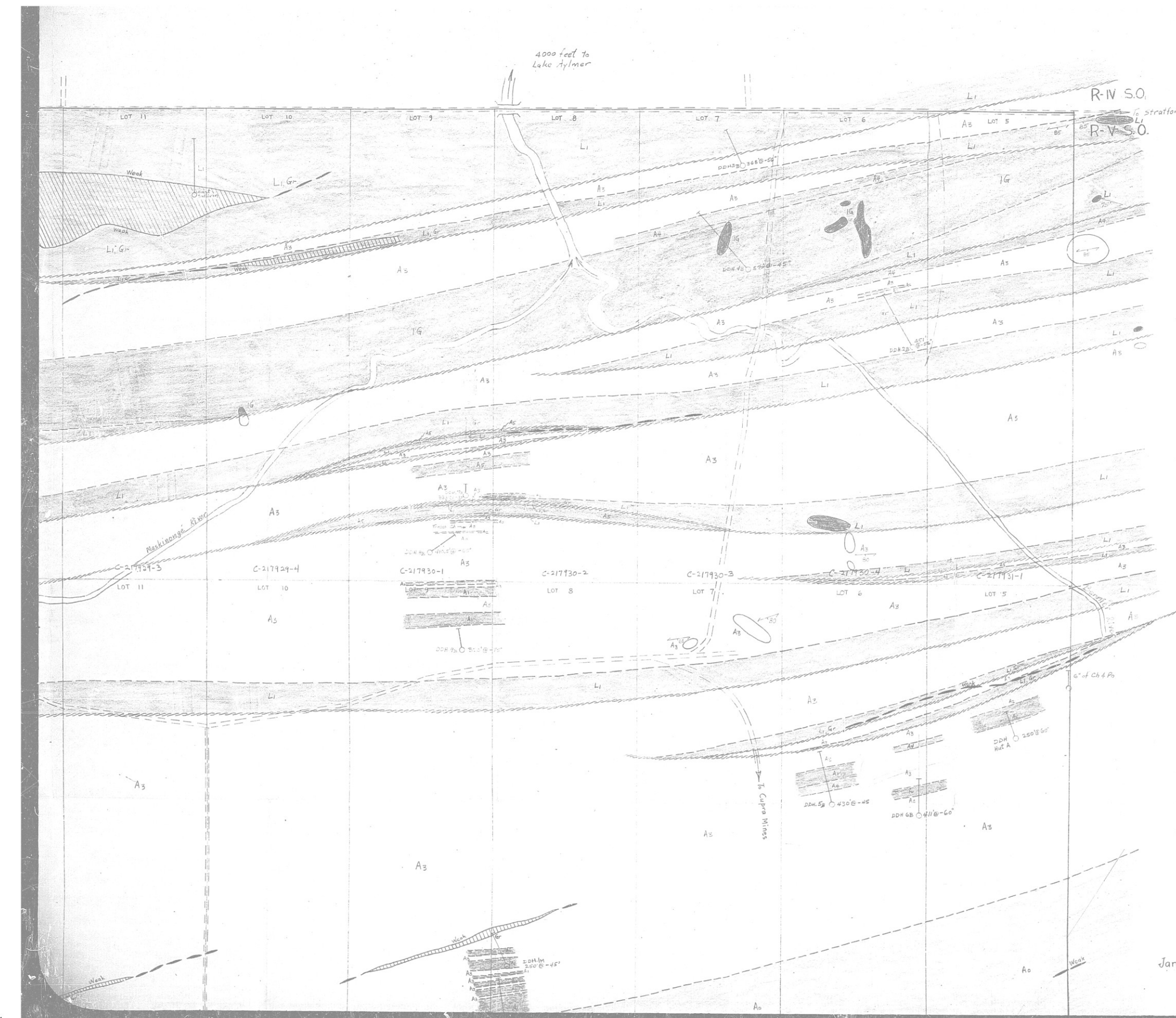

2/4

- LEGEND**
- UPPER DEVONIAN**
 Intrusive mass
 Grey hornblende-biotite granite
- SILURIC-DEVONIAN**
 LIME ALGAE FORMATION
 Silty argillaceous limestone, biotite, dolomitized
- CAMBRO-LOWER ORDOVICIAN**
 ALBERT FORMATION (WESTERN SCHISTOSITY)
 Phyllite and slate
 Gypsiferous chert (red iron formations)
 Micaceous breccia (concrete pyroclastics)
 Blue-grey tuff, locally porphyritic
 Basaltic tuff and fine tuffaceous pyroclastics (mainly phyllitic tuff)
 Chlorite-sarcolite schist (differses multi-grained)
 Chlorite schist (melio-undulose)
 Mixed gneiss (loc. interbedded V, V₂, V₃, V₄, V₅, V₆, V₇, V₈, V₉, V₁₀, V₁₁, V₁₂, V₁₃, V₁₄, V₁₅, V₁₆, V₁₇, V₁₈, V₁₉, V₂₀, V₂₁, V₂₂, V₂₃, V₂₄, V₂₅, V₂₆, V₂₇, V₂₈, V₂₉, V₃₀, V₃₁, V₃₂, V₃₃, V₃₄, V₃₅, V₃₆, V₃₇, V₃₈, V₃₉, V₄₀, V₄₁, V₄₂, V₄₃, V₄₄, V₄₅, V₄₆, V₄₇, V₄₈, V₄₉, V₅₀, V₅₁, V₅₂, V₅₃, V₅₄, V₅₅, V₅₆, V₅₇, V₅₈, V₅₉, V₆₀, V₆₁, V₆₂, V₆₃, V₆₄, V₆₅, V₆₆, V₆₇, V₆₈, V₆₉, V₇₀, V₇₁, V₇₂, V₇₃, V₇₄, V₇₅, V₇₆, V₇₇, V₇₈, V₇₉, V₈₀, V₈₁, V₈₂, V₈₃, V₈₄, V₈₅, V₈₆, V₈₇, V₈₈, V₈₉, V₉₀, V₉₁, V₉₂, V₉₃, V₉₄, V₉₅, V₉₆, V₉₇, V₉₈, V₉₉, V₁₀₀)
 undifferentiated because of lack of information
- Rock exposure
 Geological contact
 Strike and dip of beds
 Strike and dip of cleavage and schistosity
 Fault
 Diamond drill hole in a 1/4 section
 Diamond drill hole in a 1/4 section
 Electromagnetic conductor, strong or weak
 Graphitic rock
 Chalcopyrite
 Pyrrhotite

- SYMBOLS**
- Stream
 Road
 Trail



GEOLOGICAL MAP
 (Northwestern Sheet)
 ON THE PROPERTY OF
R. O. BARTLETT
 Stratford Twp, P.Q.
 By R. Y. Lamarche
 January 1969
 Scale: 1"=200'

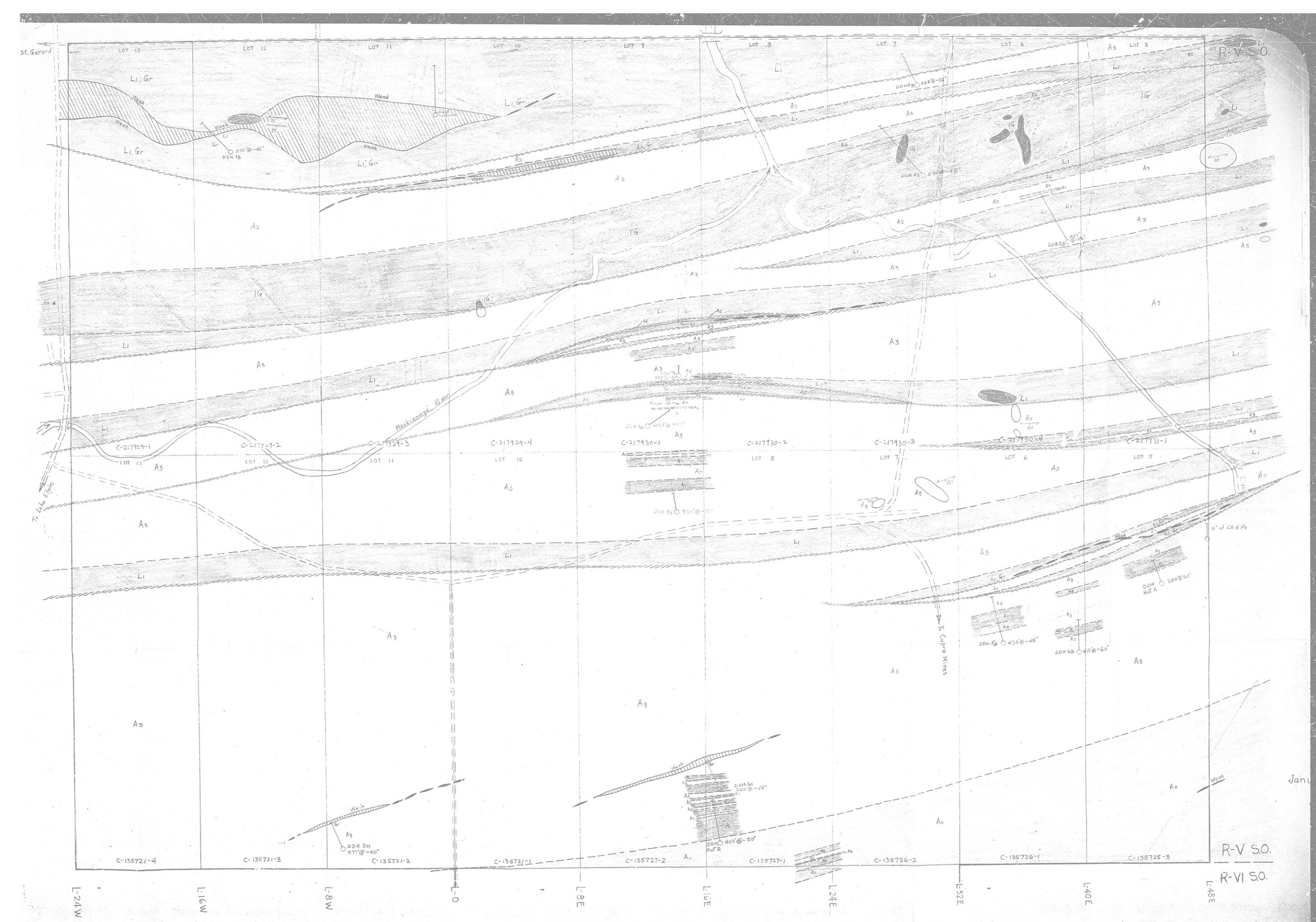

3/4



4/4

- LEGEND**
- UPPER DEVONIAN**
 Intrusive mass
 Grey hornblende-biotite granite
- SILURIC-DEVONIAN**
 LIME ALGAE FORMATION
 Silty argillaceous limestone, biotite, dolomitized
- CAMBRO-LOWER ORDOVICIAN**
 ALBERT FORMATION (WESTERN SCHISTOSITY)
 Phyllite and slate
 Gypsiferous chert (red iron formations)
 Micaceous breccia (concrete pyroclastics)
 Blue-grey tuff, locally porphyritic
 Basaltic tuff and fine tuffaceous pyroclastics (mainly phyllitic tuff)
 Chlorite-sarcolite schist (differses multi-grained)
 Chlorite schist (melio-undulose)
 Mixed gneiss (loc. interbedded V, V₂, V₃, V₄, V₅, V₆, V₇, V₈, V₉, V₁₀, V₁₁, V₁₂, V₁₃, V₁₄, V₁₅, V₁₆, V₁₇, V₁₈, V₁₉, V₂₀, V₂₁, V₂₂, V₂₃, V₂₄, V₂₅, V₂₆, V₂₇, V₂₈, V₂₉, V₃₀, V₃₁, V₃₂, V₃₃, V₃₄, V₃₅, V₃₆, V₃₇, V₃₈, V₃₉, V₄₀, V₄₁, V₄₂, V₄₃, V₄₄, V₄₅, V₄₆, V₄₇, V₄₈, V₄₉, V₅₀, V₅₁, V₅₂, V₅₃, V₅₄, V₅₅, V₅₆, V₅₇, V₅₈, V₅₉, V₆₀, V₆₁, V₆₂, V₆₃, V₆₄, V₆₅, V₆₆, V₆₇, V₆₈, V₆₉, V₇₀, V₇₁, V₇₂, V₇₃, V₇₄, V₇₅, V₇₆, V₇₇, V₇₈, V₇₉, V₈₀, V₈₁, V₈₂, V₈₃, V₈₄, V₈₅, V₈₆, V₈₇, V₈₈, V₈₉, V₉₀, V₉₁, V₉₂, V₉₃, V₉₄, V₉₅, V₉₆, V₉₇, V₉₈, V₉₉, V₁₀₀)
 undifferentiated because of lack of information
- Rock exposure
 Geological contact
 Strike and dip of beds
 Strike and dip of cleavage and schistosity
 Fault
 Diamond drill hole in a 1/4 section
 Diamond drill hole in a 1/4 section
 Electromagnetic conductor, strong or weak
 Graphitic rock
 Chalcopyrite
 Pyrrhotite

- SYMBOLS**
- Stream
 Road
 Trail



GEOLOGICAL MAP
 (Northwestern Sheet)
 ON THE PROPERTY OF
R. O. BARTLETT
 Stratford Twp, P.Q.
 By R. Y. Lamarche
 January 1969
 Scale: 1"=200'

Lot 13

Lot 12

Lot 11

Lot 10

Lot 9

Lot 8

Lot 7

Lot 6

Lot 5

LEGEND

UPPER DEVONIAN

INTRUSIVE ROCK

I6 Grey hornblende-biotite granite

SILURO-DEVONIAN

LAKE AYLMER FORMATION

L1 silty argillaceous limestone, locally dolomitized

CAMBRO-LOWER ORDOVICIAN

ASCOT FORMATION (WEEDON SCHISTS)

A7 Phyllite and slate

A6 Jasperoid chert (red iron formation)

A5 Volcanic breccia (coarse pyroclastics)

A4 Blue-grey tuff, locally porphyritic

A3 Sericite schist and fine felsic pyroclastics (mainly rhyolitic tuffs)

A2 Chlorite-sericite schist (tuffaceous meta-graywacke)

A1 Chlorite schist (meta-andesite)

A0 Mixed volcanics (i.e. interbedded V₁, V₂, V₃, V₄ & V₅, undifferentiated because of lack of information)

Rock exposure

Geological contact

Strike and dip of beds

Strike and dip of cleavage and schistosity

Fault

Diamond drill hole: 1B = No. 1 Bartlett
1M = No. 1 Moneta

Electromagnetic conductor, strong or weak

Gr Graphitic rock

Ch Chalcopyrite

Po Pyrrhotite

SYMBOLS

Stream

Road

Trail

R. VI S.O.

GEOLOGICAL MAP

(Southeastern Sheet)

ON THE PROPERTY OF

R. O. BARTLETT

Stratford Twp., P.Q.

By R. Y. Lamarche

January 1969

Scale: 1" = 200'

Ministère des Richesses Naturelles, Québec
8 SEP 1970
SERVICE DES GITES MINÉRAUX
No GM-26293

R. Y. Lamarche

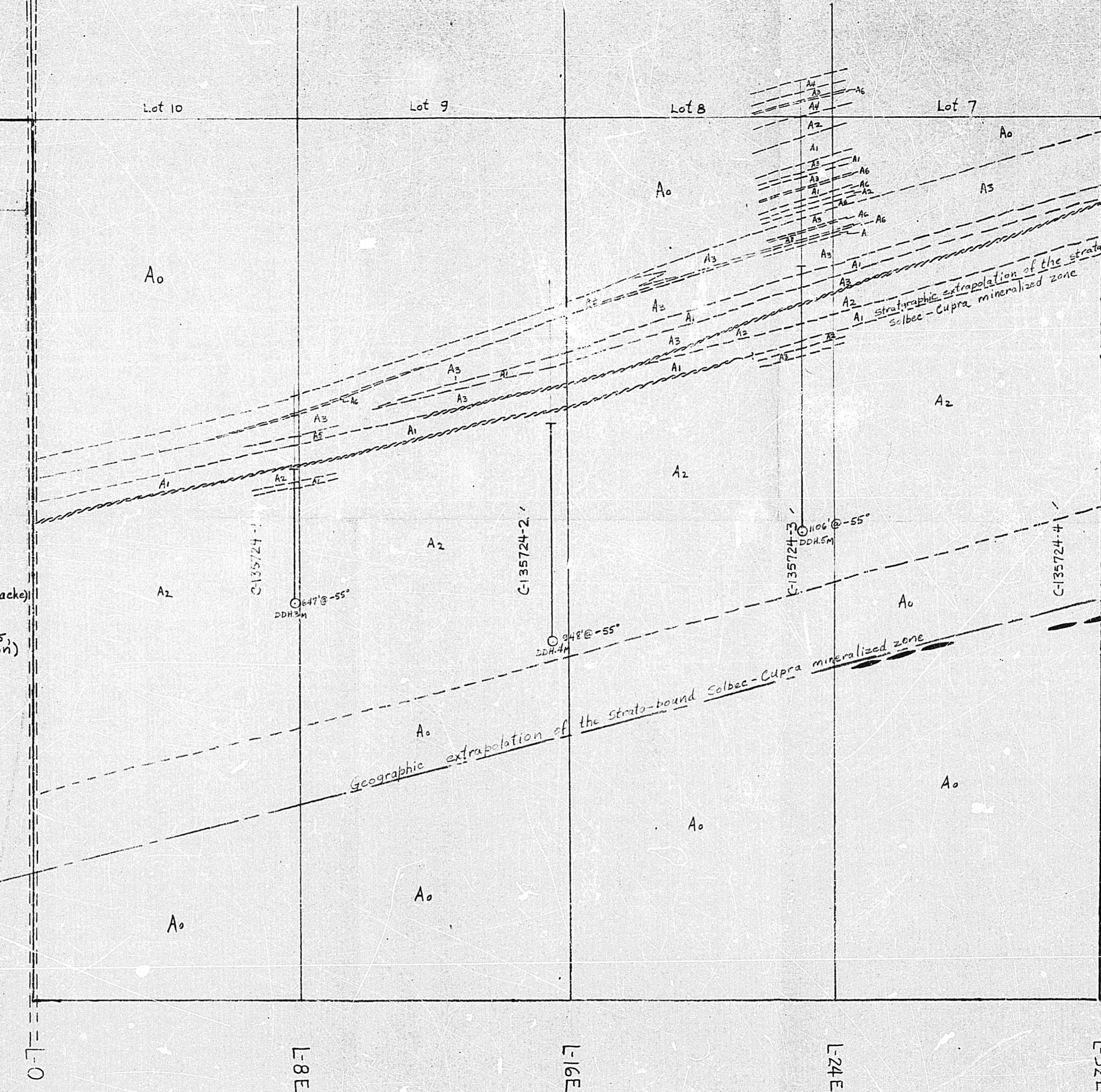

Lot 13

Lot 12

Lot 11

Lot 10

Lot 9

Lot 8

Lot 7

Lot 6

Lot 5

LEGEND

UPPER DEVONIAN

INTRUSIVE ROCK

Grey hornblende-biotite granite

SILURO-DEVONIAN

LAKE AYLMER FORMATION

silty argillaceous limestone, locally dolomitized

CAMBRO-LOWER ORDOVICIAN

ASCOT FORMATION (WEEDON SCHISTS)

Phyllite and slate

Jasperoid chert (red iron formation)

volcanic breccia (coarse pyroclastics)

Blue-grey tuff, locally nephritic

sericite schist and fine felsic pyroclastics (mainly rhyolitic tuffs)

Chlorite-sericite schist (tuffaceous meta-graywacke)

Chlorite schist (meta-andesite)

Mixed volcanics (i.e. interbedded V₁, V₂, V₃, V₄ & V₅, undifferentiated because of lack of information)

Rock exposure

Geological contact

Strike and dip of beds

Strike and dip of cleavage and schistosity

Fault

Diamond drill hole: 1B = No. 1 Bartlett
1M = No. 1 Moneta

Electromagnetic conductor, strong or weak

Gr Graphitic rock

Ch Chalcopyrite

Po Pyrrhotite

SYMBOLS

Stream

Road

Trail

R. VI S.O.

GEOLOGICAL MAP

(Southeastern Sheet)

ON THE PROPERTY OF

R. O. BARTLETT

Stratford Twp, P.O.

By R. Y. Lamarche

January 1969

Scale: 1" = 200'

Ministère des Richesses Naturelles, Québec
8 SEP 1970
SERVICE DES GITES MINÉRAUX
No GM- 26293

R. Y. Lamarche

