

GM 24658

DIAMOND DRILL LOG, QUEBEC GOLD BELT OPTION

Documents complémentaires

Additional Files



Licence



Licence

Cette première page a été ajoutée
au document et ne fait pas partie du
rapport tel que soumis par les auteurs.

Énergie et Ressources
naturelles

Québec 

EXPLORATION DEPARTMENT

Property Quebec Gold Belt Option
 Location Louvicourt Township, Quebec
 Claim No. boundary line claim A35518 & 182836-2
 Location of Core Louvicourt, Quebec.

MCINTYRE
 PORCUPINE MINES LIMITED

DIAMOND DRILL LOG

Hole No. 019-68-8A (68-8A) Sheet No. 1
 Length of Hole 550.0 feet
 Date Started January 22, 1969 Completed Feb. 1
 Core Logged by February 8, 1969. A. Skrecky
 Date.....
 Elevation same as Datum 019-68-8
 Co-ordinates of Collar
 Hole located 70 feet behind Hole 019-68-8
 East

At	Surveys Dip	Bearing
Collar	-55°	north 8 west along claim line
300 feet	-48°	

From	To	Description of Core	Sample No.	FOOTAGE		Width	CORE ASSAYS		
				From	To		Gold	Silver	Copper
0	17.0	CASING-Drillers report sand and boulders to bedrock.							
17.0	48.3	AGGLOMERATE-A dark grey rock with scattered green and grey angular fragments. Rock banded and weakly sheared at 30° to the line of hole. Rock mineralized with trace disseminated pyrite.							
48.3	56.0	PORPHYRITIC RHYOLITE-A cream coloured rock contacts at 30° to the line of hole. Rock is peppered with 1/8 inch eyes of glassy quartz and with 1/4 inch poorly defined phenocrysts of an olive green secondary mineral. Rock is flecked with bright green fuschite and is mineralized trace disseminated pyrite. Rocks is possibly a recrystallized tuff, and identical to material encountered in the bottom of Hole 019-68-3.							
56.0	95.0	DACITE-A grey rock sheared at 35° to the line of hole. Rock is even textured fine grained and locally agglomerite.							
		67.6 - 0.8 ft. quartz contacts ground mineralization shreds of chlorite							
95.0	162.2	AGGLOMERATE-A grey to locally green rock with many acid fragments. Rock sheared and foliated at 45° to the line of hole. Rock mineralized trace to locally							

Ministere des Richesses Naturelles, Québec
 22 AGU 1969
 SERVICE DES GITES MINÉRAUX
 No GM- 24658

EXPLORATION DEPARTMENT

Property Quebec Gold Belt Option
 Location.....
 Claim No.....
 Location of Core.....

At	Surveys	
	Dip	Bearing

MCINTYRE

PORCUPINE MINES LIMITED

DIAMOND DRILL LOG

Hole No. 019-68-8A Sheet No. 2
 Length of Hole.....
 Date Started..... Completed.....
 Core Logged by..... *[Signature]*
 Date.....
 Elevation..... Datum.....
 Co-ordinates of Collar
 North.....
 East.....

From	To	Description of Core	Sample No.	FOOTAGE		Width	CORE ASSAYS		
				From	To		Gold	Silver	Copper
		2 percent fine pyrite, scattered grains of chalcopyrite. Rock locally spherulitic with small quartz eyes and shows general chloritization.							
		144.2 - 0.6 ft. section mineralized trace chalcopyrite-pyrite							
		150.4 - trace chalcopyrite							
		157.0 - 0.1 ft. quartz-carbonate mineralized trace chalcopyrite							
		157.3 - 2.4 ft. section mineralized irregular splashes chalcopyrite-pyrite							
		162.0 - trace chalcopyrite							
162.0	498.0	DACITE-A massive green rock mottled with much chlorite. Rock sheared at 45° to the line of hole. Rock locally vesicular and cut by scattered limonite stained fractures main ones trending at 45° to the line of hole often at right angles to the shearing. Rock locally brecciated chlorite healed. Rock mineralized general trace fine disseminated pyrite, locally with chalcopyrite as tabled below.							
		162.2 - 1.9 ft. irregular quartz mineralized with shreds of chlorite trace chalcopyrite contacts ground.							
		170.3 - 0.5 ft. quartz at 80° to the line of hole mineralized trace chalcopyrite							
		176.0 - 0.5 ft. irregular quartz no vesicular mineralization							

EXPLORATION DEPARTMENT

Property Quebec Gold Belt Option

Location

Claim No.

Location of Core

	At	Surveys Dip	Bearing
.....			
.....			
.....			

MCINTYRE

PORCUPINE MINES LIMITED

DIAMOND DRILL LOG

Hole No. 019-68-8A Sheet No. 3

Length of Hole

Date Started

Completed

Core Logged by [Signature]

Date

Elevation

Datum

Co-ordinates of Collar

North

East

From	To	Description of Core	Sample No.	FOOTAGE		Width	CORE ASSAYS		
				From	To		Gold	Silver	Copper
		177.6 - 5.0 ft. section breccia mineralized trace to locally light pyrite-chalco- pyrite	8288	177.6	182.6	5.0	tr.	0.09	0.67
		199.5 - 1/2 inch quartz at 90° to the line of hole							
		200.0 - trace native copper on open fracture							
		202.0 - 12.0 ft. section cut by many open limonite stained fractures some of which show a little dendritic native copper. Short sections are mineralized with trace pyrite surrounded by chalcocite. Section badly broken and ground	8286	202.0	208.0	6.0	nil	0.02	0.07
			8287	208.0	214.0	6.0	nil	0.07	0.10
		214.0 - 10.0 ft. section with scattered open limonite stained fractures usually at 90° to the line of hole. A few fractures are partly plated with a little dendritic native copper.							
		221.2 - 0.1 ft. quartz at 60° to the line of hole no vascular mineralization							
		225.0 - trace chalc. open							
		225.6 - 0.4 ft. irregular quartz carbonate							

EXPLORATION DEPARTMENT

Property Quebec Gold Belt Option

Location

Claim No.

Location of Core

At	Surveys	
	Dip	Bearing
.....
.....
.....

MCINTYRE

PORCUPINE MINES LIMITED

DIAMOND DRILL LOG

Hole No. 019-68-8A Sheet No. 4

Length of Hole

Date Started Completed

Core Logged by [Signature]

Date

Elevation Datum

Co-ordinates of Collar

North

East

From	To	Description of Core	Sample No.	FOOTAGE		Width	CORE ASSAYS		
				From	To		Gold	Silver	Copper
		227.8 - vesicle lined with tiny quartz crystals and some bornite							
		228.0 - 4.0 ft. ground core							
		232.5 - trace chalcopyrite core badly broken up							
		233.0 - 2.0 ft. ground core							
		235.0 - slickensided fractures at 5° to the line of hole. The section 228.0 to 235.0 feet is considered a possible fault zone.							
		238.0 - to one half inch quartz veins trend at 5° and 30° to the line of hole latter is younger and is mineralized with coarse pyrite chalcopyrite							
		242.2 - 0.2 ft quartz at 45° to the line of hole no viscular mineralization							
		243.0 - 400 ft. section highly brecciated-chlorite healed							
		272.0 - 0.2 ft. section mineralized coarse chalcopyrite-pyrite							
		305.0 - 5.8 ft. breccia mineralized light pyrite trace to locally light chalcopyrite	8295	305.0	310.8	5.8	0.01	0.13	1.27
		318.3 - 0.2 ft. section mineralized coarse hematite-pyrite-chalcopyrite							
		325.8 - trace pyrite-chalcopyrite							
		331.1 - trace chalcopyrite							

EXPLORATION DEPARTMENT

Property Quebec Gold Belt Option

Location

Claim No.

Location of Core

	At	Surveys Dip	Bearing
.....			
.....			
.....			

MCINTYRE

PORCUPINE MINES LIMITED

DIAMOND DRILL LOG

Hole No. 019-68-8A Sheet No. 5

Length of Hole

Date Started

Completed

Core Logged by [Signature]

Date

Elevation

Datum

Co-ordinates of Collar

North

East

From	To	Description of Core	Sample No.	FOOTAGE		Width	CORE ASSAYS		
				From	To		Gold	Silver	Copper
		333.3 - trace chalcopryrite							
		335.0 - 0.4 ft. section mineralized light chalcopryrite							
		338.0 - breccia to 390.0 feet healed with much chlorite locally with later quartz in thread like veinlets.							
		354.0 - 5.2 ft. badly ground breccia mineralized light pyrite gtrace to locally light chalcopryrite	8285	354.0	359.2	5.2	tr	0.10	0.45
		360.0 - trace chalcopryrite							
		361.0 - trace chalcopryrite							
		382.4 - 0.4 ft. section mineralized light pyrite							
		383.7 - 0.8 ft. section mineralized heavy pyrite trace chalcoprysite							
		386.0 - 0.9 ft. section mineralized light pyrite trace chalcopryrite							
		393.0 - heavy pyrite in ground and buttoned core							
		404.0 - 1.5 ft. ground core							
		410.2 - 0.2 ft. section mineralized trace pyrite-chalcopryrite							
		432.8 - 2.7 ft. heavy granular pyrite light chalcopryrite	8289	432.8	435.5	2.7	0.005	0.34	0.53

EXPLORATION DEPARTMENT

Property Quebec Gold Belt Option
 Location _____
 Claim No. _____
 Location of Core _____

At	Surveys Dip	Bearing

MCINTYRE

PORCUPINE MINES LIMITED

DIAMOND DRILL LOG

Hole No. 019-68-8A Sheet No. 6
 Length of Hole _____
 Date Started _____ Completed _____
 Core Logged by [Signature]
 Date _____
 Elevation _____ Datum _____
 Co-ordinates of Collar
 North _____
 East _____

From	To	Description of Core	Sample No.	FOOTAGE		Width	CORE ASSAYS		
				From	To		Gold	Silver	Copper
		435.5 - 1.2 ft. ground core							
		436.7 - 0.8 ft. section mineralized trace pyrite							
		437.5 - 3.7 ft. breccia mineralized light pyrite trace to locally light chalcop- pyrite trace bornite-chalcocite	8290	437.5	441.2	3.7	0.01	0.22	1.72
		441.2 - 5.0 ft. section mineralized trace pyrite-chalcopyrite	8291	441.2	446.2	5.0	tr	0.01	0.13
		446.2 - 5.0 ft. section mineralized as at 437.5	8282	446.2	451.2	5.0	0.01	0.24	2.45
		451.2 - 2.8 ft. section mineralized trace pyrite-chalcopyrite	8293	451.2	454.0	2.8	tr	0.06	0.10
		454.0 - 9.5 ft. ground core from which a large handful of chips were recovered. These chips are mineralized with trace to locally heavy pyrite-splashes of chalcopyrite. Section includes 10 marble like pieces of massive pyrite-chalcopyrite							
		463.5 - balance of section cut by scattered limonite stained fractures							
		466.7 - 1.2 ft. near massive pyrite trace chalcopyrite section badly buttoned	8294	466.7	467.9	1.2	0.02	0.23	0.55
		469.0 - 1.0 ft. ground core							
		473.8 - 0.5 ft. section mineralized coarse pyrite trace chalcopyrite							
		477.6 - 0.4 ft. section as above							
		491.4-6.6 ft. ground core							

EXPLORATION DEPARTMENT

Property Quebec Gold Belt Option
 Location Louvicourt Township, Quebec.
 Claim No. A35519
 Location of Core core shack claim A35516

MCINTYRE
 PORCUPINE MINES LIMITED

DIAMOND DRILL LOG

Hole No. 019-68-9 Sheet No. one
 Length of Hole 508.0 feet
 Date Started January 13th, 1969 Completed Jan. 15th
 Core Logged by A. Skrocky
 Date January 16th, 1969.
 Elevation plus 37.5 feet Datum 019-68-4
 Co-ordinates of Collar
 North South 979
 East East 5600

	At	Surveys Dip	Bearing
collar		-50	south along picket line
200 feet		-31	
400 feet		-15	

From	To	Description of Core	Sample No.	FOOTAGE		Width	CORE ASSAYS						
				From	To		Gold	Silver	Copper	Zinc			
0	23.0	Casing - Drillers report sand and boulders to bedrock. Recovered rock fragments consist of grey hornblende granite. Agglomerate - a green to locally grey rock with angular chloritic fragments. Rock is locally amygdaloidal. Rock weakly foliated and sheared at 50° to the line of hole. Rock locally mineralized with a trace of sulphide mineralization, the main sections are tabled below.											
		32.0 - open rusty fractures partly stained with malachite.											
		36.8 - 0.5 foot irregular quartz - open fractures flecked with a bit of dendritic native copper.											
		38.0 - 0.8 foot section mineralized trace disseminated pyrite.											
		40.7 - 0.1 foot rusty quartz at 90° to the line of hole.											
		42.0 - 1.4 foot section mineralized trace pyrite-chalcopyrite.											
		49.9 - 0.2 foot quartz at 70° to the line of hole, mineralized trace chlorite.											
		56.6 - 0.5 foot section mineralized trace pyrite-chalcopyrite.											
		58.5 - 0.1 foot section heavy pyrite- chalcopyrite.											
		60.0 - 12.2 foot section mineralized trace to locally light chalcopyrite-pyrite in irregular fractures.	6423	60.0	62.0	2.0	trace	0.14	1.35				
			6424	62.0	66.8	4.8	nil	0.05	0.25				

EXPLORATION DEPARTMENT

MCINTYRE
PORCUPINE MINES LIMITED

DIAMOND DRILL LOG

Property Quebec Gold Belt Option
Location Louvicourt Township, Quebec
Claim No. A 35519
Location of Core

Hole No. 019-68-12 Sheet No. one
Length of Hole 507.0 feet
Date Started January 24, 1969 Completed Jan. 25th
Core Logged by A. Skrucky
Date January 27, 1969
Elevation plus 31.5 feet Datum 019-68-4
Co-ordinates of Collar
NEM 984 South
East 5500 East

At	Surveys Dip	Bearing
collar	- 50	south along short picket line
200 feet	- 38° 30'	
400 feet	- 19	

From	To	Description of Core	Sample No.	FOOTAGE		Width	CORE ASSAYS		
				From	To				
0	28.0	casing - Drillers report sand and gravel to bedrock - no rock fragments recovered.							
28.0	174.7	breccia - rock consists of alternating sections of brecciated chloritic fragments healed by a grey fine grained acidic material and by brecciated and sheared grey acidic rock healed with much chlorite. Latter chlorite is darker green than the first mentioned fragments. Rock is mineralized with trace pyrite and with widely scattered grains and spines of chalcopyrite. Rock sheared at 60° to the line of hole.							
		53.0 - 0.1 feet rusty quartz at 60° to the line of hole no visual mineralized							
		65.8 - 0.4 feet section mineralized light disseminated chalcopyrite							
		71.7 - 0.1 feet rusty quartz at 60° to the line of hole no visual mineralized							
		73.9 - 0.8 feet section mineralized light pyrite chalcopyrite							
		87.2 - 0.6 feet section mineralized trace pyrite-chalcopyrite							
		124.2 - 5.0 feet section mineralized trace chalcopyrite-pyrite	6447	124.2	129.2	5.0	TR	0.13	0.28
		133.1 - 2.7 feet section mineralized with light very irregular chalcopyrite	6446	133.1	135.8	2.7	0.06	0.34	1.72
		145.7 - 1.0 feet section mineralized trace chalcopyrite							
		151.8 - 1/2 inch quartz at 90° to the line of hole							
		159.4 - trace chalcopyrite							

EXPLORATION DEPARTMENT

Property..... Quebec Gold Belt Option
 Location..... Louvicourt Township, Quebec.
 Claim No. A35517
 Location of Core shack claim A35516

MCINTYRE
 PORCUPINE MINES LIMITED

DIAMOND DRILL LOG

Hole No. 019-68-14 Sheet No. 028
 Length of Hole 688.0 feet
 Date Started January 31st, 1969 Completed Feb. 4
 Core Logged by A. Skrecky
 Date February 6th, 1969
 Elevation same as Datum 019-68-4

At	Surveys	
	Dip	Bearing
collar	- 60	north along picket line
200 feet	- 51	
400 feet	- 33	
600 feet	- 17	

Co-ordinates of Collar
 North 200
 East 5200

From	To	Description of Core	Sample No.	FOOTAGE		Width	CORE ASSAYS		
				From	To		gold	silver	copper
0	47.0	Casing. Drillers report gravel and sand to bedrock.							
47.0	83.6	Lapilli tuff - a grey rock tinged green in places due to accessory chlorite. Rock sheared and bedded at 30° to the line of hole, angular to sub angular fragments consist of feldspathic material, others are cherty. Rock mineralized 2 percent dusty to granular pyrite and with widely scattered grains of chalcopyrite. Rock somewhat sericitic. 62.3 - 1/2 inch quartz at 60° to the line of hole, mineralized traces of chalcopyrite. 68.0 - 1/2 inch quartz as above. 79.6 - 0.4 foot irregular quartz sericite at 60° to the line of hole, mineralized heavy pyrite.							
83.6	119.6	Rhyolite - a hard grey rock sericitized and sheared at 35° to the line of hole. Quartz eyes and flecks of chlorite abundant in first 15.0 feet. Rock then chilled. Rock mineralized 5 percent dusty pyrite scattered grains chalcopyrite. 109.4 - 0.3 foot bed cherty tuff at 35° to the line of hole. 119.4 - 0.2 foot quartz carbonized mineralized traces chalcopyrite.							

EXPLORATION DEPARTMENT

Property Quebec Gold Belt Option
 Location
 Claim No.
 Location of Core
 At Surveys Bearing
 Dip

MCINTYRE PORCUPINE MINES LIMITED

DIAMOND DRILL LOG

Hole No. 019-68-14 Sheet No. two
 Length of Hole
 Date Started Completed
 Core Logged by
 Date
 Elevation Datum
 Co-ordinates of Collar
 North
 East

From	To	Description of Core	Sample No.	FOOTAGE		Width	CORE ASSAYS						
				From	To								
119.6	257.4	Lapilli tuff - as in section 47.0 to 83.6 feet. Rock mineralized 2 percent dusty pyrite scattered grains chalcopyrite. Rock cut by scattered 1/8 inch quartz at 60° to the line of hole, mineralized trace chalcopyrite.											
257.4	542.0	Rhyolite - a grey rock locally tinged green due to minor chlorite. First 15.0 feet shows a peculiar mottling - peppered with match head sized dots of chlorite. Rock mineralized trace to locally 1 percent pyrite few grains chalcopyrite. Rock cut by scattered 1/8 inch quartz carbonated veins at 60° to the line of hole, these mineralized trace chalcopyrite.											
		257.4 - 1/2 inch quartz at 60° to the line of hole, no visual mineralization.											
		257.6 - 1/2 inch sinuous quartz carbonated veinlet par the core axis for 2.0 feet. No visual mineralization.											
		311.0 - rock to 475.0 feet highly brecciated healed with chlorite-pyrite. Rock mineralized 2 to 3 percent pyrite scattered chalcopyrite.											
		314.6 - 2.2 foot section mineralized irregular trace chalcopyrite	8280	314.6	316.8	2.2	0.01	0.03	0.32				
		317.5 - 0.5 foot quartz-carbonated chlorite at 60° to the line of hole.											
		346.0 - 0.1 foot quartz carbonated at 60° to the line of hole mineralized traces of chalcopyrite.											
		389.5 - 20.4 foot section mineralized 3 percent pyrite trace chalcopyrite	6451	389.5	394.5	5.0	tr	0.04	0.05				

EXPLORATION DEPARTMENT

Property..... Cubaes Gold Belt Option.....

Location.....

Claim No.....

Location of Core.....

	Surveys	
At	Dip	Bearing

MCINTYRE
PORCUPINE MINES LIMITED

DIAMOND DRILL LOG

Hole No. 019-68-14 Sheet No. three

Length of Hole.....

Date Started..... Completed.....

Core Logged by.....

Date.....

Elevation..... Datum.....

Co-ordinates of Collar

North.....

East.....

From	To	Description of Core	Sample No.	FOOTAGE		Width	CORE ASSAYS					
				From	To							
			6452	394.5	399.5	5.0	tr	0.06	0.07			
			6453	399.5	404.9	5.4	tr	0.09	0.30			
			6454	404.9	409.9	5.0	tr	0.02	0.03			
		437.2 - 1 inch quartz at 40° to the line of hole, mineralized heavy chlorite										
		438.0 - trace chalcopryrite										
		452.7 - 1.5 foot irregular quartz chlorite										
		454.7 - 1.0 foot section mineralized trace chalcopryrite										
		458.0 - trace chalcopryrite										
		463.0 - 1.7 foot irregular quartz chlorite										
		475.0 - balance of section weakly brecciated healed with chlorite and minor pyrite widely scattered grains chalcopryrite.										
		508.7 - 0.2 foot quartz carbonated at 60° to the line of hole traces of chalcopryrite.										
542.0	596.0	Dacite - a grey green rock massive and fine grained. Rock highly brecciated healed and soaked with chlorite. Rock mineralised 2 to locally 5 percent disseminated pyrite trace to locally light chalcopryrite. The chalcopryrite occurs disseminated as well as in seams and streaks trending at 65° to the line of hole. The main copper sections samples as follows.	6455	542	547.0	5.0	tr	0.02	0.25			

EXPLORATION DEPARTMENT

Property.....Quebec Gold Belt Option,.....

Location.....Louvicourt Township, Quebec.....

Claim No. A35518.....

Location of Core core shack claim a 35516.....

Surveys		
At	Dip	Bearing
collar	vertical	
200 feet	- 84 o 30'	
400 feet	- 83 o 30'	

MCINTYRE

PORCUPINE MINES LIMITED

DIAMOND DRILL LOG

Hole No. 019-68-17 Sheet No. one.....

Length of Hole.....472.0 feet.....

Date Started.....February 17, 1969..... Completed Feb. 20th.....

Core Logged by.....A. Skrecky.....

Date.....February 21, 1969.....

Elevation.....minus 30 feet..... Datum 019-68-4.....

Co-ordinates of Collar

North.....200.....

XXX West.....200 (Sleepy Lake Grid).....

From	To	Description of Core	Sample No.	FOOTAGE		Width	CORE ASSAYS		
				From	To		Gold	Silver	Copper
0	25.0	Casing - Drillers report sand and boulders to bedrock. Grey and pink granite boulders were recovered from this section. The hole collared into badly broken ground and it was necessary to ream the casing to 48.0 feet before solid rock was encountered.							
25.0	35.0	Andesite - a green fine grained highly altered rock locally bleached and brecciated. Rock cut by many open limonite stained fractures, most of which trend at a small angle to the line of hole. Only 5.0 feet of core was recovered from this section.							
35.0	428.0	Agglomerate - a green to green grey rock with scattered acid and chloritic fragments. Rock sheared at a small angle to the line of hole. Rock to 63.5 feet is highly crushed sheared and faulted. This section is very badly broken up and only 70° to the line of hole was recovered. Fragments show much slickensiding and are at times plated with a thin film of pyrite. Rock cut by many open limonite stained fractures a few of which show flakes of native copper. Rock mineralized general trace pyrite scattered grains chalcopyrite.	6478	42.0	47.0	5.0	Tr.	0.03	0.07
		56.5 - 1 inch massive pyrite at 20° to the line of hole.							
		64.0 - 2.2 foot section mineralized with irregular massive pyrite seams trace chalcopyrite at 45° to the line of hole.	6479	64.0	66.2	2.2	0.01	0.05	0.50

EXPLORATION DEPARTMENT

Property Quebec Gold Belt Option

Location

Claim No.

Location of Core

At Surveys
 Dip Bearing

MCINTYRE

PORCUPINE MINES LIMITED

DIAMOND DRILL LOG

Hole No. 019-68-17 Sheet No. two

Length of Hole

Date Started

Core Logged by

Date

Elevation

Co-ordinates of Collar

North

East

From	To	Description of Core	Sample No.	FOOTAGE		Width	CORE ASSAYS		
				From	To		Gold	Silver	Copper
		68.8 - 1 inch pyrite-limonite-chalcopyrite at 45° to the line of hole.							
		76.6 - rusty fracture zone at 20° to the line of hole.							
		74.2 - 2.0 foot section with scattered vuggy fractures at 45° to the line of hole.							
		104.8 - 1 inch seam pyrite-chalcopyrite at 35° to the line of hole.							
		113.0 - 1/2 inch rusty quartz at 60° to the line of hole.							
		140.1 - 0.1 foot quartz carbonated at 35° to the line of hole trace pyrite-chalcopyrite.							
		160.0 - 2.2 foot breccia at 20° to the line of hole mineralized traces pyrite chalcopyrite.	6480	160.0	162.2	2.2	0.01	0.05	0.95
		176.0 - 22.3 foot dacite a grey rock brecciated soaked and healed with chlorite. Rock cut by a few threads of quartz-chlorite at 10° to the line of hole.							
		These mineralized trace chalcopyrite. Rock mineralized with trace disseminated pyrite-chalcopyrite. Last 0.3 foot sheared at 30° to the line of hole.							
		189.2 - slickensided fractures at 10° to the line of hole.							
		192.0 - 0.3 foot irregular quartz carbonated at 25° to the line of hole, mineralized trace pyrite-chalcopyrite.							
		198.3 - 0.7 foot rusty quartz at 45° to the line of hole, mineralized irregu-							

EXPLORATION DEPARTMENT

Property.....Quebec Gold Belt Option.....

Location.....

Claim No.....

Location of Core.....

	Surveys	
At	Dip	Bearing

.....

.....

.....

MCINTYRE

PORCUPINE MINES LIMITED

DIAMOND DRILL LOG

Hole No. 019-68-17 Sheet No. three

Length of Hole.....

Date Started.....Completed

Core Logged by.....

Date.....

Elevation Datum

Co-ordinates of Collar

North.....

East

From	To	Description of Core	Sample No.	FOOTAGE		Width	CORE ASSAYS		
				From	To		Gold	Silver	Copper
		lar chlorite.							
		198.3 - 0.7 foot rusty quartz at 45° to the line of hole, mineralized irregular chlorite.							
		200.7 - 9.1 foot felsite at 70° to the line of hole.							
		205.5 - 1 inch quartz-carbonated pyrite-chalcopryrite at 30° to the line of hole.							
		208.0 - 10.0 foot fault zone at 10° to the line of hole.							
		218.0 - 8.0 foot breccia first 6.0 foot mineralized trace pyrite-chalcopryrite	6481	218.0	224.0	6.0	Tr.	0.05	0.35
		229.0 - 1/2 inch seam chlorite-chalcopryrite at 30° to the line of hole.							
		261.0 - 0.5 foot quartz carbonated at 30° to the line of hole, mineralized trace pyrite.							
		288.7 - 0.1 foot quartz carbonated at 30° to the line of hole, mineralized trace chalcopryrite.							
		317.0 - seam chlorite - chalcopryrite at 20° to the line of hole.							
		327.2 - 0.3 foot quartz-chlorite at 50° to the line of hole, mineralized trace black tourmaline.							
		346.6 - 0.6 foot white quartz at 90° to the line of hole, no visual mineralized.							
		356.5 - 0.4 foot breccia mineralized 1 percent chalcopryrite.							

EXPLORATION DEPARTMENT

Property Quebec Gold Belt Option

Location

Claim No.

Location of Core

At Surveys
 Dip Bearing

MCINTYRE
 PORCUPINE MINES LIMITED

DIAMOND DRILL LOG

Hole No. 019-68-18 Sheet No. five

Length of Hole

Date Started

Core Logged by

Date

Elevation

Co-ordinates of Collar

North

East

From	To	Description of Core	Sample No.	FOOTAGE		Width	CORE ASSAYS		
				From	To				
		167.6 - seam pyrite-chalcopryrite at 20° to the line of hole							
		175.0 - 1 inch breccia at 20. to the line of hole mineralized with heavy pyrite light chlorite-chalcopryrite and fine chalcocite							
		175.8 - 0.2 feet irregular leached quartz mineralized trace chalcopryrite							
		177.0 - native copper on open limonite stained fracture							
		179.0 - open frac as above							
		184.6 - open frac as above							
		186.6 - 0.1 feet vuggy quartz at 10° to the line of hole mineralized light pyrite- chalcopryrite							
		186.6 - 5.9 feet agglomerate with many acid fragments.							
		188.5 - 1.0 feet breccia mineralized light pyrite trace chalcopryrite-chalcocite							
		194.6 - 3.0 feet chlorite rich section mineralized trace dusty pyrite-chalcopryrite	6483	194.6	197.6	3.0	0.01	0.06	0.50
		201.0 - 0.2 feet fault at 90° to the line of hole.							
		209.0 - irregular seams chalcopryrite at 10° to the line of hole							
		229.3 - 3.2 feet section cut by irregular 1 inch seams massive pyrite at 30° to the line of hole. Section mineralized trace chalcopryrite some dusty chalcocite Core badly broken and ground.	6484	229.3	232.5	3.2	0.01	0.10	0.35

EXPLORATION DEPARTMENT

Property Quebec Gold Belt Option
 Location Louvicourt Township, Quebec
 Claim No. A - 35517
 Location of Core core shack claim a 35516

MCINTYRE
 PORCUPINE MINES LIMITED

DIAMOND DRILL LOG

Hole No. 019-68-20 Sheet No. 058
 Length of Hole 428.0 feet
 Date Started February 28, 1969 Completed Feb. 29
 Core Logged by A. Skrocky
 Date March 3, 1969
 Elevation same as Datum 019-60-4
 Co-ordinates of Collar
 North 330
 East 6800

At	Surveys	Bearing
collar	- 60°	north along picket line
200 feet	- 52° 30'	
400 feet	- 43°	

From	To	Description of Core	Sample No.	FOOTAGE		Width	CORE ASSAYS		
				From	To				
0	44.0	casing - drillers report sand and small boulders to bedrock. One small fragment of pink granite was recovered from this section.							
44.0	134.0	amygdaloidal lava - a grey to grey green rock very highly altered and sheared at 30° to the line of hole. Rock is soft with abundant secondary minerals mainly chloritic types. Short sections consist of massive black chlorite. Amygdules are represented by ovoid chloritic masses sprinkled with cube pyrite at times with a grain or two of chalcopyrite. Rock is locally agglomeritic. Rock mineralized with a general trace fine disseminated pyrite - widely scattered grains of chalcopyrite.							
		48.8 - 1.6 feet grey rhyolite. A hard flinty rock flanked by 0.4 feet sections of highly chloritic flow contact material. Rock mineralized trace pyrite-chalcopyrite and there is a marked increase in the sulphide mineralization in the flow contact zones.							
		65.7 - 9.3 feet flow contact material highly chloritic mineralized 5 percent fine pyrite trace chalcopyrite.	6487	65.7	71.0	5.3	tr	0.03	0.05
		78.9 - 0.4 feet heavy chlorite mineralized trace pyrite-chalcopyrite	6488	71.0	77.0	4.0	tr	0.07	0.27
		82.0 - 3.0 feet section as above							

EXPLORATION DEPARTMENT

Property..... Quebec Gold Belt Option.....

Location.....

Claim No.....

Location of Core.....

MCINTYRE

PORCUPINE MINES LIMITED

DIAMOND DRILL LOG

Hole No. 019-68-20 Sheet No. two

Length of Hole.....

Date Started..... Completed

Core Logged by.....

Date.....

Elevation Datum

Co-ordinates of Collar

North.....

East

From	To	Description of Core	Sample No.	FOOTAGE		Width	CORE ASSAYS						
				From	To								
		85.0 - 1.0 feet ground core											
		93.3 - 7.5 feet flow contact material - highly chloritic mineralized 2 percent pyrite trace chalcopyrite											
		129.0 - 5.0 feet flow contact material - very highly chloritic mineralized trace pyrite											
134.0	304.0	dacite - a grey green rock mottled with much chlorite. Rock sheared at 50 to the line of hole. Rock locally amygdaloidal and agglomeritic. Rock mineralized general trace fine disseminated pyrite - widely scattered grains of chalcopyrite. Scattered short sections are mineralized with up to 2 percent pyrite.											
		191.0 - 63.0 feet fault breccia zone. Rock is mashed looking and cut by numerous slickensided fractures trending at various angles to the line of hole. Shear faces are often curved and the core is very badly broken up.	6489	191.0	196.0	5.0	tr	0.11	0.40				
		The slickensided fractures are plated with black chlorite and in places with a thin film of chalcopyrite. Scattered sections were sampled as	6490	196.0	200.8	4.8	tr	0.06	0.22				
		tabled.	6491	205.0	209.0	4.0	tr	0.08	0/15				
			6492	214.8	219.8	5.0	tr	0.07	0.25				
		232.5 - 0.4 feet quartz - contacts green no visual mineralized	6493	219.8	222.8	3.0	tr	0.05	0.05				

EXPLORATION DEPARTMENT

Property Quebec Gold Belt Option
 Location Louvicourt Township, Quebec
 Claim No. A 35517
 Location of Core core shack claim A 35516

MCINTYRE
 PORCUPINE MINES LIMITED

DIAMOND DRILL LOG

Hole No. 019-68-21 Sheet No. one
 Length of Hole 608.0 feet
 Date Started March 5, 1969 Completed March 9
 Core Logged by A. Strackey
 Date March 14, 1969
 Elevation plus 5.0 feet Datum 019-68-4
 Co-ordinates of Collar
 North 400
 East 7200

	At	Dip	Bearing
	collar	- 60°	south along picket line
	200 feet	- 46°	
	400 Feet	- 21°	
	600 feet	- 17° 30'	

From	To	Description of Core	Sample No.	FOOTAGE		Width	CORE ASSAYS		
				From	To		gold	silver	copper
0	42.0	casing - drillers report sand and boulders to bedrock. Recovered material includes pink granite, grey granite, quartz diorite, agglomerate biotite anisite and rhyolite. A 1.5 ft. boulder of mineralized rhyolite was encountered at 55.0 feet and was followed by boulders of granite and agglomerate. The rhyolite was highly brecciated and mineralized with fair pyrite-chalcopyrite. This boulder was assayed with the following results.	3281	boulder	1.5	0.01	0.07	0.48	
42.0	55.3	amygdaloidal lava - a very highly altered rock with scattered quartz filled amygdulae, others are marked by fuzzy ovoid masses of secondary minerals including chlorite, peppered with small pyrite cubes. Rock mineralized 1/2 percent pyrite and with scattered grains of chalcopyrite. Rock is sheared at 45° to the line of core. Rock is highly brecciated healed with irregular calcite rebrecciated then healed with chlorite.							
55.3	66.0	porphyritic rhyolite - a light coloured rock characterized by uniformly disseminated grains of glassy quartz. Rock could be a recrystallized tuff. First contact at 45° to the line of core lower contact irregular and mineralized with light chalcopyrite for 0.2 feet.							
66.0	134.0	amygdaloidal lava same as section 42.0 to 55.3 feet. Rock locally mineralized trace pyrite-chalcopyrite.							

EXPLORATION DEPARTMENT

Property Quebec Gold Belt Option

Location

Claim No.

Location of Core

	Surveys	
At	Dip	Bearing
.....
.....

MCINTYRE
PORCUPINE MINES LIMITED

DIAMOND DRILL LOG

Hole No. 019-68-21 Sheet No. three

Length of Hole

Date Started

Core Logged by

Date

Elevation

Co-ordinates of Collar

North

East

From	To	Description of Core	Sample No.	FOOTAGE		Width	CORE ASSAYS		
				From	To		gold	silver	copper
		general trace pyrite with heavier sulphide sections tabled below. Rock mineralized with scattered grains chalcopyrite.							
		157.0 - 4.5 feet mineralized 3 percent pyrite trace chalcopyrite							
		162.8 - 4.0 feet section mineralized 4 percent pyrite trace chalcopyrite	6789	162.8	166.8	4.0	0.01	0.06	0.32
		178.0 - 0.2 feet section mineralized with heavy chalcopyrite							
		191.5 - 1.4 feet section very highly altered porphyry							
192.9	371.4	amygdaloidal lava - a very highly altered rock soaked with much chlorite. Amygdules are represented by fuzzy masses of chloritic material which are sprinkled with cube pyrite and trace chalcopyrite. Rock mineralized with 2 percent disseminated pyrite widely scattered grains chalcopyrite.	6790	198.8	201.1	2.3	tr	0.05	0.04
		198.8 - 2.3 feet section mineralized trace chalcopyrite	6495	201.1	206.1	5.0	tr	0.04	0.20
		212.3 - trace chalcopyrite							
		213.0 - 0.5 feet section mineralized trace chalcopyrite							
		214.3 - 5.4 feet section mineralized trace chalcopyrite	6496	214.3	219.7	5.4	nil	0.05	0.30
		222.0 - 0.7 feet section mineralized trace chalcopyrite							
		226.5 - 3.0 feet section mineralized trace chalcopyrite	6791	226.5	229.5	3.0	tr	0.05	0.40

EXPLORATION DEPARTMENT

Property Quebec Gold Belt Option

Location

Claim No.

Location of Core

	At	Surveys Dip	Bearing
.....			
.....			
.....			

MCINTYRE

PORCUPINE MINES LIMITED

DIAMOND DRILL LOG

Hole No. 019-65-21 Sheet No. four

Length of Hole

Date Started Completed

Core Logged by

Date

Elevation Datum

Co-ordinates of Collar

North

East

From	To	Description of Core	Sample No.	FOOTAGE		Width	CORE ASSAYS		
				From	To		gold	silver	copper
		234.8 - 1/4 inch seam massive chalcopyrite 65° to the line of hole							
		237.1 - 5.0 feet section mineralized trace chalcopyrite few seams chalcopyrite up to 1/4 inch thick	6497	237.1	242.1	5.0	0.005	3.18	0.67
		243.6 - 0.2 feet section mineralized light chalcopyrite							
		244.7 - 1/4 inch seam chalcopyrite at 45° to the line of hole							
		247.0 - 1/4 inch seam chalcopyrite at 90° to the line of hole							
		248.0 - 5.0 feet section mineralized trace chalcopyrite estimated at 0.20 percent copper							
		258.3 - 0.2 feet section mineralized light chalcopyrite							
		280.0 - scattered amygdulose filled with chalcopyrite							
		292.9 - 5.1 feet section mineralized trace chalcopyrite estimated at 0.10 percent copper							
		309.0 - 0.6 feet section mineralized trace chalcopyrite							
		322.0 - 1.6 feet section mineralized trace chalcopyrite							
		336.7 - 2.4 feet section cut by irregular fracture healed with pyrite-chalcopyrite							
		351.0 - 5.6 feet section mineralized trace chalcopyrite estimated at 0.15 percent copper							

EXPLORATION DEPARTMENT

Property Quebec Gold Belt Option
 Location Louvicourt Township, Quebec
 Claim No. A-37461
 Location of Core core shack claim A 35516

MCINTYRE
 PORCUPINE MINES LIMITED

DIAMOND DRILL LOG

Hole No. 019-68-23 Sheet No. 001
 Length of Hole 488.0 feet
 Date Started March 20, 1969 Completed March 22
 Core Logged by A. Skrecky
 Date March 24, 1969
 Elevation plus 49 feet Datum 019-68-4
 Co-ordinates of Collar
 North 330
 East W 4400

Surveys		
At	Dip	Bearing
collar	- 60°	south along picket line
200 feet	- 56°	
400 feet	- 52° 30'	

From	To	Description of Core	Sample No.	FOOTAGE		Width	CORE ASSAYS						
				From	To		As	Ag					
0	6.0	casing											
6.0	66.0	dacite - a medium grained pale green coloured rock with prominent 1/16 inch diameter phenocrysts of feldspar. Rock is locally peppered with tiny grains of glassy quartz. Rock is massive, scattered 2 inch sections are somewhat bleached. Rock cut by scattered threads of quartz and calcite. Rock mineralized with widely scattered grains of pyrite and chalcopyrite.											
		13.0 - 1/2 inch leached rusty quartz at 10° to the line of hole.											
		49.3 - 1/4 inch seam epidote at 35° to the line of hole.											
		57.1 - 1/2 inch calcite at 40° to the line of hole											
66.0	107.4	agglomerate - contact with previous section is gradational. Rock consists of angular to somewhat rounded fragments of bluish cherty rhyolite imbedded in a chloritic groundmass. The chloritic material comprises 50% of the section and is mineralized with trace pyrite-chalcopyrite											
		95.0 - balance of section is mineralized with 1 percent fine pyrite scattered grains chalcopyrite-pyrrhotite.											
		97.8 - 1.0 feet section highly brecciated healed with irregular seams pyrite up to 1/4 inch thick.	6799	97.8	98.8	1.0	tr	0.03					

EXPLORATION DEPARTMENT

Property..... Porcupine Gold Belt Option

Location.....

Claim No.

Location of Core.....

At	Surveys Dip	Bearing

MCINTYRE
PORCUPINE MINES LIMITED

DIAMOND DRILL LOG

Hole No. 019-68-24 Sheet No. 570

Length of Hole.....

Date Started..... Completed.....

Core Logged by.....

Date.....

Elevation..... Datum.....

North..... Co-ordinates of Collar.....

East.....

From	To	Description of Core	Sample No.	FOOTAGE		Width	CORE ASSAYS							
				From	To									
		250.0 - 0.4 feet bleached section												
		255.0 - 0.7 feet section as above												
		255.6 - 0.1 feet quartz-carbonate at 60° to the line of hole												
		255.6 - 1/2 inch quartz at 90° to previous veinlet mineralized trace chalcopyrite-malachite												
		259.3 - trace chalcopyrite												
		260.5 - several slickensided fractures at 25° to the line of hole												
		280.0 - balance of rock is highly sheared at 20° to the line of hole section brecciated healed with calcite												
292.4	312.0	gabbro - a dark green medium grained rock first contact at 25° along a narrow shear zone. Lower contact at 25° to the line of hole and lined with a 1 inch calcite veinlet. Rock contains abundant accessory biotite and is mineralized with 2 percent disseminated pyrrhotite-pyrite along with scattered grains of chalcopyrite. Rock is cut by scattered quartz-carbonate veinlets up to 1 inch wide the main ones trend at 90° to the line of hole. Last 2.0 feet mineralized with small amounts of a greyish brown unidentified secondary mineral												
312.0	430.5	dacite - a pale green fine grained rock highly sheared at 25° to the line of hole.	8283	394.0	310.0	6.0	nil	tr						

EXPLORATION DEPARTMENT

Property..... Quebec Gold Belt Option

Location.....

Claim No.....

Location of Core.....

At Surveys
 Dip Bearing

MCINTYRE

PORCUPINE MINES LIMITED

DIAMOND DRILL LOG

Hole No. 019-68-24 Sheet No. three

Length of Hole.....

Date Started..... Completed.....

Core Logged by.....

Date.....

Elevation..... Datum.....

Co-ordinates of Collar

North.....

East.....

From	To	Description of Core	Sample No.	FOOTAGE		Width	CORE ASSAYS	
				From	To		gold	silver
		First 8.0 feet brecciated healed with irregular calcite up to 1/2 inch wide veinlets.						
		This section also cut by later talc plated slickensided fracs the main ones of which trend at 25° to the line of hole.						
		326.0 - 0.3 feet ankerite at 60° to the line of hole mineralized trace pyrrhotite						
		328.3 - 0.5 feet quartz at 50° to the line of hole no visual mineralization						
		361.2 - 2.0 feet quartz at 80° to the line of hole wallrock mineralized trace tourmaline	3284	361.2	363.2	2.0	nil	tr
		368.0 - 0.2 feet calcite at 45° to the line of hole mineralized trace pyrite						
		381.0 - 0.5 feet section mineralized light disseminated pyrite						
		397.6 - 3.0 feet highly chloritized section mineralized with 2 percent pyrrhotite pyrite trace chalcopyrite						
		412.0 - 10.0 feet section mineralized trace disseminated pyrite						
420.5	519.4	andesite - a green rock highly sheared at 25° to the line of hole. Rock is highly altered with grey and green secondary minerals common. Rock locally mineralized with pyrite cubes up to 1/2 inch square. Rock cut by many slickensided fractures plated with talc. Rock cut by scattered threads of calcite.						
		454.0 - 1.8 feet garnet schist - a gray to mauve coloured rock peppered with tiny pink garnets. Rock highly sericitized and sheared.						

EXPLORATION DEPARTMENT

Property Quebec Gold Belt Option
 Location Louvicourt Township, Quebec
 Claim No. A 35516
 Location of Core Claims A 35516

MCINTYRE
 PORCUPINE MINES LIMITED

DIAMOND DRILL LOG

Hole No. 019-68-25 Sheet No. 002
 Length of Hole 728.0 feet
 Date Started April 4, 1969 Completed April 19
 Core Logged by A. Strecky
 Date April 12, 1969
 Elevation plus 13.0 feet Datum 019-68-4
 Co-ordinates of Collar
 North 150
 East 3600

At	Surveys Dip	Bearing
collar	- 60°	north along picket line
100 feet	- 56°	
200 feet	- 40° 30'	
400 feet	- 34°	

From	To	Description of Core	Sample No.	FOOTAGE		Width	CORE ASSAYS		
				From	To		gold	silver	copper
	600 feet	- 27° 30'							
0	85.0	casing - Drillers report sand and gravel to 60 feet then gravel and boulders to bedrock. Recovered overburden fragments include gabbro, diorite, granodiorite, grey granite and andesite.							
85.0	209.2	lapilli tuff - a grey to mauve coloured rock, highly sericitized and sheared at 30° to the line of hole. Rock is mineralized with 2 percent fine pyrite short sections show 5 to 10 percent fine pyrite along with scattered grains of chalcopyrite. Rock is locally brecciated healed with chlorite-pyrite. Rock is cut by scattered threads of quartz - calcite.							
	107.6	- 7.0 feet quartz healed breccia	8298	107.6	114.6	7.0	tr	0.02	0.05
	126.0	- 0.1 feet quartz-carbonate at 60° to the line of hole no visual mineralization							
	184.6	- 1/2 inch quartz-carbonate at 45° to the line of hole mineralized traces chalcopyrite							
	199.2	- 10.0 feet section mineralized 5 to 10 percent pyrite	8299	204.2	209.2	5.0	nil	0.01	
209.2	252.5	tuff - a grey fine grained rock bedded at 45° to the line of hole. Rock cut by scattered threads calcite paralleling the bedding and by irregular masses of quartz-carbonate up to 0.1 feet in diameter. Rock mineralized with scattered grains pyrite-chalcopyrite.							
	247.4	- 5.1 feet section tuff and agglomerate mineralized 5 percent dusty							

EXPLORATION DEPARTMENT

MCINTYRE
PORCUPINE MINES LIMITED

DIAMOND DRILL LOG

Property.....
Location.....
Claim No.....
Location of Core.....
At Surveys Dip Bearing

Hole No. 019-58-25 Sheet No. two
Length of Hole.....
Date Started..... Completed.....
Core Logged by.....
Date.....
Elevation..... Datum.....
Co-ordinates of Collar.....
North.....
East.....

From	To	Description of Core	Sample No.	FOOTAGE		Width	CORE ASSAYS		
				From	To		gold	silver	copper
		pyrite trace chalcopyrite	8300	247.4	252.5	3.1	tr	0.03	0.10
252.5	283.3	agglomerate - a green fine grained rock with scattered grey pyrite rich fragments. Rock locally tuffaceous, sheared at 45° to the line of hole. Scattered 0.1 foot sections are mineralized with fine pyrite.							
283.3	297.0	tuff - a mixture of tuff and agglomerate. Rock bedded at 45° to the line of hole. The tuffaceous material is alternately grey and green in colour with the grey sections mineralized with up to 3 percent dusty pyrite along with scattered grains of chalcopyrite.							
297.0	445.0	agglomerate - a green coloured rock with abundant grey pyrite rich fragments. Rock is peppered with pea size fragments of massive pyrite. Rock mineralized with 1 percent fine pyrite scattered grains and splashes of chalcopyrite. Rock is locally amygdaloidal and chloritized.							
		296.1 - 5.6 foot contact section mineralized 3 percent pyrite trace chalcopyrite	8301	296.1	301.7	3.6	tr	0.02	0.10
		312.3 - 1 inch quartz carbonate at 45° to the line of hole no visual mineralization							
		345.3 - 0.6 foot grey tuff bedded at 45° to the line of hole. mineralized 10 percent dusty pyrite trace chalcopyrite							
		342.7 - 21.8 foot section mineralized 4 percent pyrite trace chalcopyrite	8302	352.7	374.5	4.0	tr	0.02	0.10

EXPLORATION DEPARTMENT

Property Quebec Gold Belt Option

Location

Claim No.

Location of Core

At Surveys
 Dip Bearing

MCINTYRE

PORCUPINE MINES LIMITED

DIAMOND DRILL LOG

Hole No. 019-68-25 Sheet No. three

Length of Hole

Date Started

Core Logged by

Date

Elevation

Co-ordinates of Collar

North

East

From	To	Description of Core	Sample No.	FOOTAGE		Width	CORE ASSAYS		
				From	To		gold	silver	copper
			8303	357.5	363.5	6.0	tr	0.01	0.10
			8304	363.5	369.5	6.0	nil	0.01	0.07
			8305	369.5	374.5	5.0	tr	0.02	0.15
		400.5 - 1/4 inch quartz at 25° to the line of hole mineralized trace chalcopyrite							
		401.4 - 2 inch quartz as above							
		434.7 - 0.5 feet section mineralized heavy quartz-chalcopyrite-pyrite							
445.0	488.0	dacite - a grey green medium grained rock sheared at 50° to the line of hole. Rock mineralized 2 percent fine pyrite scattered grains chalcopyrite. Rock is highly brecciated, chlorite healed.							
		476.0 - 1 inch quartz-carbonate at 25° to the line of hole followed by 1 inch quartz at 90° to the first veinlet. Both mineralized trace pyrite-chalcopyrite.							
		478.0 - 0.3 feet quartz-carbonate at 30° to the line of hole mineralized trace chalcopyrite							
		480.4 - 0.2 feet quartz-carbonate at 90° to the line of hole trace pyrite							
488.0	516.3	agglomerate - a green rock with scattered pale green fragments containing abundant spherules of quartz. Rock mineralized 1 percent fine pyrite scattered grains of chalcopyrite. Rock sheared at 60° to the line of hole.							

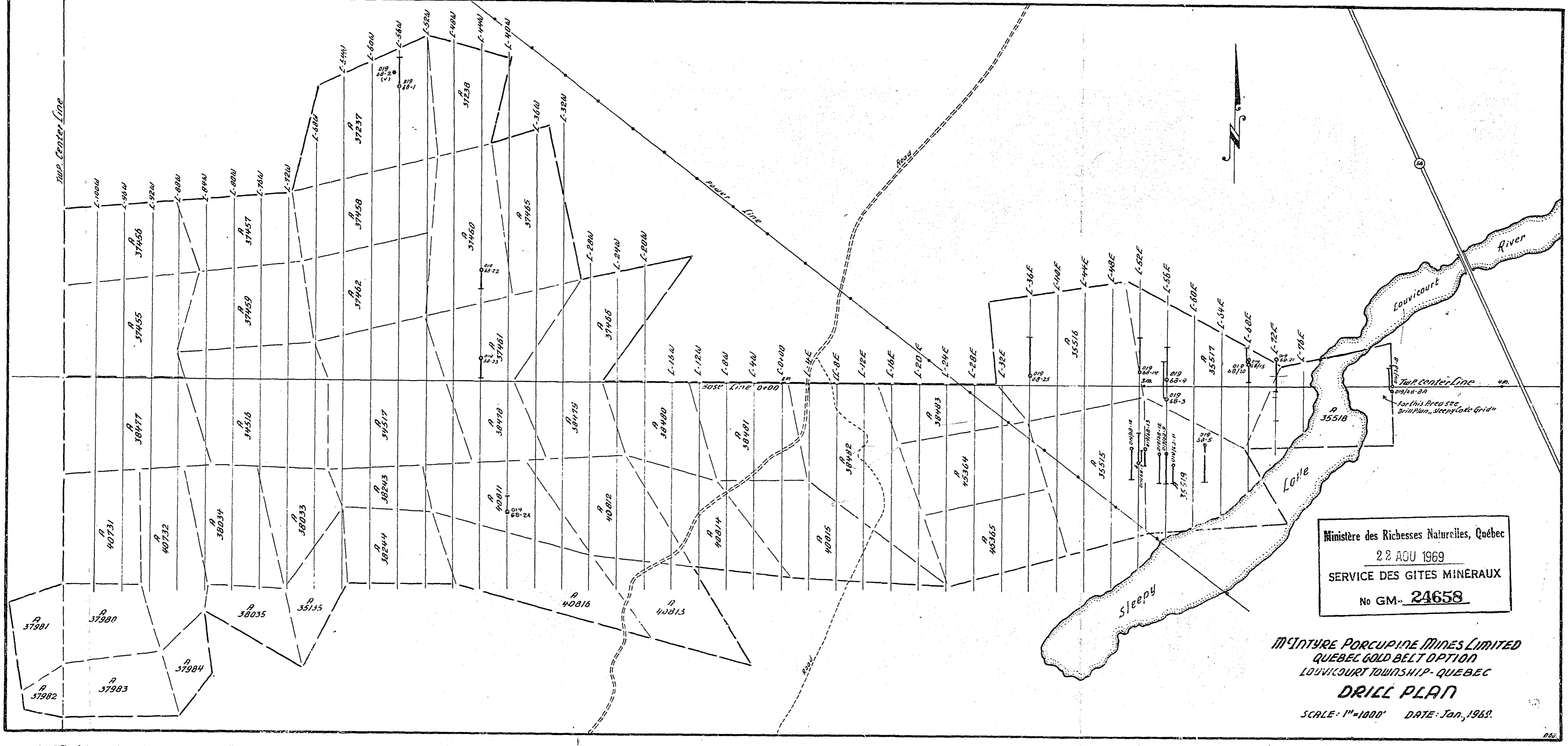

Ministère des Richesses Naturelles, Québec
 22 AGU 1969
 SERVICE DES GITES MINÉRAUX
 No GM- 24658

McINTYRE PORCUPINE MINES LIMITED
 QUEBEC GOLD BELT OPTION
 LOUVICOURT TOWNSHIP- QUEBEC
DRILL PLAN
 SCALE: 1"=1000' DATE: Jan., 1969.

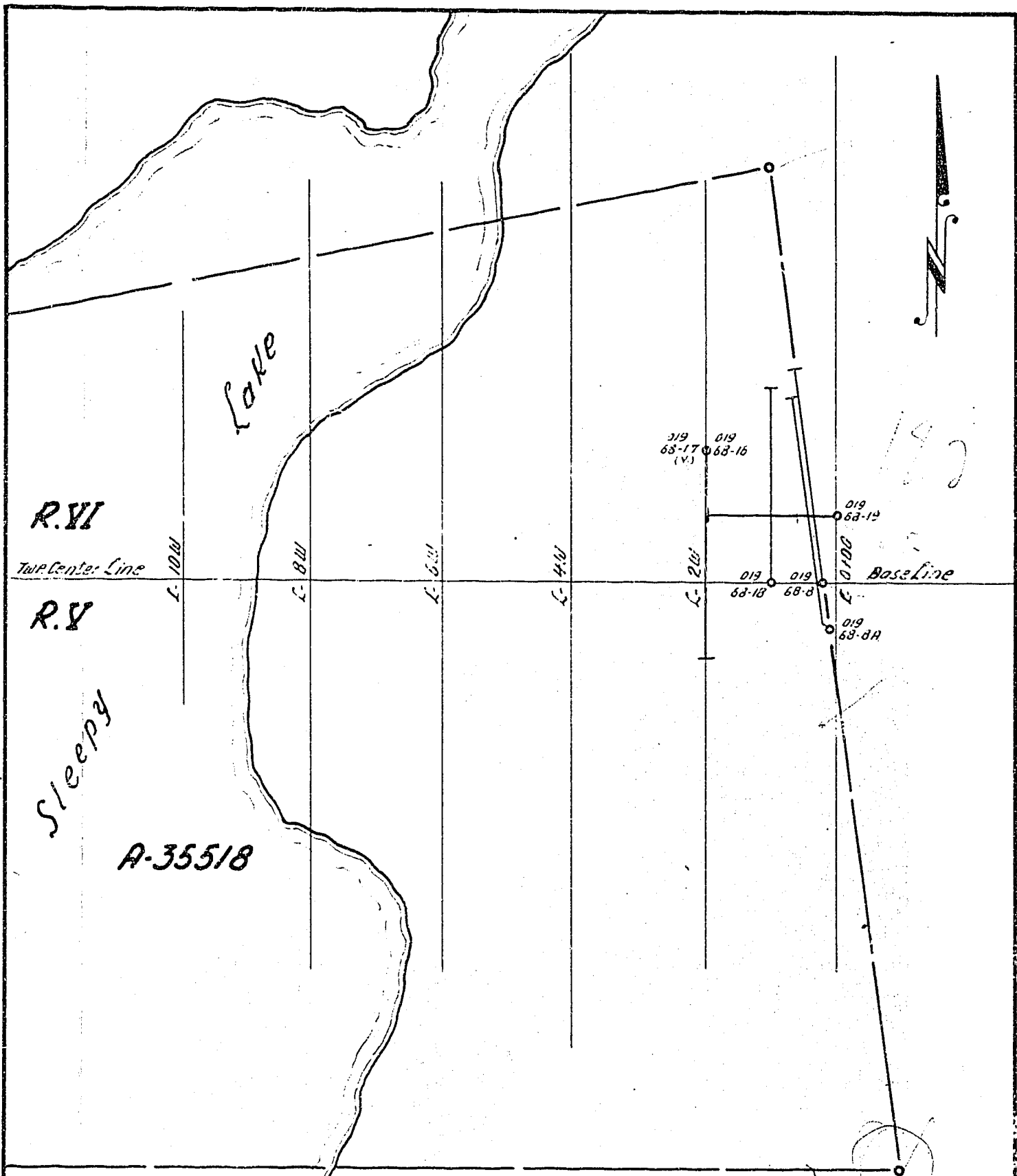

Ministère des Richesses Naturelles, Québec
 22 AOU 1969
 SERVICE DES GITES MINÉRAUX
 No GM- 21658

McINTYRE PORCUPINE MINES LIMITED
 QUEBEC GOLD BELT OPTION
 SLEEPY LAKE GRID
 LOUVICOURT TOWNSHIP - QUEBEC
DRILL PLAN
 SCALE: 1" = 200' DATE: Jan., 1969.