

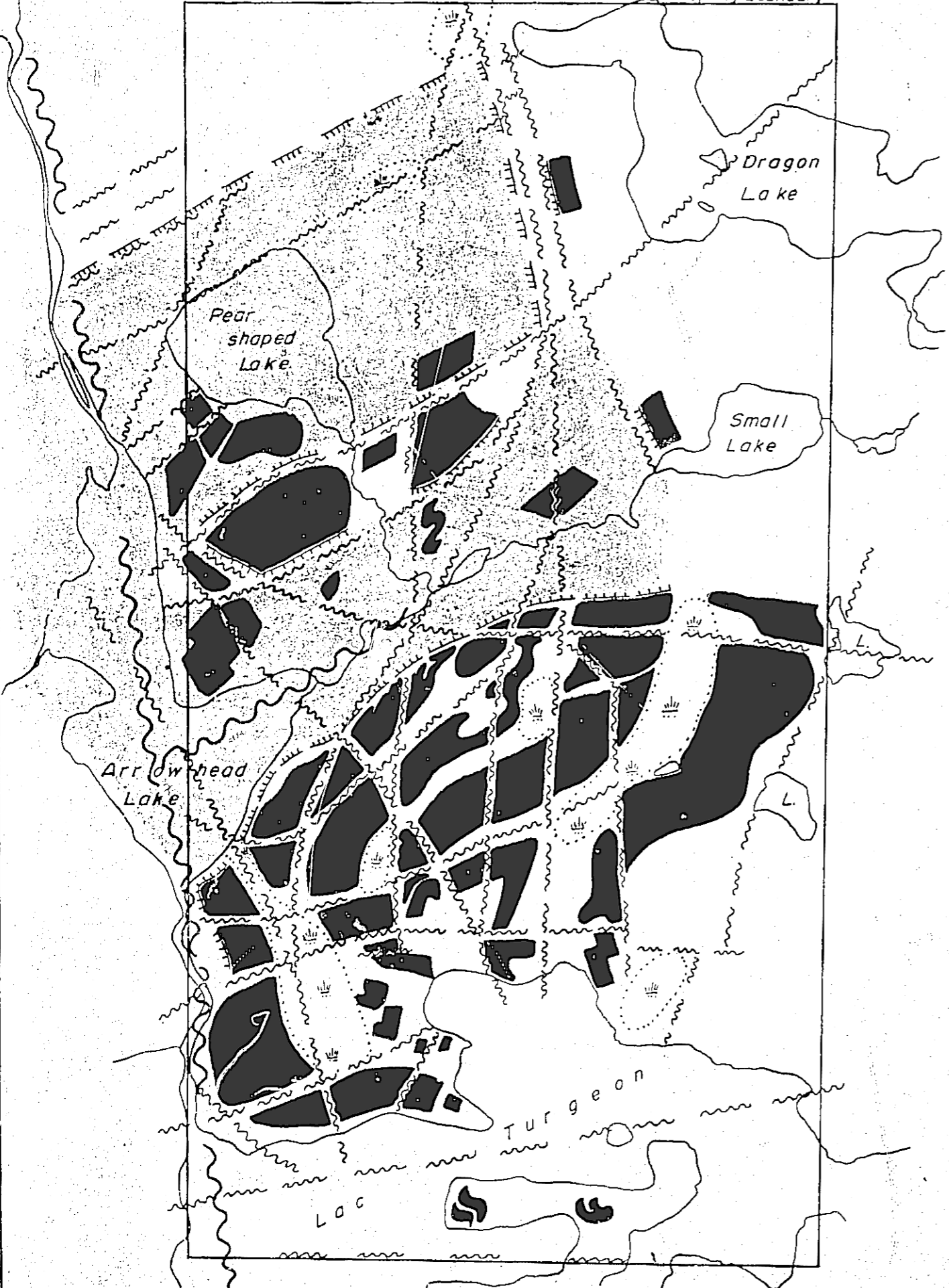





Property Boundary

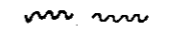
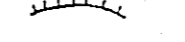

LEGEND

-  Main regional observed faults
-  Local faults
-  Scarps
-  Boundary of slumpage basin
-  Block (unfractured unit)
-  Dragfolding noted
-  Swamp

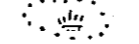
PUBLIC

Ministère des Richesses Naturelles, Québec
 SERVICE DES GITES MINÉRAUX
 No GM- 22348

MAP 6

NORTHERN CANADA MINES LIMITED				
TORONTO		at 1075		ONTARIO
DESHERBIERS TOWNSHIP				
JOHAN-BEETZ AREA — QUEBEC				
STRUCTURAL GEOLOGY				
Drawn C.A.H.	Checked J. REISER	Scale 1" = 1320'	Date May 1968	Proj. No. 677

Handwritten signature

Handwritten initials

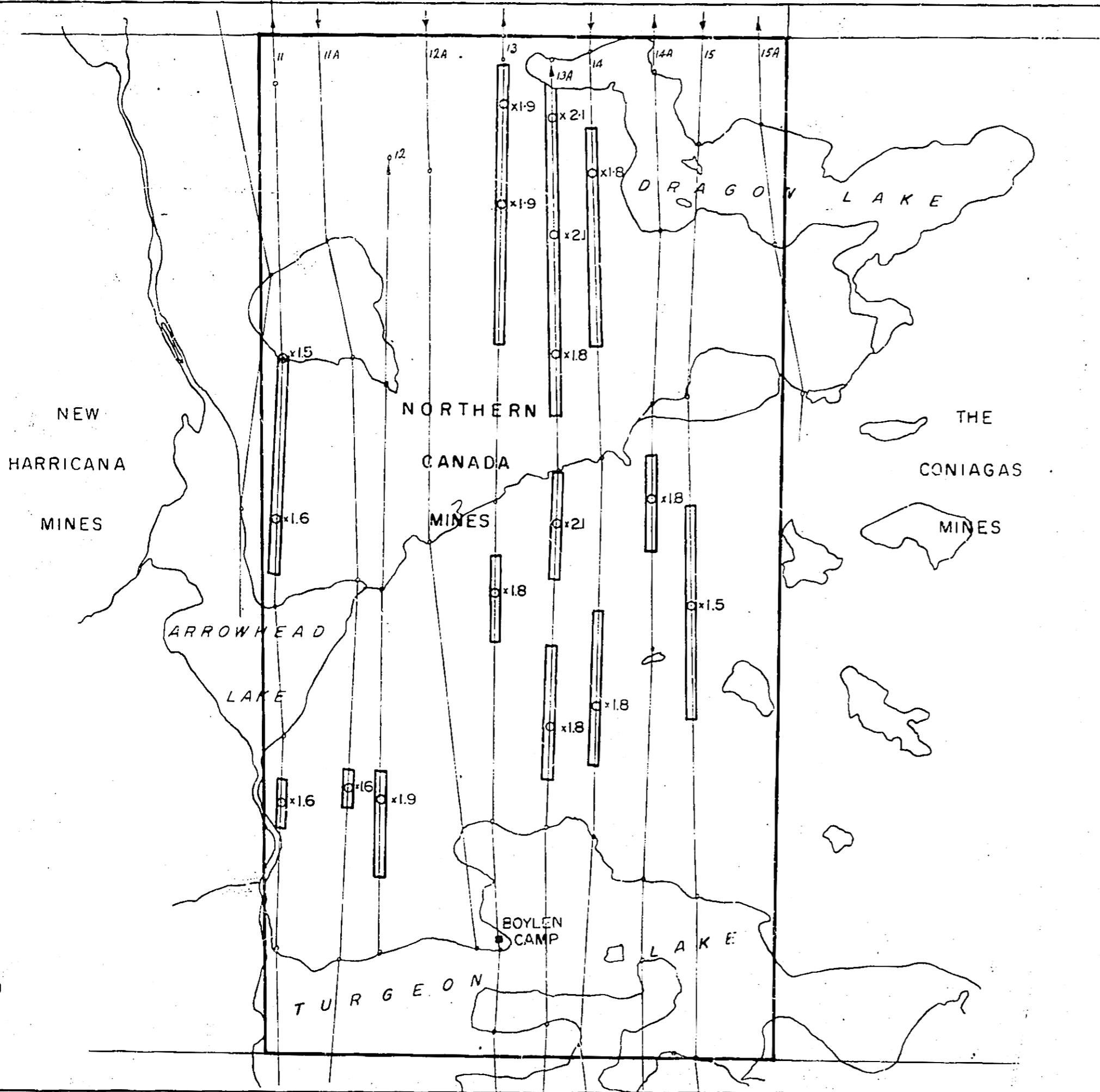

PUBLIC

LEGEND

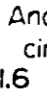
-  Flight Line and Number
-  Anomaly (width noted and peak circled - with value times background)

Minsitère des Richesses Naturelles, Québec
 SERVICE DES GITES MINÉRAUX
 No GM- 22378

MAP 5
NORTHERN CANADA MINES LIMITED
 DESHERBIERS TOWNSHIP JOHAN BEETZ AREA, QUEBEC
 & 1015
 AIRBORNE RADIOACTIVITY MAP

DRAWN RHD	CHECKED JLR	SCALE 1"=1320'	DATE APRIL 1968	PROJECT 677
--------------	----------------	-------------------	--------------------	----------------

16mm

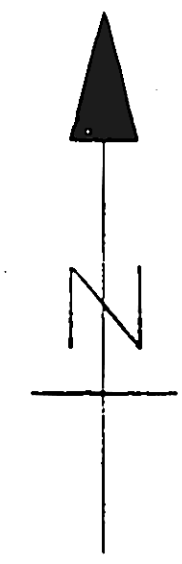
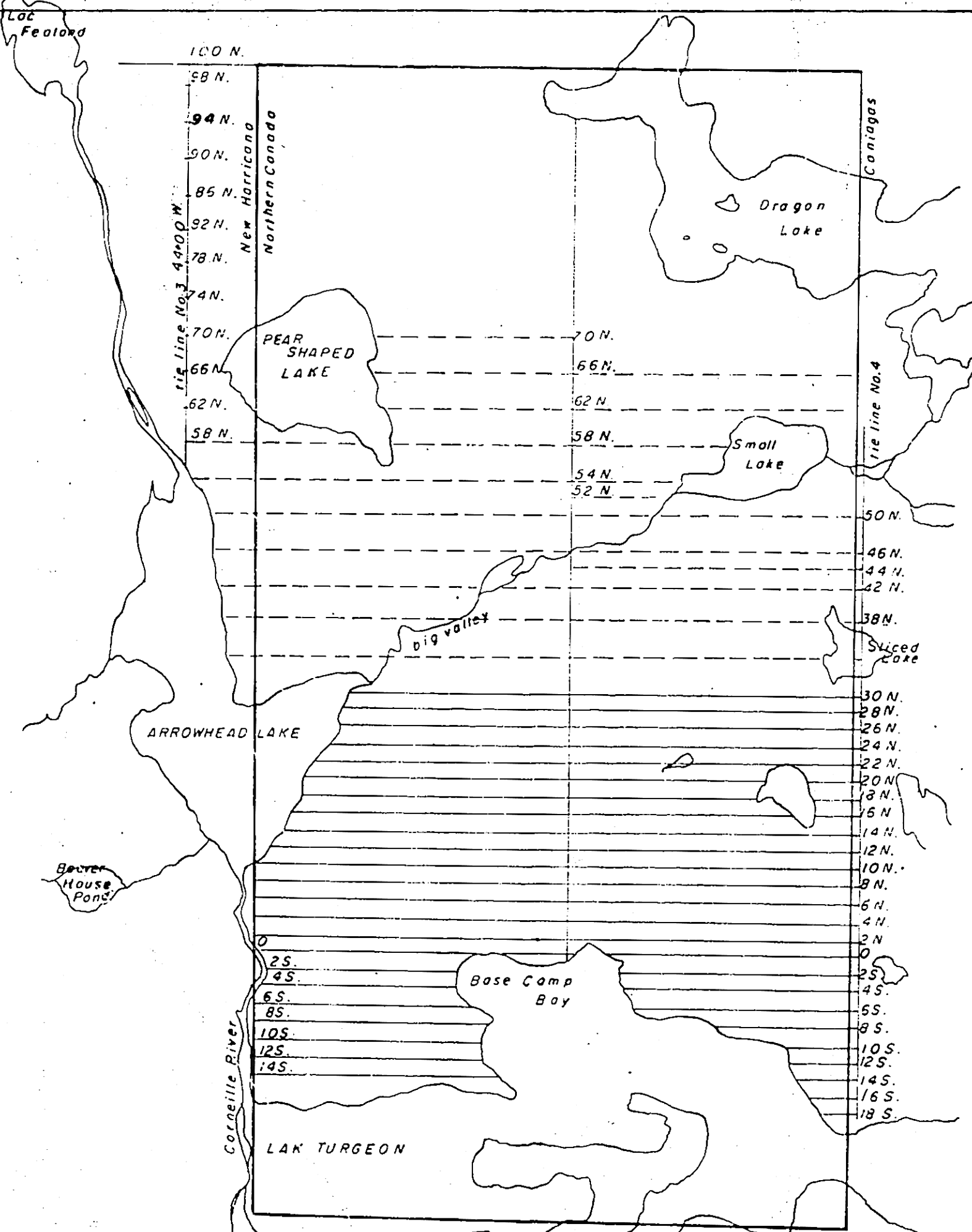

LEGEND

NORTHERN CANADA
 Grid of lines
 Approx. scale 1320' to 1"
 solid lines are cut,
 chained and picketed lines
 at 200' intervals

Broken lines are blazed
 compass run, chained
 flagged lines at
 400' intervals

PUBLIC

Ministère des Richesses Naturelles, Québec
 SERVICE DES GITES MINÉRAUX
 No GM- 22318

MAP: 4			
NORTHERN CANADA MINES LIMITED			
DESHERBIERS TWP., JOHAN-BEETZ AREA, QUE.			
& 1975			
LINE CUTTING MAP			
Drawn DGB	Scale 1" = 1320'	Date APR. 23/68	Project 677

16-2000

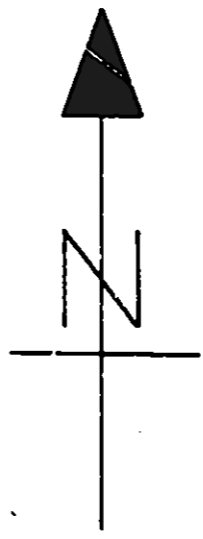
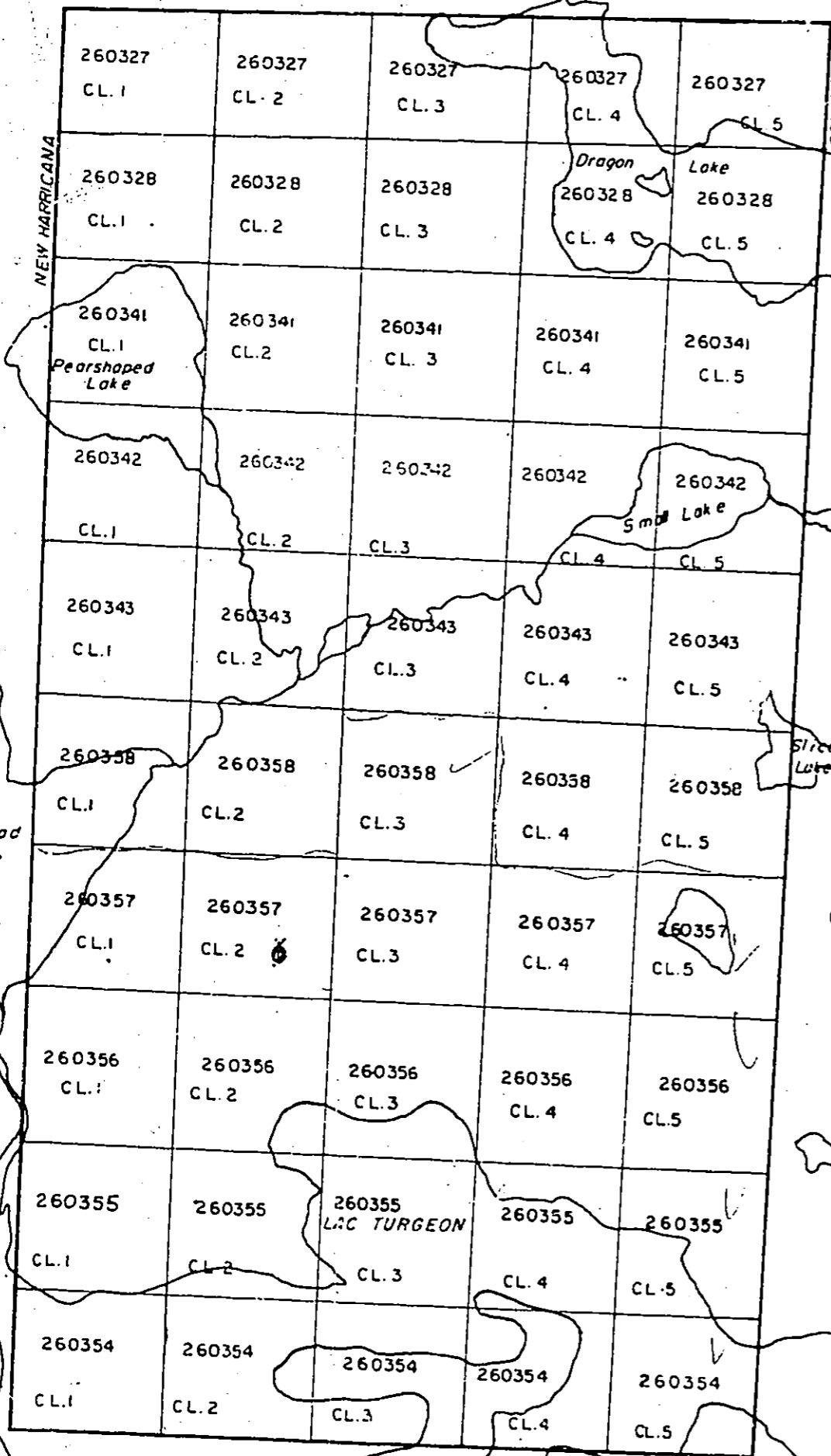

PUBLIC

Ministère des Richesses Naturelles, Québec
 SERVICE DES GITES MINÉRAUX
 No GM-22318

MAP: 3			
NORTHERN CANADA MINES LIMITED			
DESHERBIERS Twp., JOHAN-BEETZ AREA, QUE.			
6 10/15			
CLAIM MAP			
Drawn: D.G.B.	Scale: 1" = 1320'	Date: APR. 24/69	Project: 677

16/10/69

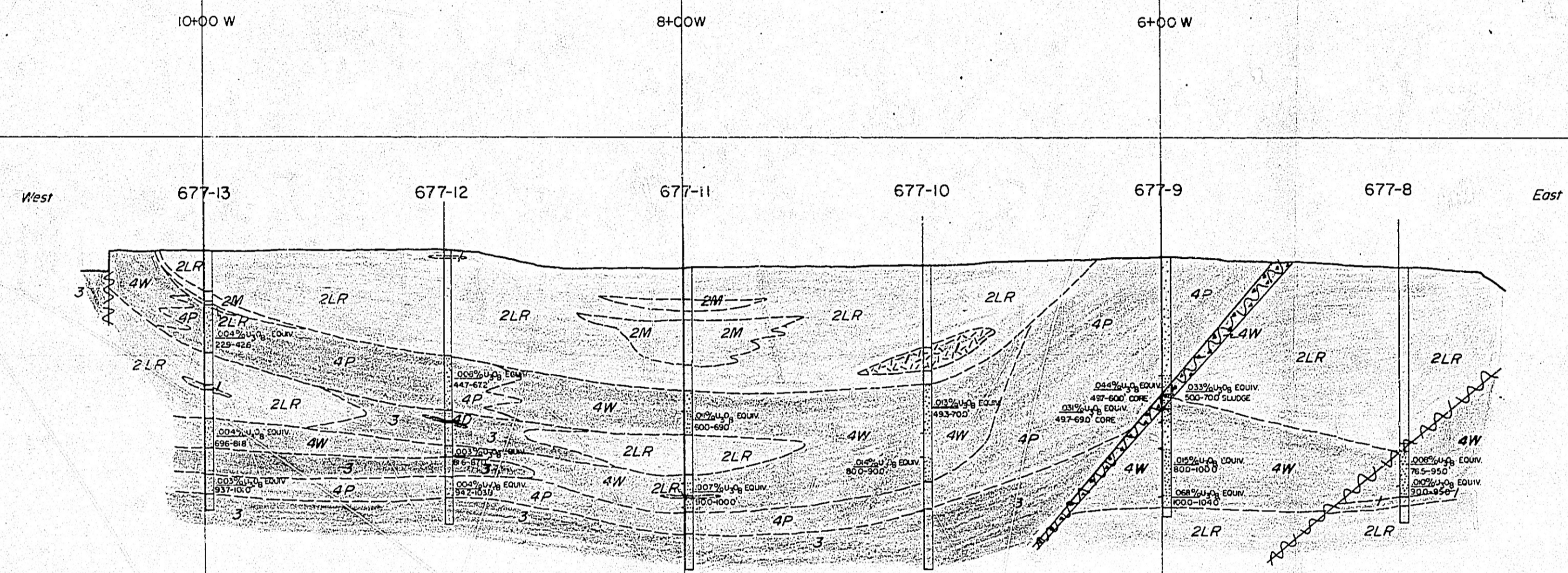

LEGEND

- PEGMATITE - (W) - White, sill variety, minor pink feldspar, minor smoky or smoky quartz, occasional biotite - weakly radioactive.
- (P) - Pink, sill variety, minor white feldspar, minor smoky quartz, moderate biotite in well developed books. - Usually radioactive - with or without sulphides.
- (D) - Pink, usually in dyke form, mottled texture, medium grain - Radioactive.
- GRANITE - - Pink, uniform, medium grained.
- METAGABRO - (M) - Massive hornblende schist, minor biotite - possibly volcanic origin.
- (LR) - "Leopard Rock" - Light (feldspathic) and dark (mafic) mottled texture of varying patterned and sized patches. Sometimes quite acidic - other times very basic - often contains disseminated sulphides.
- METASEDIMENTS - Dominantly quartzite, up to 20% mafics, weakly schisted.
- GRANITIZATION
- BRECCIATION
- SULPHIDES
- RADIOACTIVITY
- FAULT
- CONTACT

PUBLIC

Ministère des Richesses Naturelles, Québec
4 - SEP 1969
SERVICE DES GITES MINÉRAUX
No GM- 22378

24X32

MAP 9

NORTHERN CANADA MINES LIMITED
TORONTO ONTARIO

Property in
Desherbiers Twp., Johan-Beetz Area, Québec

Longitudinal Section of Line 17 North - Looking North
Diamond Drill Holes 677-8 to 677-13

DRAWN RHD	CHECKED JLR	SCALE 1" = 40'	DATE MAR. 1968	PROJ. NO. 677
--------------	----------------	-------------------	-------------------	------------------

Handwritten signature

10+00W

8+00W

6+00W

4+00W

West

677-1

677-2

677-3

677-4

677-5

677-6

677-7

East

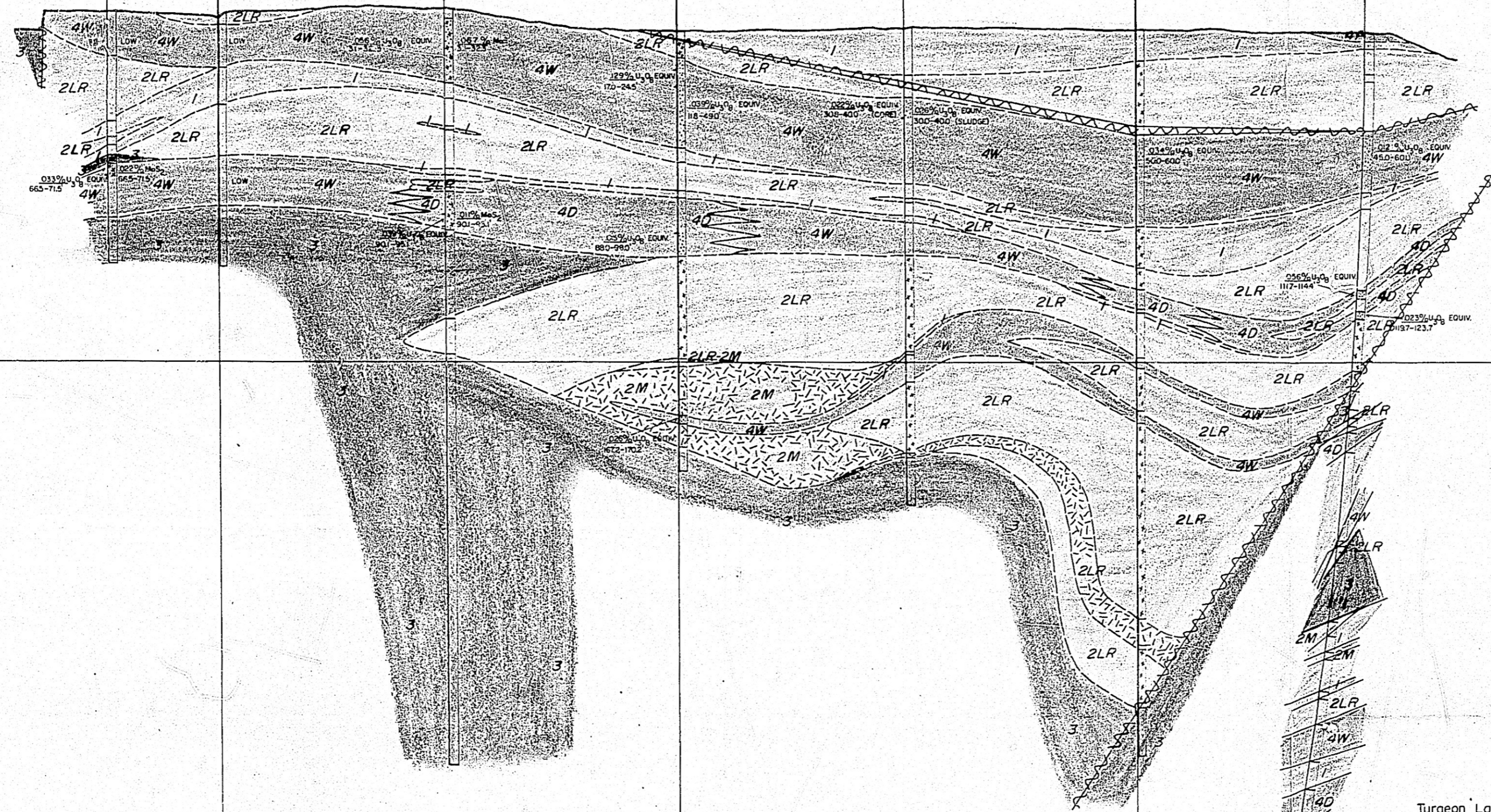

Turgeon Lake high water mark - Elevation 000'

LEGEND

- PEGMATITE - (W) - White, sill variety, minor pink feldspar, minor smokey or amethystine quartz, occasional biotite - weakly radioactive.
- (P) - Pink, sill variety, minor white feldspar, minor smokey quartz, moderate biotite in well developed books. - Usually radioactive - with or without sulphides.
- (D) - Pink, usually in dyke form, mottled texture, medium grain - Radioactive.
- GRANITE - - Pink, uniform, medium grained.
- METAGABRO - (M) - Massive hornblende schist, minor biotite - possibly volcanic origin.
- (LR) - "Leopard Rock" - Light (feldspathic) and dark (mafic) mottled texture of varying patterned and sized patches. Sometimes quite acidic - other times very basic - often contains disseminated sulphides.
- METASEDIMENTS - Dominantly quartzite, up to 20% mafics, weakly schisted.
- GRANITIZATION
- BRECCIATION
- SULPHIDES
- RADIOACTIVITY
- FAULT
- CONTACT

PUBLIC

Minière des Richesses Naturelles, Québec
 4-SEP-1969
 SERVICE DES GITES MINÉRAUX
 22378
 No GM-~~24145~~

24 X 32

MAP 8

NORTHERN CANADA MINES LIMITED
 TORONTO ONTARIO

Property in
 Desherbiers Twp, Johan-Beetz Area, Québec

Longitudinal Section of Line 16 North - Looking North
 Diamond Drill Holes 677-1 to 677-7

DRAWN RHD	CHECKED JLR	SCALE 1" = 40'	DATE MAR. 1968	PROJ. No. 677
--------------	----------------	-------------------	-------------------	------------------

Handwritten signature

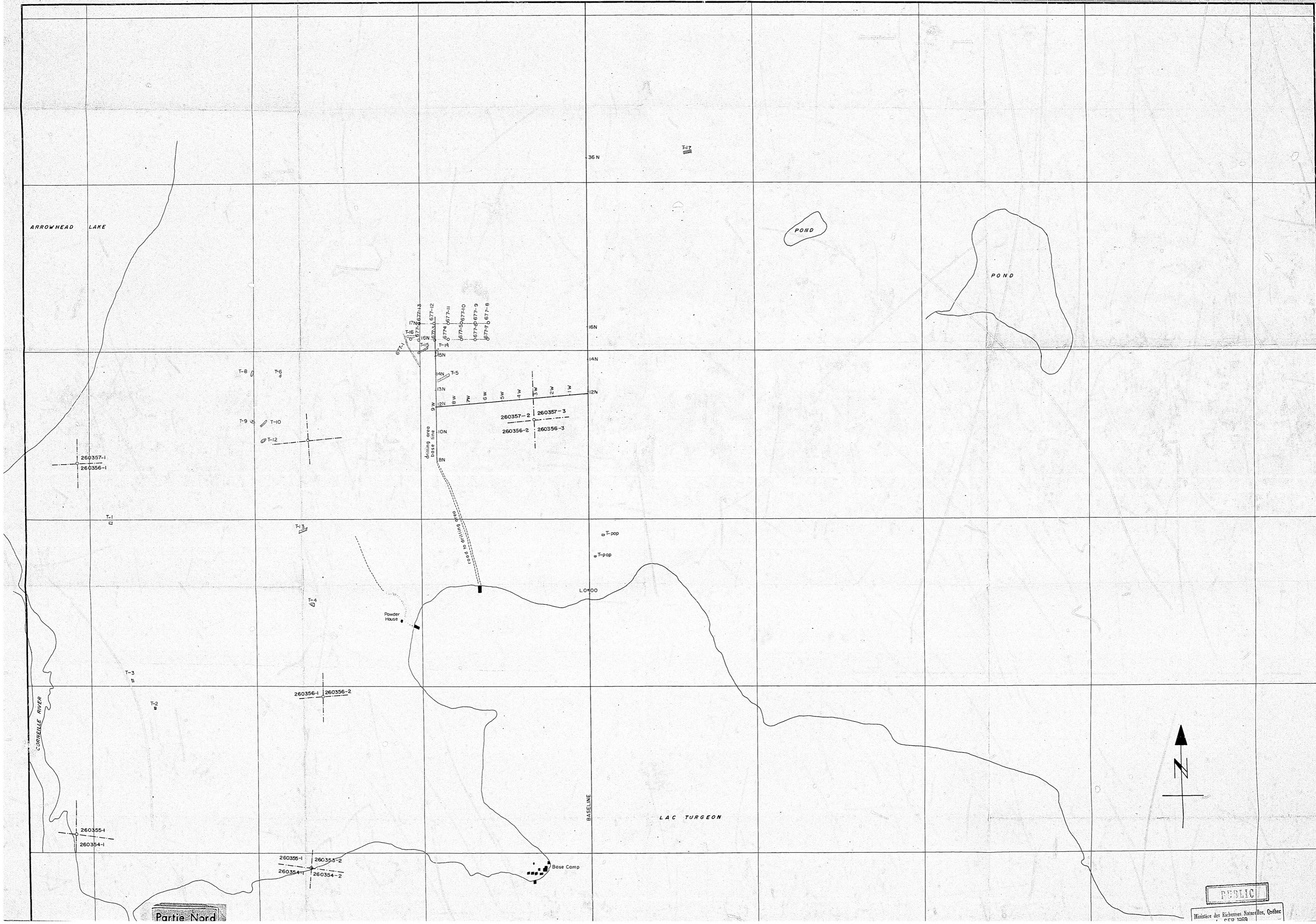

1/2

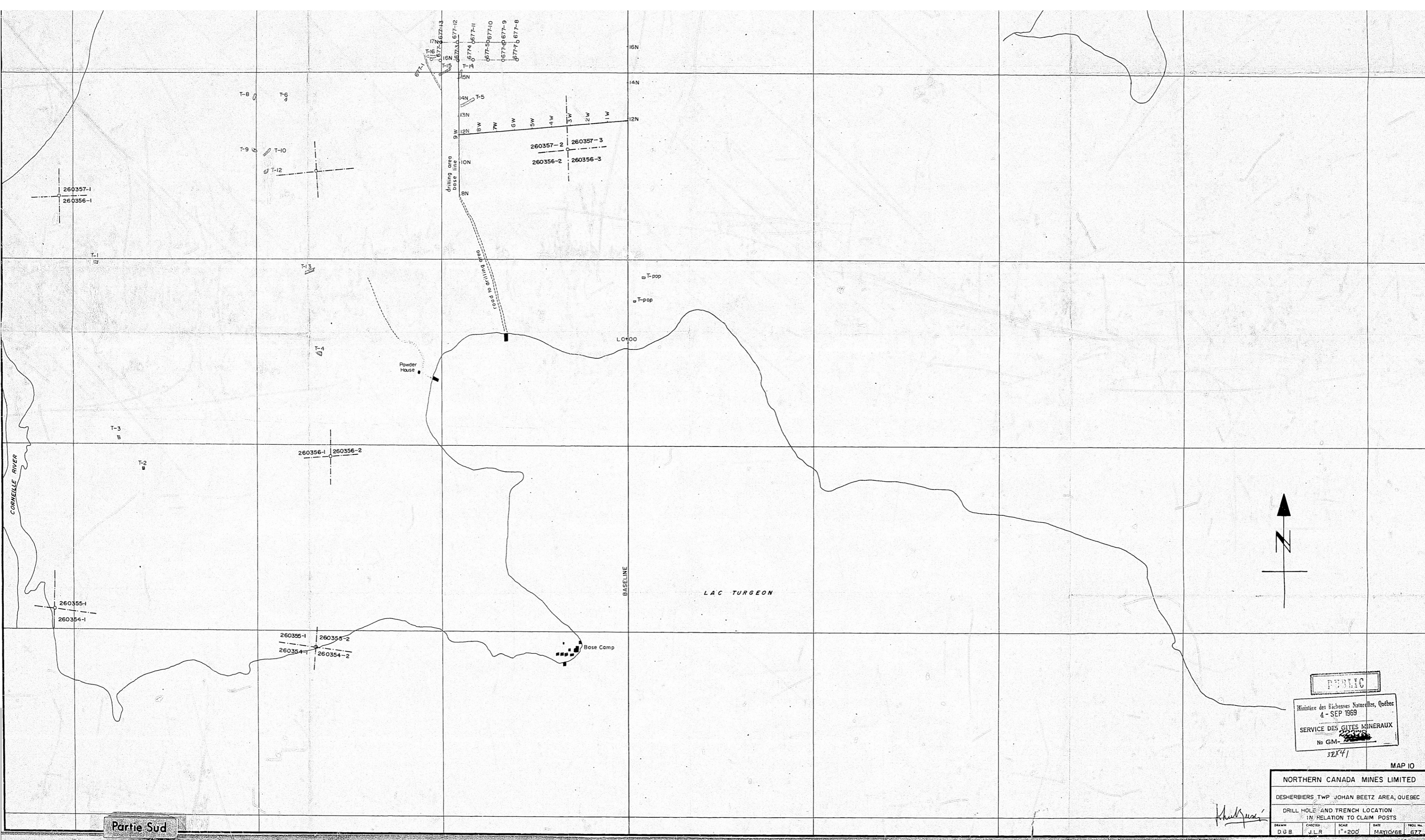

Partie Sud

PUBLIC
 Ministère des Richesses Naturelles, Québec
 4 - SEP 1989
 SERVICE DES GISEMENTS MINÉRAUX
 No GM. 260356
 12X41

MAP 10
 NORTHERN CANADA MINES LIMITED
 DESHERBIERS TWP JOHAN BEETZ AREA, QUEBEC
 DRILL HOLE AND TRENCH LOCATION
 IN RELATION TO CLAIM POSTS
 DATE: 1989
 DRAWN: J.L.R.
 SCALE: 1"=200'
 MAP NO. 677

2/2