

980

955

930

SECTION  
17 W

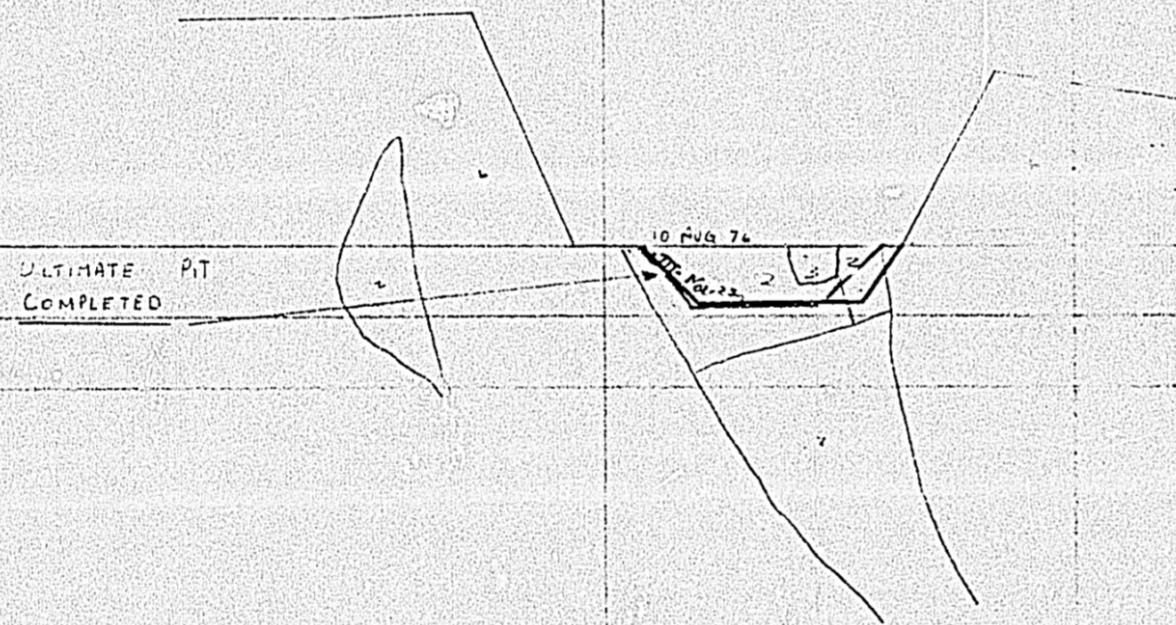

980

955

930

SECTION  
16 W

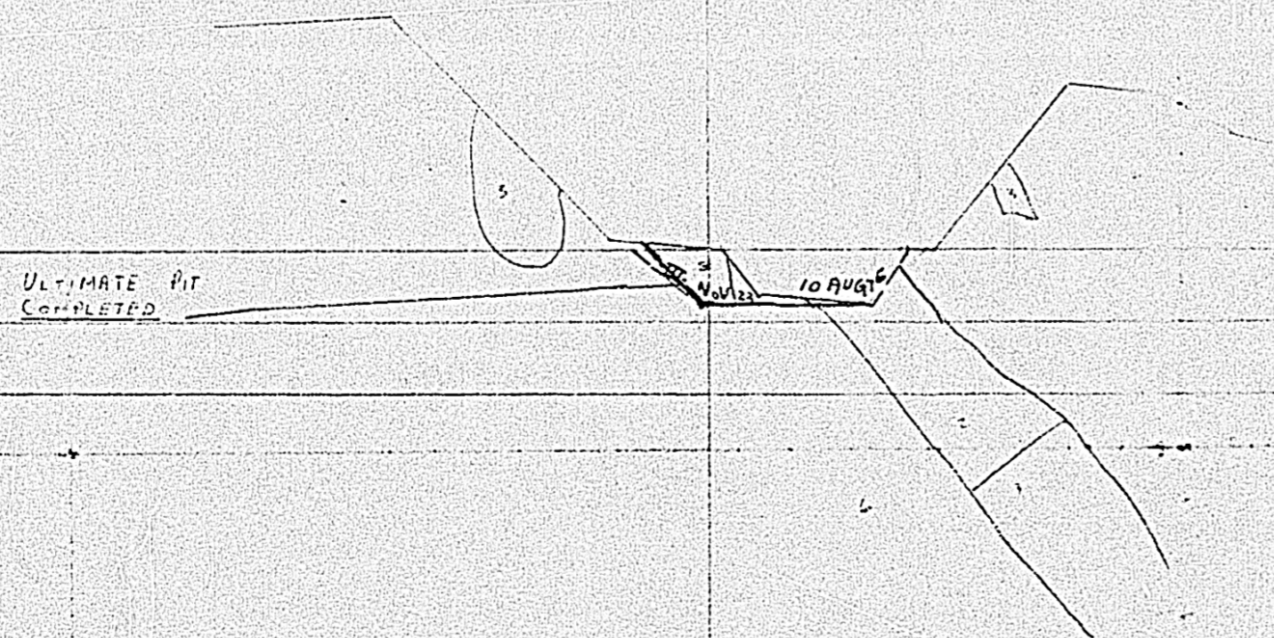

980

955

930

SECTION  
15 W

1/2

ULTIMATE PIT  
COMPLETED

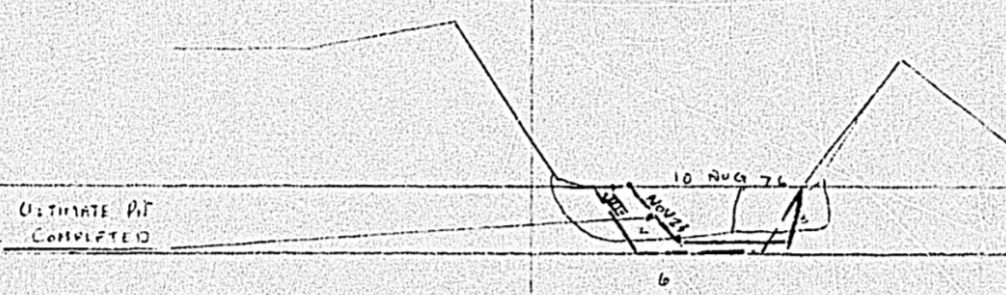

980

955

930

SECTION  
17 W

ULTIMATE PIT  
COMPLETED

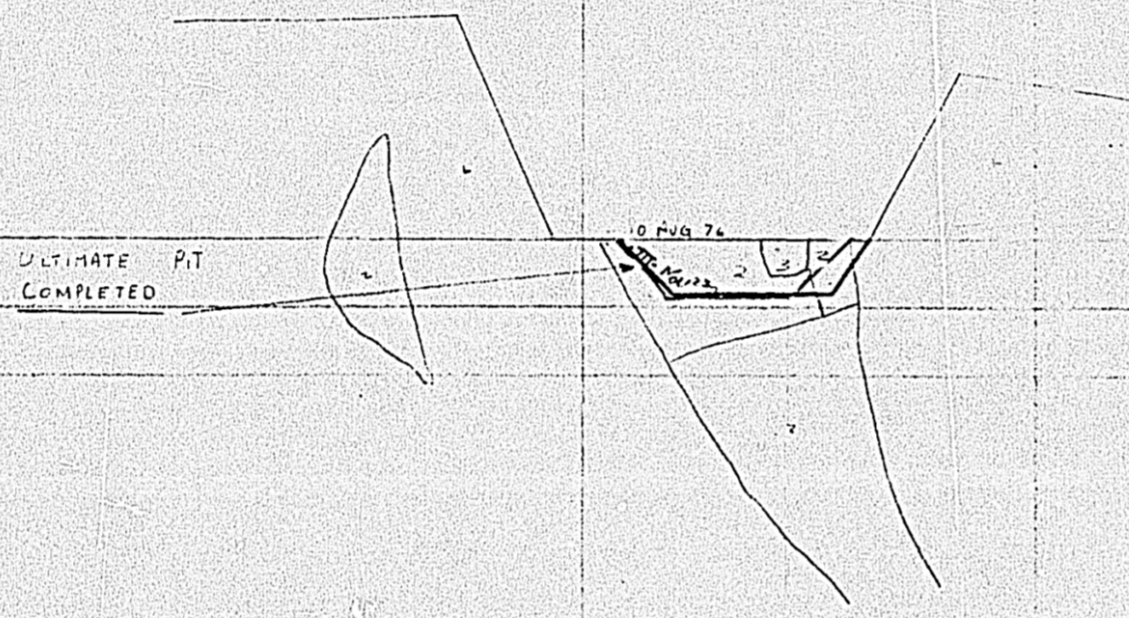

980

955

930

SECTION  
16 W

ULTIMATE PIT  
COMPLETED

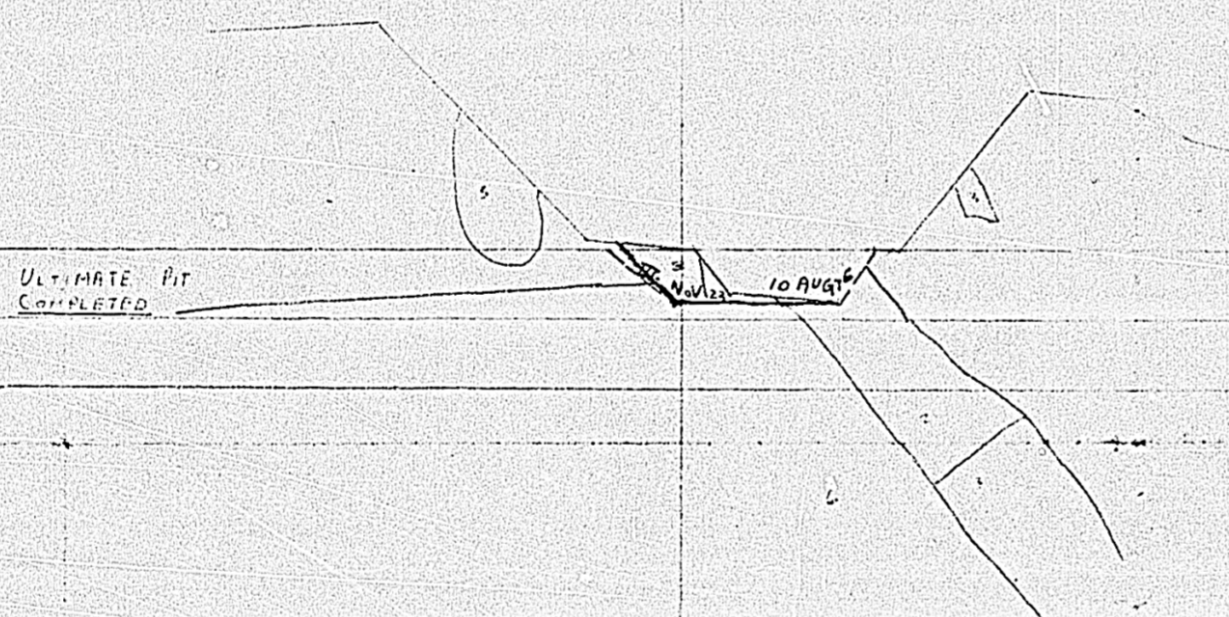

980

955

930

SECTION  
15 W

ULTIMATE PIT  
COMPLETED

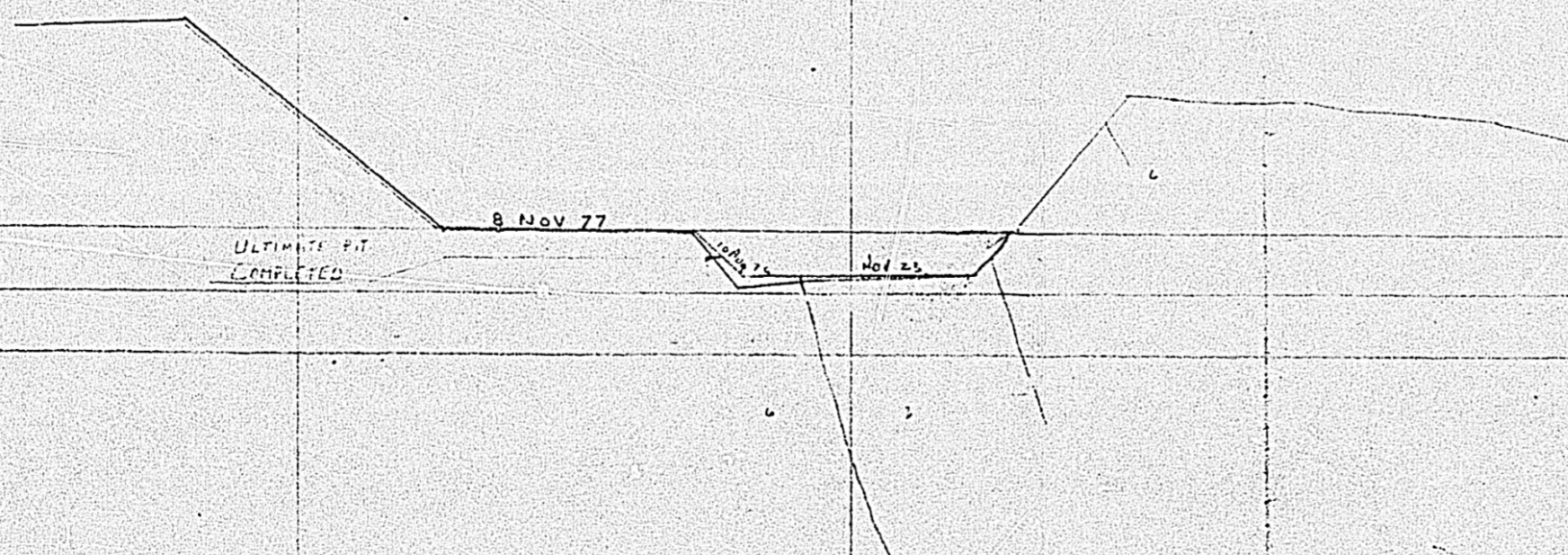

980

955

930

SECTION  
14 W

BOLDUC MINE

1" = 50'

MINE REVISOR: Nov 23rd/76  
GEOLOGY: JANG/76  
REVISED: Nov 18/76

SEP 22/76 HW  
7 DEC 1977

FILE 1-D-3

2/2

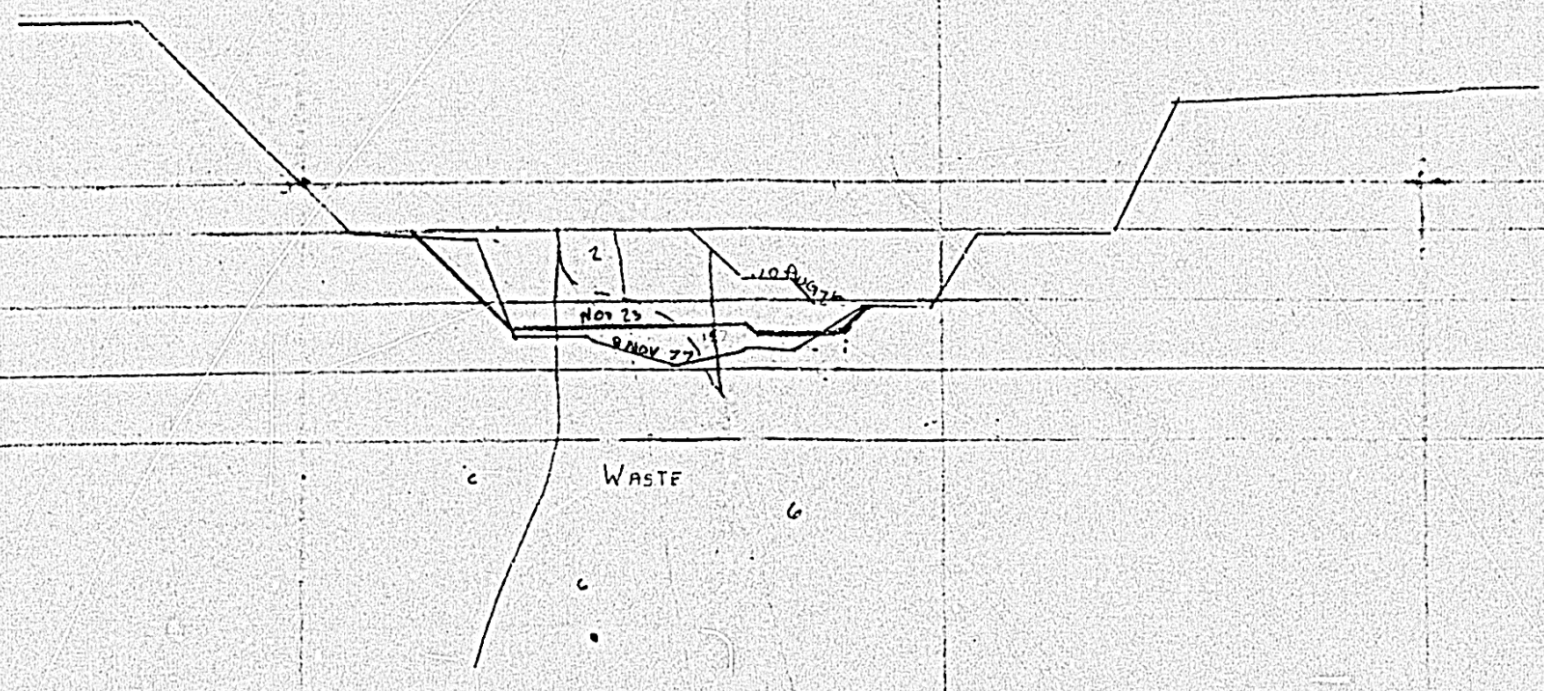

980  
955  
930  
905

SECTION  
13 W

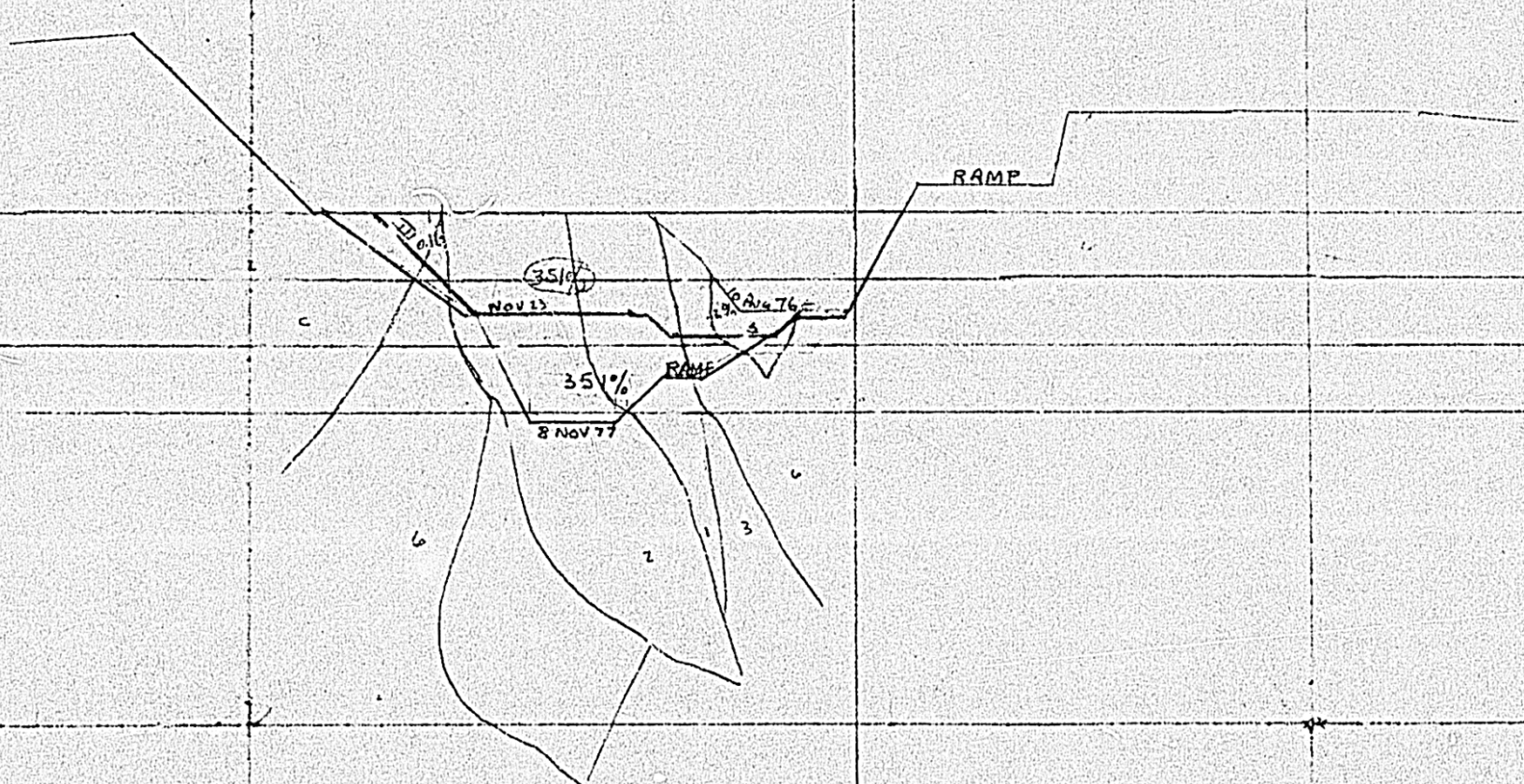

980  
955  
930  
905

SECTION  
12 W

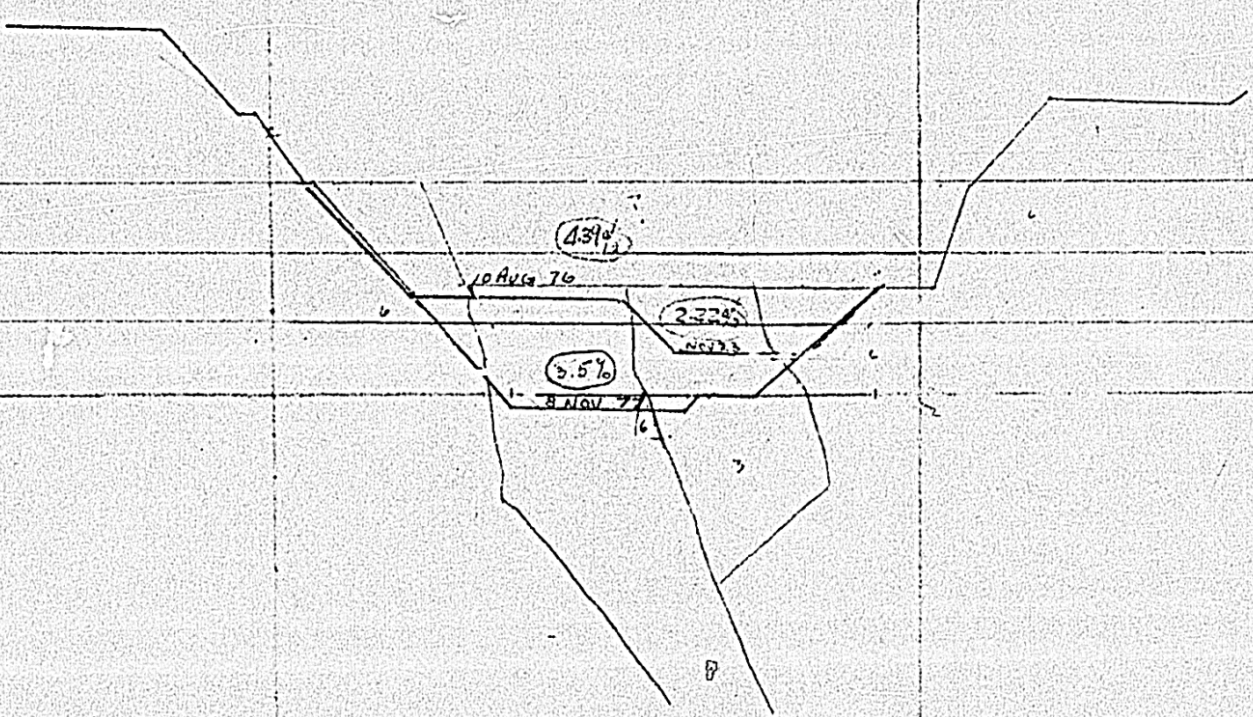

980  
955  
930  
905

SECTION  
11 W

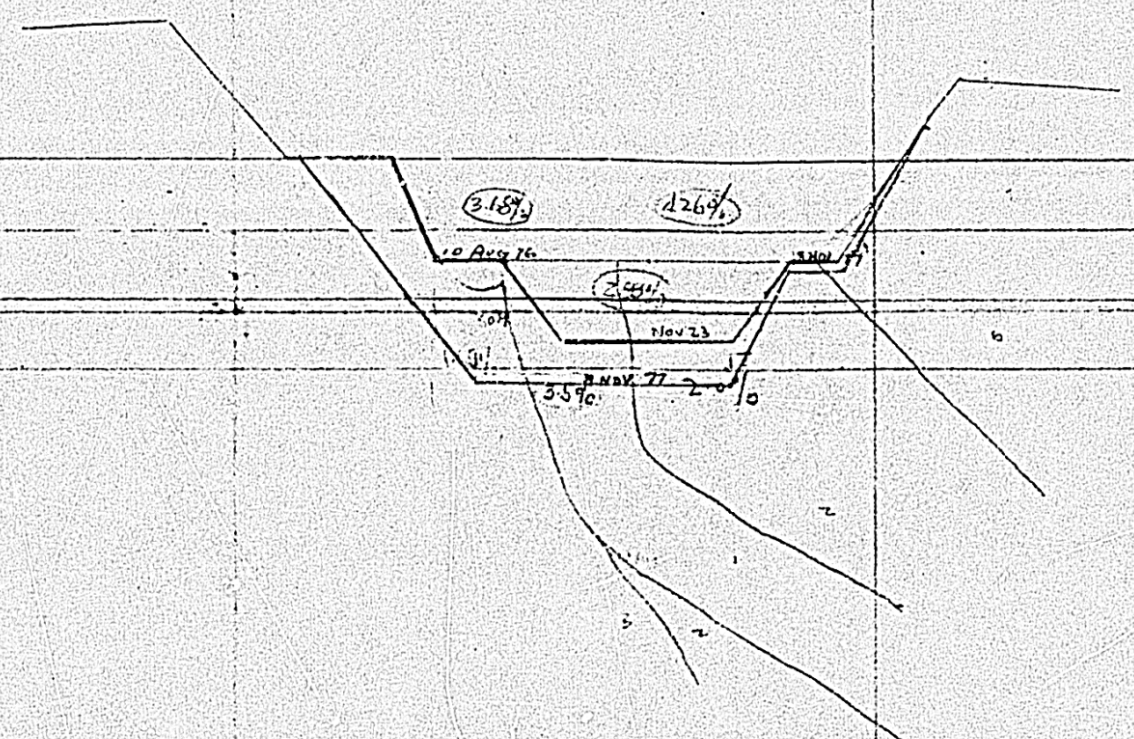

980  
955  
930  
905

SECTION  
10 W

980

1/2

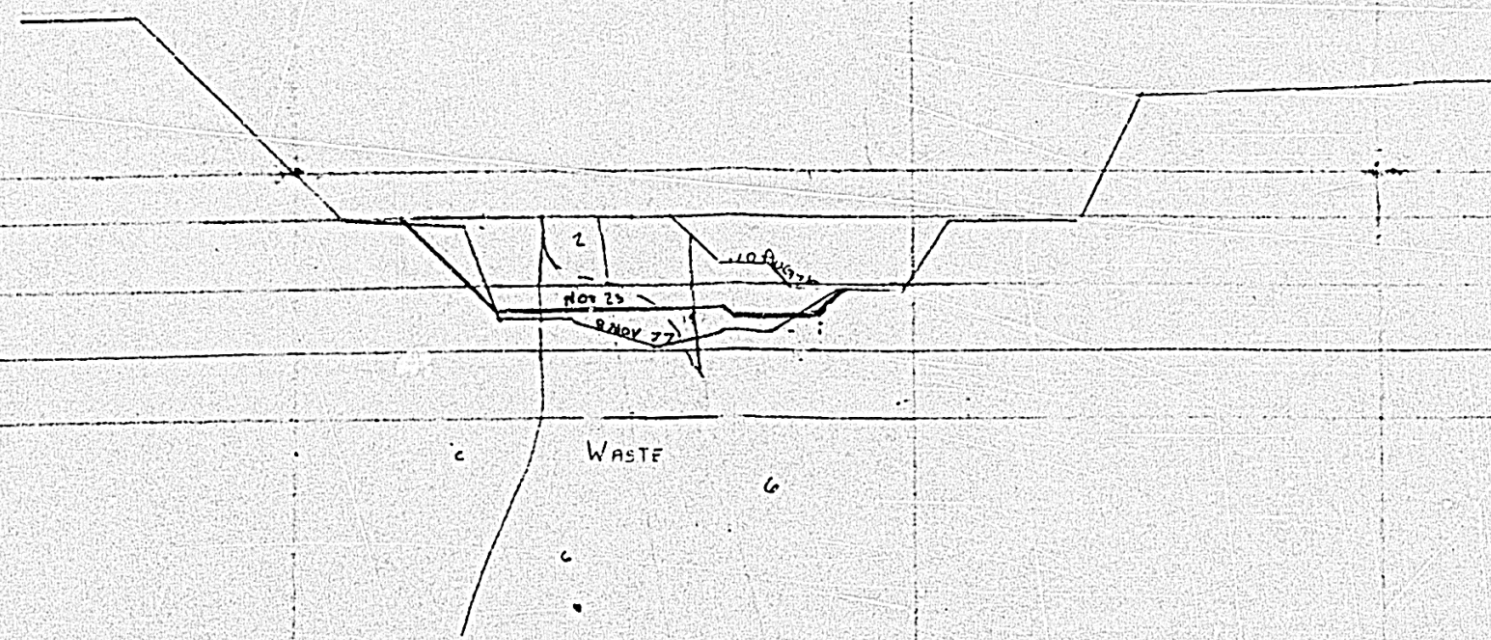

SECTION  
13 W

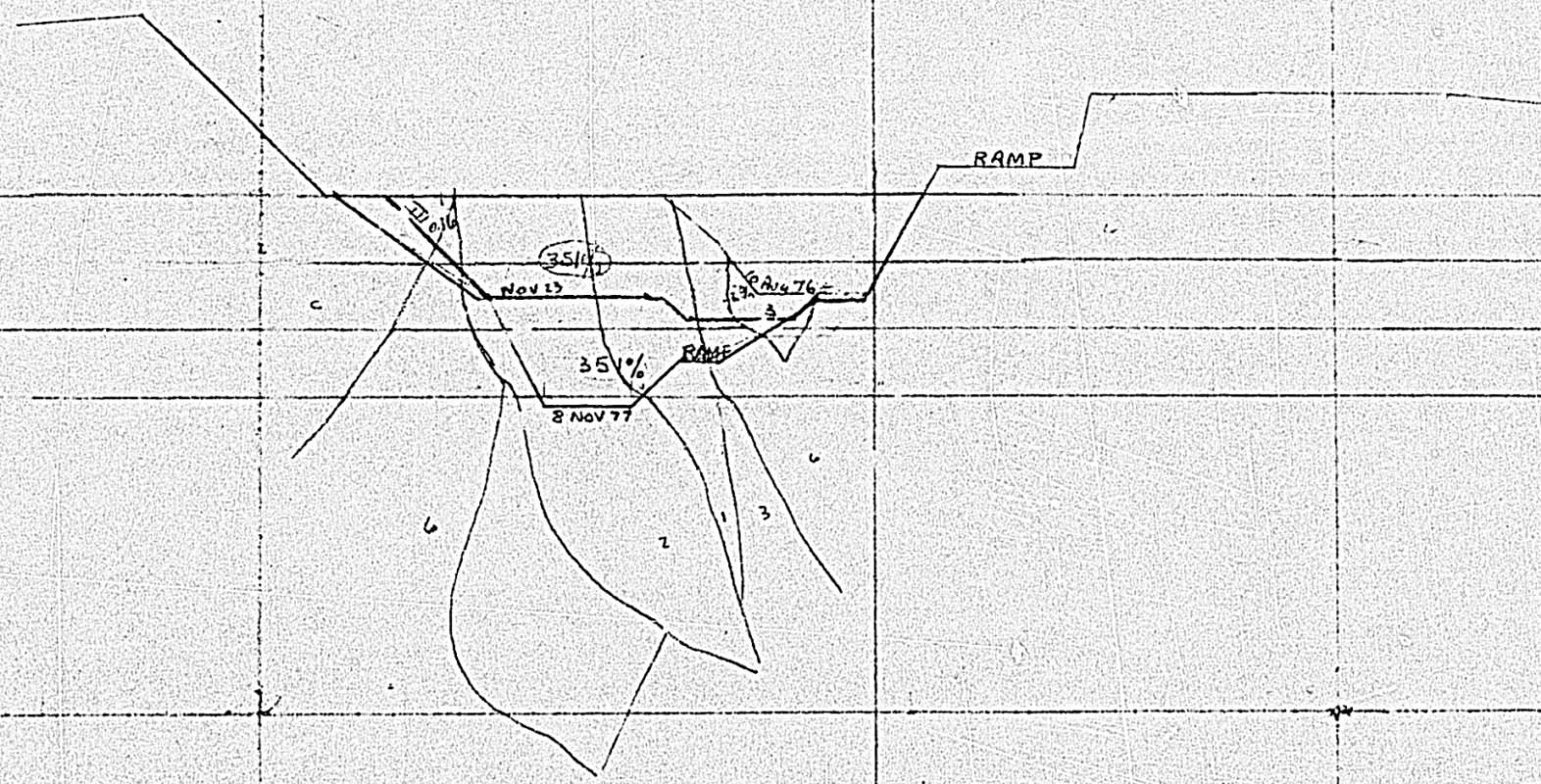

SECTION  
12 W

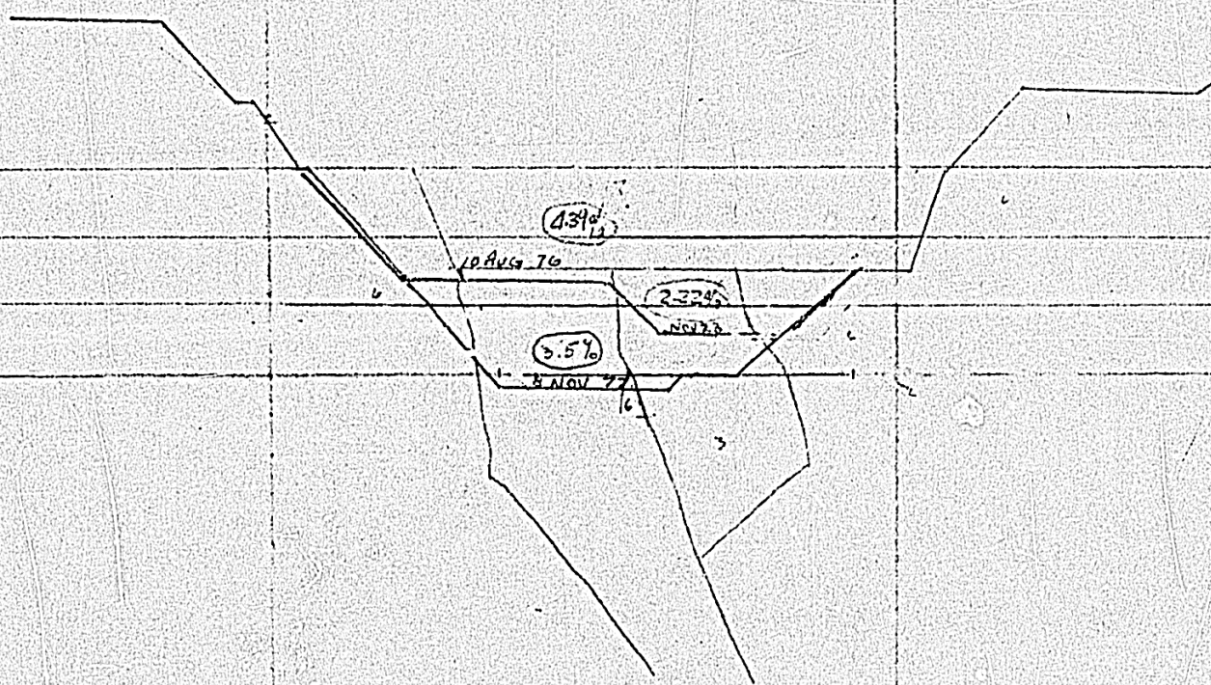

SECTION  
11 W

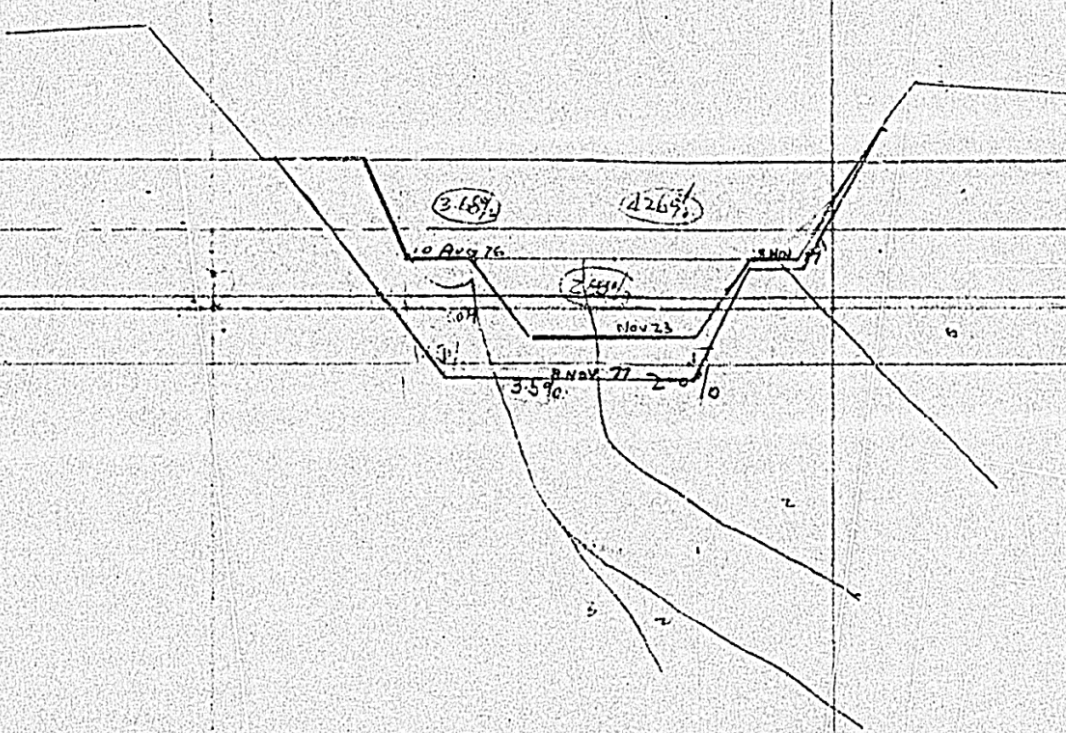

SECTION  
10 W

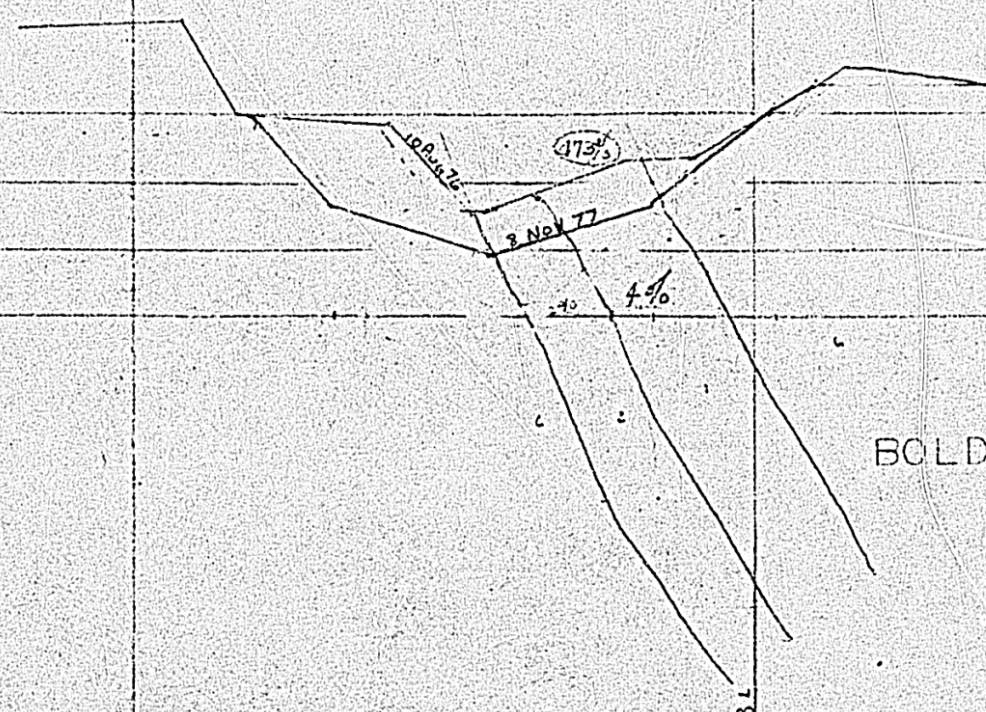

BOLDUC MINE

SECTION  
9 W

1" = 50'

Map was Revised: Nov. 25/76

Geology: JAN 9/76  
Revised: Nov 18/76

SEP. 22/76

FILE I-D-3

7 DEC 1977

2/2

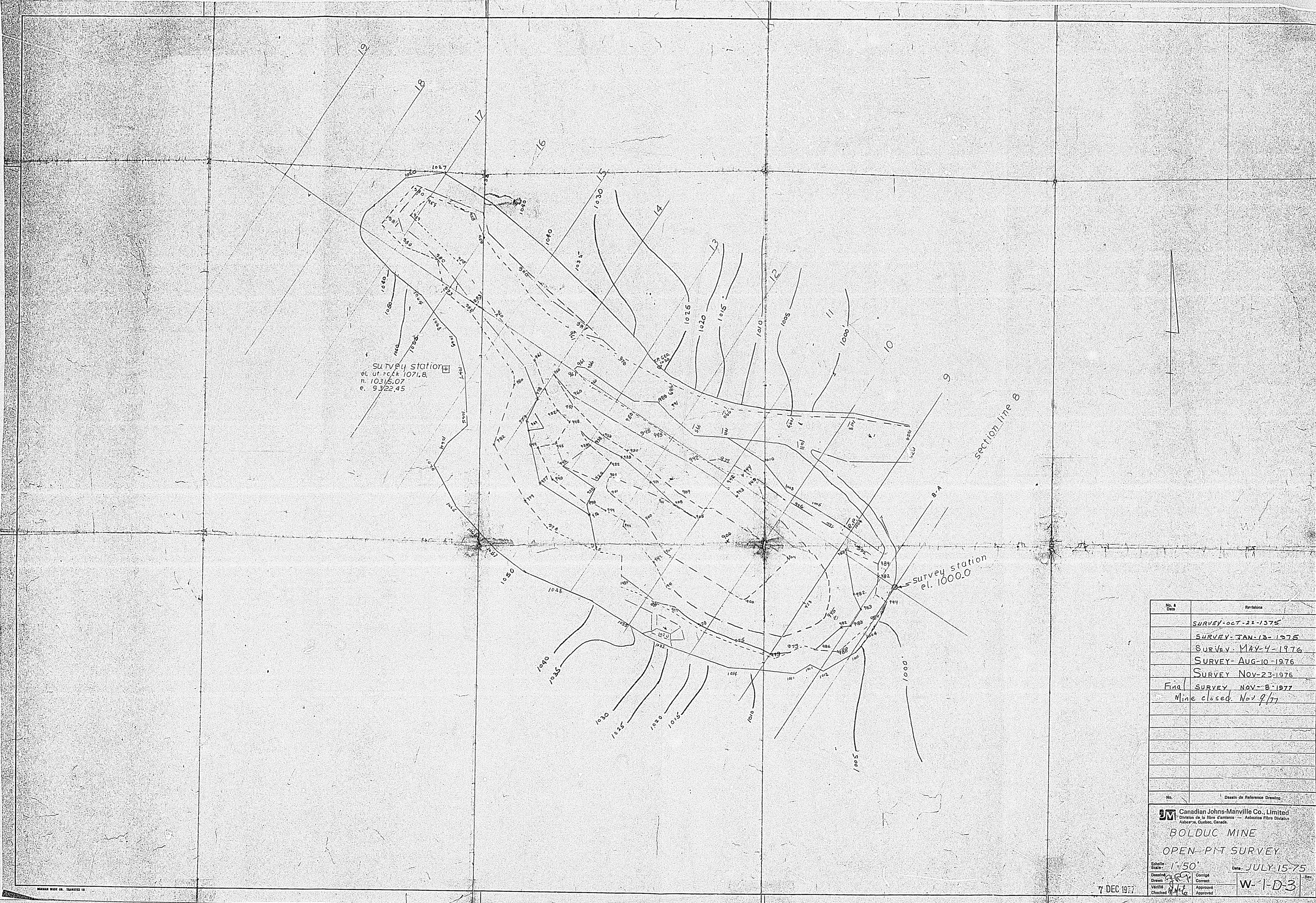

No. & Date	Revisions
	SURVEY-OCT-22-1975
	SURVEY-JAN-13-1976
	SURVEY-MAY-4-1976
	SURVEY-AUG-10-1976
	SURVEY-NOV-23-1976
	Final SURVEY-NOV-8-1977
	Mine closed Nov 9/77

No. \_\_\_\_\_ Dessin de Reference Drawing

**Canadian Johns-Manville Co., Limited**  
 Division de la fibre d'amianto - Asbestos Fibre Division  
 Asbestos, Quebec, Canada

**BOLDUC MINE**

**OPEN-PIT SURVEY**

Echelle/Scale: 1"=50' Date: JULY-15-75

Drawn: *[Signature]* Correct: \_\_\_\_\_  
 Verified: *[Signature]* Approved: \_\_\_\_\_  
 Checked: *[Signature]* Approved: \_\_\_\_\_

W-1-D-3

7 DEC 1977