

Casing	Carbonate Vein
Diabase Dyke	Diabase
Felsic Dyke	Gabbro
Intermediate Volcanic	Lost Core
Leucogabbro	Mafic Dyke
Melagabbro	Massive Sulphide
Metasediment	Metavolcanic
Mafic Volcanic	Pegmatite
Pelite	Paragneiss
Poikilitic Gabbro	Meta-psammite
Metapyroxenite	Quartz Gabbro
Quartzite	Quartz Vein
Siltstone	Metased-Schist
Unknown	

Cu (%) Left of column	
0 - 0.5	0.5 - 0.75
0.75 - 1	1 - 1.5
> 1.5	
Ni (%) Right of column	
0 - 0.5	0.5 - 0.75
0.75 - 1	1 - 1.5
> 1.5	

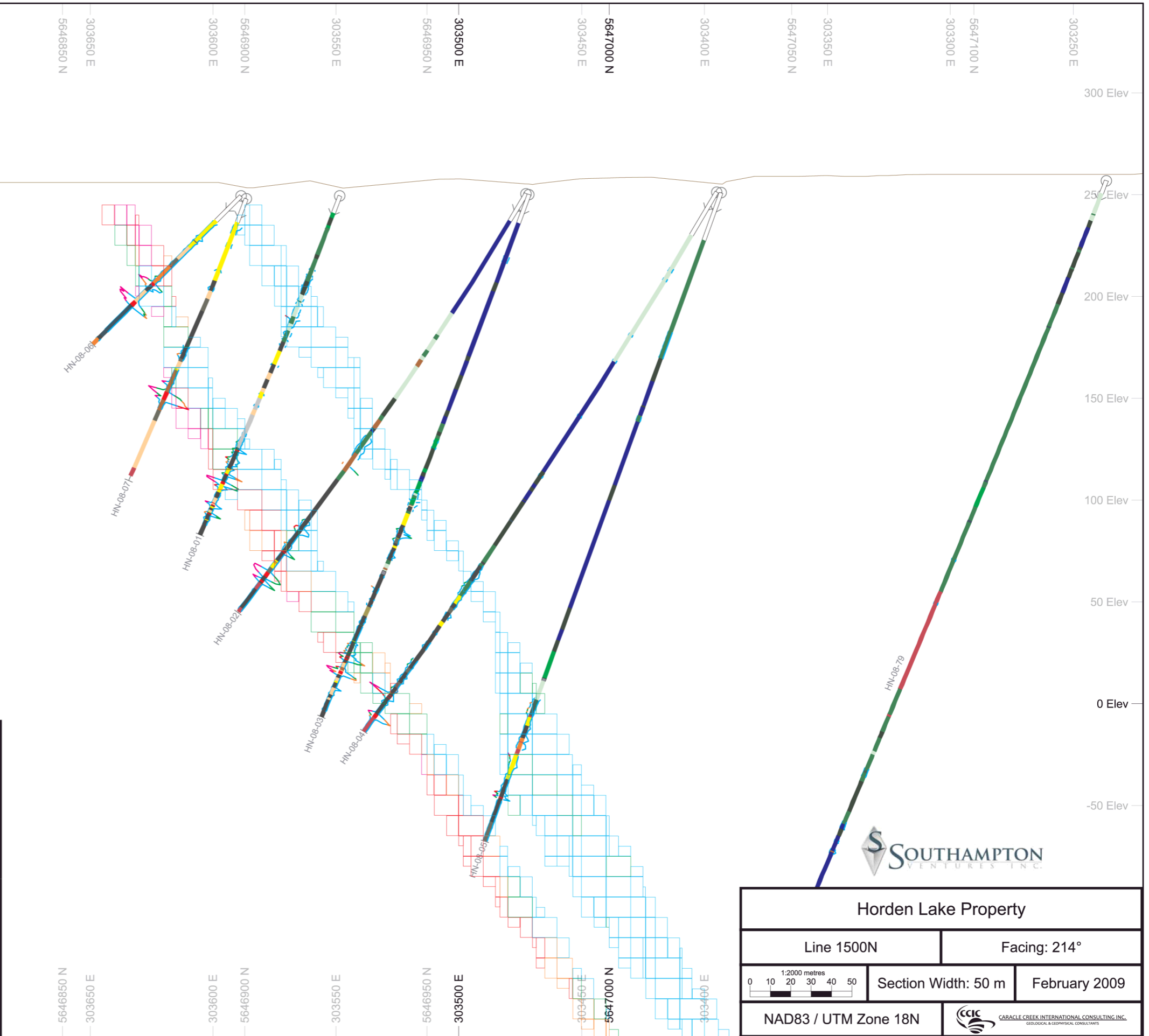

SOUTHAMPTON
VENTURES INC.

Hornden Lake Property	
Line 1500N	Facing: 214°
0 10 20 30 40 50 1:2000 metres	Section Width: 50 m
February 2009	
NAD83 / UTM Zone 18N	CARACLE CREEK INTERNATIONAL CONSULTING INC. GEOLOGICAL & GEOPHYSICAL CONSULTANTS

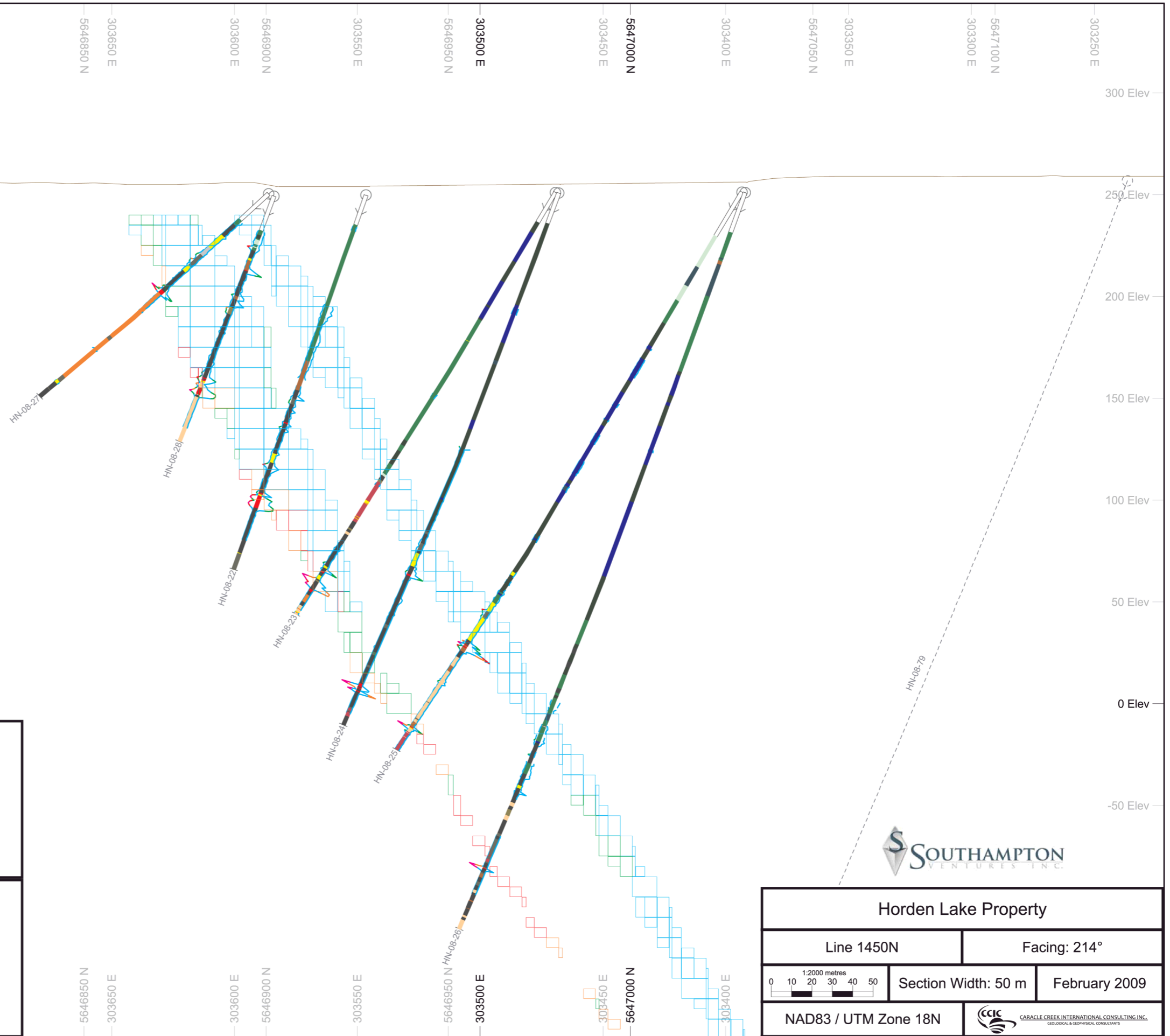
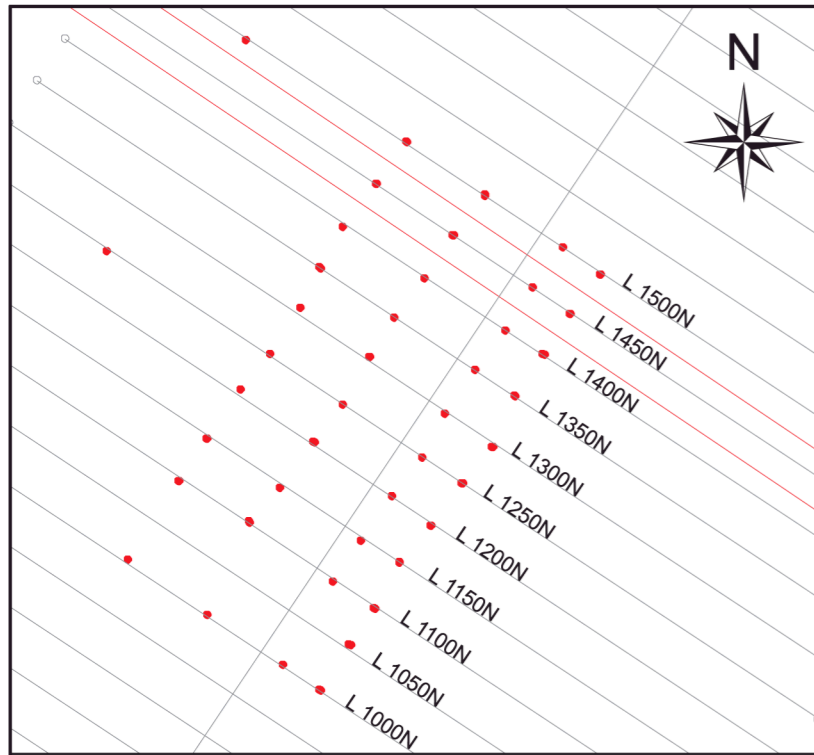

Casing	Carbonate Vein
Diabase Dyke	Diabase
Felsic Dyke	Gabbro
Intermediate Volcanic	Lost Core
Leucogabbro	Mafic Dyke
Melagabbro	Massive Sulphide
Metasediment	Metavolcanic
Mafic Volcanic	Pegmatite
Pelite	Paragneiss
Poikilitic Gabbro	Meta-psammite
Metapyroxenite	Quartz Gabbro
Quartzite	Quartz Vein
Siltstone	Metased-Schist
Unknown	

Cu (%) Left of column	
0 - 0.5	—
0.5 - 0.75	—
0.75 - 1	—
1 - 1.5	—
> 1.5	—
Ni (%) Right of column	
0 - 0.5	—
0.5 - 0.75	—
0.75 - 1	—
1 - 1.5	—
> 1.5	—



Hornden Lake Property	
Line 1450N	Facing: 214°
	Section Width: 50 m
February 2009	
NAD83 / UTM Zone 18N	
<small>CARACLE CREEK INTERNATIONAL CONSULTING INC. GEOLOGICAL & GEOPHYSICAL CONSULTANTS</small>	

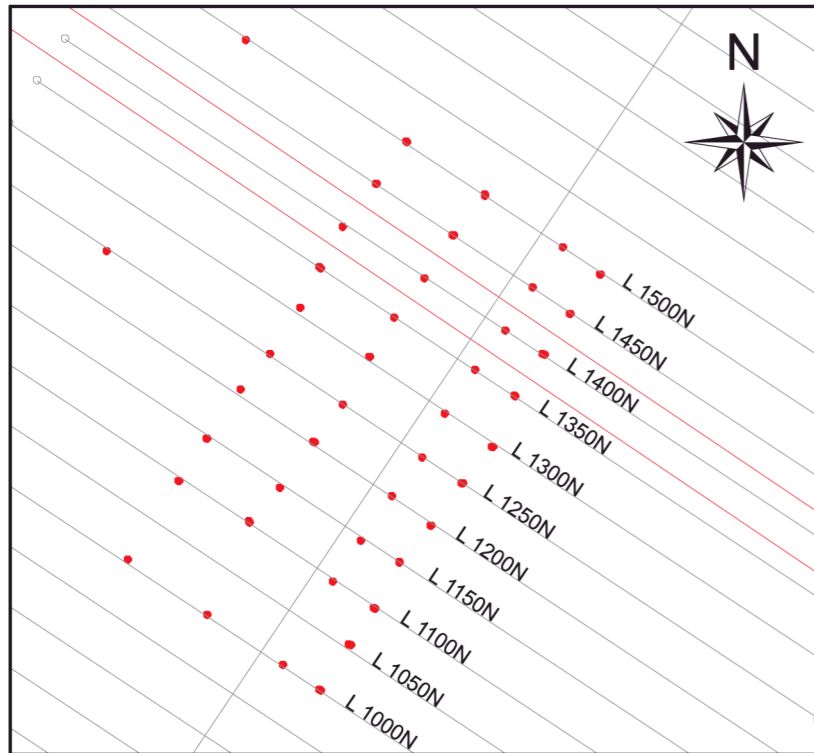

Casing	Carbonate Vein
Diabase Dyke	Diabase
Felsic Dyke	Gabbro
Intermediate Volcanic	Lost Core
Leucogabbro	Mafic Dyke
Melagabbro	Massive Sulphide
Metasediment	Metavolcanic
Mafic Volcanic	Pegmatite
Pelite	Paragneiss
Poikilitic Gabbro	Meta-psammite
Metapyroxenite	Quartz Gabbro
Quartzite	Quartz Vein
Siltstone	Metased-Schist
Unknown	

Cu (%) Left of column	
0 - 0.5	0.75 - 1
0.5 - 0.75	1 - 1.5
0.75 - 1	> 1.5
1 - 1.5	
> 1.5	
Ni (%) Right of column	
0 - 0.5	0.75 - 1
0.5 - 0.75	1 - 1.5
0.75 - 1	> 1.5
1 - 1.5	
> 1.5	

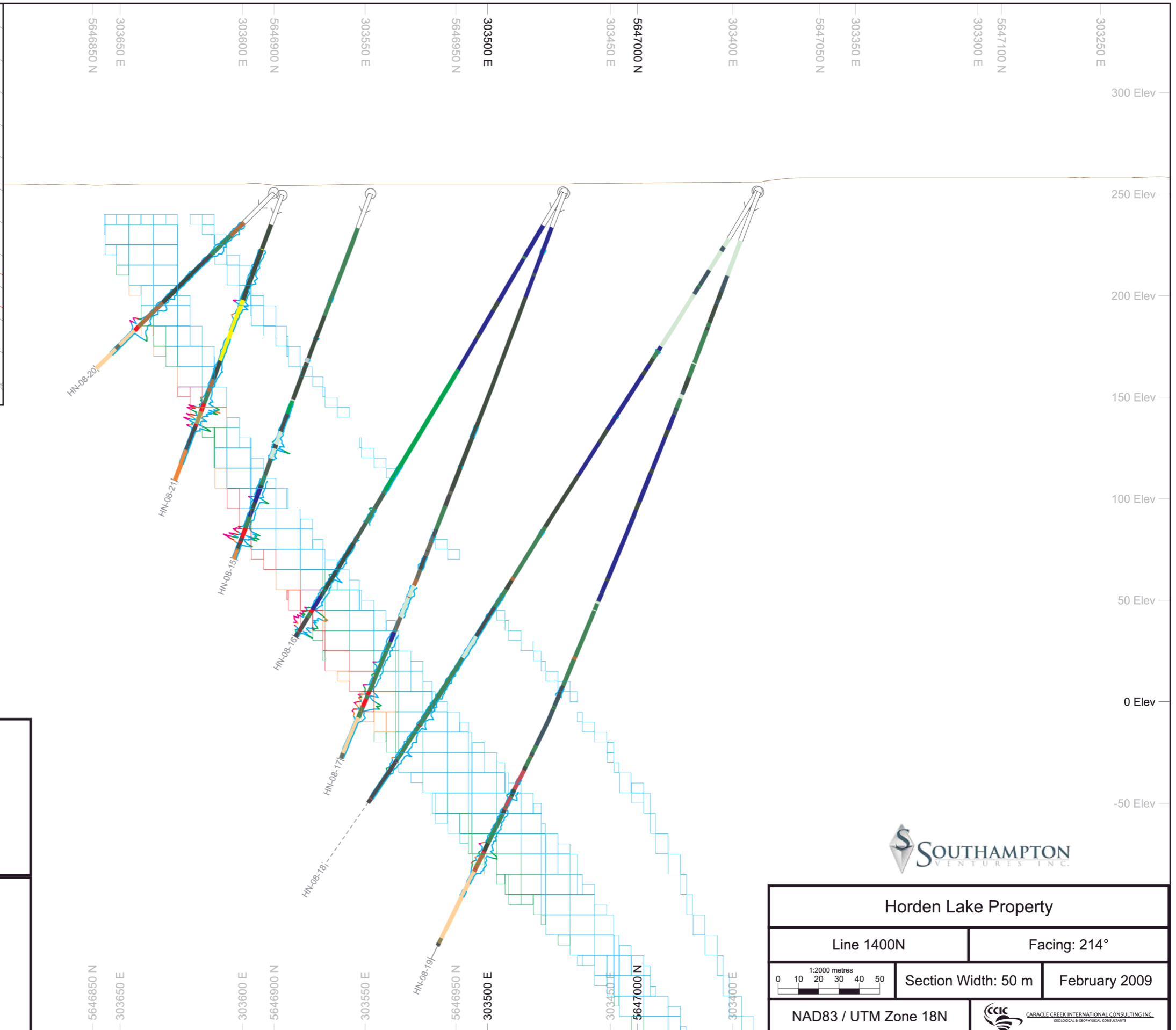

Hornden Lake Property		
Line 1400N	Facing: 214°	
	Section Width: 50 m	February 2009
NAD83 / UTM Zone 18N		 <small>CARACLE CREEK INTERNATIONAL CONSULTING INC.</small> <small>GEOLOGICAL & GEOPHYSICAL CONSULTANTS</small>

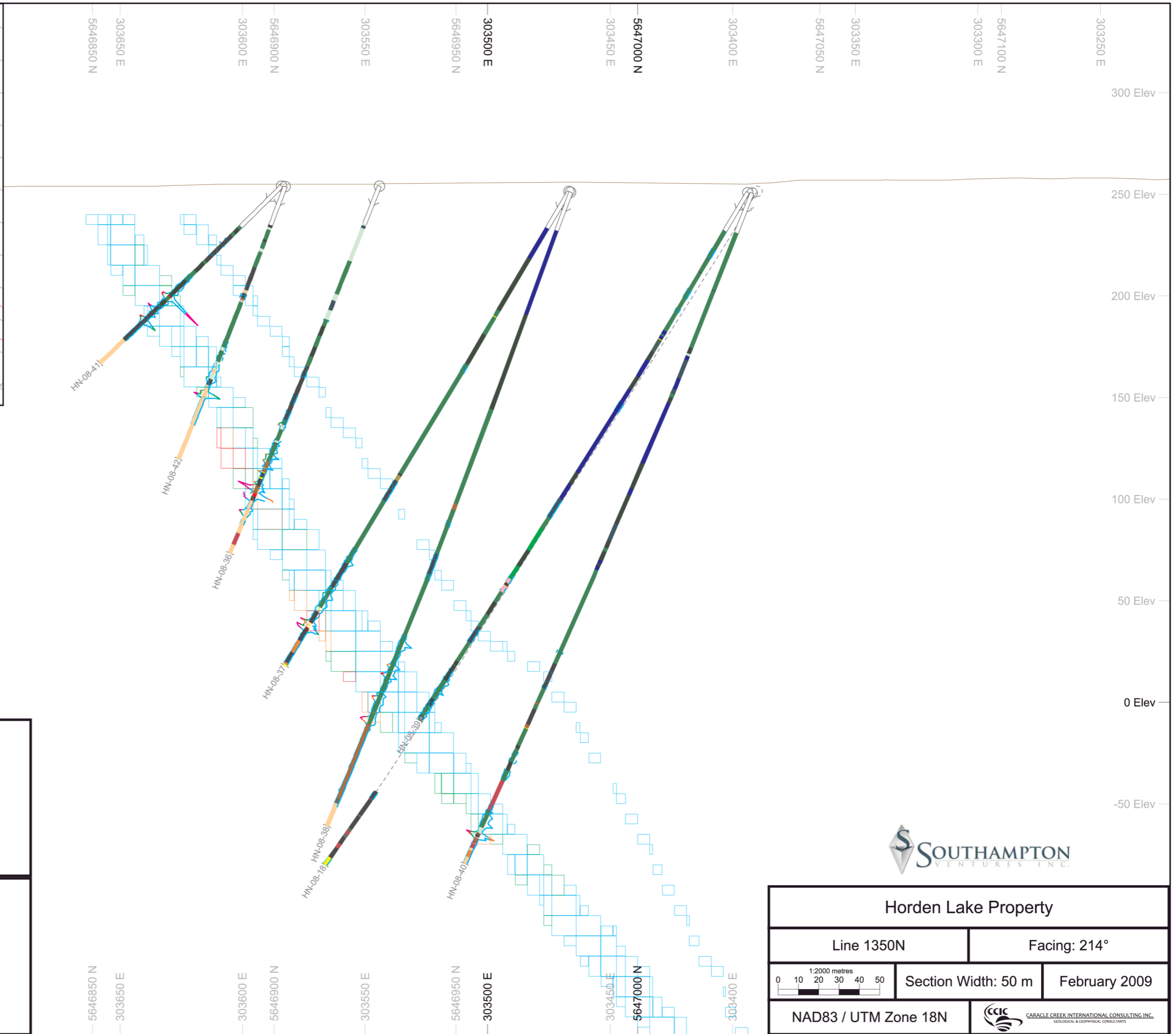
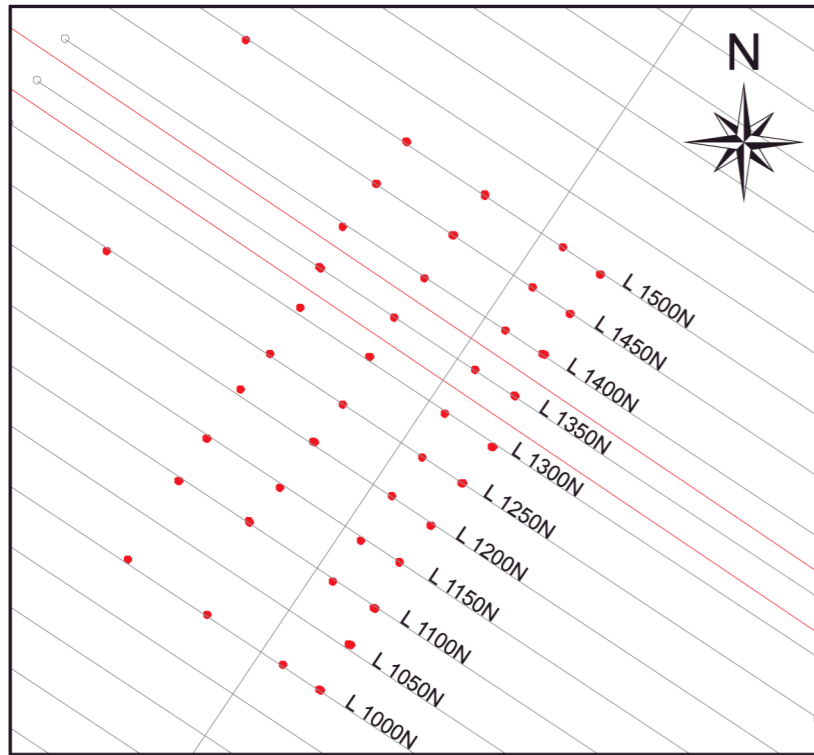

Casing	Carbonate Vein
Diabase Dyke	Diabase
Felsic Dyke	Gabbro
Intermediate Volcanic	Lost Core
Leucogabbro	Mafic Dyke
Melagabbro	Massive Sulphide
Metasediment	Metavolcanic
Mafic Volcanic	Pegmatite
Pelite	Paragneiss
Poikilitic Gabbro	Meta-psammite
Metapyroxenite	Quartz Gabbro
Quartzite	Quartz Vein
Siltstone	Metased-Schist
Unknown	

Cu (%) Left of column	
0 - 0.5	—
0.5 - 0.75	—
0.75 - 1	—
1 - 1.5	—
> 1.5	—
Ni (%) Right of column	
0 - 0.5	—
0.5 - 0.75	—
0.75 - 1	—
1 - 1.5	—
> 1.5	—



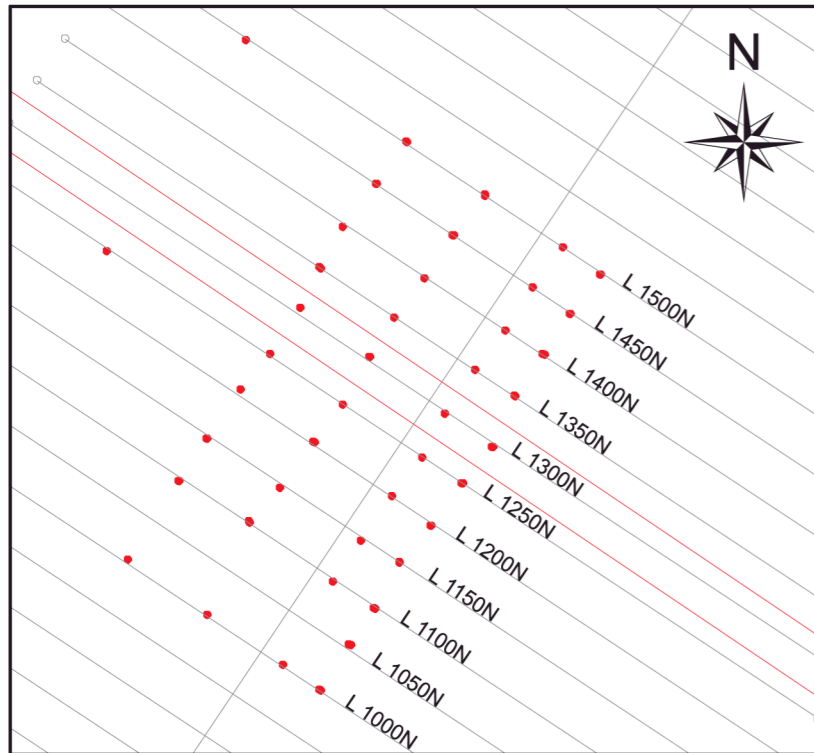

Horden Lake Property		
Line 1350N	Facing: 214°	
	Section Width: 50 m	February 2009
NAD83 / UTM Zone 18N		 <small>CARACLE CREEK INTERNATIONAL CONSULTING INC. GEOLOGICAL & GEOPHYSICAL CONSULTANTS</small>

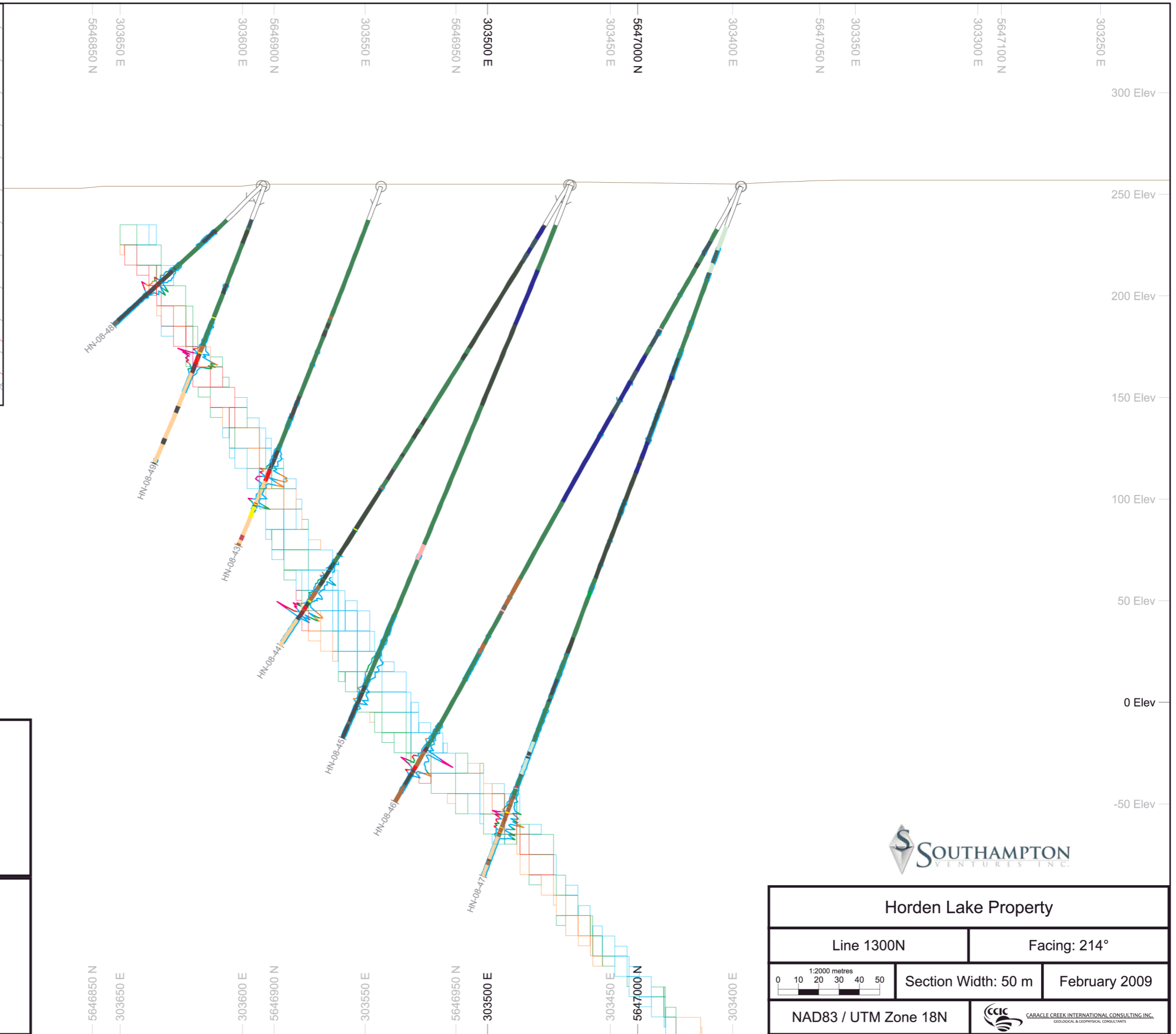

Casing	Carbonate Vein
Diabase Dyke	Diabase
Felsic Dyke	Gabbro
Intermediate Volcanic	Lost Core
Leucogabbro	Mafic Dyke
Melagabbro	Massive Sulphide
Metasediment	Metavolcanic
Mafic Volcanic	Pegmatite
Pelite	Paragneiss
Poikilitic Gabbro	Meta-psammite
Metapyroxenite	Quartz Gabbro
Quartzite	Quartz Vein
Siltstone	Metased-Schist
Unknown	

Cu (%) Left of column	
0 - 0.5	0.5 - 0.75
0.75 - 1	1 - 1.5
1 - 1.5	> 1.5
Ni (%) Right of column	
0 - 0.5	0.5 - 0.75
0.75 - 1	1 - 1.5
1 - 1.5	> 1.5



Horden Lake Property		
Line 1300N	Facing: 214°	
0 10 20 30 40 50 1:2000 metres	Section Width: 50 m	February 2009
NAD83 / UTM Zone 18N		 CARACLE CREEK INTERNATIONAL CONSULTING INC. <small>GEOLOGICAL & GEOPHYSICAL CONSULTANTS</small>

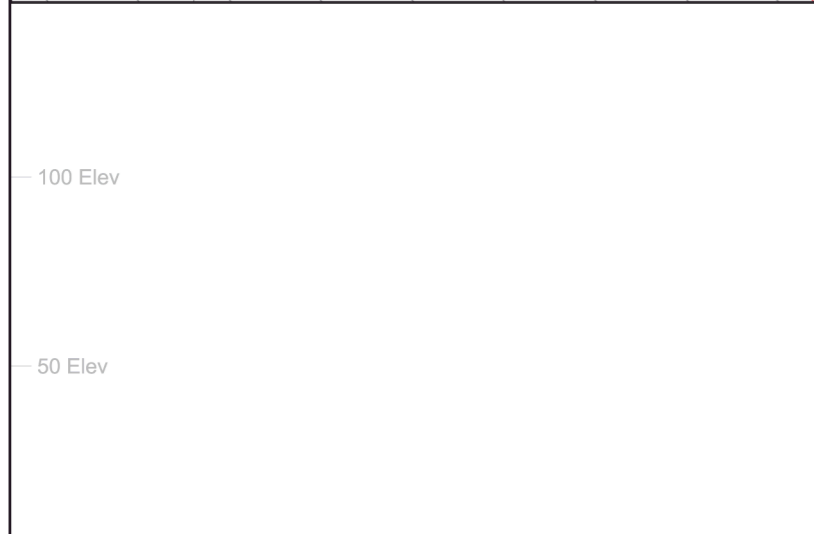
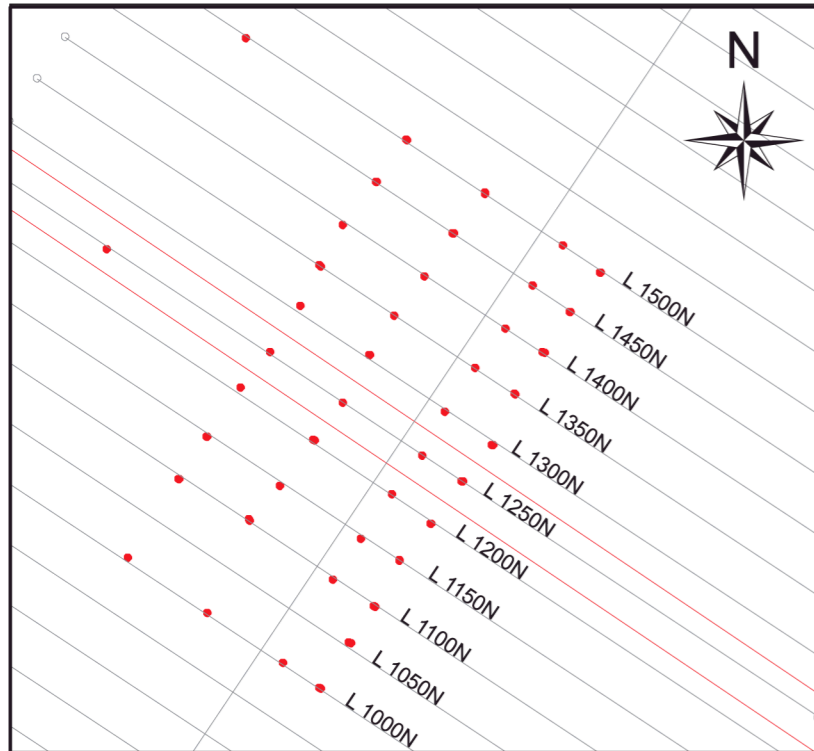

Casing	Carbonate Vein
Diabase Dyke	Diabase
Felsic Dyke	Gabbro
Intermediate Volcanic	Lost Core
Leucogabbro	Mafic Dyke
Melagabbro	Massive Sulphide
Metasediment	Metavolcanic
Mafic Volcanic	Pegmatite
Pelite	Paragneiss
Poikilitic Gabbro	Meta-psammite
Metapyroxenite	Quartz Gabbro
Quartzite	Quartz Vein
Siltstone	Metased-Schist
Unknown	

Cu (%) Left of column	
0 - 0.5	0.5 - 0.75
0.75 - 1	1 - 1.5
> 1.5	
Ni (%) Right of column	
0 - 0.5	0.5 - 0.75
0.75 - 1	1 - 1.5
> 1.5	

SOUTHAMPTON
VENTURES INC.

Hornden Lake Property

Line 1250N	Facing: 214°	
0 10 20 30 40 50 1:2000 metres	Section Width: 50 m	February 2009
NAD83 / UTM Zone 18N		CARACLE CREEK INTERNATIONAL CONSULTING INC. GEOLOGICAL & GEOPHYSICAL CONSULTANTS

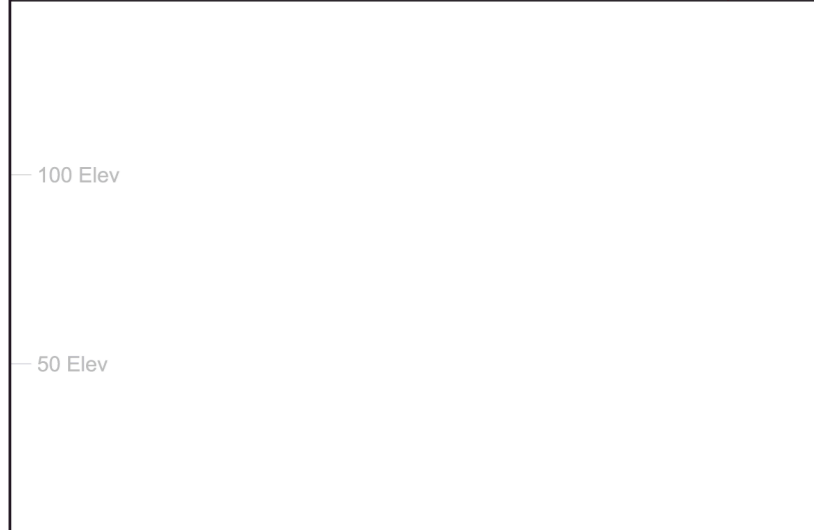
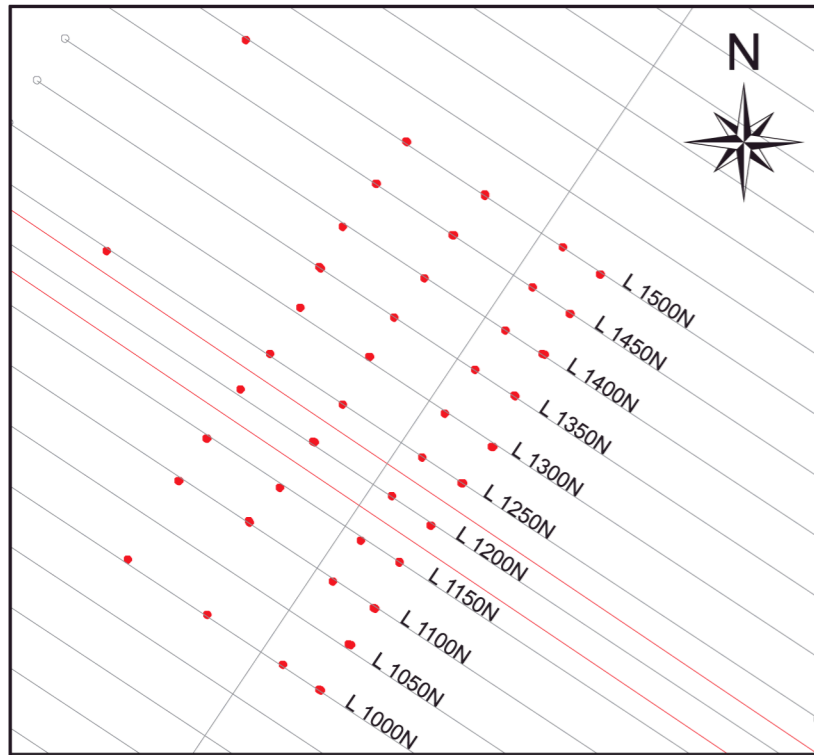

Casing	Carbonate Vein
Diabase Dyke	Diabase
Felsic Dyke	Gabbro
Intermediate Volcanic	Lost Core
Leucogabbro	Mafic Dyke
Melagabbro	Massive Sulphide
Metasediment	Metavolcanic
Mafic Volcanic	Pegmatite
Pelite	Paragneiss
Poikilitic Gabbro	Meta-psammite
Metapyroxenite	Quartz Gabbro
Quartzite	Quartz Vein
Siltstone	Metased-Schist
Unknown	

Cu (%) Left of column	
0 - 0.5	0.5 - 0.75
0.75 - 1	1 - 1.5
1 - 1.5	> 1.5
Ni (%) Right of column	
0 - 0.5	0.5 - 0.75
0.75 - 1	1 - 1.5
1 - 1.5	> 1.5

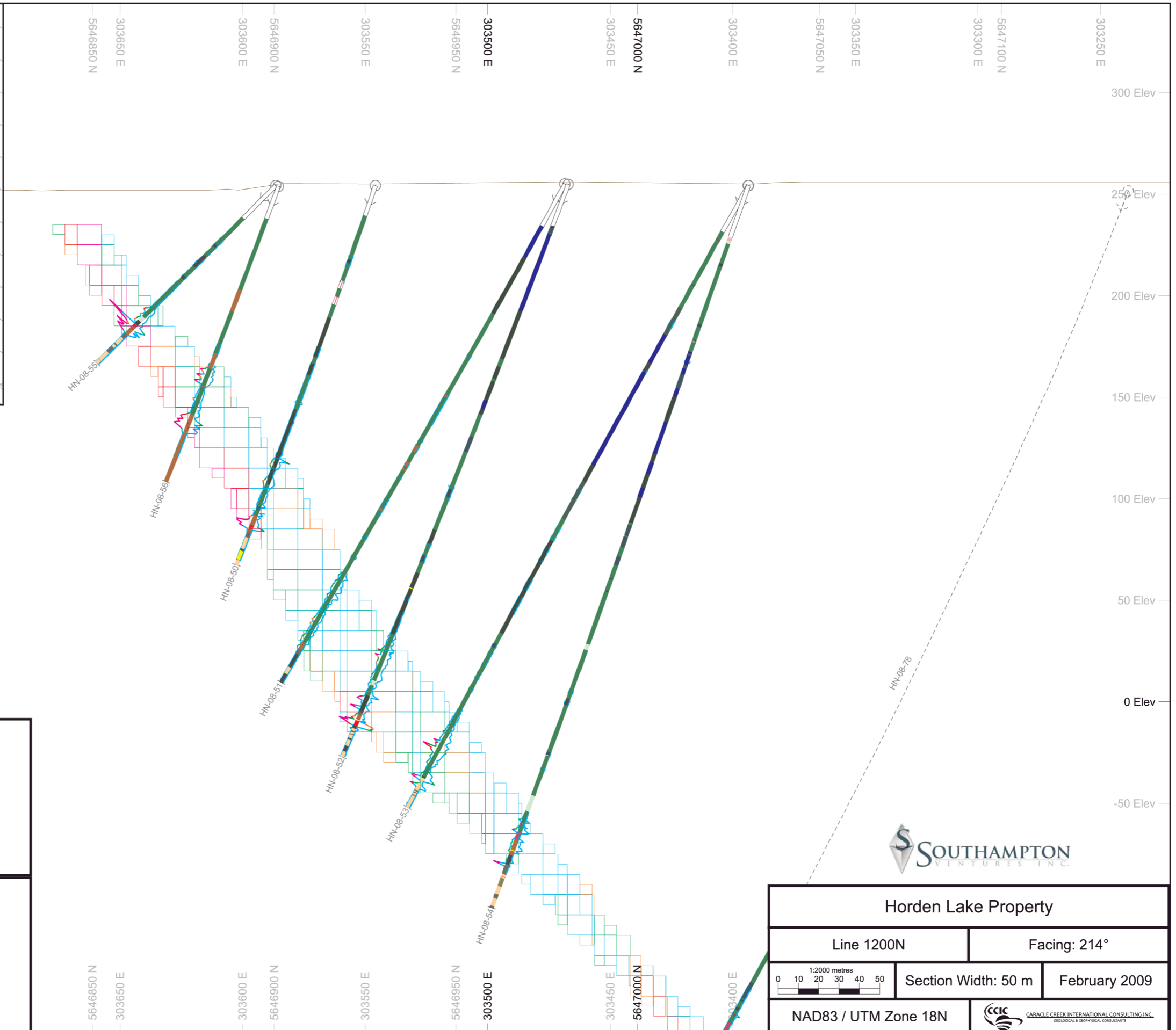

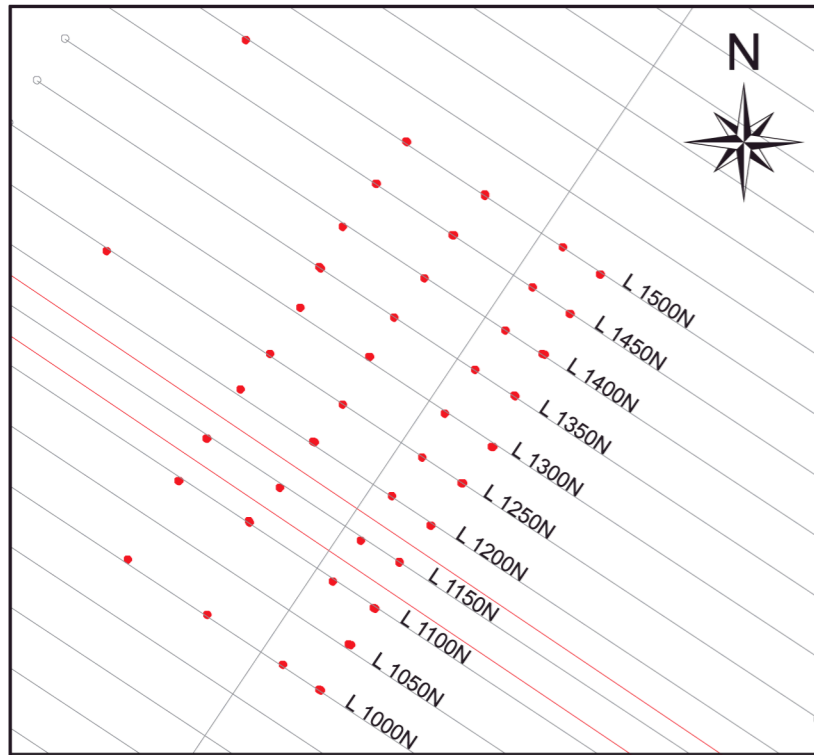

Casing	Carbonate Vein
Diabase Dyke	Diabase
Felsic Dyke	Gabbro
Intermediate Volcanic	Lost Core
Leucogabbro	Mafic Dyke
Melagabbro	Massive Sulphide
Metasediment	Metavolcanic
Mafic Volcanic	Pegmatite
Pelite	Paragneiss
Poikilitic Gabbro	Meta-psammite
Metapyroxenite	Quartz Gabbro
Quartzite	Quartz Vein
Siltstone	Metased-Schist
Unknown	

Cu (%) Left of column	
0 - 0.5	—
0.5 - 0.75	—
0.75 - 1	—
1 - 1.5	—
> 1.5	—
Ni (%) Right of column	
0 - 0.5	—
0.5 - 0.75	—
0.75 - 1	—
1 - 1.5	—
> 1.5	—

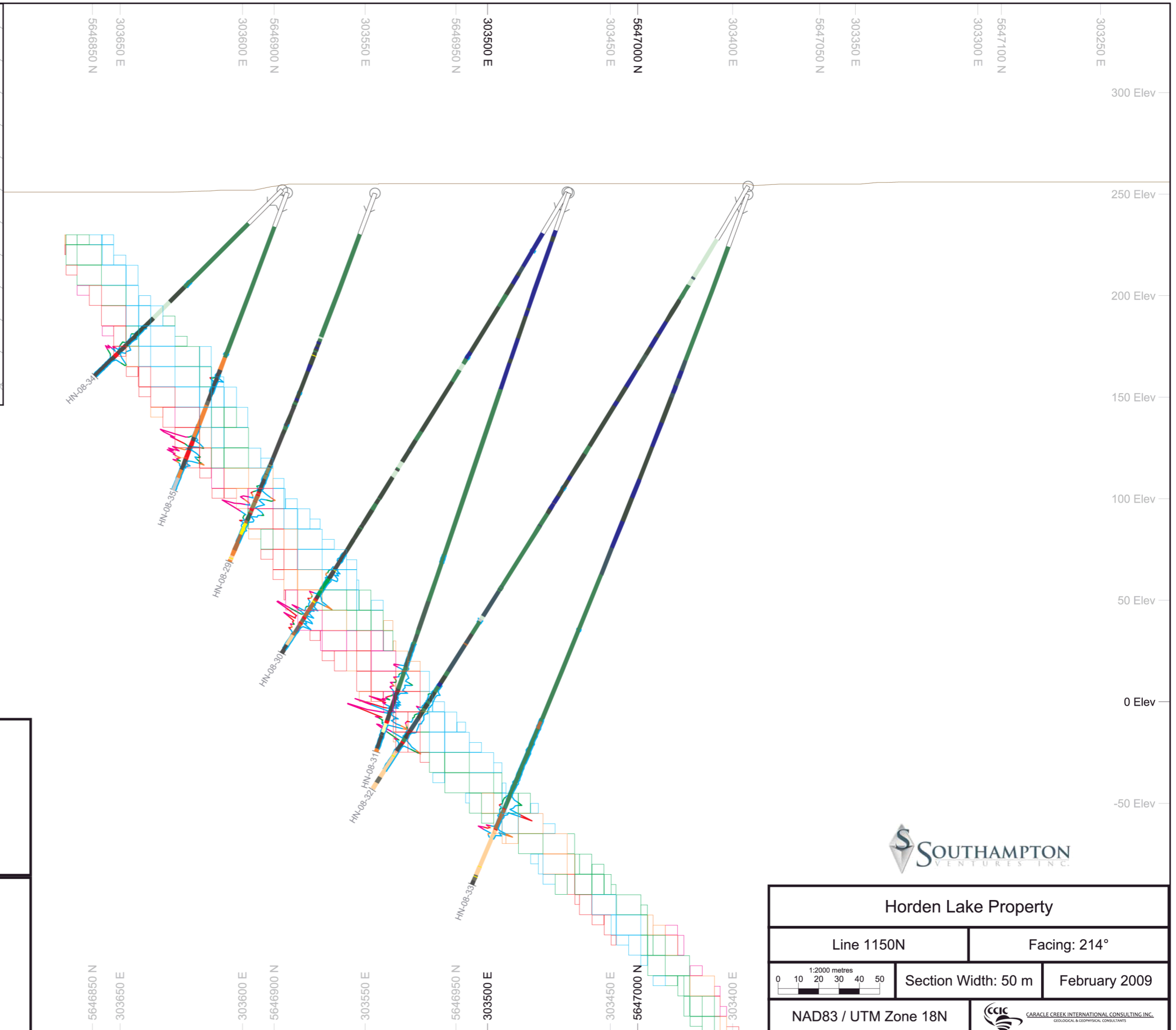

Hornden Lake Property		
Line 1150N	Facing: 214°	
	Section Width: 50 m	February 2009
NAD83 / UTM Zone 18N		 <small>CARACLE CREEK INTERNATIONAL CONSULTING INC.</small> <small>GEOLOGICAL & GEOPHYSICAL CONSULTANTS</small>

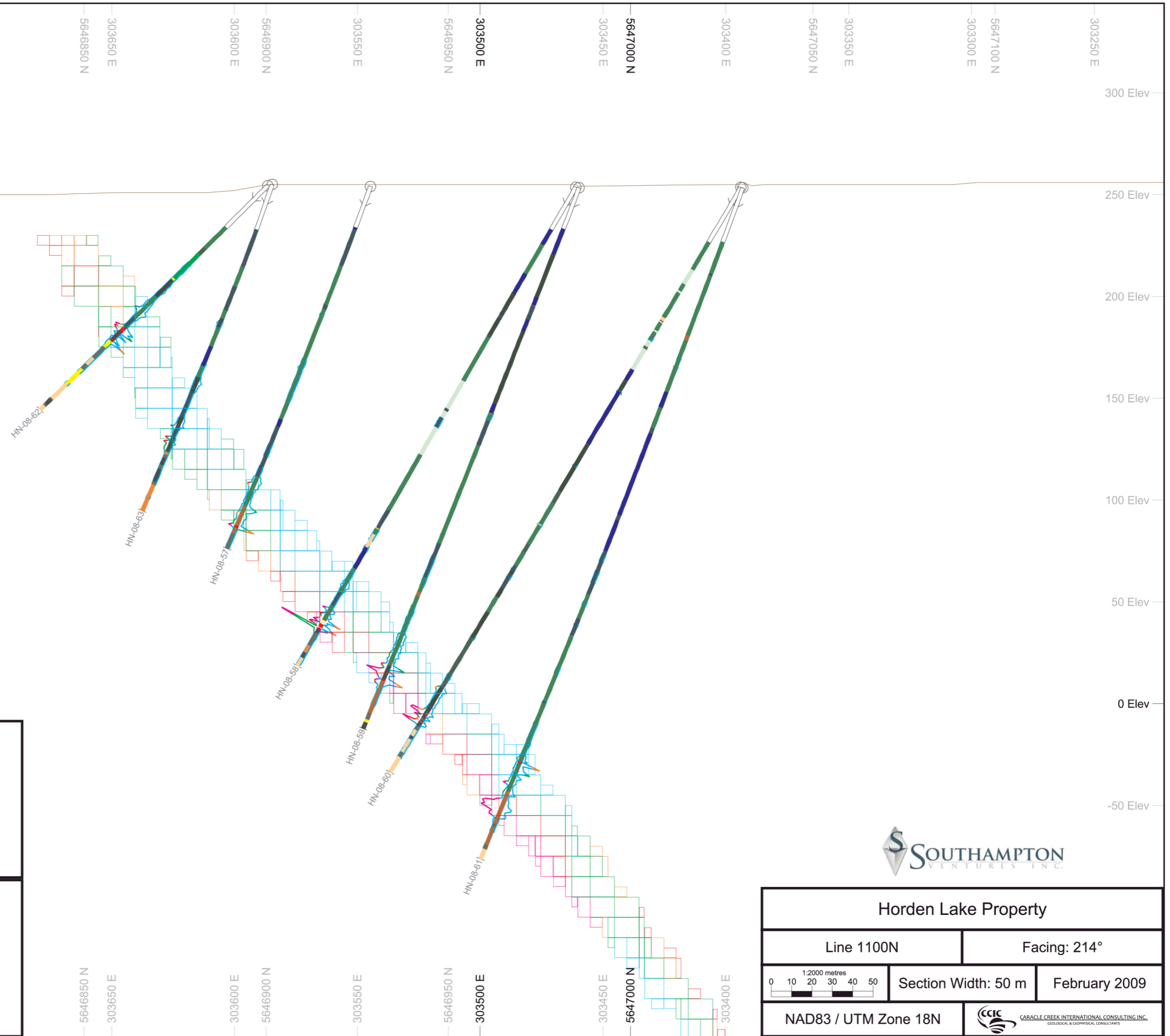
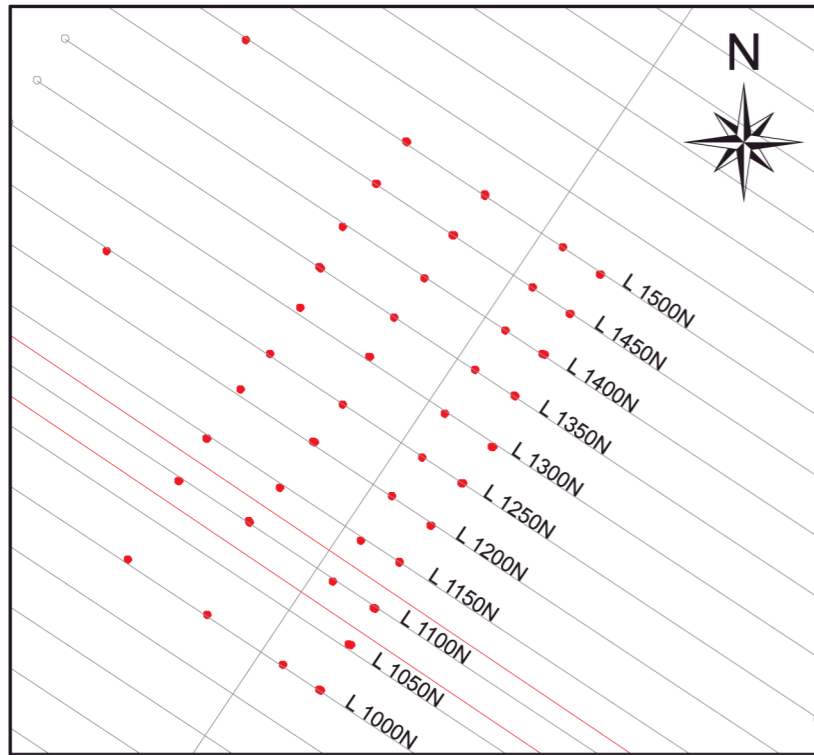

Casing	Carbonate Vein
Diabase Dyke	Diabase
Felsic Dyke	Gabbro
Intermediate Volcanic	Lost Core
Leucogabbro	Mafic Dyke
Melagabbro	Massive Sulphide
Metasediment	Metavolcanic
Mafic Volcanic	Pegmatite
Pelite	Paragneiss
Poikilitic Gabbro	Meta-psammite
Metapyroxenite	Quartz Gabbro
Quartzite	Quartz Vein
Siltstone	Metased-Schist
Unknown	

Cu (%) Left of column	
0 - 0.5	—
0.5 - 0.75	—
0.75 - 1	—
1 - 1.5	—
> 1.5	—
Ni (%) Right of column	
0 - 0.5	—
0.5 - 0.75	—
0.75 - 1	—
1 - 1.5	—
> 1.5	—



Hornden Lake Property		
Line 1100N	Facing: 214°	
	Section Width: 50 m	February 2009
NAD83 / UTM Zone 18N		 <small>CARACLE CREEK INTERNATIONAL CONSULTING INC. GEOLOGICAL & GEOPHYSICAL CONSULTANTS</small>

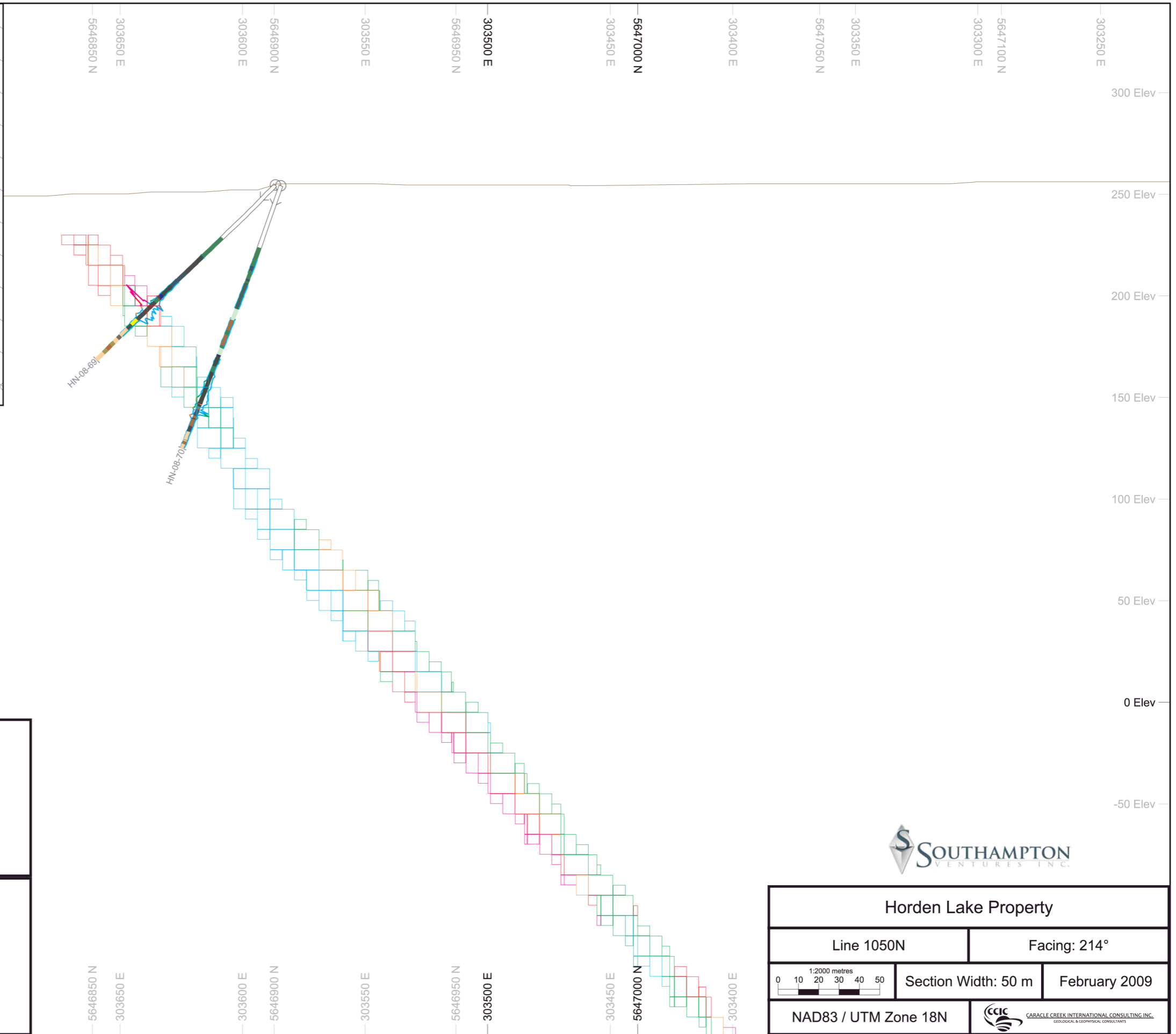
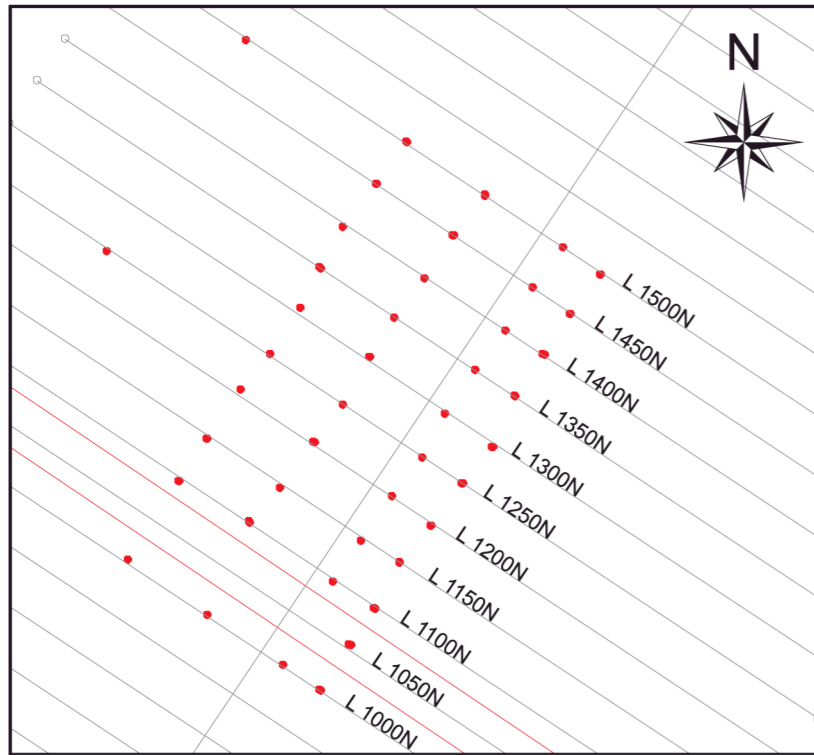

Casing	Carbonate Vein
Diabase Dyke	Diabase
Felsic Dyke	Gabbro
Intermediate Volcanic	Lost Core
Leucogabbro	Mafic Dyke
Melagabbro	Massive Sulphide
Metasediment	Metavolcanic
Mafic Volcanic	Pegmatite
Pelite	Paragneiss
Poikilitic Gabbro	Meta-psammite
Metapyroxenite	Quartz Gabbro
Quartzite	Quartz Vein
Siltstone	Metased-Schist
Unknown	

Cu (%) Left of column	
0 - 0.5	
0.5 - 0.75	
0.75 - 1	
1 - 1.5	
> 1.5	
Ni (%) Right of column	
0 - 0.5	
0.5 - 0.75	
0.75 - 1	
1 - 1.5	
> 1.5	



Horden Lake Property		
Line 1050N	Facing: 214°	
	Section Width: 50 m	February 2009
NAD83 / UTM Zone 18N		 <small>CARACLE CREEK INTERNATIONAL CONSULTING INC. GEOLOGICAL & GEOPHYSICAL CONSULTANTS</small>

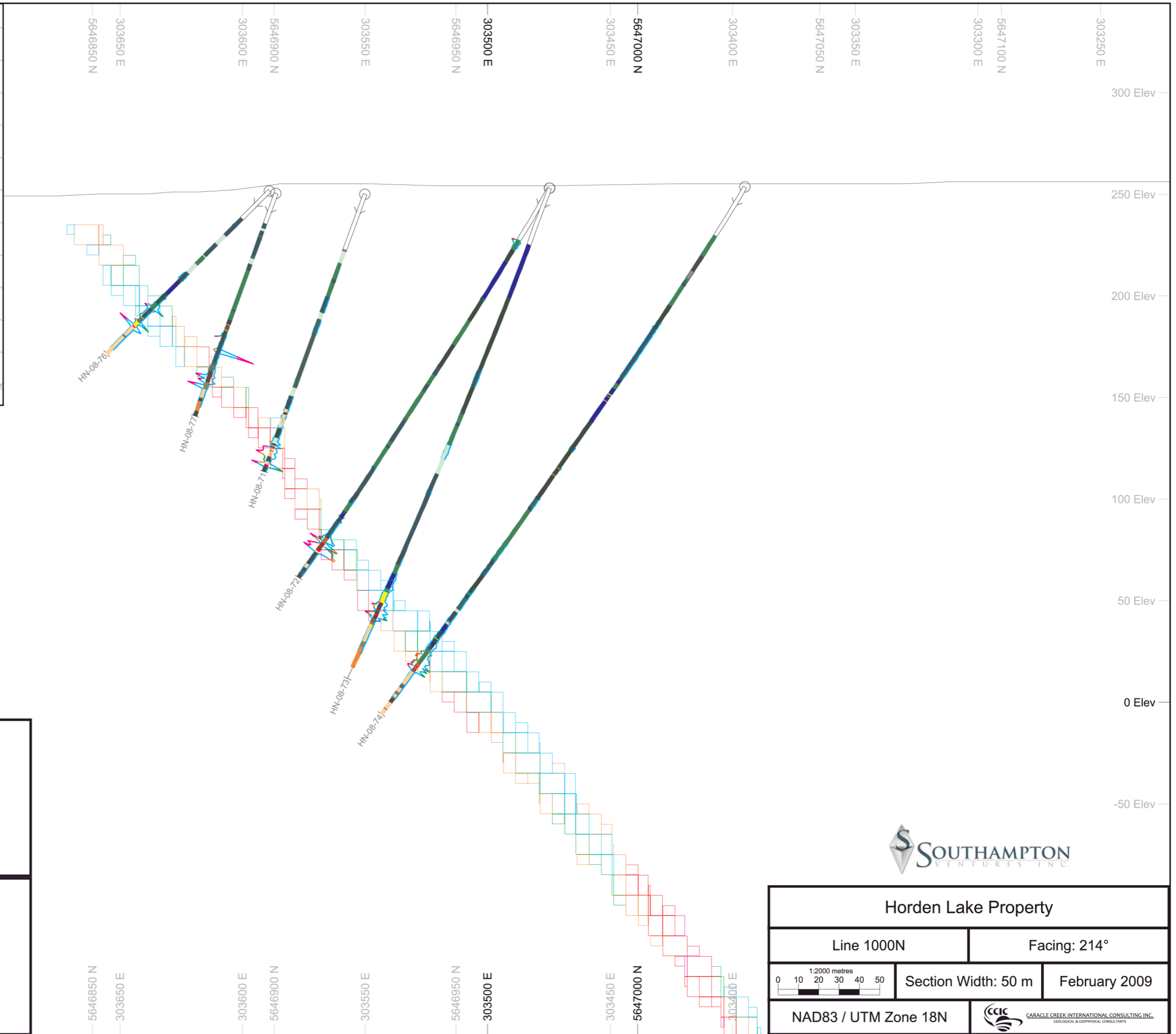
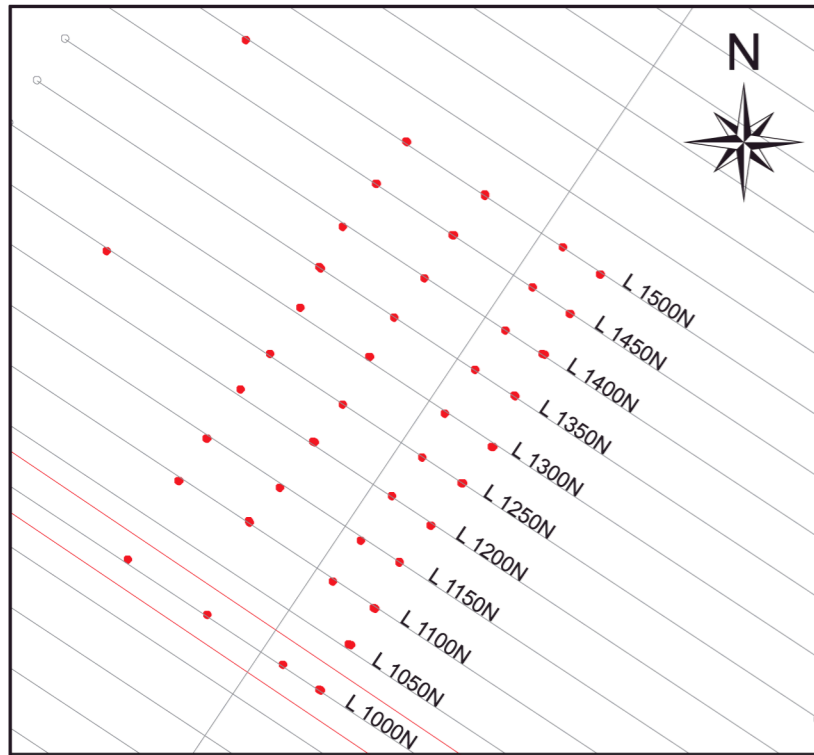

Casing	Carbonate Vein
Diabase Dyke	Diabase
Felsic Dyke	Gabbro
Intermediate Volcanic	Lost Core
Leucogabbro	Mafic Dyke
Melagabbro	Massive Sulphide
Metasediment	Metavolcanic
Mafic Volcanic	Pegmatite
Pelite	Paragneiss
Poikilitic Gabbro	Meta-psammite
Metapyroxenite	Quartz Gabbro
Quartzite	Quartz Vein
Siltstone	Metased-Schist
Unknown	

Cu (%) Left of column	
0 - 0.5	0.5 - 0.75
0.75 - 1	1 - 1.5
> 1.5	
Ni (%) Right of column	
0 - 0.5	0.5 - 0.75
0.75 - 1	1 - 1.5
> 1.5	



Hornden Lake Property		
Line 1000N	Facing: 214°	
	Section Width: 50 m	February 2009
NAD83 / UTM Zone 18N		 <small>CARACLE CREEK INTERNATIONAL CONSULTING INC. GEOLOGICAL & GEOPHYSICAL CONSULTANTS</small>

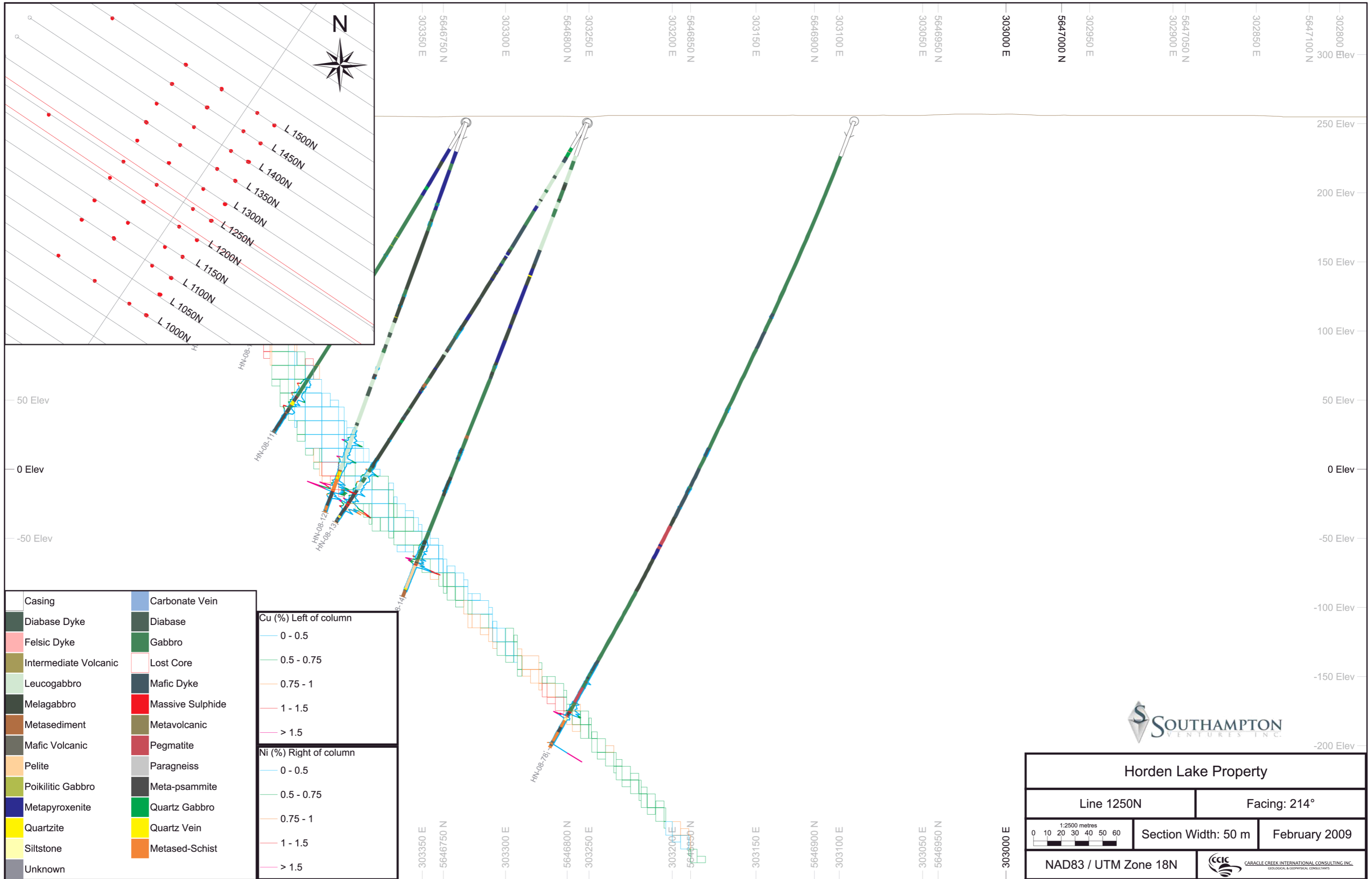

Casing	Carbonate Vein
Diabase Dyke	Diabase
Felsic Dyke	Gabbro
Intermediate Volcanic	Lost Core
Leucogabbro	Mafic Dyke
Melagabbro	Massive Sulphide
Metasediment	Metavolcanic
Mafic Volcanic	Pegmatite
Pelite	Paragneiss
Poikilitic Gabbro	Meta-psammite
Metapyroxenite	Quartz Gabbro
Quartzite	Quartz Vein
Siltstone	Metased-Schist
Unknown	

Cu (%) Left of column	
0 - 0.5	Light Blue
0.5 - 0.75	Green
0.75 - 1	Orange
1 - 1.5	Red
> 1.5	Purple

Ni (%) Right of column	
0 - 0.5	Light Blue
0.5 - 0.75	Green
0.75 - 1	Orange
1 - 1.5	Red
> 1.5	Purple



Horden Lake Property		
Line 1250N		Facing: 214°
1:2500 metres 		Section Width: 50 m
February 2009		
NAD83 / UTM Zone 18N		CARACLE CREEK INTERNATIONAL CONSULTING INC. <small>GEOLOGICAL & GEOPHYSICAL CONSULTANTS</small>

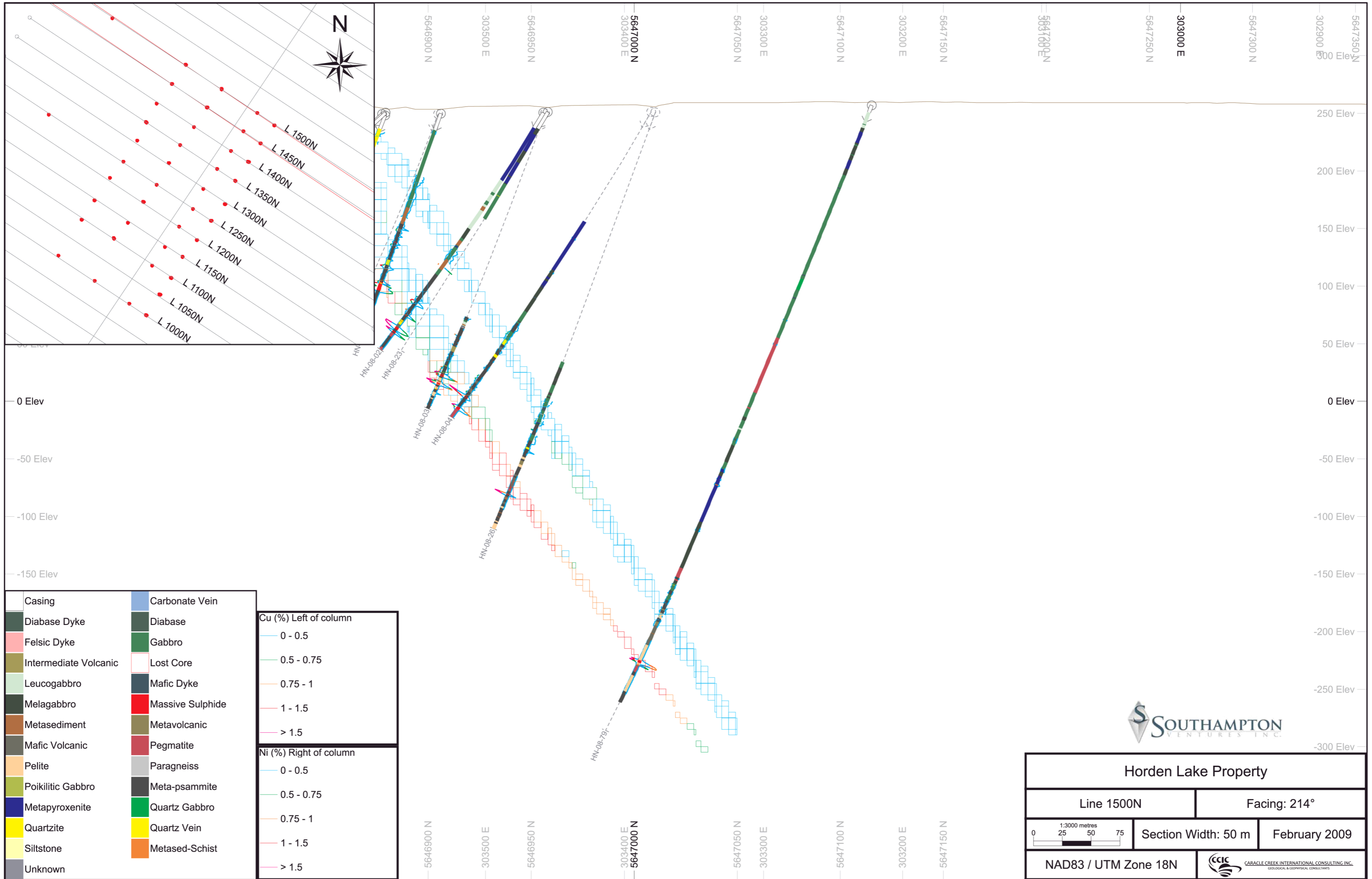

Casing	Carbonate Vein
Diabase Dyke	Diabase
Felsic Dyke	Gabbro
Intermediate Volcanic	Lost Core
Leucogabbro	Mafic Dyke
Melagabbro	Massive Sulphide
Metasediment	Metavolcanic
Mafic Volcanic	Pegmatite
Pelite	Paragneiss
Poikilitic Gabbro	Meta-psammite
Metapyroxenite	Quartz Gabbro
Quartzite	Quartz Vein
Siltstone	Metased-Schist
Unknown	

Cu (%) Left of column	
0 - 0.5	Light Blue
0.5 - 0.75	Green
0.75 - 1	Orange
1 - 1.5	Red
> 1.5	Pink

Ni (%) Right of column	
0 - 0.5	Light Blue
0.5 - 0.75	Green
0.75 - 1	Orange
1 - 1.5	Red
> 1.5	Pink



Horden Lake Property		
Line 1500N	Facing: 214°	
	Section Width: 50 m	February 2009
NAD83 / UTM Zone 18N		 <small>CARACLE CREEK INTERNATIONAL CONSULTING INC.</small> <small>GEOLOGICAL & GEOPHYSICAL CONSULTANTS</small>