

DIAMOND DISCOVERIES INTERNATIONAL

CLAIM LOCATION MAP

SCALE: 1:100,000	NTS: 24P/6,7,8,9,10,11,12
DATE: MAY 2, 2002	DRAWN BY:

FIG. 1

MRN-GÉOINFORMATION 2002
GM 59662

DIAMOND DISCOVERIES INTERNATIONAL CORP.

UNGAVA BAY

DIAMOND DISCOVERIES INTERNATIONAL INC.
(D.D.I. #6)
P.E.M. 1472

LEVELLAND ENERGY & RESOURCES LTD
P.E.M. 1481

DIAMOND DISCOVERIES INTERNATIONAL INC.
(D.D.I. #5)
P.E.M. 1483

INTERNATIONAL TOWER HILL MINES
P.E.M. 1467

DUMONT NICKEL
P.E.M. 1470

AYREX RESOURCES LTD
P.E.M. 1463

TWIN MINING CORP.
P.E.M. 1464

TWIN MINING CORP.
P.E.M. 1462

(D.D.I. #2)
DIAMOND DISCOVERIES INTERNATIONAL INC.
P.E.M. 1499

ALLUVAO FJORD

J.P. CLOUTIER
P.E.M. 1197

TWIN MINING CORP.
P.E.M. 1459

MARUM RESOURCES
P.E.M. 1466

(D.D.I. #1)
DIAMOND DISCOVERIES INTERNATIONAL INC.
P.E.M. 1473

(D.D.I. #3)
DIAMOND DISCOVERIES INTERNATIONAL INC.
P.E.M. 1482

(D.D.I. #4)
DIAMOND DISCOVERIES INTERNATIONAL INC.
P.E.M. 1517

QUEBEC LABORON

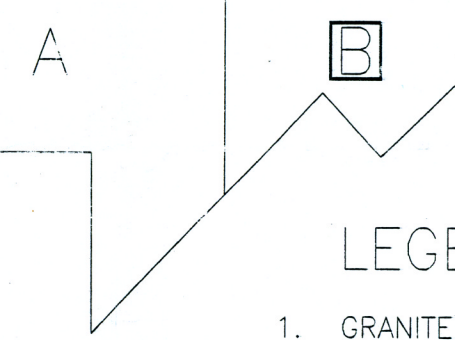
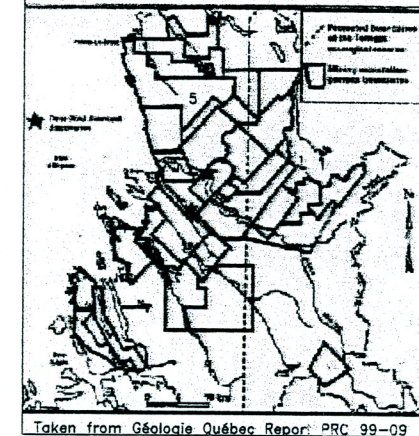

LEGEND

1. GRANITE / GRANULITE
 - a) granite (undifferentiated)
 - b) granodiorite
 - c) diorite
2. GNEISS (garnet bearing)
 - a) granite gneiss
 - b) oxidized biotite +/- graphite gneiss
 - c) quartz gneiss (80% quartz-feldspar)
 - d) biotite-amphibole gneiss
3. PERIDOTITE
4. KIMBERLITE-LAMPROPHYRE

Pg PEGMATITE
 Gossan Zone

- SAMPLE LOCATIONS
- B-09 Stream Sediment Sample Site (no KIM's)
 - B-09 Stream Sediment Sample Site (with KIM's)
 - X H2RX-014, A-01, KD-01 Kimberlite / lamprophyre rock sample site
 - X 5140 Rock Sample Site
 - ▲ 5100 Float Sample Site (lamprophyre - red)

- GEOLOGICAL SYMBOLS
- Geological Contact
 - Outcrop Outline
 - ? --- 4 Interpreted location of kimberlite / lamprophyre
 - Magnetometer Survey Line with Anomaly
 - Strike & Dip of Foliation / Bedding
 - Fault
 - Glacial Striae
 - Topographic contours (250 m interval)

MRN-GÉOINFORMATION 2002
 GM 59662

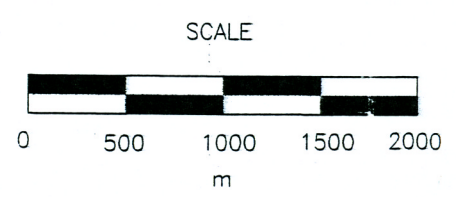

DIAMOND DISCOVERIES INTERNATIONAL	
DDI 6 PROPERTY	
GEOLOGY	
TORNGAT PROJECT	
SCALE: 1:20,000	NTS: 24P//I
DATE: Jan / 2001	DRAWN BY: G. SCOTT
REVISED:	SHEET "B"



D.P.I. 4

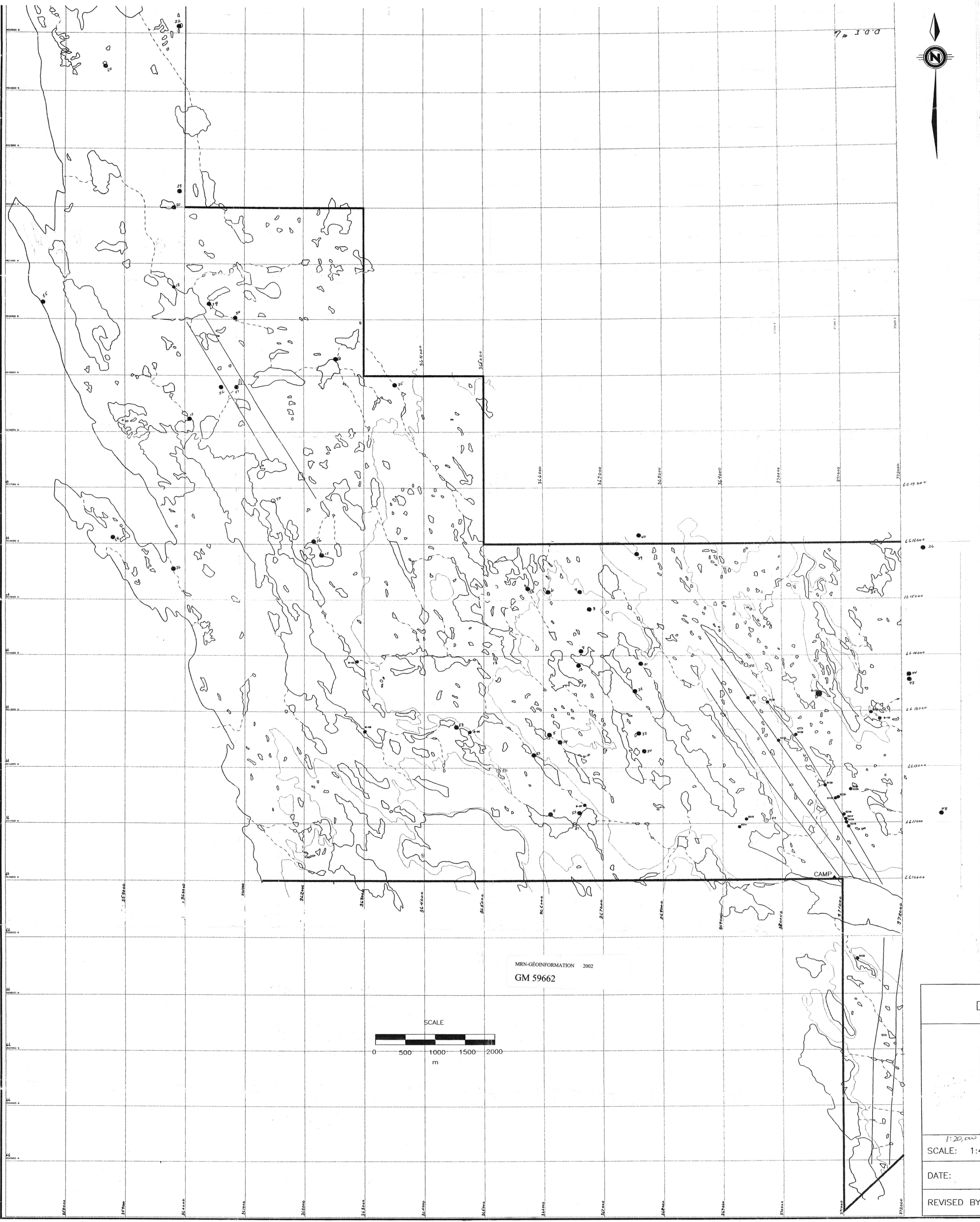

MRN-GÉOINFORMATION 2002
GM 59662

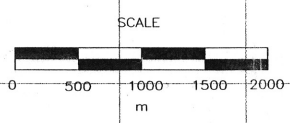

1:20,000
SCALE: 1:4
DATE:
REVISED BY: