

LEGEND

- VI Felsic Volcanic
 - VIA Rhyolite
 - VIB Rhyodacite
 - VIC Dacite
 - VZJ Amphibole
 - VZB Biotite
 - YB Granite
 - YSD Syenite
 - I3A Gabro
 - S6A Argillite
 - S10 Chert
 - S10F Ferruginous Chert
- TEXTURES
- BP Pyroclastic Breccia
 - BR Brecciated
 - BX Flow Breccia
 - FT Fragmental
 - MA Massive
 - PR Pyroclastic
 - Tu Tuff
 - IF Iron Formation
 - QY Quartz Eyes
 - FP Feldspar Porphyry
- MINERALS
- cp chalcopryite
 - gr garnet
 - hm hematite
 - mg magnetite
 - po pyrrhotite
 - py pyrite

- D outcrop area
- foliation; vertical, dip
- lineation/plunge
- glacial striation
- geological contact
- interpreted structure

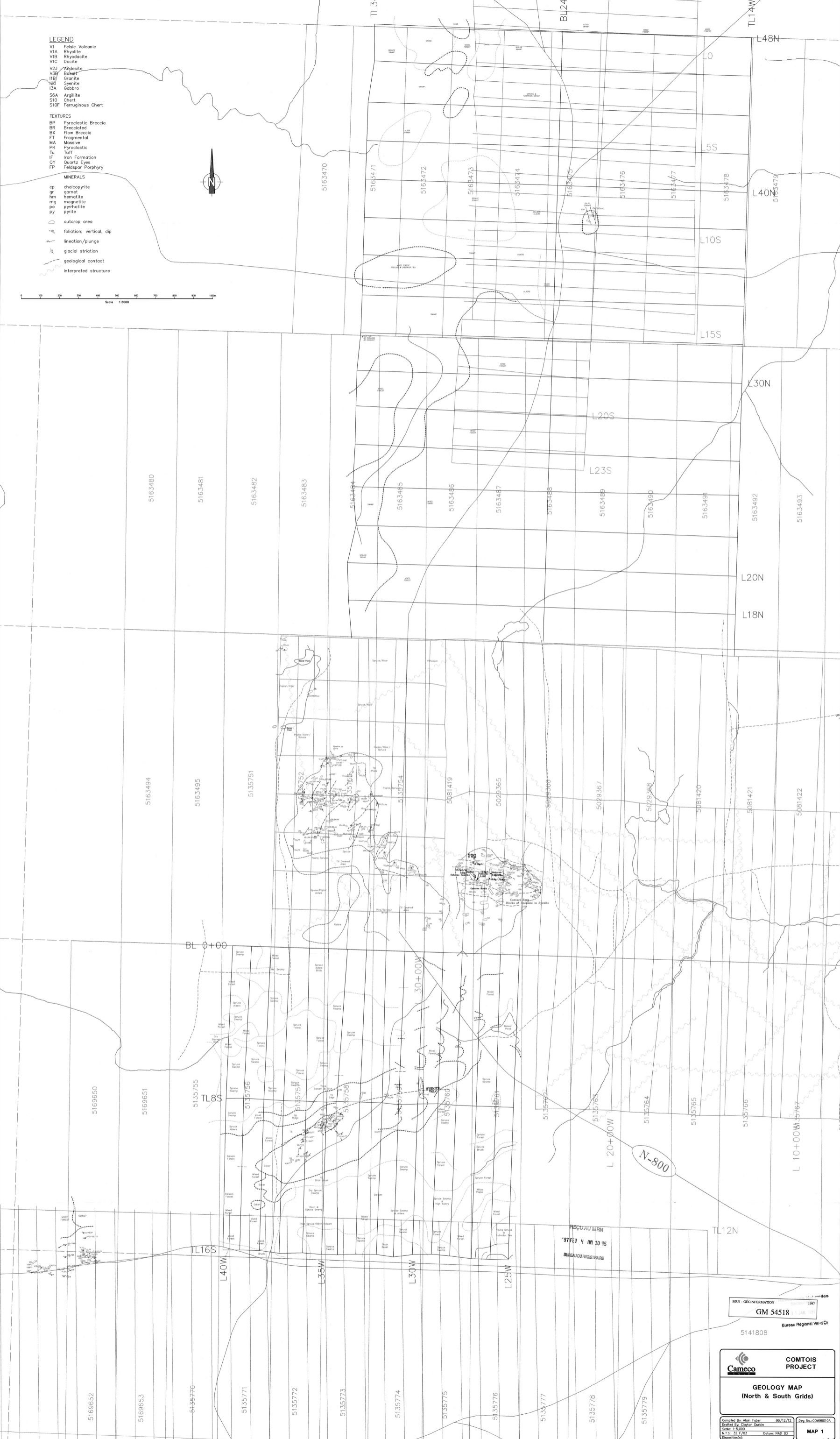
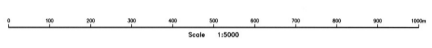

RECU DU MAN
 '97 FEV 4 AN 20 45
 BUREAU DU REGISTRE

MRN - GEODINFORMATION 1997
GM 54518
 Bureau Régional Vah-O'Gr

COMTOIS PROJECT
GEOLOGY MAP
 (North & South Grids)

Compiled By: Alain Faber 06/12/92
 Drafted By: Clayton Durbin
 Scale: 1:5,000
 N.T.S.: 32 F/93
 Date: NAD 83
 Disposition: 02

L18N

BL 16+00N

BL 8+00N

BL 0+00N

L 0+00E

L 10+00W

TL12N

Belt River



- LEGEND**
- V1 Felsic Volcanic
 - V1A Rhyolite
 - V1B Rhyodacite
 - V1C Dacite
 - V2J Andesite
 - V3B Basalt
 - I1B Granite
 - I2D Syenite
 - I3A Gabbro
 - S6A Argillite
 - S10 Chert
 - S10F Ferruginous Chert
- TEXTURES**
- BP Pyroclastic Breccia
 - BR Brecciated
 - BX Flow Breccia
 - FT Fragmental
 - MA Massive
 - PR Pyroclastic
 - Tu Tuff
 - IF Iron Formation
 - QY Quartz Eyes
 - FP Feldspar Porphyry

- MINERALS**
- cp chalcocopyrite
 - gr garnet
 - hm hematite
 - mg magnetite
 - po pyrrhotite
 - py pyrite
- outcrop area
 - ~ foliation; vertical, dip
 - ~ lineation/plunge
 - ~ glacial striation
 - - - geological contact
 - ~ interpreted structure

MRN - GÉOINFORMATION 1997
GM 54518
 Ressources Naturelles
 Secteur mines
 31 JAN. 1997
 Bureau Régional Val-d'Or

COMTOIS PROJECT
GEOLOGY MAP
 (Prospected Claim Group)

Compiled By: Alain Faber 96/12/12
 Drafted By: Clayton Durbin
 Scale: 1:5,000
 N.T.S.: 32 F/03 Datum: NAD 83
 Disposition:
 97034002

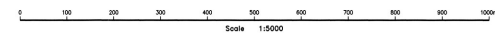

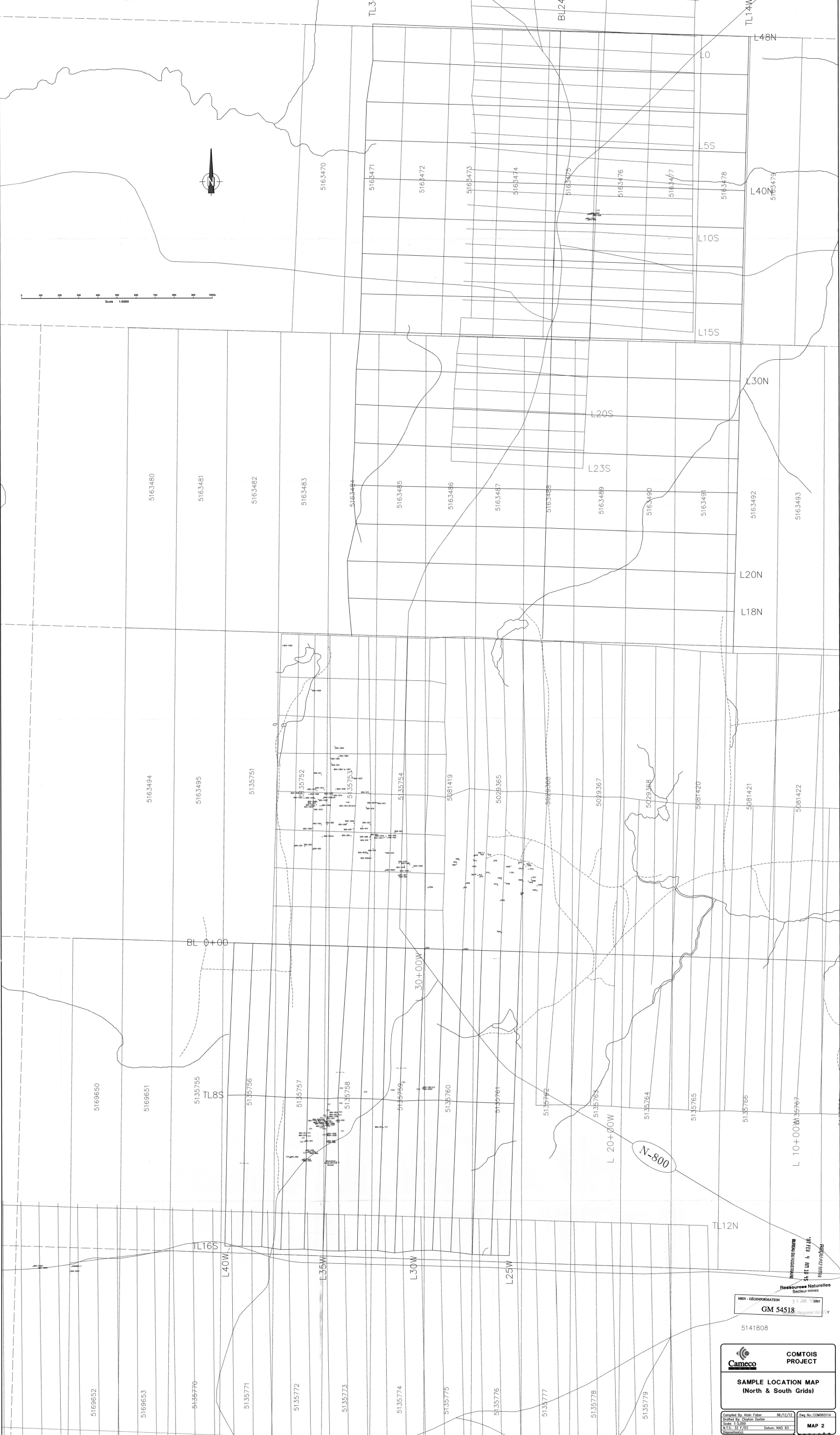
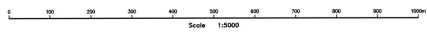

MRN - GÉOINFORMATION 31 JAN. 1997
GM 54518
Régional V&C

COMTOIS PROJECT

SAMPLE LOCATION MAP
(North & South Grids)

Completed By: Alain Faber 96/12/02
 Drawn By: Christine Duchon
 Scale: 1:5,000
 N.E.S.: 97-03 Datum: NAD 83
 Disposition: 01

97034002

Resources Naturelles
Secteur mines
Région du Québec
31 JAN. 1997

MAP 2

L18N

BL 16+00N

BL 8+00N

BL 0+00N

L 0+00

L 10+00N

TL12N

Belt River



MRN - GÉOINFORMATION 1997
GM 54518

Ressources Naturelles
Secteur mines
31 JAN 1997
Bureau Régional Val-d'Or

COMTOIS PROJECT
SAMPLE LOCATION MAP
(Prospected Claim Group)

Compiled By: Alain Faber 96/12/12
Drafted By: Clayton Durbin
Scale: 1:5,000
N.T.S.: 32 F/03 Datum: NAD 83
Disposition: C
MAP C-2
97034002