

Legend

- 1 Metavolcanics.
- 2 Biotite paragneiss and garnet-biotite paragneiss.
- 2a Biotite paragneiss.
- 2b Biotite and/or hornblende paragneiss.
- 2c Quartzite.
- 3 Metagabbro, in places with metasedimentary rocks.
- 4 Biotite granite.
- 4a Hornblende granite, in places with biotite.
- 4b Hornblende and/or biotite granitic gneiss.
- 5 Muscovite pegmatite and/or white granite.

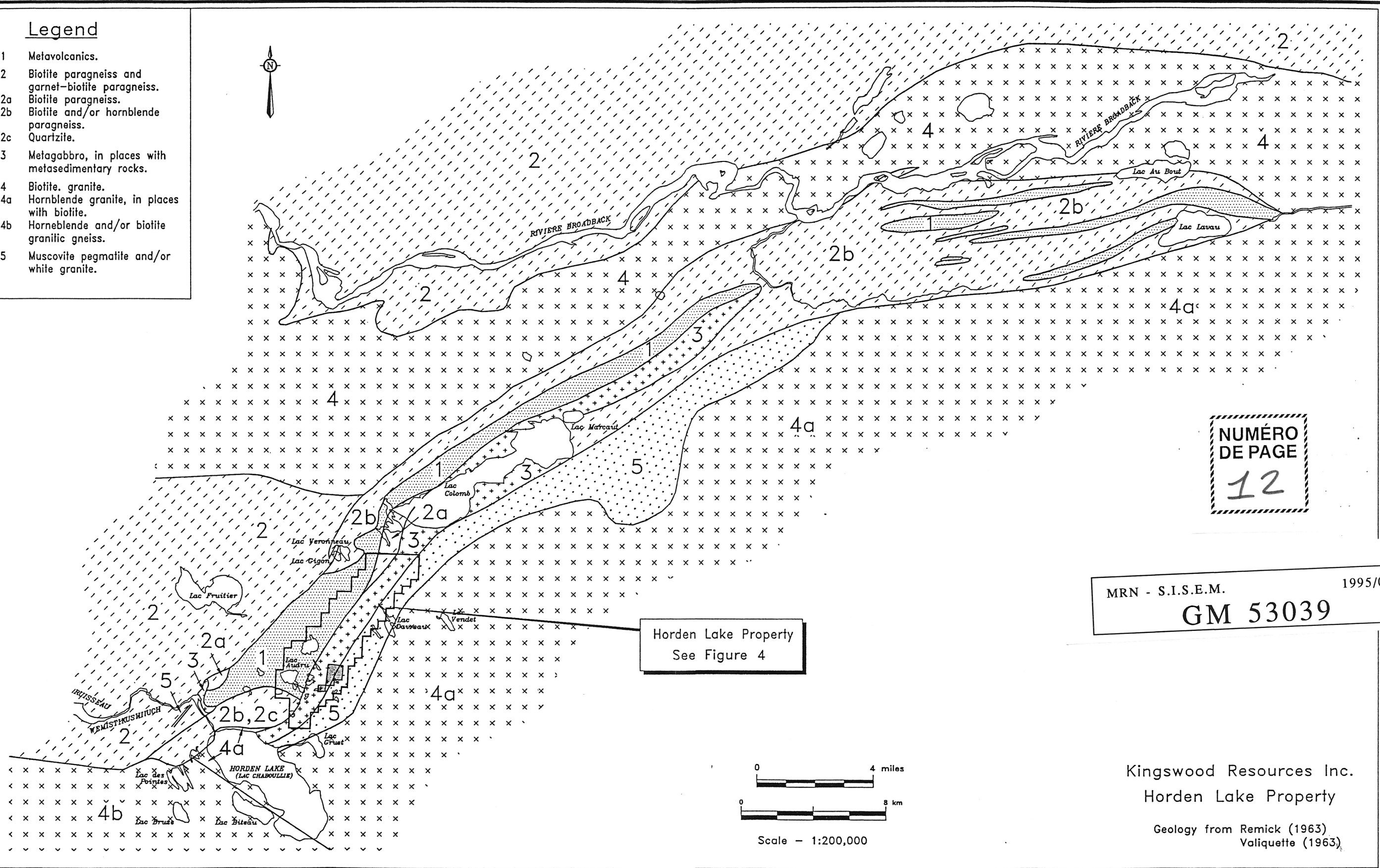

NUMÉRO DE PAGE
12

MRN - S.I.S.E.M. 1995/06/15
GM 53039

Horden Lake Property
 See Figure 4

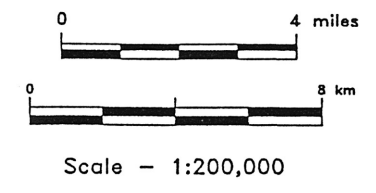

Kingswood Resources Inc.
 Horden Lake Property
 Geology from Remick (1963)
 Valiquette (1963)

Figure 3. Regional Geology

GM 53039

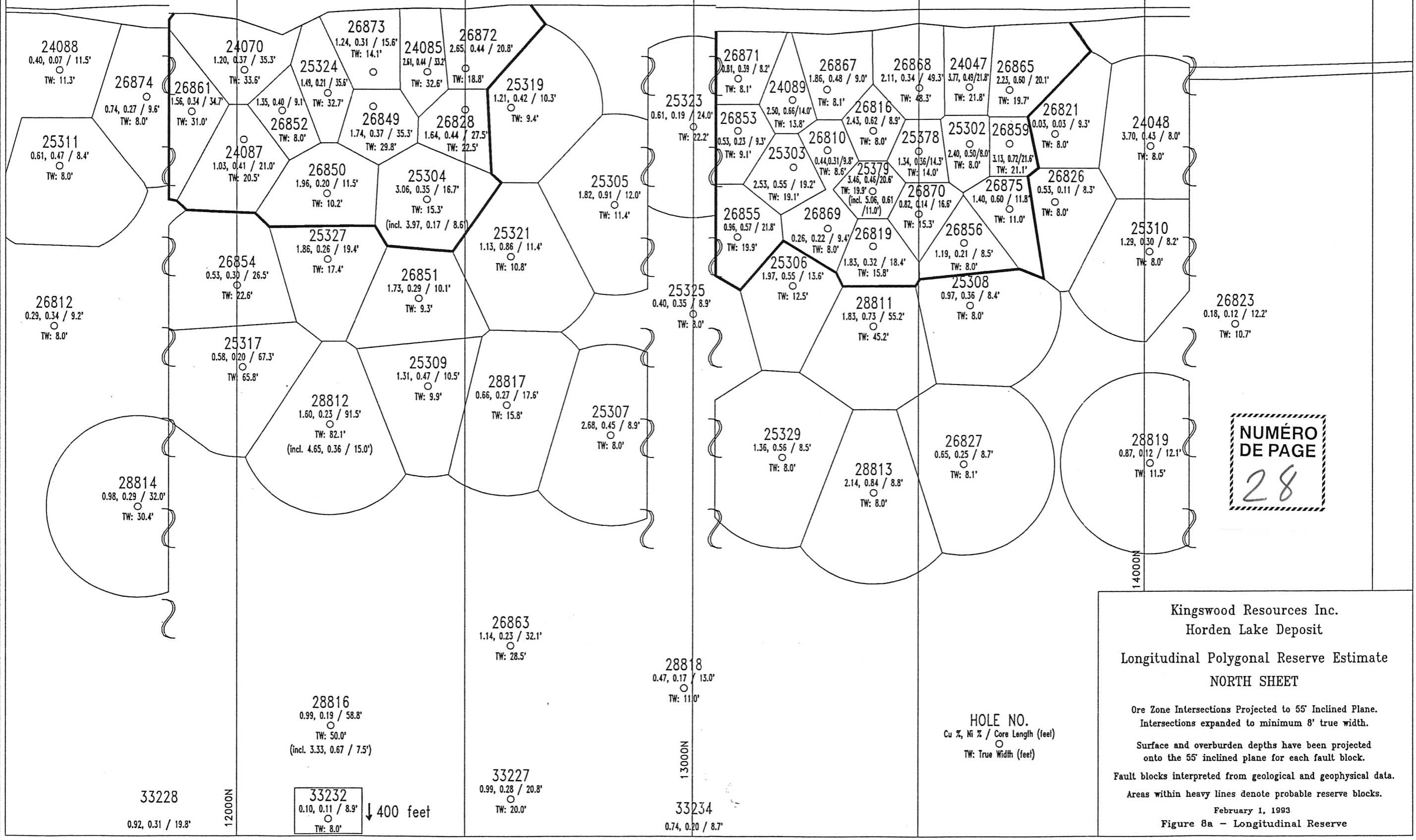

NUMÉRO DE PAGE
 28

Kingswood Resources Inc.
Horden Lake Deposit
Longitudinal Polygonal Reserve Estimate
NORTH SHEET

Ore Zone Intersections Projected to 55° Inclined Plane.
 Intersections expanded to minimum 8' true width.

Surface and overburden depths have been projected onto the 55° inclined plane for each fault block.

Fault blocks interpreted from geological and geophysical data.

Areas within heavy lines denote probable reserve blocks.

February 1, 1993
 Figure 8a - Longitudinal Reserve

HOLE NO.
 Cu %, Ni % / Core Length (feet)
 TW: True Width (feet)

33232
 0.10, 0.11 / 8.9'
 TW: 8.0'

↓ 400 feet

NUMÉRO
DE PAGE

29

9000N

10000N

11000N

9000N

10000N

11000N

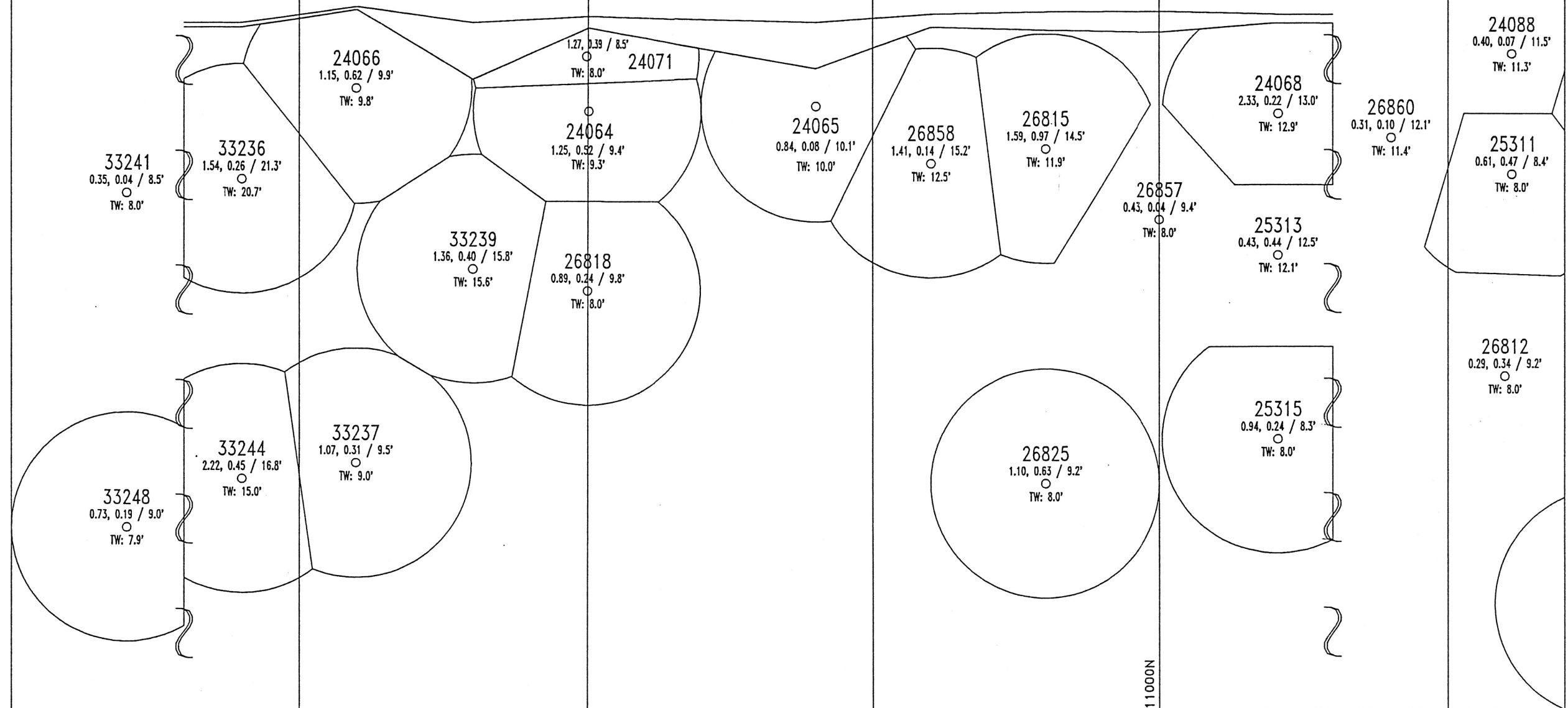

MRN - S.I.S.E.M. 1995/06/15
GM 53039

HOLE NO.
Cu %, Ni % / Core Length (feet)
TW: True Width (feet)

Kingswood Resources Inc.
Horden Lake Deposit
Longitudinal Polygonal Reserve Estimate
SOUTH SHEET

Ore Zone Intersections Projected to 55' Inclined Plane.
Intersections expanded to minimum 8' true width.

Surface and overburden depths have been projected
onto the 55' inclined plane for each fault block.

Fault blocks interpreted from geological and geophysical data.

February 1, 1993
Figure 8b - Longitudinal Reserve