

# GM 48616

REPORT ON THE EXPLORATORY DRILLING PROGRAM, ISLE-DIEU PROPERTY

Documents complémentaires

*Additional Files*



Licence



*License*

Cette première page a été ajoutée  
au document et ne fait pas partie du  
rapport tel que soumis par les auteurs.

Énergie et Ressources  
naturelles

Québec 

REPORT  
ON THE EXPLORATORY DRILLING PROGRAM  
CONDUCTED DURING FEB-MARCH 1989  
IN THE DUNLOP BAY AREA  
ON THE ISLE-DIEU TWP PROPERTY OF  
EXPLORATIONS MINIERES DU NORD LTEE

M.E.R.  
SERV. TITRES MINIERES  
BUREAU DE QUEBEC  
89 MMI 9 13 24

Ministère de l'Énergie et des Ressources  
Service de la Géoinformation  
Date: 13 JUIN 1989  
No G.M.: 48616

ABITIBI GREENSTONE BELT  
MATAGAMI AREA  
NW QUEBEC, CANADA

ÉNERGIE ET RESSOURCES  
SECTEUR MINES

08 MAI 1989

Bureau régional Val d'Or

Fin. 20818  
+ M89 128036

Bernard Borduas, Geologist.  
April 1989

Isle-Dieu township  
NTS map : 32F/13

## CONTENTS

|                                     | Page |
|-------------------------------------|------|
| INTRODUCTION .....                  | 1    |
| PROPERTY, LOCATION AND ACCESS ..... | 1    |
| DESCRIPTION OF WORK PERFORMED ..... | 3    |
| RESULTS                             |      |
| Hole 100E-1 .....                   | 5    |
| Hole 40N-1 .....                    | 5    |
| Hole 92E-1 .....                    | 6    |
| Hole 52N-1 .....                    | 6    |
| Hole 52N-2 .....                    | 7    |
| CONCLUSION .....                    | 8    |

### List of figures

|   |   |
|---|---|
| - Claim map of the property at scale 1:50,000 ..... | 2 |
| - Drill holes location map at scale 1:10,000 .....  | 4 |

### APPENDIX

- Diamond drill logs with assays and geologic section at 1:2,500.
- Certificates of analysis.

## INTRODUCTION

This report describes the february-march 1989 diamond drilling program carried by Explorations Minières du Nord Ltée in the Dunlop bay area of it's Isle-Dieu township property near Matagami in northwest Quebec.

Five (5) holes totalizing 918.3 meters (3013 feet) of diamond drilling were done during this exploration program to test different geophysical anomalies (I.P., VLF & Magnetic) along with geochemical and structural features within the Dunlop bay granitic intrusive.

On site supervision was done by Bernard Borduas, geologist. Drilling was done by Forage Diamex Inc of Amos, Quebec and assaying was done by Metri-clab Inc laboratory of Ste-Marthe-sur-le-Lac, Quebec.

## PROPERTY, LOCATION AND ACCESS

The Isle-Dieu township property of Explorations Minières du Nord Ltée consist of a block of 81 contiguous claims, covering a superficy of approximately 1177 hectares, in ranges 5 to 8 of Isle-Dieu township, northwest Quebec, Canada. Claim map of figure 1 page 2 illustrates the property outline.

The Isle-Dieu property is located some 8 kilometers northeast of the town of Matagami. Access to the property is relatively easy through a 2 kilometers long gravel road running northward from the Matagami-James Bay highway.

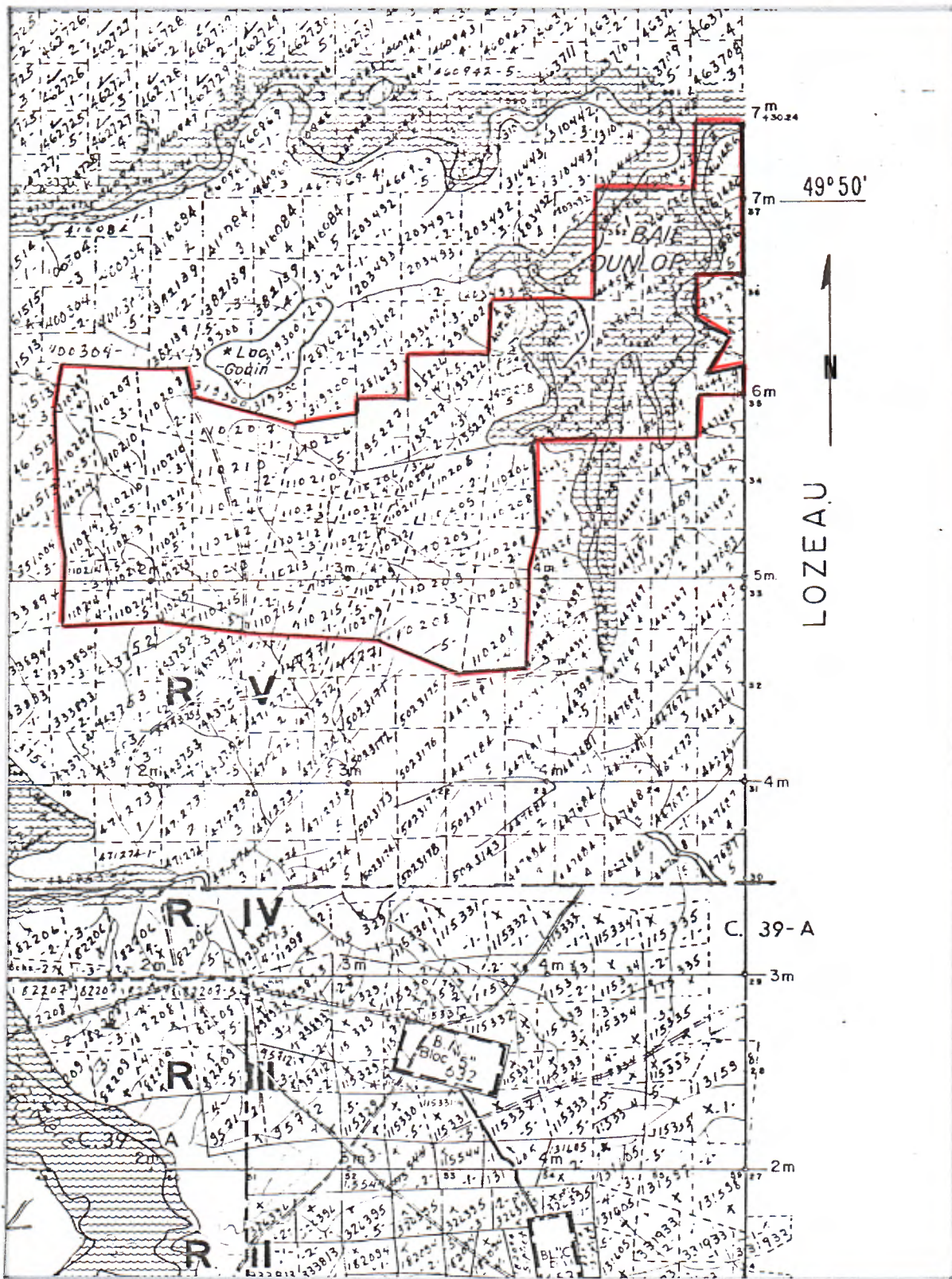

Fig 1

Scale 1:50,000

Claim map, as of April 1989, of Explorations Minières du Nord Ltée Isle-Dieu township property (red contour), Dunlop bay area, Matagami, northwest Quebec.

## DESCRIPTION OF WORK PERFORMED

During the period from February 26 to April 1989 drilling contractor Forage Diamex Inc of Amos, Quebec drilled five (5) holes on the property for a total length of 918.3 meters (3013 feet) of drilling.

On all drill sites casing were removed, except for hole 52N-2 where casing was left in the hole to permit further investigation in the hole.

The core was logged, splitted and stored in Matagami. The core was logged in meters. All mineralized and or strongly altered sections were splitted integrally and were analysed geochemically by atomic absorption for Gold. Sections with even small percentage of sulfides were also analysed geochemically by atomic absorption for Arsenic (As), Copper (Cu), Zinc (Zn), Silver (Ag) and occasionally for Lead (Pb). Assay results for Gold are given in ppb (part per billion), grams per metric ton (g/mt) and once per ton (oz/t). First gold analysis greater than 40 ppb were recheck 2 times and final result is the average of 3 assays. Assay results for Arsenic, Copper, Zinc, Silver and Lead are given in ppm (part per million).

In the report a short description of each hole with results is given. A drill holes location map at scale 1:10,000 appears on figure 2 page 4. Diamond drill logs are found in appendix with a summarized geologic section at scale 1:2500 as well as the certificates of analysis.

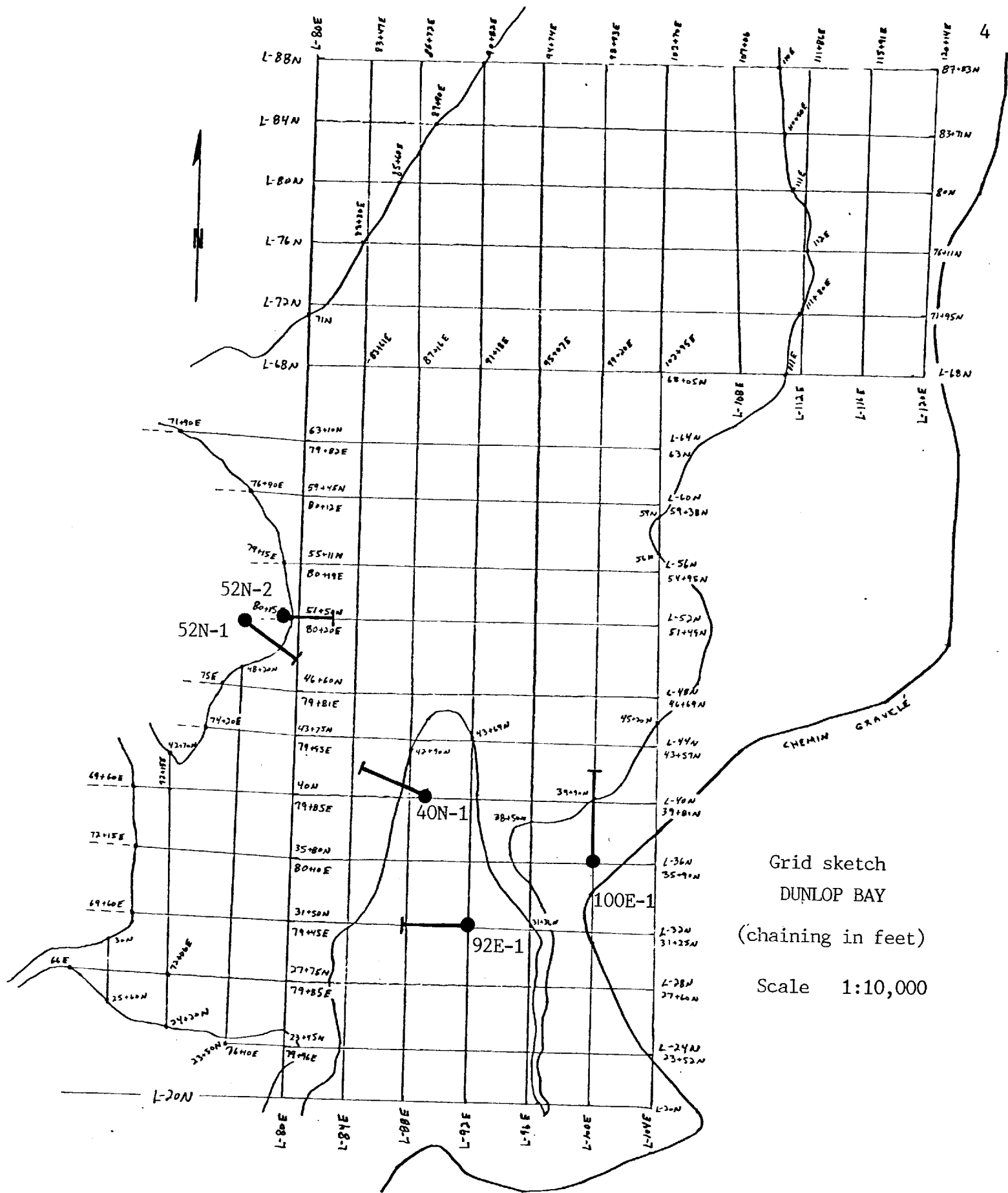

Grid sketch  
 DUNLOP BAY  
 (chaining in feet)  
 Scale 1:10,000

Location plan of holes: 100E-1, 92E-1, 40N-1, 52N-1 & 52N-2 drilled by EXPLORATIONS MINIERES DU NORD LTEE in the Dunlop bay area, Matagami Lake, northwest Quebec.

## RESULTS

A short description of the holes drilled with the results is given below. A summarized geologic section of each hole at scale 1:2500 follows the drill logs in appendix with the certificates of analysis. A drill hole location map at scale 1:10,000 appears on figure 2 page 4 of the report.

Hole 100E-1 ( 243.8 meters or 800 feet )

This hole located on L-100E,36N was drill to test short weak VLF & magnetic anomalies.

The hole went through 12.8 meters of overburden and intersected granite to 243.8m at the end of the hole.

The granite was moderately to strongly hematized and epidotized from 166m to 199m. A fault zone with intense crushing over 50 cm within a 3 meters zone of shearing and crushing was intersected at 191.8m in the hole. The presence of small quantities of purple fluorite in centimetric quartz-carbonate veinlets cutting the granite was noted from 230.85m to 243.83m at the end of the hole.

In the hole 41 sections were analysed geochemically by atomic absorption for Gold. Only a few weak anomalous Gold values were obtain.

Hole 40N-1 ( 179.8 meters or 590 feet )

This hole located on L-40N,89E was drill to test a VLF EM conductor coincident with a North 20°E fault with apparent dextral movement cutting the Dunlop granite and appearing on the governmental geologic maps.

The hole went through 6.1 meters of overburden and intersected granite to 179.8m at the end of the hole.

At 124.7m the hole intersected a fault zone characterized by gauge,mylonite and brecciated rock over 40 cm, followed from 125.1m to 136.5m by a zone moderately to strongly fractured, brecciated, hematized, locally silicified with



quartz-carbonate fracture filling and local presence of galena. At 146.05m a 1 cm wide silicified, slightly carbonatized and epidotized shear with 30 % pyrite gave 1.72 g/mt Au (0.05 oz/t Au) over 15 cm.

In the hole 29 sections were analysed geochemically by atomic absorption for Gold and 6 of those sections were also analysed for Silver, Copper, Zinc, Arsenic and Lead.

Best results obtain were: 27 g/mt Ag with 1.37 % Pb over 75 cm at 128.9m, 11.5 g/mt Ag with 0.85 % Pb over 75 cm at 132.65m and 1.72 g/mt Au over 15 cm at 146.05m in the hole.

Hole 92E-1 ( 176.78 meters or 580 feet )

This hole located on L-92E,32N was drill to test 2 weak VLF EM conductors and a weak magnetic anomaly.

The hole went through 23.16 meters of overburden and intersected granite to 176.78m at the end of the hole.

At 82.6m the hole intersected a fault characterized by a zone of crushing and gauge over 10 cm and from 130.3m to 138.5m the hole intersected a zone moderately fractured and sheared but strongly epidotized and chloritized, moderately hematized and carbonatized with calcite veining.

In the hole 17 sections were analysed geochemically by atomic absorption for Gold, 2 of those sections were analysed for Silver, Copper, Zinc and Arsenic and 1 section was also analysed for Lead. Only a few weak anomalous Gold values were obtain.

Hole 52N-1 ( 178.3 meters or 585 feet )

This hole located on L-52N,76E was drill to test a wide weak I.P. anomaly with a weak east flanking magnetic anomaly. The hole had to be stop at 178.3m because of technical problems.

The hole went through 22.24 meters of overburden and intersected granite to 178.3m at the end of the hole.

The granite was locally moderately altered, epidotized, hematized, chloritized and carbonatized over short sections. A gabbroic dyke intersected at 129.15m over 1 meter carried traces of chalcopyrite.

In the hole 18 sections were geochemically analysed by atomic absorption for Gold and 2 of those sections were also analysed for Copper, Zinc, Silver and Arsenic. Only a few weak anomalous Gold values were obtain.

Hole 52N-2           ( 139.6 meters   or   458 feet )

This hole located on L-52N,79+40E was drill to continue eastward the geologic section started with hole 52N-1 and to test a weak VLF and magnetic anomaly.

The hole went through 4.88 meters of overburden and intersected granite to 139.6m where the hole was stop. Casing of this hole was left in ground to permit eventual return to the hole for further drilling and or geophysical investigation.

In the hole 11 sections were geochemically analysed by atomic absorption for Gold and 3 of those sections were also analysed for Copper, Zinc, Silver and Arsenic. No significantly Gold anomalous values were obtain.

CONCLUSION

The primary goal of this drilling program was to test a number of geophysical targets (I.P., VLF & Magnetic) within the Dunlop bay granitic intrusive to locate Gold and or base metal bearing geologic structures or bodies of the Belmoral or Silidor type of occurrence.

Although no economic Gold and or base metal intersections were obtained greater geologic knowledge about the Dunlop bay granitic intrusive was gained.

Hole 40N-1 testing the North 20° East Dunlop bay fault encountered low grade Lead-Silver mineralization along this structure. Also a low grade Gold intersection of 0.05 oz/t Au over 15 cm intersected less than 20 meters from the lead-silver intersections indicate potential metallogenesis along this structure running across Dunlop bay. Therefore more exploration drilling seems justified and is recommended along the North 20° E fault identified in Dunlop bay.

April 1989



A handwritten signature in cursive script that reads "Bernard Borduas".

Bernard Borduas, Geologist

APPENDIX

DIAMOND DRILL LOGS WITH ASSAYS  
&  
GEOLOGIC SECTION AT SCALE 1:2500

Hole No: 100E-1Ref. Grid: (feet)Co-ordinates: L-100E , 36NAzimuth: NorthDip: - 46°Total Length: 243.8 meters (800 feet)

Horizontal Proj.: \_\_\_\_\_

Vertical Proj.: \_\_\_\_\_

Dip Test

Depth Angle

collar - 46°122m - 42°243.8m - 41°Prospect: ISLE-DIEUVenture No: \_\_\_\_\_ N.T.S.: 32F/13Location Area/Twp: Isle-Dieu twpClaim No: 464589-5Core Size: BQDrill Contractor: Forage DIAMEX Inc.Date Started: February 26 , 1989Date Completed: March 4 , 1989

| Depth |       | Description   | Sample No. | Intersection |       |           | Assays |  |
|-------|-------|---|------------|--------------|-------|-----------|--------|--|
| From  | To    |   |            | From         | To    | Width (m) | Au ppb |  |
| 0     | 12.8  | OVERBURDEN (casing pulled out)  |            |              |       |           |        |  |
| 12.8  | 243.8 | GRANITE<br>Grey-white, pinkish to reddish where hematized, greenish-grey where epidotized, grey where carbonatized; medium to coarse grain with local finer grain grey-green more dioritic xenoliths. |            |              |       |           |        |  |
|       |       | 23.5: Fracture 1-2mm wide at 5-10° c/a with a little barren qtz-carb-chlorite veining and strong hematization of the walls over 1.3 meter from 23.0m.   | 27001      | 23.0         | 24.3  | 1.3       | 21     |  |
|       |       | 29.4: Fracture at 40° c/a with strong hematization, slight shearing and epidotization over 1.35 meter but no traces of sulfide.   | 27002      | 29.4         | 30.75 | 1.35      | 5      |  |
|       |       | 53.65: Millimetric fracture, chloritized, sulfide barren at 40° c/a with 1-2 cm wide hematization.  | 27003      | 53.6         | 53.7  | 0.1       | 6      |  |
|       |       | 56.5: Epidotized, chloritized shear 5mm wide (t.w.) at 35° c/a with slight hematization and epidotization over 20 cm.   | 27004      | 56.5         | 56.7  | 0.2       | 4      |  |
|       |       | 59.05: Idem to 27003.   | 27005      | 59.05        | 59.2  | 0.15      | 4      |  |
|       |       | Rock is moderately fractured, hematized and slightly epidotized from 62.3m to 67.8m   |            |              |       |           |        |  |

Logged by: Bernard Borduas, Geologist.

| Depth |    | Description  | Sample No. | Intersection |        |           | Assays |   |
|-------|----|--|------------|--------------|--------|-----------|--------|---|
| From  | To |  |            | From         | To     | Width (m) | Au ppb |   |
|       |    | 62.3:Zone moderately hematized with a few 25-30° c/a hematitic fracture over 90 cm.  | 27006      | 62.3         | 63.2   | 0.9       | 5      |   |
|       |    | 66.2:Epidotized,moderately carbonatized,slightly chloritized shear,barren,10 cm wide(t.w.) at 45-50° c/a with strong hematization over 25 cm.  | 27007      | 66.1         | 66.35  | 0.25      | 4      |   |
|       |    | Rock is moderately fractured, hematized and slightly epidotized from 72.3 to 75.7m   |            |              |        |           |        |   |
|       |    | 79.6:Zone moderately hematized and slightly epidotized barren over 80 cm.  | 27008      | 79.6         | 80.4   | 0.8       | 4      |   |
|       |    | 85.9:Zone strongly epidotized and hematized over 35 cm.  | 27009      | 85.9         | 86.25  | 0.35      | 4      |   |
|       |    | 91.45:Zone moderately hematized,slightly fractured and epidotized,barren over 1.05 meter.  | 27010      | 91.45        | 92.5   | 1.05      | 5      |   |
|       |    | 99.0:Idem to 27010 over 1.5 meter.   | 27011      | 99.0         | 100.5  | 1.5       | 10     |   |
|       |    | 102.8:Zone slightly sheared and fractured,moderately hematized,slightly chloritized and barren over 1.9m   | 27012      | 102.8        | 104.7  | 1.9       | 4      |   |
|       |    | From 107m to 124m rock is slightly to moderately hematized and slightly epidotized from place to place.  |            |              |        |           |        |   |
|       |    | 112.95:Zone moderately hematized and slightly epidotized with rare trace of py over 15 cm.   | 27013      | 112.95       | 113.1  | 0.15      | 6      |   |
|       |    | From 124m to 166m rock is more homogeneously slightly to moderately hematized,slightly epidotized and slightly carbonatized from place to place.                                     |            |              |        |           |        |   |
|       |    | 129.05:Zone sheared 20-25 c/a,carbonatized and epidotized with a thin qtz-carb-tourmaline 1-2mm wide veinlet sub-parallel to core axis and carrying 0.5-1 % diss cp & py over 35 cm. | 27014      | 129.05       | 129.4  | 0.35      | 4      | Cu:1425ppm<br>Zn: 35ppm<br>As: 1 ppm<br>Ag:0.9ppm |
|       |    | 138.8:Zone moderately fractured, hematized, epidotized and slightly carbonatized, barren over 45 cm.   | 27015      | 138.8        | 139.25 | 0.45      | 5      |   |
|       |    | 151.4:Zone moderately hematized with a little carbonate and odd trace of sulfide over 30 cm.   | 27016      | 151.4        | 151.7  | 0.3       | 4      |   |
|       |    | 159.5:Zone moderately hematized,slightly epidotized and chloritized with odd tr of sulfide over 30 cm.   | 27017      | 159.5        | 159.8  | 0.3       | 4      |   |

| Depth |    | Description   | Sample No. | Intersection |        |           | Assays |  |
|-------|----|---|------------|--------------|--------|-----------|--------|--|
| From  | To |   |            | From         | To     | Width (m) | Au ppb |  |
|       |    | 162.45:Idem to 27017 over 25 cm.  | 27018      | 162.45       | 162.7  | 0.25      | 5      |  |
|       |    | 168.2:Zone moderately fractured,hematized and chloritic with rare trace of sulfide over 50 cm.  | 27019      | 168.2        | 168.7  | 0.5       | 5      |  |
|       |    | From 166m to 199m rock is homogeneously moderately to strongly hematized,slightly to moderately epidotized in places and locally chloritic. |            |              |        |           |        |  |
|       |    | 176.3:Zone moderately fractured,hematized,slightly epidotized and chloritized with odd trace of sulfide over 1.3 meter.                     | 27020      | 176.3        | 177.6  | 1.3       | 5      |  |
|       |    | 185.7:Zone idem to 27020 over 1.3 meter.  | 27021      | 185.7        | 187.0  | 1.3       | 4      |  |
|       |    | 187.0:Zone moderately fractured,strongly hematized and epidotized over 40 cm.   | 27022      | 187.0        | 187.4  | 0.4       | 6      |  |
|       |    | 191.8:Zone moderately sheared 45° c/a,crushed,chloritized,hematized and slightly silicified with rare trace of sulfide over 1.1 meter.      | 27023      | 191.8        | 192.9  | 1.1       | 4      |  |
|       |    | 192.9:Crushed zone,granulated (fault) over 50 cm.   | 27024      | 192.9        | 193.4  | 0.5       | 5      |  |
|       |    | 193.4:Zone moderately hematized,crushed,sheared,chloritized and slightly kaolinitized over 1.4 m.   | 27025      | 193.4        | 194.8  | 1.4       | 4      |  |
|       |    | 201.7:Zone slightly sheared 20-25° c/a with trace of sulfide and green chrysocolla or malachite over 20 cm.                                 | 27026      | 201.7        | 201.9  | 0.2       | 49     |  |
|       |    | 205.6:Zone moderately fractured and hematized with rare trace of pyrite over 3.3 meters.  | 27027      | 205.6        | 207.2  | 1.6       | 7      |  |
|       |    |   | 27028      | 207.2        | 208.9  | 1.7       | 8      |  |
|       |    | 212.2:Zone slightly sheared 30-35° c/a,strongly epidotized and moderately hematized over 45 cm.   | 27029      | 212.2        | 212.65 | 0.45      | 6      |  |
|       |    | 214.5:Zone slightly sheared and fractured 35° c/a,hematized with qtz-carb veining and odd trace of py over 25 cm.                           | 27030      | 214.5        | 214.75 | 0.25      | 4      |  |
|       |    | 225.2:Zone fractured,moderately leached,limonitized,kaolinitized and barren over 80 cm.(fault or large diacalse)                            | 27031      | 225.2        | 226.0  | 0.8       | 4      |  |
|       |    | 229.25:Zone slightly fractured with a few millimetric qtz-carb-hematite veinlets at 50° c/a,barren over 35 cm.                              | 27032      | 229.25       | 229.6  | 0.35      | 4      |  |



| Depth |    | Description   | Sample No. | Intersection |        |           | Assays |  |
|-------|----|---|------------|--------------|--------|-----------|--------|--|
| From  | To |   |            | From         | To     | Width (m) | Au ppb |  |
|       |    | 230.85:Zone moderately fractured,hematized with a little qtz-carb-hematite veinlets 2-5mm wide at 35-55° c/a with traces of purple fluorite and odd traces of pyrite over 1.9 meters. | 27033      | 230.85       | 232.75 | 1.9       | 5      |  |
|       |    | 233.5:Zone slightly sheared,hematized and epidotized with a 1 cm wide(t.w.) 45-50° c/a qtz-carb-fluorite veinlet and odd trace of cp,py over 20 cm.                                   | 27034      | 233.5        | 233.7  | 0.2       | 4      |  |
|       |    | 237.3:Zone slightly sheared with 2 qtz-carb-fluorite veinlets 1 cm wide(t.w.) at 45° c/a with traces of cp,py over 50 cm.   | 27035      | 237.3        | 237.8  | 0.5       | 6      |  |
|       |    | 237.8:Zone moderately hematized,slightly carbonatized and brecciated with trace of py over 90 cm.   | 27036      | 237.8        | 238.7  | 0.9       | 5      |  |
|       |    | 238.7:Qtz-carb-py veinlet 2 mm wide at 35° c/a in zone idem to 27036 over 15 cm.  | 27037      | 238.7        | 238.85 | 0.15      | 41     |  |
|       |    | 238.85:Zone idem to 27036 over 75 cm.   | 27038      | 238.85       | 239.6  | 0.75      | 6      |  |
|       |    | 239.6:Zone fractured,moderately brecciated,silicified with qtz-carb veining,slightly chloritized with tr of py over 70 cm.  | 27039      | 239.6        | 240.3  | 0.7       | 7      |  |
|       |    | 240.3:Zone fractured,moderately silicified,slightly chloritized with trace of py over 40 cm.  | 27040      | 240.3        | 240.7  | 0.4       | 13     |  |
|       |    | 242.6:Zone with 2 qtz-carb-fluorite veinlets 1 cm wide at 65 & 75 c/a carrying rare trace of py over 15 cm.   | 27041      | 242.6        | 242.75 | 0.15      | 5      |  |
|       |    | END OF HOLE at 243.83 meters.   |            |              |        |           |        |  |

# GEOLOGIC SECTION

HOLE 100E-1

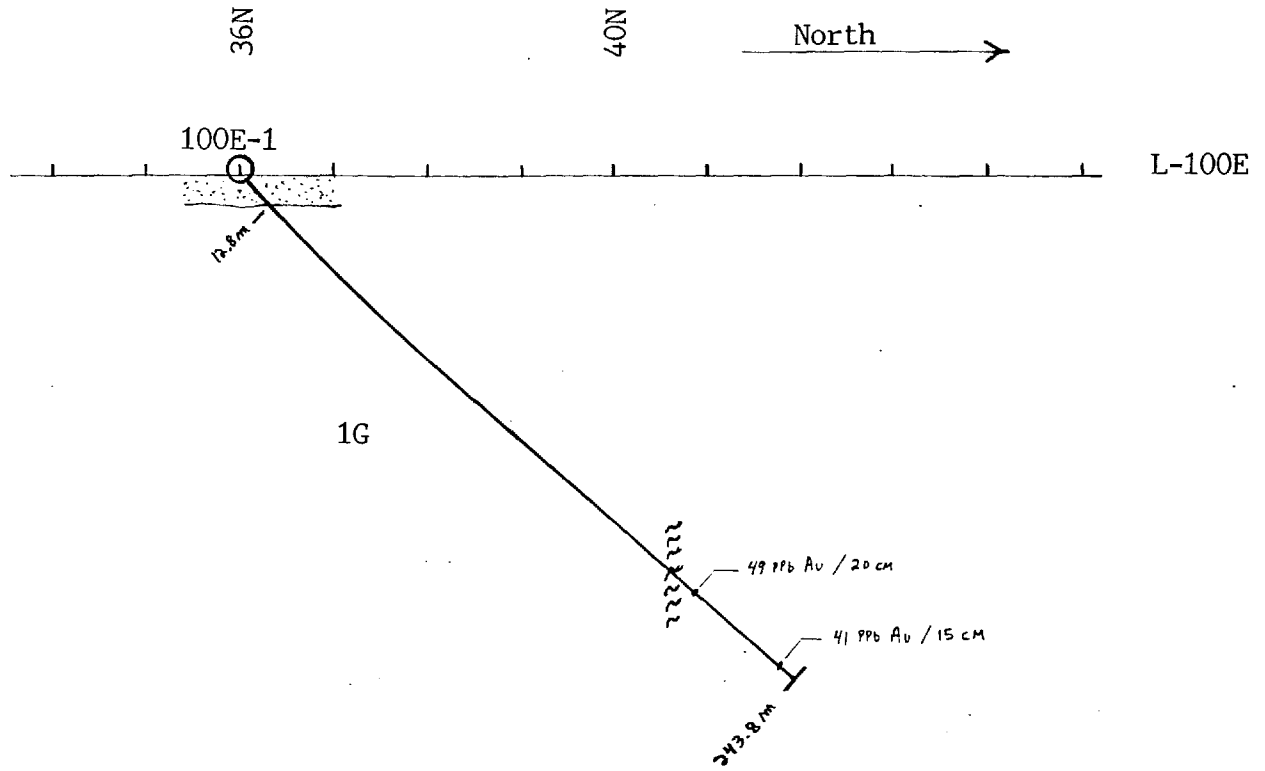

## LEGEND

1G : Granite  
~~~~~ : Shear / fault zone

Scale 1:2,500

Hole No: 40N-1Ref. Grid: (feet)Co-ordinates: L-40N , 89EAzimuth: N 290°Dip: - 45°Total Length: 179.8 meters (590 feet)Horizontal Proj.: Vertical Proj.: 

Dip Test

Depth Angle

collar - 45°91.4m - 42°179.8m - 37°Prospect: ISLE-DIEUVenture No:  N.T.S.: 32F/13Location Area/Twp: Isle-Dieu twpClaim No: 464589-1Core Size: BQDrill Contractor: Forage DIAMEX Inc.Date Started: March 5 , 1989Date Completed: March 11 , 1989

| Depth |       | Description                                                                                                                                                                                                                                                                                                                                                                                                                                                                                                                                                                                                                                                                                                                                                                                    | Sample No. | Intersection |      |           | Assays |  |
|-------|-------|------------------------------------------------------------------------------------------------------------------------------------------------------------------------------------------------------------------------------------------------------------------------------------------------------------------------------------------------------------------------------------------------------------------------------------------------------------------------------------------------------------------------------------------------------------------------------------------------------------------------------------------------------------------------------------------------------------------------------------------------------------------------------------------------|------------|--------------|------|-----------|--------|--|
| From  | To    |                                                                                                                                                                                                                                                                                                                                                                                                                                                                                                                                                                                                                                                                                                                                                                                                |            | From         | To   | Width (m) | Au ppb |  |
| 0     | 6.1   | OVERBURDEN (casing pulled out)                                                                                                                                                                                                                                                                                                                                                                                                                                                                                                                                                                                                                                                                                                                                                                 |            |              |      |           |        |  |
| 6.1   | 179.8 | GRANITE<br>Grey-white to reddish(where hematized),medium to coarse grain,locally moderately to strongly hematized and or epidotized. Locally sheared and chloritized.<br>8.6:Core broken,strongly hematized with barren gauge over 55 cm.<br>20.4:Zone strongly hematized,slightly sheared with rare trace of pyrite over 1.3 meters.<br>35.1:Zone strongly hematized over 20 cm.<br>38.2:Silicified shear 1-2 cm wide(t.w.) at 35° c/a with trace of cp,py over 40 cm.<br>49.5:Qtz-carb-hematite vein 1 cm wide (t.w.) at 20°, slightly brecciated with rare trace of py over 40 cm.<br>59.7:Zone moderately fractured 35-45° c/a and hematized with rare trace of py over 40 cm.<br>63.1:Zone moderately fractured,sheared and silicified 35-50° c/a,strongly hematized with a little random |            |              |      |           |        |  |
|       |       |                                                                                                                                                                                                                                                                                                                                                                                                                                                                                                                                                                                                                                                                                                                                                                                                | 27042      | 8.6          | 9.15 | 0.55      | 10     |  |
|       |       |                                                                                                                                                                                                                                                                                                                                                                                                                                                                                                                                                                                                                                                                                                                                                                                                | 27043      | 20.4         | 21.7 | 1.3       | 5      |  |
|       |       |                                                                                                                                                                                                                                                                                                                                                                                                                                                                                                                                                                                                                                                                                                                                                                                                | 27044      | 37.9         | 38.3 | 0.4       | 50     |  |
|       |       |                                                                                                                                                                                                                                                                                                                                                                                                                                                                                                                                                                                                                                                                                                                                                                                                | 27045      | 49.3         | 49.7 | 0.4       | 7      |  |
|       |       |                                                                                                                                                                                                                                                                                                                                                                                                                                                                                                                                                                                                                                                                                                                                                                                                | 27046      | 59.7         | 60.1 | 0.4       | 4      |  |
|       |       |                                                                                                                                                                                                                                                                                                                                                                                                                                                                                                                                                                                                                                                                                                                                                                                                | 27047      | 63.1         | 64.4 | 1.3       | 8      |  |

Logged by: Bernard Borduas,Geologist

| Depth |    | Description                                                                                                                                                                                       | Sample No. | Intersection |        |           | Assays |  |
|-------|----|---------------------------------------------------------------------------------------------------------------------------------------------------------------------------------------------------|------------|--------------|--------|-----------|--------|--|
| From  | To |                                                                                                                                                                                                   |            | From         | To     | Width (m) | Au ppb |  |
|       |    | qtz-carb veining and rare trace of sulfide over 1.3 meters.                                                                                                                                       |            |              |        |           |        |  |
|       |    | 66.4:Zone moderately fractured and hematized,slightly carbonatized with rare trace of py over 1.4m.                                                                                               | 27048      | 66.4         | 67.8   | 1.4       | 6      |  |
|       |    | 73.7:Carbonatized shear 2 cm wide at 20-25° c/a,moderately silicified,chloritized,epidotized and hematized with < 0.5 % py over 30 cm.                                                            | 27049      | 73.6         | 73.9   | 0.3       | 102    |  |
|       |    | 75.2:Carbonated shear 8 cm wide(t.w.) at 35° c/a,moderately chloritized and brecciated with trace of pyrite over 30 cm.                                                                           | 27050      | 75.2         | 75.5   | 0.3       | 5      |  |
|       |    | 75.8:Carbonatized shear 2-3 cm wide(t.w.) at 35° c/a moderately epidotized with 0.5 % cp,py over 30cm.                                                                                            | 27051      | 75.8         | 76.1   | 0.3       | 51     |  |
|       |    | From 90m to 103.3m rock is becoming homogeneously moderately hematized and locally epidotized.                                                                                                    |            |              |        |           |        |  |
|       |    | 91.4:Qtz-carb-hematite vein 2 cm wide(t.w.),sheared 35° c/a with rare trace of py over 20 cm.                                                                                                     | 27052      | 91.3         | 91.5   | 0.2       | 6      |  |
|       |    | 103.2:Carbonatized,chloritized,hematized,brecciated shear 10 cm wide(t.w.) at 40-50 c/a with rare tr of pyrite over 30 cm.                                                                        | 27053      | 103.0        | 103.3  | 0.3       | 5      |  |
|       |    | From 103.3m to 112.3m and again from 115.8m to 125.1m rock becomes strongly hematized(brick red),slightly to moderately fractured,chloritized with some carbonate filling and locally epidotized. |            |              |        |           |        |  |
|       |    | 104.75:Zone strongly hematized,moderately epidotized chloritized and slightly carbonatized with rare trace of pyrite over 1.7 meters.                                                             | 27054      | 104.75       | 106.45 | 1.7       | 5      |  |
|       |    | 106.45:Zone fractured,slightly sheared 25° c/a with qtz-carb veining,strongly hematized and moderately epidotized and chloritized with rare trace of py over 55 cm.                               | 27055      | 106.45       | 107.0  | 0.55      | 6      |  |
|       |    | 110.35:Carbonate rich vein,black,graphitic,fine grain with trace of sulfide over 5 cm.                                                                                                            | 27056      | 110.35       | 110.4  | 0.05      | 5      |  |
|       |    | 120.0:Zone strongly hematized,moderately chloritized                                                                                                                                              | 27057      | 120.0        | 121.5  | 1.5       | 11     |  |

| Depth |    | Description                                                                                                                               | Sample No. | Intersection |           | Analysis |        |        |        |              |
|-------|----|-------------------------------------------------------------------------------------------------------------------------------------------|------------|--------------|-----------|----------|--------|--------|--------|--------------|
| From  | To |                                                                                                                                           |            | From - To    | Width (m) | Au ppb   | Ag ppm | Cu ppm | Zn ppm | As ppm       |
|       |    | epidotized, slightly brecciated with rare tr of py over 1.5 meters.                                                                       |            |              |           |          |        |        |        |              |
|       |    | 123.8: Zone strongly hematized, moderately chloritized, epidotized, silicified and sheared with rare trace of pyrite over 90 cm.          | 27058      | 123.8-124.7  | 0.9       | 6        |        |        |        |              |
|       |    | 124.7: Gauge, mylonite and brecciated rock (fault), strongly hematitic and chloritized with shearing evidence at 45° c/a over 40 cm.      | 27059      | 124.7-125.1  | 0.4       | 9        | 1.3    | 46     | 45     | 4.0          |
|       |    | From 125.1m to 136.5m rock is moderately to strongly fractured, hematized, brecciated, locally silicified with qtz-carb fracture filling. |            |              |           |          |        |        |        | Pb: 13ppm    |
|       |    | 125.1: Zone strongly fractured, hematized, brecciated, silicified and chloritized with trace of py over 65 cm.                            | 27060      | 125.1-125.75 | 0.65      | 22       | 1.0    | 20     | 37     | 6.0          |
|       |    | 127.5: Zone fractured, hematized, silicified brecciated with qtz-carb veining and trace of py over 50 cm.                                 | 27061      | 127.5-128.0  | 0.5       | 9        | 0.6    | 16     | 33     | 3.5          |
|       |    | 128.0: Zone hematized, moderately fractured epidotized with qtz-carb veining and trace of py over 90 cm.                                  | 27062      | 128.0-128.9  | 0.9       | 4        | 0.6    | 48     | 35     | 4.5          |
|       |    | 128.9: Zone idem to 27062 with 0.5 % py & 0.5 % galena over 75 cm.                                                                        | 27063      | 128.9-129.65 | 0.75      | 10       | 27.0   | 1101   | 38     | 12.0         |
|       |    | 132.65: Zone strongly fractured, slightly chloritized with carbonate fracture filling and tr py, galena over 75 cm.                       | 27064      | 132.65-133.4 | 0.75      | 4        | 11.5   | 504    | 34     | 6.0          |
|       |    | 135.9: Zone fractured 25° c/a, brecciated, weakly silicified with carbonate fracture filling and tr py over 60 cm.                        | 27065      | 135.9-136.5  | 0.6       | 5        |        |        |        |              |
|       |    | From 136.5m to 179.82m rock is homogeneously hematized moderately.                                                                        |            |              |           |          |        |        |        | Pb: 13700ppm |
|       |    | 139.0: Qtz-carb vein 1 cm wide (t.w.) at                                                                                                  | 27066      | 139.0-139.15 | 0.15      | 6        |        |        |        | 6.0          |
|       |    |                                                                                                                                           |            |              |           |          |        |        |        | Pb: 849ppm   |

| Depth |    | Description                                                                                                              | Sample No.   | Intersection |         |           | Assays |         |
|-------|----|--------------------------------------------------------------------------------------------------------------------------|--------------|--------------|---------|-----------|--------|---------|
| From  | To |                                                                                                                          |              | From         | To      | Width (m) | Au ppb | Au oz/t |
|       |    | 25° c/a with 2 % pyrite.                                                                                                 |              |              |         |           |        |         |
|       |    | 146.05:Silicified,slightly epidotized and carbonatized shear 1 cm wide(t.w.) at 25° c/a with 30% py.                     | 27067        | 146.05       | 146.2   | 0.15      | 1718   | 0.05    |
|       |    | 148.8:Carbonate-graphite-pyrite 3 mm wide (t.w.) veinlet at 15° c/a.                                                     | 27068        | 148.8        | 149.0   | 0.2       | 13     |         |
|       |    | 152.75:Zone moderately sheared 15-20 c/a,silicified, carbonatized,epidotized and chloritized with 1 % pyrite over 45 cm. | 27069        | 152.75       | 153.2   | 0.45      | 44     |         |
|       |    | 158.0:Carbonatized,chloritized shear 2-3 cm wide(t.w.) at 30° c/a with trace of sulfide.                                 | 27070        | 158.0        | 158.15  | 0.15      | 6      |         |
|       |    | 171.8:Epidotized shear 2 cm wide(t.w.) at 15-20 c/a moderately carbonatized,brecciated and barren.                       |              |              |         |           |        |         |
|       |    | END OF HOLE at 179.82 meters.                                                                                            |              |              |         |           |        |         |
|       |    | List of assays of interest                                                                                               |              |              |         |           |        |         |
|       |    | Sample #                                                                                                                 | Intersection | Width (m)    | Au g/mt | Ag g/mt   | Pb %   |         |
|       |    | 27063                                                                                                                    | 128.9-129.65 | 0.75         |         | 27.0      | 1.37   |         |
|       |    | 27064                                                                                                                    | 132.65-133.4 | 0.75         |         | 11.5      | 0.085  |         |
|       |    | 27067                                                                                                                    | 146.05-146.2 | 0.15         | 1.72    |           |        |         |

# GEOLOGIC SECTION

HOLE 40N-1

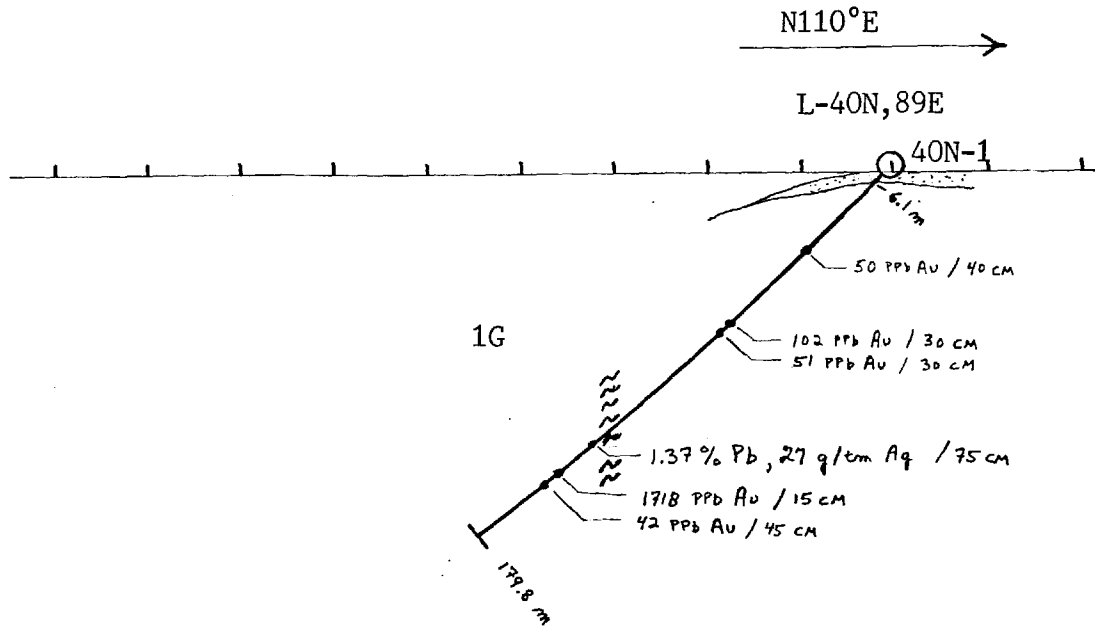

## LEGEND

1G : Granite

Scale 1:2,500

~~~~~ : Shear / fault zone

Hole No: 92E-1  
 Ref. Grid: (feet)  
 Co-ordinates: L-92E, 32N  
 Azimuth: N 270°  
 Dip: - 45°  
 Total Length: 176.78 meters (580')  
 Horizontal Proj.: \_\_\_\_\_  
 Vertical Proj.: \_\_\_\_\_

Dip Test  
 Depth Angle  
collar - 45°  
91.4m - 45°  
 \_\_\_\_\_  
 \_\_\_\_\_  
 \_\_\_\_\_

Prospect: ISLE-DIEU  
 Venture No: \_\_\_\_\_ N.T.S.: 32F/13  
 Location Area/Twp: Isle-Dieu twp  
 Claim No: 464589-3  
 Core Size: BQ  
 Drill Contractor: Forage DIAMEX Inc.  
 Date Started: March 12, 1989  
 Date Completed: March 18, 1989

| Depth |        | Description  | Sample No. | Intersection |      |           | Assays |  |
|-------|--------|--|------------|--------------|------|-----------|--------|--|
| From  | To     |  |            | From         | To   | Width (m) | Au ppb |  |
| 0     | 23.16  | OVERBURDEN (casing pulled out)   |            |              |      |           |        |  |
| 23.16 | 176.78 | GRANITE<br>Grey-white, pinkish to reddish where hematized, greenish grey where epidotized, grey where carbonatized; medium to coarse grain with local finer grain grey-green more dioritic xenoliths or phases.<br><br>From 41m to 51.4m rock is homogeneously moderately hematized and slightly epidotized.<br>From 76m to 124m rock is slightly to moderately hematized and epidotized from places to places.<br><br>77.05: Millimetric epidotized fracture at 50° c/a with a little galena, py, cp and molybdenite.<br><br>81.15: Dark green fine grain basic dyke at 35° c/a with rare trace of sulfide over 55 cm.<br><br>82.6: Crushed zone chloritized and barren at 40-45° c/a over 10 cm.<br><br>87.1: Zone sheared and brecciated 20-25° c/a 10 cm wide (t.w.) moderately epidotized, chloritized and siliceous with rare trace of sulfide over 40 cm. |            |              |      |           |        |  |
|       |        |  | 27071      | 77.05        | 77.2 | 0.15      | 114    | As: 1.0 ppm<br>Ag: 1.3 ppm<br>Cu: 2490 ppm<br>Zn: 43 ppm<br>Pb: 11 ppm |
|       |        |  | 27072      | 81.15        | 81.7 | 0.55      | 7      |  |
|       |        |  | 27073      | 82.6         | 82.7 | 0.1       | 4      |  |
|       |        |  | 27074      | 87.1         | 87.5 | 0.4       | 5      |  |

Logged by: Bernard Borduas, Geologist.



| Depth |    | Description  | Sample No. | Intersection |        |           | Assays |  |
|-------|----|--|------------|--------------|--------|-----------|--------|--|
| From  | To |  |            | From         | To     | Width (m) | Au ppb |  |
|       |    | 100.9: Epidotized, silicified shear 1-2 cm wide (t.w.) at 35° c/a in moderately fractured and hematized zone with rare trace of sulfide over 60 cm.                            | 27075      | 100.8        | 101.4  | 0.6       | 4      |  |
|       |    | 103.8: Millimetric fracture at 50 c/a, epidotized with a little py & cp.   | 27076      | 103.8        | 103.9  | 0.1       | 4      |  |
|       |    | 121.2: Zone with 2 millimetric 35° c/a shears epidotized, hematized, silicified and carbonatized with tr of sulfide over 20 cm.  | 27077      | 121.2        | 121.4  | 0.2       | 4      |  |
|       |    | From 124m to 130.3m rock gets moderately fractured, hematized, chloritized, epidotized and slightly carbonatized.  |            |              |        |           |        |  |
|       |    | 125.0: Zone moderately fractured, hematized, chloritized with a little carbonate veining and trace of sulfide over 1.1 meter.  | 27078      | 125.0        | 126.1  | 1.1       | 4      |  |
|       |    | From 130.3m to 138.5m rock become more fractured, slightly sheared, strongly epidotized, chloritized, moderately hematized and carbonatized with carbonate veining.            |            |              |        |           |        |  |
|       |    | 130.3: Zone fractured, epidotized, hematized with a little qtz-carb veining and trace of sulfide over 1.05 meter.  | 27079      | 130.3        | 131.35 | 1.05      | 6      |  |
|       |    | 134.9: Zone sheared, chloritized, carbonatized, hematized strongly epidotized with tr of sulfide over 95 cm.   | 27080      | 134.9        | 135.85 | 0.95      | 4      |  |
|       |    | 137.7: Zone moderately sheared, strongly epidotized, carbonatized, slightly hematized with a few centimetric qtz-carb veins at 35-40 c/a and rare trace of sulfide over 80 cm. | 27081      | 137.7        | 138.5  | 0.8       | 4      |  |
|       |    | 143.1: Epidotized, silicified shear 1 cm wide (t.w.) at 45° c/a with 0.5 % diss cp & py.   | 27082      | 143.1        | 143.2  | 0.1       | 301    | Cu: 1470ppm<br>Zn: 45ppm<br>Ag: 0.7ppm<br>As: 1.5ppm |
|       |    | 146.9: Zone with 3 hematite-carbonate fractures 2-3 mm wide (t.w.) at 25-30 c/a with rare trace of sulfide over 75 cm.   | 27083      | 146.9        | 147.65 | 0.75      | 4      |  |
|       |    | 155.25: Zone slightly sheared 45° c/a with a little epidotization, silicification and tr cp over 45 cm.  | 27084      | 155.75       | 155.7  | 0.45      | 5      |  |

| Depth |    | Description   | Sample No. | Intersection |       |           | Assays |  |
|-------|----|---|------------|--------------|-------|-----------|--------|--|
| From  | To |   |            | From         | To    | Width (m) | Au ppb |  |
|       |    | 158.35: Epidotized-cp-py millimetric veinlet at 45° c/a   | 27085      | 158.35       | 158.5 | 0.15      | 27     |  |
|       |    | 168.8: Zone moderately fractured, sheared 20 c/a at 168.9 with a zone of crushing over 5 cm at 169.4m and and rare trace of sulfide over 80 cm. | 27086      | 168.8        | 169.6 | 0.8       | 5      |  |
|       |    | 173.1: Zone moderately hematized with a little qtz-epidote veining and rare tr of sulfide over 1.6 m.   | 27087      | 173.1        | 174.7 | 1.6       | 4      |  |
|       |    | END OF HOLE at 176.78 meters.   |            |              |       |           |        |  |

# GEOLOGIC SECTION

HOLE 92E-1

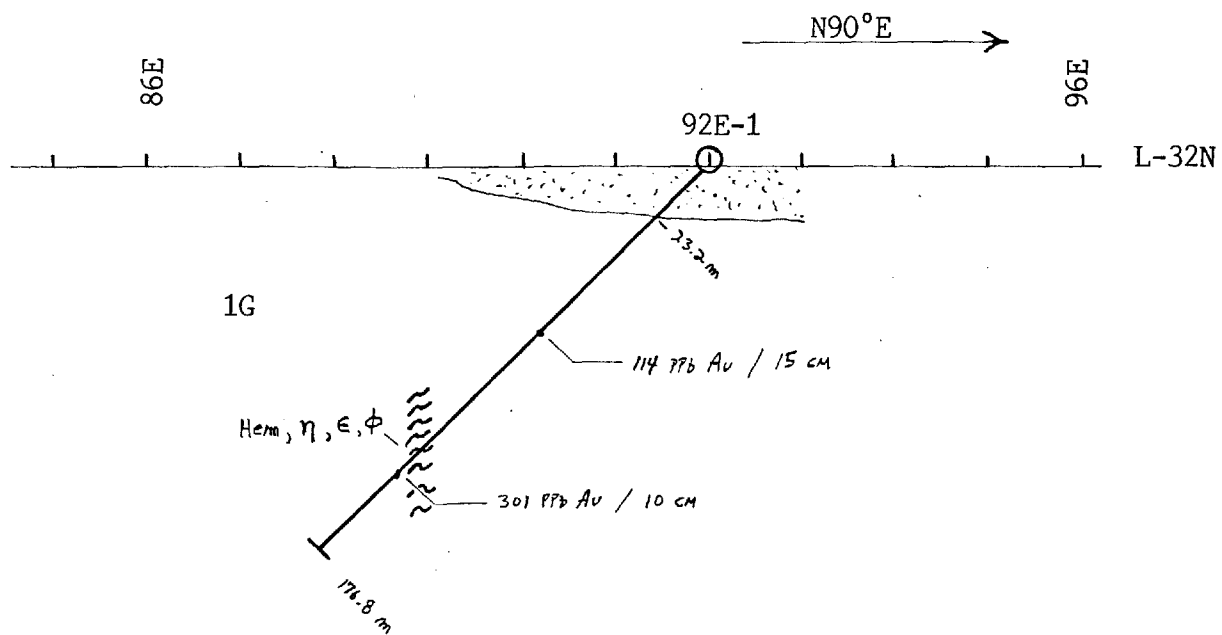

## LEGEND

- 1G : Granite
- Hem : hematite
- ε : epidotization
- φ : chloritization
- η : carbonatization
- ~~~~~ : Shear / fault zone

Scale 1:2,500

Hole No: 52N-1  
 Ref. Grid: (feet)  
 Co-ordinates: L-52N , 76E  
 Azimuth: N 125°  
 Dip: - 45°  
 Total Length: 178.3 meters (585')  
 Horizontal Proj.: \_\_\_\_\_  
 Vertical Proj.: \_\_\_\_\_

Dip Test  
 Depth Angle  
 collar - 45°  
152.4m - 43°  
 \_\_\_\_\_  
 \_\_\_\_\_  
 \_\_\_\_\_

Prospect: ISLE-DIEU  
 Venture No: \_\_\_\_\_ N.T.S.: 32F/13  
 Location Area/Twp: Isle-Dieu twp  
 Claim No: 464673-1  
 Core Size: BO  
 Drill Contractor: Forage DIAMEX Inc.  
 Date Started: March 20 , 1989  
 Date Completed: March 29 , 1989

| Depth |       | Description.  | Sample No. | Intersection |       |           | Assays |  |
|-------|-------|---|------------|--------------|-------|-----------|--------|--|
| From  | To    |   |            | From         | To    | Width (m) | Au ppb |  |
| 0     | 22.24 | OVERBURDEN (casing pulled out)  |            |              |       |           |        |  |
| 22.24 | 178.3 | GRANITE<br>Grey-white, pinkish to reddish where hematized, greenish grey where epidotized, grey where carbonatized; medium to coarse grain with local finer grain grey green more dioritic xenoliths or phases. |            |              |       |           |        |  |
|       |       | 23.4: Zone moderately fractured, hematized, epidotized, carbonatized and silicified with rare trace of pyrite over 60 cm.   | 27088      | 23.4         | 24.0  | 0.6       | 4      |  |
|       |       | 29.8: Rock is moderately hematized and slightly epidotized over 90 cm.  |            |              |       |           |        |  |
|       |       | 66.45: Zone moderately sheared 65° c/a, hematized, carbonatized, silicified, slightly epidotized and chloritized with tr py, cp over 20 cm.   | 27089      | 66.45        | 66.65 | 0.2       | 6      |  |
|       |       | 76.1: Zone idem to 27089 but barren over 20 cm.   | 27090      | 76.1         | 76.3  | 0.2       | 53     |  |
|       |       | 91.45: Zone idem to 27090 but less sheared and altered over 30 cm.  | 27091      | 91.45        | 91.75 | 0.3       | 4      |  |
|       |       | 93.8: Zone strongly epidotized and chloritized, moderately carbonatized and hematized, slightly sheared and   | 27092      | 93.8         | 94.4  | 0.6       | 4      |  |

Logged by: Bernard Borduas, Geologist.

| Depth |        | Description  | Sample No. | Intersection |        |           | Assays |  |
|-------|--------|--|------------|--------------|--------|-----------|--------|--|
| From  | To     |  |            | From         | To     | Width (m) | Au ppb |  |
|       |        | fractured 80° c/a, barren over 60 cm.  |            |              |        |           |        |  |
|       | 107.25 | Zone slightly sheared 55-65 c/a, epidotized and moderately silicified with rare trace of sulfide over 30 cm.   | 27093      | 107.25       | 107.55 | 0.3       | 4      |  |
|       | 113.0  | Zone slightly fractured 45-55 c/a, moderately epidotized and hematized, barren over 1 meter.   | 27094      | 113.0        | 114.0  | 1.0       | 5      |  |
|       | 120.3  | Zone moderately fractured and sheared 55-70 c/a carbonatized, chloritized, silicified, epidotized and hematized with tr of sulfide over 95 cm.   | 27095      | 120.3        | 121.25 | 0.95      | 4      |  |
|       | 123.8  | Zone slightly sheared 65-75 c/a, epidotized and hematized with odd tr of sulfide over 20 cm.   | 27096      | 123.8        | 124.0  | 0.2       | 4      |  |
|       | 129.15 | Gabbroic dyke (dark green) with upper contact sheared 55-60 c/a, moderately carbonatized, chloritized and carrying < 1 % cp, py in the first 30 cm. Less carbonatized with trace of sulfide in the last 70 cm. Lower contact at 65-70 c/a. Granitic dyke or xenolith over 15 cm at 129.4m. | 27097      | 129.15       | 129.45 | 0.3       | 94     | Zn: 52ppm<br>Cu: 1340ppm<br>Ag: 0.7ppm<br>As: 1.0ppm |
|       |        |  | 27098      | 129.45       | 130.15 | 0.7       | 4      |  |
|       |        | From 130.8m to 133.3m rock becomes moderately fractured hematized, slightly to moderately chloritized and epidotized with a little barren carbonate fracture filling.  |            |              |        |           |        |  |
|       | 133.3  | Zone fractured, slightly sheared 65 c/a, strongly hematized, moderately chloritized with carbonate fracture filling and trace of sulfide over 2.75m.   | 27099      | 133.3        | 134.7  | 1.4       | 4      |  |
|       |        |  | 27100      | 134.7        | 136.05 | 1.35      | 6      |  |
|       | 146.1  | Zone moderately sheared 60 c/a, carbonatized, epidotized and chloritized with a little Qtz-carb veining and trace cp, py over 1 meter.   | 27101      | 146.1        | 147.1  | 1.0       | 4      | Zn: 36ppm<br>Cu: 29ppm<br>Ag: 0.4ppm<br>As: 0.5ppm   |
|       | 151.5  | Carbonatized, chloritized shear 1 cm wide (t.w.) at 25° c/a with trace of sulfide over 25 cm.  | 27102      | 151.5        | 151.75 | 0.25      | 5      |  |
|       |        | From 167.1m to 170.7m rock is moderately hematized and chloritized, locally moderately fractured and epidotized.   |            |              |        |           |        |  |
|       | 167.3  | Zone moderately hematized, slightly to moderately fractured and epidotized with a little carbonate fracture filling and odd tr of sulfide over 1.7m.   | 27103      | 167.3        | 169.0  | 1.7       | 4      |  |

| Depth |    | Description   | Sample No. | Intersection |       |           | Assays |  |
|-------|----|---|------------|--------------|-------|-----------|--------|--|
| From  | To |   |            | From         | To    | Width (m) | Au ppb |  |
|       |    | 170.1: Zone moderately carbonatized, chloritized and hematized with trace of sulfide over 60 cm.  | 27104      | 170.1        | 170.7 | 0.6       | 4      |  |
|       |    | 175.25: Zone moderately sheared 45-50 c/a, fractured, hematized and epidotized with carbonate veining and rare trace of sulfide over 45 cm. | 27105      | 175.25       | 175.7 | 0.45      | 59     |  |
|       |    | END OF HOLE at 178.3 meters .   |            |              |       |           |        |  |

# GEOLOGIC SECTION

HOLE 52N-1

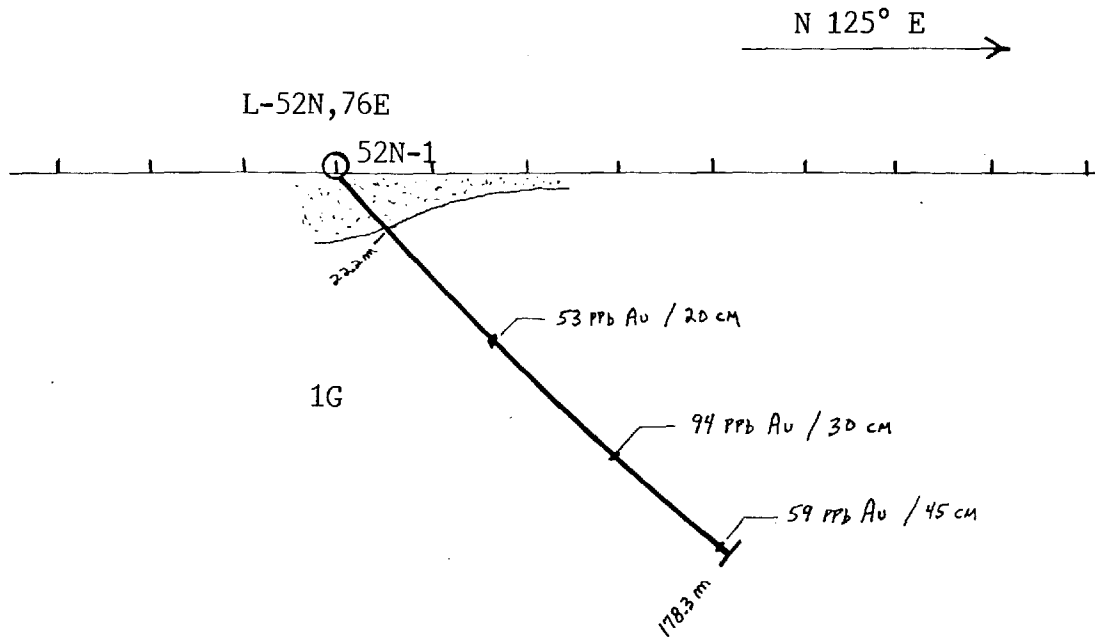

## LEGEND

1G : Granite

Scale 1:2,500

Hole No: 52N-2  
 Ref. Grid: (feet)  
 Co-ordinates: L-52N , 79+40E  
 Azimuth: N 90°  
 Dip: - 46°  
 Total Length: 139.6 meters (458')  
 Horizontal Proj.: \_\_\_\_\_  
 Vertical Proj.: \_\_\_\_\_

Dip Test  
 Depth Angle  
collar - 46°  
76.2m - 46°  
139.6m - 46°  
 \_\_\_\_\_  
 \_\_\_\_\_

Prospect: ISLE-DIEU  
 Venture No: \_\_\_\_\_ N.T.S.: 32F/13  
 Location Area/Twp: Isle-Dieu twp.  
 Claim No: 464673-1  
 Core Size: BQ  
 Drill Contractor: Forage DIAMEX Inc.  
 Date Started: March 29 , 1989  
 Date Completed: April 1 , 1989

| Depth |       | Description  | Sample No. | Intersection |       |           | Assays |  |
|-------|-------|--|------------|--------------|-------|-----------|--------|--|
| From  | To    |  |            | From         | To    | Width (m) | Au ppb |  |
| 0     | 4.88  | OVERBURDEN (casing left in hole)   |            |              |       |           |        |  |
| 4.88  | 139.6 | GRANITE<br>Grey-white, pinkish to reddish where hematized, greenish grey where epidotized, grey where carbonatized; medium to coarse grain with local finer grain more dioritic xenoliths or phases. |            |              |       |           |        |  |
|       |       | 19.3: Zone slightly sheared, hematized, chloritized, epidotized and carbonatized with odd trace of sulfide over 1.5 meters.  | 27106      | 19.3         | 20.8  | 1.5       | 5      |  |
|       |       | 38.9: Zone moderately sheared 40-45 c/a, epidotized, hematized, chloritized and carbonatized with trace of pyrite over 20 cm.  | 27107      | 38.9         | 39.1  | 0.2       | 8      |  |
|       |       | 51.75: Qtz-carb vein 1 cm wide at 30 c/a with hematization, epidotization, chloritization, carbonatization and trace of pyrite over 10 cm.   | 27108      | 51.75        | 51.85 | 0.1       | 4      |  |
|       |       | 58.7: Zone slightly sheared, epidotized, chloritized, moderately hematized with odd trace of sulfide over 30 cm.   | 27109      | 58.7         | 59.0  | 0.3       | 4      |  |
|       |       | 82: Zone slightly to moderately hematized and epidoti-   | 27110      | 82.0         | 83.3  | 1.3       | 4      |  |

Logged by: Bernard Borduas, Geologist.



| Depth |    | Description  | Sample No. | Intersection |        |           | Assays |   |
|-------|----|--|------------|--------------|--------|-----------|--------|---|
| From  | To |  |            | From         | To     | Width (m) | Au ppb |   |
|       |    | zed with rare tr of sulfide over 1.3 meter.  |            |              |        |           |        |   |
|       |    | 98.6:Zone moderately sheared 30 c/a,carbonatized and chloritized with trace of pyrite over 30 cm.  | 27111      | 98.6         | 98.9   | 0.3       | 4      |   |
|       |    | 99.5:Qtz-carb veinlet 5mm wide(t.w.) at 45° c/a with 5 % cp,py with hematized,chloritized walls over 10 cm.  | 27112      | 99.45        | 99.55  | 0.1       | 5      | Zn:39ppm<br>Cu:1269ppm<br>Ag:0.6ppm<br>As:0.5ppm                          |
|       |    | 109.65:Zone moderately sheared 35-45 c/a,carbonatized hematized and chloritized with < 0.5 % py over 50cm.   | 27113      | 109.65       | 110.15 | 0.5       | 4      |   |
|       |    | 120.0:Zone slightly fractured,sheared,hematized and epidotized with local small patches (2-10mm wide) of epidote-cp-py giving traces of cp,py over 2.2m.                         | 27114      | 120.0        | 121.2  | 1.2       | 5      | Zn:22ppm<br>Cu:146ppm   |
|       |    | From 127.5m to 132m rock is moderately fractured,hematized,epidotized,chloritized,locally sheared 35-45 c/a and carbonatized.  | 27115      | 121.2        | 122.2  | 1.0       | 8      | As:0.5ppm<br>Ag:0.3ppm<br>Cu:386ppm<br>Zn:24ppm<br>Ag:0.3ppm<br>As:1.0ppm |
|       |    | 130.0:Zone fractured with carb-epidote shears 2mm-1cm wide(t.w.) at 35-45 c/a,moderately hematized,chloritized,epidotized and carbonatized with trace of pyrite over 1.7 meters. | 27116      | 130.0        | 131.7  | 1.7       | 4      |   |
|       |    | END OF HOLE at 139.6 meters.   |            |              |        |           |        |   |

# GEOLOGIC SECTION

HOLE 52N-2

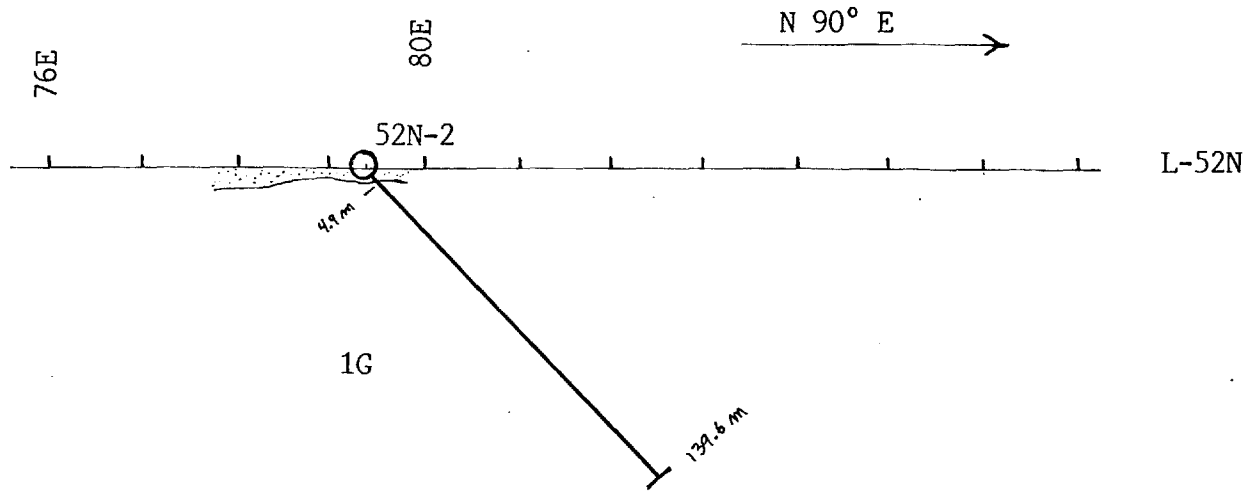

## LEGEND

1G : Granite

Scale 1:2,500

CERTIFICATES OF ANALYSIS



EXPL. MINIERES DU NORD LTEE.  
1698 Duchesne  
Val D'Or / Que.  
J9P 6G8

RÉSULTATS # 02912633-A COMMANDE #

PROJET ISLE-DIEU

DATE 89/02/22

PAGE 1

Att.: M. Bernard Borduas

## RÉSULTATS D'ANALYSES/ASSAY REPORT

| ÉCHANTILLONS<br>SAMPLES | Cu   | Pb  | Zn  | As  | Ag  | Au  | Au   | Au   | Au-1 | Au-2 | Au-3 |
|-------------------------|------|-----|-----|-----|-----|-----|------|------|------|------|------|
|                         | ppm  | ppm | ppm | ppm | ppm | ppb | g/tm | oz/t | ppb  | ppb  | ppb  |
| 27001                   |      |     |     |     |     | 21  |      |      |      |      |      |
| 27002                   |      |     |     |     |     | 5   |      |      |      |      |      |
| 27003                   |      |     |     |     |     | 6   |      |      |      |      |      |
| 27004                   |      |     |     |     |     | 4   |      |      |      |      |      |
| 27005                   |      |     |     |     |     | 4   |      |      |      |      |      |
| 27006                   |      |     |     |     |     | 5   |      |      |      |      |      |
| 27007                   |      |     |     |     |     | 4   |      |      |      |      |      |
| 27008                   |      |     |     |     |     | 4   |      |      |      |      |      |
| 27009                   |      |     |     |     |     | 4   |      |      |      |      |      |
| 27010                   |      |     |     |     |     | 5   |      |      |      |      |      |
| 27011                   |      |     |     |     |     | 10  |      |      |      |      |      |
| 27012                   |      |     |     |     |     | 4   |      |      |      |      |      |
| 27013                   |      |     |     |     |     | 6   |      |      |      |      |      |
| 27014                   | 1425 |     | 35  | 1.0 | 0.9 | 4   |      |      |      |      |      |
| 27015                   |      |     |     |     |     | 5   |      |      |      |      |      |
| 27016                   |      |     |     |     |     | 4   |      |      |      |      |      |
| 27017                   |      |     |     |     |     | 4   |      |      |      |      |      |
| 27018                   |      |     |     |     |     | 5   |      |      |      |      |      |
| 27019                   |      |     |     |     |     | 5   |      |      |      |      |      |
| 27020                   |      |     |     |     |     | 5   |      |      |      |      |      |
| 27021                   |      |     |     |     |     | 4   |      |      |      |      |      |
| 27022                   |      |     |     |     |     | 6   |      |      |      |      |      |
| 27023                   |      |     |     |     |     | 4   |      |      |      |      |      |
| 27024                   |      |     |     |     |     | 5   |      |      |      |      |      |
| 27025                   |      |     |     |     |     | 4   |      |      |      |      |      |
| 27026                   |      |     |     |     |     | 49  |      |      | 48   | 50   |      |
| 27027                   |      |     |     |     |     | 7   |      |      |      |      |      |
| 27028                   |      |     |     |     |     | 8   |      |      |      |      |      |
| 27029                   |      |     |     |     |     | 6   |      |      |      |      |      |
| 27030                   |      |     |     |     |     | 4   |      |      |      |      |      |

*J. H. Blais*



EXPL. MINIERES DU NORD LTEE.  
1698 Duchesne  
Val D'Or / Que.  
J9P 6G8

RÉSULTATS # 02912633-A COMMANDE #

PROJET ISLE-DIEU

DATE 89/02/22

PAGE 2

Att.: M. Bernard Borduas

## RÉSULTATS D'ANALYSES/ASSAY REPORT

| ÉCHANTILLONS<br>SAMPLES | Cu  | Pb  | Zn  | As  | Ag  | Au  | Au   | Au    | Au-1 | Au-2 | Au-3 |
|-------------------------|-----|-----|-----|-----|-----|-----|------|-------|------|------|------|
|                         | ppm | ppm | ppm | ppm | ppm | ppb | g/tm | oz/t  |      |      |      |
| 27031                   |     |     |     |     |     | 4   |      |       |      |      |      |
| 27032                   |     |     |     |     |     | 4   |      |       |      |      |      |
| 27033                   |     |     |     |     |     | 5   |      |       |      |      |      |
| 27034                   |     |     |     |     |     | 4   |      |       |      |      |      |
| 27035                   |     |     |     |     |     | 6   |      |       |      |      |      |
| 27036                   |     |     |     |     |     | 5   |      |       | 38   | 44   |      |
| 27037                   |     |     |     |     |     | 41  |      |       |      |      |      |
| 27038                   |     |     |     |     |     | 6   |      |       |      |      |      |
| 27039                   |     |     |     |     |     | 7   |      |       |      |      |      |
| 27040                   |     |     |     |     |     | 13  |      |       |      |      |      |
| 27041                   |     |     |     |     |     | 5   |      |       |      |      |      |
| 27042                   |     |     |     |     |     | 10  |      |       |      |      |      |
| 27043                   |     |     |     |     |     | 5   |      |       |      |      |      |
| 27044                   |     |     |     |     |     | 50  |      |       | 47   | 53   |      |
| 27045                   |     |     |     |     |     | 7   |      |       |      |      |      |
| 27046                   |     |     |     |     |     | 4   |      |       |      |      |      |
| 27047                   |     |     |     |     |     | 8   |      |       |      |      |      |
| 27048                   |     |     |     |     |     | 6   |      |       |      |      |      |
| 27049                   |     |     |     |     |     | 102 | 0.10 | 0.003 | 97   | 104  | 106  |
| 27050                   |     |     |     |     |     | 5   |      |       |      |      |      |
| 27051                   |     |     |     |     |     | 51  |      |       | 49   | 53   |      |
| 27052                   |     |     |     |     |     | 6   |      |       |      |      |      |
| 27053                   |     |     |     |     |     | 5   |      |       |      |      |      |
| 27054                   |     |     |     |     |     | 5   |      |       |      |      |      |
| 27055                   |     |     |     |     |     | 6   |      |       |      |      |      |
| 27056                   |     |     |     |     |     | 5   |      |       |      |      |      |
| 27057                   |     |     |     |     |     | 11  |      |       |      |      |      |
| 27058                   |     |     |     |     |     | 6   |      |       |      |      |      |
| 27059                   | 46  | 13  | 45  | 4.0 | 1.3 | 9   |      |       |      |      |      |
| 27060                   | 20  | 9   | 37  | 6.0 | 1.0 | 22  |      |       |      |      |      |

*J. Blais*



EXPL. MINIERES DU NORD LTEE.  
1698 Duchesne  
Val D'Or / Que.  
J9P 6G8

RÉSULTATS # 02912633-A COMMANDE #

PROJET ISLE-DIEU

DATE 89/02/22

PAGE 3

Att.: M. Bernard Borduas

RÉSULTATS D'ANALYSES/ASSAY REPORT

| ÉCHANTILLONS<br>SAMPLES | Cu   | Pb    | Zn  | As   | Ag   | Au   | Au   | Au    | Au-1 | Au-2 | Au-3 |
|-------------------------|------|-------|-----|------|------|------|------|-------|------|------|------|
|                         | ppm  | ppm   | ppm | ppm  | ppm  | ppb  | g/tm | oz/t  |      |      |      |
| 27061                   | 16   | 15    | 33  | 3.5  | 0.6  | 9    |      |       |      |      |      |
| 27062                   | 48   | 23    | 35  | 4.5  | 0.6  | 4    |      |       |      |      |      |
| 27063                   | 1101 | 13700 | 38  | 12.0 | 27.0 | 10   |      |       |      |      |      |
| 27064                   | 504  | 849   | 34  | 6.0  | 11.5 | 4    |      |       |      |      |      |
| 27065                   |      |       |     |      |      | 5    |      |       |      |      |      |
| 27066                   |      |       |     |      |      | 6    |      |       |      |      |      |
| 27067                   |      |       |     |      |      | 1718 | 1.7  | 0.050 | 1818 | 1682 | 1655 |
| 27068                   |      |       |     |      |      | 13   |      |       |      |      |      |
| 27069                   |      |       |     |      |      | 44   |      |       | 43   | 45   |      |
| 27070                   |      |       |     |      |      | 6    |      |       |      |      |      |

*J. H. Blas*



EXPLORATIONS MINIERES DU NORD LTEE  
1698 Duchesne  
Val D'Or / Que.  
J9P 6G8

RÉSULTATS # 02912633-B COMMANDE #

PROJET #Isle-Dieu

DATE: 89/02/22

PAGE 1

Att.: M. Bernard Borduas

RÉSULTATS D'ANALYSES/ASSAY REPORT

| ÉCHANTILLONS<br>SAMPLES | Cu   | Pb  | Zn  | As  | Ag  | Au  | Au   | Au    | Au-1 | Au-2 | Au-3 |
|-------------------------|------|-----|-----|-----|-----|-----|------|-------|------|------|------|
|                         | ppm  | ppm | ppm | ppm | ppm | ppb | g/tm | oz/t  | ppb  | ppb  | ppb  |
| 27071                   | 2490 | 11  | 43  | 1.0 | 1.3 | 114 | 0.11 | 0.003 | 110  | 114  | 118  |
| 27072                   |      |     |     |     |     | 7   |      |       |      |      |      |
| 27073                   |      |     |     |     |     | 4   |      |       |      |      |      |
| 27074                   |      |     |     |     |     | 5   |      |       |      |      |      |
| 27075                   |      |     |     |     |     | 4   |      |       |      |      |      |
| 27076                   |      |     |     |     |     | 4   |      |       |      |      |      |
| 27077                   |      |     |     |     |     | 4   |      |       |      |      |      |
| 27078                   |      |     |     |     |     | 4   |      |       |      |      |      |
| 27079                   |      |     |     |     |     | 6   |      |       |      |      |      |
| 27080                   |      |     |     |     |     | 4   |      |       |      |      |      |
| 27081                   | 1470 |     | 45  | 1.5 | 0.7 | 4   | 0.30 | 0.009 | 279  | 315  | 308  |
| 27082                   |      |     |     |     |     | 301 |      |       |      |      |      |
| 27083                   |      |     |     |     |     | 4   |      |       |      |      |      |
| 27084                   |      |     |     |     |     | 5   |      |       |      |      |      |
| 27085                   |      |     |     |     |     | 27  |      |       |      |      |      |
| 27086                   |      |     |     |     |     | 5   |      |       |      |      |      |
| 27087                   |      |     |     |     |     | 4   |      |       |      |      |      |
| 27088                   |      |     |     |     |     | 4   |      |       |      |      |      |
| 27089                   |      |     |     |     |     | 6   |      |       |      |      |      |
| 27090                   |      |     |     |     |     | 53  |      |       |      |      |      |
| 27091                   | 1340 |     | 52  | 1.0 | 0.7 | 4   |      |       | 93   | 95   |      |
| 27092                   |      |     |     |     |     | 4   |      |       |      |      |      |
| 27093                   |      |     |     |     |     | 4   |      |       |      |      |      |
| 27094                   |      |     |     |     |     | 5   |      |       |      |      |      |
| 27095                   |      |     |     |     |     | 4   |      |       |      |      |      |
| 27096                   |      |     |     |     |     | 4   |      |       |      |      |      |
| 27097                   |      |     |     |     |     | 94  |      |       |      |      |      |
| 27098                   |      |     |     |     |     | 4   |      |       |      |      |      |
| 27099                   |      |     |     |     |     | 4   |      |       |      |      |      |
| 27100                   |      |     |     |     |     | 6   |      |       |      |      |      |

*H. Blais*



EXPLORATIONS MINIERES DU NORD LTEE.  
1698 Duchesne  
Val D'Or / Que.  
J9P 6G8

RÉSULTATS # 02912633-B COMMANDE #

PROJET Isle-Dieu

DATE 89/02/22

PAGE 2

Att.: M. Bernard Borduas

RÉSULTATS D'ANALYSES/ASSAY REPORT

| ÉCHANTILLONS<br>SAMPLES | Cu   | Pb  | Zn  | As  | Ag  | Au  | Au   | Au   | Au-1 | Au-2 | Au-3 |
|-------------------------|------|-----|-----|-----|-----|-----|------|------|------|------|------|
|                         | ppm  | ppm | ppm | ppm | ppm | ppb | g/tm | oz/t |      |      |      |
| 27101                   | 29   |     | 36  | 0.5 | 0.4 | 4   |      |      | 55   | 62   |      |
| 27102                   |      | 5   |     |     |     |     |      |      |      |      |      |
| 27103                   |      | 4   |     |     |     |     |      |      |      |      |      |
| 27104                   |      | 4   |     |     |     |     |      |      |      |      |      |
| 27105                   |      | 59  |     |     |     |     |      |      |      |      |      |
| 27106                   |      |     |     |     |     | 5   |      |      |      |      |      |
| 27107                   |      |     |     |     |     | 8   |      |      |      |      |      |
| 27108                   |      |     |     |     |     | 4   |      |      |      |      |      |
| 27109                   |      |     |     |     |     | 4   |      |      |      |      |      |
| 27110                   |      |     |     |     |     | 4   |      |      |      |      |      |
| 27111                   | 1269 |     | 39  | 0.5 | 0.6 | 4   |      |      |      |      |      |
| 27112                   |      | 5   |     |     |     |     |      |      |      |      |      |
| 27113                   |      |     |     |     |     | 4   |      |      |      |      |      |
| 27114                   | 146  |     | 22  | 0.5 | 0.3 | 5   |      |      |      |      |      |
| 27115                   | 386  |     | 24  | 1.0 | 0.3 | 8   |      |      |      |      |      |
| 27116                   |      |     |     |     |     | 4   |      |      |      |      |      |

*H. Blais*