

UTM  
astronomic  
magnetic

10  
Outcrop  
Creek  
Swamp  
Highway  
Electric line  
Fence  
Access road

ÉNERGIE ET RESSOURCES  
SÉCTEUR MINES

2.2. JUL. 1988  
Bureau régional Val d'Or

**noremco**  
explorations inc.

**explorations**  
**noremco inc.**

LA GAUCHETIERE PROJECT N°1434, STE HELENE PROJECT N°1433

Ministère de l'Énergie et des Ressources  
Service de la Géoinformation  
Date: 13 JAN 1989  
No G.M.: 17637

**VAL D'OR**  
GÉOPHYSIQUE

EXECUTED BY: \_\_\_\_\_ DATE: \_\_\_\_\_  
DRAWN BY: \_\_\_\_\_  
INTERPRETED BY: \_\_\_\_\_  
APPROVED BY: \_\_\_\_\_

SCALE: 1:5000      MAP N°: \_\_\_\_\_

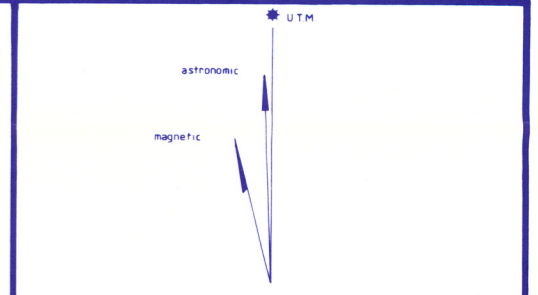
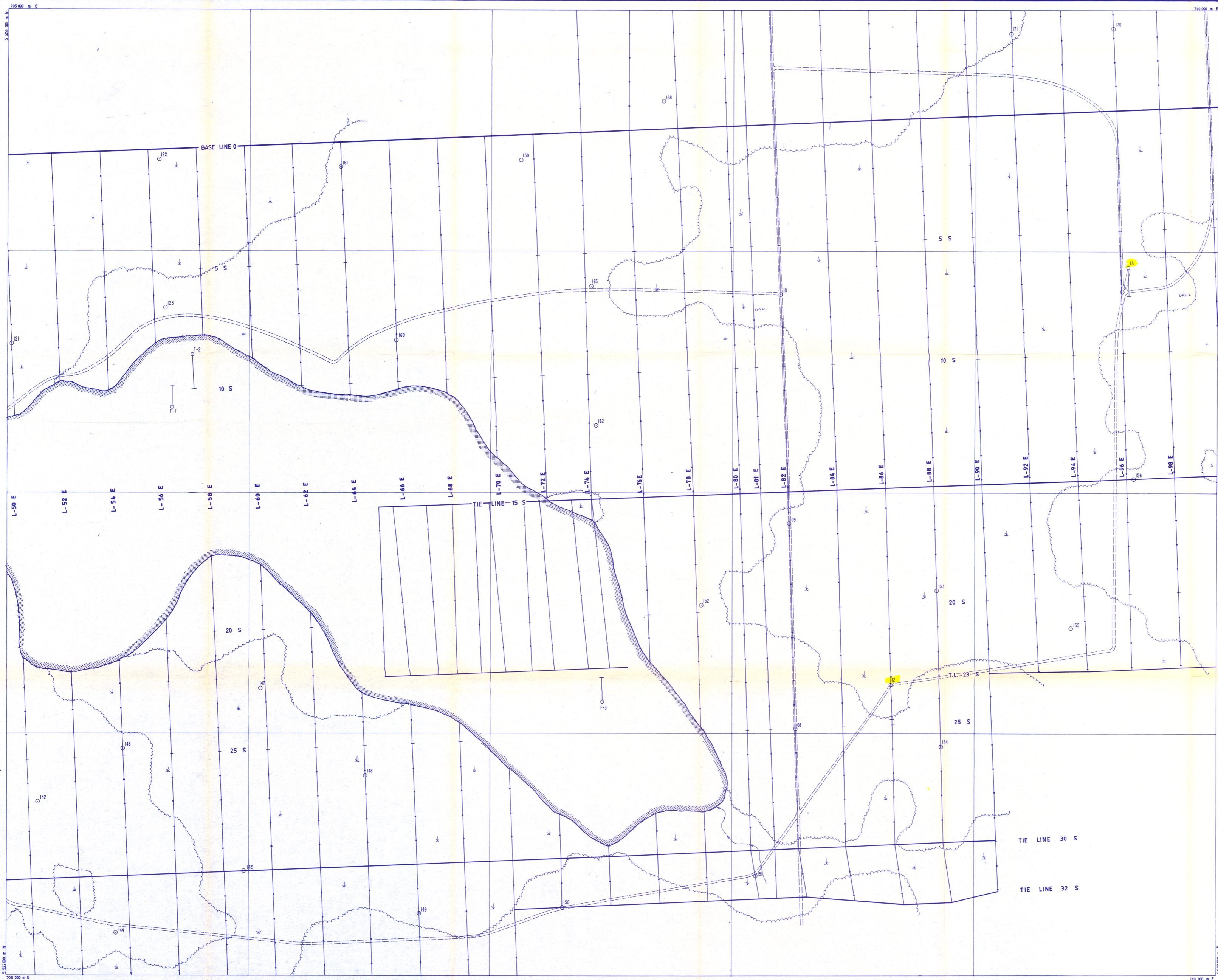

O Outcrop  
 ~ Creek  
 \* Swamp  
 = Highway  
 - Electric line  
 - Fence  
 - Access road

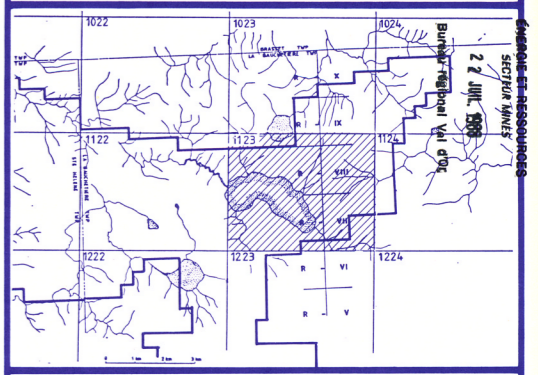

**noremco** **explorations noremco inc.**  
**LA GAUCHETIERE PROJECT N° 1434**  
 Ministère de l'Énergie et des Ressources  
 Service de la Géoinformation  
 Date: 18 JAN 1959  
 No G.M.: 17617  
**VAL D'OR GÉOPHYSIQUE**  
 EXECUTED BY: \_\_\_\_\_  
 DRAWN BY: \_\_\_\_\_  
 INTERPRETED BY: \_\_\_\_\_  
 APPROVED BY: \_\_\_\_\_  
 SCALE: 1:5000 MAP N°: \_\_\_\_\_

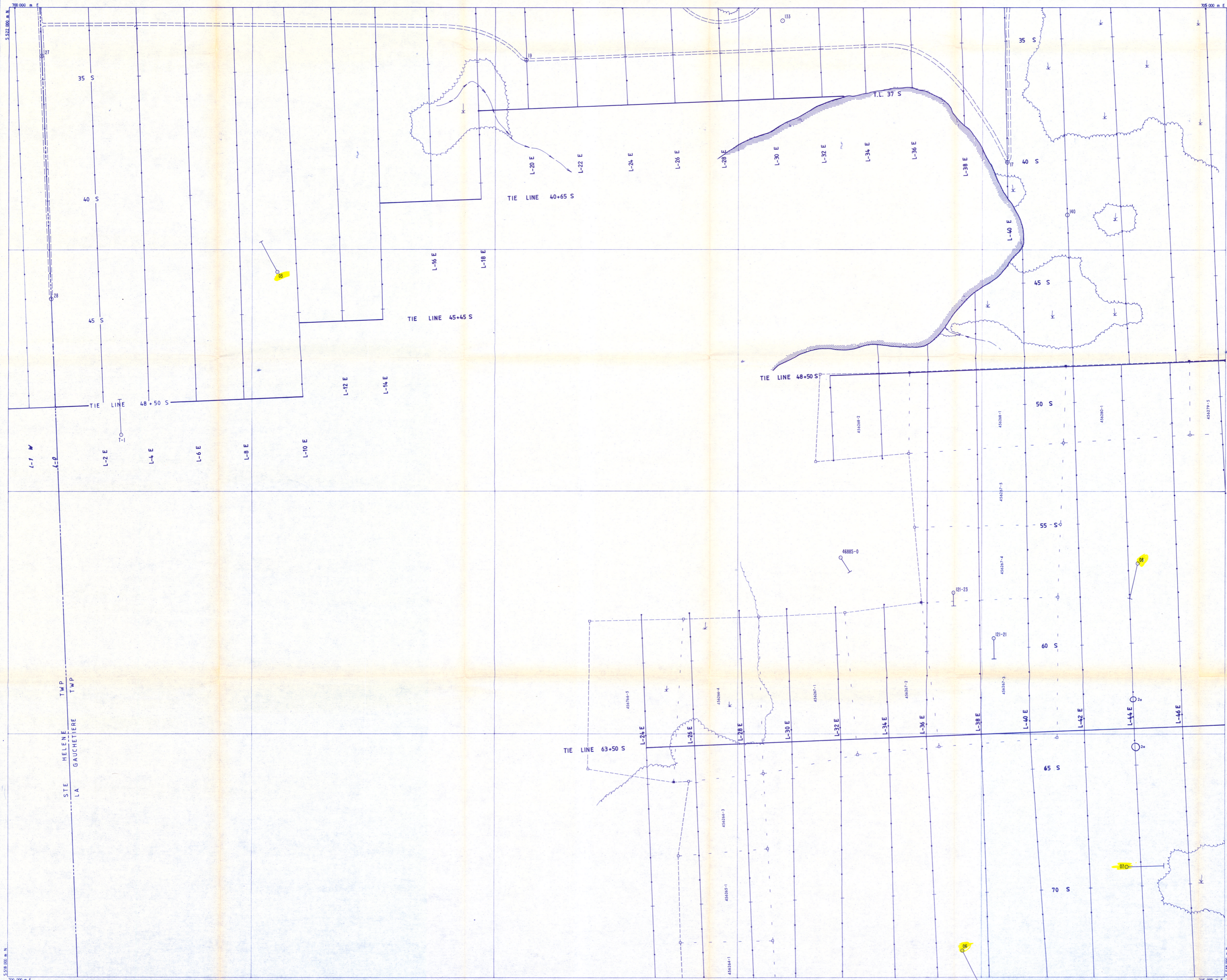

UTM  
astronomic  
magnetic

Outcrop  
 Creek  
 Swamp  
 Highway  
 Electric line  
 Fence  
 Access road

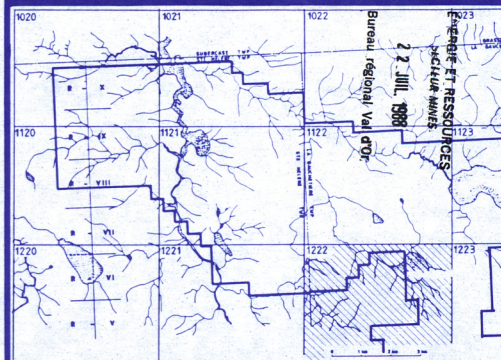

LA GAUCHETIERE PROJECT N°1434, STE HELENE PROJECT N°1433

Ministère de l'Énergie et des Ressources  
 Service de la Géoinformation  
 Date: 15 JAN 2005  
 No. C.M.: 17617

EXECUTED BY: \_\_\_\_\_ DATE: \_\_\_\_\_  
 DRAWN BY: \_\_\_\_\_  
 INTERPRETED BY: \_\_\_\_\_  
 APPROVED BY: \_\_\_\_\_

SCALE: 1:5000 MAP N°:

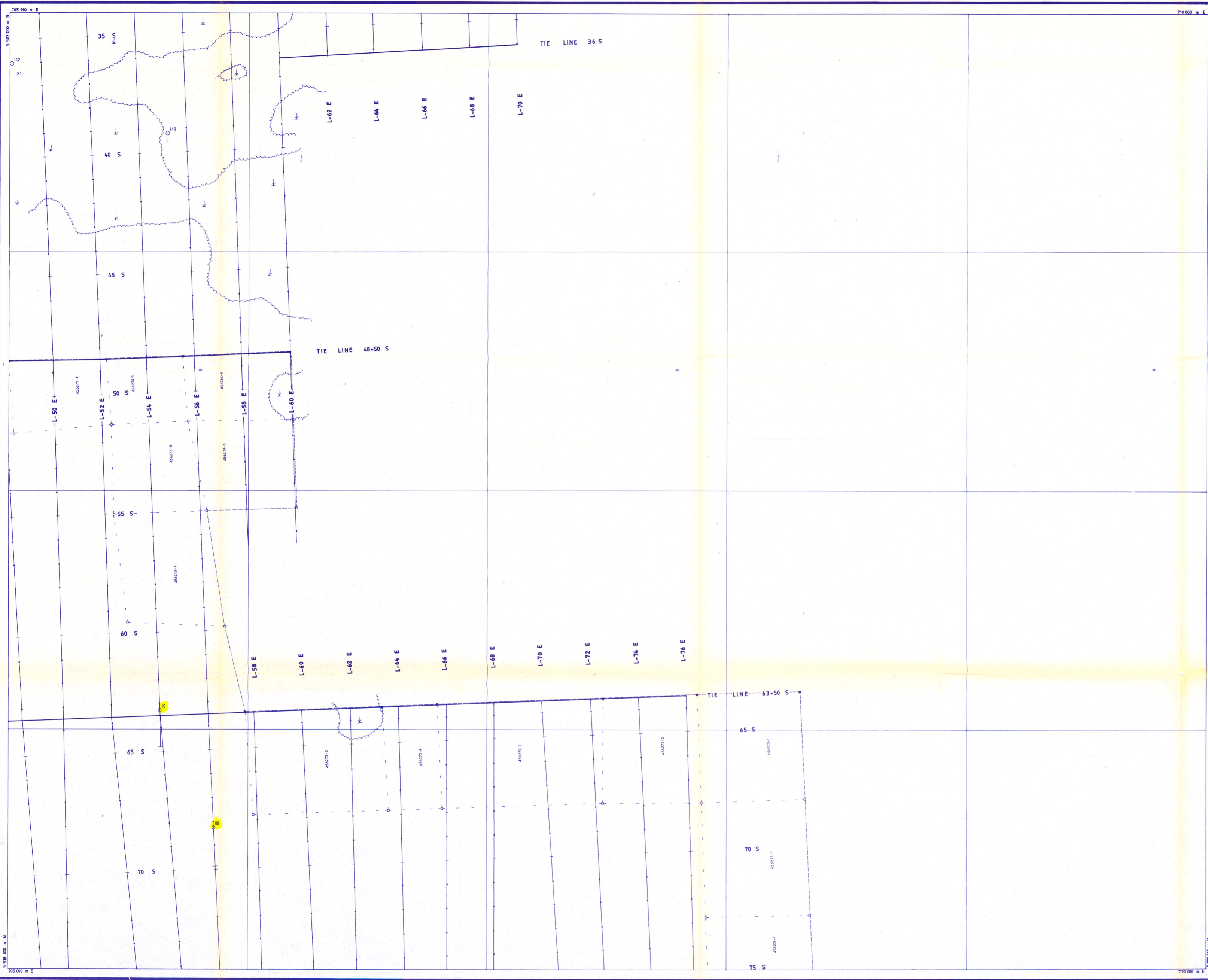

UTM

astronomic

magnetic

Legend:

- Outcrop
- Creek
- Swamp
- Highway
- Electric line
- Fence
- Access road

Exploitation minière  
Région du Nord  
Région de la Capitale  
Région de la Gaspésie  
Région de la Nouvelle-Écosse  
Région du Québec  
Région de l'Ontario  
Région du Manitoba  
Région du Saskatchewan  
Région de l'Alberta  
Région de la Colombie-Britannique  
Région du Yukon  
Région des Territoires du Nord-Ouest  
Région des Territoires du Nord-Est  
Région du Nunavut

**noremco** **explorations**

**explorations inc.** **noremco inc.**

LA GAUCHETIERE PROJECT N° 1434

Ministère de l'Énergie et des Ressources  
Service de la Géoinformation  
Date: 18 JAN 1988  
No G.M.: 17617

**VAL D'OR**  
**GÉOPHYSIQUE**

EXECUTED BY: \_\_\_\_\_ DATE: \_\_\_\_\_  
DRAWN BY: \_\_\_\_\_  
INTERPRETED BY: \_\_\_\_\_  
APPROVED BY: \_\_\_\_\_

SCALE: 1:5000      MAP N°: \_\_\_\_\_

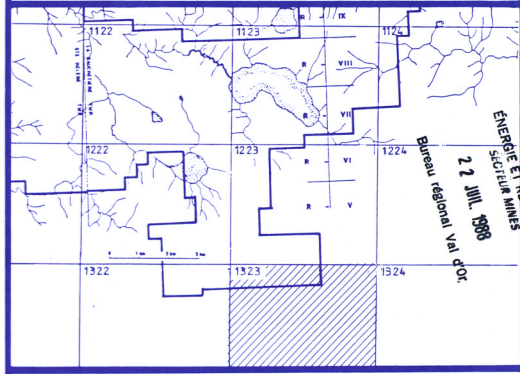
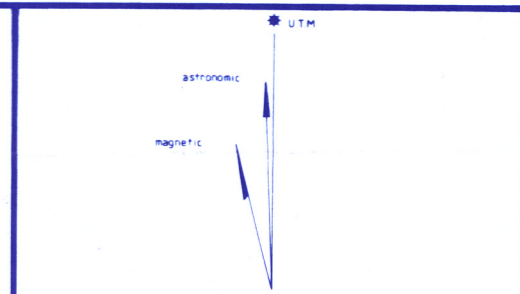
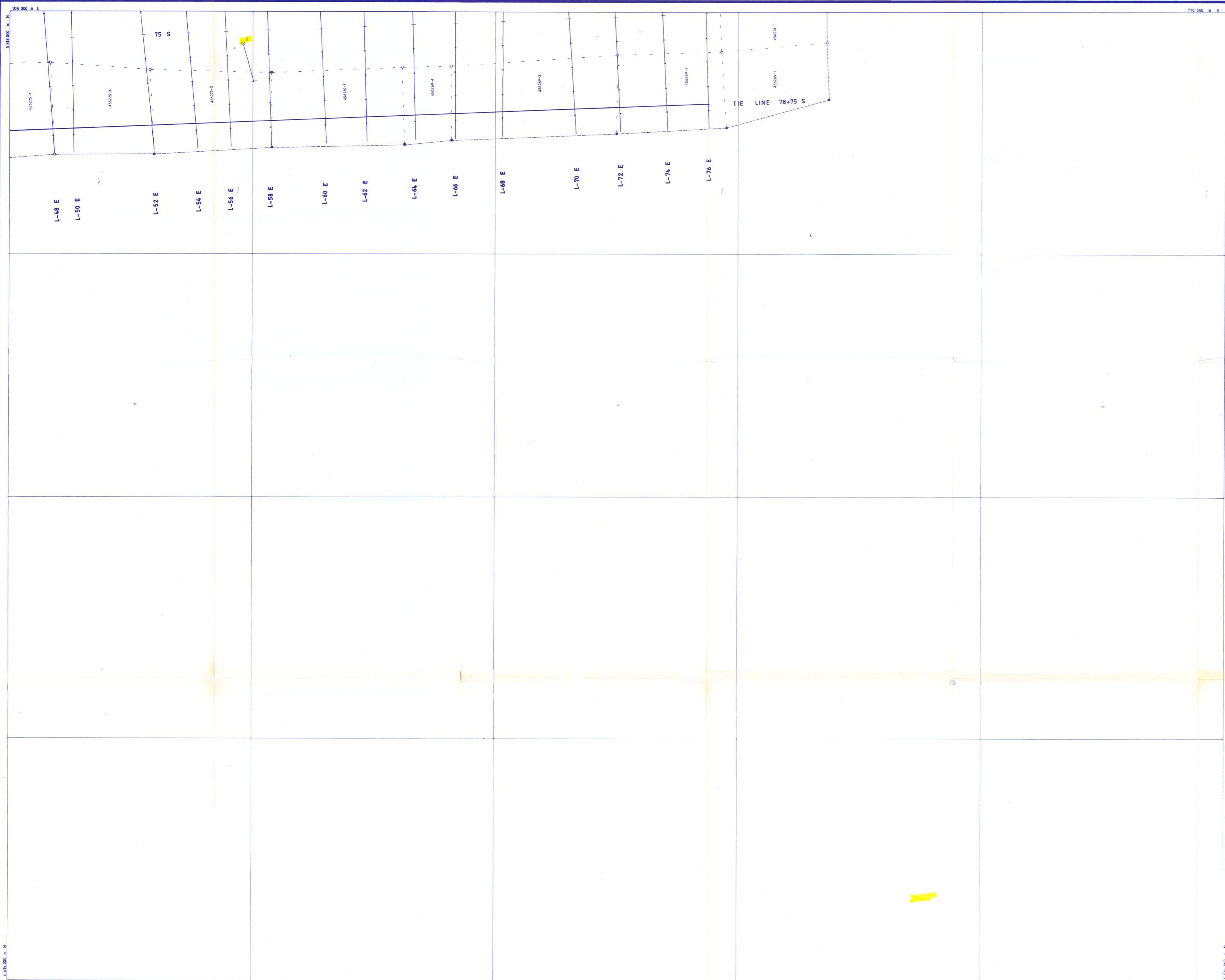



LA GAUCHETIERE PROJECT N° 1434

Ministère de l'Énergie et des Ressources  
 Service de la Géoinformation  
 Date: 27 Juin 1989  
 No. G.M.: 17617



EXECUTED BY: \_\_\_\_\_  
 DRAWN BY: \_\_\_\_\_  
 INTERPRETED BY: \_\_\_\_\_  
 APPROVED BY: \_\_\_\_\_

SCALE: 1:500      MAP N°: \_\_\_\_\_

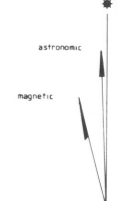
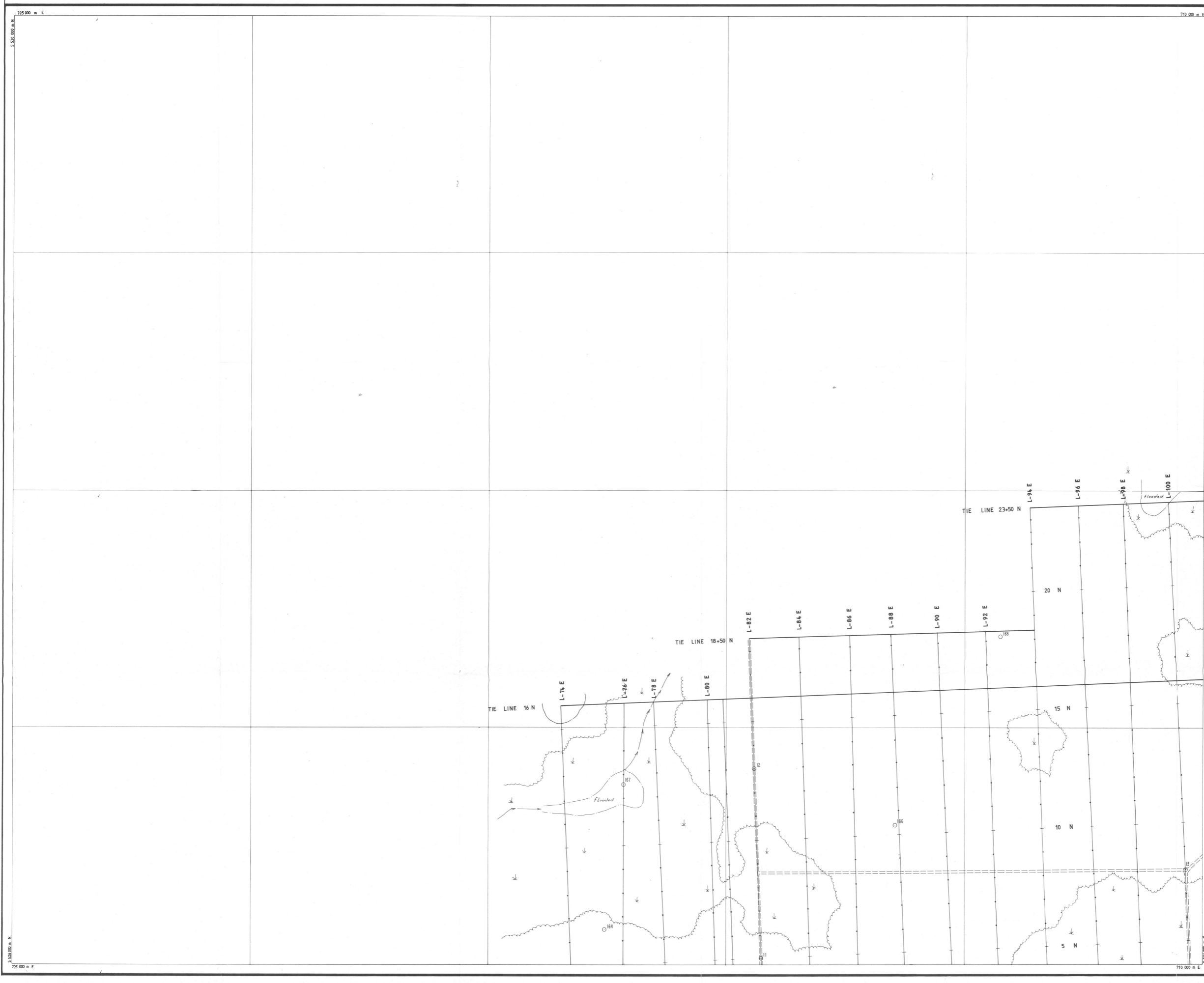

- Outcrop
- Creek
- Swamp
- Highway
- Electric line
- Fence
- Access road

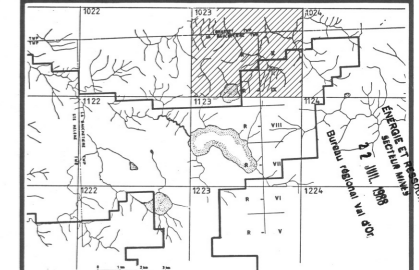

**noramco** **explorations**

LA GAUCHETIERE PROJECT N° 1434

Ministère de l'Énergie et des Ressources  
Service de la Géoinformation  
Date: 18 JAN 1990  
No G.M.: 17617

**VAL D'OR**  
**GÉOPHYSIQUE**

EXECUTED BY: \_\_\_\_\_ DATE: \_\_\_\_\_  
 DRAWN BY: \_\_\_\_\_  
 INTERPRETED BY: \_\_\_\_\_  
 APPROVED BY: \_\_\_\_\_

SCALE: 1:5000 MAP N°:

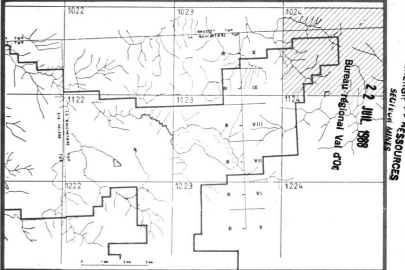
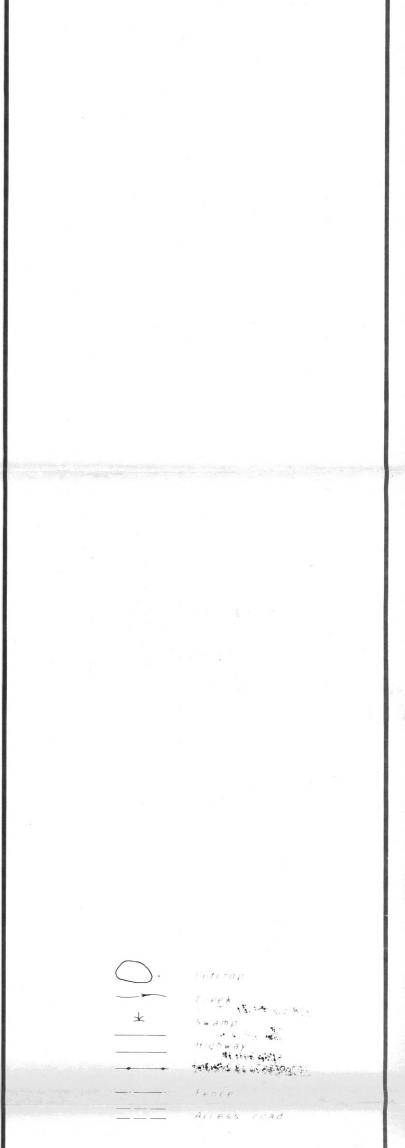
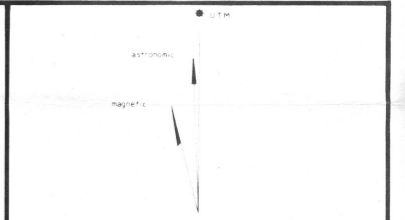
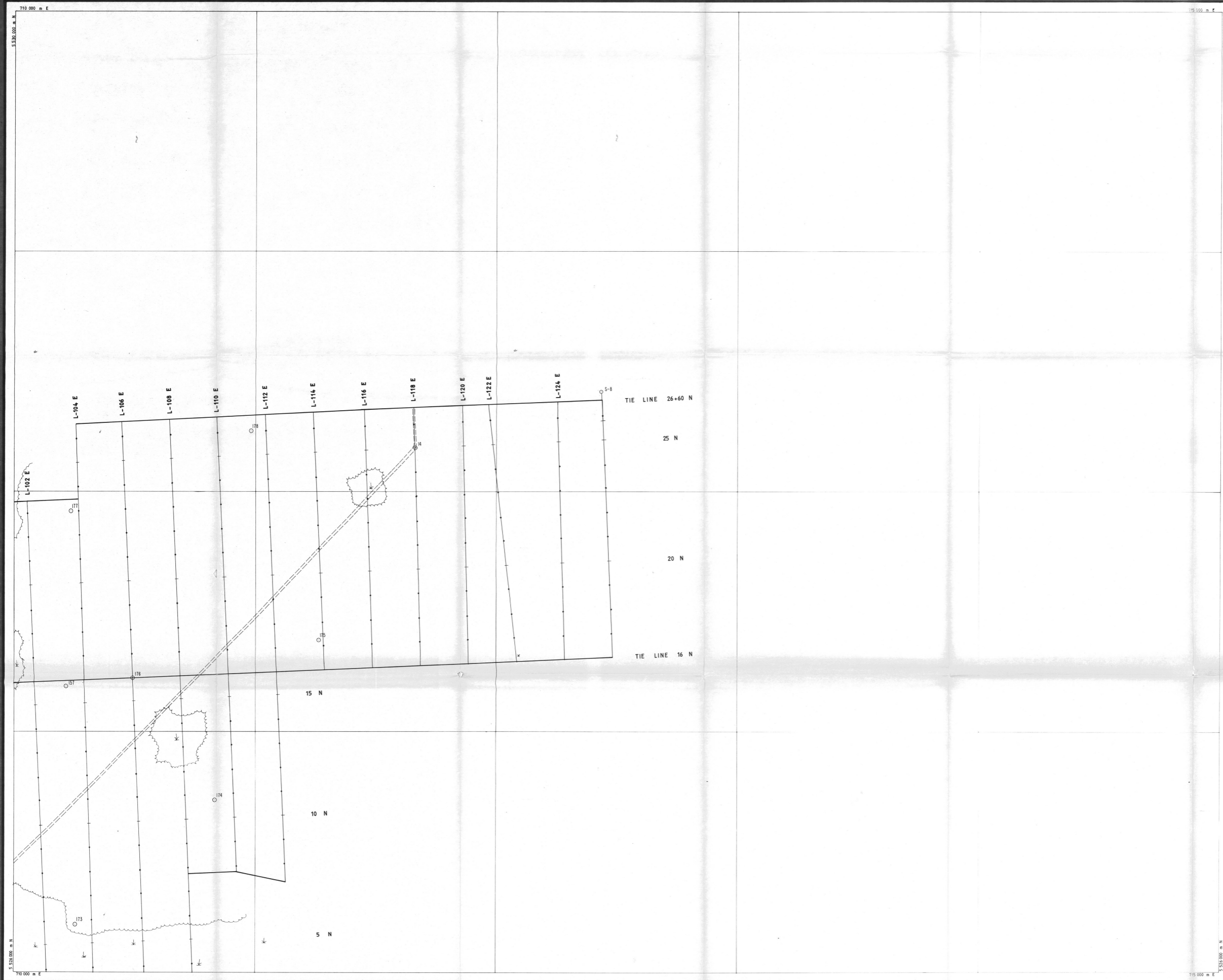

**noremco** **exploration** **services** **noremco inc.**  
 LA GAUCHETIERE PROJECT, N° 1634  
 Ministère de l'Énergie et des Ressources  
 Service de la Géoinformation  
 Date: 18 JAN 1992  
 No G.M.: 17617  
**VAL D'OR**  
**GÉOPHYSIQUE**  
 SCALE: 1:500 MAP N°

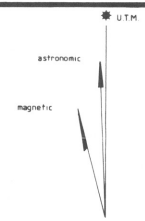
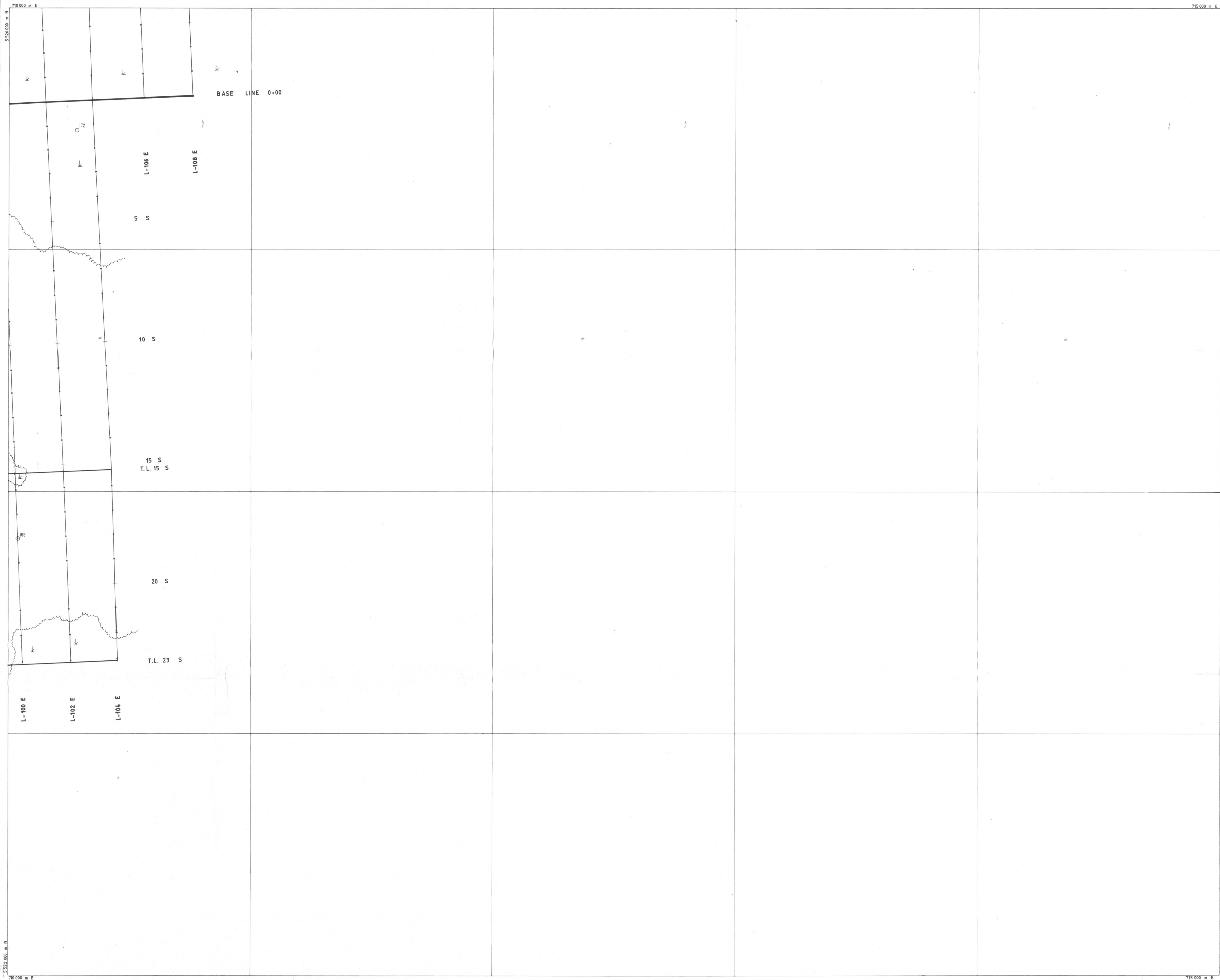

- Outcrop
- Creek
- Swamp
- Highway
- Electric line
- Fence
- Access road

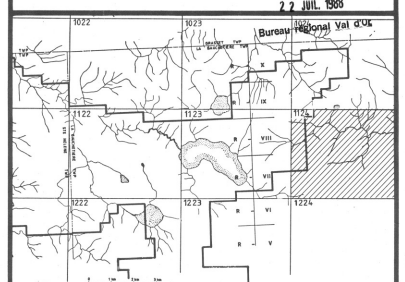

22 JUL 1988

**noramco** **explorations inc.**

LA GAUCHETIERE PROJECT N° 1434

Ministère de l'Énergie et des Ressources  
Service de la Géoinformation  
Date: 18 JAN 1989  
No. G.M.: 17617

**VAL D'OR**  
**GÉOPHYSIQUE**

EXECUTED BY _____	DATE _____
DRAWN BY _____	_____
INTERPRETED BY _____	_____
APPROVED BY _____	_____

SCALE : 1:5000      MAP N° :



H-1434-001

ELEVATION: Surface

AZIMUTH: 242 degrees

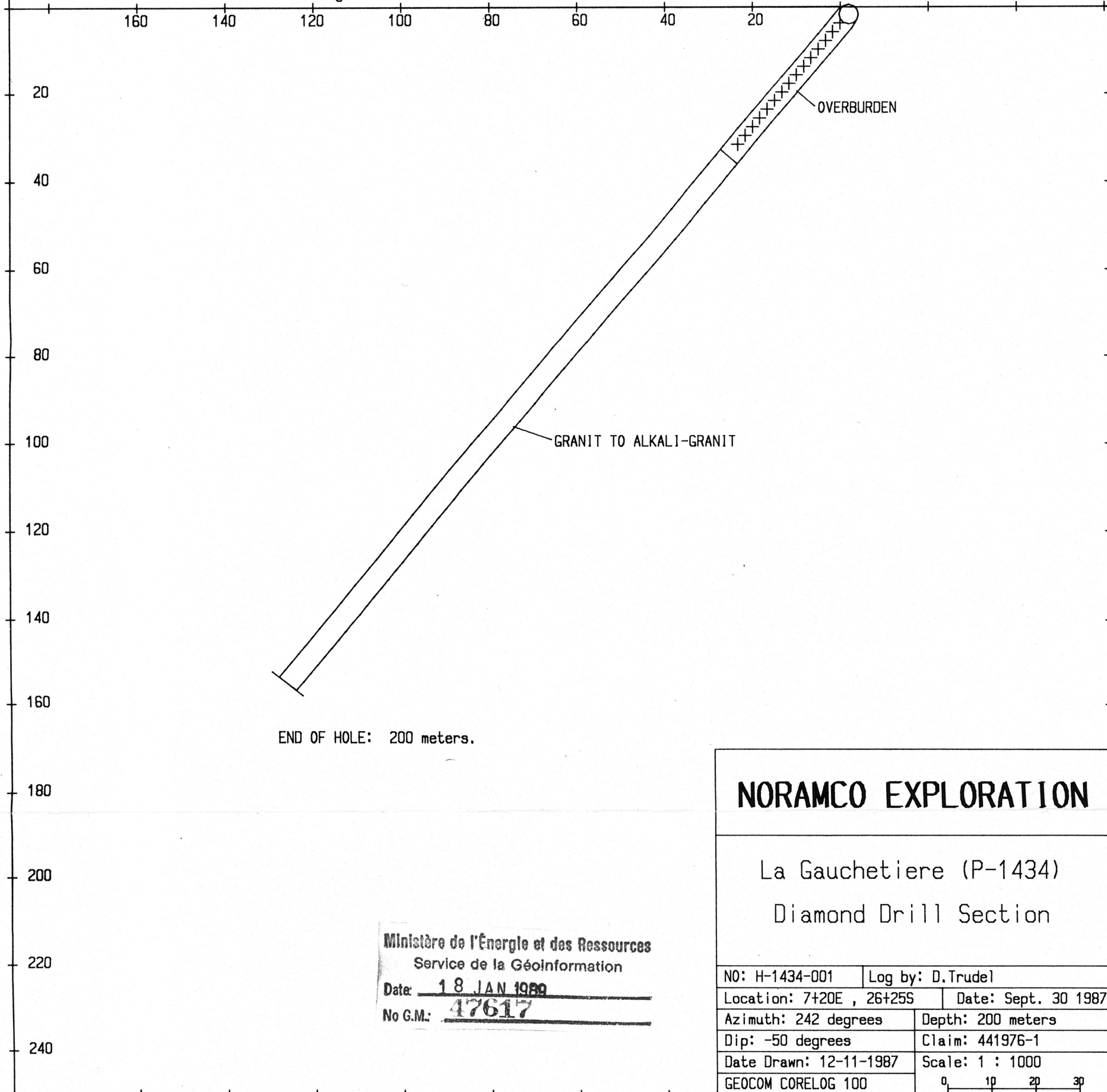

END OF HOLE: 200 meters.

## NORAMCO EXPLORATION

La Gauchetiere (P-1434)  
Diamond Drill Section

Ministère de l'Énergie et des Ressources  
Service de la Géoinformation

Date: 18 JAN 1989

No G.M.: 47617

NO: H-1434-001	Log by: D.Trudel
Location: 7+20E , 26+25S	Date: Sept. 30 1987
Azimuth: 242 degrees	Depth: 200 meters
Dip: -50 degrees	Claim: 441976-1
Date Drawn: 12-11-1987	Scale: 1 : 1000
GEOCOM CORELOG 100	0 10 20 30

H-1434-002

ELEVATION: Surface

AZIMUTH: 360 degrees

160

140

120

100

80

60

40

20

20

40

60

80

100

120

140

160

180

200

220

240

OVERBURDEN

K FELDSPAR GRANITE

END OF HOLE: 199 meters.

# NORAMCO EXPLORATION

La Gauchetiere (P-1434)  
Diamond Drill Section

Ministère de l'Énergie et des Ressources  
Service de la Géoinformation

Date: 18 JAN 1989

No G.M.: 47617

NO: H-1434-002		Log by: Alain Chevalier	
Location: 29+80E , 7+85S		Date: Oct. 01 1987	
Azimuth: 360 degrees		Depth: 199 meters	
Dip: -50 degrees		Claim: 442010-5	
Date Drawn: 12-11-1987		Scale: 1 : 1000	
GEOCOM CORELOG 100		0 1p 2p 3p	

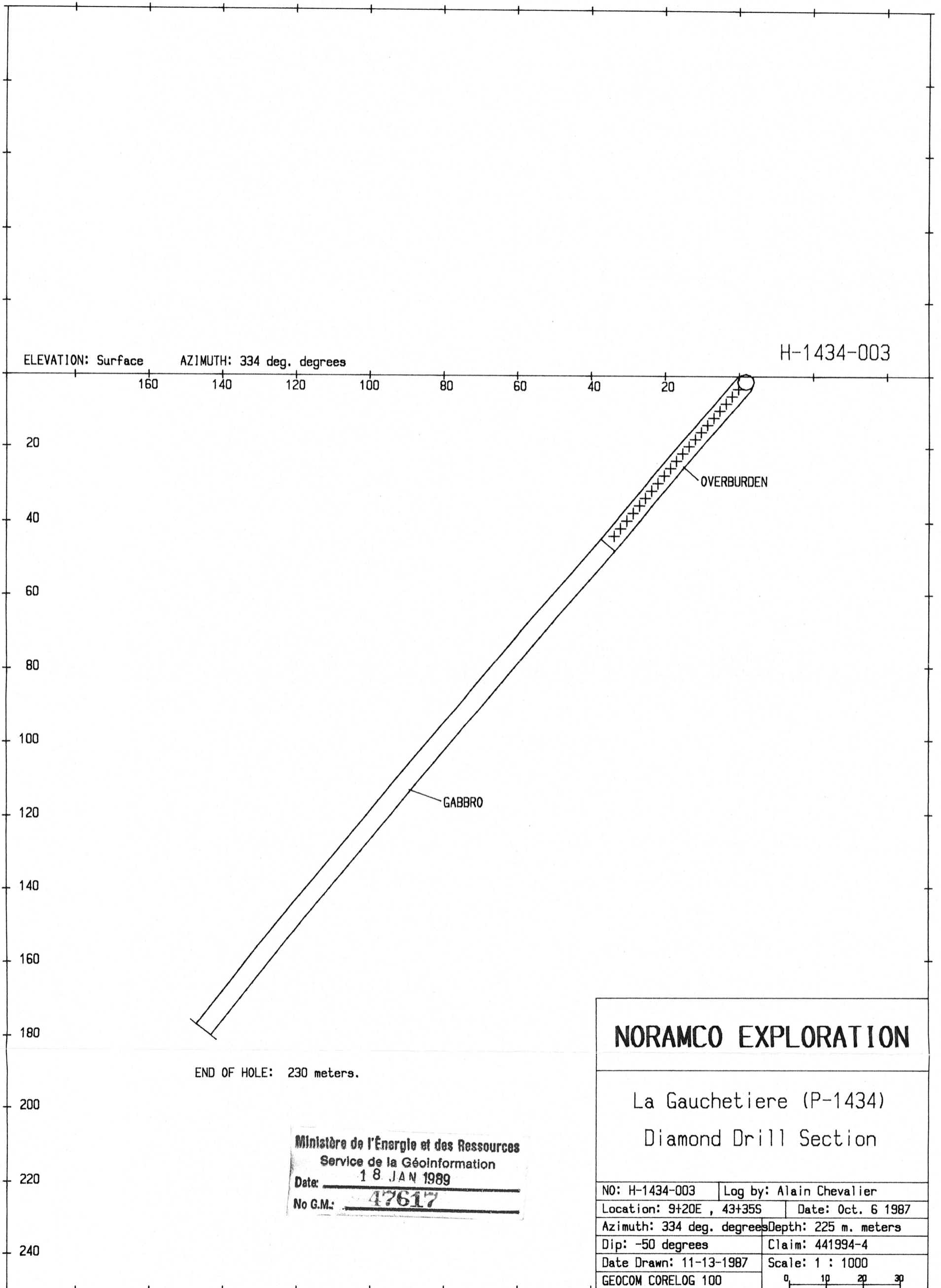

# NORAMCO EXPLORATION

La Gauchetiere (P-1434)  
Diamond Drill Section

Ministère de l'Énergie et des Ressources  
Service de la Géoinformation  
Date: 18 JAN 1989  
No G.M.: 47617

NO: H-1434-003	Log by: Alain Chevalier
Location: 9+20E , 43+35S	Date: Oct. 6 1987
Azimuth: 334 deg. degrees	Depth: 225 m. meters
Dip: -50 degrees	Claim: 441994-4
Date Drawn: 11-13-1987	Scale: 1 : 1000
GEOCOM CORELOG 100	0 10 20 30

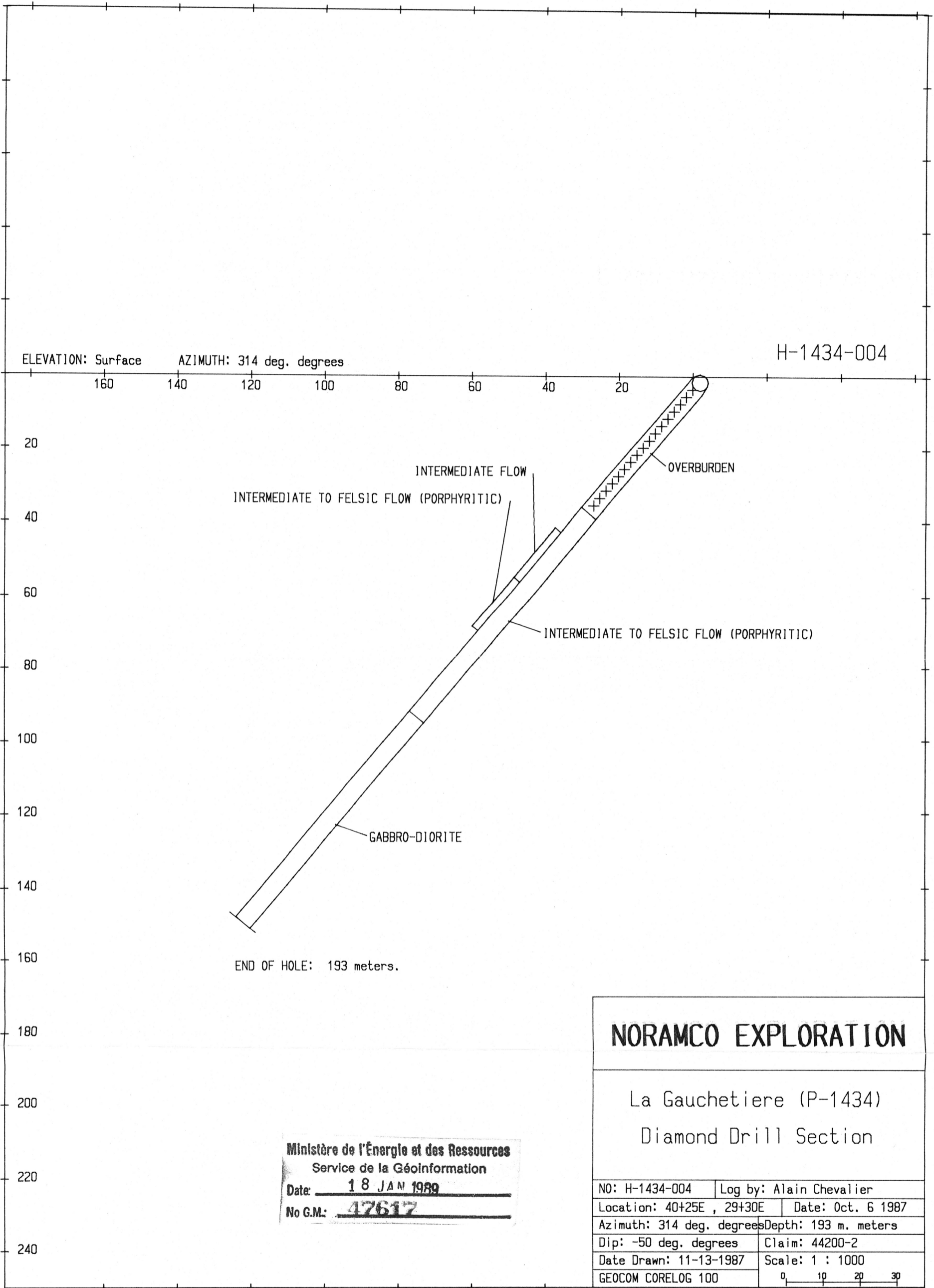

## NORAMCO EXPLORATION

La Gauchetiere (P-1434)  
Diamond Drill Section

Ministère de l'Énergie et des Ressources  
Service de la Géoinformation  
Date: 18 JAN 1989  
No G.M.: 47617

NO: H-1434-004	Log by: Alain Chevalier
Location: 40+25E, 29+30E	Date: Oct. 6 1987
Azimuth: 314 deg. degrees	Depth: 193 m. meters
Dip: -50 deg. degrees	Claim: 44200-2
Date Drawn: 11-13-1987	Scale: 1 : 1000
GEOCOM CORELOG 100	0 10 20 30

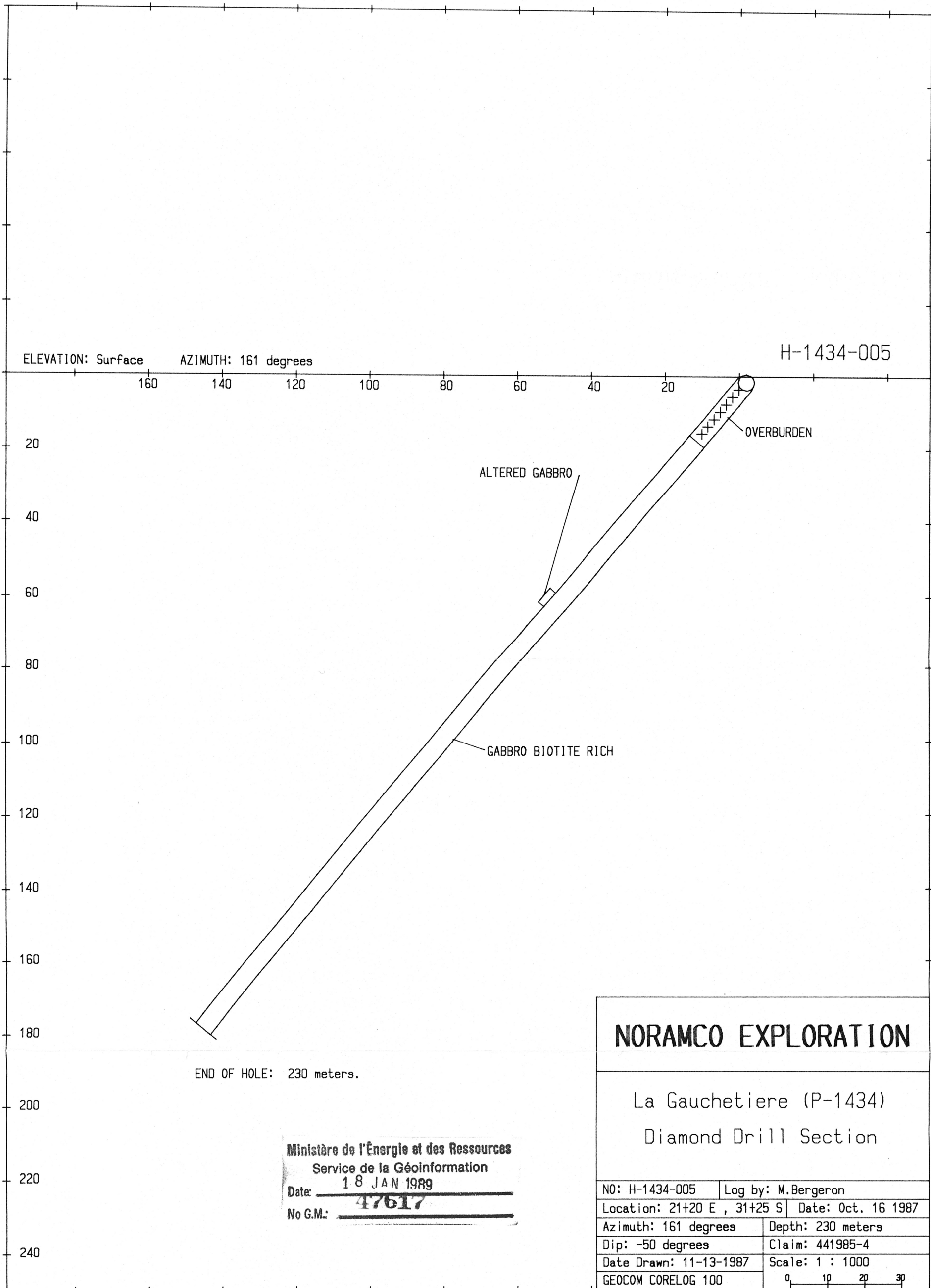

ELEVATION: Surface

AZIMUTH: 161 degrees

H-1434-005

160

140

120

100

80

60

40

20

20

40

60

80

100

120

140

160

180

200

220

240

OVERBURDEN

ALTERED GABBRO

GABBRO BIOTITE RICH

END OF HOLE: 230 meters.

## NORAMCO EXPLORATION

La Gauchetiere (P-1434)  
Diamond Drill Section

Ministère de l'Énergie et des Ressources  
Service de la Géoinformation

Date: 18 JAN 1989

No G.M.: 47617

NO: H-1434-005 | Log by: M. Bergeron

Location: 21+20 E , 31+25 S | Date: Oct. 16 1987

Azimuth: 161 degrees | Depth: 230 meters

Dip: -50 degrees | Claim: 441985-4

Date Drawn: 11-13-1987 | Scale: 1 : 1000

GEOCOM CORELOG 100

0 10 20 30

H-1434-006

ELEVATION: Surface AZIMUTH: 155 degrees

160 140 120 100 80 60 40 20

20

40

60

80

100

120

140

160

180

200

220

240

OVERBURDEN

WACKE+ARGILITE

WACKE+ARGILITE

WACKE

WACKE (MAFIC FLOW SCHISTOSED?)

WACKE

END OF HOLE: 218 meters.

# NORAMCO EXPLORATION

La Gauchetiere (P-1434)  
Diamond Drill Section

Ministère de l'Énergie et des Ressources  
Service de la Géoinformation

Date: 18 JAN 1989

No G.M.: 47617

NO: H-1434-006 | Log by: M. Bergeron

Location: 37+00 E, 72+35 S | Date: Oct. 17 1987

Azimuth: 155 degrees | Depth: 218 meters

Dip: -50 degrees | Claim: 456264-4

Date Drawn: 12-11-1987 | Scale: 1 : 1000

GEOCOM CORELOG 100 | 0 10 20 30

H-1434-007

ELEVATION: Surface

AZIMUTH: 90 degrees

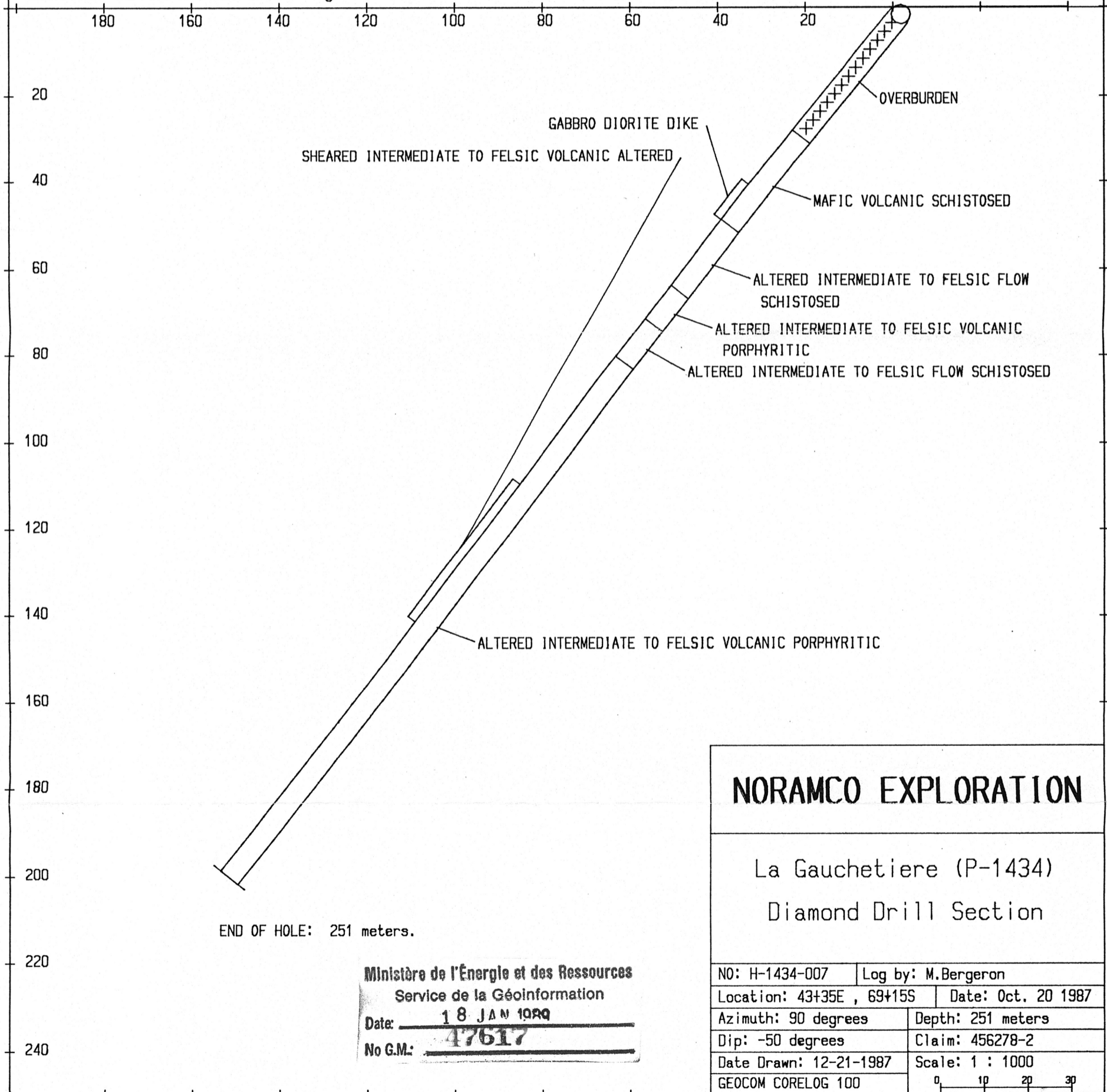

END OF HOLE: 251 meters.

### NORAMCO EXPLORATION

La Gauchetiere (P-1434)  
Diamond Drill Section

Ministère de l'Énergie et des Ressources  
 Service de la Géoinformation  
 Date: 18 JAN 1989  
 No G.M.: 47617

NO: H-1434-007		Log by: M. Bergeron	
Location: 43+35E , 69+15S		Date: Oct. 20 1987	
Azimuth: 90 degrees		Depth: 251 meters	
Dip: -50 degrees		Claim: 456278-2	
Date Drawn: 12-21-1987		Scale: 1 : 1000	
GEOCOM CORELOG 100		0 10 20 30	

ELEVATION: Surface AZIMUTH: 195 degrees

H-1434-008

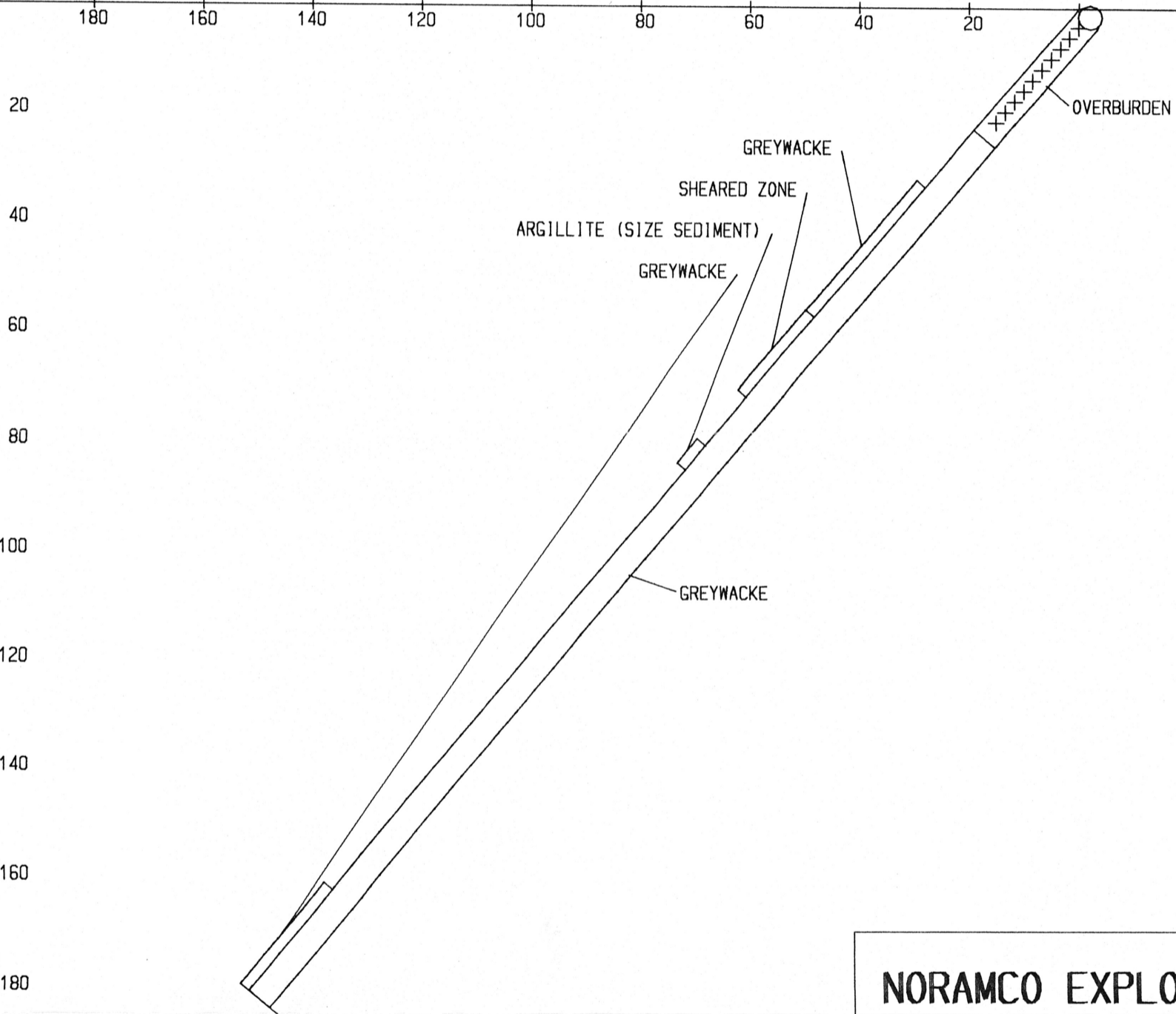

END OF HOLE: 236 meters.

Ministère de l'Énergie et des Ressources  
Service de la Géoinformation  
Date: 18 JAN 1989  
No G.M.: 47617

## NORAMCO EXPLORATION

La Gauchetière (P-1434)  
Diamond Drill Section

NO: H-1434-008	Log by: Alain Chevalier
Location: 44+35E, 56+75S	Date: Oct. 21, 1987
Azimuth: 195 degrees	Depth: 236 meters
Dip: -50 degrees	Claim:
Date Drawn: 11-13-1987	Scale: 1 : 1000
GEOCOM CORELOG 100	0 10 20 30



H-1434-009

ELEVATION: Surface

AZIMUTH: 180 degrees

180 160 140 120 100 80 60 40 20

20

40

60

80

100

120

140

160

180

200

220

240

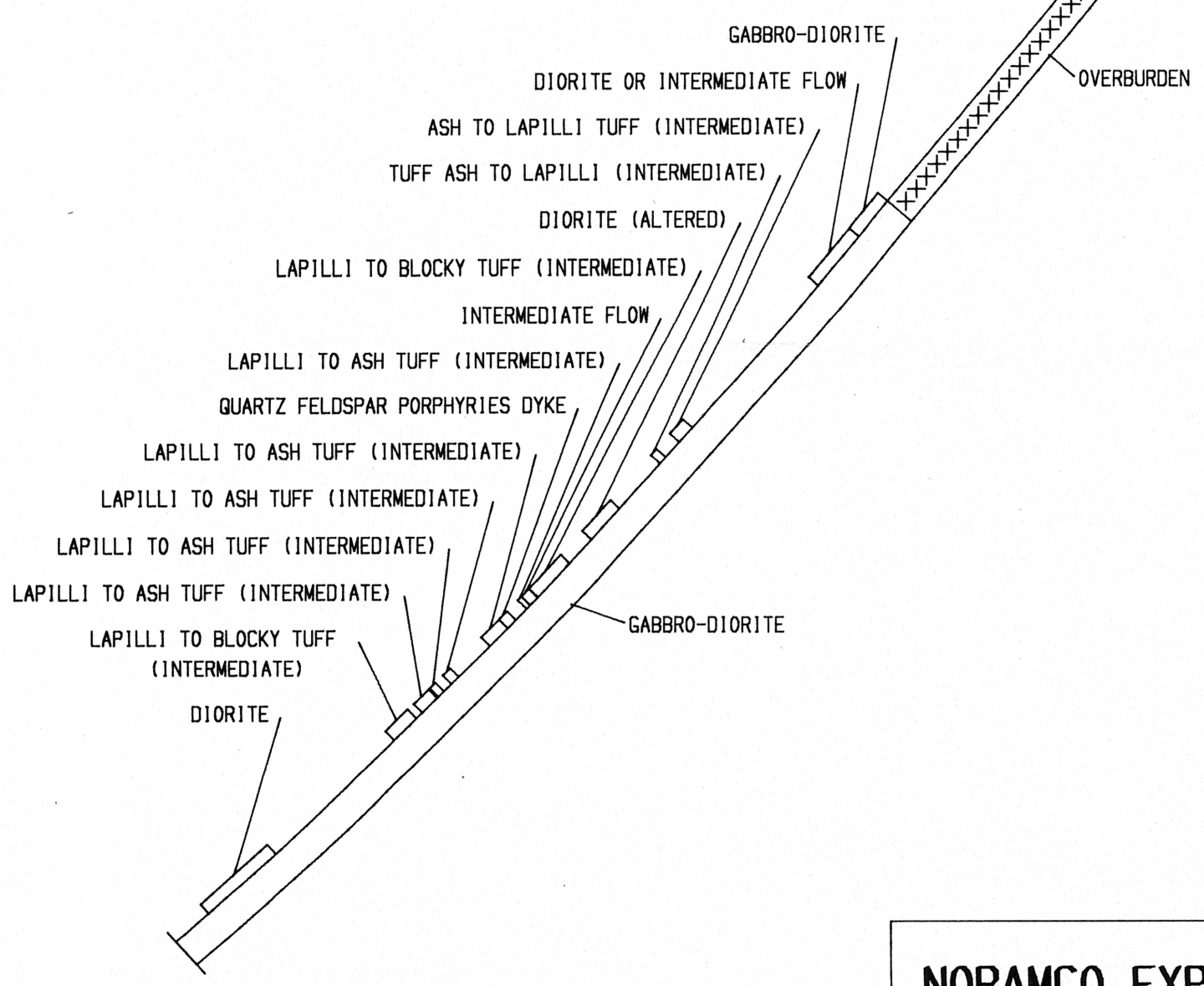

END OF HOLE: 236 meters.

# NORAMCO EXPLORATION

La Gauchetiere (P-1434)  
Diamond Drill Section

Ministère de l'Énergie et des Ressources  
Service de la Géoinformation

Date: 18 JAN 1989  
No G.M.: 47617

NO: H-1434-009		Log by: Alain Chevalier	
Location: 56+00E, 68+25S		Date: Sept. 23 1987	
Azimuth: 180 degrees		Depth: 236 meters	
Dip: -50 degrees		Claim: 456273-1	
Date Drawn: 12-11-1987		Scale: 1 : 1000	
GEOCOM CORELOG 100		0 10 20 30	

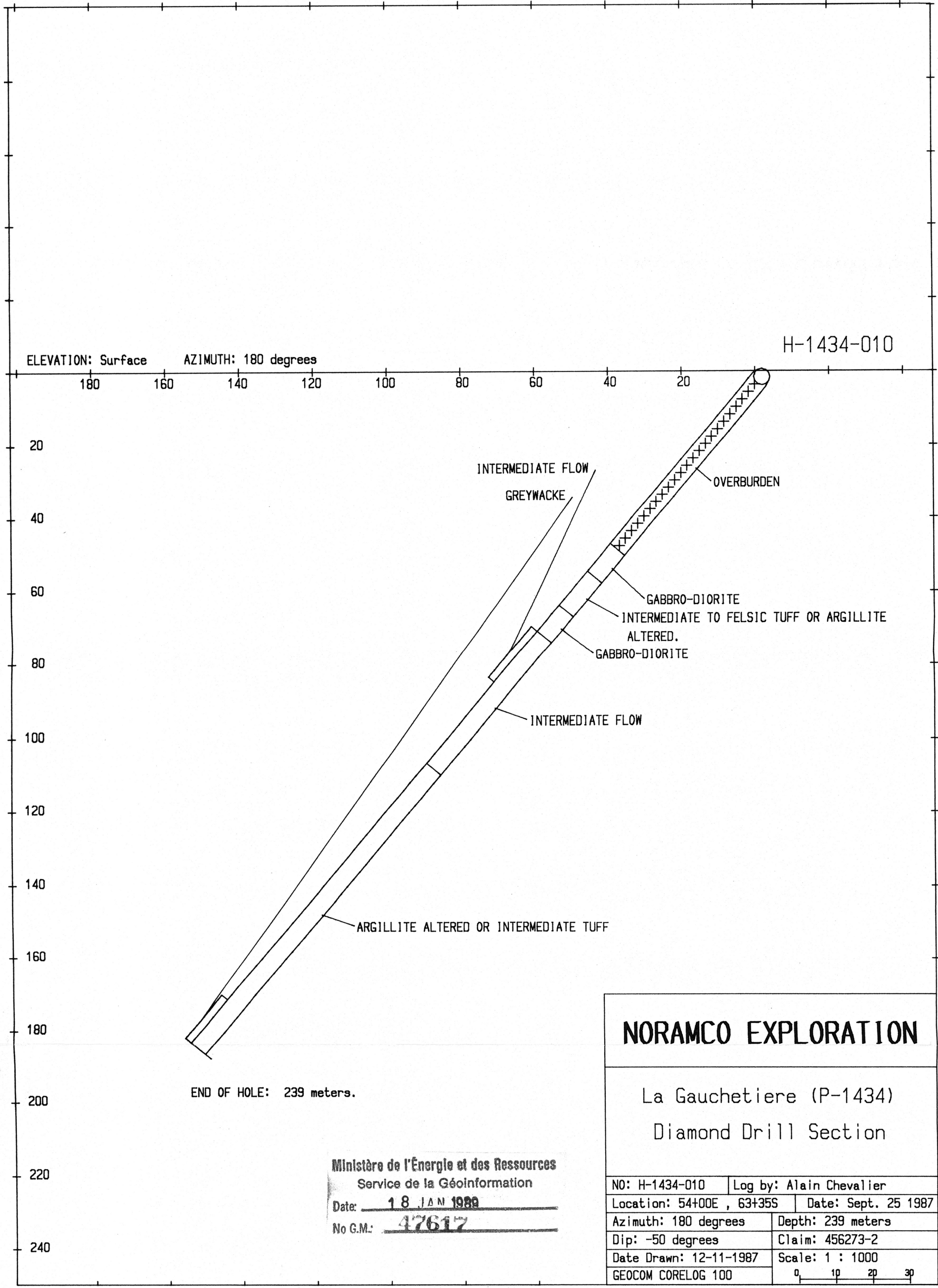

H-1434-010

ELEVATION: Surface

AZIMUTH: 180 degrees

INTERMEDIATE FLOW  
GREYWACKE

OVERBURDEN

GABBRO-DIORITE  
INTERMEDIATE TO FELSIC TUFF OR ARGILLITE  
ALTERED.  
GABBRO-DIORITE

INTERMEDIATE FLOW

ARGILLITE ALTERED OR INTERMEDIATE TUFF

END OF HOLE: 239 meters.

## NORAMCO EXPLORATION

La Gauchetiere (P-1434)  
Diamond Drill Section

Ministère de l'Énergie et des Ressources  
Service de la Géoinformation  
Date: 18 JAN 1989  
No G.M.: 47617

NO: H-1434-010	Log by: Alain Chevalier
Location: 54+00E , 63+35S	Date: Sept. 25 1987
Azimuth: 180 degrees	Depth: 239 meters
Dip: -50 degrees	Claim: 456273-2
Date Drawn: 12-11-1987	Scale: 1 : 1000
GEOCOM CORELOG 100	0 10 20 30

H-1434-011

ELEVATION: Surface

AZIMUTH: 165 degrees

180

160

140

120

100

80

60

40

20

20

40

60

80

100

120

140

160

180

200

220

240

OVERBURDEN

INTERMEDIATE TO MAFIC (ANDESITE)FLOW BRECCIA

INTERMEDIATE TO FELSIC(DACITE)MASSIVE VOLCANIC.

GABBRO

INTERMEDIATE TO MAFIC MASSIVE VOLCANIC(ANDESITE)

INTERMEDIATE TO MAFIC VOLCANIC (ANDESITE) PORPHYRITIC.

PORPHYRITIC GABBRO OR(PORPHYRITIC INTERMEDIATE FLOW)

INTERMEDIATE TO MAFIC FLOW BRECCIA

INTERMEDIATE TO MAFIC VOLCANIC(ANDESITE)MASSIVE

END OF HOLE: 240 meters.

# NORAMCO EXPLORATION

La Gauchetiere (P-1434)  
Diamond Drill Section

Ministère de l'Énergie et des Ressources  
Service de la Géoinformation

Date: 18 JAN 1988

No G.M.: 47617

NO: H-1434-011		Log by: M. Bergeron	
Location: 56+70 E , 75+50 S		Date: Sept. 26 1987	
Azimuth: 165 degrees		Depth: 240 meters	
Dip: -50 degrees		Claim: 456275-2	
Date Drawn: 12-11-1987		Scale: 1 : 1000	
GEOCOM CORELOG 100		0 10 20 30	

H-1434-012

ELEVATION: Surface

AZIMUTH: 180 degrees

160

140

120

100

80

60

40

20

20

40

60

80

100

120

140

160

180

200

220

240

INTERMEDIATE FLOW (PORPHYRITIC)

OVERBURDEN

INTERMEDIATE FLOW (PORPHYRITIC)

INTERMEDIATE FLOW (PORPHYRITIC)

RHYOLITE TO RHYOLITIC FLOW

END OF HOLE: 216.33 meters.

## NORAMCO EXPLORATION

La Gauchetiere (P-1434)

Diamond Drill Section

Ministère de l'Énergie et des Ressources  
Service de la Géoinformation

Date: 18 JAN 1989

No G.M.: 47617

NO: H-1434-012 | Log by: Alain Chevalier

Location: 86+00E, 23+35S | Date: Jan. 29 1988

Azimuth: 180 degrees | Depth: 216.33 meters

Dip: -50 degrees | Claim: 442014-4

Date Drawn: 02-18-1988 | Scale: 1 : 1000

GEOCOM CORELOG 100

0 10 20 30

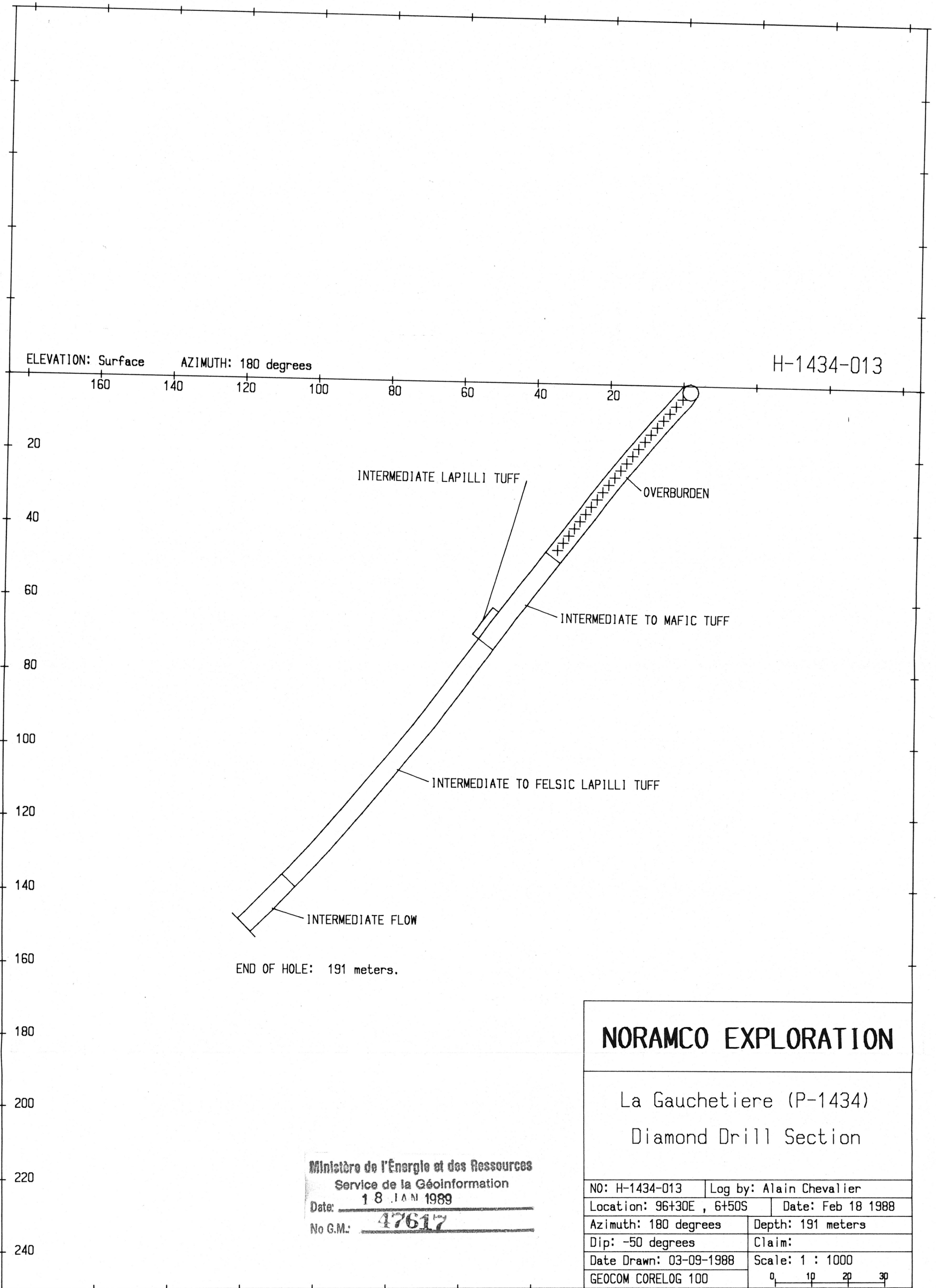

## NORAMCO EXPLORATION

La Gauchetiere (P-1434)  
Diamond Drill Section

Ministère de l'Énergie et des Ressources  
Service de la Géoinformation  
Date: 18 JAN 1989  
No G.M.: 47617

NO: H-1434-013	Log by: Alain Chevalier
Location: 96+30E, 6+50S	Date: Feb 18 1988
Azimuth: 180 degrees	Depth: 191 meters
Dip: -50 degrees	Claim:
Date Drawn: 03-09-1988	Scale: 1 : 1000
GEOCOM CORELOG 100	0    10    20    30