

FALCONBRIDGE LTD/LTÉE
 LAC SHORTT AREA
 GAND, LA RONCIÈRE TWPS.

Sheet: 701 1 of 2
 Date: 1988
 Scale: 1:10000
 Drawn by: [Signature]

ODM LEGEND
 Bedrock Lithology

PROTEROZOIC
 6 Diabase

ARCHEAN
 5 Lamprophyre
 4 Pyroclastics

4a Intermediate
 4b Felsic

3 Intermediate volcanics
 2 Gabbro
 1 Mafic volcanics

Symbols
 01 4a Reverse circulation drill hole No. LS-87-01 with bedrock intersection of Unit 4a and 3 percent Fe/Mg carbonate confirmed by reverse-circulation drilling
 Major lithologic contact identified or confirmed by reverse-circulation drilling
 Fault identified by reverse-circulation drilling
 Percent Fe/Mg carbonate; contours at 1, 5, 10, 15 and 20 percent
 Bedrock gold anomaly (<10 ppb)
 Shearing present in bedrock
 Hematite staining present in bedrock
 Inferred continuation of axis of Esturgeon Syncline
 Shear zone

Ministère de l'Énergie et des Ressources
 Service de la Géoinformation
 Date: 2.5.1988
 No. G.M.: 45894

FALCONBRIDGE LTÉE
 PN-020 PROPERTY
 GAND AND LA RONCIÈRE TWPS
 Plan 1
 BEDROCK GEOLOGY AND ALTERATION

20 AVR 1988
 ÉNERGIE ET RESSOURCES REÇU
 SERVICE GÉOLOGIQUE DU QUÉBEC
 SOUTIEN-NORAND

BY OVERBURDEN DRILLING MANAGEMENT LIMITED MARCH 1988
 SCALE 1:10,000

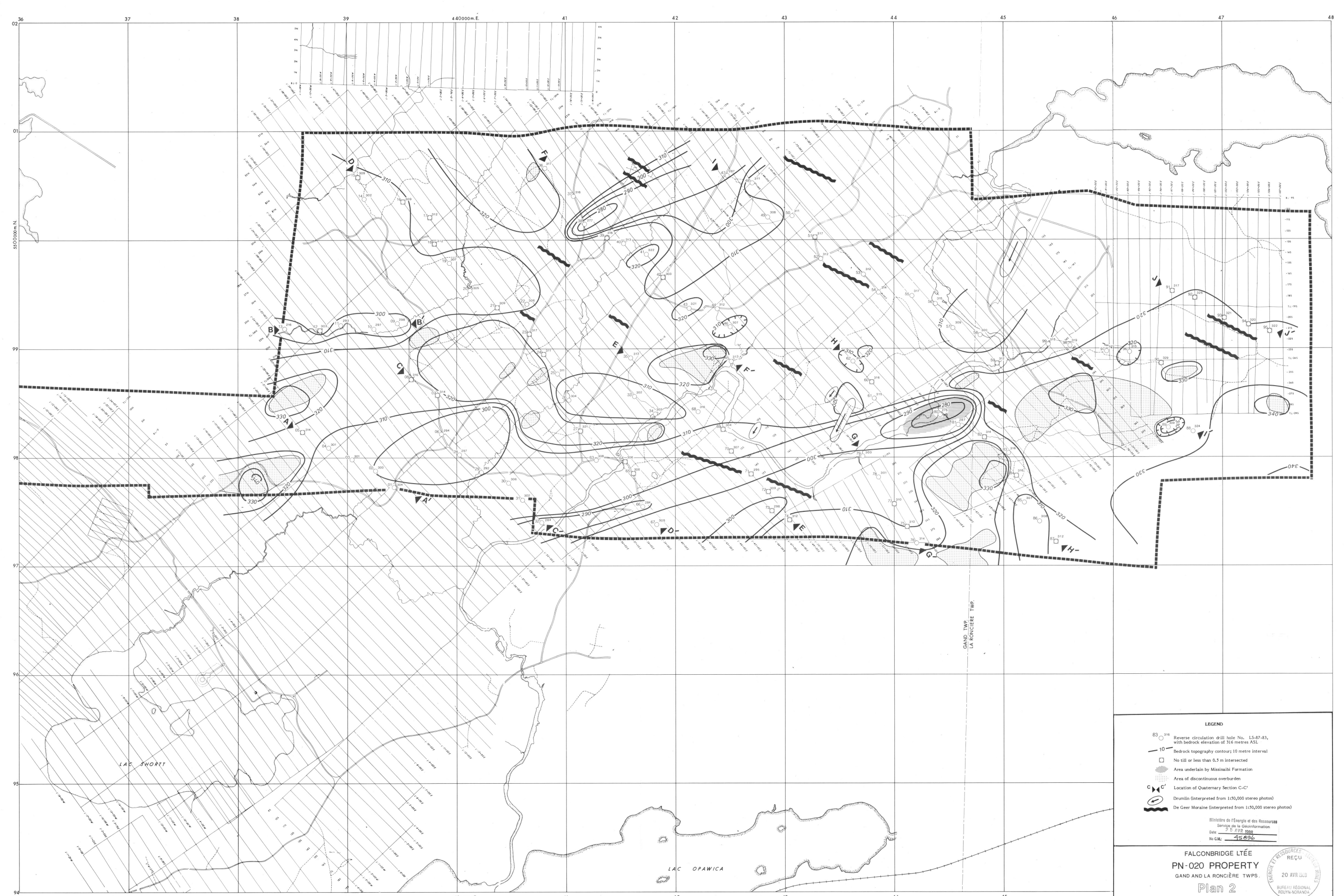

LEGEND

- 83-316 Reverse circulation drill hole No. LS-87-83, with bedrock elevation of 316 metres ASL
- 10 Bedrock topography contour; 10 metre interval
- No till or less than 0.3 m intersected
- ▨ Area underlain by Missisquoi Formation
- ▩ Area of discontinuous overburden
- C-C' Location of Quaternary Section C-C'
- Drumlin (interpreted from 1:50,000 stereo photos)
- ⊖ De Geer Moraine (interpreted from 1:50,000 stereo photos)

Ministère de l'Énergie et des Ressources
 Service de la Géométrie
 Date: 25 AVR 1988
 No. G.M.: 45896

FALCONBRIDGE LTÉE
 PN-020 PROPERTY
 GAND AND LA RONCIERE TWPS.
Plan 2
 BEDROCK TOPOGRAPHY AND
 QUATERNARY GEOLOGY
 BY OVERBURDEN DRILLING MANAGEMENT LIMITED MARCH 1988

ÉNERGIE ET RESSOURCES
 REÇU
 20 AVR 1988
 BUREAU RÉGIONAL
 ROUYN-NORANDA

FALCONBRIDGE LTD./LTÉE
 LAC SHORTT AREA
 GAND, LA RONCIERE TWPS.

Sheet: 701 of 2
 Edited by: _____ Date: _____
 Executed by: _____
 Interpreted by: _____
 Drawn by: _____

Scale: 1:10000
 Échelle: 1:10000

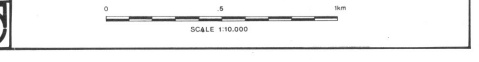

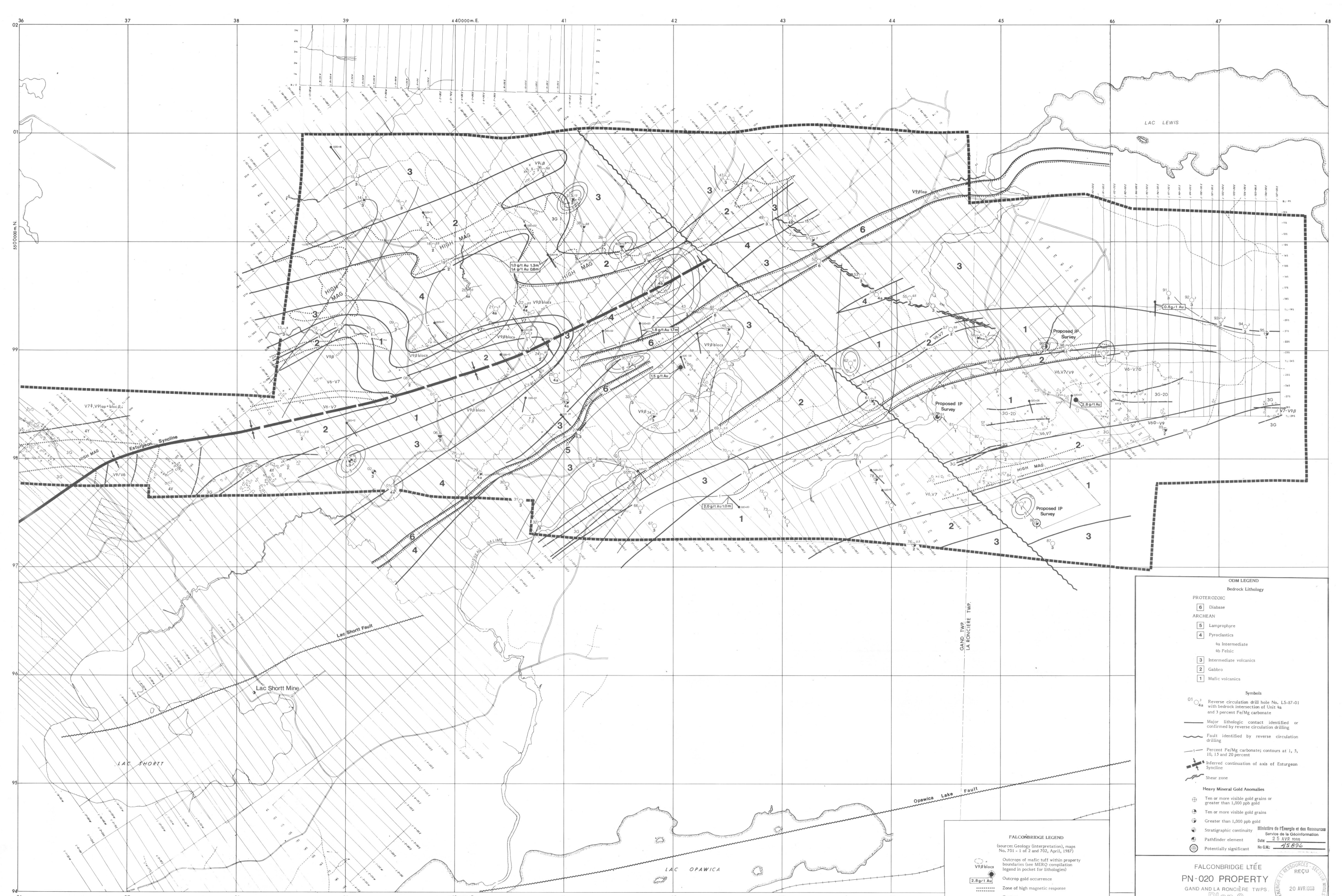

ODM LEGEND

Bedrock Lithology

PROTEROZOIC

6 Diabase

ARCHEAN

5 Lamprophyre

4 Pyroclastics

4a Intermediate

4b Felsic

3 Intermediate volcanics

2 Gabbro

1 Mafic volcanics

Symbols

01 4a Reverse circulation drill hole No. LS-37-01 with bedrock intersection of Unit 4a and 3 percent Fe/Mg carbonate

Major lithologic contact identified or confirmed by reverse circulation drilling

Fault identified by reverse circulation drilling

Percent Fe/Mg carbonate contours at 1, 5, 10, 15 and 20 percent

Inferred continuation of axis of Esturgeon Syncline

Shear zone

Heavy Mineral Gold Anomalies

⊕ Ten or more visible gold grains or greater than 1,000 ppb gold

⊙ Ten or more visible gold grains

⊙ Greater than 1,000 ppb gold

⊙ Stratigraphic continuity

⊙ Pathfinder element

⊙ Potentially significant

Ministère de l'Énergie et des Ressources
Service de la Géoinformation
Date: 25 AVR 1999
No. GM: 45896

FALCONBRIDGE LEGEND

(Source: Geology (Interpretation), maps No. 701 - 1 of 2 and 702, April, 1987)

V9B blocs Outcrops of mafic tuff within property boundaries (see MEKO compilation legend in pocket for lithologies)

2.0 g/t Au Outcrop gold occurrence

Zone of high magnetic response

Contact

Fault

FALCONBRIDGE LTD./LTEE
LAC SHORTT AREA
GAND, LA RONCIERE TWPS.

Sheet: 701 let 2 Date: 25 AVR 1999
Checked by: [Signature] Drawn by: [Signature]
Date: [] Revised by: [] Date: []
Scale: 1:50000

FALCONBRIDGE LTÉE
PN-020 PROPERTY
GAND AND LA RONCIERE TWPS.
Plan 3

**BEDROCK GEOLOGY,
HEAVY MINERAL GEOCHEMISTRY
AND PROPOSED FOLLOW-UP
EXPLORATION**

BY OVERBURDEN DRILLING MANAGEMENT LIMITED MARCH 1988

20 AVR 1999
REGIONAL
QUÉBEC-NORANDA

SCALE 1:50,000

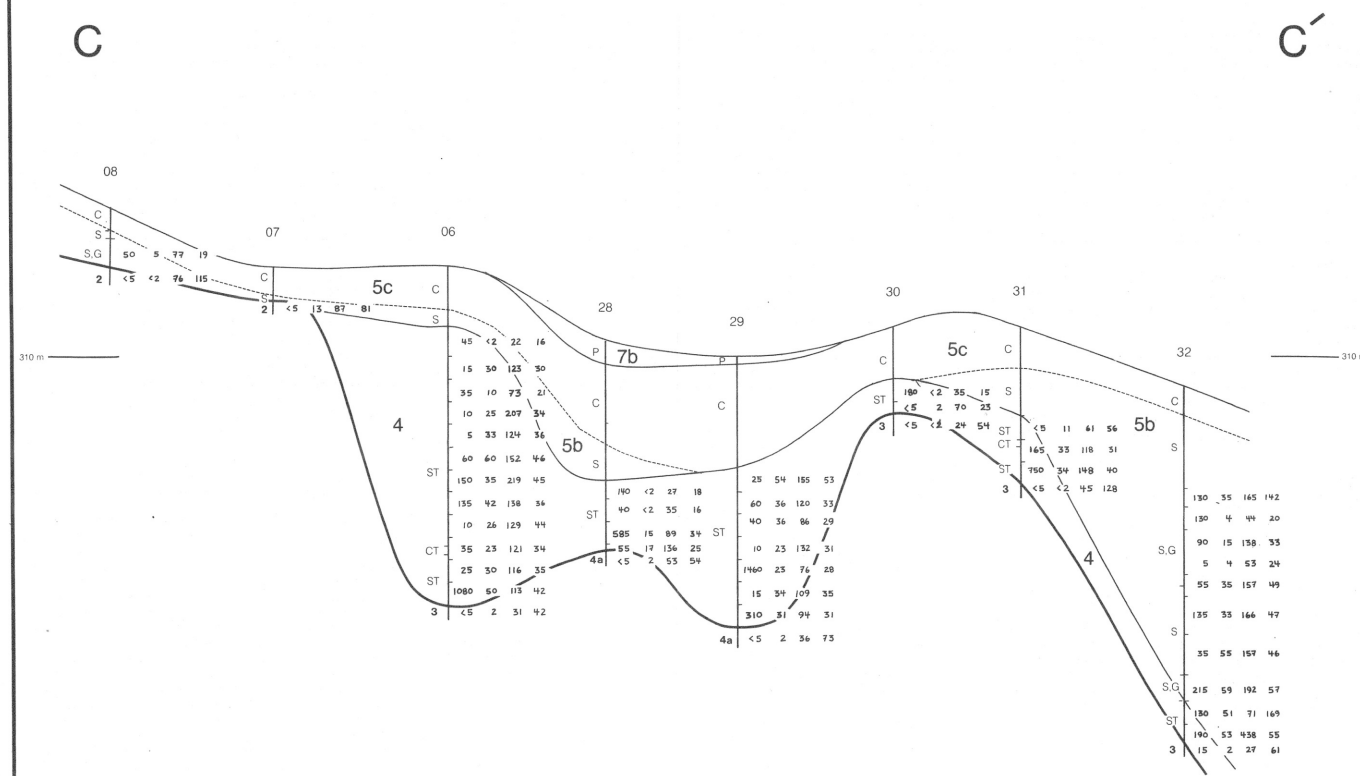
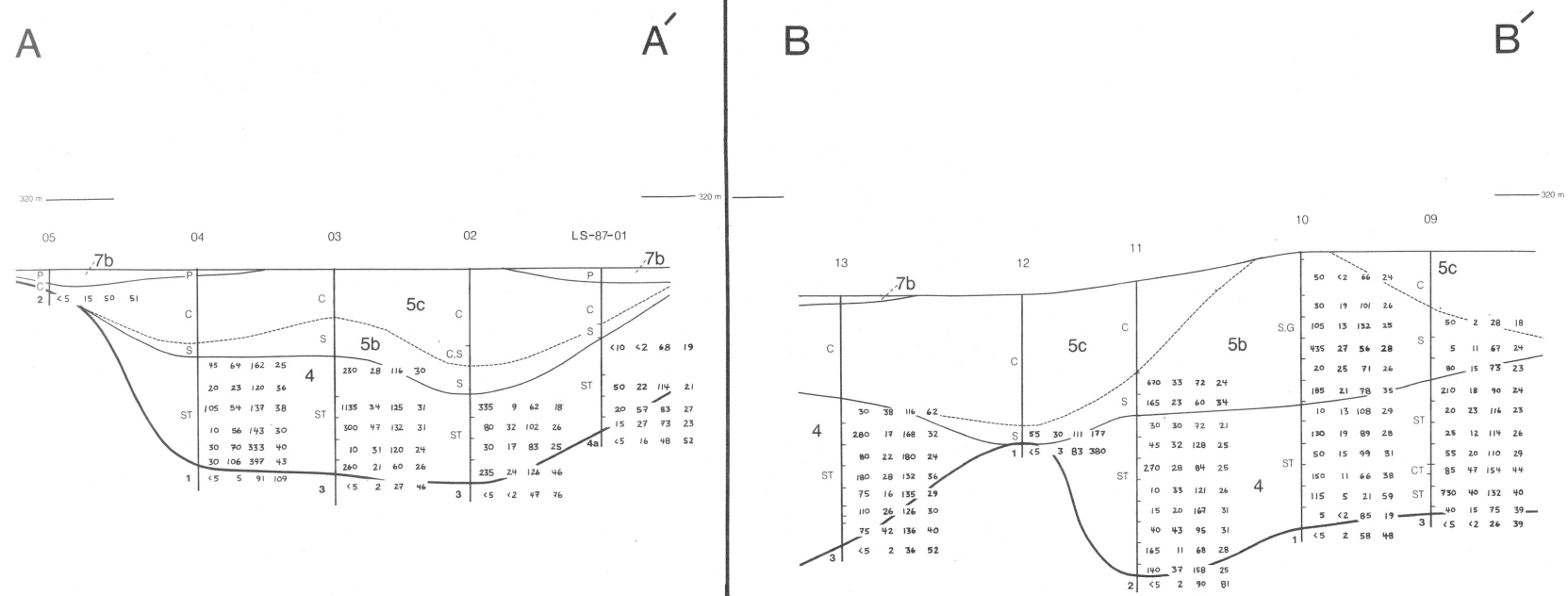

- LEGEND**
- Abitibi Quaternary Stratigraphy**
- 0 **HOLOCENE**
Years B.P. 7 Holocene sediments
7b - forest-peat member
7a - fluvial member
- 10,000 **PLEISTOCENE**
Years B.P. **LATE WISCONSINAN**
- 6 Cochrane Till
6c - regressive sediments
6b - till
6a - transgressive sediments
- 5 Ojibway II Sediments
5d - littoral and aeolian member
5c - glaciolacustrine clay member
5b - glaciolacustrine sand member
5a - glaciolacustrine member
- 4 Chibougamau/Matheson Till
- 100,000 **EARLY WISCONSINAN AND SANGAMON**
Years B.P. 3 Missinaibi Formation
3c - Ojibway I member
3b - forest-peat member
3a - fluvial member
- ILLINOIAN**
- 2 Lower Till and Sediments
- 1,000,000 **YARMOUTH AND KANSAN**
Years B.P. 1 Older Till and Sediments
- Sediment Varieties**
- P Peat
C Clay, silt
S Sand
G Gravel
ST Sand-silt till; clay subordinate
CT Clay till
- Symbols**
- Quaternary/bedrock unconformity
Interglacial unconformity
Quaternary unit boundary
Quaternary sub-unit boundary
- Geochemistry**
- ST 48 109 4 40 Sand-silt till interval with 48 ppb Au, 109 ppm As, 4 ppm Cu, and 40 ppm Zn in non-magnetic heavy mineral fraction (S.G. greater than 3.3)
- Bedrock Lithology**
- PROTEROZOIC**
- 6 Diabase
- ARCHEAN**
- 5 Lamprophyre
4 Pyroclastics
- 4a Intermediate
4b Felsic
- 3 Intermediate volcanics
2 Gabbro
1 Mafic volcanics
- Scale**
- HOR. 1:10,000 VERT. 1:400

Ministère de l'Énergie et des Ressources
Service de la Géoinformation
Date: 25 AVR 1988
No G.M.: 45896

FALCONBRIDGE LTÉE
PN-020 PROPERTY
GAND AND LA RONCIÈRE TWPS.
Sections
A-A', B-B' and
C-C'
BY OVERBURDEN DRILLING MANAGEMENT LIMITED MARCH 1988

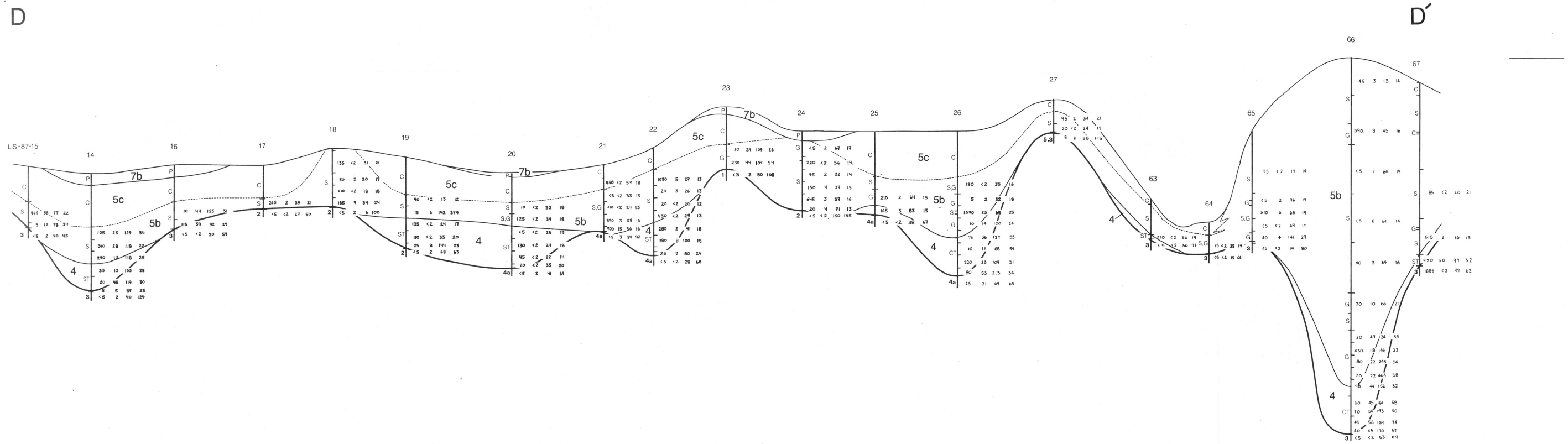

- LEGEND**
- Abitibi Quaternary Stratigraphy**
- HOLOCENE**
 Years B.P. 7 Holocene sediments
 7b - forest-peat member
 7a - fluvial member
- PLEISTOCENE**
 10,000 Years B.P. **LATE WISCONSINAN**
 6 Cochrane Till
 6c - regressive sediments
 6b - till
 6a - transgressive sediments
 5 Ojibway II Sediments
 5d - littoral and aeolian member
 5c - glaciolacustrine clay member
 5b - glaciolacustrine sand member
 5a - glaciolacustrine member
 4 Chibougamau/Matheson Till
- EARLY WISCONSINAN AND SANGAMON**
 100,000 Years B.P. 3 Missinaibi Formation
 3c - Ojibway I member
 3b - forest-peat member
 3a - fluvial member
- ILLINOIAN**
 2 Lower Till and Sediments
- YARMOUTH AND KANSAN**
 1,000,000 Years B.P. 1 Older Till and Sediments
- Sediment Varieties**
 P Peat
 C Clay, silt
 S Sand
 G Gravel
 ST Sand-silt till; clay subordinate
 CT Clay till
- Symbols**
 Quaternary/bedrock unconformity
 Interglacial unconformity
 Quaternary unit boundary
 Quaternary sub-unit boundary
- Geochemistry**
 Sand-silt till interval with
 48 ppb Au, 109 ppm As, 4 ppm Cu,
 and 40 ppm Zn in non-magnetic
 heavy mineral fraction (S.G.
 greater than 3.3)
- Bedrock Lithology**
- PROTEROZOIC**
 6 Diabase
- ARCHEAN**
 5 Lamprophyre
 4 Pyroclastics
 4a Intermediate
 4b Felsic
- 3 Intermediate volcanics
 2 Gabbro
 1 Mafic volcanics
- Scale**
 HOR. 1:10,000 VERT. 1:400

Ministère de l'Énergie et des Ressources
 Service de la Géoinformation
 Date: 25 AVR 1988
 No G.M.: 45896

FALCONBRIDGE LTÉE
 PN-020 PROPERTY
 GAND AND LA RONCIÈRE TWPS.
 Section
 D-D'
 BY OVERBURDEN DRILLING MANAGEMENT LIMITED MARCH 1988

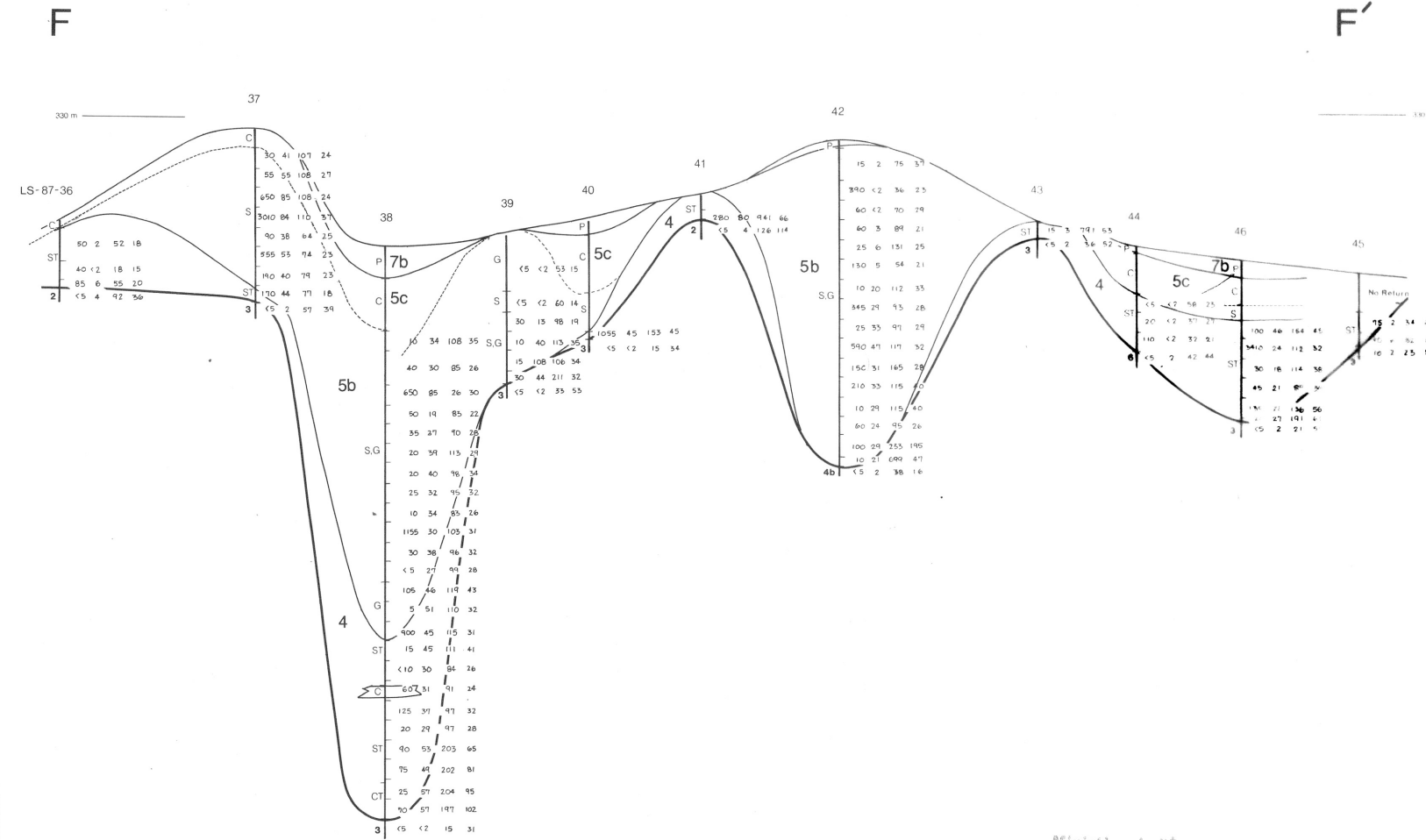
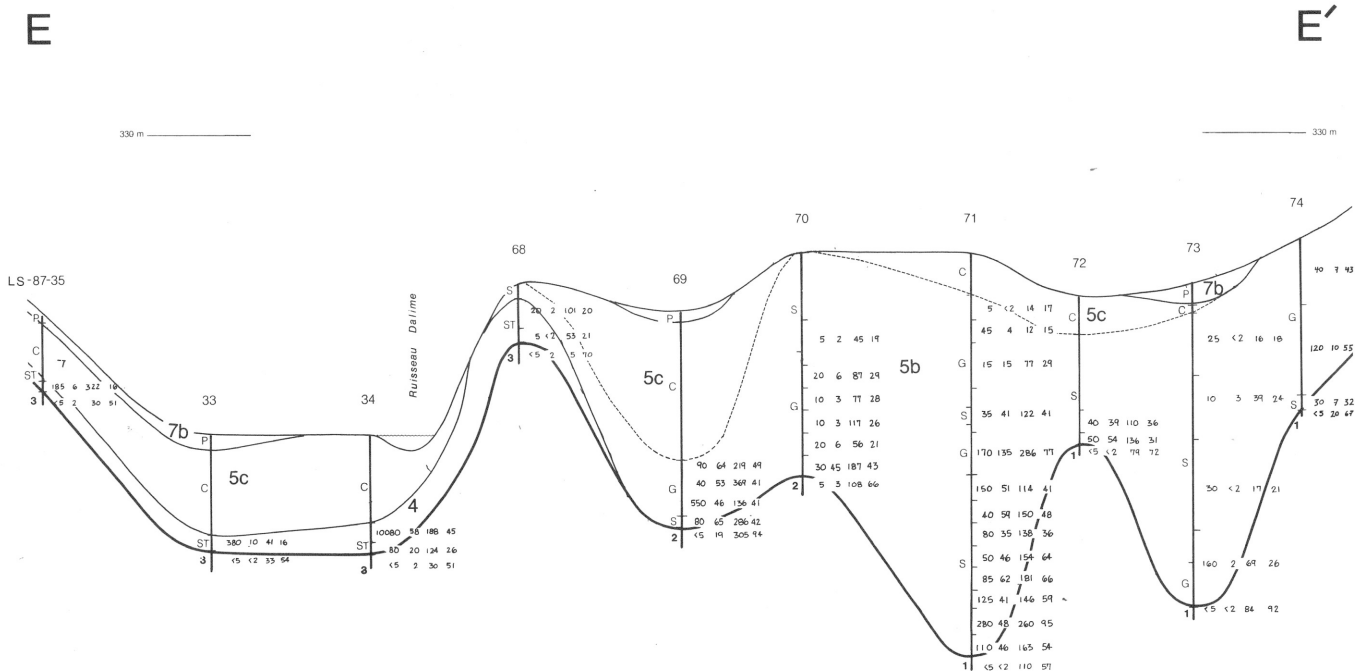

- LEGEND**
- Altiibi Quaternary Stratigraphy
- Years B.P. ⁰ **HOLOCENE**
- 7 Holocene sediments
 - 7b - forest-peat member
 - 7a - fluvial member
- 10,000 Years B.P. **PLEISTOCENE**
- LATE WISCONSINAN**
- 6 Cochrane Till
 - 6c - regressive sediments
 - 6b - till
 - 6a - transgressive sediments
 - 5 Ojibway II Sediments
 - 5d - littoral and aeolian member
 - 5c - glaciolacustrine clay member
 - 5b - glaciolacustrine sand member
 - 5a - glaciolacustrine sand member
 - 4 Chibougamau/Matheson Till
- 100,000 Years B.P. **EARLY WISCONSINAN AND SANGAMON**
- 3 Missinabi Formation
 - 3c - Ojibway I member
 - 3b - forest-peat member
 - 3a - fluvial member
- ILLINOIAN**
- 2 Lower Till and Sediments
- 1,000,000 Years B.P. **YARMOUTH AND KANSAN**
- 1 Older Till and Sediments
- Sediment varieties**
- P Peat
 - Clay, silt
 - S Sand
 - G Gravel
 - ST Sand-silt till; clay subordinate
 - CT Clay till
- Symbols**
- Quaternary/bedrock unconformity
 - interglacial unconformity
 - Quaternary unit boundary
 - Quaternary sub-unit boundary
- Geochemistry**
- ST 48 109 4 40
Sand-silt till interval with 48 ppb Au, 109 ppm As, 4 ppm Cu, and 40 ppm Zn in non-magnetic heavy mineral fraction (S.G. greater than 3.3)
- Bedrock Lithology**
- PROTEROZOIC**
- 6 Diabase
- ARCHEAN**
- 5 Lamprophyre
 - 4 Pyroclastics
 - 4a Intermediate
 - 4b Felsic
 - 3 Intermediate volcanics
 - 2 Gabbro
 - 1 Mafic volcanics
- Scale**
- HOR. 1:10,000 VERT. 1:400

Ministère de l'Énergie et des Ressources
 Service de la Géoinformation
 Date: 25 AVR 1988
 No G.M.: 45896

FALCONBRIDGE LTÉE
 PN-020 PROPERTY
 GAND AND LA RONCIÈRE TWPS.
 Sections
 E-E' and F-F'

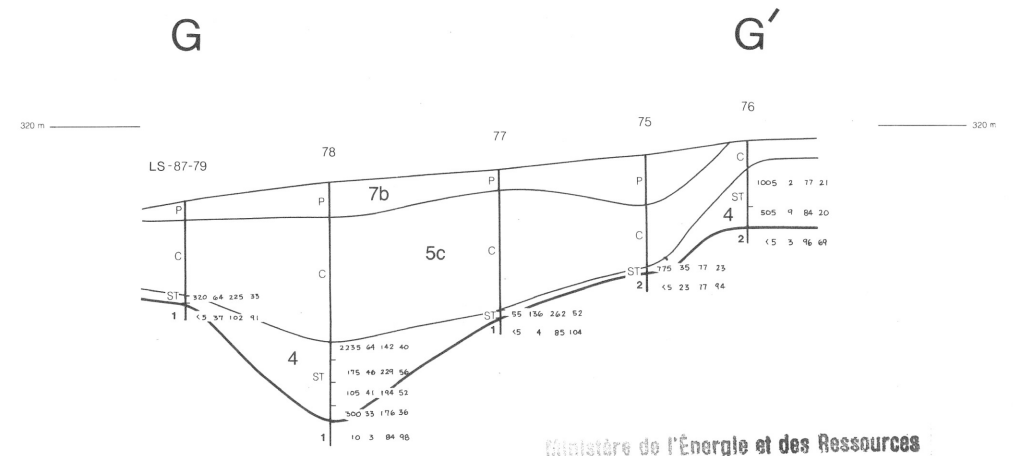
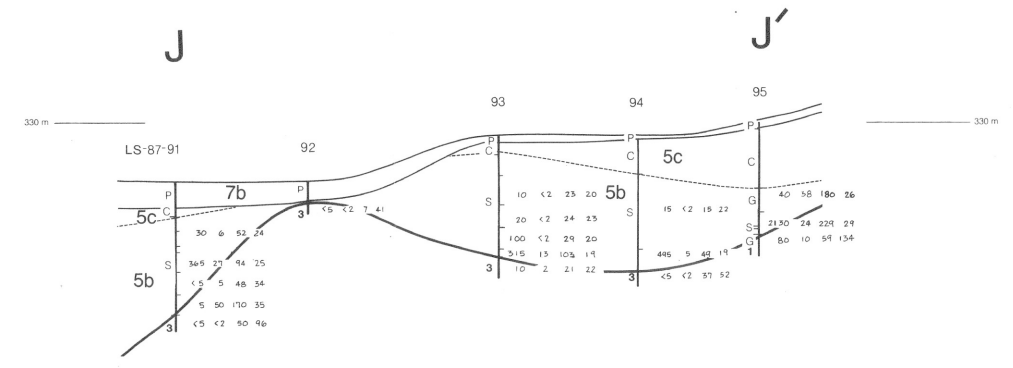
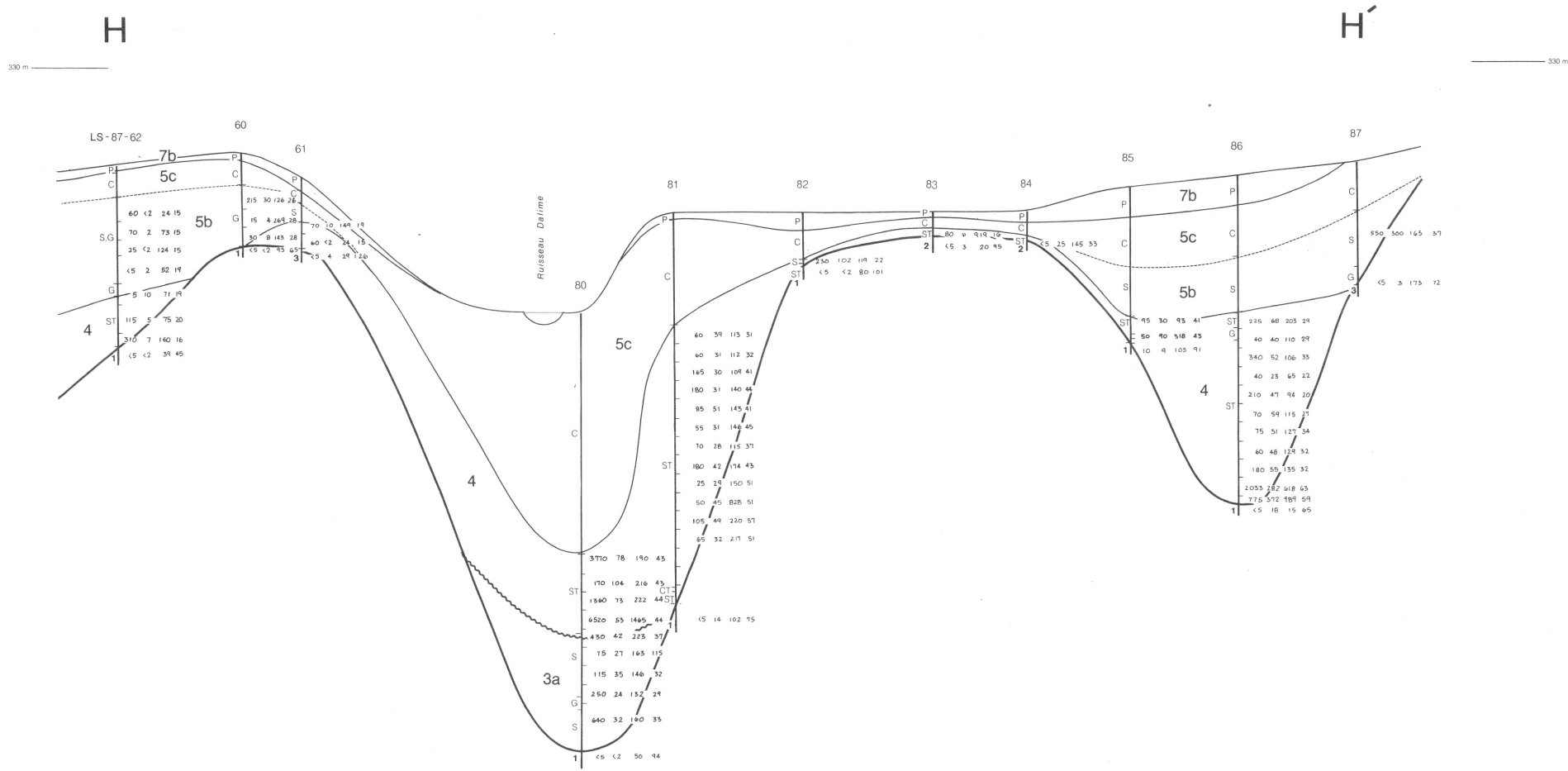

Ministère de l'Énergie et des Ressources
 Service de la Géoinformation
 Date: 25 AVR 1988
 No G.M.: 45896

- LEGEND**
 Abitibi Quaternary Stratigraphy
- HOLOCENE**
 Years B.P. 0
 7 Holocene sediments
 7b - forest-peat member
 7a - fluvial member
- PLEISTOCENE**
 10,000 Years B.P.
LATE WISCONSINAN
 6 Cochrane Till
 6c - regressive sediments
 6b - till
 6a - transgressive sediments
 5 Ojibway II Sediments
 5d - littoral and aeolian member
 5c - glaciolacustrine clay member
 5b - glaciolacustrine sand member
 5a - glaciolacustrine member
 4 Chibougamau/Matheson Till
- EARLY WISCONSINAN AND SANGAMON**
 100,000 Years B.P.
 3 Missinabi Formation
 3c - Ojibway I member
 3b - forest-peat member
 3a - fluvial member
- ILLINOIAN**
 2 Lower Till and Sediments
- YARMOUTH AND KANSAN**
 1,000,000 Years B.P.
 1 Older Till and Sediments
- Sediment Varieties**
 P Peat
 C Clay, silt
 S Sand
 G Gravel
 ST Sand-silt till; clay subordinate
 CT Clay till
- Symbols**
 Quaternary/bedrock unconformity
 Interglacial unconformity
 Quaternary unit boundary
 Quaternary sub-unit boundary
- Geochemistry**
 Sand-silt till interval with
 48 ppb Au, 109 ppm As, 4 ppm Cu,
 and 40 ppm Zn in non-magnetic
 heavy mineral fraction (S.G.
 greater than 3.3)
- Bedrock Lithology**
- PROTEROZOIC**
 6 Diabase
- ARCHEAN**
 5 Lamprophyre
 4 Pyroclastics
 4a Intermediate
 4b Felsic
 3 Intermediate volcanics
 2 Gabbro
 1 Mafic volcanics
- Scale**
 HOR. 1:10,000 VERT. 1:400

FALCONBRIDGE LTÉE
 PN-020 PROPERTY
 GAND AND LA RONCIÈRE TWPS.
 Sections
 H-H', J-J', and
 G-G'
 BY OVERBURDEN DRILLING MANAGEMENT LIMITED MARCH 1988

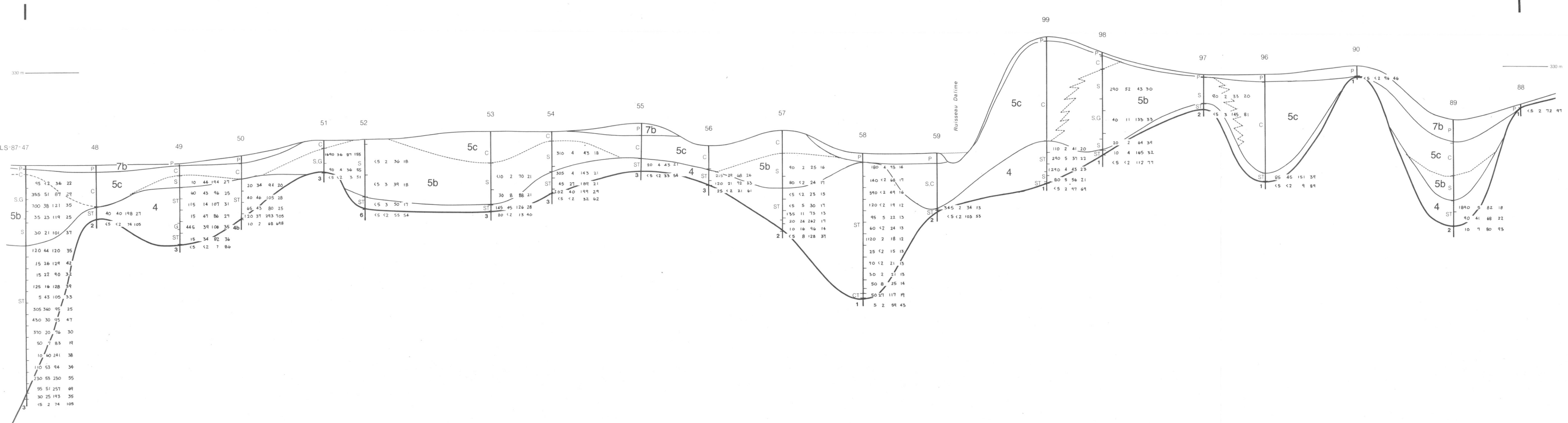

330 m

330 m

LS-87-47

ST
48 109 4 40

Ministère de l'Énergie et des Ressources
 Service de la Géoinformation
 Date: 25 AVR 1988
 No G.M.: 45896

- LEGEND**
- Abitibi Quaternary Stratigraphy**
- Years B.P. 0 **HOLOCENE**
 7 Holocene sediments
 7b - forest-peat member
 7a - fluvial member
- 10,000 Years B.P. **PLEISTOCENE**
LATE WISCONSINAN
 6 Cochrane Till
 6c - regressive sediments
 6b - till
 6a - transgressive sediments
 5 Ojibway II Sediments
 5d - littoral and aeolian member
 5c - glaciolacustrine clay member
 5b - glaciolacustrine sand member
 5a - glaciolacustrine member
 4 Chibougamau/Matheson Till
- 100,000 Years B.P. **EARLY WISCONSINAN AND SANGAMON**
 3 Missisquoi Formation
 3c - Ojibway I member
 3b - forest-peat member
 3a - fluvial member
- ILLINOIAN**
 2 Lower Till and Sediments
- 1,000,000 Years B.P. **YARMOUTH AND KANSAN**
 1 Older Till and Sediments
- Sediment Varieties**
 P Peat
 C Clay, silt
 S Sand
 G Gravel
 ST Sand-silt till; clay subordinate
 CT Clay till
- Symbols**
 Quaternary/bedrock unconformity
 Interglacial unconformity
 Quaternary unit boundary
 Quaternary sub-unit boundary
- Geochemistry**
 Sand-silt till interval with
 48 ppb Au, 109 ppm As, 4 ppm Cu,
 and 40 ppm Zn in non-magnetic
 heavy mineral fraction (S.G.
 greater than 3.3)
- Bedrock Lithology**
- PROTEROZOIC**
 6 Diabase
- ARCHEAN**
 5 Lamprophyre
 4 Pyroclastics
 4a Intermediate
 4b Felsic
 3 Intermediate volcanics
 2 Gabbro
 1 Mafic volcanics
- Scale
 HOR. 1:10,000 VERT. 1:400

FALCONBRIDGE LTÉE
 PN-020 PROPERTY
 GAND AND LA RONCIÈRE TWPS.
 Section
 I-I'

BY OVERBURDEN DRILLING MANAGEMENT LIMITED MARCH 1988