

- GOLD PRODUCERS
- FORMER PRODUCERS

0 3.9 7.9 11.9
SCALE IN MILES

Ministère de l'Énergie et des Ressources
Service de la Géoinformation
Date: 14 MAR 1988
No G.M.: 45810

LOCATION MAP

by **SOCOMINES INC.**, Mining Consultants.

*Jean Lavallée
May 19th, 1988*

Rg VIII

Rg VII

Rg VI

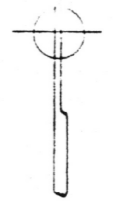
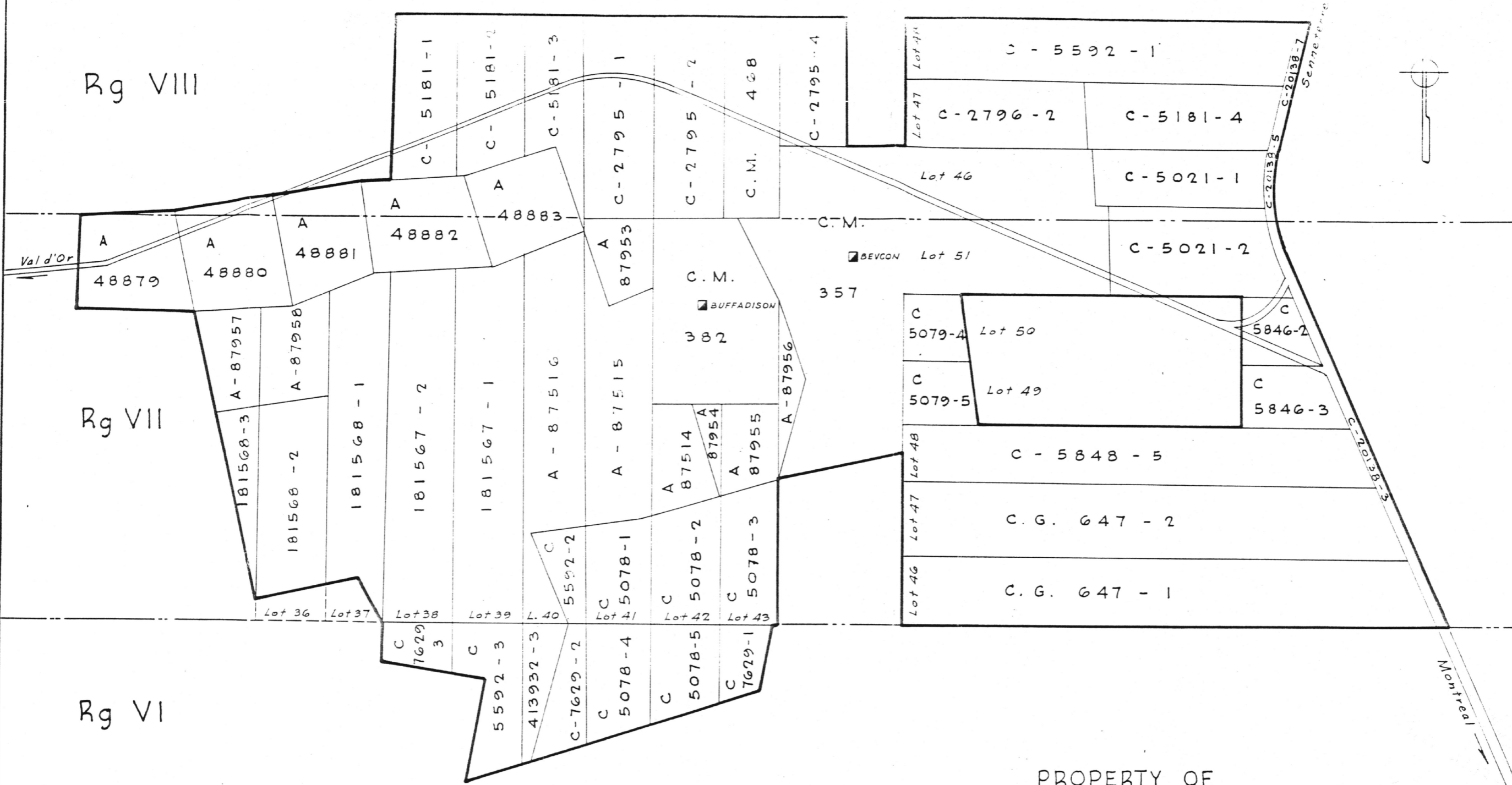

Ministère de l'Énergie et des Ressources
 Service de la Géoinformation
 Date: 14 MAR 1998
 No G.M.: 45810

PROPERTY OF
 ABITIBI RESOURCES LTD
 IN
 LOUVICOURT TOWNSHIP
 by
 SOCOMINES INC., Mining Consultants.

Jean Lavallée
 May 18 1998

Scale: 1" = 1320'

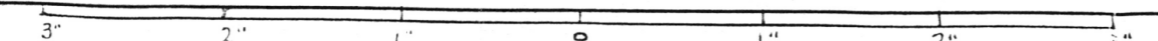

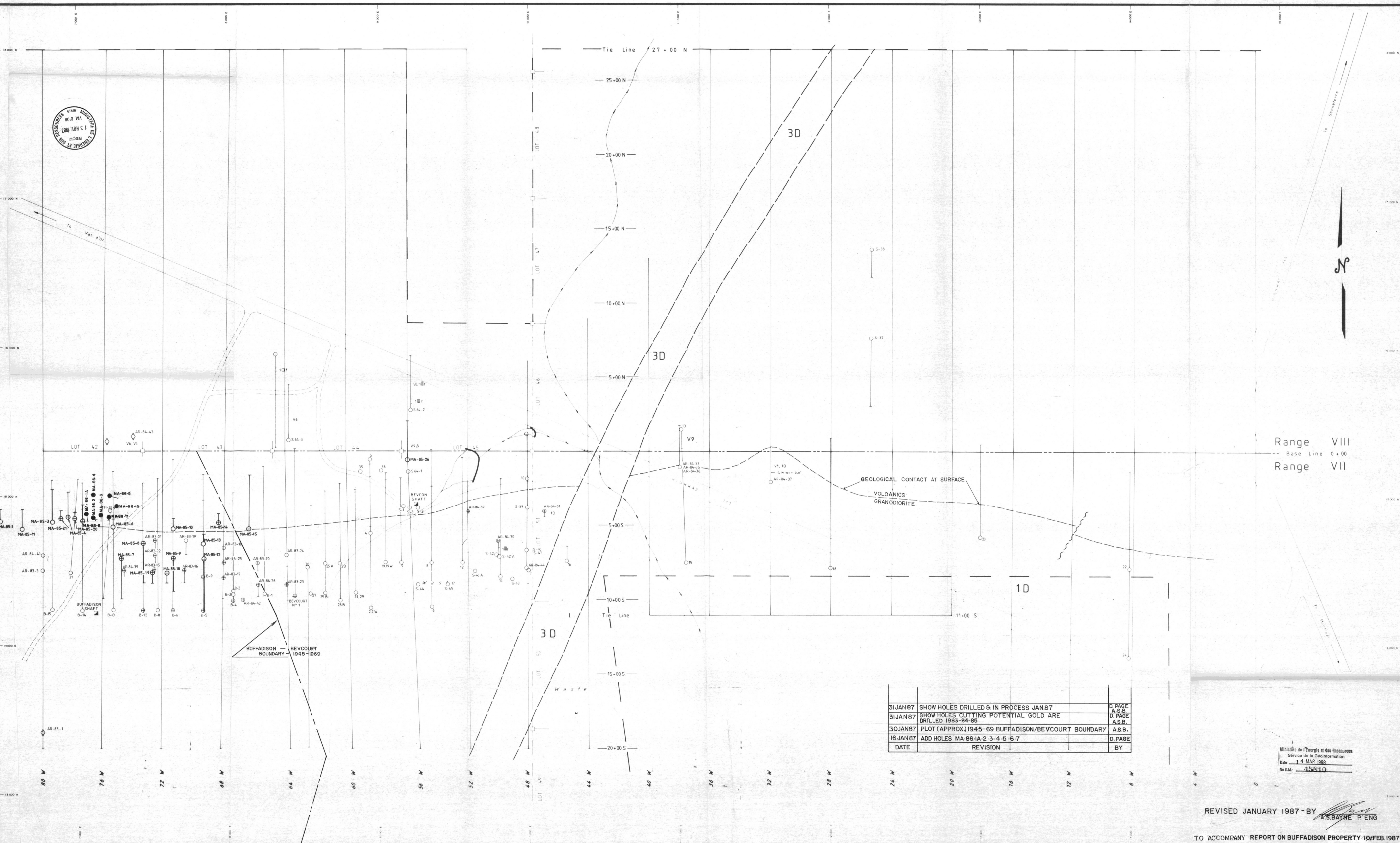

Range VIII
Base Line 0+00
Range VII

DATE	REVISION	BY
31 JAN 87	SHOW HOLES DRILLED & IN PROCESS JAN 87	D. PAGE
31 JAN 87	SHOW HOLES CUTTING POTENTIAL GOLD ARE DRILLED 1993-94-85	D. PAGE
30 JAN 87	PLOT (APPROX) 1945-69 BUFFADISON/BEVCOURT BOUNDARY	A.S.B.
16 JAN 87	ADD HOLES MA-86-1A-2-3-4-5-6-7	D. PAGE

Ministère de l'Énergie et des Ressources
Service de la Géoinformation
Date: 14 MAR 1988
No. C.M.: 15510

REVISED JANUARY 1987 - BY A.S.BAYNE P. ENG

TO ACCOMPANY REPORT ON BUFFADISON PROPERTY 10/FEB/1987

SYMBOLS

(Symbol) SHOW HOLES DRILLED & IN PROCESS JAN 87
 (Symbol) SHOW HOLES CUTTING POTENTIAL GOLD ARE DRILLED 1993-94-85
 (Symbol) PLOT (APPROX) 1945-69 BUFFADISON/BEVCOURT BOUNDARY
 (Symbol) ADD HOLES MA-86-1A-2-3-4-5-6-7

(Symbol) BUFFADISON/BEVCOURT BOUNDARY 1945-1969
 (Symbol) BEVCOURT SHAFT
 (Symbol) BUFFADISON SHAFT
 (Symbol) TIE LINE
 (Symbol) LOT BOUNDARIES
 (Symbol) SURFACE GEOLOGICAL CONTACT
 (Symbol) VOLCANICS GRANODIORITE

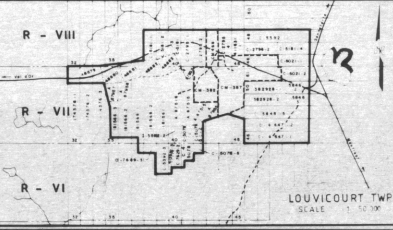
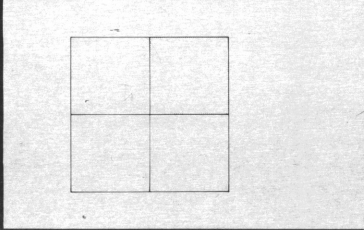

ABITIBI RESOURCES LTD

GEOLOGICAL COMPILATION MAP

GEOLOGICA INC.

NTS REF: _____
 CANTON TWP: LOUVICOURT
 GEOLOGICAL GEOLOGY: D. SULLIVAN
 DESIGN DRAWN: B. MOSEAU
 REVISION: A. KHOBZI
 DATE MAP NO: _____ DATE: 04 MAR 88

14 800N 14 600N 14 400N 14 200N 14 000N 13 800N 13 600N 13 400N 13 200N 13 000N

360°

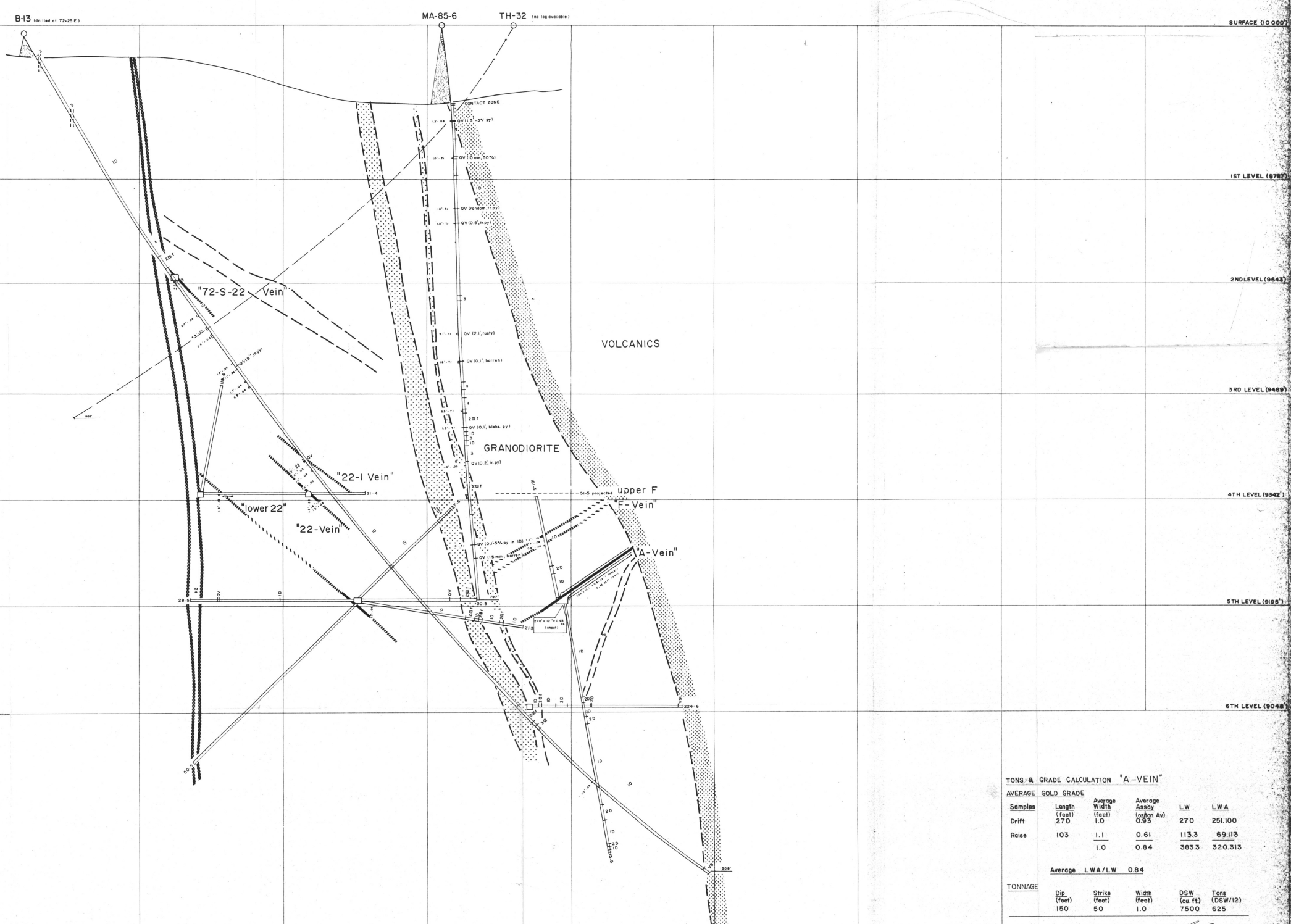

TONS & GRADE CALCULATION "A-VEIN"

AVERAGE GOLD GRADE	Average Length (feet)	Average Width (feet)	Average Assay (ounces Au)	LW	LWA
Drift	270	1.0	0.93	270	251.100
Raise	103	1.1	0.61	113.3	69.113
		1.0	0.84	383.3	320.313
Average		LWA/LW	0.84		

TONNAGE	Dip (feet)	Strike (feet)	Width (feet)	DSW (cu. ft)	Tons (DSW/12)
	150	50	1.0	7500	625

REVISED: JANUARY 1987 - BY *A.S. Bayne*
 A.S. BAYNE, P. ENG
 TO ACCOMPANY REPORT ON BUFFADISON PROPERTY 10/FEB. 1987

30JAN87	SHOWN TYPICAL TONS/GRADE CALCULATION	A.S.B
DATE	REVISIONS	BY

LEGEND

- ID GRANODIORITE
- 2D DIORITE
- 3 MAFIC DYKE
- 2Bf QUARTZ FELDSPAR PORPHYRY
- V9 TUFFS VOLCANICS
- QV QUARTZ VEIN
- py PYRITE
- σ SILICIFIED
- MAJOR SHEAR ZONE
- SHEARED ROCKS
- GEOLOGICAL CONTACT
- UNDERGROUND WORKINGS
- DIAMOND DRILL HOLES

ORE RESERVE CALCULATION

- PROVEN ORE
- PROBABLE ORE
- INFERRED ORE
- FT - oz/ton Au

MID CANADA GOLD AND COPPER MINES LTD
 ABITIBI RESOURCES LTD
 JOINT VENTURE

SECTION 72+00 E

GEOLOGICA INC.
 A. LAURENT
 C. KHOSHDEL

Ministère de l'Énergie et des Ressources
 Service de la Géoinformation
 Date: 14 MAR 1988
 No. C.M.: 45810

ITS REF: 32 / C3
 CANTONVILLE LOUVICOURT
 ESCHELLE/SCALE: 1" = 50'

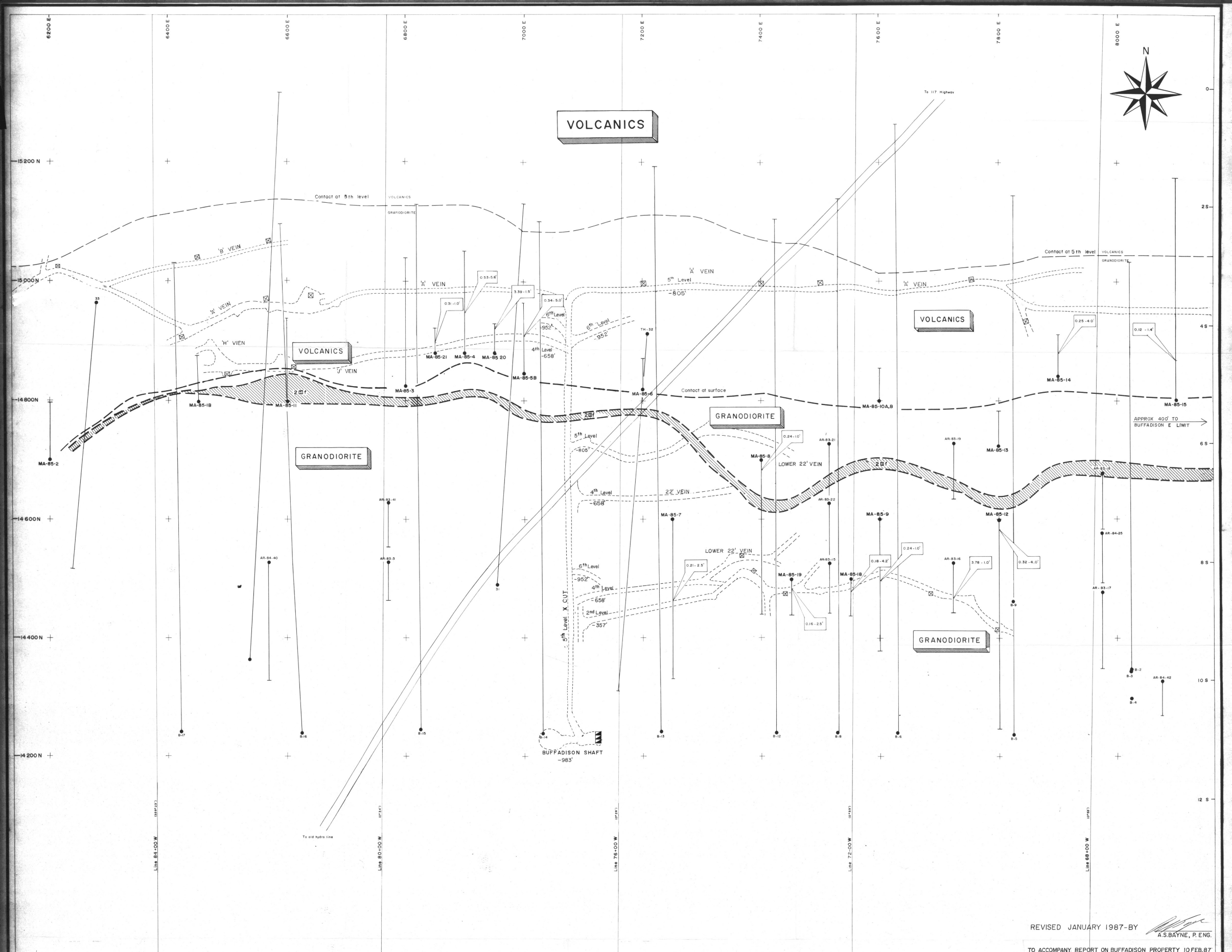

REVISED JANUARY 1987-BY
A.S. BAYNE, P. ENG.
TO ACCOMPANY REPORT ON BUFFADISON PROPERTY 10FEB.87

DATE	REVISIONS	BY
31JAN87	SHOW VEINS A, B, H, J, 22 & LOWER 22 4 th & 5 th LEVELS - PER 1948 MINE PLANS	A.S.B.
30JAN87	PLOT MINE DRIFT B RAISE PLANS PER 1948 PLANS 2 nd 4 th 5 th 6 th Levels	A.S.B.
30JAN87	PLOT 5 th Level SHAFT STATION	A.S.B.
30JAN87	RELOT BUFFADISON SHAFT	A.S.B.

Ministère de l'Énergie et des Ressources
Service de la Géoinformation
Date: 4 MAR 1988
No. C.M.: 45810

- LEGEND**
- GRANDIORITE
 - VOLCANICS
 - ▨ QUARTZ-FELDSPAR PORPHYRY
 - PRESUMED GEOLOGICAL CONTACT AT SURFACE
 - - - PRESUMED GEOLOGICAL CONTACT AT 5th LEVEL
 - - - SURFACE PROJECTION OF THE 5th LEVEL
 - FORMER BUFFADISON SHAFT
 - RAISE
 - GOLD VALUES IN oz/ton Au-Ft
 - DIAMOND DRILL HOLE LOCATIONS

It should be noted that holes MA-85-1 to MA-85-15 were surveyed and therefore their locations may be considered to be precise.

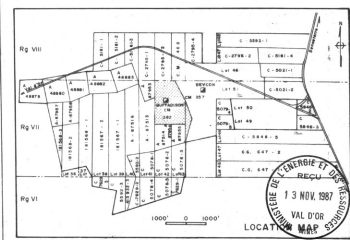

MID CANADA GOLD AND COPPER MINES LTD
ABITIBI RESOURCES LTD.
JOINT VENTURE

FORMER BUFFADISON SHAFT AREA
SURFACE PLAN

GEOLOGICA INC.
A.J. BEAUREGARD B.Sc.
K.A. KHORRAM M.Sc.

NTS/REF: 32 C3
CANTON/WR: LOUVICOURT
GÉOLOGIE/GEOLOGY: D.L. SULLIVAN
DESSINÉ/DRAWN: Y. ALLAIRE
REVISÉ/REVISED: K.A. KHORRAM

ÉCHELLE/SCALE: 1" = 50'
CARTÉ/MAP NO.:
DATE: 05/88

HOLE No.	FEET	Au oz/t.
3	2.0	0.11
	4.5	0.06
	2.5	0.71
13	2.0	0.22
	1.0	0.32
	1.0	0.10
15	2.0	0.57
	2.5	0.19
	7.5	0.33
	2.0	3.14
	5.0	1.06
	2.0	1.66
16	3.0	0.06
	1.0	3.78
17	2.0	0.14
	4.0	0.15
	6.5	0.07
20	2.0	0.52
	3.5	0.10
	3.0	0.15
	1.0	0.29
	2.0	0.13
	3.0	0.10
21	3.0	0.17
22	2.0	0.19
23	10.0	0.04
	1.5	0.19
25	3.5	0.07
	1.5	1.55
	5.5	0.12
	2.0	0.10
26	2.0	1.04
	2.0	1.54
	2.0	0.43
	6.0	0.13
30	10.0	0.08
	4.0	0.10
	1.0	0.13
31	4.0	0.07
	4.5	0.06
32	3.0	0.14

HOLE No.	FEET	Au OZ/t.
37	2.0	0.14
38	1.0	0.48
39	10.0	0.08
41	3.0	0.07
	2.0	0.09
42	6.0	0.06
43	4.0	0.09

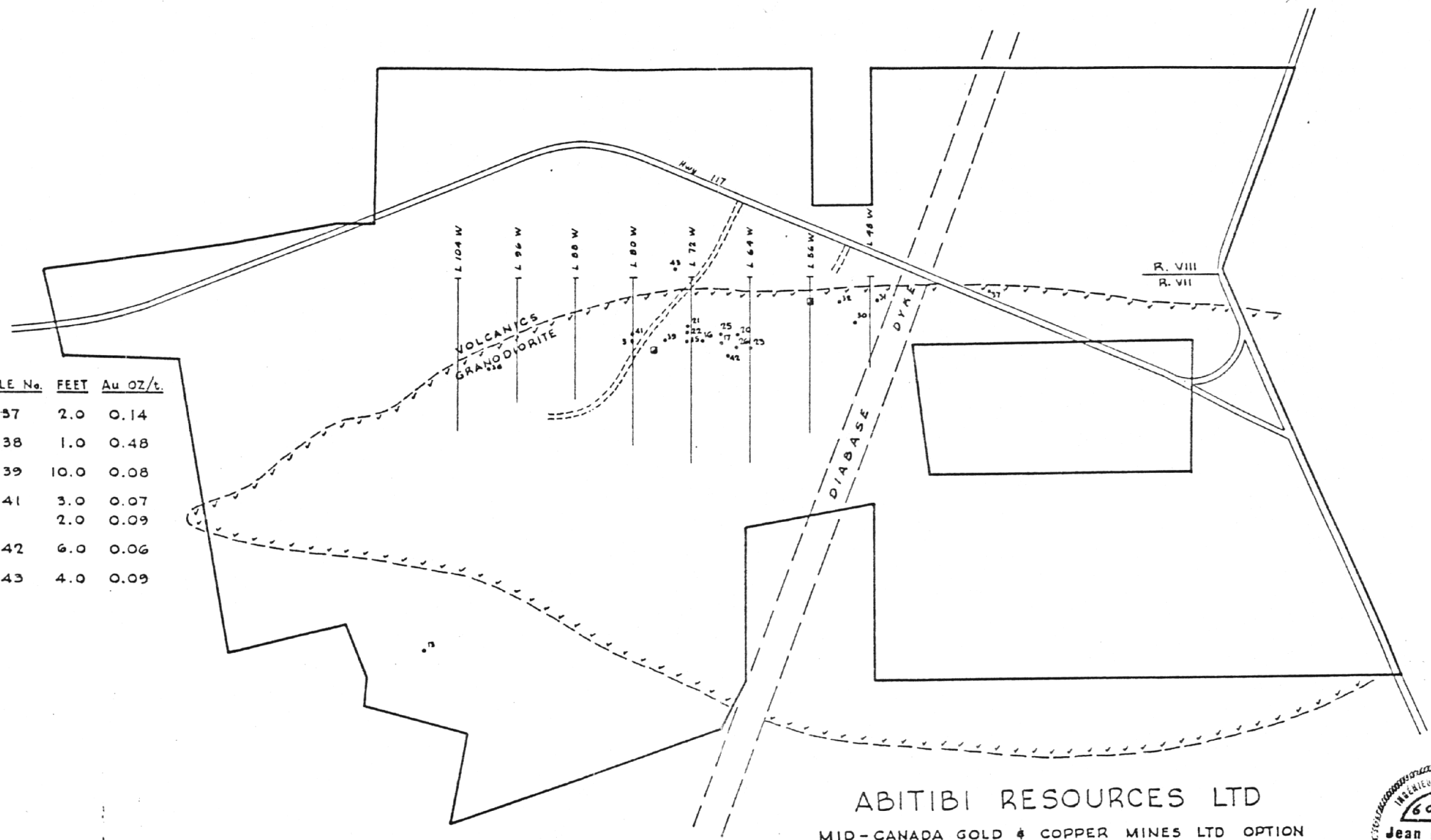

MRN-GÉOINFORMATION 1988

GM 45810

ABITIBI RESOURCES LTD
 MID-CANADA GOLD & COPPER MINES LTD OPTION
 LOUVICOURT TWP.

1983-84 RECENT DRILLING RESULTS

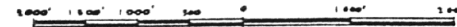

INGÉNIEUR - ENGINEER
 60456
 Jean Lavalée
 May 18th 1985

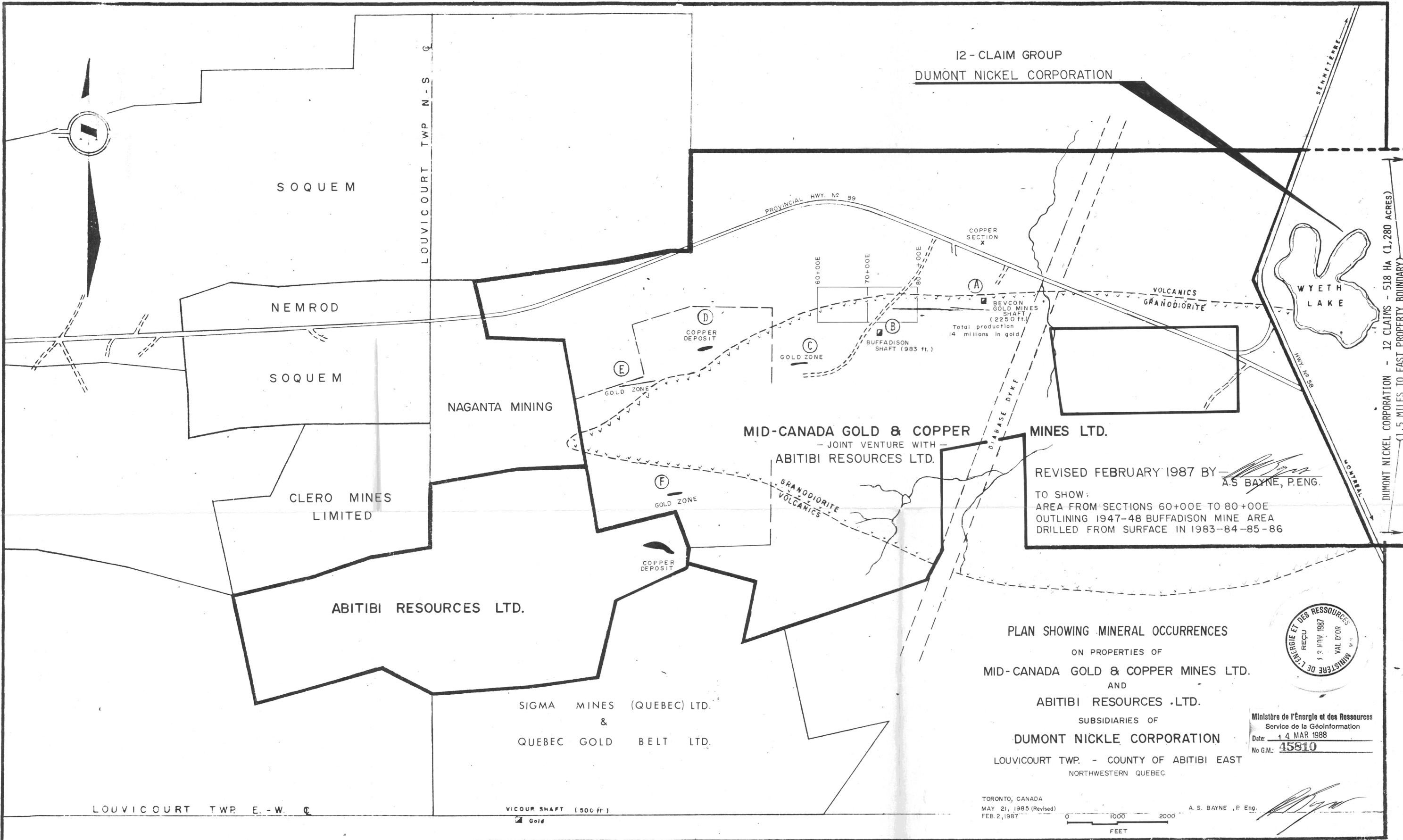

12 - CLAIM GROUP
 DUMONT NICKEL CORPORATION

DUMONT NICKEL CORPORATION - 12 CLAIMS - 518 HA (1,280 ACRES)
 1.5 MILES TO EAST PROPERTY BOUNDARY

REVISED FEBRUARY 1987 BY *A.S. Bayne*
 A.S. BAYNE, P.ENG.
 TO SHOW:
 AREA FROM SECTIONS 60+00E TO 80+00E
 OUTLINING 1947-48 BUFFADISON MINE AREA
 DRILLED FROM SURFACE IN 1983-84-85-86

PLAN SHOWING MINERAL OCCURRENCES
 ON PROPERTIES OF
 MID-CANADA GOLD & COPPER MINES LTD.
 AND
 ABITIBI RESOURCES LTD.
 SUBSIDIARIES OF
 DUMONT NICKLE CORPORATION
 LOUVICOURT TWP. - COUNTY OF ABITIBI EAST
 NORTHWESTERN QUEBEC



Ministère de l'Énergie et des Ressources
 Service de la Géoinformation
 Date: 14 MAR 1988
 No G.M.: 45810

TORONTO, CANADA
 MAY 21, 1985 (Revised)
 FEB. 2, 1987
 A. S. BAYNE, P. Eng.
 0 1000 2000
 FEET

LOUVICOURT TWP. E. - W. C

VICOUR SHAFT (500 ft.)
 Gold