

**LEGEND**

- Claim post / Claim line
- Outcrop
- Foliation at inclined
- Geological contact (assumed) blaster geophysics
- Fault (after geophysics) b/probable
- Rock sample number
- (S, P, M, Z, A) Au(ppb), Cu(ppm), Zn(ppm), As(ppm)

**ROCK SUFFIXES**

V2 Rhyolite	V6 Andesite
V7 Basalt	V9 Tuff
I Felsic Intrusive	ID Granodiorite
IG Granite	3D Diabase

**ALTERATION & STRUCTURE SUFFIXES**

α Felsic	η Carbonized	σ Silicified
⊙ Pillowed	† Banded	‡ Sheared
⊠ Porphyritic		

**MINERAL SUFFIXES**

f Feldspar	q Quartz	Py Pyrite
v Vein	Mt Magnetite	Po Pyrrhotite

**ABBREVIATIONS**

carb	Carbonate Alteration
chl	Chloritic Alteration
sil	Silicification
qv	Quartz Vein
qv-c	Quartz Carbonate Vein
crs	Coarse
shr	Shear
7gd	Granodiorite
5g	Gabbro
3	Felsic Volcanics
lf	Mafic Flows

Ministère de l'Énergie et des Ressources  
Service de la Géoinformation  
Date: 5 JAN 1987  
No. G.M.: 14559

200 100 0 100 200 300 400 500 600 meters

Société en Commandite Explorations KERY

GREVET PROJECT (Q-28) East Grid  
Grevet Twp (Rg VI, Rg VII, Rg VIII and Rg IX)

**COMPILATION MAP  
(EAST SECTOR)**

MAP NO:	SURVEY BY: M.L.L.J., M.G., P.D., F.C., R.F., B.O.
SCALE: 1:10,000	PLOTTED BY: M.L.L.J., M.G., P.D., F.C., R.F., B.O.
DATE: JULY 1985 DEC 86	DRAWN BY: M.G., R.L., S.M.C.
NTS: 32F2	APPROVED BY:

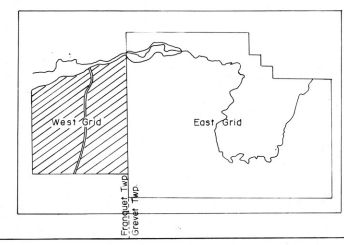
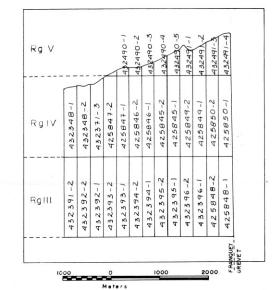
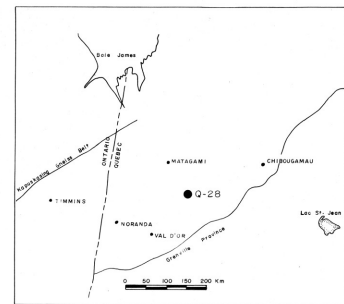
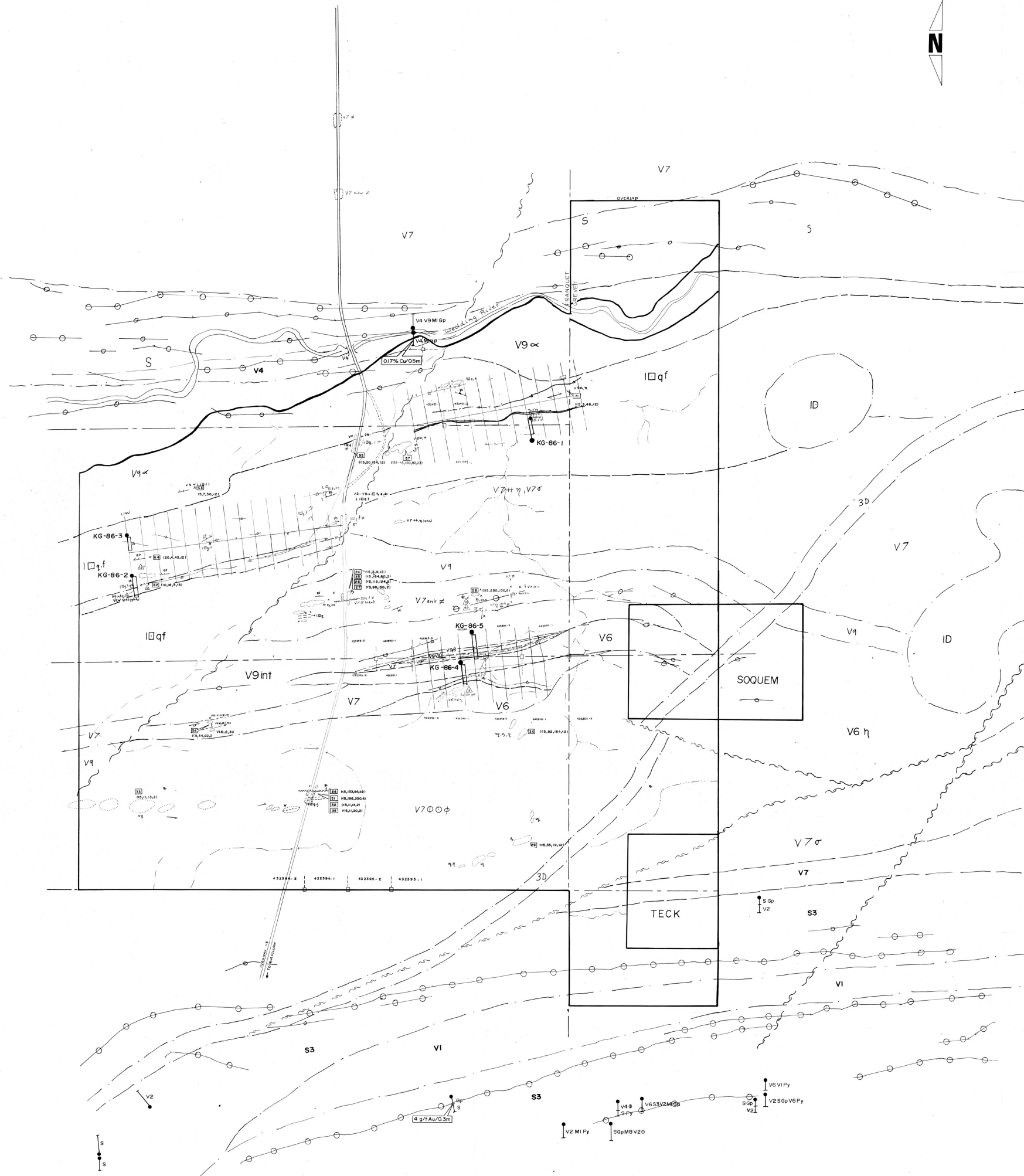

- LEGEND**
- Claim post / Claim line
  - Outcrop
  - Foliation a) inclined b) vertical
  - Bedding a) inclined
  - Geological Contact a) assumed b) after geophysics c) probable
  - Fault a) after geophysics b) known
  - Rock Sample Number 1992
  - Rock Sample Number 1996
  - Au (ppb), Cu (ppm), Zn (ppm), As (ppm)
  - H.E.M. Conductors TTTT Hz

- ROCK SUFFIXES**
- |                    |                            |
|--------------------|----------------------------|
| V6 Andesite        | V7 Basalt                  |
| V9 Tuff            | V10 Agglomerate            |
| I Felsic intrusive | S Undetermined Sedimentary |
| 3D Diabase         | IR Rhyolite                |

- ALTERATION & STRUCTURE SUFFIXES**
- |                              |                              |                |
|------------------------------|------------------------------|----------------|
| α Felsic                     | η Carbonized                 | σ Silicified   |
| φ Chloritized                | π Pyritized                  | † Banded       |
| ○ Amygdaloidal               | Φ Pillowed                   | ▲ Flow Breccia |
| □ Porphyritic (< 50% phenoc) | ▣ Porphyritic (> 50% phenoc) |                |
| ≡ Sheared                    | z                            |                |

- MINERAL SUFFIXES**
- |              |              |              |
|--------------|--------------|--------------|
| v Vein       | j Carbonate  | f Feldspar   |
| Mr Magnetite | q Quartz     | Ank Ankerite |
| k Sericite   | w Tourmaline |              |

Ministère de l'Énergie et des Ressources  
 Service de l'Information  
 Date: 5 NOV 1997  
 No. GM: 44588

200 300 0 200 400 600 meters

Société en Commandite Explorations KERY  
 GREVET PROJECT (Q-28)  
 Franquet Twp (Rg III, Rg IV, Rg V)

**COMPILATION**  
**(WEST SECTOR)**

MAP NO.	SURVEY BY M.L.L.C.J., P.D., F.C. + M.S.
SCALE: 1:10,000	PLOTTED BY M.L.L.C.J., P.D., F.C. + M.S.
DATE: October 1985	DRAWN BY M.G. S.S. G.M.C.
NTS: 3272	APPROVED BY: <i>[Signature]</i>

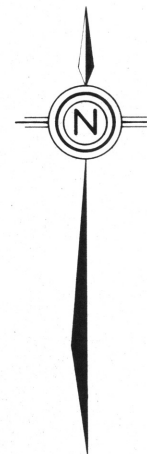

**LEGEND**

ROCK SUFFIXES

- |    |      |    |                  |
|----|------|----|------------------|
| V9 | Tuff | I  | Felsic Intrusive |
|    |      | IS | Syenite          |

ABBREVIATIONS

- |    |            |   |             |
|----|------------|---|-------------|
| Py | Pyrite     | □ | Porphyritic |
| c  | Chlorite   | σ | Silicified  |
| f  | Feldspar   | ≠ | Sheared     |
| j  | Carbonate  | ∠ | Felsic      |
| k  | Sericite   | v | Vein        |
| q  | Quartz     |   |             |
| w  | Tourmaline |   |             |

- |  |  |
|--|--|
|  | Rock Sample Number                               |
|  | Humus Sample Results (Anomalous)                 |
|  | H.E.M. Conductors                                |
|  | Claim Post (assumed)                             |
|  | Outcrop possibility                              |
|  | Creek  |
|  | Swamp  |
|  | Highway  |
|  | Electric line                                    |
|  | Access road                                      |
|  | Trail  |
|  | Geological Contact (inferred)                    |
|  | Kink fold with dip                               |
|  | Foliation a) inclined b) vertical c) dip unknown |

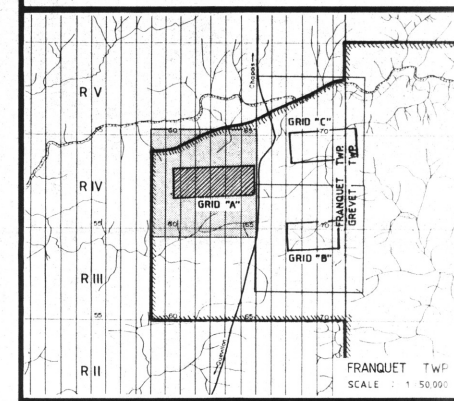

Societe en Commandite Explorations KERY

GREVET PROJECT (Q-28) GRID "A"

Ministère de l'Énergie et des Ressources  
 Service de la Géoinformation  
 Date: 5 JUN 1987  
 No G.M.: 44593  
 Compilation



SURVEY BY VAL D'OR GEOPHYSIQUE LTEE  
 EXECUTED BY B. Clifton, D. Boyer  
 DRAWN BY D. Boyer  
 INTERPRETED BY  
 APPROVED BY Stefan B. Spetzler Feb 87

SCALE: 1:2,500 DWG No:

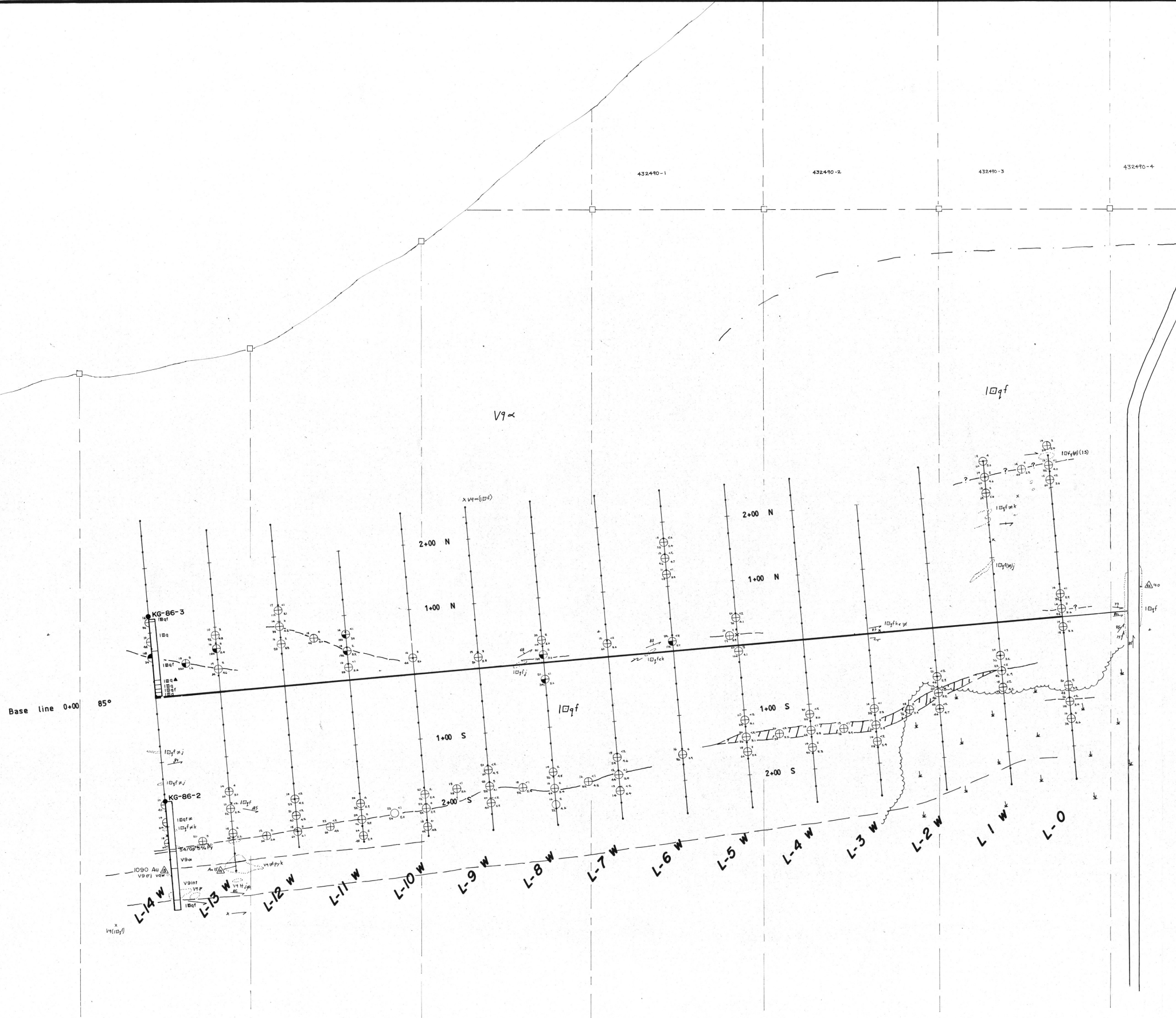

**GRID "A"**

432348-1 432343-2 432371-3 425847-2 425846-1 425846-2 425846-1 425845-2



**LEGEND**

**ROCK SUFFIXES**

V6	Andesite	I	Felsic
V7	Basalt		
V9	Tuff		

**ABBREVIATIONS**

Cp	Chalcopyrite	?	Carbonatized
Py	Pyrite	σ	Silicified
ank	Ankerite	o	Amygdular
j	Carbonate	≠	Sheared
k	Sericite	+	Banded
q	Quartz	v	Vein
e	Epidote	□	Porphyritic

	Rock Sample Number
	Humus Sample Results (anomalous)
	Claim Post (found)
	H.E.M. Conductors
	Magnetic High Axis
	V.L.F. Conductors
	Outcrop possibility
	Creek
	Swamp
	Highway
	Electric line
	Access road
	Trail
	Geological Contact (inferred)
	Foliation a) inclined b) vertical
	Previous Diamond Drill Hole

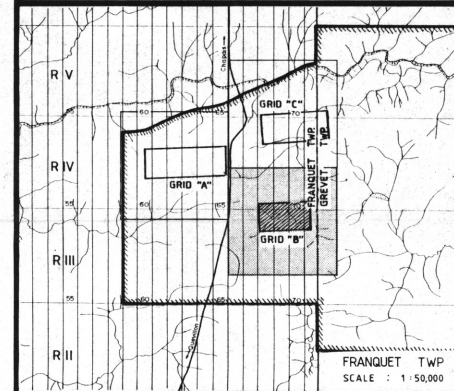

**GRID "B"**

FRANQUET

GREVET

Societe en Commandite Explorations KERY

GREVET PROJECT (Q-28) GRID "B"

Ministère de l'Énergie et des Ressources  
 Service de la Géoinformation  
 Date: 5 JAN 1987  
 No G.M.: 44598 *Compilation*

SURVEY BY VAL D'OR GEOPHYSIQUE LTEE  
 EXECUTED BY B. D'Or, D. Bayer, R. Husack, T. Springs  
 DRAWN BY D. Bayer  
 INTERPRETED BY *Stefan B. Speth*  
 APPROVED BY *Stefan B. Speth* Feb 87  
 SCALE: 1:2,500 DWG No: \_\_\_\_\_

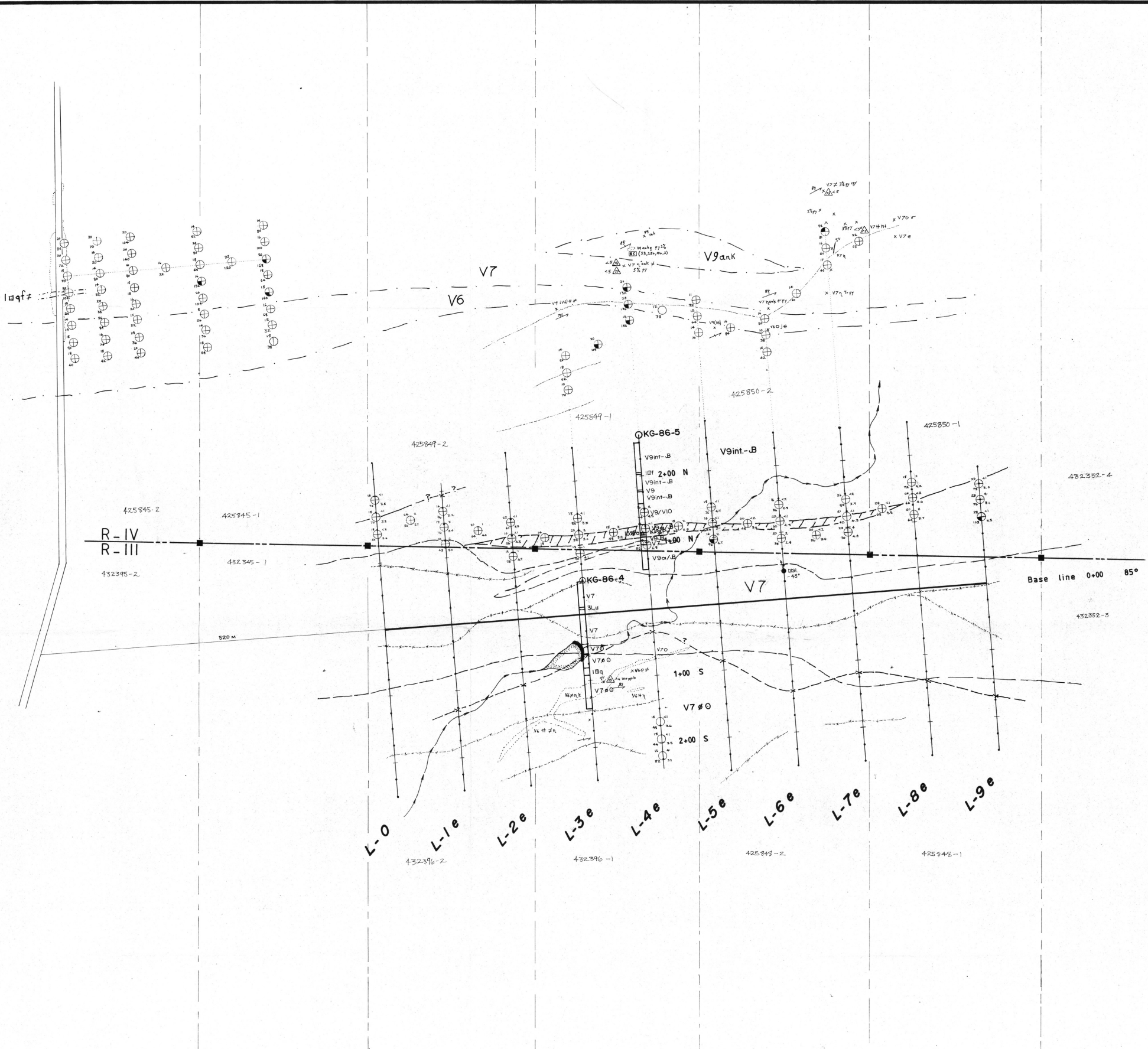



**LEGEND**

ROCK SUFFIXES

- |    |        |   |                  |
|----|--------|---|------------------|
| V9 | Tuff   | I | Felsic Intrusive |
| V7 | Basalt |   |                  |

Abbreviations

- |    |          |   |              |
|----|----------|---|--------------|
| Py | Pyrite   | □ | Porphyritic  |
| q  | Quartz   | ⌘ | Carbonatized |
| f  | Feldspar | ≠ | Sheared      |
| k  | Sericite |   |              |

- Foliation (inclined)
- Geological Contact (inferred)
- Diamond Drill Hole
- Humus Sample Results (anomalous)
- Claim Post (assumed)
- Claim Post (located)
- H.E.M. Conductors
- Outcrop possibility
- Creek
- Swamp
- Highway
- Electric line
- Access road
- Trail

Ministère de l'Énergie et des Ressources  
 Service de la Géoinformation  
 Date: 5 Juin 1987  
 No G.M.: 44589

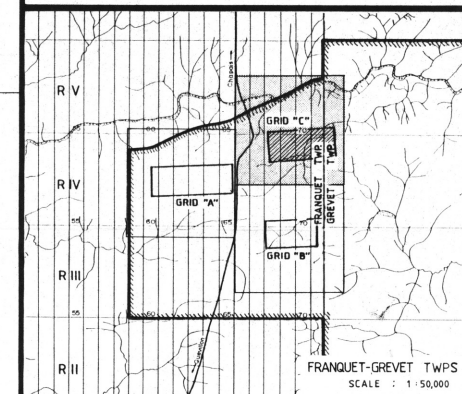

Société en Commandite Explorations KERY

GREVET PROJECT (Q-28) GRID "C"

Compilation

SURVEY BY VAL D'OR GEOPHYSIQUE LTEE  
 EXECUTED BY B. Olson, D. Beyer  
 DRAWN BY D. Beyer  
 INTERPRETED BY  
 APPROVED BY *Stephan B. Laporte* Feb 87

SCALE: 1:2,500 DWG NO: \_\_\_\_\_



**GRID "C"**

FRANQUET GREVET

432350-4

425845-2    425845-1    425849-2    425849-1    425850-2    425850-1

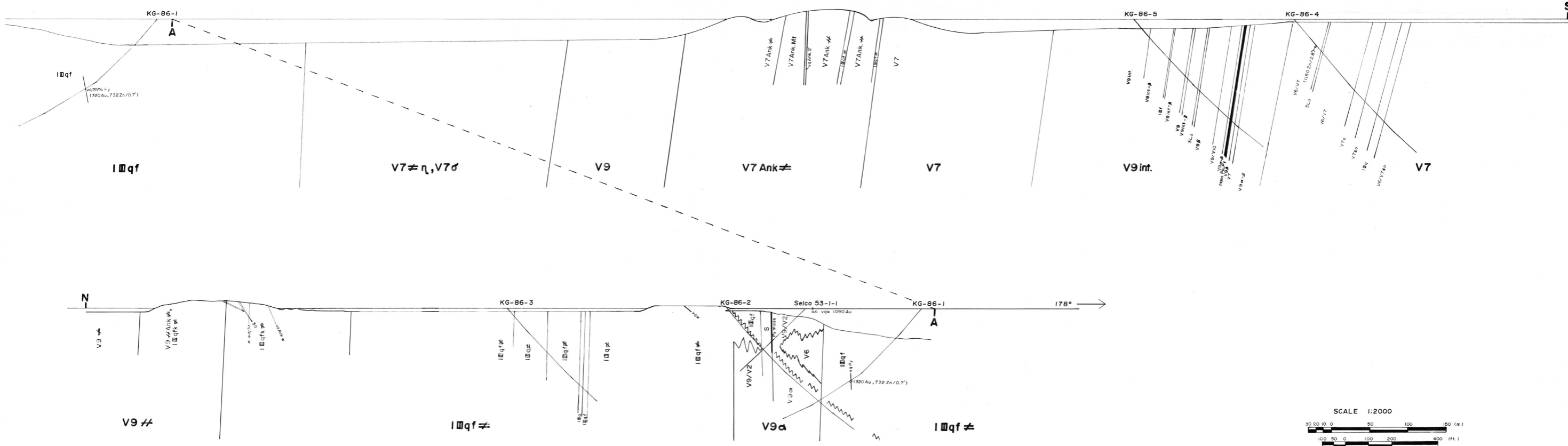

**LOCATION MAP**  
**LEGEND**  
 DDH; KG-86-1-5, 1986  
 Selco 53-1-1, 1953  
 Geologic Contact (extrapolated from geophysics)  
 Fault (from geophysics)  
 Massive Sulphides (Py, Py+Po)  
 Grid Outline  
 Property Boundary

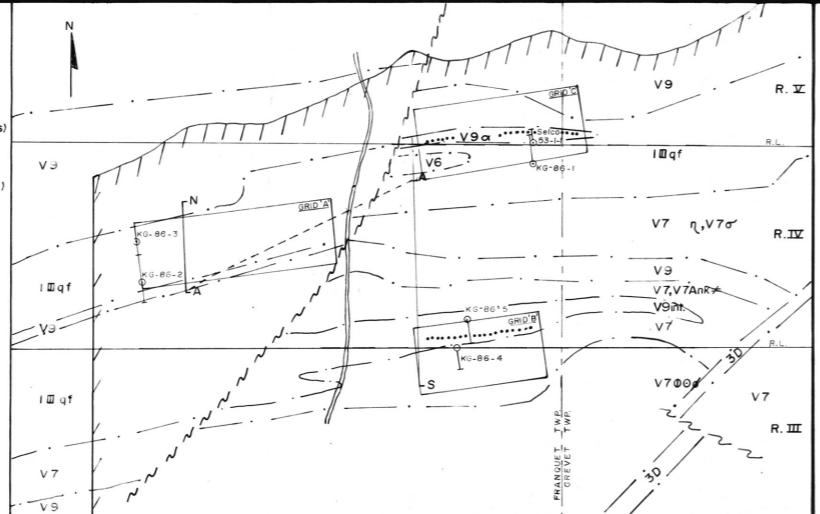

**LEGEND**

I0q	Quartz Porphyry	Ank.	Ankerite
I0qf	Quartz Feldspar Porphyry	k	Sericite
3G	Gabbro	Po	Pyrrhotite
3L	Lamprophyre	Py	Pyrite
V2	Rhyolite	va	Quartz vein
V6	Andesite	Gp	Graphite
V7	Basalt	Mt	Magnetite
V9	Tuff	w	Tourmaline
V10	Agglomerate	≠	Sheared
S	Sediments	---	Fault (from geophys.)
S4	Argillite	#	Banded
α	Felsic	η	Carbonitized
int.	Intermediate	σ	Silicified
β	Mafic		

399Au, 747Zn/2.5'  
 Anomalous values; Au in ppb  
 Zn in ppm

Societe en Commandite Explorations KERY

**GREVET PROPERTY (Q-28)**

**CROSS SECTION "NW SECTOR"**

Holes: KG-86-1, 2, 3, 4 & 5 (1986 DDH program)  
 Selco 53-1-1 (1953 Selco DDH program)

Ministere de l'Energie et des Ressources  
 Service de la Geoinformation  
 Date: 5 JUN 1987  
 No G.M.: 44558

NB: Holes projected along interpreted stratigraphy  
 KG-86-2 & 3 shifted north to correct for fault offset.

SCALE: 1:2000	NTS: 32 F/2	PLOTTED BY: T.L., B.O.
DATE: DEC. 1986	SECTION: NW SECTOR	DRAFTED BY: G.M.C.
MAP NO:	LOOKING: 086°	APPROVED BY: <i>[Signature]</i>

**GEOPHYSICS**

**LEGEND**

Max Min II HEM Survey  
(1777 Hz)

In phase (%)

Out of phase (%)

Magnetic Survey

Total Field (g)

Vert. Grad. (g/m)



**PLAN (Vertical Projection)**

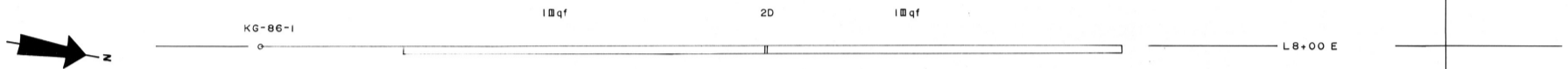

**SECTION (L8+00E)**

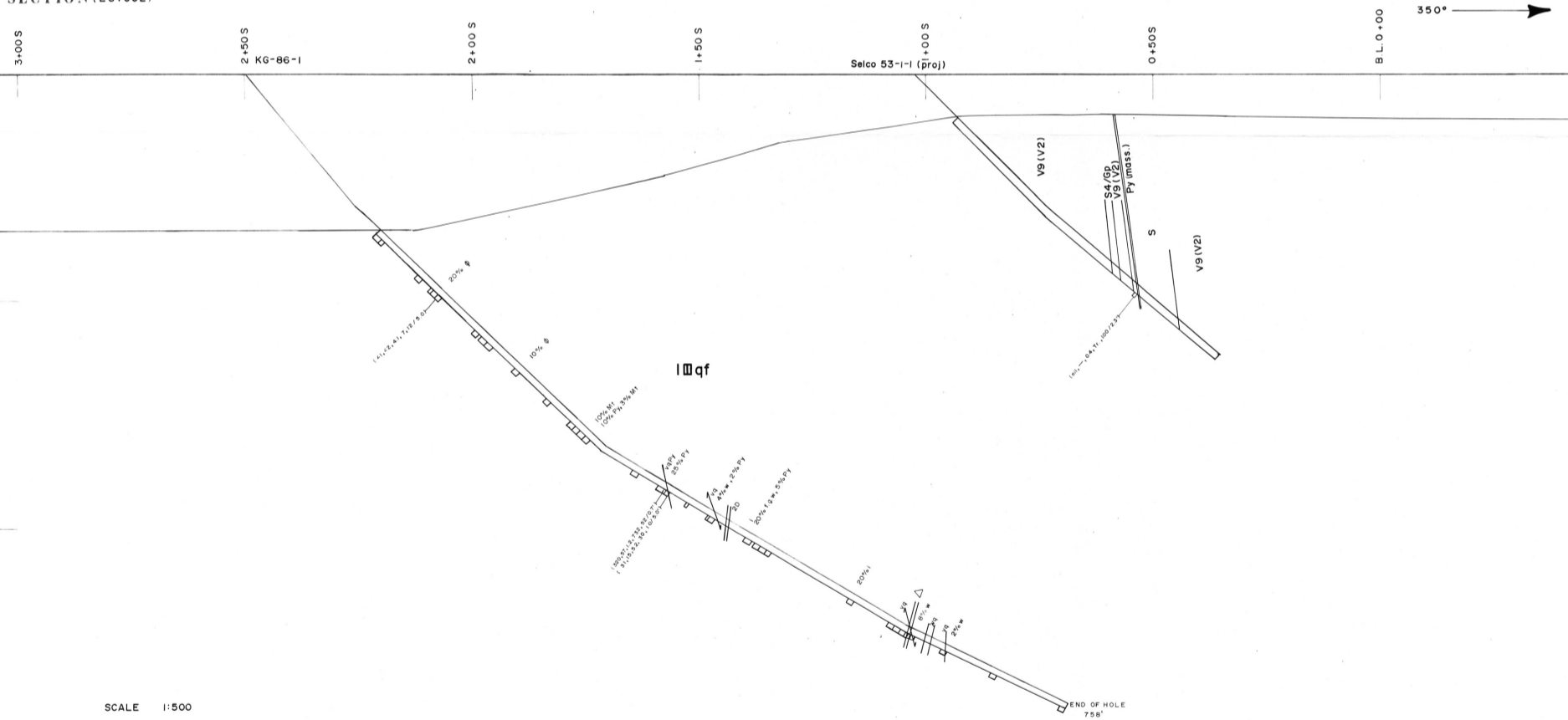

SUFFIXES FOR ROCK TYPES	MINERAL SUFFIXES	ALTERATION SUFFIXES	PETROGRAPHIC AND STRUCTURAL SUFFIXES
V9 Tuff	e Epidote	cl Carbonatized	o Pillowed
V7 Basalt	c Chlorite	si Silicified	△ Porphyritic < 50% phenocrysts
V6 Andesite	j Carbonate	ch Chloritized	□ Brecciated
V5 Mafic to intermediate Volc	q Quartz	h Homotized	Fault
V4 Dacite	t Talc	ser Sericized	# Schistose
V2 Rhyolite	k Sericite	ep Epidotized	∠ Angle of foliation
Mt Schist	w Tourmaline		∠ Angle of veining
2Dq Quartz Diorite	v Vein of		∠ Shear
S Sediment	py Pyrite		○ Amygdaloidal
100qf Quartz Feldspar Porphyry	py Pyrrhotite		○ Drilling drill hole
	mt Magnetite		○ Overburden drill hole
	hem Hematite		○ Au/ppm, As, Ag, Zn, Cu (ppm) / footage

**GREVET PROPERTY (Q-28)**

**DDH SECTION KG-86-1**

Hole: KG-86-1  
 Location: Grid "C", L8+00 E / 2+50 S  
 Azimuth: 350°  
 Dip: -50°  
 Length: 758'



Ministère de l'Énergie et des Ressources  
 Service de la Géoinformation  
 Date: 5 JUN 1987  
 No G.M.L.: 44585

*Stijn B. Logothetis Feb 87*

**GEOPHYSICS**

**LEGEND**

MaxMin II HEM Survey  
(1777 Hz)

In phase (%)  $\triangle$ — $\triangle$   
Out of phase (%)  $\triangle$ - - - $\triangle$

Magnetic Survey

Total field (g)  $\circ$ — $\circ$   
Vert. Grad (g/m)  $\circ$ - - - $\circ$

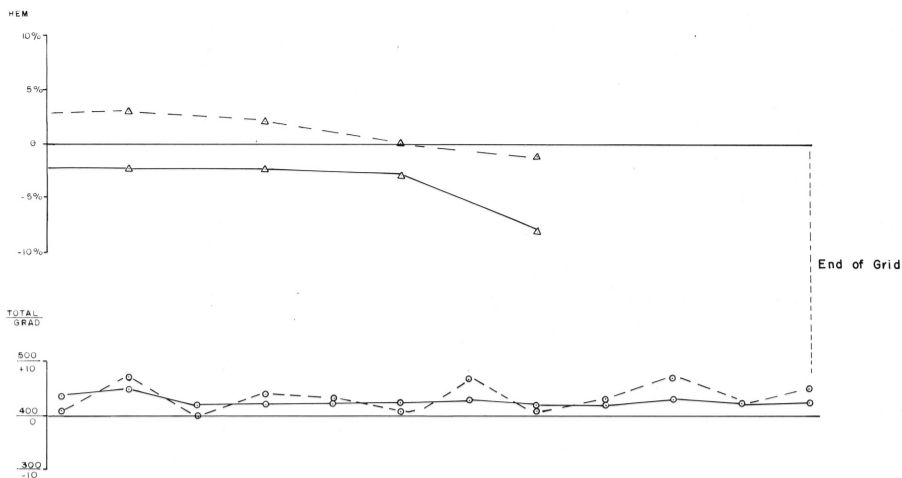

**PLAN (Vertical Projection)**



**SECTION (L14+00W)**

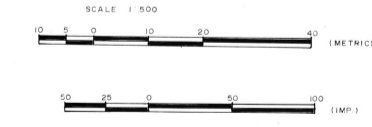
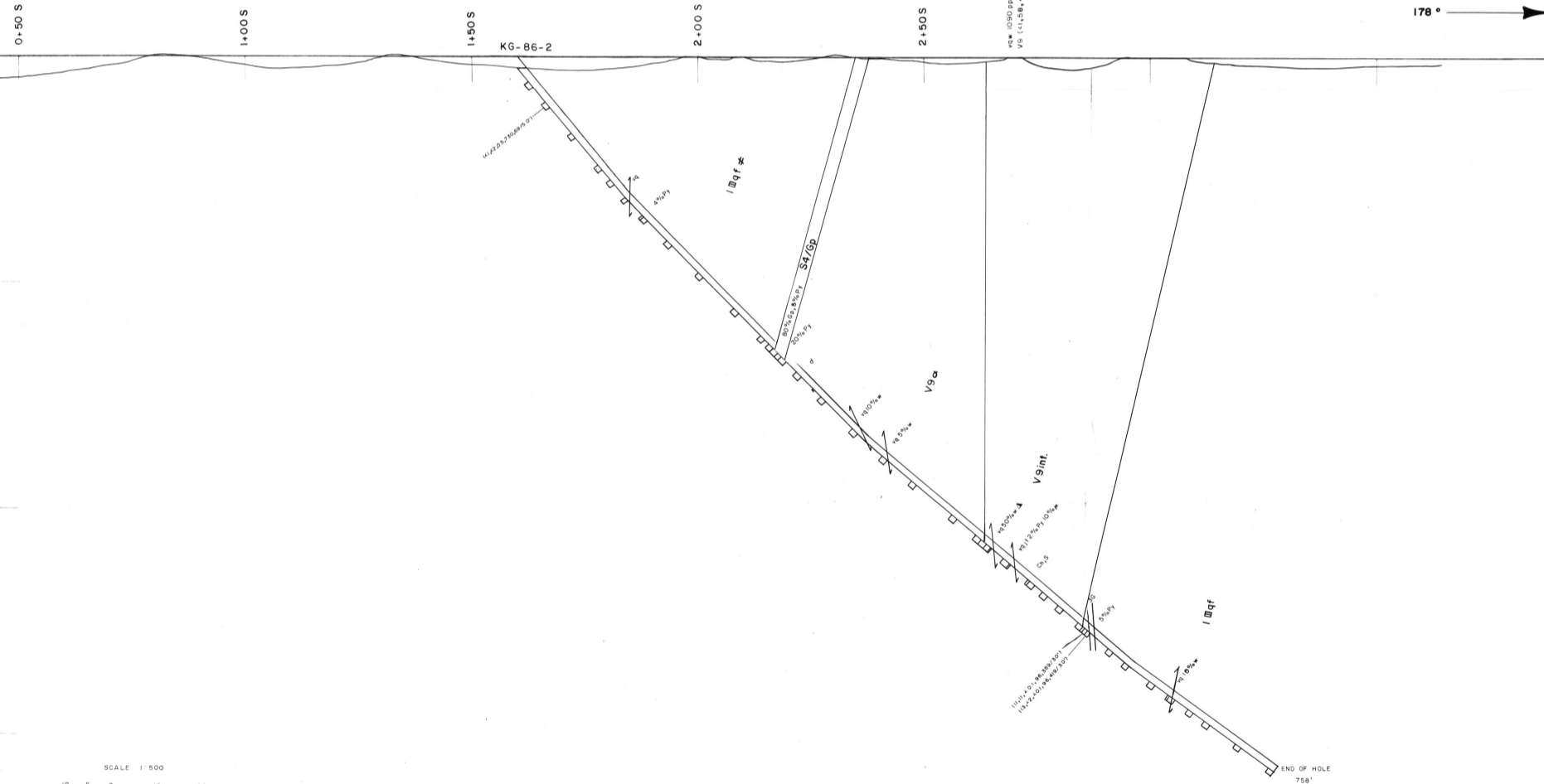

SUFFIXES FOR ROCK TYPES	MINERAL SUFFIXES	ALTERATION SUFFIXES	PETROGRAPHIC AND STRUCTURAL SUFFIXES
V9 Tuff	v Epidote	l Carbonatized	o Riolite
V7 Basalt	c Chlorite	f Silicified	□ Plagioclase + 50% plagioclase
V6 Andesite	j Carbonate	φ Chloritized	△ Brecciated
V5 Mafic to intermediate volc	q Quartz	h Hydrothermal	~ Fault
V4 Dacite	t Talc	λ Sericitized	⊥ Schistose
V2 Rhyolite	k Sericite	E Sphalerized	∠ Angle of foliation
M Schist	w Tourmaline		∠ Angle of zoning
2Dq Quartz Diorite	v Vein of		≡ Sheared
S Sediment	Py Pyrite		⊙ Amygdaloidal
I Bqf Quartz Feldspar Porphyry	Py Pyrite		⊙ Brecciated
	Mt Magnetite		⊙ Overburden Core Hole
	Hm Hematite		⊙ Au (ppm), Ag, Zn, Cu (ppm) / Footage Note: Plotting cut-off values: Au ≥ 20, Ag ≥ 45, Zn ≥ 170, Cu ≥ 90

**GREVET PROPERTY (Q-28)**

**DDH SECTION KG-86-2**

Hole: KG-86-2  
Location: Grid "A", L14+00 W / I+60 S  
Azimuth: 178°  
Dip: -50°  
Length: 758'



Ministère de l'Énergie et des Ressources  
Service de la Géoinformation  
Date: 6 NOV 1987  
No G.M.: 44535





**GEOPHYSICS**

**LEGEND**

Max Min II HEM Survey  
(1777 Hz)

In phase (%)  $\triangle$ — $\triangle$   
Out of phase (%)  $\triangle$ - - - $\triangle$

Magnetic Survey

Total Field (g)  $\circ$ — $\circ$   
Vert. Grad. (g/m)  $\circ$ - - - $\circ$

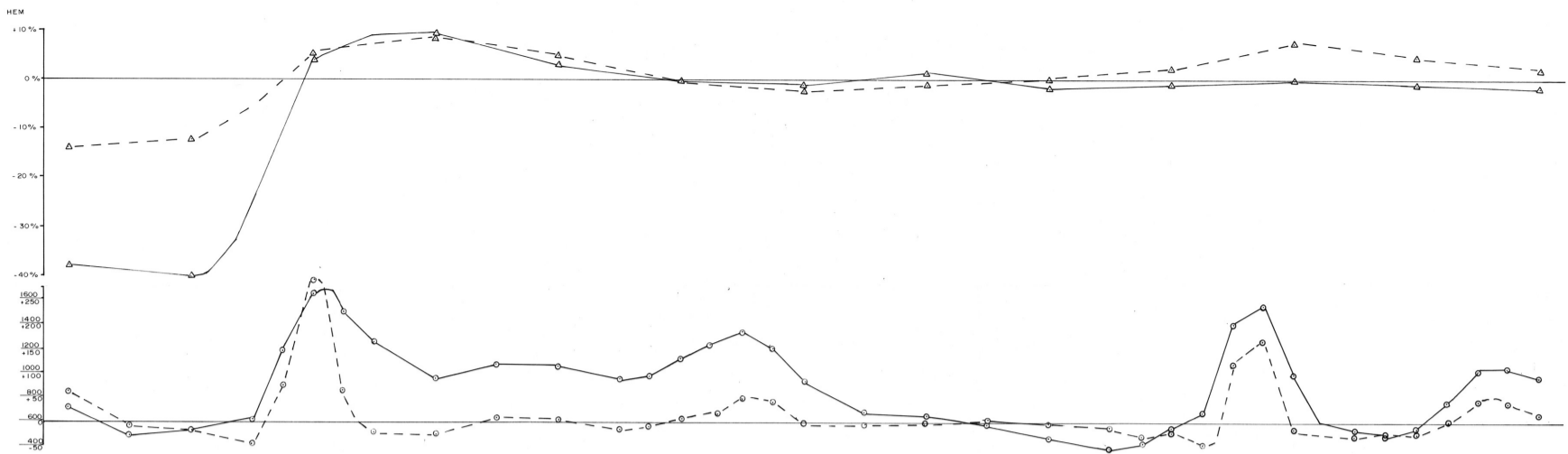

**PLAN (Vertical Projection)**

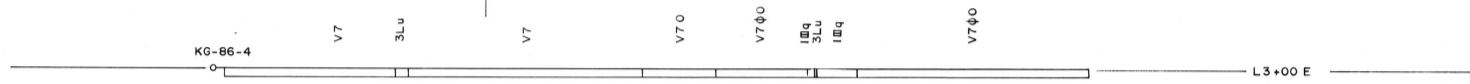

**SECTION (L3+00 E)**

1+50 N 1+00 N 0+50 N B.L. 0+00 0+50 S 1+00 S 1+50 S 175° 2+00 S

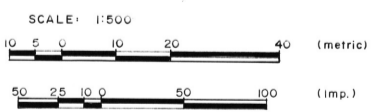
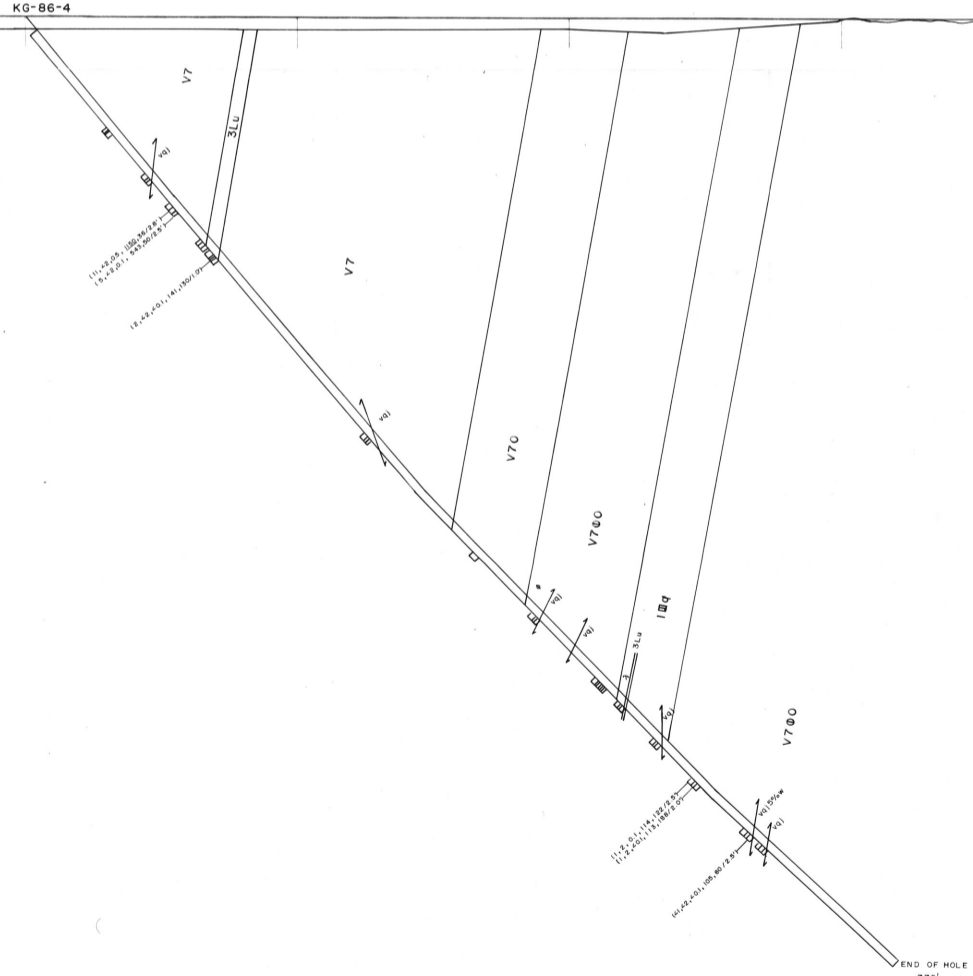

**SUFFIXES FOR ROCK TYPES**

V9	Tuff
V7	Basalt
V6	Andesite
V5	Mafic to intermediate volc
V4	Dacite
V2	Rhyolite
M	Schist
2Dq	Quartz Diorite
S	Sediment
10q	Quartz Porphyry
3L	Lamprophyre

**MINERAL SUFFIXES**

e	Epidote
c	Chlorite
j	Carbonate
q	Quartz
f	Feldspar
k	Sericite
w	Tourmaline
v	Vein of
Py	Pyrite
Py	Pyrrhotite
Mt	Magnetite
Hem	Hematite

**ALTERATION SUFFIXES**

cl	Carbonatized
sf	Silicified
ch	Chloritized
hm	Homogenized
sc	Sericitized
ep	Epidotized

**PETROGRAPHIC AND STRUCTURAL SUFFIXES**

o	Pillowed
pr	Porphyritic + 50% phenocrysts
br	Brecciated
f	Fault
sch	Schistose
∠	Angle of foliation
∠	Angle of veining
she	Sheared
am	Amygdaloidal
di	Dipicoid Drill hole
ob	Overburden: Drill hole
100, 50, 0, 5, 17, 92/50	Angle 1, As, Ag, Zn, Cu ppm 1/footage

Note: Plotting cut-off values  
Au: 20  
As: 20  
Ag: 0.4  
Zn: 160  
Cu: 110

**SUFFIXES FOR COMPOSITION**

fe	Felsic
int	Intermediate
ba	Mafic

**GREVET PROPERTY (Q-28)**

**DDH SECTION KG-86-4**

Hole: KG-86-4  
Location: Grid "B", L 3+00 E / 0+50 N  
Azimuth: 175°  
Dip: -50°  
Length: 776'



Ministère de l'Énergie et des Ressources  
Service de la Géoinformation  
Date: 5 JUN 1987  
No G.M.: 44555

Société en Commandite Explorations KERY

SECTION  
GRID "B", L3+00 E

1:500  
DEC. '86  
T.L.  
G.M.C.

*Stefan B. Laporte Feb '87*

**GEOPHYSICS**

**LEGEND**

Max Min  $\square$  HEM Survey  
(1777 Hz)

In phase (%) ———  
Out of phase (%) - - - -



**PLAN (VERTICAL PROJECTION)**

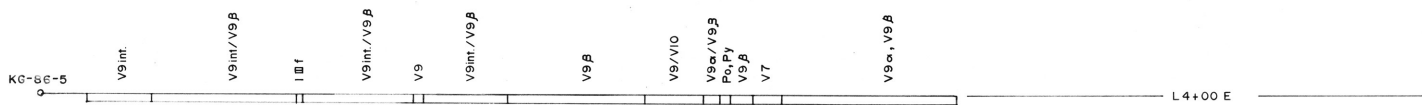

**SECTION**

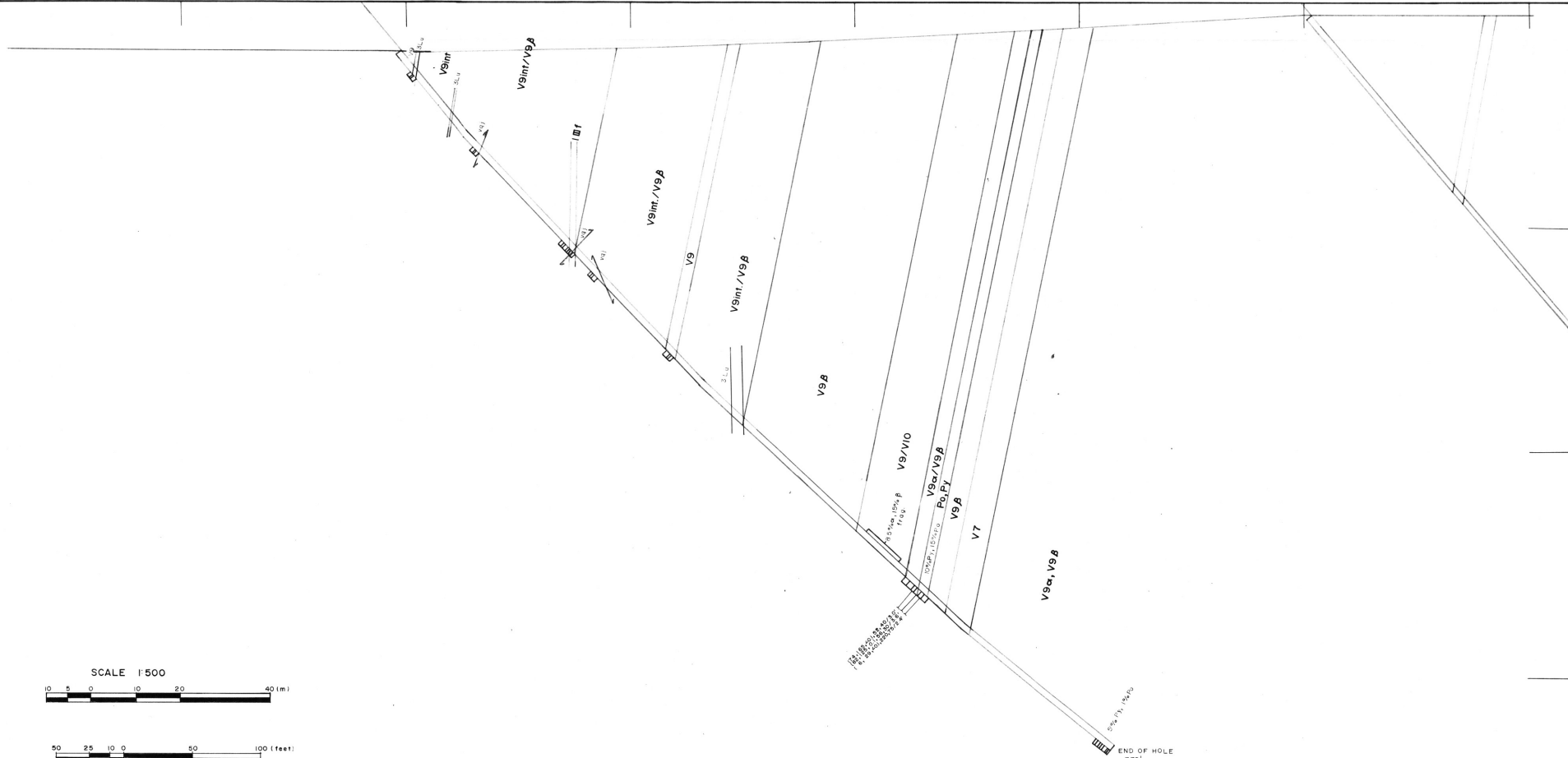

SUFFIXES FOR ROCK TYPES	MINERAL SUFFIXES	ALTERATION SUFFIXES	PETROGRAPHIC AND STRUCTURAL SUFFIXES
V9 Tuff	e Epidote	cl Carbonatized	O Pillowed
V7 Basalt	c Chlorite	sl Silicified	□ Porphyritic > 50% phenocrysts
V6 Andesite	j Carbonate	cl Chloritized	△ Brecciated
V5 Mafic to intermediate Volc	q Quartz	h Hematized	~ Fault
V4 Dacite	t Talc	λ Sericitized	# Schistose
V2 Rhyolite	k Sericite	ε Epitaxial	∠ Angle of foliation
M Schist	w Tourmaline		∠ Angle of veining
2Dq Quartz Diorite	v Vein of		≡ Sheared
S Sediment	Py Pyrite		⊙ Amygdaloidal
IPt Feldspar Porphyry	Po Pyrrhotite		⊙ Diamond Drill Hole
3L Lamprophyre	Mt Magnetite		⊙ Overburden Drill Hole
	Hem Hematite		
	a Amphibole		

**GREVET PROPERTY (Q-28)**

**DDH SECTION KG-86-5**

Hole: KG-86-5  
Location: Grid "B", L4+00E / 2+60N  
Azimuth: 175°  
Dip: -50°  
Length: 778'



Ministère de l'Énergie et des Ressources  
Service de la Géoinformation  
Date: 5 JAN 1987  
No G.M.: 44588