

LEGEND

- 13 Diabase
 - 12 Granite
 - 11 Undifferentiated Hornblende Gneiss and Gabbro
 - 10 Gabbro
 - 9 Migmatite
 - 8 Migmatized Hornblende Gneiss
 - 7 Basic Hornblende Gneiss
 - 6 Biotite Gneiss
 - 5 Carbonate - Scapolite Amphibolite
 - 4 Rusty Weathering Gneiss
 - 3 Marble
 - 2 Granular Amphibolite
 - 1 Banded Hornblende and Biotite Gneiss
 - Strike and Dip
 - Geological Boundary
- SCALE**
0 1 2
miles

MAPPED BY OSBORNE, 1944

LACANA MINING CORPORATION LACANA EX (1981) INC.

NEW CALUMET MINES LTD. PROPERTY
GRAND CALUMET ISLAND TWP., QUEBEC
J. MacLATCHY OPTION
**GENERAL GEOLOGICAL MAP
OF CALUMET ISLAND**

MER-GÉOINFORMATION 1987

GM 44397

PREPARED	DATE	SCALE	PROJECT	MAP SHEET	FIGURE
	12/86		6303		5

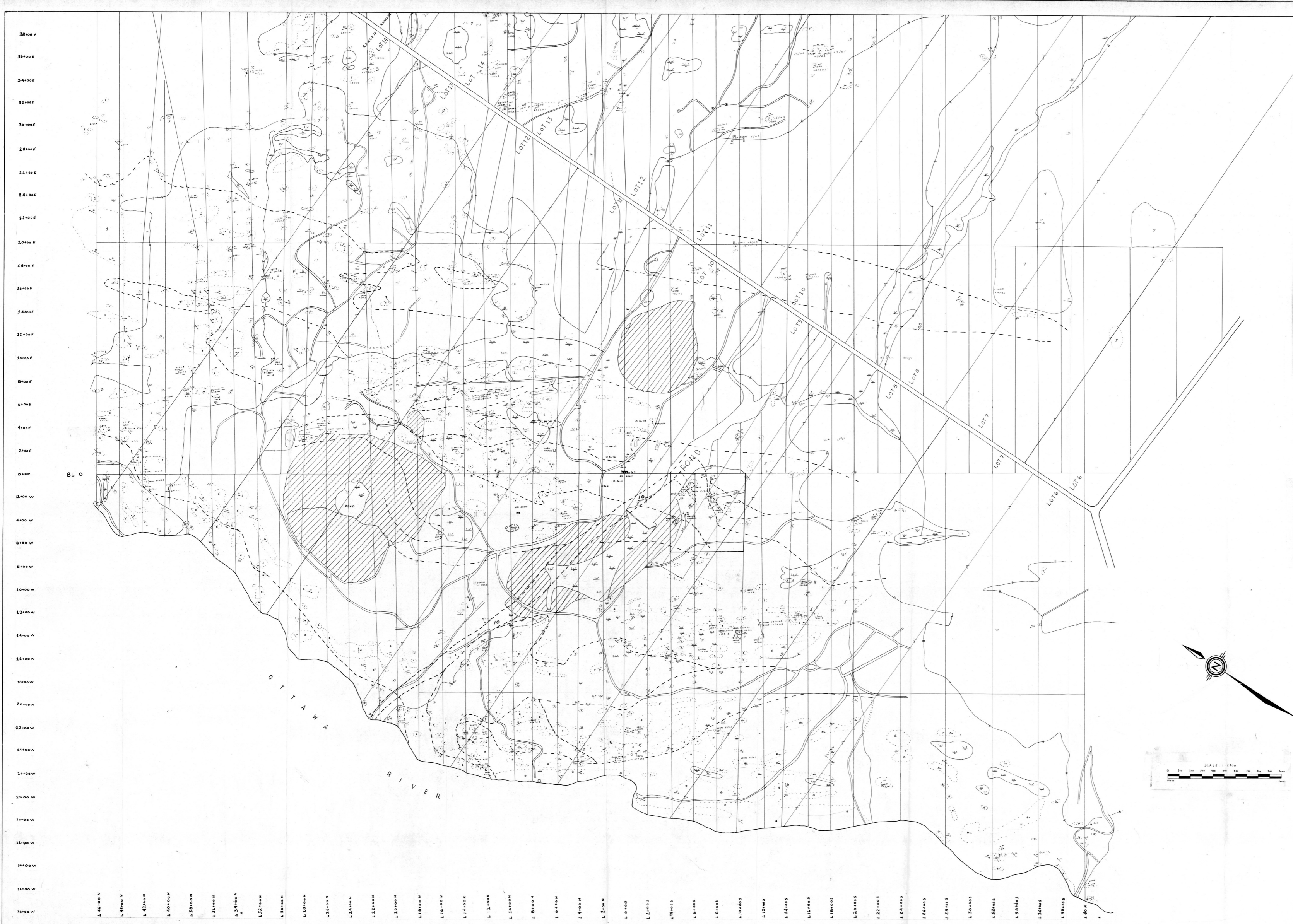

LEGEND

10	DIABASE
9	PEGMATITE
8	MARBLE: CALCAREOUS TO SOLO WHITE (SILICIFIED DOLMITE, QUARTZITE, META-ARENITE)
7	PORPHYROBLASTIC HORNBLENSE GNEISS
6	HORNBLENSE BIOTITE GNEISS: MAFIC, POORLY TO MODERATELY FOLIATED
5	AMPHIBOLITE: FINE GRAIN, DARK GREEN
4	MINERALISED AND ALTERED ZONE
3	MASSIVE SULPHIDES: FREQUENTLY AND USUALLY IN CARBONATE MATRIX: 1-2% Cu, Fe, Zn
2	WHITE CARBONATE: 2-4% CALCITE WITH MINOR TO MODERATE SPHERULATED QUARTZ: 1-2% Fe, Mn, Ni, Pb, Zn, Ag, Au, U, Th, Radium
1	CALC-SILICATES: 1-2% MAFIC TALL, USUALLY AND USUALLY QUARTZ, PROPORTION TO QUARTZ: 1-2% Fe, Mn, Ni, Pb, Zn, Ag, Au, U, Th, Radium
0	COARSE BLACK BIOTITE: UNFOLIATED TO MODERATELY FOLIATED: 7% Ca, Fe, Pb, Zn, Ag, Au, U, Th, Radium
0	SILICIOUS BIOTITE GNEISS WITH GARNETS, Ca, Ca
3	SILICIOUS QUARTZ BIOTITE GNEISS: MINE UNIT MINOR MINERALISATION BY AN UNIDENTIFIED SULPHIDE: 1-2% Cu, Fe, Zn, Ag, Au, U, Th, Radium
2	ALTERED AMPHIBOLITE: FORMING WALLS AND CONTACTS: MODERATE TO HIGHLY FOLIATED: 1-2% Cu, Fe, Zn, Ag, Au, U, Th, Radium
1	LEUCOCATIC QUARTZ BIOTITE GNEISS: FOLIATED, USUALLY UNFOLIATED: 1-2% Cu, Fe, Zn, Ag, Au, U, Th, Radium
0	QUARTZ BIOTITE GNEISS: 1-2% Cu, Fe, Zn, Ag, Au, U, Th, Radium
0	DISSEMINATED MAGNETITE
0	QUARTZ VEIN
0	QUARTZ CARBONATE VEIN
0	CALCITE
0	TREMOLITE ACTINOLITE
0	HEMATITE
0	GRAPHITE
0	SPHALERITE
0	GALENA
0	CALCOPRITE
0	FRYBITE
0	PRYBITE
0	ARSENOPHYTE
0	VISIBLE GOLD
0	MAGNETITE
0	GEOLOGICAL CONTACT
0	OUTCROP, ROCK TYPE
0	FOLIATION (DIP)
0	FOLD AXIS PLUNGE
0	MINERAL LOCATION
0	SAMPLE LOCATION, NUMBER: A-100 / A-101
0	MINOR FOLDS
0	TAILINGS PILES
0	ROAD
0	HOUSE OR OLD MINE BUILDING
0	SWAMP
0	CREEK
0	BEAVER DAM
0	EDGE OF FOREST AND CULTIVATED LAND
0	PIT
0	TRENCH

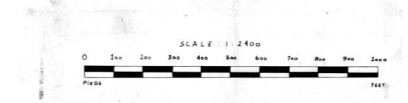

Ministère de l'Énergie et des Ressources
Service de la Géoinformation
No. G.M. 14397







LACANA MINING CORPORATION LACANA EX (1981) INC.

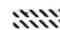
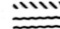

NEW CALUMET MINES LTD. PROPERTY
GRAND CALUMET ISLAND TWP., QUEBEC
J. MACLATCHY OPTION

PROPERTY GEOLOGY-MINE GRID

PREPARED	DATE	SCALE	PROJECT	MAP SHEET	FIGURE
C.B.	12/84	1:2400	6303		6

LEGEND

-  CARBONATED AMPHIBOLITE
-  SILICEOUS BIOTITE GNEISS
-  MASSIVE SULPHIDES
-  ALTERATION ZONE
-  GOLD MIGMATITE ZONE
-  LEUCOCRATIC BIOTITE GNEISS
-  MAGNETITE BEARING HORIZON

-  MINE WORKINGS
-  LACANA DDH

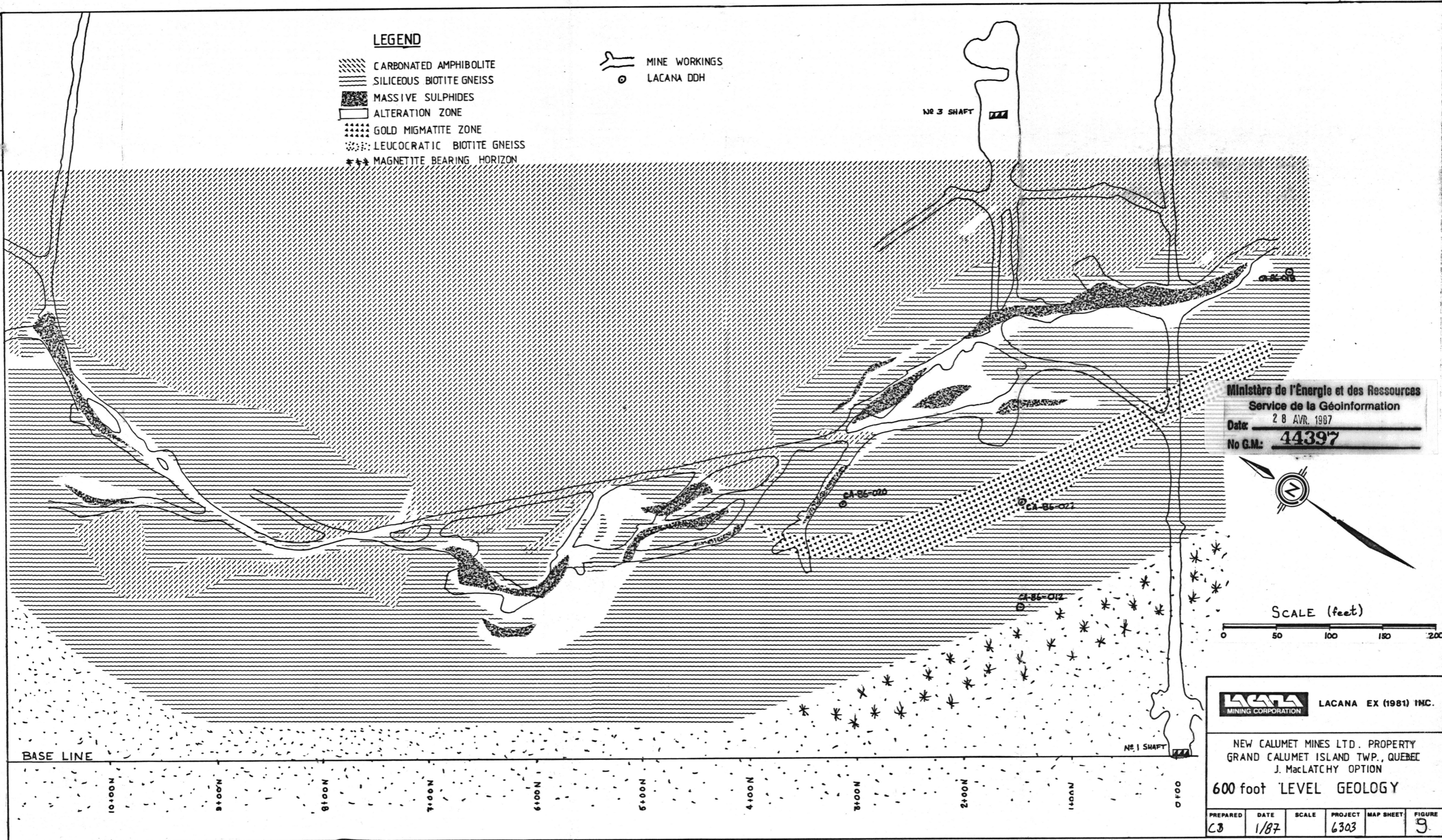

Ministère de l'Énergie et des Ressources
 Service de la Géoinformation
 Date: 28 AVR, 1987
 No G.M.: 44397

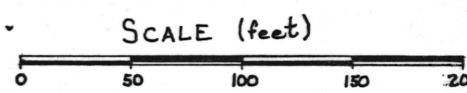
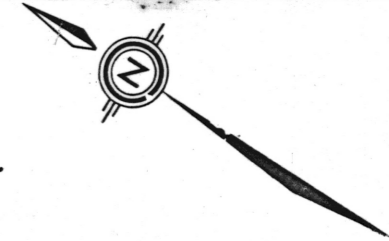

LACANA MINING CORPORATION LACANA EX (1981) INC.

NEW CALUMET MINES LTD. PROPERTY
 GRAND CALUMET ISLAND TWP., QUEBEC
 J. MacLATCHY OPTION
 600 foot LEVEL GEOLOGY

PREPARED	DATE	SCALE	PROJECT	MAP SHEET	FIGURE
CB	1/87		6303		9

MACDONALD PIT
FIGURE 14

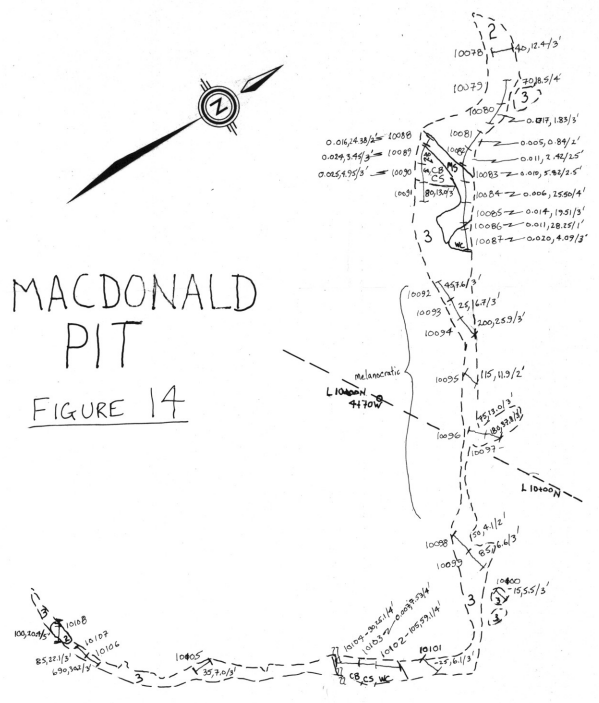

ST. ANNE TRENCH #1
FIGURE 17

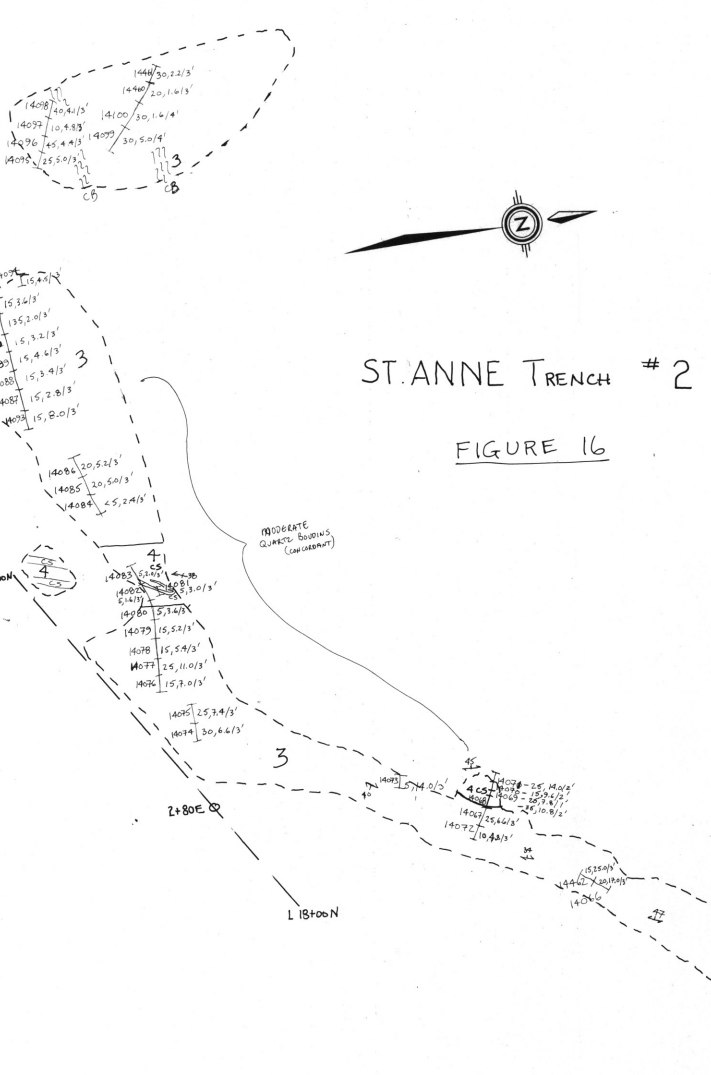
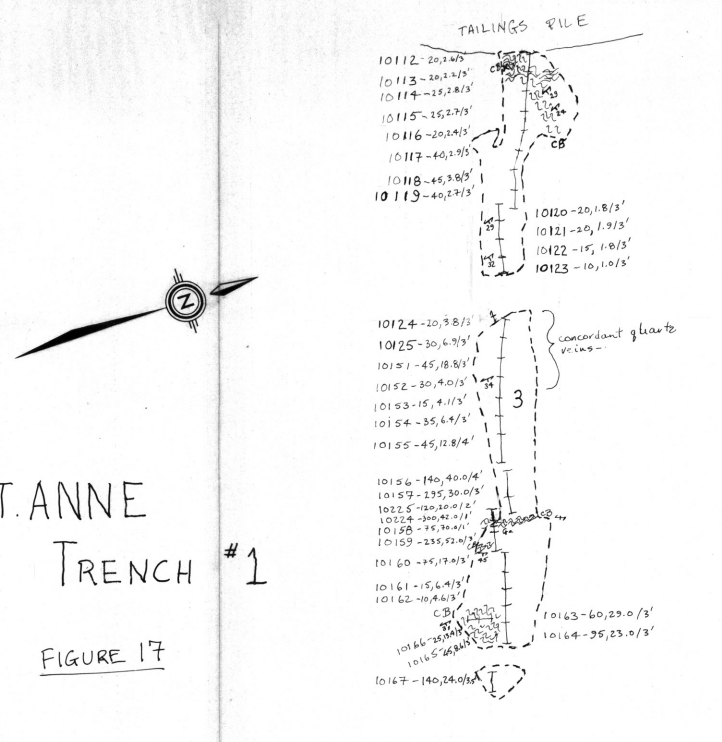

ST. ANNE TRENCH #2
FIGURE 16

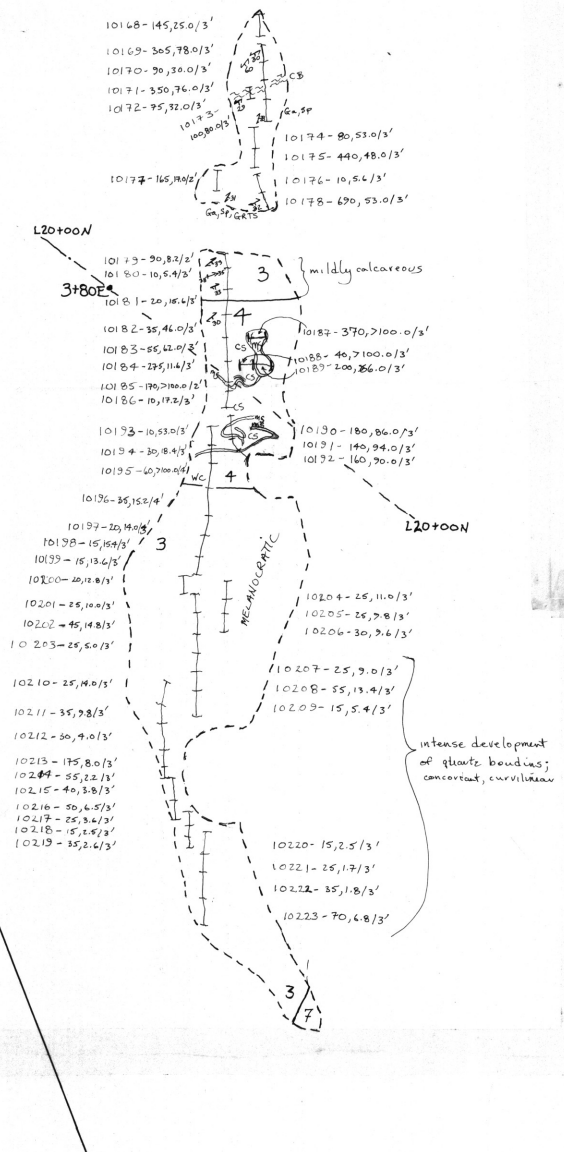

RUSSEL TRENCH
FIGURE 15

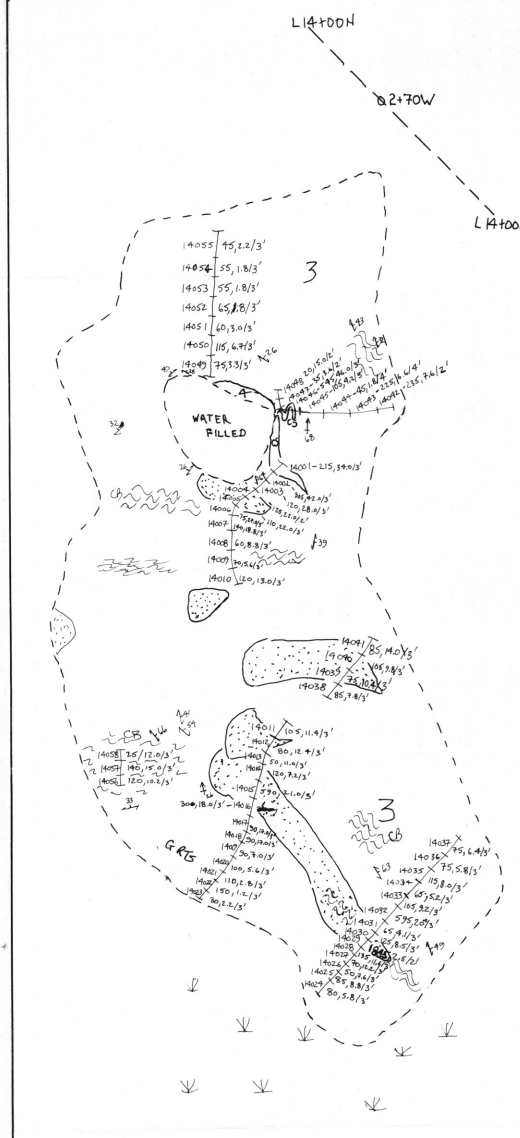

LEGEND

- [7] HORNEBLENDE GNEISS
- [4] MINERALIZED AND ALTERED ZONE
- [M3] MASSIVE SULPHIDES
- [WC] WHITE CARBONATE
- [CS] CALC-SILICATES
- [CB] COARSE BIOTITE
- [3] SILICEOUS BIOTITE GNEISS - HOSTS UNIT 4
- [2] ALTERED AMPHIBOLITE - CARBONATED TO SILICIFIED
- COARSE MICA
- STRUCTURAL PATTERN
- 30 FOLIATION (DIP)
- 20+ FOLD AXIS (PLUNGE)
- GEOLOGICAL CONTACT
- OUT CROP PERIMETER
- GRID CROSS-LINE
- 14000 SAMPLE NUMBER
- CONTINUOUS CHIP SAMPLE INTERVAL
- 14000X GRAB SAMPLE
- 50,10,1/3 SAMPLE RESULTS GOLD (PPM), SILVER (PPM), INTERMETAL WIDTH (GWT)
- GA GALENA
- SP SPHALERITE
- Chalco CHALCOPYRITE
- Bi BIOTITE
- Qtz QUARTZ
- QB QUARTZ BOULDER
- Pb PYRROPHITE
- DISSEMINATED AND BLEBBY SULPHIDES (Sp, Pb, Fe, Ar, etc)

* SEE 1:1200 SCALE GEOLOGY MAP FOR LOCATIONS (FIGURE)

SCALE 1 inch = 10 feet

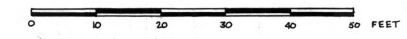

Ministère de l'Énergie et des Ressources
Service de l'Information
Date: 28 Jan 1981
No. GL: 44397

LACANA MINING CORPORATION LACANA EX (1981) INC.

NEW CALUMET MINES LTD. PROPERTY
GRAND CALUMET ISLAND TWP., QUEBEC
J. MacLATCHY OPTION

MACDONALD, RUSSEL, AND STANNE TRENCH

PREPARED	DATE	SCALE	PROJECT	MAP SHEET	FIGURE
	12/86	1:120	6303		13

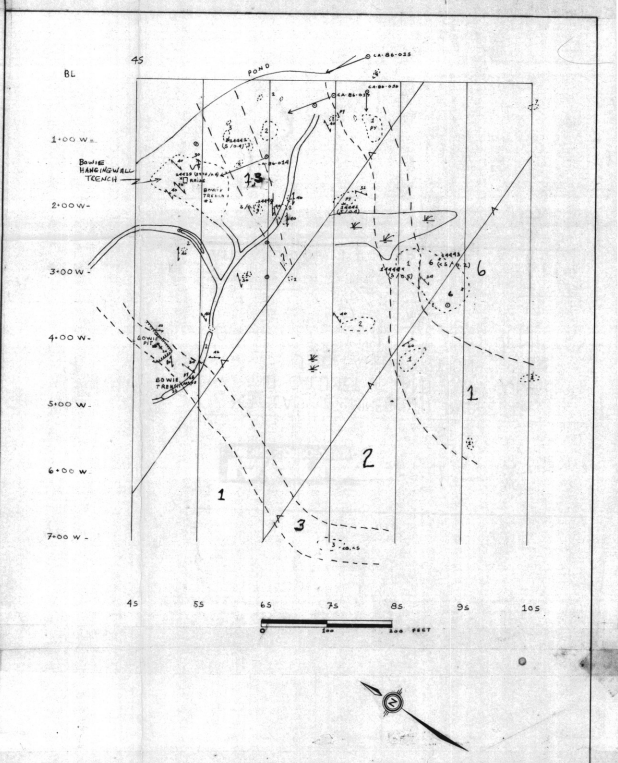
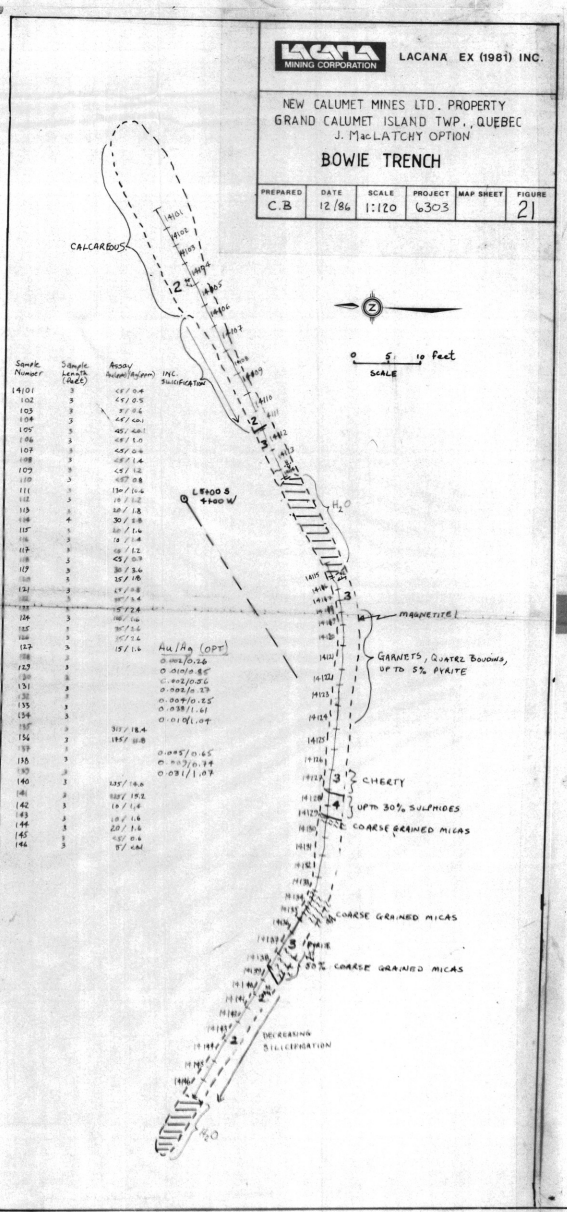
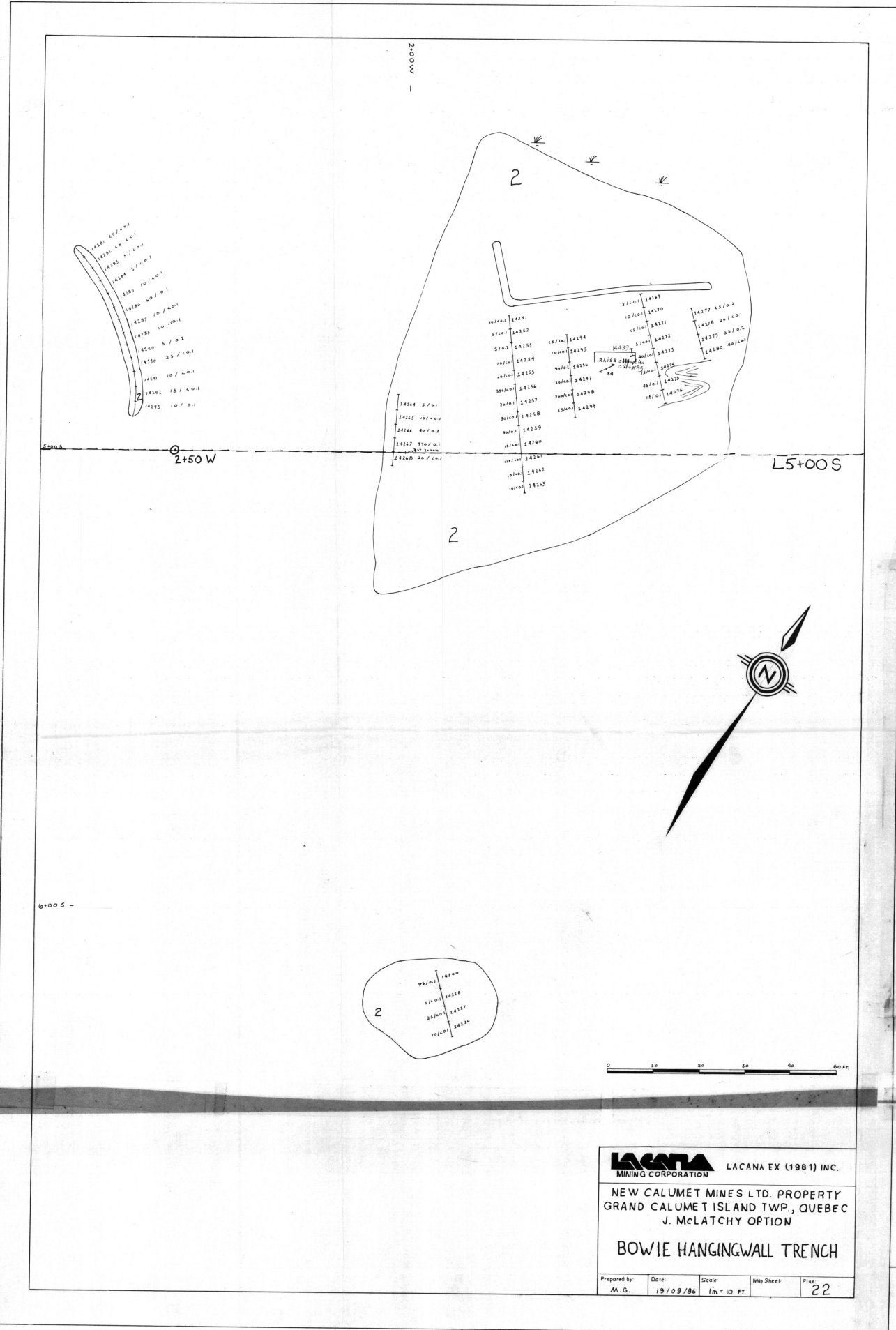
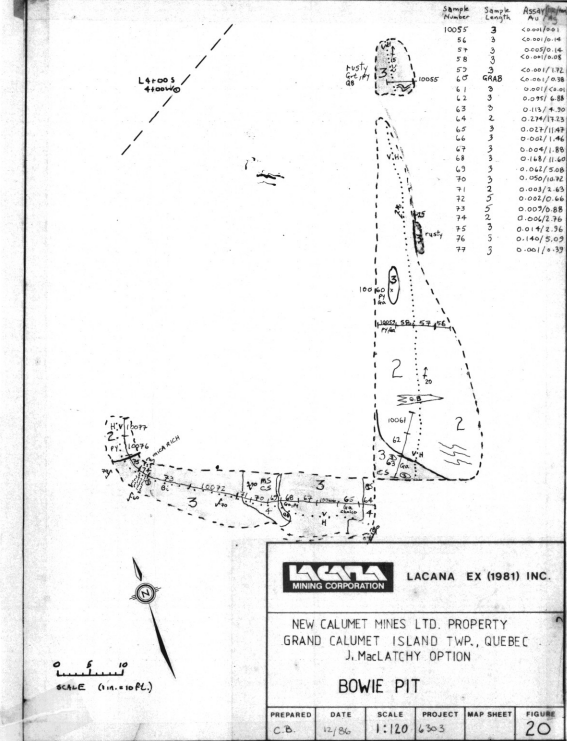

- LEGEND**
- ① PERMATITE
 - ② AMPHIBOLITE - Fine grained, green
 - ③ MINERALIZED AND ALTERED ZONE INCLUDING MS - MASSIVE SULPHIDES WC - WHITE CARBONATE CS - CALC - SILICATES CB - COARSE BIOTITE
 - ④ SILICEOUS BIOTITE GNEISS - HOSTS MINERALIZATION
 - ⑤ CARBONATE ALTERED AMPHIBOLITE (26) SILICIFIED
 - ⑥ LEUCOCRATIC TO MESOCRATIC BIOTITE GNEISS
 - ⑦ COARSE MICA ZONE
- 1000 - SWAMP
 - 50/52 - CONTINUOUS OR SAMPLE
 - X - GROSS SAMPLE
 - - GEOLOGICAL BOUNDARY (PRESUMED, KNOWN)
 - 90° - FOLIATION (DIP)
 - 15° - MINOR FOLD AXIS (PLUNGE)
 - - OUTCROP PERIMETER
 - - VERTICAL/HORIZONTAL FACES
 - - STRUCTURAL PATTERN
 - - LACANA DRILL HOLE - 1986
 - - NEW CALUMET MINE LN. DRILL HOLE
 - X - SWAMP
 - - FENCE (LO-LINE)
 - PY - PYRITE
 - Ca - GALENA
 - SP - SPHALERITE
 - Po - PYRRHOTITE
 - Bi - BIOTITE
 - Gvt - GARNETS
 - Chalco - CHALCOPYRITE
 - QB - QUARTZ BOUNDIN

LACANA MINING CORPORATION LACANA EX (1981) INC.

NEW CALUMET MINES LTD. PROPERTY
 GRAND CALUMET ISLAND TWP., QUEBEC
 J. MacLATCHY OPTION
BOWIE ZONE GEOLOGY AND SURFACE WORKINGS

PREPARED	DATE	SCALE	PROJECT	MAP SHEET	FIGURE
M.G.	12/86	1:120	6303	18	

Ministère de l'Énergie et des Ressources
 Service de la Géoinformation
 Date: 28 JUN 1987
 No. G.M.: 44397

GOLD

CONTOURS (ppb)

- 3
- 6
- 9
- 12
- 15
- 20
- 25
- 30
- 40
- 50

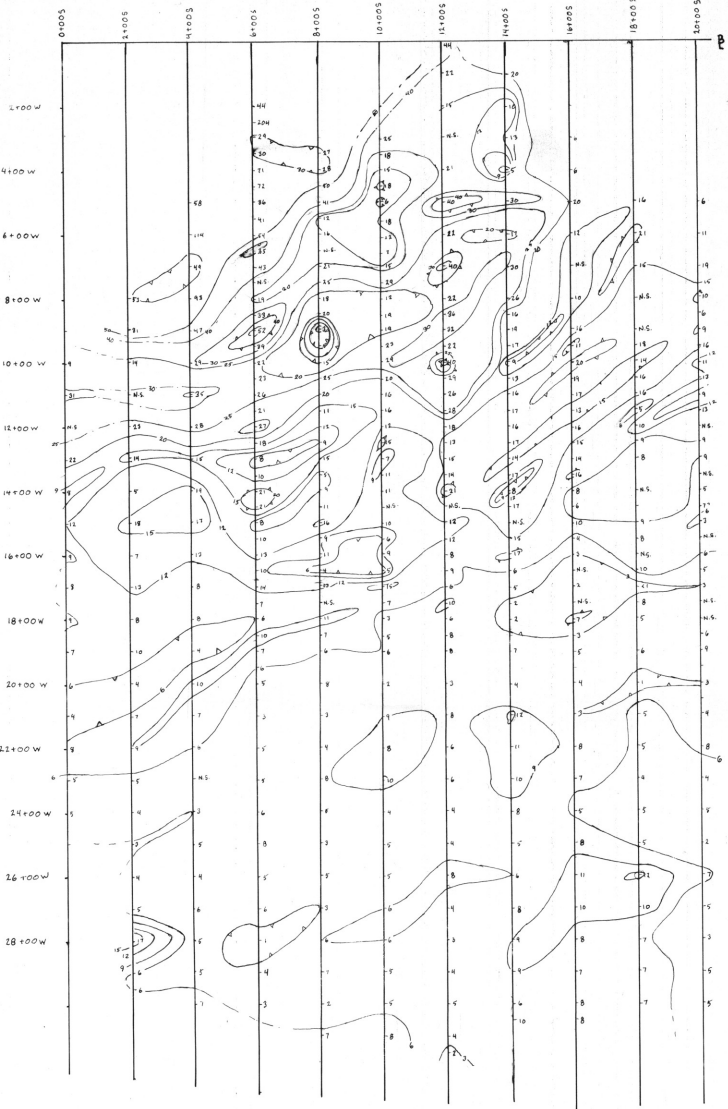

SILVER

CONTOURS (ppm)

- 0.3
- 0.5
- 0.7
- 1.0
- 1.5
- 2.0
- 3.0
- 5.0
- 7.5
- 9.0

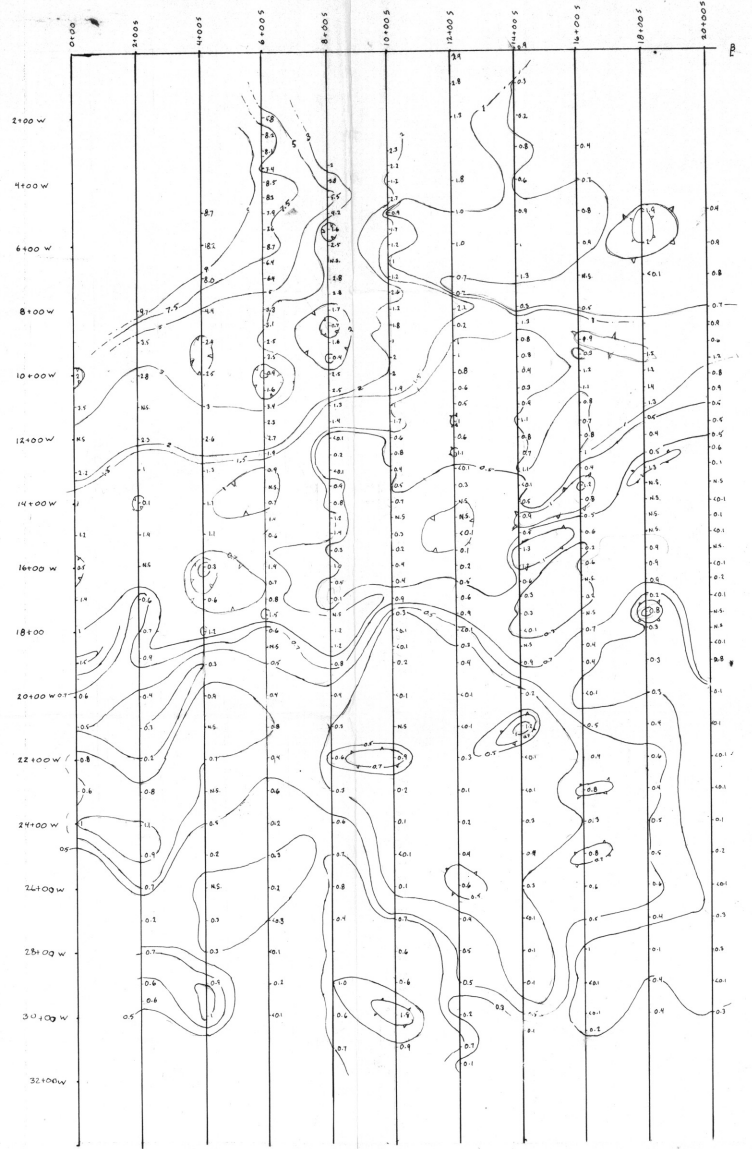

ZINC

CONTOURS (ppm)

- 100
- 200
- 300
- 400
- 500
- 600
- 800
- 1000
- 1200
- 1500

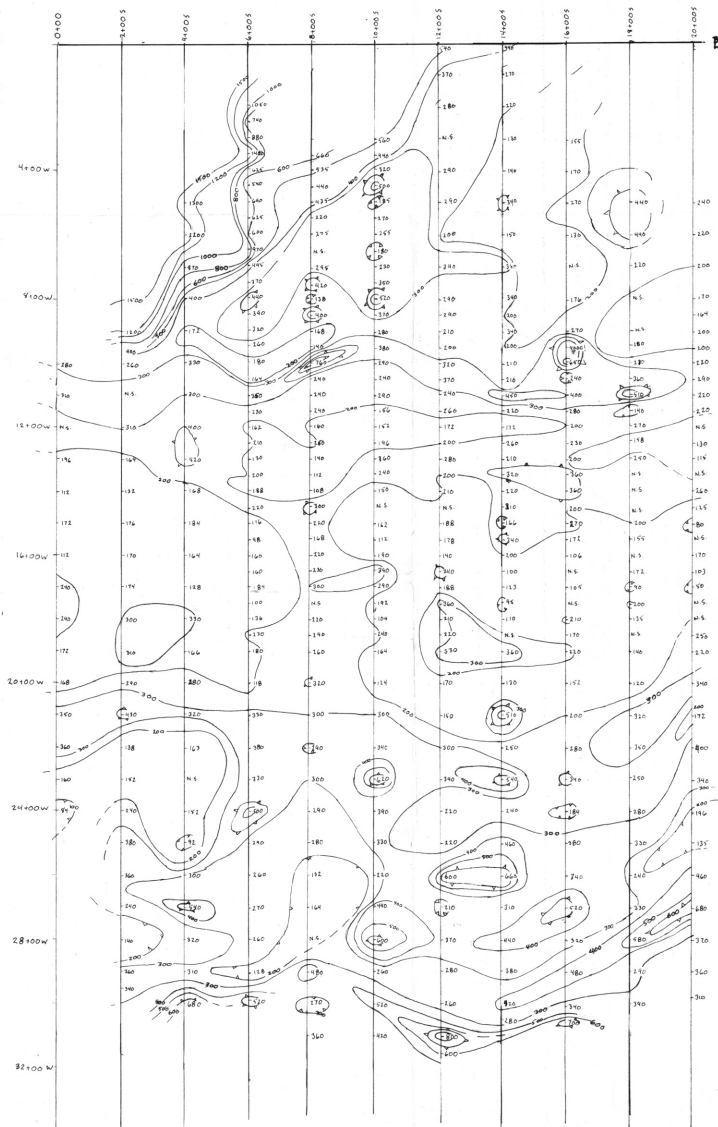

LEAD

CONTOURS (ppm)

- 100
- 200
- 300
- 400
- 500
- 600
- 700
- 800
- 900
- 1000
- 1100
- 1200

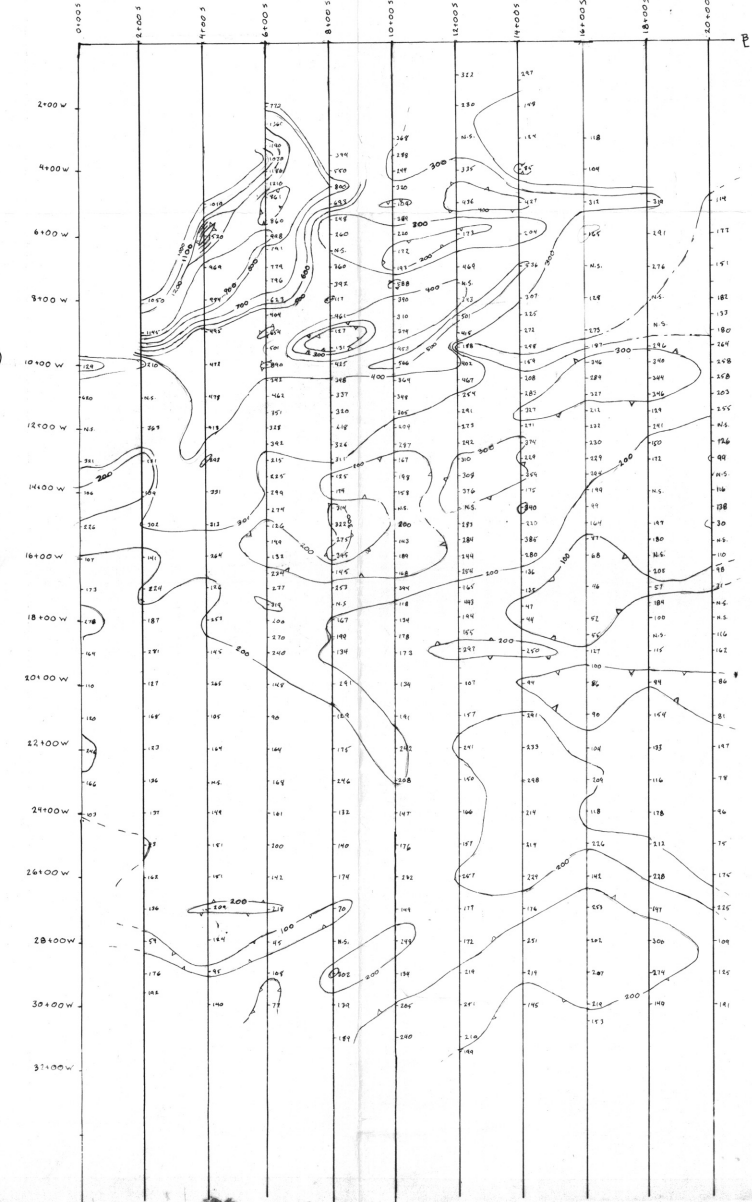

SCALE (feet) 1 in. = 200 feet

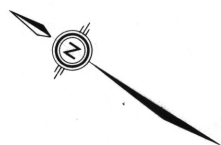

Ministère de l'Énergie et des Ressources
Service de la Géoinformation
Date: 29 Jan. 1987
No. G.M.: 44397

LACANA MINING CORPORATION LACANA EX (1981) INC.

NEW CALUMET MINES LTD. PROPERTY
GRAND CALUMET ISLAND TWP., QUEBEC
J. MacLATCHY OPTION
SOUTH EXTENSION SOIL GEOCHEMISTRY
"A" HORIZON (Au, Ag, Zn, Pb)

PREPARED	DATE	SCALE	PROJECT	MAP SHEET	FIGURE
AM.	12/86	1:2400	6303		24

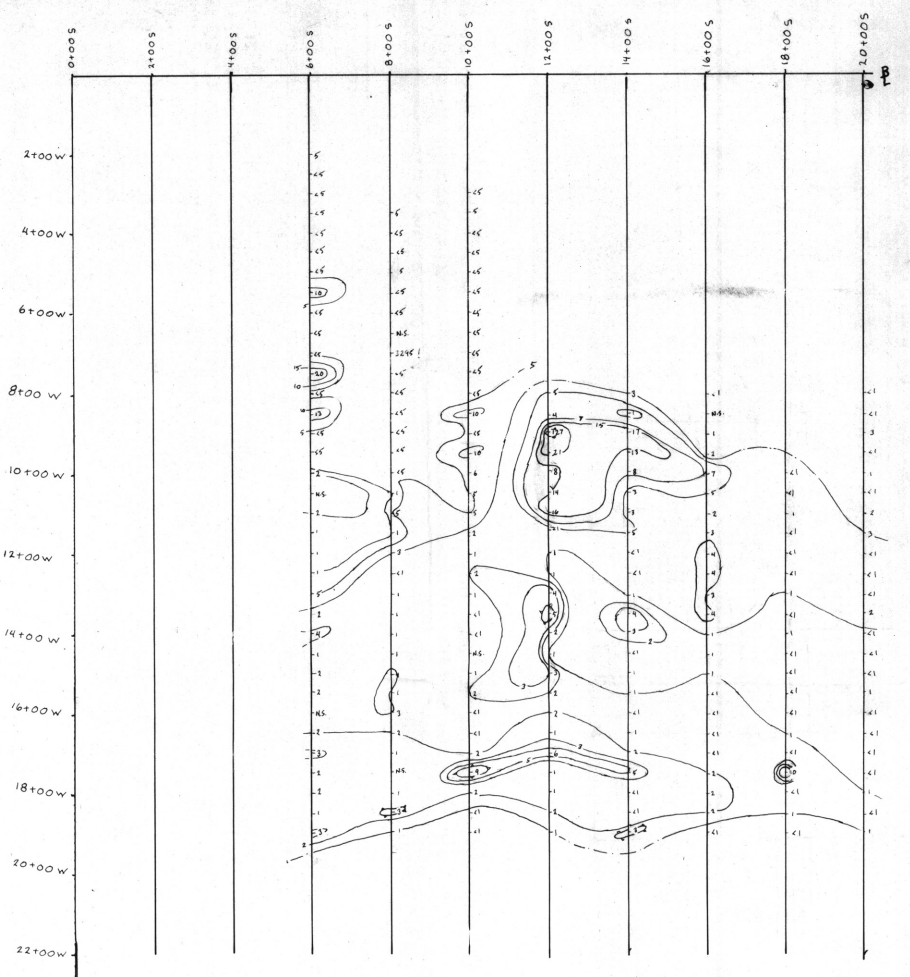

GOLD
 CONTOURS (ppb)
 1
 2
 3
 5
 7
 15
 21
 26

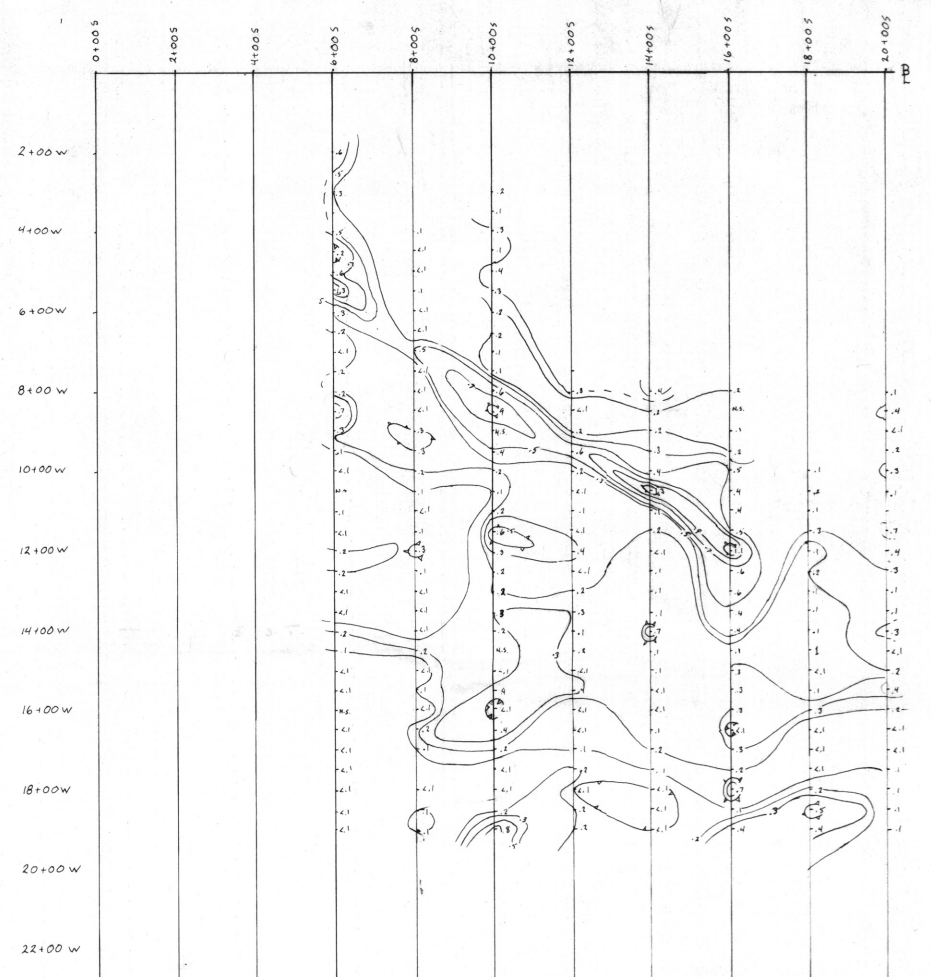

SILVER
 CONTOURS (ppm)
 0.1
 0.2
 0.3
 0.5
 0.7
 0.9

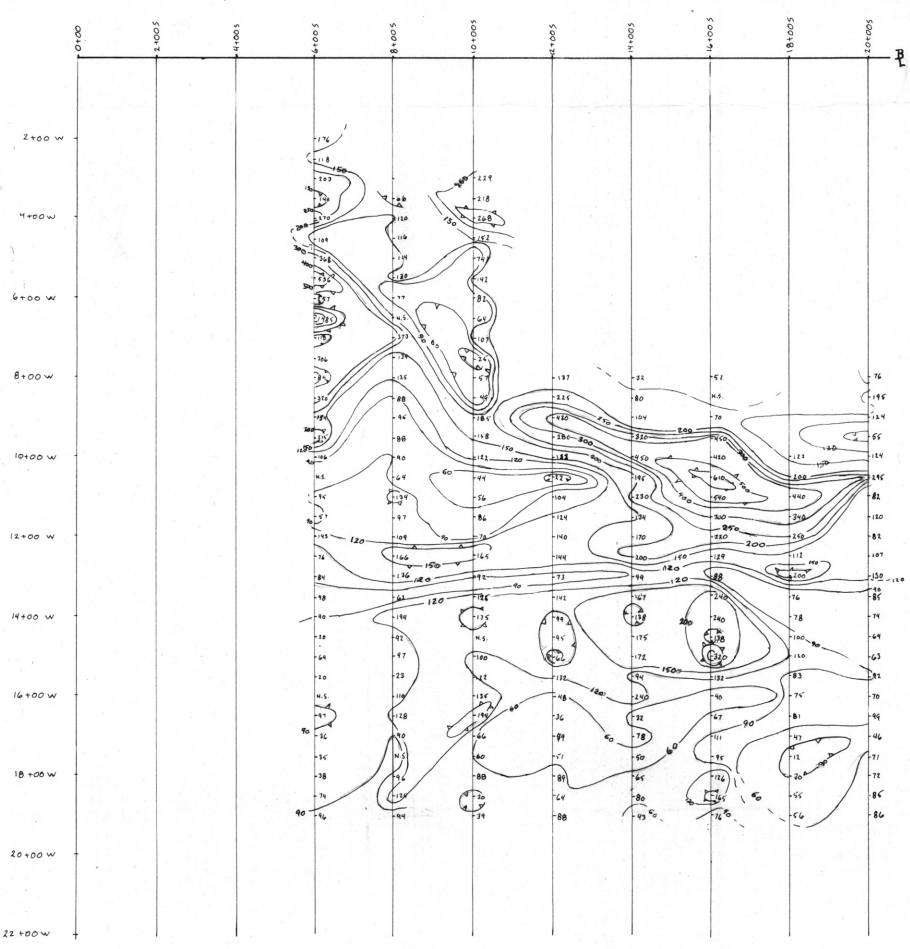

ZINC
 CONTOURS (ppm)
 30
 60
 90
 120
 150
 200
 250
 300
 400
 500
 600

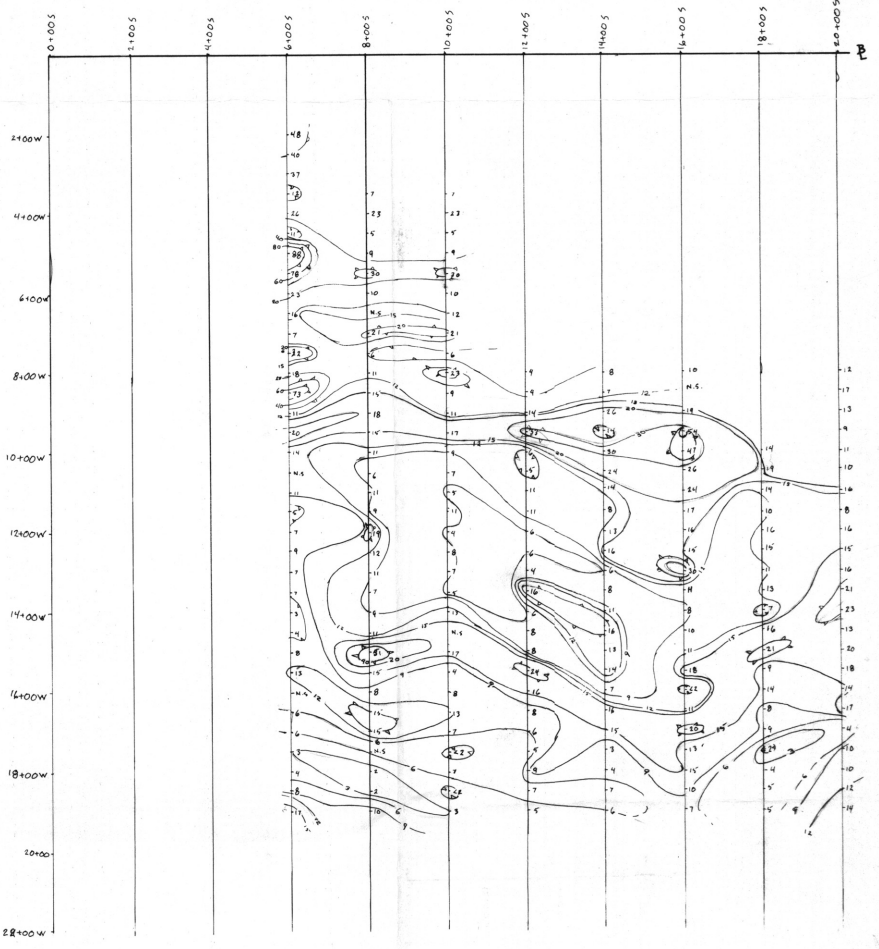

LEAD
 CONTOURS (ppm)
 3
 6
 9
 12
 15
 20
 30
 40
 60
 80

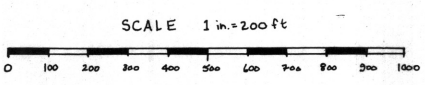
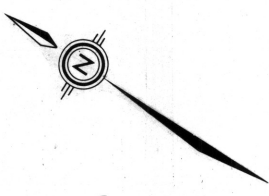

Ministère de l'Énergie et des Ressources
 Service de la Géoinformation
 Date: 28 AVR. 1987
 No G.M.: 44397

LACANA MINING CORPORATION LACANA EX (1981) INC.

NEW CALUMET MINES LTD. PROPERTY
 GRAND CALUMET ISLAND TWP., QUEBEC
 J. MacLATCHY OPTION

**SOUTH EXTENSION SOIL GEOCHEMISTRY
 "B" HORIZON (Au, Ag, Zn, Pb)**

PREPARED	DATE	SCALE	PROJECT	MAP SHEET	FIGURE
A.M.	12/86	1:2400	6303		25

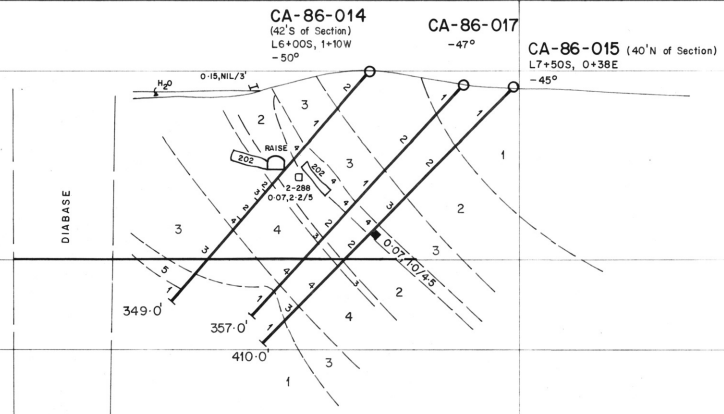

9,000

8,000

LEGEND

LITHOLOGY

- 10 Diabase
- 7 Porphyroblastic hornblende gneiss
- 5 Fine grained green amphibolite
- 4 Ore alteration — calc silicates, garnets, massive sulphides, white carbonate, coarse biotite
- MIG Auriferous horizon
- 3 Siliceous biotite gneiss (Mine unit)
- 2 Carbonate amphibolite
- 2b Silicified amphibolite
- 1 Leucocratic biotite gneiss
- Magnetite

SYMBOLS

- ~ Fault
- Approximate geologic contact
- Drift
- Stope
- Lacana D.D.H. — Surface (Depth — Ft.)
- New Calumet Mine D.D.H. — Surface
- N.C.M. D.D.H. — Underground (Level No. — Hole No.)
- Gold, Silver Assay (OPT) Interval (Ft.)

Ministère de l'Énergie et des Ressources
 Service de la Géoinformation
 Date: 28 NOV 1987
 No G.M.: 44397



CALUMET ISLAND GOLD
BOWIE ZONE

PREPARED	DATE	SCALE	PROJECT	MAP SHEET	FIGURE
C.B.	DEC. 1986	1" = 100'	6303		

BASELINE

Elev. 10,000

Surface at No. 1 Shaft

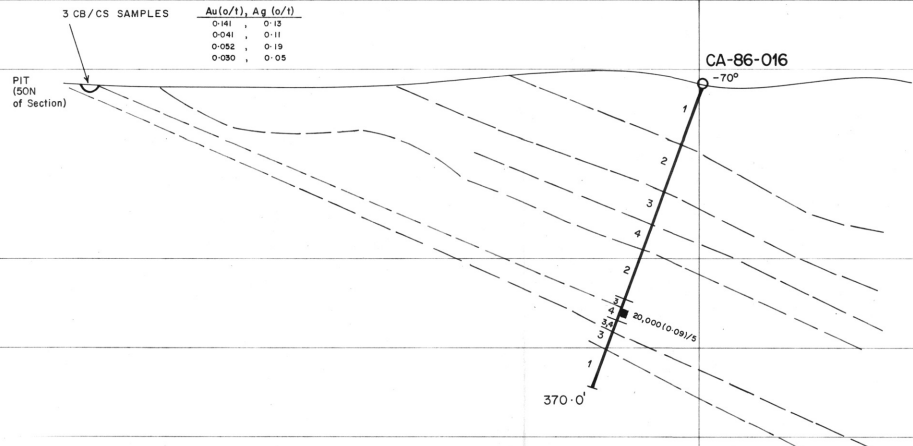

3 CB/CS SAMPLES		Au (g/t), Ag (g/t)	
0-141	0-13		
0-041	0-11		
0-082	0-19		
0-090	0-05		

9,000

200

300

400

500

600

750

900

1050

1200

1350

1500

8,000

LEGEND

LITHOLOGY

- 10 Diabase
- 7 Porphyroblastic hornblende gneiss
- 5 Fine grained green amphibolite
- 4 Ore alteration — calc silicates, garnets, massive sulphides, white carbonate, coarse biotite
- M/G Auriferous horizon
- 3 Siliceous biotite gneiss (Mine unit)
- 2 Carbonate amphibolite
- 2b Silicified amphibolite
- 1 Leucocratic biotite gneiss
- Magnetite

SYMBOLS

- ~ Fault
- Approximate geologic contact
- ⌒ Drift
- Stope
- 205 LACANA D.D.H. — Surface (Depth — Ft.)
- 300 NEW CALUMET MINE D.D.H. — Surface
- 2-44 N.C.M. D.D.H. — Underground (Level No. — Hole No.)
- Gold Silver Assay (OPT)/Interval (Ft.)

Ministère de l'Énergie et des Ressources
 Service de la Géoinformation
 Date: 20 AVR. 1987
 No G.M.: 44397

LACANA MINING CORPORATION LACANA EX (1981) INC.

CALUMET ISLAND GOLD SECTION L7 + 50S

PREPARED	DATE	SCALE	PROJECT	MAP SHEET	FIGURE
C.B.	DEC. 1985	1" = 100'	6303		

BASELINE

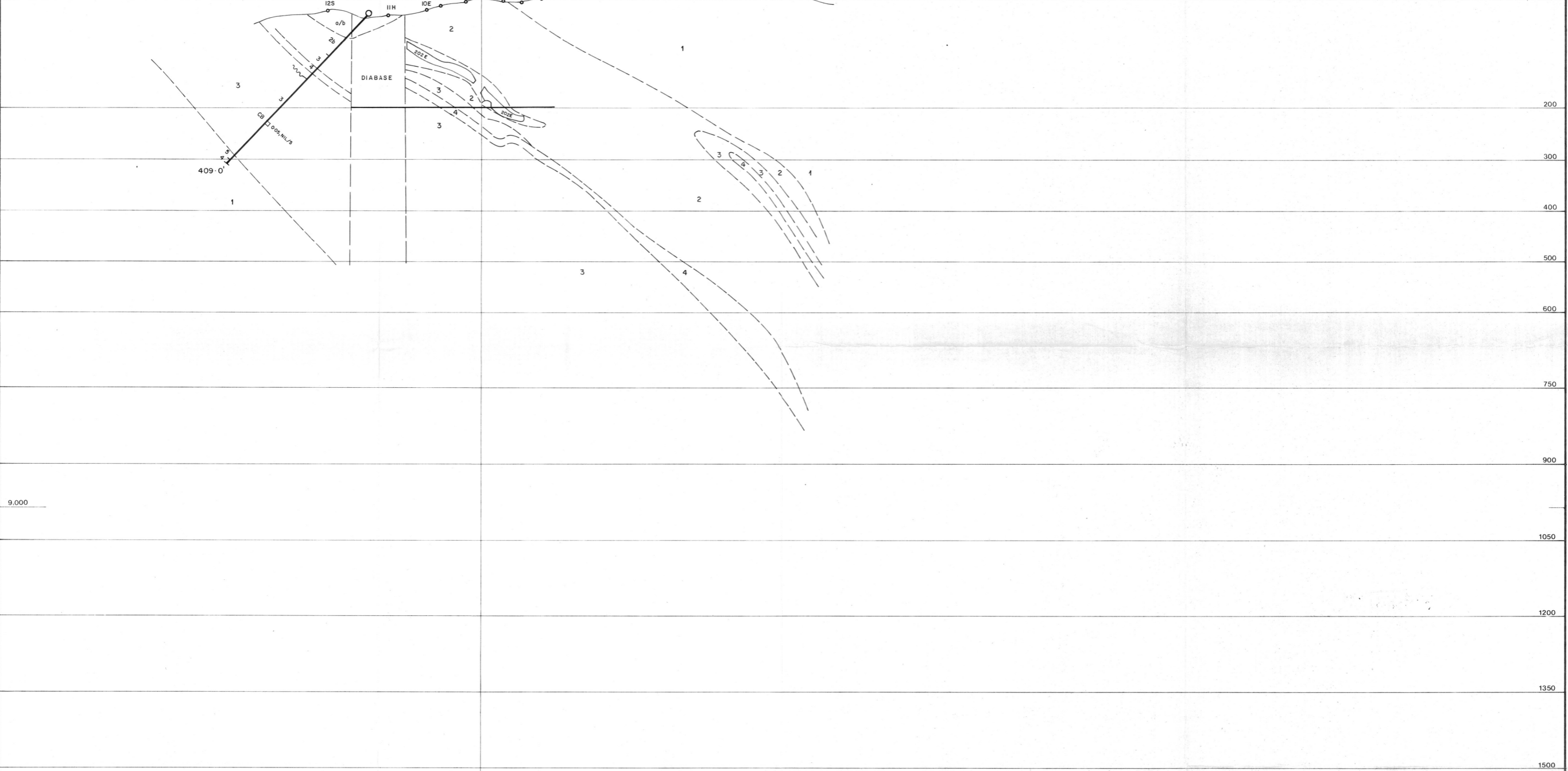

9,000

200

300

400

500

600

750

900

1050

1200

1350

1500

8,000

LEGEND

LITHOLOGY

- 10 Diabase
- 7 Porphyroblastic hornblende gneiss
- 5 Fine grained green amphibolite
- 4 Ore alteration — calc silicates, garnets, massive sulphides, white carbonate, coarse biotite
- M1G Auriferous horizon
- 3 Siliceous biotite gneiss (Mine unit)
- 2 Carbonate amphibolite
- 2b Silicified amphibolite
- 1 Leucocratic biotite gneiss
- Magnetite

SYMBOLS

- ~ Fault
- - - Approximate geologic contact
- ⌒ Drift
- ⌒ Slope
- I2S CA86-008 Lacana D.D.H. — Surface (Depth — Ft.)
- M1-1 New Calumet Mine D.D.H. — Surface
- 2-44 N.C.M. D.D.H. — Underground (Level No. — Hole No.)
- ▬ Gold, Silver Assay (OPT)/Interval (Ft.)

BASELINE

Ministère de l'Énergie et des Ressources
 Service de la Géoinformation
 Date: 28 AVR. 1987
 No G.M.: 44397



**CALUMET ISLAND GOLD
 SECTION L2 + 00S**

PREPARED	DATE	SCALE	PROJECT	MAP SHEET	FIGURE
C.B.	DEC. 1986	1" = 100'	6303		

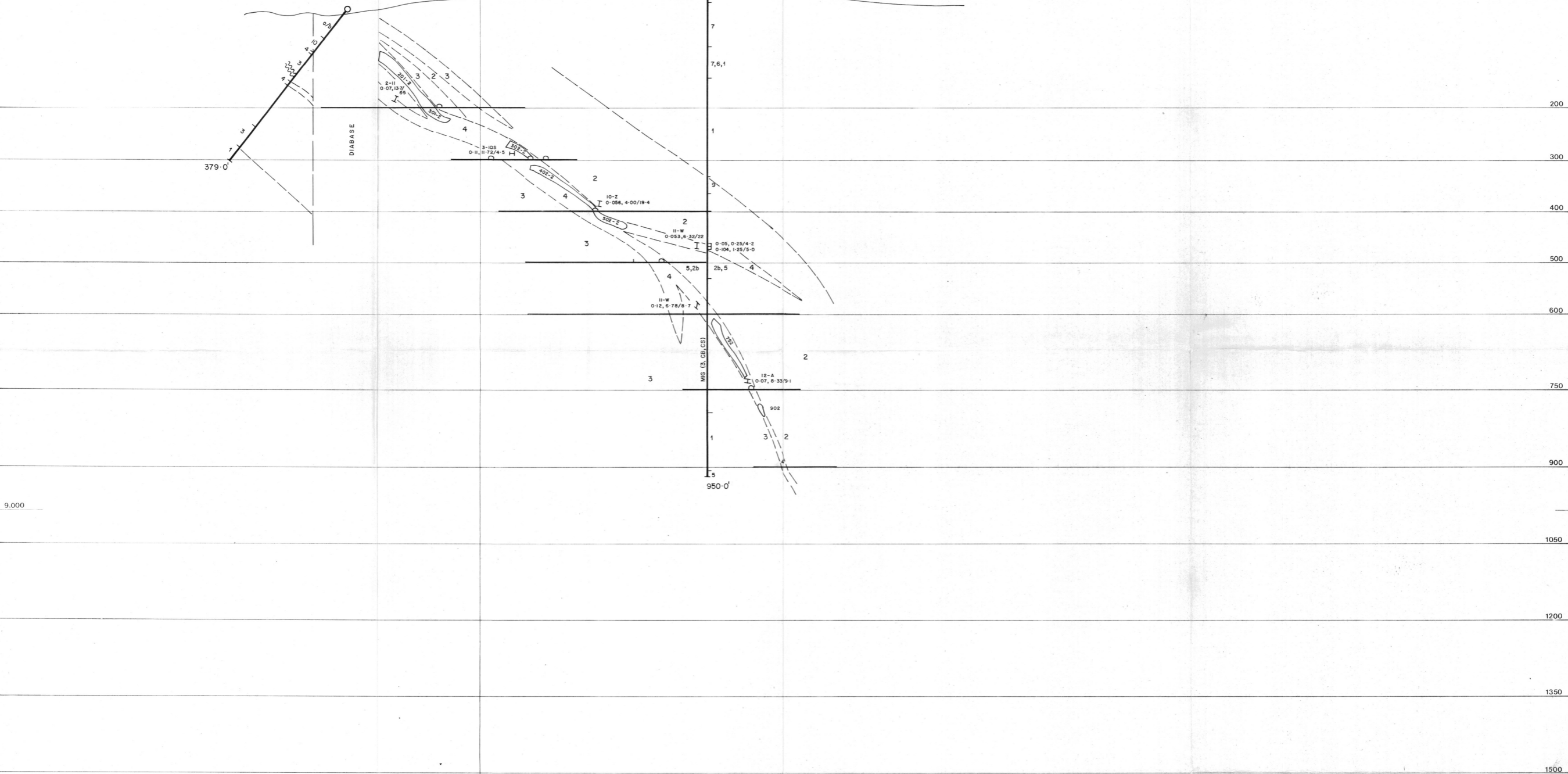

CA-86-007
(17' S of Section)
-50'

CA-86-018
-90'

DIABASE

MIG (S. CB, CS)

BASELINE

LEGEND

LITHOLOGY

- 10 Diabase
- 7 Porphyroblastic hornblende gneiss
- 5 Fine grained green amphibolite
- 4 Ore alteration — calc silicates, garnets, massive sulphides, white carbonate, coarse biotite
- MIG Auriferous horizon
- 3 Siliceous biotite gneiss (Mine unit)
- 2 Carbonate amphibolite
- 2b Silicified amphibolite
- 1 Leucocratic biotite gneiss
- Magnetite

SYMBOLS

- ~ Fault
- - - Approximate geologic contact
- D Drift
- 905 Slope
- CA86-001 Lacana D.D.H. — Surface (Depth — Ft.)
- M1-1 New Calumet Mine D.D.H. — Surface
- 2-44 N.C.M. D.D.H. — Underground (Level No. — Hole No.)
- Gold, Silver Assay (OPT) Interval (Ft.)

Ministère de l'Énergie et des Ressources
Service de la Géoinformation
Date: 28 AVR. 1987
No G.M.: 44397



**CALUMET ISLAND GOLD
SECTION L1 + 08S**

PREPARED	DATE	SCALE	PROJECT	MAP SHEET	FIGURE
C.B.	DEC. 1986	1" = 100'	6303		

CA-86-009
(35' S of Section)
-90°

CA-86-013
(20' N of Section)
-90°

CA-86-011
(20' S of Section)
-80°

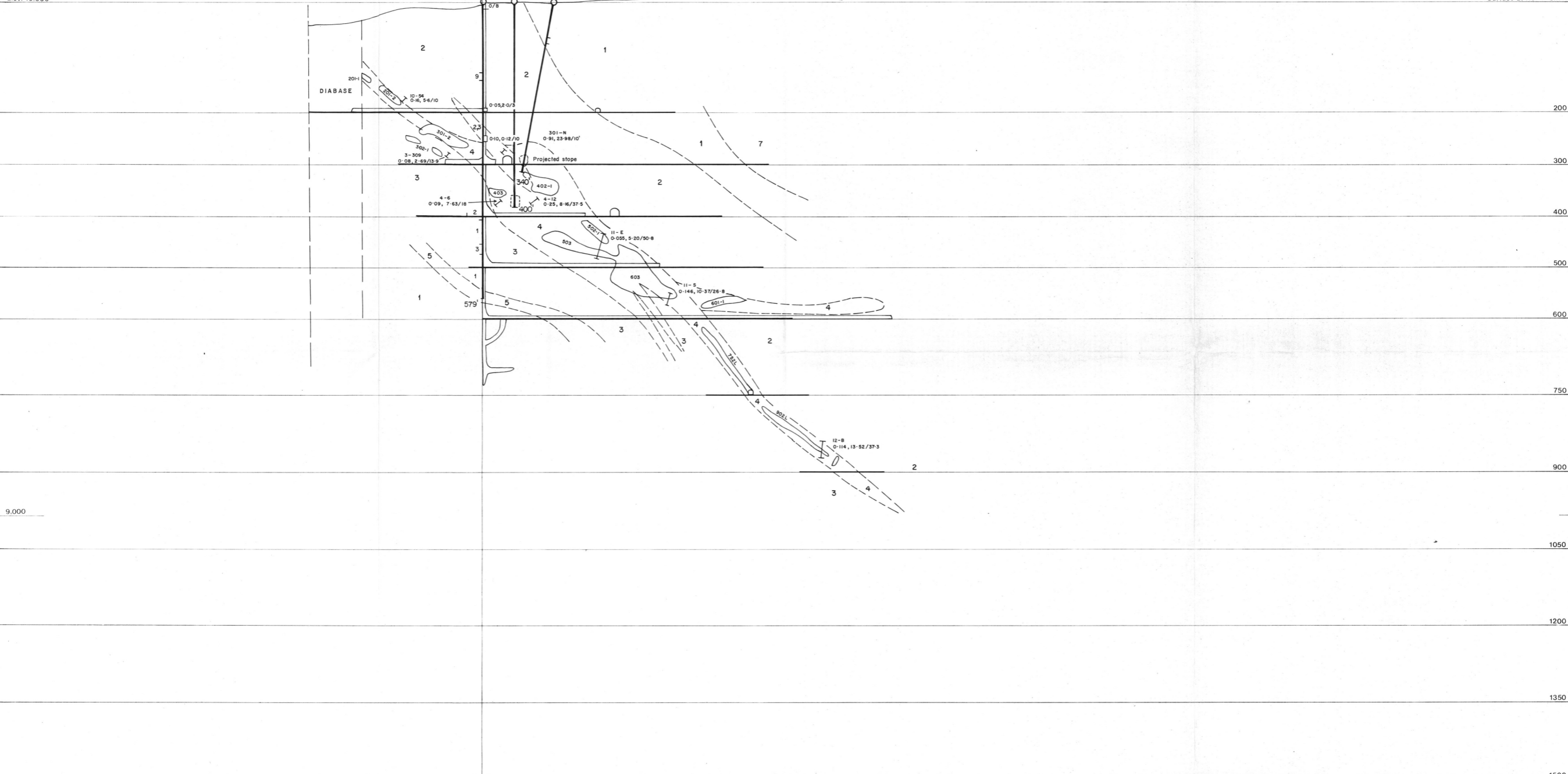

LEGEND

LITHOLOGY

- 10 Diabase
- 7 Porphyroblastic hornblende gneiss
- 5 Fine grained green amphibolite
- 4 Ore alteration — calc silicates, garnets, massive sulphides, white carbonate, coarse biotite
- MIG Auriferous horizon
- 3 Siliceous biotite gneiss (Mine unit)
- 2 Carbonate amphibolite
- 2b Silicified amphibolite
- 1 Leucocratic biotite gneiss
- Magnetite

SYMBOLS

- ~ Fault
- - - Approximate geologic contact
- Drift
- Slope
- (358-009) Lacana D.D.H. — Surface (Depth — Ft.)
- (300') New Calumet Mine D.D.H. — Surface
- (2'-44') N.C.M. D.D.H. — Underground (Level No. — Hole No.)
- Gold, Silver Assay (OPT) Interval (Ft.)

Ministère de l'Énergie et des Ressources
Service de la Géoinformation
Date: 28 AVO, 1987
No G.M.: 44397

LACANA MINING CORPORATION LACANA EX (1981) INC.

**CALUMET ISLAND GOLD
SECTION L0 + 00**

PREPARED	DATE	SCALE	PROJECT	MAP SHEET	FIGURE
C.B.	DEC 1986	1" = 100'	6303		

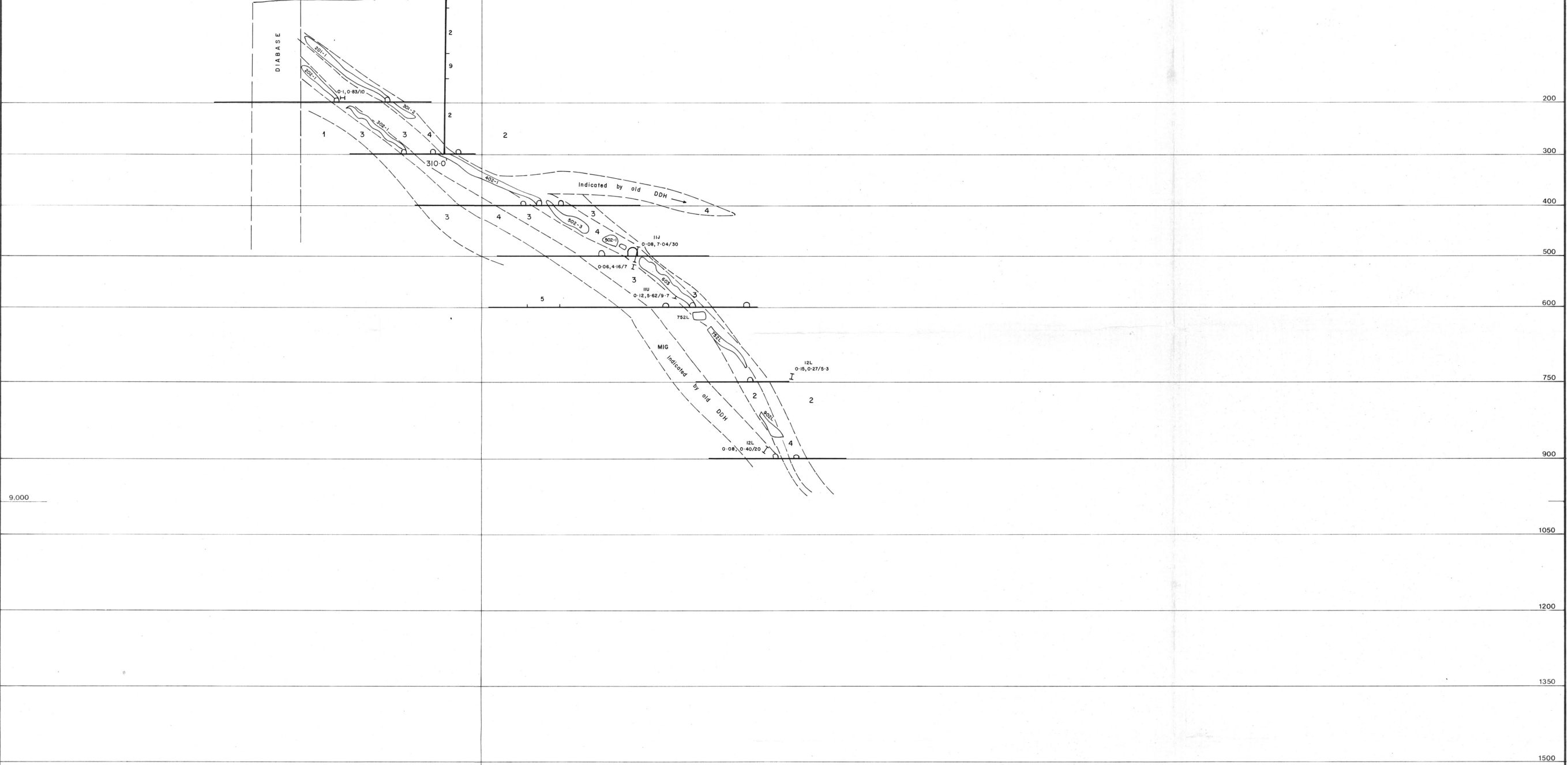

9,000

8,000

LEGEND

LITHOLOGY

- 10 Diabase
- 7 Porphyroblastic hornblende gneiss
- 5 Fine grained green amphibolite
- 4 Ore alteration — calc silicates, garnets, massive sulphides, white carbonate, coarse biotite
- MIG Auriferous horizon
- 3 Siliceous biotite gneiss (Mine unit)
- 2 Carbonate amphibolite
- 2b Silicified amphibolite
- 1 Leucocratic biotite gneiss
- Magnetite

SYMBOLS

- Fault
- Approximate geologic contact
- Drift
- Stope
- Lacana D.D.H. — Surface (Depth — Ft.)
- New Calumet Mine D.D.H. — Surface
- N.C.M. D.D.H. — Underground (Level No. — Hole No.)
- Gold, Silver Assay (OPT/Interval (Ft.))

BASELINE

Ministère de l'Énergie et des Ressources
 Service de la Géoinformation
 Date: 28 AVR. 1987
 No G.M.: 44397



**CALUMET ISLAND GOLD
SECTION L0 + 86N**

PREPARED	DATE	SCALE	PROJECT	MAP SHEET	FIGURE
C.B.	DEC. 1986	1" = 100'	6303		

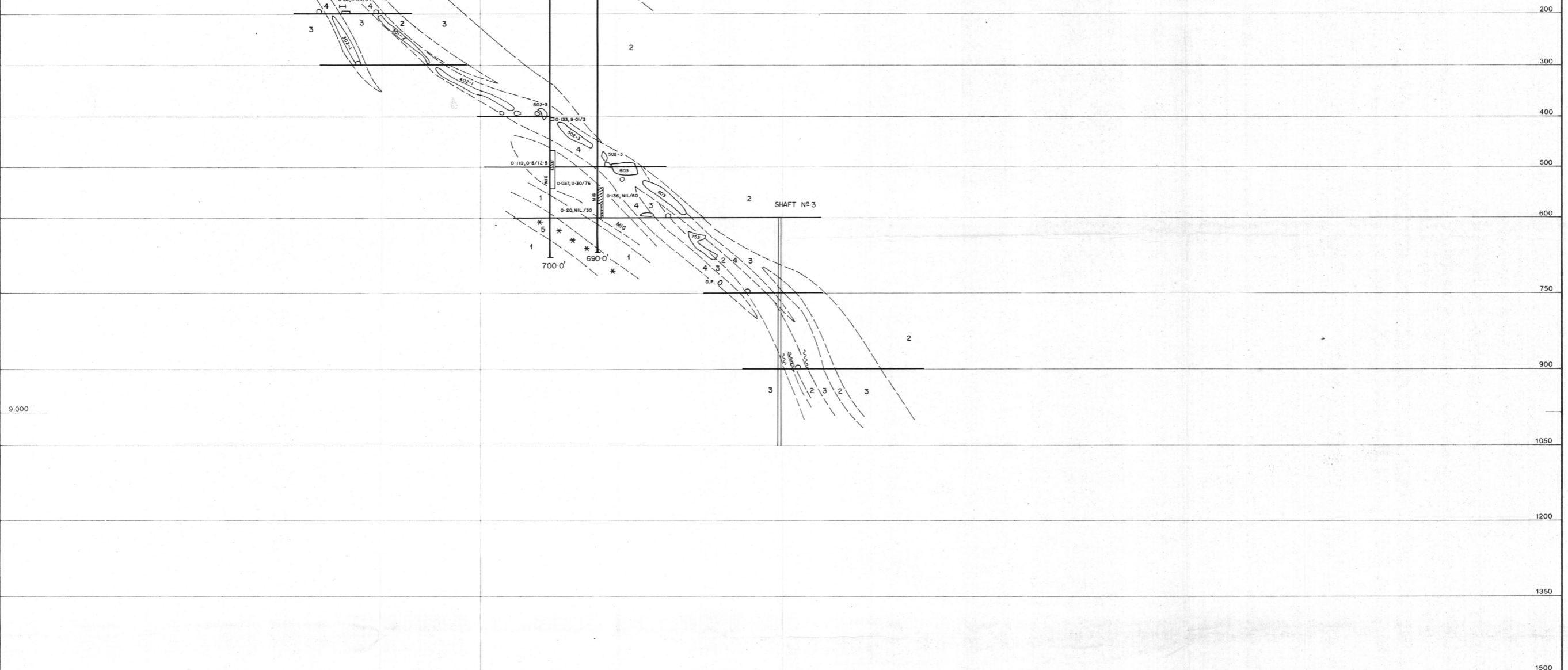

LEGEND

LITHOLOGY

- 10 Diabase
- 7 Porphyroblastic hornblende gneiss
- 5 Fine grained green amphibolite
- 4 Ore alteration — calc silicates, garnets, massive sulphides, white carbonate, coarse biotite
- M1G Auriferous horizon
- 3 Siliceous biotite gneiss (Mine unit)
- 2 Carbonate amphibolite
- 2b Silicified amphibolite
- 1 Leucocratic biotite gneiss
- Magnetite

SYMBOLS

- ~ Fault
- - - Approximate geologic contact
- Drift
- Slope
- 255
CA86-004
○ 300
M1-1
○ 44
2-44
■ Gold, Silver Assay (OPT)/Interval (Ft.)

Ministère de l'Énergie et des Ressources
 Service de la Géoinformation
 Date: 28 AVR. 1987
 No G.M.: 44397



**CALUMET ISLAND GOLD
 SECTION L1 + 48N**

PROJECT	DATE	SCALE	PROJECT	MAP SHEET	FIGURE
C.B.	DEC. 1985	1" = 100'	6303		

BASELINE

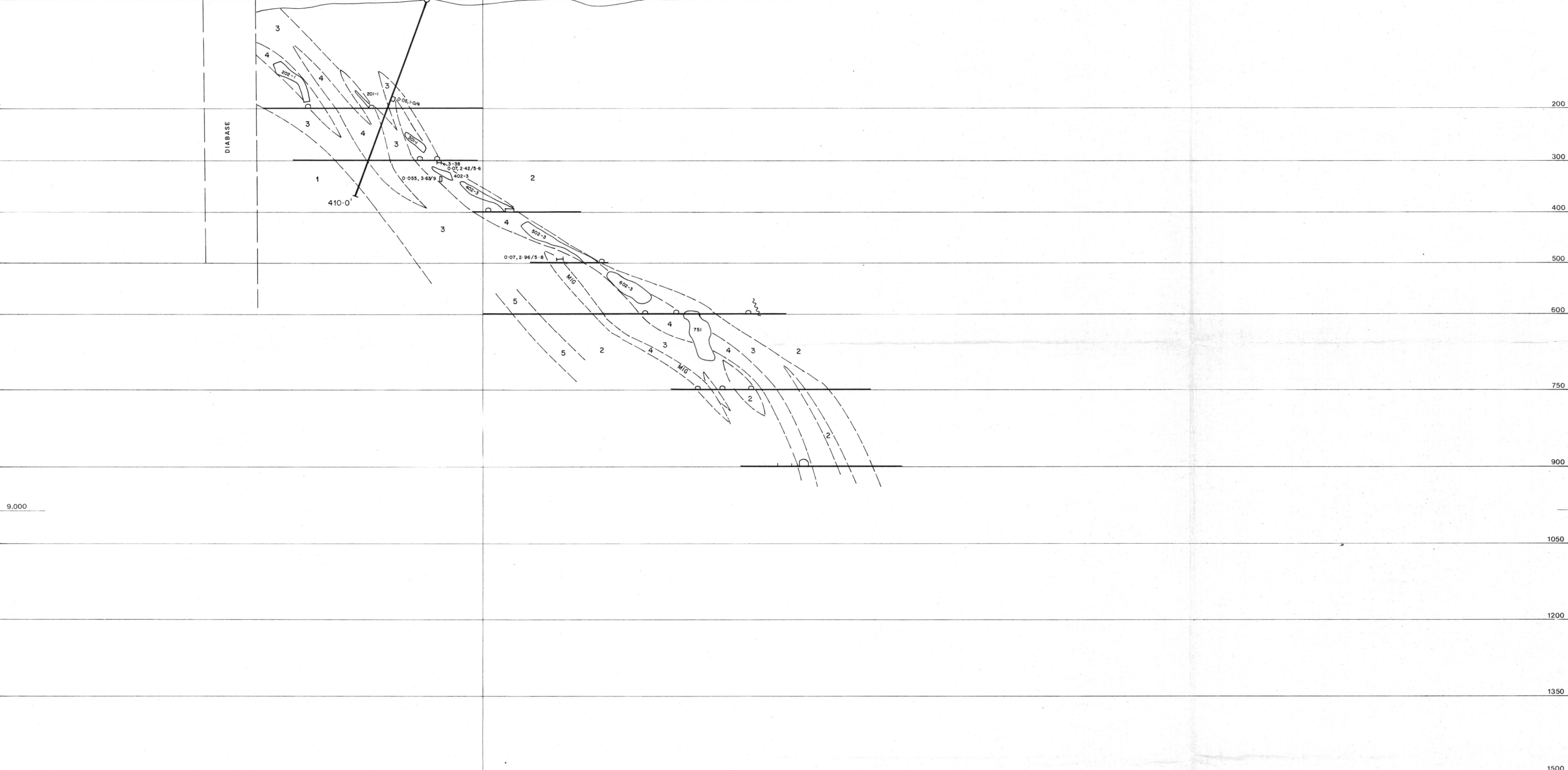

LEGEND

LITHOLOGY

- 10 Diabase
- 7 Porphyroblastic hornblende gneiss
- 5 Fine grained green amphibolite
- 4 Ore alteration — calc silicates, garnets, massive sulphides, white carbonate, coarse biotite
- MIG Auriferous horizon
- 3 Siliceous biotite gneiss (Mine unit)
- 2 Carbonate amphibolite
- 2b Silicified amphibolite
- 1 Leucocratic biotite gneiss
- Magnetite

SYMBOLS

- ~ Fault
- - - Approximate geologic contact
- Drift
- Slope
- CA86-001 Lacana D.D.H. — Surface (Depth — Ft.)
- M1-1 New Calumet Mine D.D.H. — Surface
- 2-44 N.C.M. D.D.H. — Underground (Level No. — Hole No.)
- Gold, Silver Assay (OPT)/Interval (Ft.)

Ministère de l'Énergie et des Ressources
 Service de la Géoinformation
 Date: 20 NOV 1987
 No G.M.: 44397



**CALUMET ISLAND GOLD
 SECTION L2 + 00N**

PREPARED	DATE	SCALE	PROJECT	MAP SHEET	FIGURE
C.B.	DEC. 1986	1" = 100'	6303		

CA-86-020
-90°

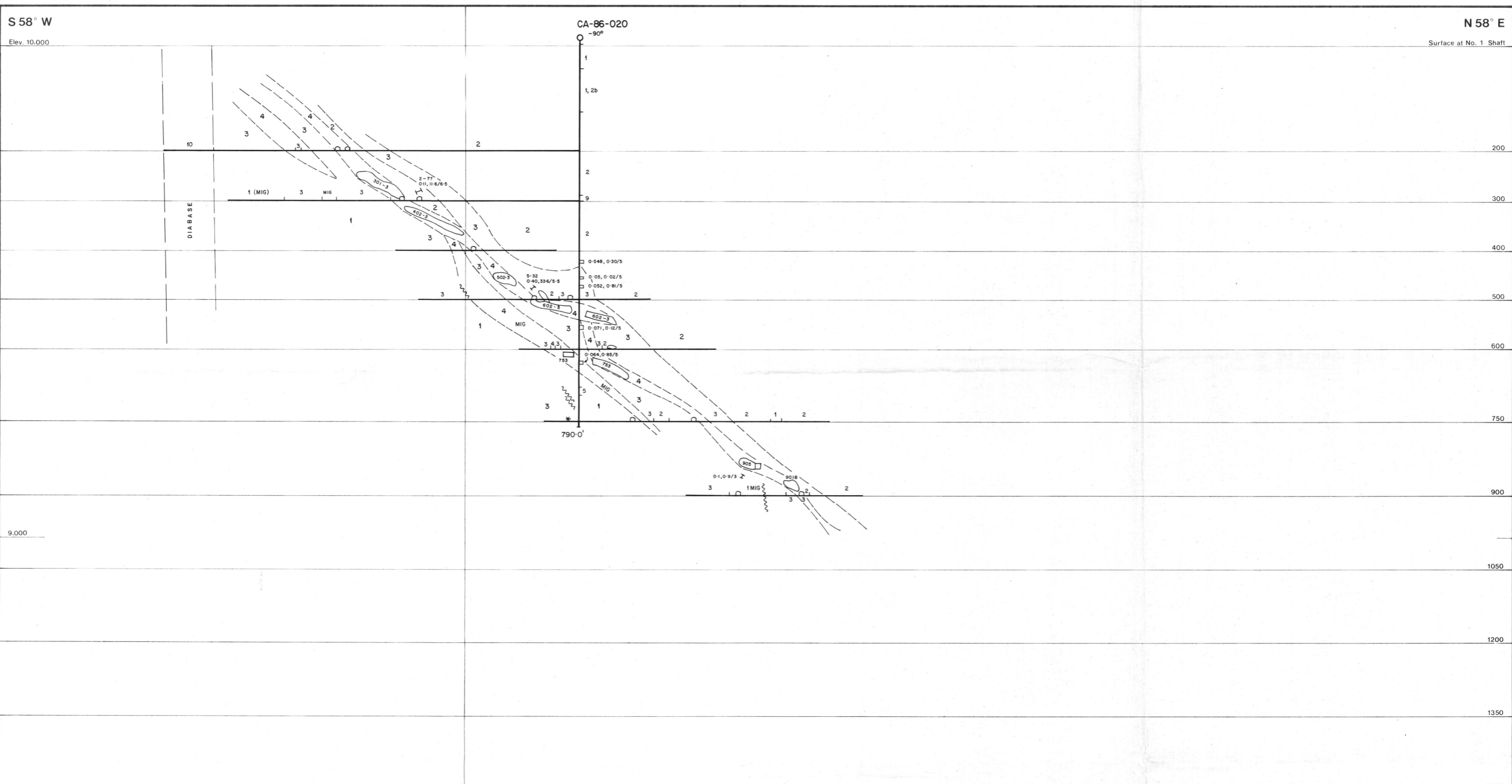

LEGEND

LITHOLOGY

- 10 Diabase
- 7 Porphyroblastic hornblende gneiss
- 5 Fine grained green amphibolite
- 4 Ore alteration — calc silicates, garnets, massive sulphides, white carbonate, coarse biotite
- MIG Auriferous horizon
- 3 Siliceous biotite gneiss (Mine unit)
- 2 Carbonate amphibolite
- 2b Silicified amphibolite
- 1 Leucocratic biotite gneiss
- Magnetite

SYMBOLS

- ~ Fault
- - - Approximate geologic contact
- Drift
- Slope
- 001 Lacana D.D.H. — Surface (Depth — Ft.)
- 100 New Calumet Mine D.D.H. — Surface
- 1-1 N.C.M. D.D.H. — Underground (Level No. — Hole No.)
- Gold, Silver Assay (DPT)/Interval (Ft.)

Ministère de l'Énergie et des Ressources
 Service de la Géoinformation
 Date: 20 AVR. 1987
 No G.M.: 44397

LACANA MINING CORPORATION LACANA EX (1981) INC.

**CALUMET ISLAND GOLD
 SECTION L3 + 12N**

PREPARED	DATE	SCALE	PROJECT	MAP SHEET	FIGURE
C.B.	DEC. 1986	1" = 100'	6303		

BASELINE

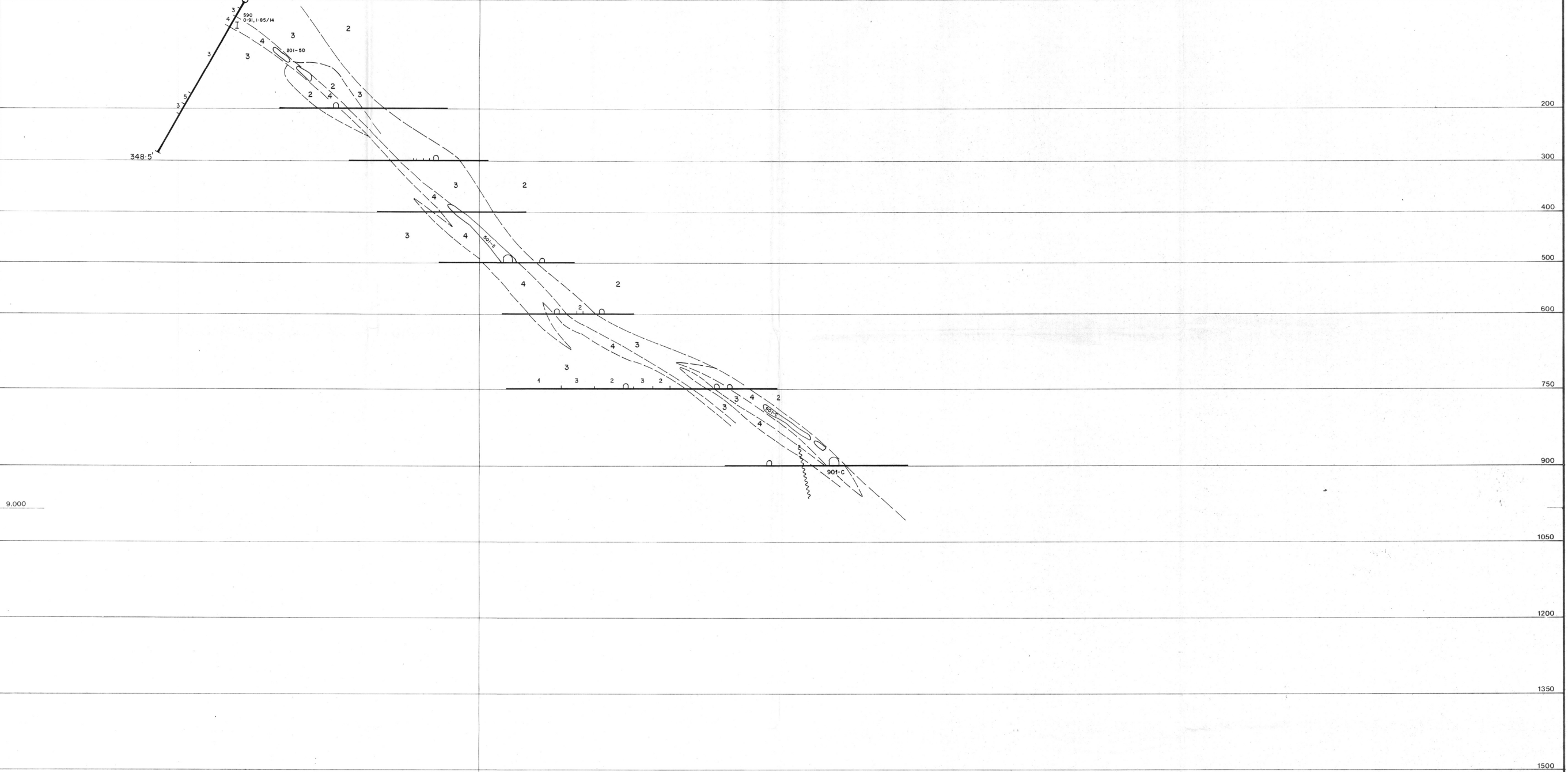

CA-86-001

- 60°

590
0-91, 1-85/14

801-50

348.5'

901-C

LEGEND

LITHOLOGY

- 10 Diabase
- 7 Porphyroblastic hornblende gneiss
- 5 Fine grained green amphibolite
- 4 Ore alteration — calc silicates, garnets, massive sulphides, white carbonate, coarse biotite
- MIG Auriferous horizon
- 3 Siliceous biotite gneiss (Mine unit)
- 2 Carbonate amphibolite
- 2b Silicified amphibolite
- 1 Leucocratic biotite gneiss
- Magnetite

SYMBOLS

- ~ Fault
- - - Approximate geologic contact
- Drift
- Slope
- CA-86-001 Lacana D.D.H. — Surface (Depth — Ft.)
- New Calumet Mine D.D.H. — Surface
- 2-44 N.C.M. D.D.H. — Underground (Level No. — Hole No.)
- Gold, Silver Assay (OPT) Interval (Ft.)

Ministère de l'Énergie et des Ressources
 Service de la Géoinformation
 Date: 28 AVR. 1987
 No G.M.: 44397

LACANA MINING CORPORATION LACANA EX (1981) INC.

**CALUMET ISLAND GOLD
 SECTION L6 + 00N**

PREPARED BY	DATE	SCALE	PROJECT	MAP SHEET	FIGURE
C.B.	DEC. 1985	1" = 100'	6303		

BASELINE

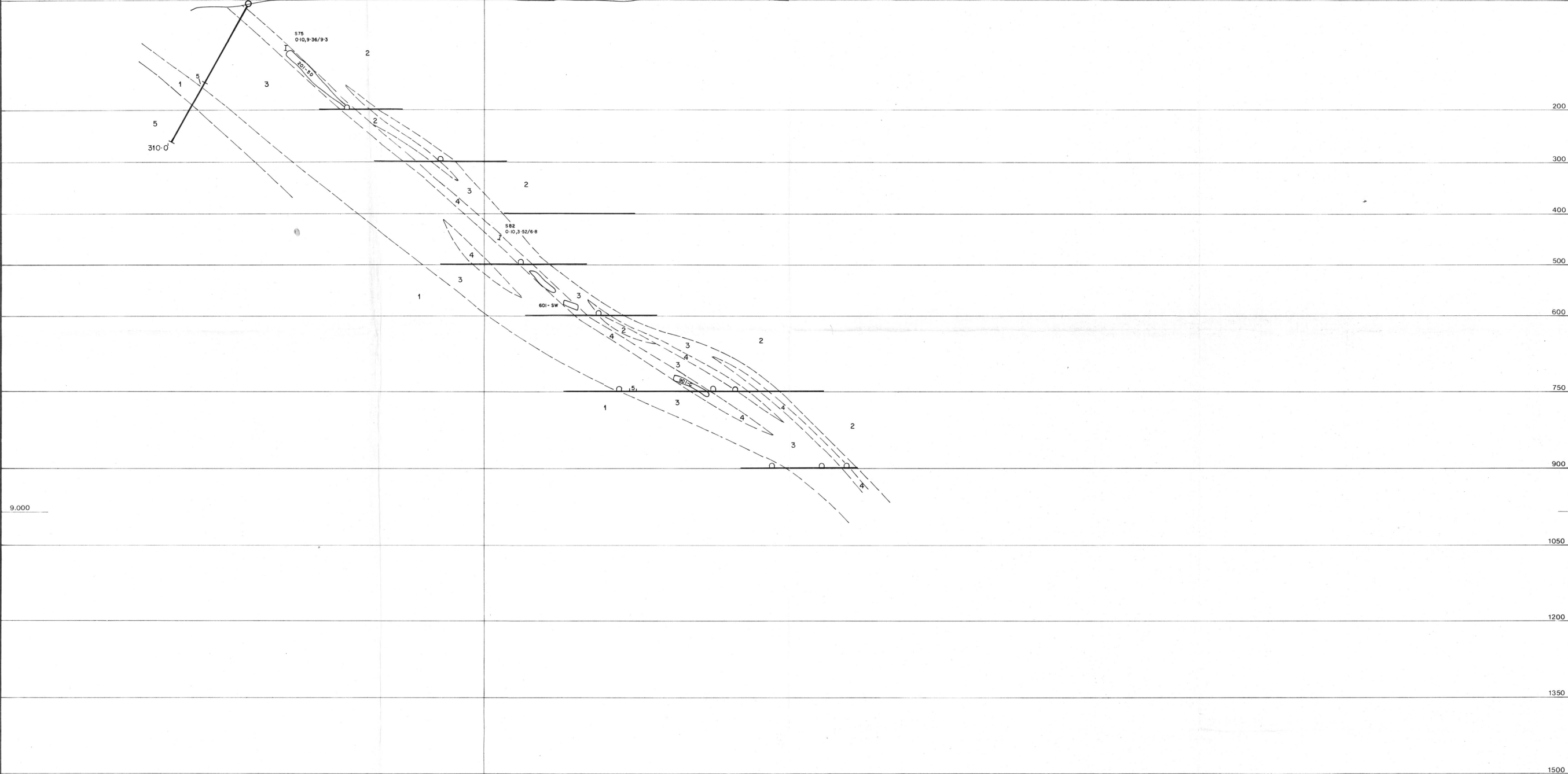

9,000

8,000

LEGEND

LITHOLOGY

- 10 Diabase
- 7 Porphyroblastic hornblende gneiss
- 5 Fine grained green amphibolite
- 4 Ore alteration — calc silicates, garnets, massive sulphides, white carbonate, coarse biotite
- MIG Auriferous horizon
- 3 Siliceous biotite gneiss (Mine unit)
- 2 Carbonate amphibolite
- 2b Silicified amphibolite
- 1 Leucocratic biotite gneiss
- Magnetite

SYMBOLS

- Fault
- Approximate geologic contact
- Drift
- Slope
- 305 CA86-001 Lacana D.D.H. — Surface (Depth — Ft.)
- M-1 New Calumet Mine D.D.H. — Surface
- 2-44 N.C.M. D.D.H. — Underground (Level No. — Hole No.)
- Gold, Silver Assay (OPT)/interval (Ft.)

Ministère de l'Énergie et des Ressources
 Service de la Géoinformation
 Date: 28 AVR 1987
 No G.M.: 44397

LACANA MINING CORPORATION LACANA EX (1981) INC.

**CALUMET ISLAND GOLD
 SECTION L7 + 00N**

PREPARED BY	DATE	SCALE	PROJECT	MAP SHEET	FIGURE
C.B.	DEC. 1986	1" = 100'	6303		

BASELINE

CA-86-019

-86°

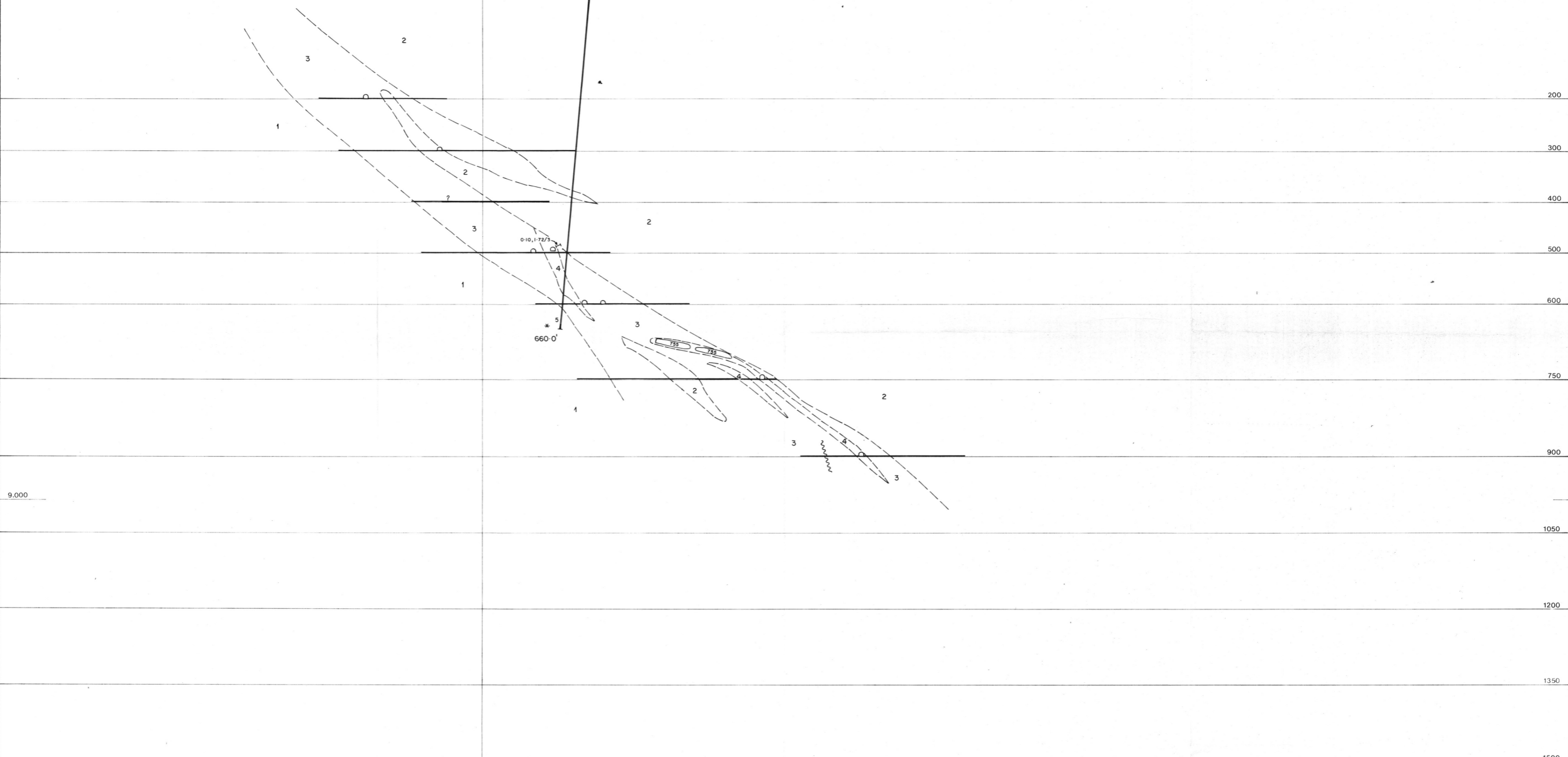

9,000

200

300

400

500

600

750

900

1050

1200

1350

1500

8,000

BASELINE

LEGEND

LITHOLOGY

- 10 Diabase
- 7 Porphyroblastic hornblende gneiss
- 5 Fine grained green amphibolite
- 4 Ore alteration — calc silicates, garnets, massive sulphides, white carbonate, coarse biotite
- MIG Auriferous horizon
- 3 Siliceous biotite gneiss (Mine unit)
- 2 Carbonate amphibolite
- 2b Silicified amphibolite
- 1 Leucocratic biotite gneiss
- Magnetite

SYMBOLS

- ~ Fault
- - - Approximate geologic contact
- Drift
- Stope
- CA-86-004 Lacana D.D.H. — Surface (Depth — Ft.)
- Mt-1 New Calumet Mine D.D.H. — Surface
- 2-44 N.C.M. D.D.H. — Underground (Level No. — Hole No.)
- Gold, Silver Assay (OPT)/Interval (FT.)

Ministère de l'Énergie et des Ressources
 Service de la Géoinformation
 Date: 28 AVR. 1987
 No G.M.: 44397

LACANA MINING CORPORATION LACANA EX (1981) INC.

**CALUMET ISLAND GOLD
 SECTION L8 + 36N**

PREPARED BY	DATE	SCALE	PROJECT	MAP SHEET	FIGURE
C.B.	DEC. 1986	1" = 100'	6303		

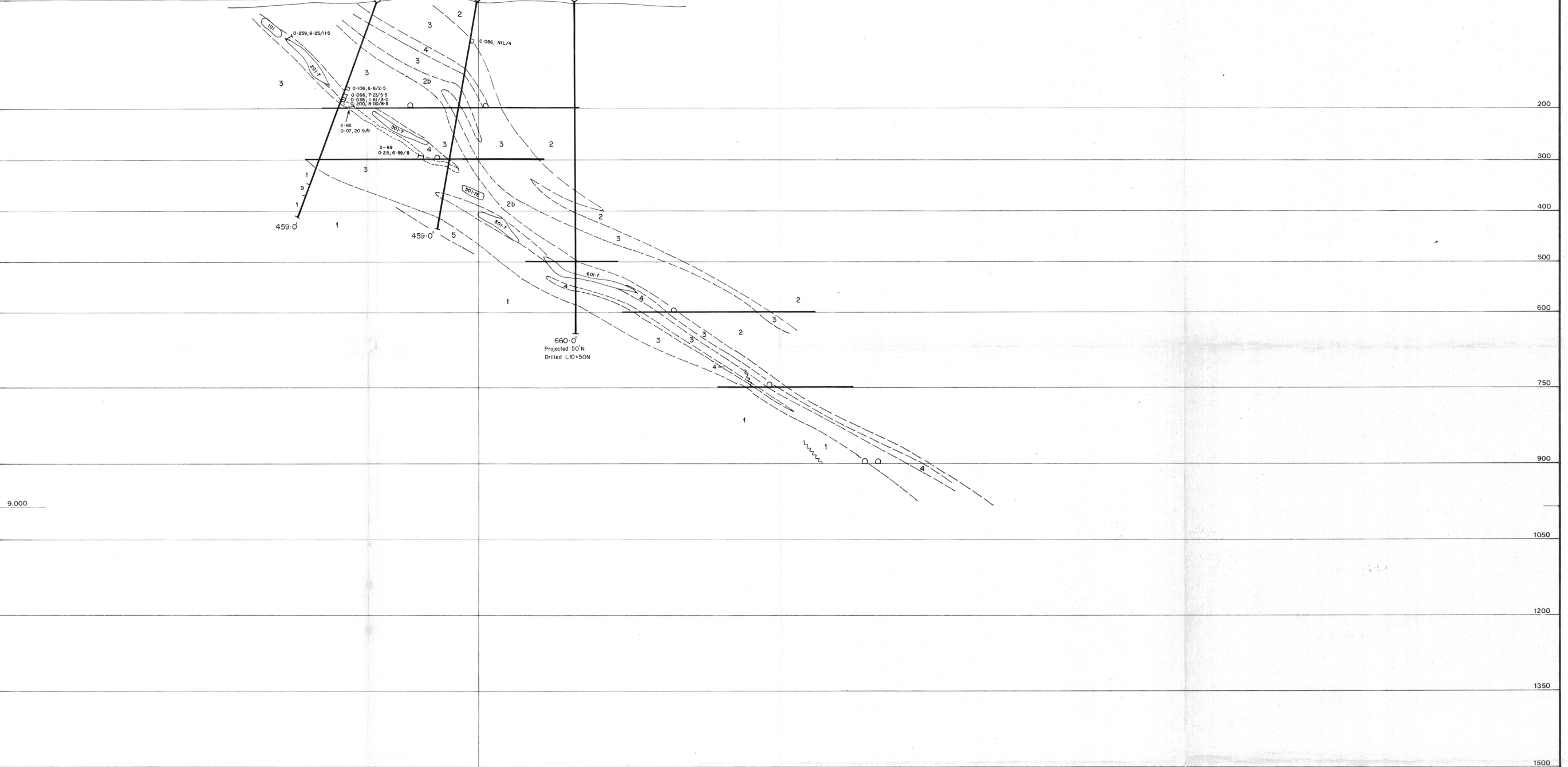

9,000

200

300

400

500

600

750

900

1050

1200

1350

1500

8,000

LEGEND

LITHOLOGY

- 10 Diabase
- 7 Porphyroblastic hornblende gneiss
- 5 Fine grained green amphibolite
- 4 Ore alteration — calc silicates, garnets, massive sulphides, white carbonate, coarse biotite
- MIG Auriferous horizon
- 3 Siliceous biotite gneiss (Mine unit)
- 2 Carbonate amphibolite
- 2b Silicified amphibolite
- 1 Leucocratic biotite gneiss
- Magnetite

SYMBOLS

- ~ Fault
- Approximate geologic contact
- Drift
- Stope
- 905 LACANA D.D.H. — Surface (Depth — Ft.)
- 300' CA86-001
- M1-1 New Calumet Mine D.D.H. — Surface
- 2-44 N.C.M. D.D.H. — Underground (Level No. — Hole No.)
- Gold, Silver Assay (OPT)/Interval (Ft.)

BASELINE

Ministère de l'Énergie et des Ressources
 Service de la Géoinformation
 Date: 28 AVR 1987
 No G.M.: 44397



**CALUMET ISLAND GOLD
 SECTION L11 + 00N**

PREPARED	DATE	SCALE	PROJECT	MAP SHEET	FIGURE
C.B.	DEC. 1986	1" = 100'	6303		