

LEGEND

- ⊠ CLAIM POST
- ← DEFINED CLAIM LINE
- 381096 CL 5 CLAIM NUMBER
- ASSUMED CLAIM LINE
- OM 2 DIAMOND DRILL HOLE LOCATION

Ministère de l'Énergie et des Ressources
 Gouvernement du Québec
 Documentation Technique
 DATE: 24 NOV 1981
 No. GM: 37604
 SCALE 1 : 1000

URANERZ EXPLORATION AND MINING LIMITED			
PROJECT 71-85 BEAVER-ZORAN OTISH/WEST Camie River Area CLAIMS AND DRILL HOLES			
COMP. C.H.	DATE NOV. 80	REP. RAP. No.	MAP. CARTE No. 390
DRAWN DESS A.R.	DATE " "		
REVISION 06/81		SCALE ECH. 1 : 1000	PROJ. No. 71-85
T.C. TO BONN	N.T.S. REF.		FILE DOSS. No.

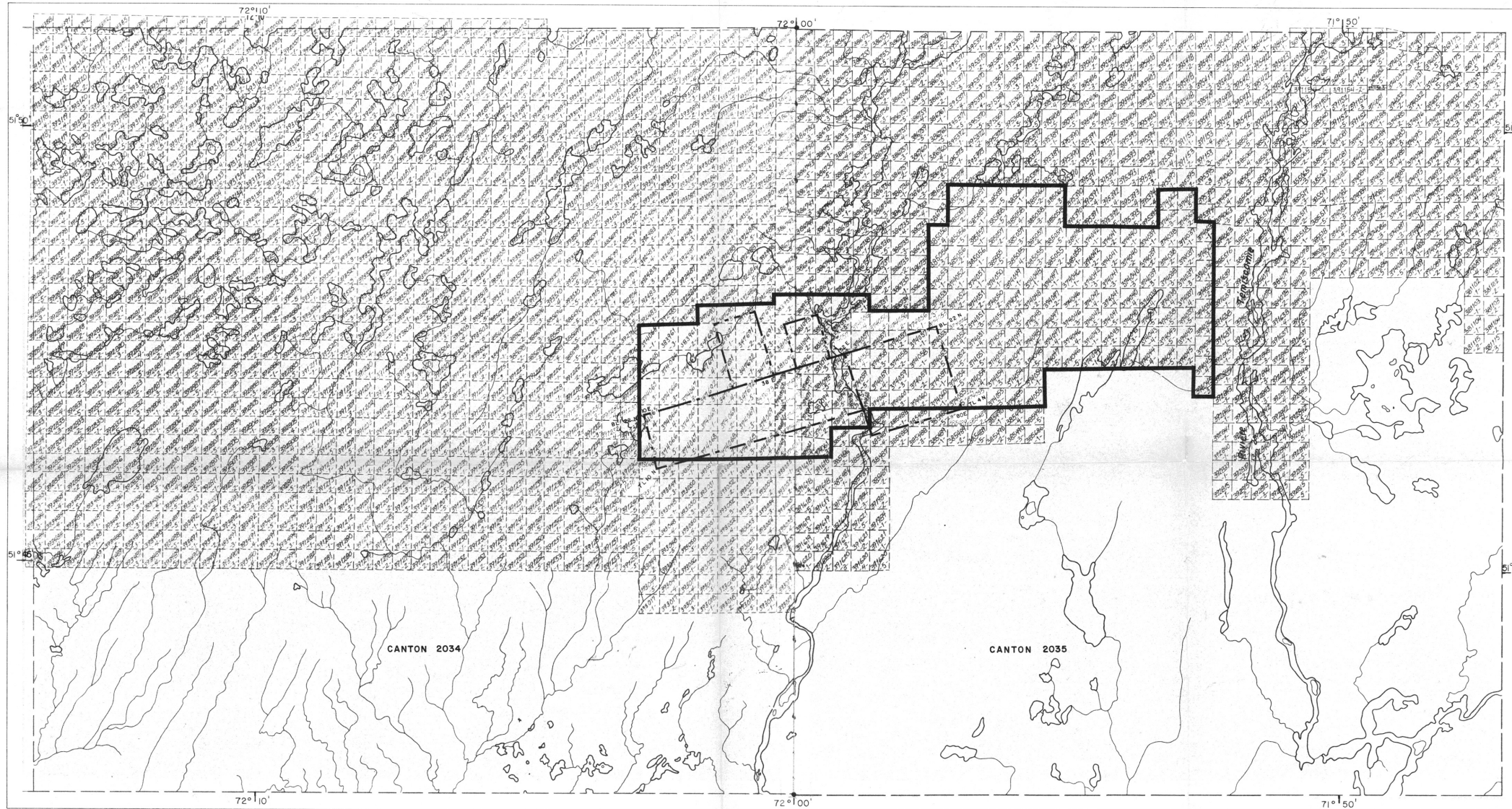

LEGEND

--- --	GRID BOUNDARY
— — —	CLAIM BLOCK BOUNDARY

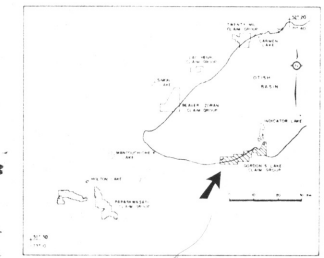

Ministère de l'Énergie et des Ressources
 Gouvernement du Québec
 Documentation Technique
 DATE: 24 NOV. 1981
 No. GM: 37604



URANERZ EXPLORATION AND MINING LIMITED					
PROJECT NO. 71-85, Bea-Zor./Otish West.					
Gordon's Lake West Claim Block					
CLAIM BOUNDARY & GRID LOCATION					
DRAWN	Z. M.	DATE	06/81	REP. DES. No.	MAP. CONTR. No.
REVISION	A. F.	DATE		SCALE: ECH.	1:50,000
T.C. TO BURN		N.T.S. REF.		PROJ. No.	71-85
				FILE. DISS. No.	

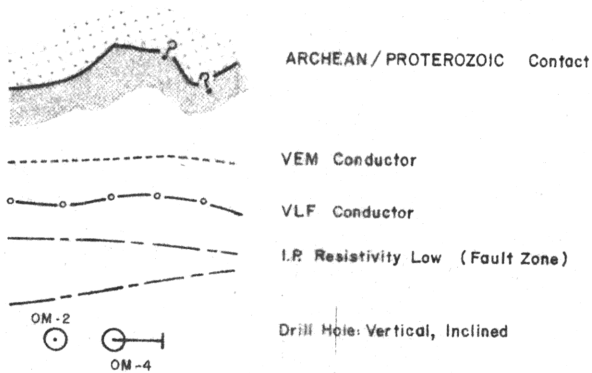
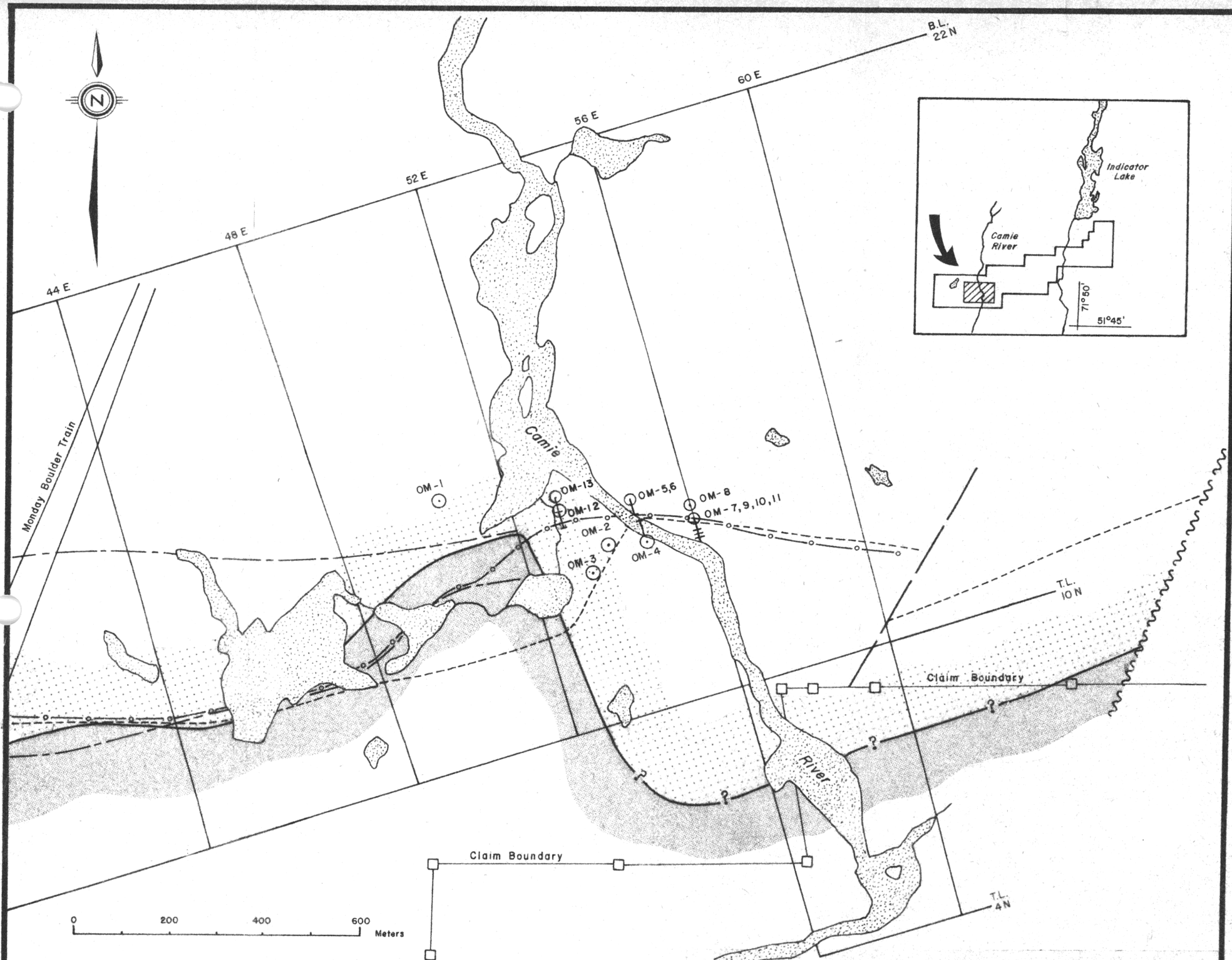

URANERZ EXPLORATION & MINING LTD.

**PROJECT BEAVER-ZORAN/OTISH WEST 71-85
CAMIE RIVER AREA
Location of Completed Drill Holes — Seas.-Rep.-Dec.80**

COMPILED: Z.M.	DATE:	TENEMENT:	MAP No.
DRAWN: BouY	DATE:	PLAN No. 389	REPORT No. 7185-41
LAST REVISION:		SCALE: 1:10 000	PROJECT No. 71-85
T.C. TO BORN:	REF:		

Fig.-4-

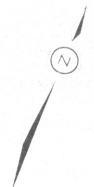
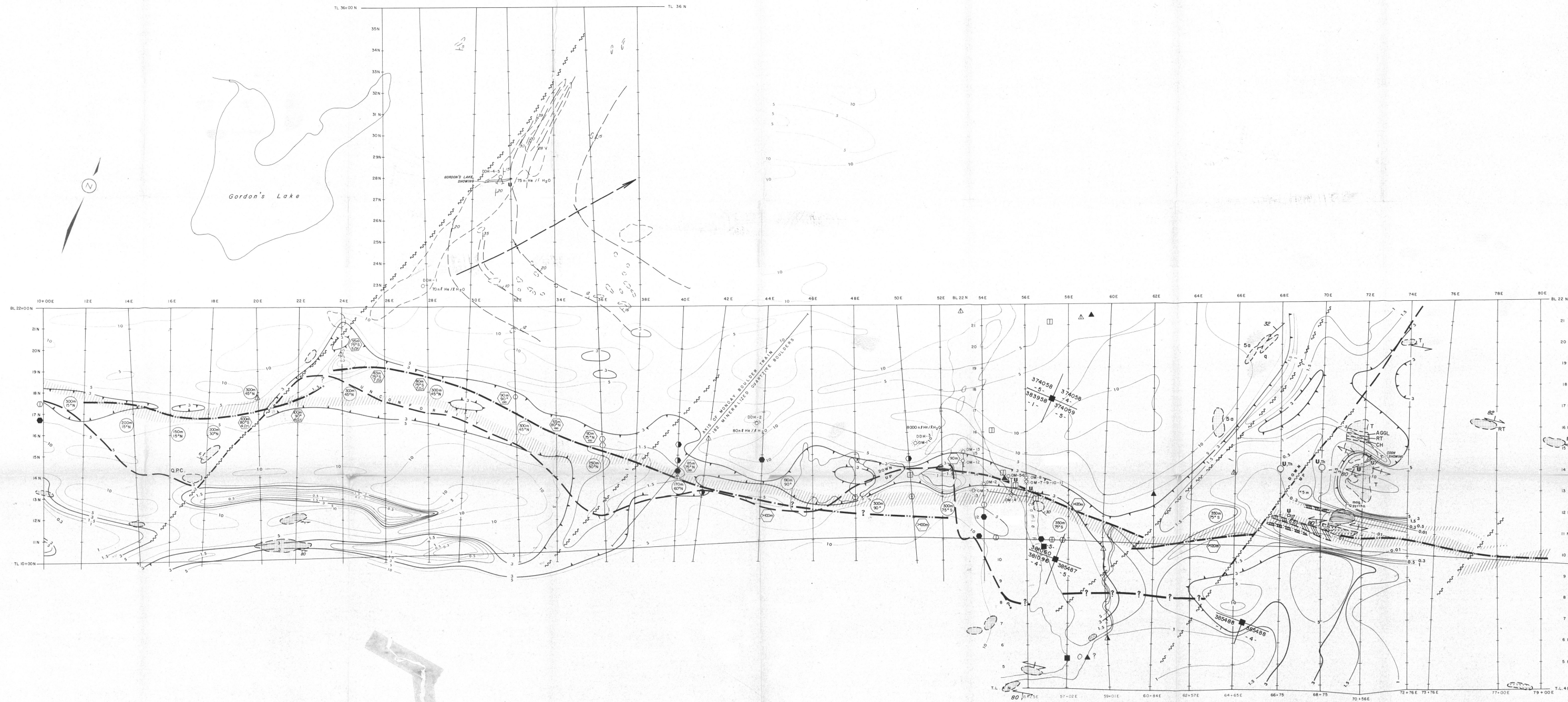

Gordon's Lake

GORDON'S LAKE
D.D.H. - 1
70m He / H₂O

TRAIL OF MONDAY BOULDER TRAIN
HEAVY MINERALIZED GRANITE BOULDERS

8000 n.l. He / H₂O
D.D.H. - 3

374058
383958
374059
- 4 -
- 5 -

384560
381096
- 4 -

385487
- 5 -

385488
385488
- 4 -

LEGEND

PLEISTOCENE
S and semi-consolidated, cross-bedded, highly limonitized.

PRECAMBRIAN
Indicator F.M. quartzites, chlorite, pebble conglomerate - altered at base.
Metalliferous T. generally undisturbed.
RT generally hydrothermal.
Cherty unit.
AGG. - volcanic agglomerate.
Cherty Iron F.M. magnetite, pyrrhotite, pyrite.
Basic Volcanic Flow.

Unconformity (mostly geophysical interpretation).
Unconformity (assumed).
Strike and dip bedding, foliation.
Fault.
Bedding trend, syncline with plunge direction.
Location of claim post.

U URANIUM - OUTCROP
U URANIUM - BOULDERS
DM-4 Diamond drill hole intersecting U - mineralization
(D.D.H. = Drilled by NORANDA in 1968
O.M. = Drilled by U.E.M. in 1980)

Apparent resistivity - contours (30 x 31 m)
Areas of low resistivity outlined by wavy lines are interpreted as due to a major fault.

E.M. CONDUCTORS:
Horizontal loop defined, depth to the top, dip, conductivity - thickness-product
Vertical loop defined
Magnetic disk, depth to the top, dip (susceptibility 2 x 10⁻⁴ - 4 x 10⁻⁴ e.m.u.)

CLASSIFICATION OF GEOCHEMICAL ANOMALIES

URANIUM IN SOILS		HELIUM IN SOILS		RADON IN SOIL GAS	
TRACKS - ECU		TRACKS - ECU		TRACKS - ECU	
1st ORDER ▲	≥ 7.3 ppm	■	9.970 n.l. He / l. Mud	●	39.2 TRACKS / cm ²
2nd ORDER △	5.7 - 7.3 ppm	□	822 - 970	○	32.4 - 39.1
3rd ORDER ▽	4.1 - 5.7 ppm	◇	674 - 822	◐	25.6 - 32.3

RADON: Samples were taken west of Camie River in the area outlined by .
HELIUM: Samples were taken along the bank of Camie River.
URANIUM: Samples were taken along the bank of Camie River as well as in the area outlined by .

D.D.H. - 3
○ 8000 n.l. He / H₂O HELIUM LEVEL in waters of D.D.H. - 3

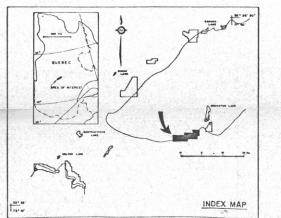

Ministère de l'Énergie et des Ressources
Gouvernement du Québec
Documentation Technique
DATE: 24 NOV 1981
N. C. 37604

URANERZ EXPLORATION & MINING LTD.

PROJECT NO. 71-85, (Bea-Zor/Olish West)
Gordon's Lake Grid
COMPILATION OF SURVEYS

OWNER: U.E.M.	DATE: 08-10-80	FILE NO.	REV. NO.
DRAWN: J.L.	DATE: 01-08-80	SCALE: 1:5000	PROJECT NO. 71-85
LAST REVISION:			
TECH. DRAWING:			

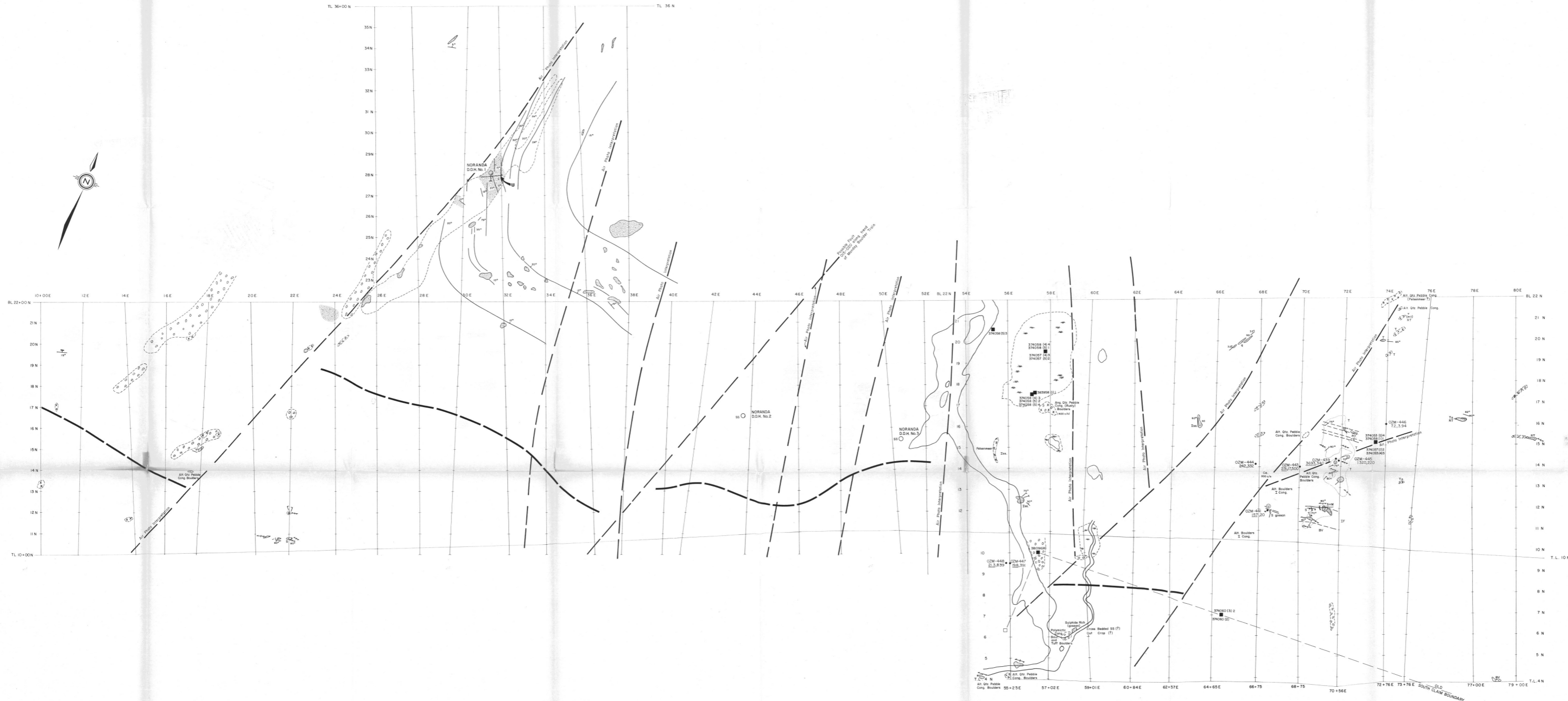

LEGEND

T	TUFF	andetic (T) some basic
RT	TUFF	rhyolite
CH	CHERT	
CONG	CONGLOMERATE	(volcanic)
CIFF	CHERTY IRON FORMATION	
BV	BASIC VOLCANIC flow	
S	SULPHIDES	
M	MAGNETIC (Mt. pyrrh.)	
I	INDICATOR	Fm.
bs	Sandstone	
cg	Conglomeratic	
q	Quartzite	
sc	Schistose	
U	URANIUM	mineralization
- - -	INTERPRETED FAULT	air photo lineation geological interpretation geological interpretation
- - -	CONTACT UNCONFORMITY	
- - -	BASEMENT/INDICATOR Fm.	
- - -	GEOLOGIC CONTACT (Interpreted)	
- - -	GEOLOGIC CONTACT (Observed)	
○	BOULDER FIELD	
○	FELSENMEER	
●	OZM-448 ROCK SAMPLE ANALYSES	H ₂ O ₂ , ThO ₂ PPM

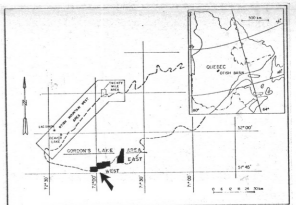

0 100 200 300 400 500 metres

Ministère de l'Énergie et des Ressources
Gouvernement du Québec
Documentation Technique
N° 1 100 889
37604

URANERZ EXPLORATION & MINING LTD.

PROJECT NO. 71-85, (Bea-Zor/Oish West)
Gordon's Lake Grid
GEOLOGY

Drawn: J. W.	Scale: 1:50,000	Project No.
Date: 07/88	Scale: 1:50,000	
Sheet No.	Scale: 1:50,000	
Scale: 1:50,000	Scale: 1:50,000	

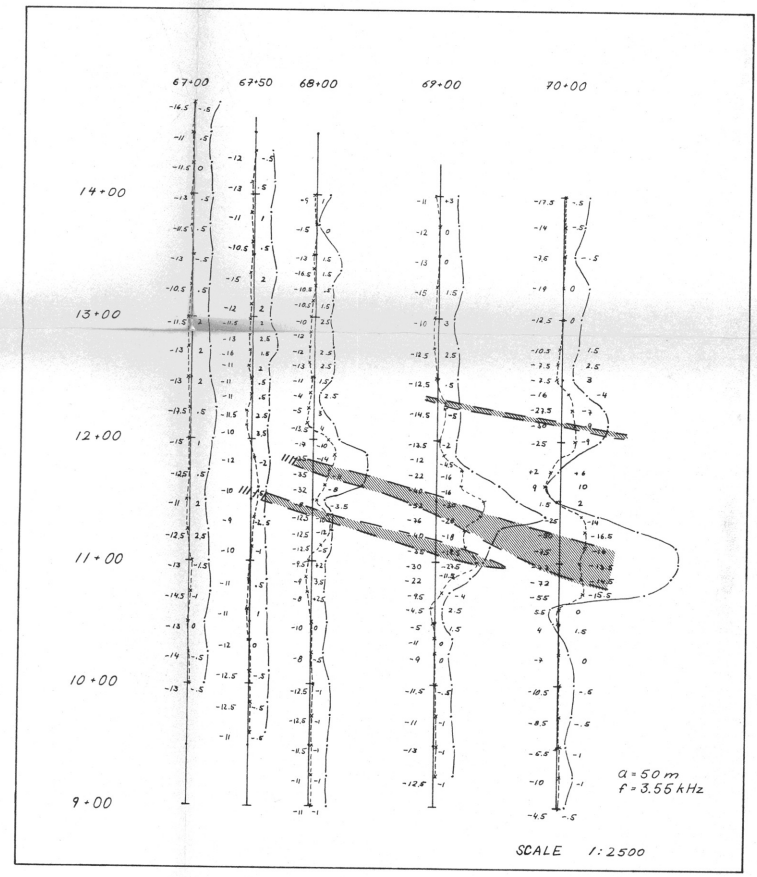
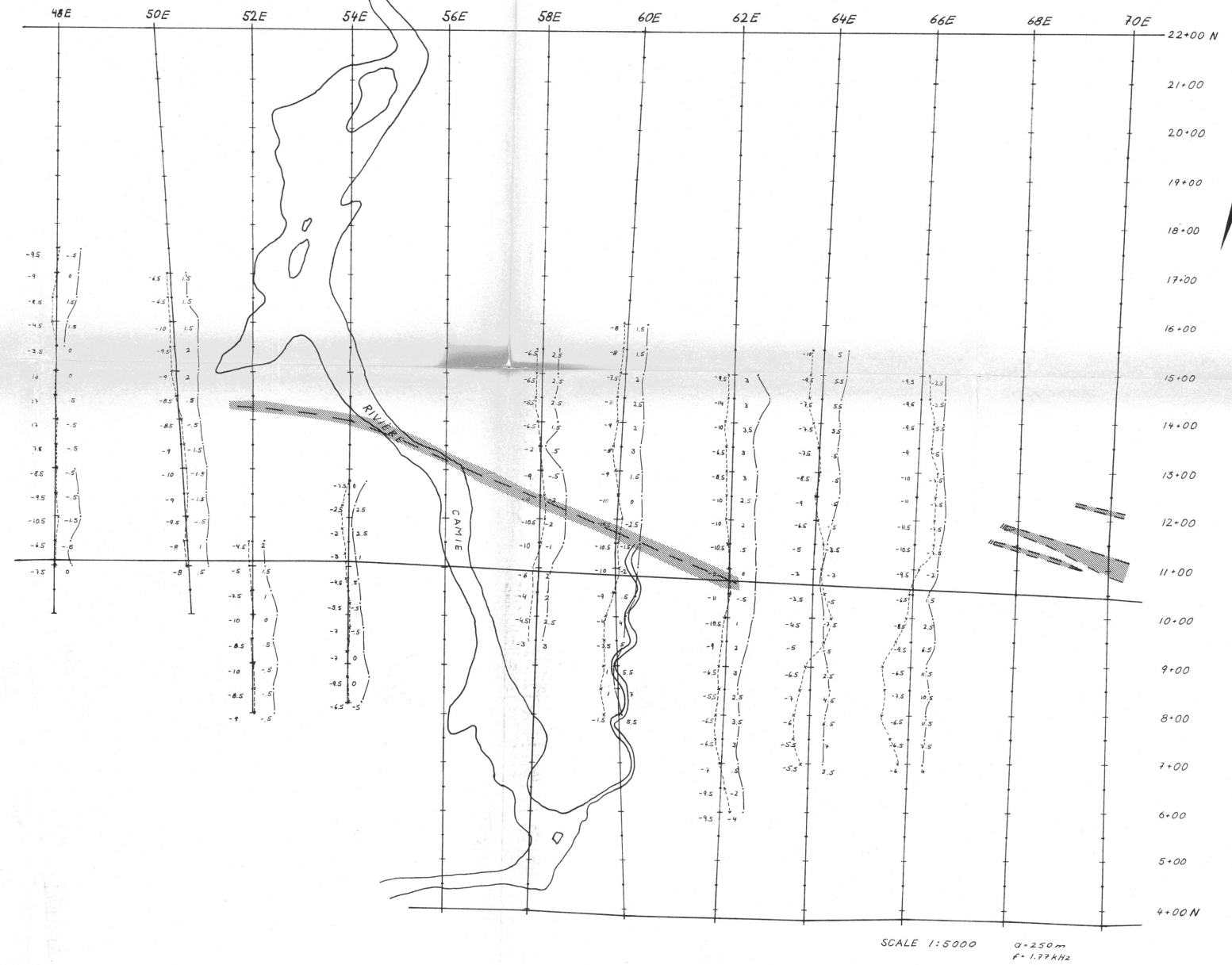
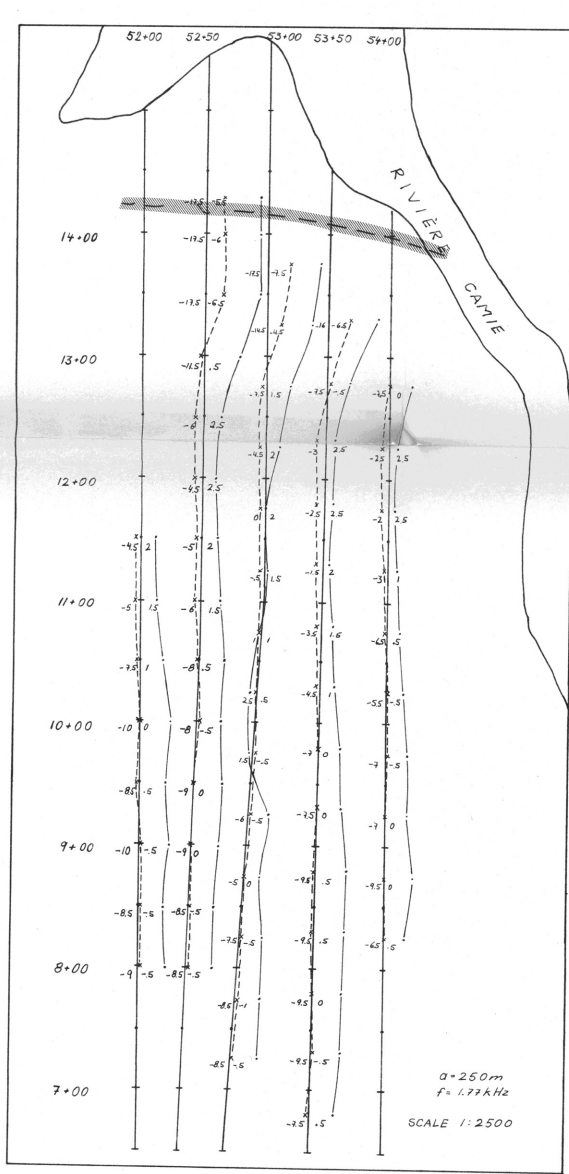

HORIZONTAL LOOP SURVEY

LEGEND

— INPHASE I
 - - - QUADRATURE Q

I (%) Q (%)

20% 10 0 -10 -20 a = 250 m
 40% 20 0 -20 -40 a = 50 m
 I, Q

HEM. CONDUCTOR

INSTR: APEX MAX MIN II

Ministère de l'Énergie et des Ressources
 Gouvernement du Québec
 Documentation Technique
 21 Nov 80

DATE: _____
 No. G.M.: **37604**

100 50 0 100 200 300 m
 CENTIMETRES

URANERZ EXPLORATION & MINING LTD.

PROJECT 71-85 BEAVER-ZORAN / OTISH WEST
 Gordon's Lake Area.
 Horizontal Loop EM. Survey, Camie River.
 Seasonal Geophysical Report, June-Dec 1980.

COMPILED: M.L.	DATE: Sept 80	TECHNICAL: _____	MAP No. 754
DRAWN: B. Lep.	DATE: " "	PLAN No. _____	REPORT No. _____
LAST REVISION: _____	SCALE: 1:5000	PROJECT No. 71-85	
T.C. TO BOMB: _____	REF: _____		

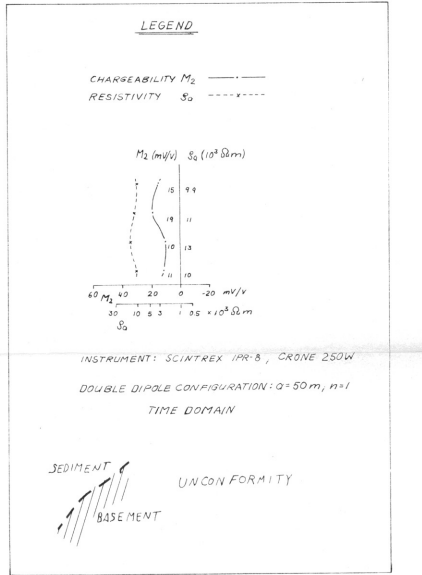
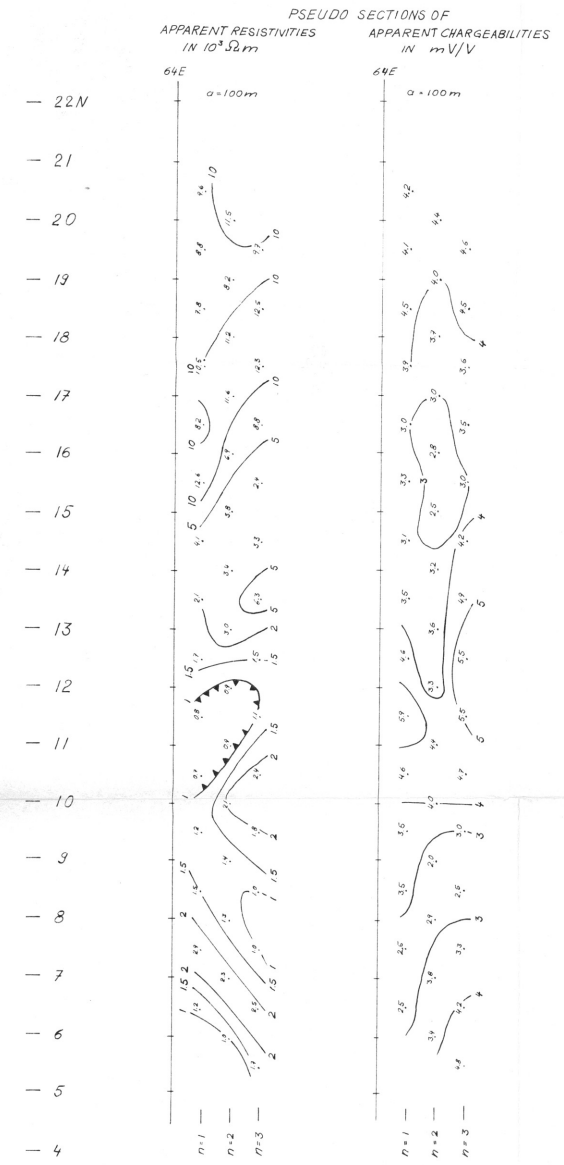
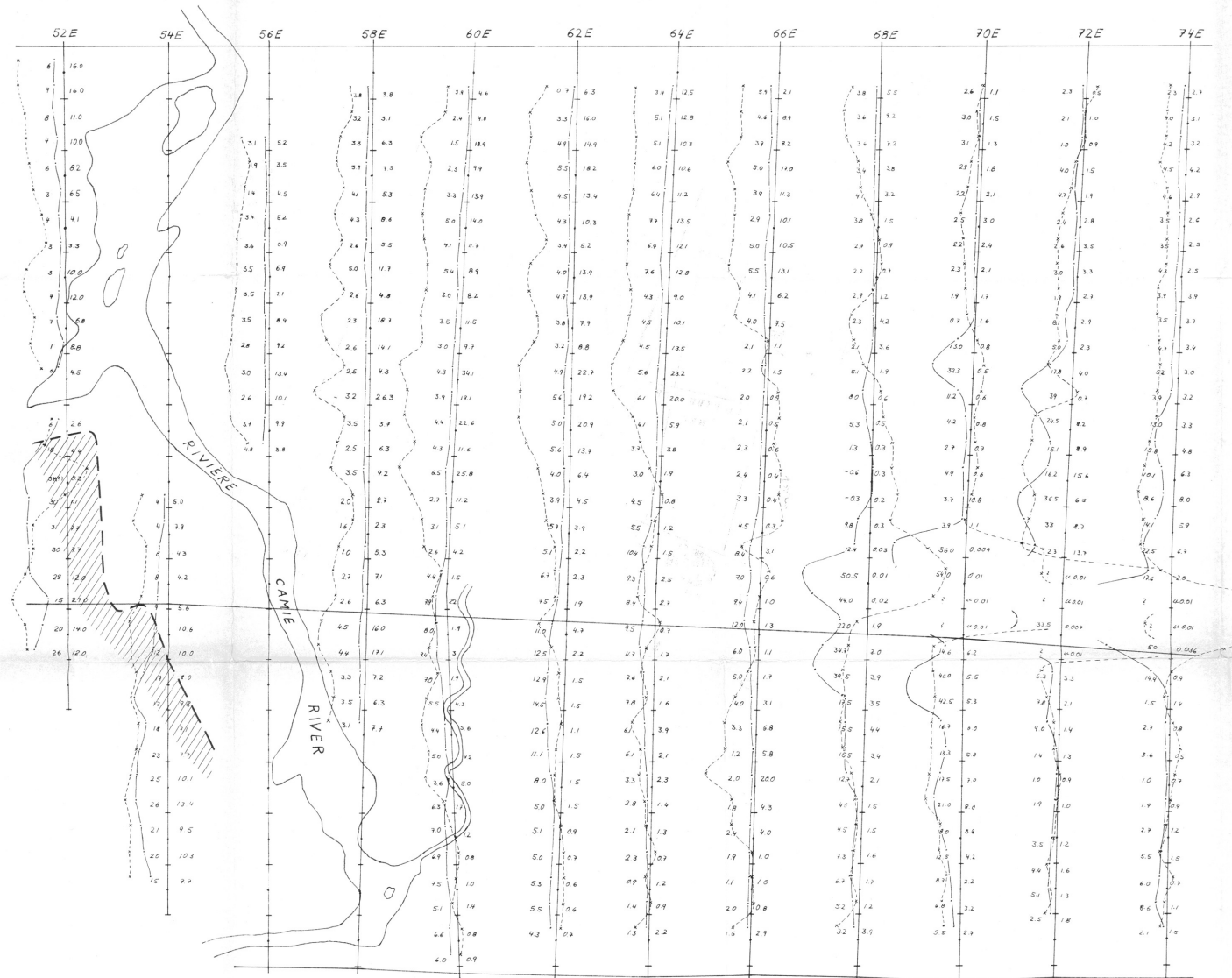
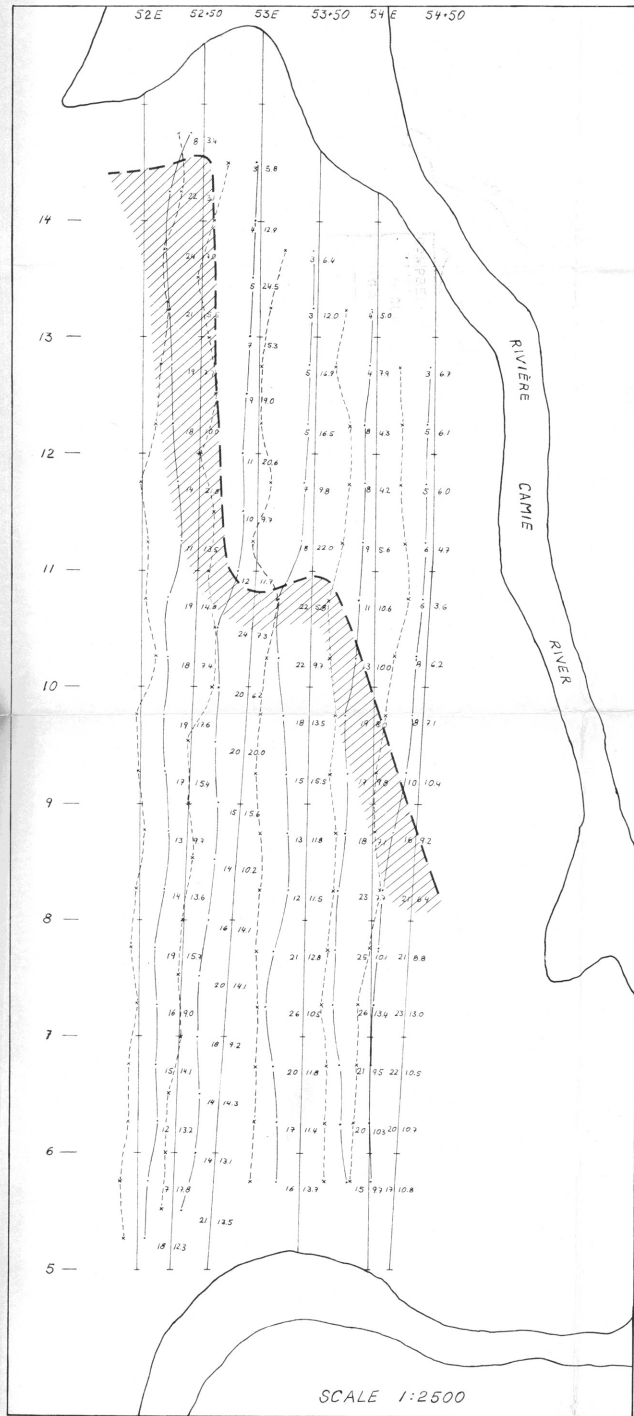

Ministère de l'Énergie et des Ressources
Gouvernement du Québec
Documentation Technique
DATE: 24 NOV 1981
No. G.M.: 37604



URANERZ EXPLORATION & MINING LTD.

PROJECT NO. 71-85 Beazor(Otish West)
Gordon's Lake Area.
Induced Polarisation Survey, Camie River.
Seasonal Geophysical Report, June-Dec.1980.

COMPILED: M.L.	DATE: Sept 80	TECHNICAL: M.L.	MAP NO: 3/82
DRAWN: J.L.P.	DATE: "	PLAN NO: "	REPORT NO: "
LAST REVISION:		SCALE: 5000	PROJECT NO: 71-85
TC TO BOM:	REF:		

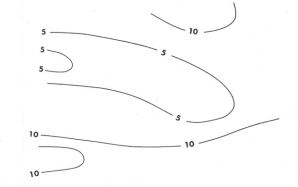
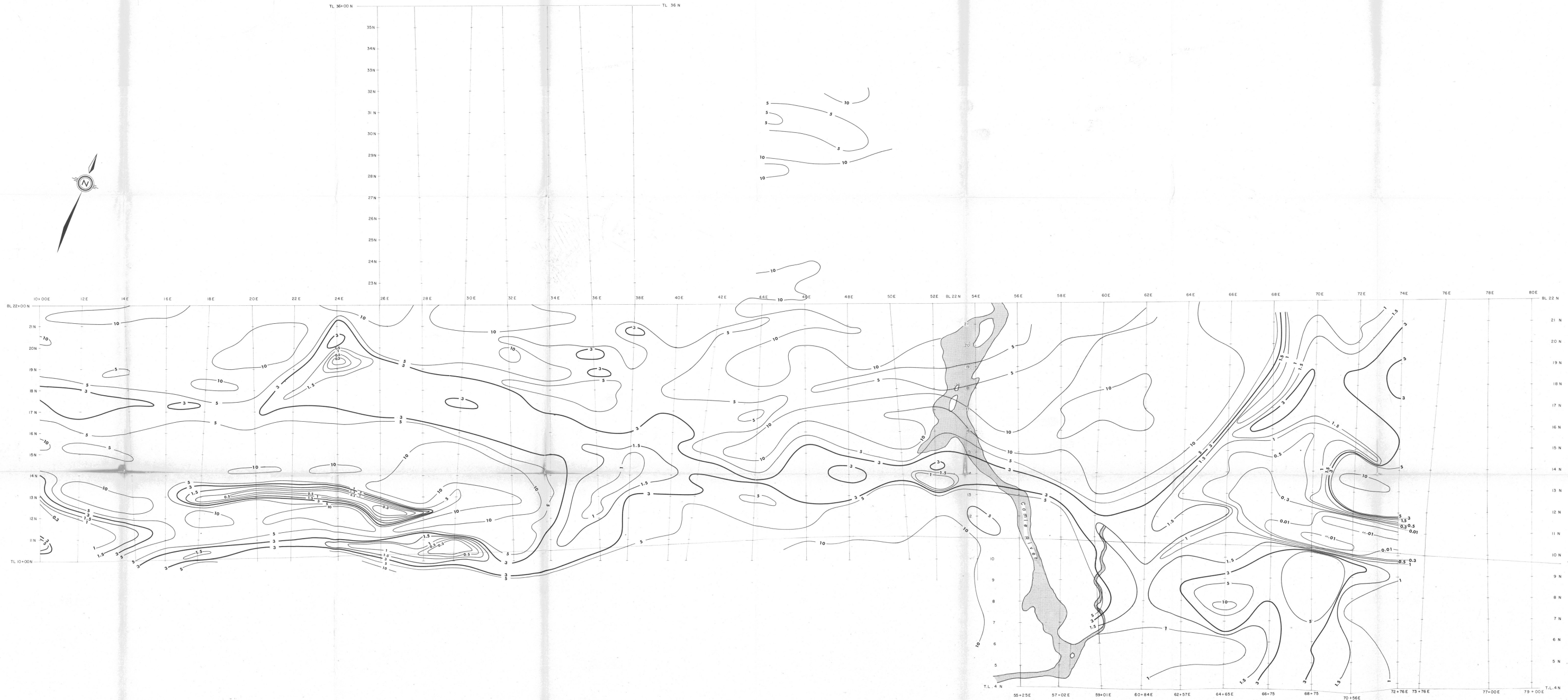

LEGEND

DOUBLE DIPOLE ARRAY, $a=50\text{ m}$, $n=1$.

Apparent Resistivity Contours, 1000 $\Omega\cdot\text{m}$.

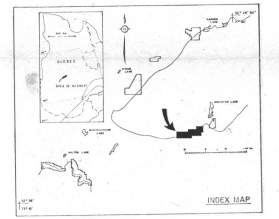

Ministère de l'Énergie et des Ressources
 Gouvernement du Québec
 Documentation Technique
 INT. 1-198-100
 No. CH. 37604

SCALE 1:50,000 ÉCHELLE

URANERZ EXPLORATION & MINING LTD.

PROJECT NO-71-85, Bea-Zor/Otish West
 Gordon's Lake Area
 INDUCED POLARISATION SURVEY
 Contoured Data

Seasonal Geophysical Report, June-December 1980	Contoured Data
DATE: 02/81	REVISION: 01
DATE: 08/81	REVISION: 02
DATE: 11/81	REVISION: 03
DATE: 01/82	REVISION: 04
DATE: 03/82	REVISION: 05
DATE: 05/82	REVISION: 06
DATE: 07/82	REVISION: 07
DATE: 09/82	REVISION: 08
DATE: 11/82	REVISION: 09
DATE: 01/83	REVISION: 10
DATE: 03/83	REVISION: 11
DATE: 05/83	REVISION: 12
DATE: 07/83	REVISION: 13
DATE: 09/83	REVISION: 14
DATE: 11/83	REVISION: 15
DATE: 01/84	REVISION: 16
DATE: 03/84	REVISION: 17
DATE: 05/84	REVISION: 18
DATE: 07/84	REVISION: 19
DATE: 09/84	REVISION: 20
DATE: 11/84	REVISION: 21
DATE: 01/85	REVISION: 22
DATE: 03/85	REVISION: 23
DATE: 05/85	REVISION: 24
DATE: 07/85	REVISION: 25
DATE: 09/85	REVISION: 26
DATE: 11/85	REVISION: 27
DATE: 01/86	REVISION: 28
DATE: 03/86	REVISION: 29
DATE: 05/86	REVISION: 30
DATE: 07/86	REVISION: 31
DATE: 09/86	REVISION: 32
DATE: 11/86	REVISION: 33
DATE: 01/87	REVISION: 34
DATE: 03/87	REVISION: 35
DATE: 05/87	REVISION: 36
DATE: 07/87	REVISION: 37
DATE: 09/87	REVISION: 38
DATE: 11/87	REVISION: 39
DATE: 01/88	REVISION: 40
DATE: 03/88	REVISION: 41
DATE: 05/88	REVISION: 42
DATE: 07/88	REVISION: 43
DATE: 09/88	REVISION: 44
DATE: 11/88	REVISION: 45
DATE: 01/89	REVISION: 46
DATE: 03/89	REVISION: 47
DATE: 05/89	REVISION: 48
DATE: 07/89	REVISION: 49
DATE: 09/89	REVISION: 50
DATE: 11/89	REVISION: 51
DATE: 01/90	REVISION: 52
DATE: 03/90	REVISION: 53
DATE: 05/90	REVISION: 54
DATE: 07/90	REVISION: 55
DATE: 09/90	REVISION: 56
DATE: 11/90	REVISION: 57
DATE: 01/91	REVISION: 58
DATE: 03/91	REVISION: 59
DATE: 05/91	REVISION: 60
DATE: 07/91	REVISION: 61
DATE: 09/91	REVISION: 62
DATE: 11/91	REVISION: 63
DATE: 01/92	REVISION: 64
DATE: 03/92	REVISION: 65
DATE: 05/92	REVISION: 66
DATE: 07/92	REVISION: 67
DATE: 09/92	REVISION: 68
DATE: 11/92	REVISION: 69
DATE: 01/93	REVISION: 70
DATE: 03/93	REVISION: 71
DATE: 05/93	REVISION: 72
DATE: 07/93	REVISION: 73
DATE: 09/93	REVISION: 74
DATE: 11/93	REVISION: 75
DATE: 01/94	REVISION: 76
DATE: 03/94	REVISION: 77
DATE: 05/94	REVISION: 78
DATE: 07/94	REVISION: 79
DATE: 09/94	REVISION: 80
DATE: 11/94	REVISION: 81
DATE: 01/95	REVISION: 82
DATE: 03/95	REVISION: 83
DATE: 05/95	REVISION: 84
DATE: 07/95	REVISION: 85
DATE: 09/95	REVISION: 86
DATE: 11/95	REVISION: 87
DATE: 01/96	REVISION: 88
DATE: 03/96	REVISION: 89
DATE: 05/96	REVISION: 90
DATE: 07/96	REVISION: 91
DATE: 09/96	REVISION: 92
DATE: 11/96	REVISION: 93
DATE: 01/97	REVISION: 94
DATE: 03/97	REVISION: 95
DATE: 05/97	REVISION: 96
DATE: 07/97	REVISION: 97
DATE: 09/97	REVISION: 98
DATE: 11/97	REVISION: 99
DATE: 01/98	REVISION: 100

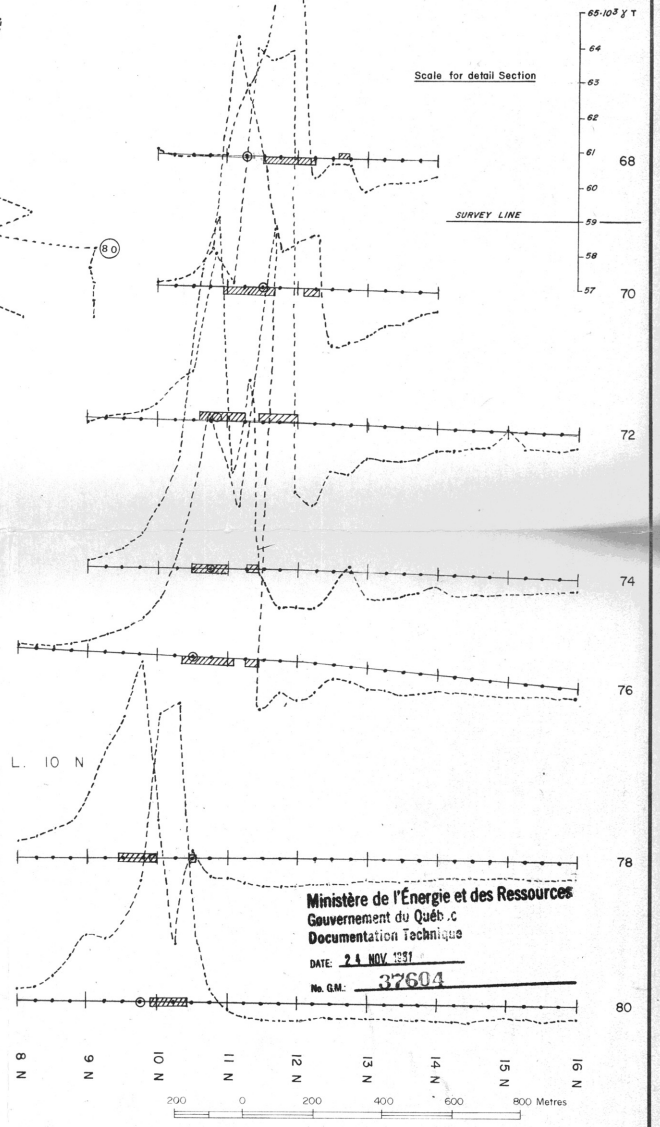
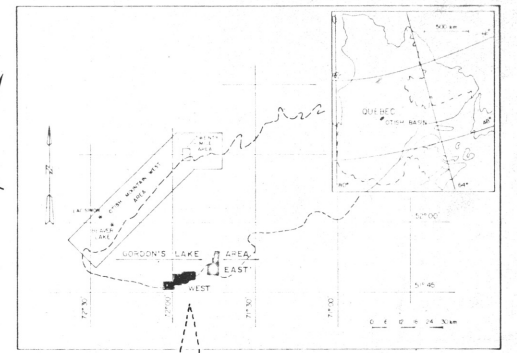
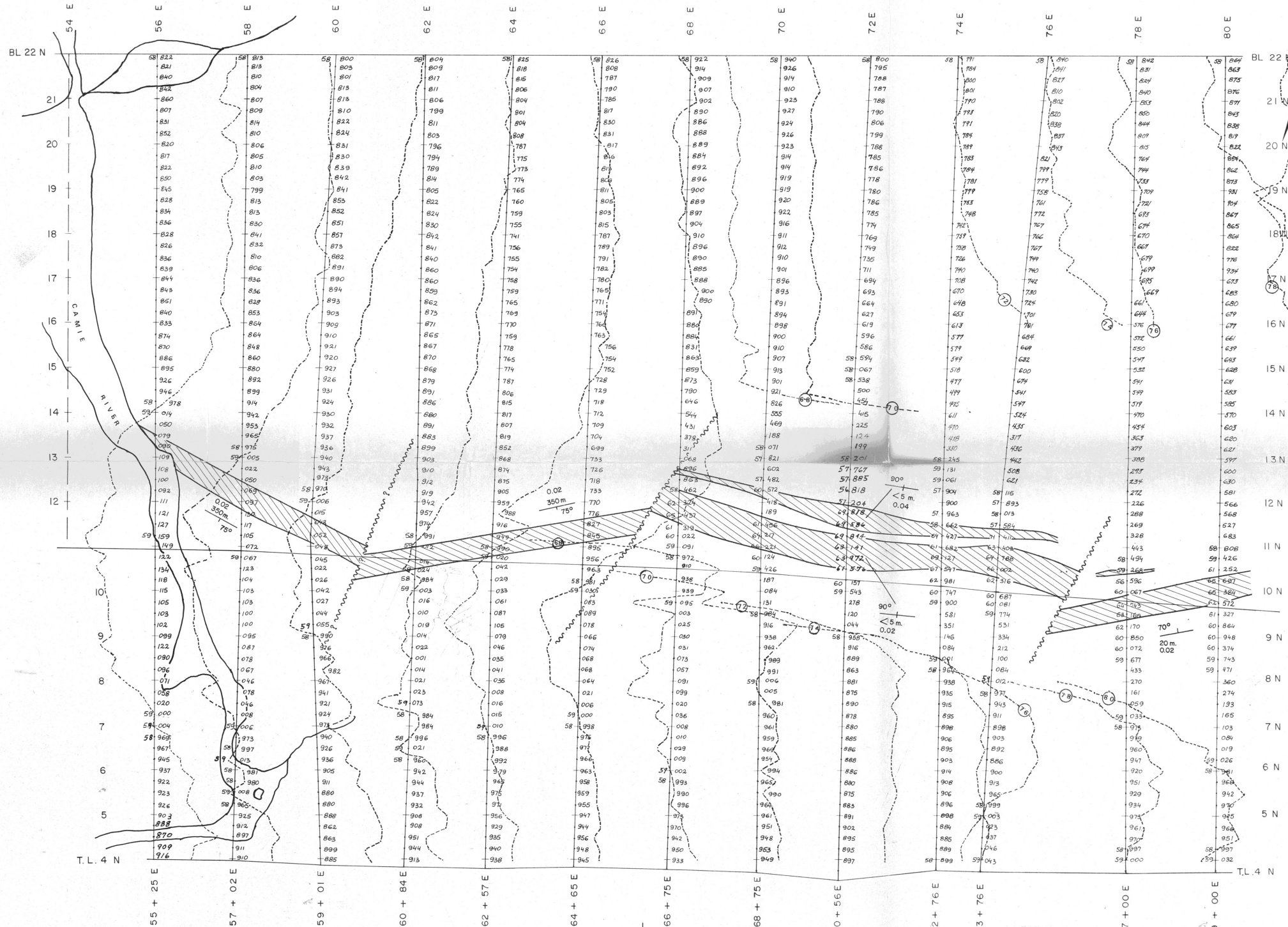

Ministère de l'Énergie et des Ressources
Gouvernement du Québec
Documentation Technique
DATE: 24 NOV 1981
No. G.M.: 37604

URANERZ EXPLORATION AND MINING LIMITED			
PROJECT: BEAVER/ZORAN - OTISH WEST 71-85			
GORDON'S LAKE AREA - WEST BLOCK			
MAGNETOMETER SURVEY			
SEASONAL GEOPHYSICAL REPORT: JAN. - MAY, 1980			
DATE: June 1980	REP. RAP. No.	MAP. CARTE No. 337	
DATE: Aug. 1980			
SCALE: ECH. 1:5000	PROJ. No. 71-85		

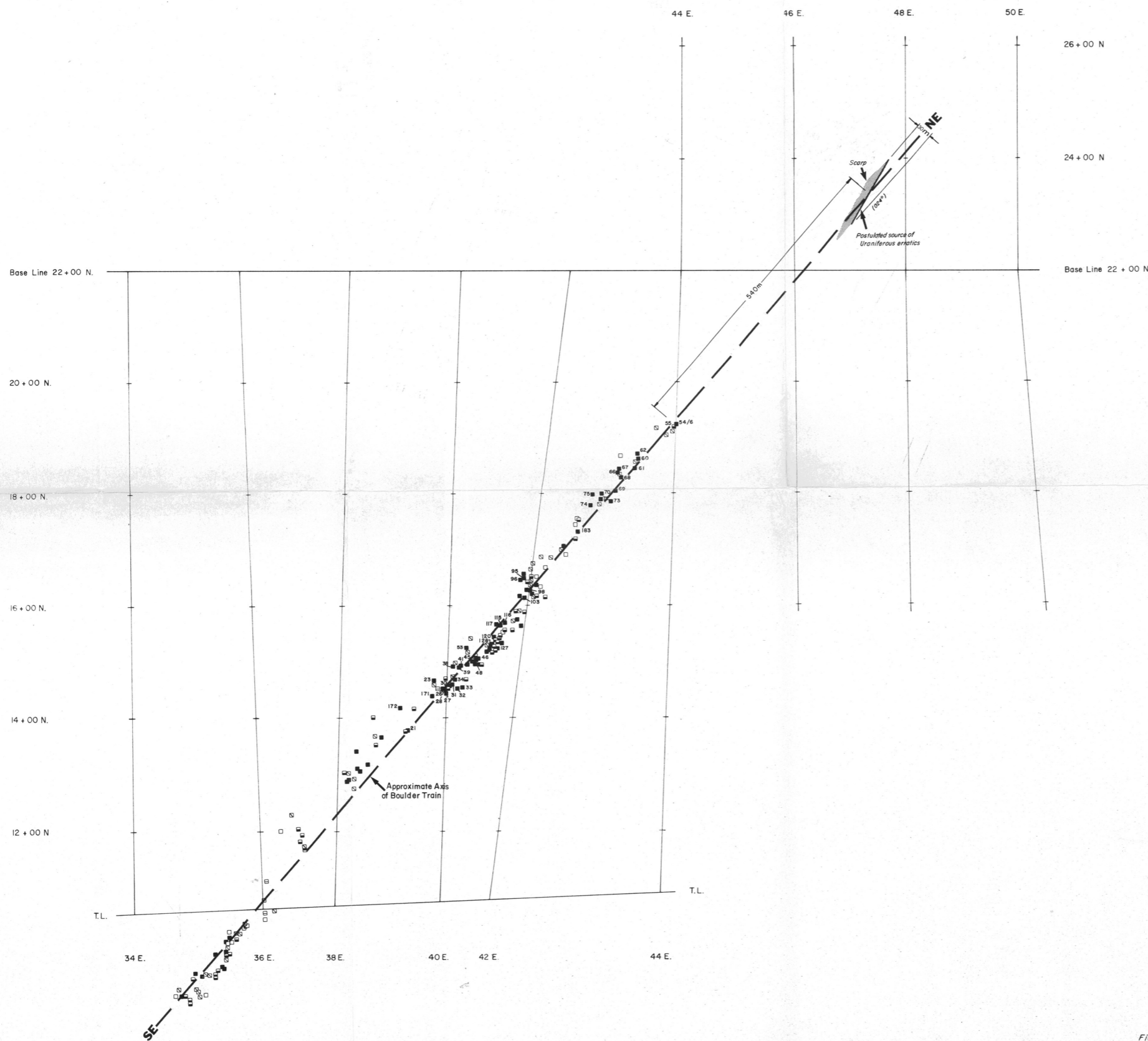

LEGEND

□	Sedimentary Boulder	200 - 1000 c/s
○	"	1000 - 2000 c/s
◻	"	2000 - 5000 c/s
■	"	> 5000 c/s
183	'U' Erratics Examined In Glacial Study.	

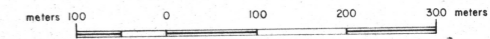
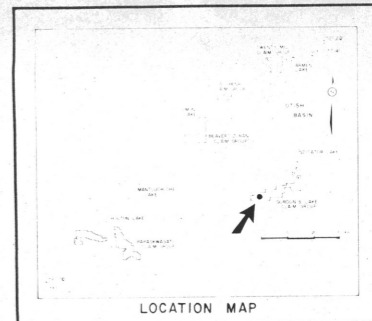

Ministère de l'Énergie et des Ressources
 Gouvernement du Québec
 Documentation Technique
 DATE: 24 NOV. 1981
 No. RM: **37604**

URANERZ EXPLORATION AND MINING LIMITED			
PROJET NO. 71-85 (Bea-Zor./Otish West) Gordon's Lake Area MONDAY BOULDER TRAIN DISTRIBUTION OF 'U' ERRATICS; POSTULATED SOURCE			
COMP. J.M.-Z.M.	DATE Oct. 1980	REP. RAP. No.	MAP. CARTE No. 410
DRAWN DESS YR.-A.R.	DATE Nov. "	SCALE ECH 1:4000	PROJ. No. 71-85
REVISION			FILE DOSS No.
T.C. TO RUNN	N.T.S. REF.		

Fig-5-

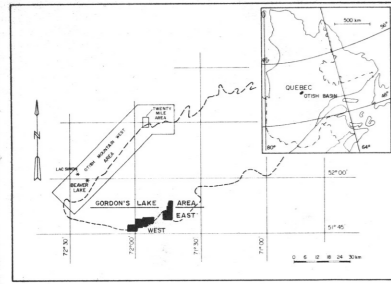

TL 36+00 N TL 36 N

35 N
34 N
33 N
32 N
31 N
30 N
29 N
28 N
27 N
26 N
25 N
24 N
23 N

Gordon's Lake
Uranium Showing

BL 22+00 N 10+00E 12E 14E 16E 18E 20E 22E 24E 26E 28E 30E 32E 34E 36E 38E 40E 42E 44E 46E 48E 50E 52E 54E BL 22+00 N

21 N
20 N
19 N
18 N
17 N
16 N
15 N
14 N
13 N
12 N
11 N

TL 10+00 N

LEGEND

Sample Number
Uranium in Soil (ppm)
Radon in Soil-Gas (tracks/mm²)

ANOMALY CLASSIFICATION

Uranium in Soil	Radon in Soil-Gas
1 st ORDER ▲ > 75 ppm	1 st ORDER ● > 392 tracks/mm ²
2 nd ORDER ▲ 57-75 "	2 nd ORDER ● 324-391 "
3 rd ORDER ▲ 41-57 "	3 rd ORDER ● 256-323 "
4 th ORDER ▲ 25-41 "	4 th ORDER ● (Normalized on 30 Days covering period)

Total Mean: 0.9 ppm
Standard Deviation: 1.6 ppm

Total Mean: 12.0 tracks/mm²
Standard Deviation: 6.6 tracks/mm²

Axis of EM Conductor

Ministère de l'Énergie et des Ressources
Gouvernement du Québec
Documentation Technique
DATE: 24 OCT 1981
No. GM: 37604

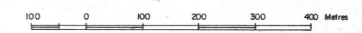

URANERZ EXPLORATION AND MINING LIMITED

PROJECT: BEAVER-ZORAN / OTISH WEST 71-85
GORDON'S LAKE WEST BLOCK
Radon (tracks) and Uranium in Soil Survey
SEASONAL GEOPHYSICAL REPORT 1980

COMP. M. L.	DATE: May 1980	REP. REP. No. 71-85 /	MAP/ CARTÉ. No. 55B
DRAWN/ Dess. M. L. Y.B.	DATE: Sept. 1980	Jan-May 1980	
REVISION:	SCALE: ED. 1: 5 000	PROJ. No. 71-85	
T.E. TO BURN:	INT. S. REF.:	FILE/ DOSS. No.:	

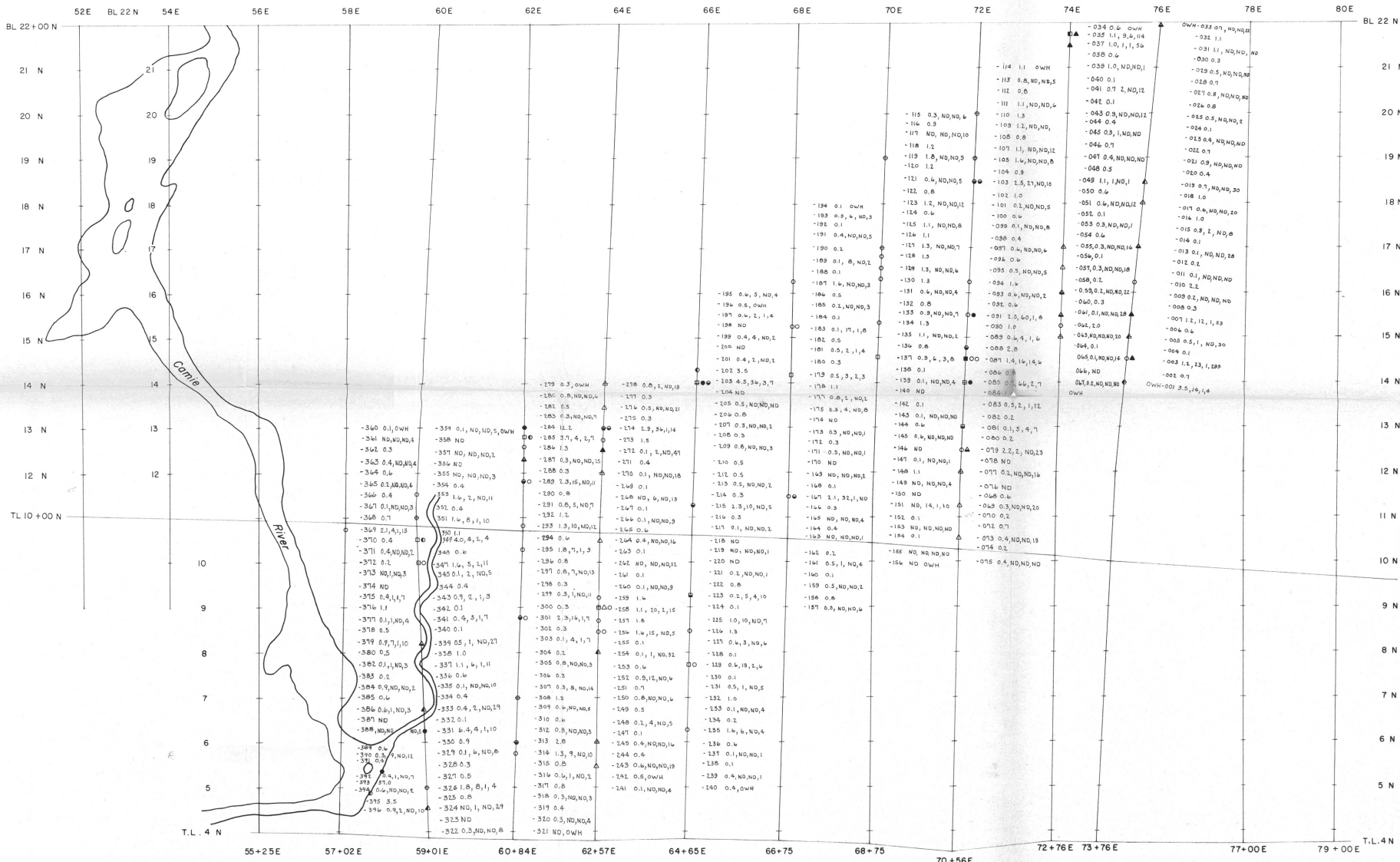

LEGEND

N.D. Not Detected
 ● OWH 051 Sample No. & Location
 (3,3,6,4,ND) (U,Cu,Co,Ni) PPM
 U PPM

Anomaly

Order	U	Co	Cu	Ni
1st Order	▲	■	●	●
2nd Order	▲	■	●	●
3rd Order	▲	■	●	●
4th Order	▲	■	●	●

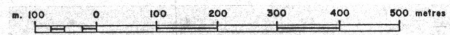
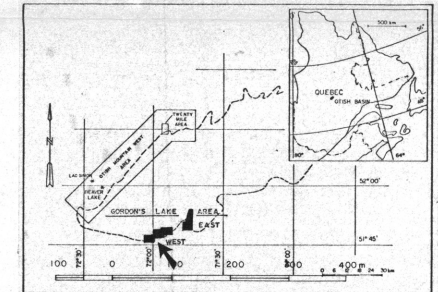

Ministère de l'Énergie et des Ressources
 Gouvernement du Québec
 Documentation Technique

DATE: 24 Nov 81
 No. GM: 37604

URANERZ EXPLORATION & MINING LTD.

PROJECT NO. 71-85, (Bea-Zor./Otish West)
 Gordon's Lake Grid (East Half)
 SOIL GEOCHEMICAL SURVEY (U,Cu,Co,Ni)

COMPILED: Z.M.	DATE: 06/81	TENEMENT:	MAP No.: 557
DRAWN: A.F.	DATE: 11	PLAN No.:	REPORT No.:
LAST REVISION:		SCALE: 1:5 000	PROJECT No.:
T.C. TO 5000:	REF:		

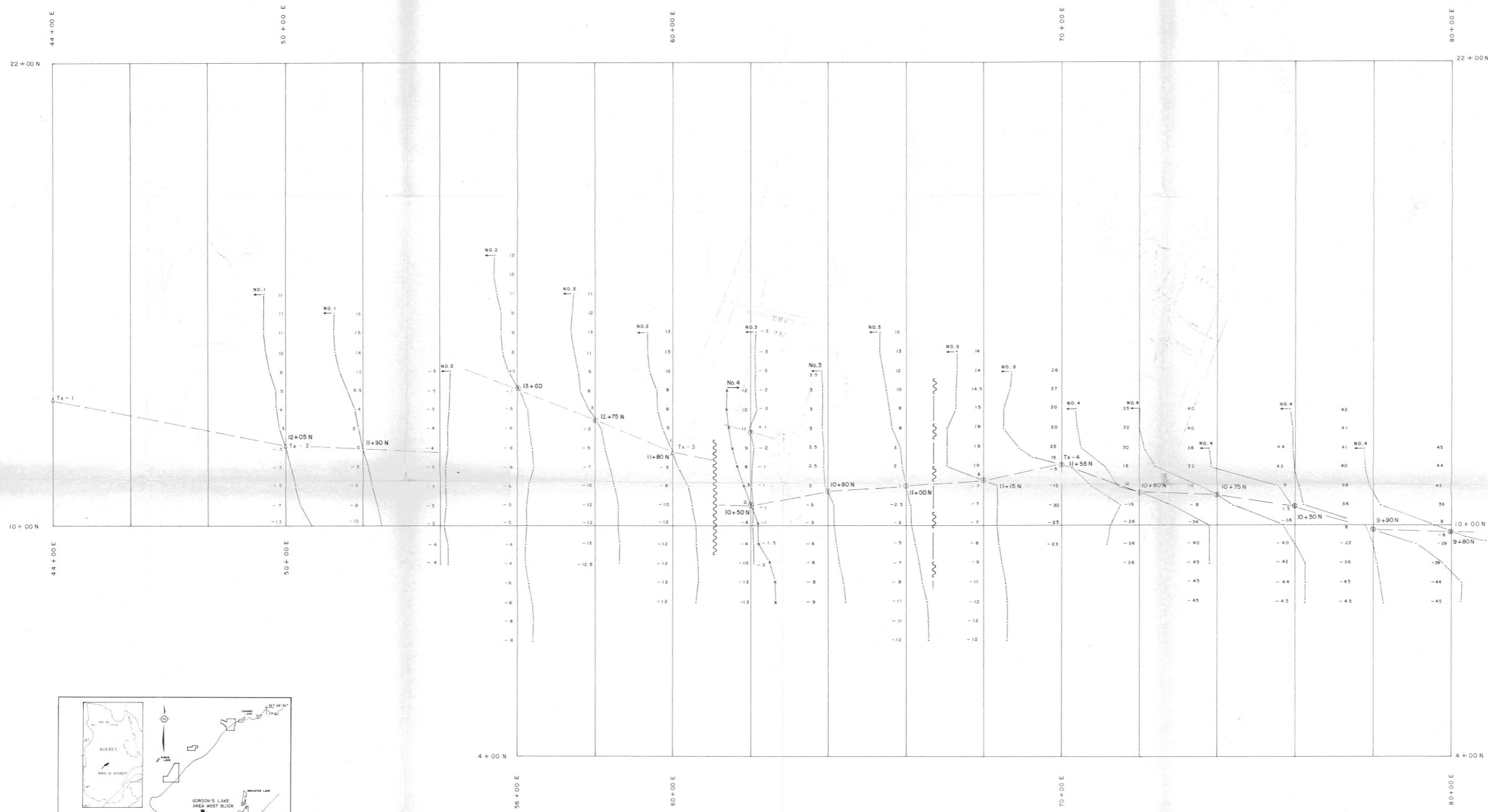

LEGEND

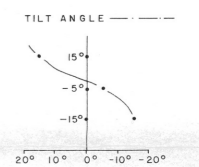

Instr. McPhar SS-15
 Operator - W. Millward
 R. Faubert

Δ Tx - 1 Transmitter location
 ← NO. 1 Direction of reading, No. transmitter
 --- Conductor's Axis
 ~~~~~ Fault  
 ⊗ Cross-over, Location

**Ministère de l'Énergie et des Ressources**  
 Gouvernement du Québec  
 Documentation Technique  
 DATE: 24 NOV. 1984  
 No. G.M.: 37604

SCALE 1:5000

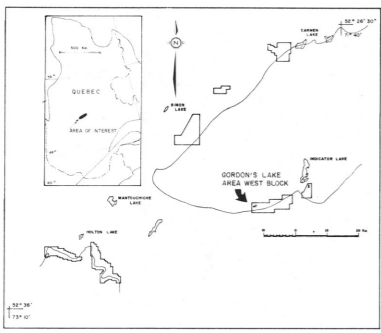
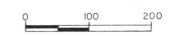

|                                                                                                                                                    |                |               |                  |
|----------------------------------------------------------------------------------------------------------------------------------------------------|----------------|---------------|------------------|
| <b>URANERZ EXPLORATION AND MINING LIMITED</b>                                                                                                      |                |               |                  |
| PROJECT BEAVER-ZORAN / OTISH WEST 71-85<br>GORDON'S LAKE AREA WEST BLOCK<br>VERTICAL LOOP E.M. SURVEY<br>SEASONAL GEOPHYSICAL REPORT JAN.-MAY 1980 |                |               |                  |
| COMP. <i>ML</i>                                                                                                                                    | DATE: 19/08/80 | REP. REP. No. | MAP. CARTE No.   |
| DRAWN/DESS. <i>P.Letn.</i>                                                                                                                         | DATE: 19/08/80 | SCALE: 1:5000 | PROJ. No.: 71-85 |
| REVISION:                                                                                                                                          |                |               | FILE, DISS. No.  |
| I.T.C. TO BUNN                                                                                                                                     | INT. S. REF.   |               |                  |

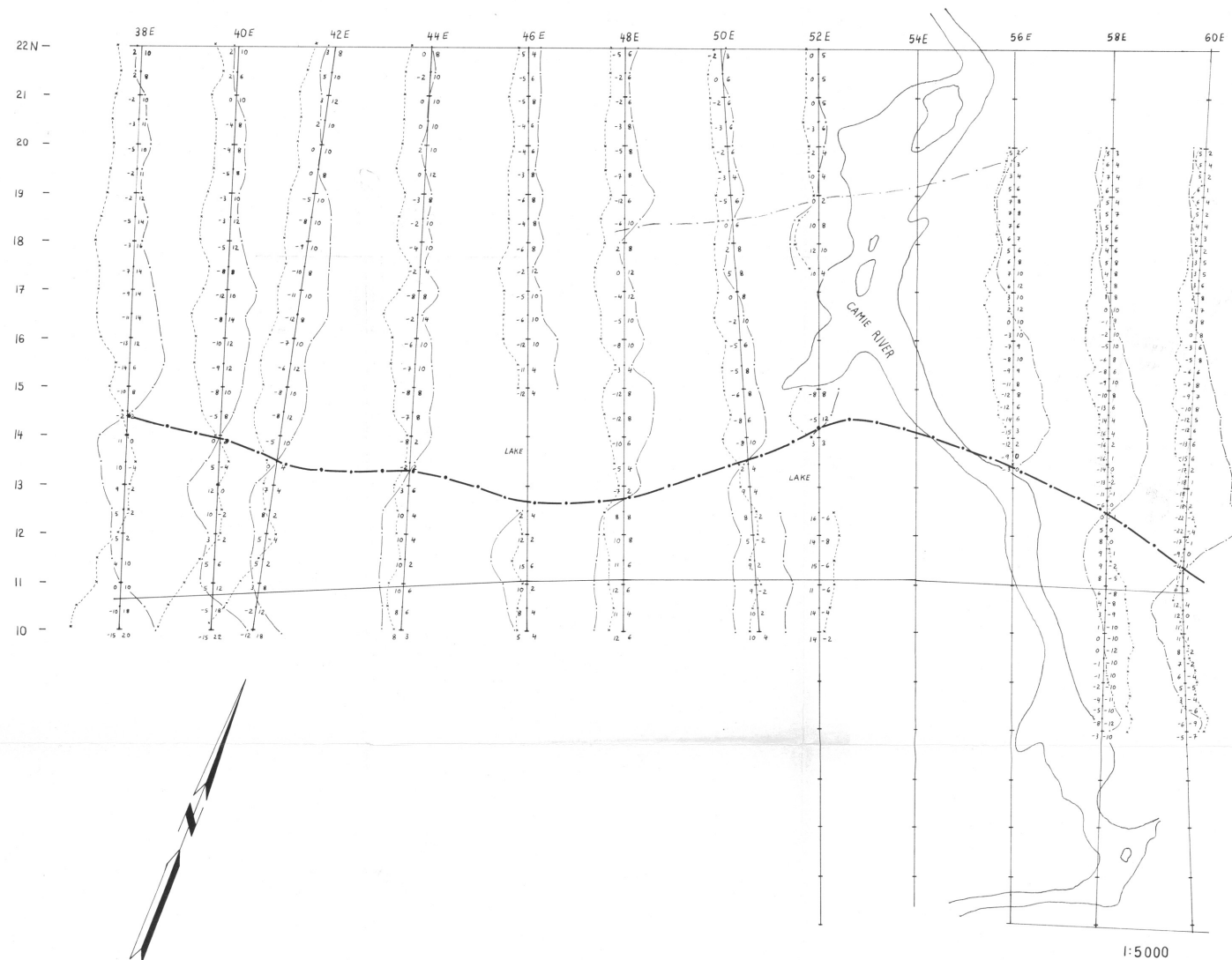

1:5000

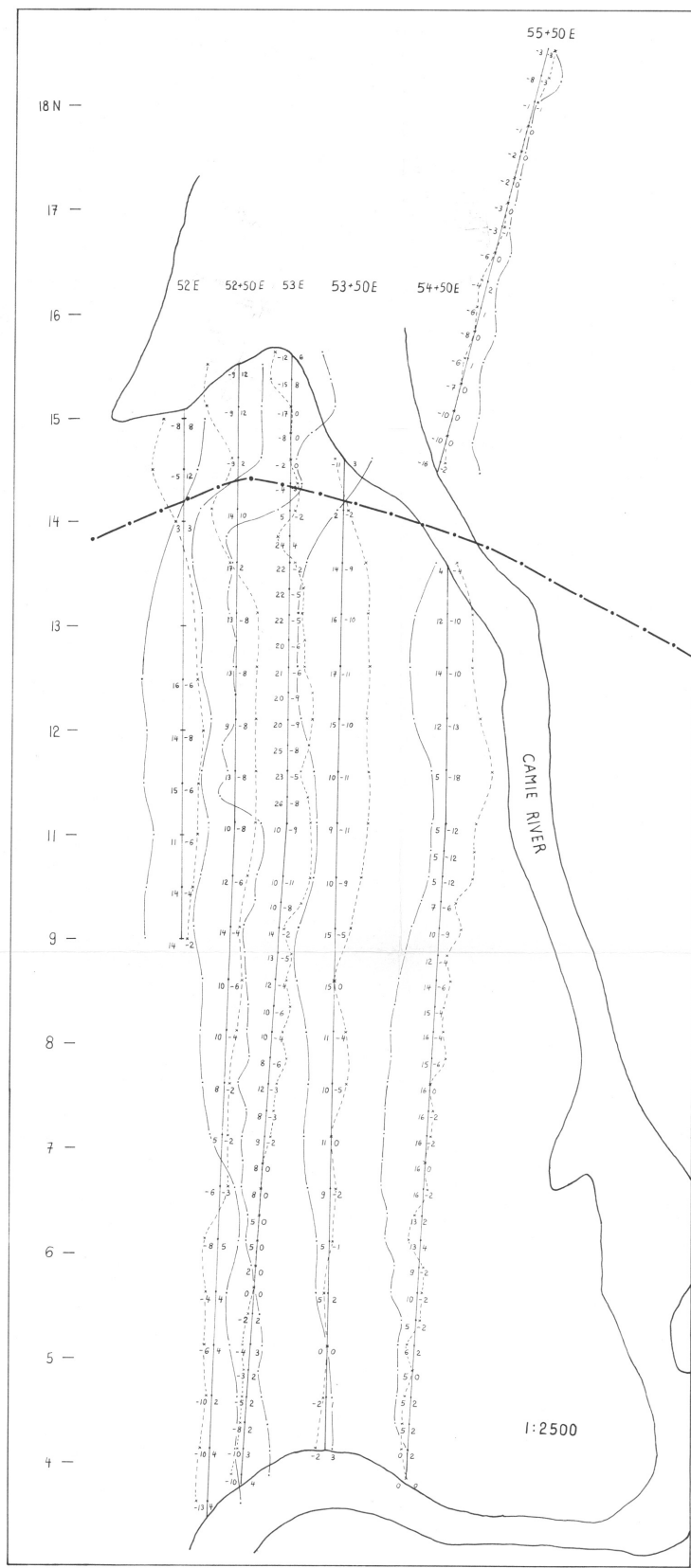

1:2500

**LEGEND**

- - - - - INPHASE I  
 - - - - - QUADRATURE Q

I (%)    Q (%)

-25    0    25

I, Q

INSTR. GEONICS EM-16 RECEIVER  
 READINGS WERE TAKEN FACING NORTH  
 STATION: NLK SEATTLE (WASHINGTON)  
 OPERATORS: N. Mc. BRIED, W. HAMMER

AXIS OF INPHASE-CROSS OVER  
 (POSSIBLE FAULT)

Ministère de l'Énergie et des Ressources  
 Gouvernement du Québec  
 Documentation Technique  
 DATE: 24 NOV. 1981  
 No. G.M.: 37604



**URANERZ EXPLORATION & MINING LTD.**

**PROJECT NO. 71-85 Bea.Zor.(Otish West)**  
 Gordon's Lake Area.  
 VLF (EM-16) Survey, Camie River.  
 Seasonal Geophysical Report, June-Dec 1980.

|                |               |               |            |
|----------------|---------------|---------------|------------|
| COMPILED: 9/81 | DATE: Sept 80 | TENEMENT: 124 | MAP No.    |
| DRAWN: 9/81    | DATE:         | PLAN No.      | REPORT No. |
| LAST REVISION: | SCALE: 5000   | PROJECT No.   | 71-85      |
| T.C. TO BOON:  | REF:          |               |            |