

LEGEND:
 ○ ≤ 5000 cps
 □ ≥ 5000 cps
 — CONTRACTOR GRID
 - - - URANERZ GRID

Ministère des Richesses Naturelles, Québec
 SERVICE DE LA
 DOCUMENTATION TECHNIQUE
 Date: 25 SEP. 1979
 No GM: 34787

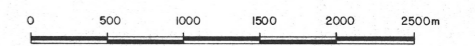

URANERZ EXPLORATION & MINING LTD.

BEAVER LAKE AREA 71-85
LINECUTTING BEAVER LAKE CLAIMS
& RESULTS OF GROUND RADIOMETRIC SURVEY

COMPILED G. H.	DATE AUG. 77	REPORT No AR-7185-1	MAP No. A
DRAWN J. B. H.	DATE AUG. 77	PLAN No.	
LAST REVISION:	SCALE 1 : 25 000	PROJECT No 7185	
T.C. TO BONN	NTS REF	FILE No AQ5-17	

T/L 3600 N

T/L 3600 N

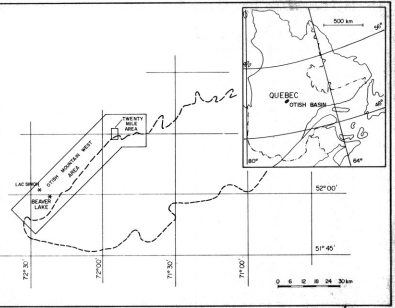

3500 N
3400 N

361659-3
3300 N
3200 N
3100 N

361631-1
B/L 3000 N
2900 N
2800 N
2700 N

361631-2
T/L 2600 N

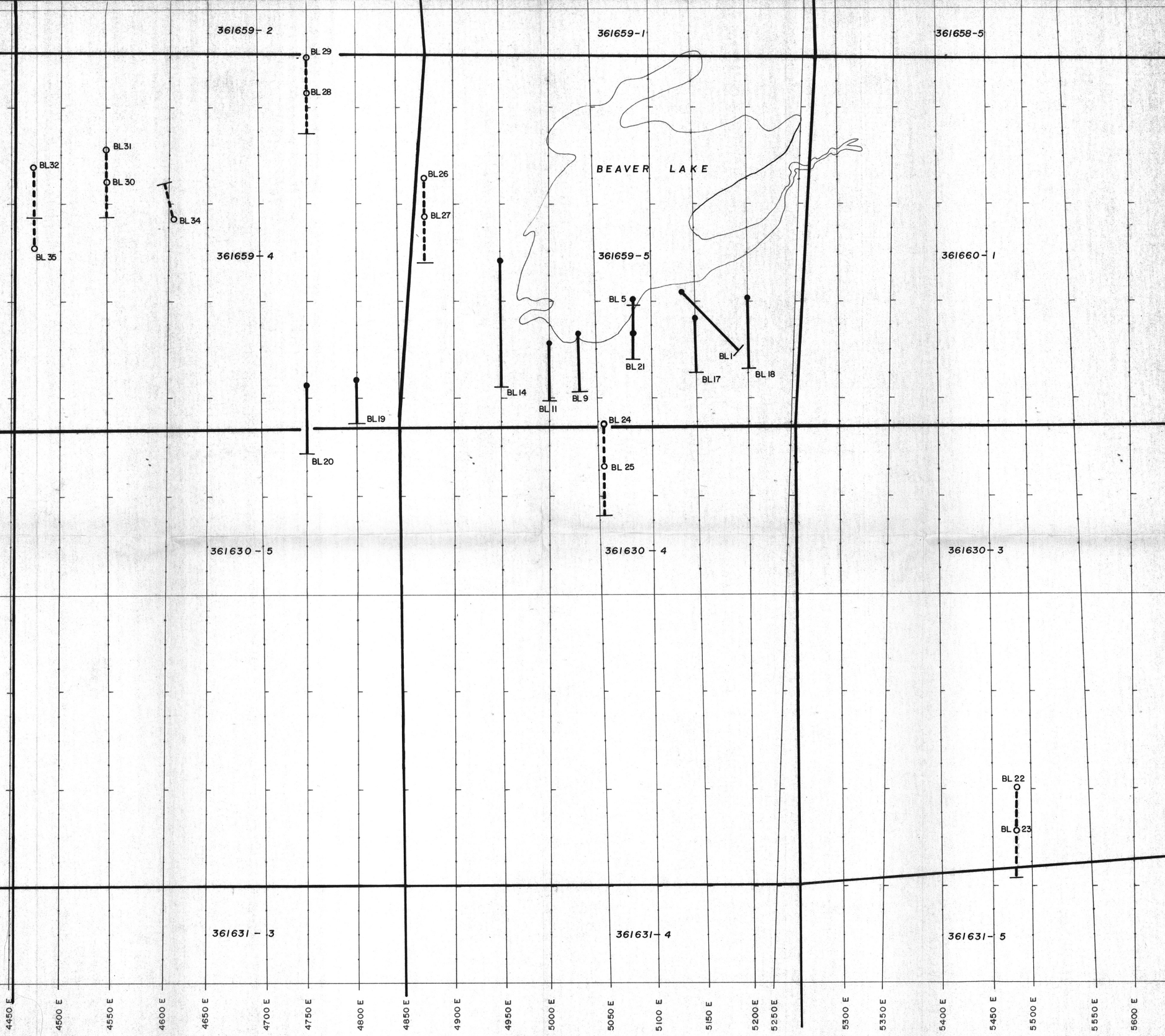

BEAVER LAKE

LEGEND:

- DIAMOND DRILL HOLE 1977, SURFACE PROJECTION.
- DIAMOND DRILL HOLE 1978, SURFACE PROJECTION.



Ministère des Richesses Naturelles, Québec
SERVICE DE LA DOCUMENTATION TECHNIQUE
Date: 25 SEP 1978
No GM: 34787

CONFIDENTIAL

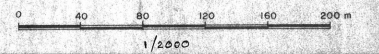

URANERZ EXPLORATION & MINING LTD.

**PROJECT: BEAVER-ZORAN/OTISH WEST 71-85
BEAVER LAKE AREA
DIAMOND DRILL PLAN
ASSESSMENT REPORT 1978**

COMPILED BY: G.	DATE: NOV 78	REVISION:	MAP No. 14
DRAWN: J. B. H.	DATE: NOV 78	PLAN No.	REPORT No.
LAST REVISION:	SCALE: 1:2000	PROJECT No. AQ-7185	
E.C. TO 8084	REP:		

T/L 4000 N

T/L 4000 N

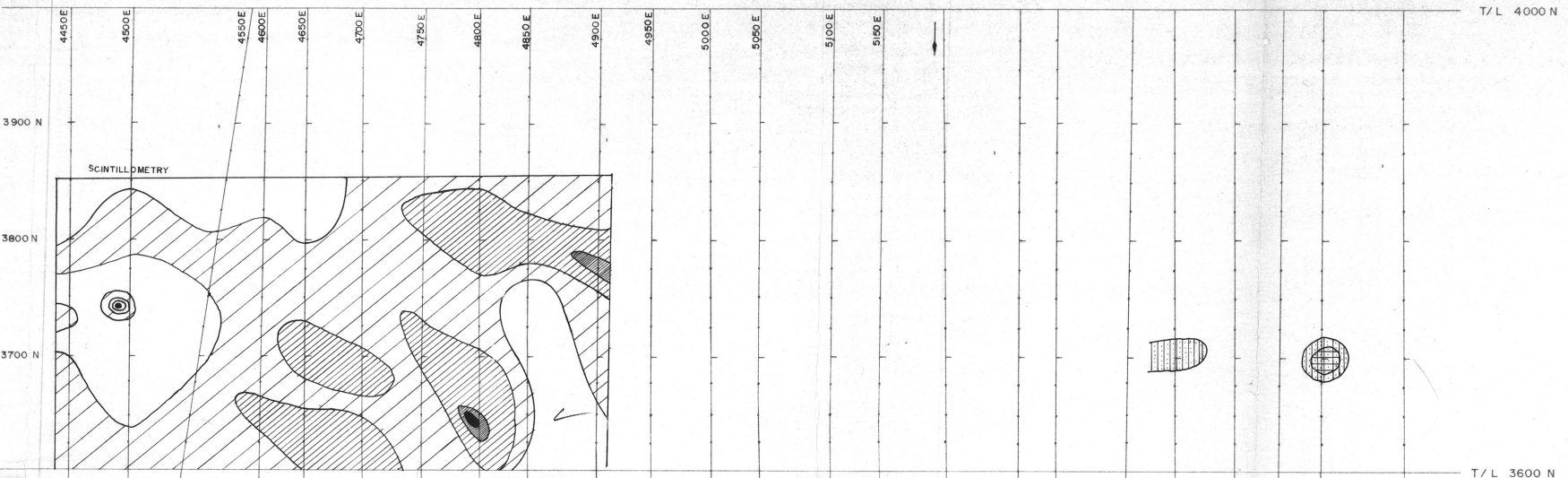
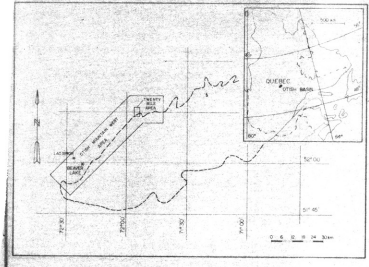

T/L 3600 N

T/L 3600 N

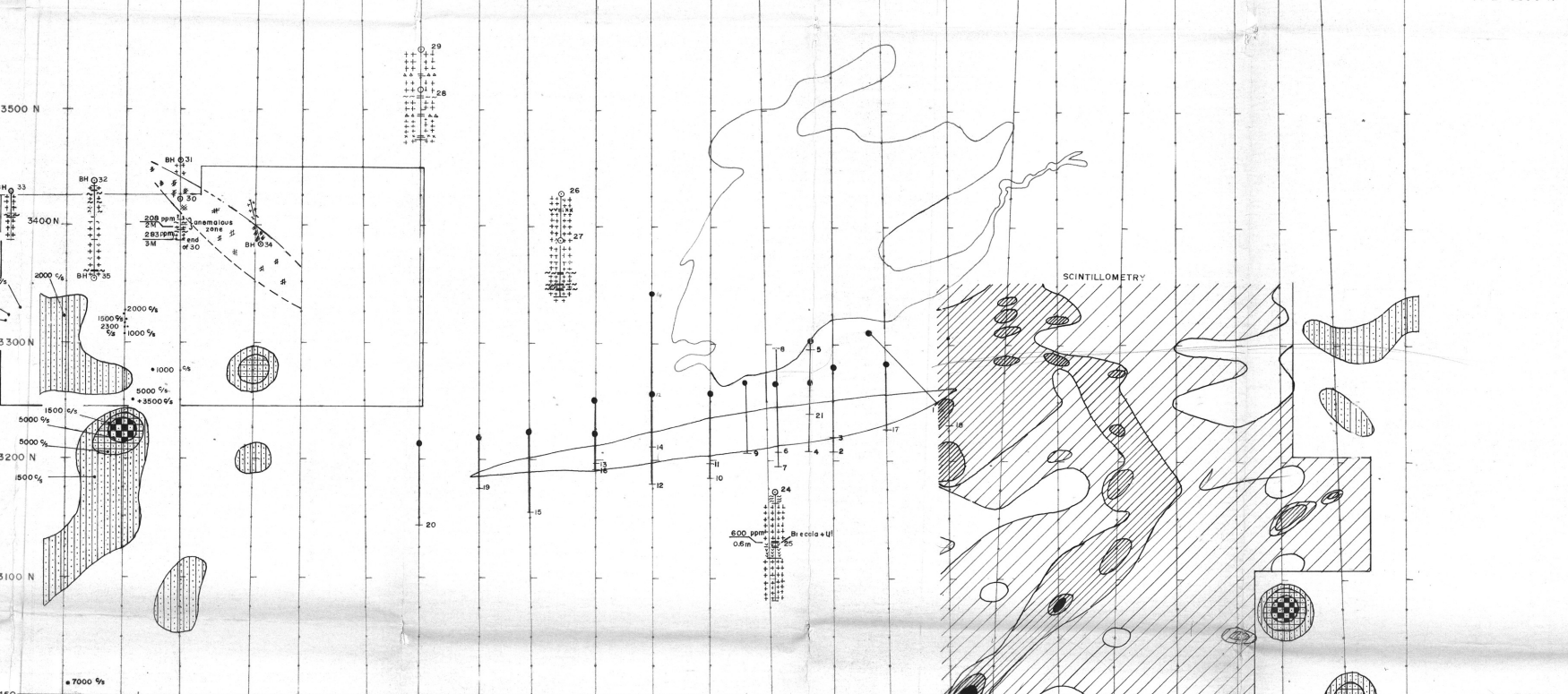

T/L 3000 N

T/L 3000 N

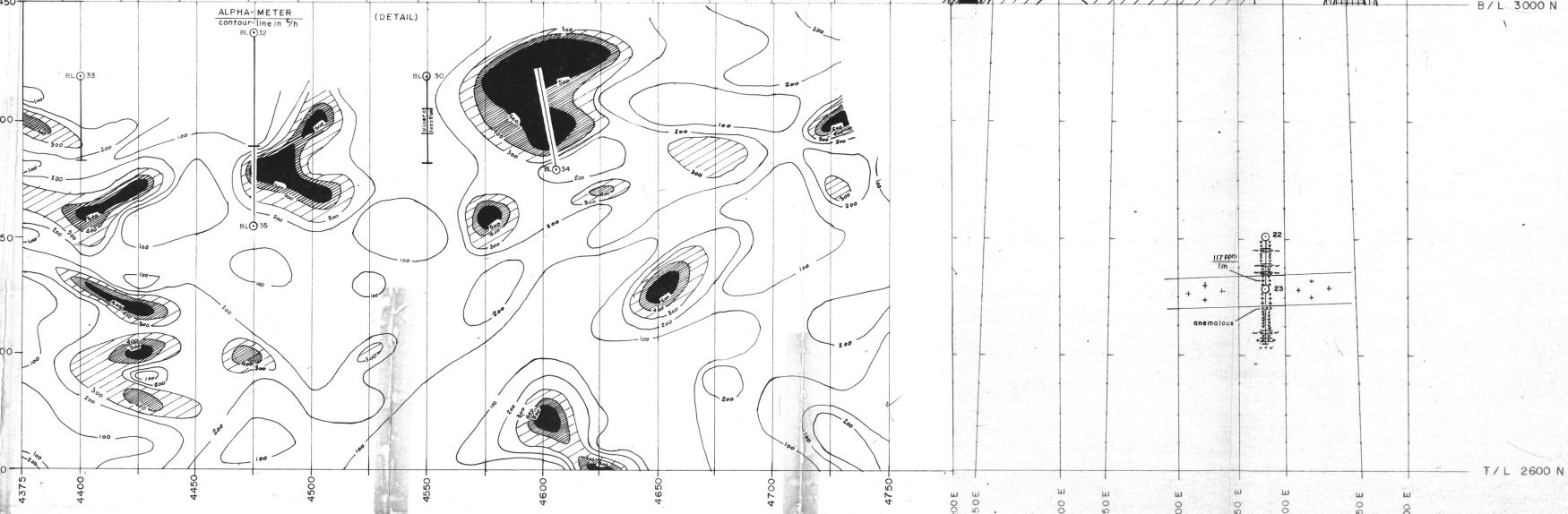

T/L 2600 N

T/L 2600 N

LEGEND

- GEOLOGY**
- ~ GNEISS
- ⋈ VOLCANICS
- ⋈ GRANIT
- ⋈ PEGMATITE
- x x BRECCIATION
- SCINTILLOMETRY (SPP II)**
- 0-65 %
- ▨ 70-100 %
- ▩ 105-150 %
- 155-250 %
- >250
- ALPHA-METER (regional)**
- ▨ 200-399 cph
- ▩ 400-699 cph
- >699 cph
- ALPHA-METER (detail)**
- ▨ 100
- ▩ 200
- 300
- RADIOACTIVE BOULDERS with RADIOACTIVITY (SPP II)

Ministère des Richesses Naturelles, Québec
 SERVICE DE LA DOCUMENTATION TECHNIQUE
 Date: 25 SEP 1978
 No GM: 34787

CONFIDENTIAL

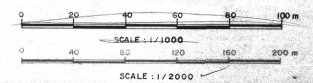

URANERZ EXPLORATION & MINING LTD.

**PROJECT: BEAVER-ZORAN/OTISH WEST 71-85
 BEAVER LAKE AREA
 COMPILATION OF SURVEY RESULTS
 ASSESSMENT REPORT**

COMPILED BY: W.G.	DATE: SEPT 77/8	TITLE: MGS-137	MAP NO.:
DRAWN BY: S.C.	DATE: SEP 78	SCALE:	FORM NO. 7185-10
LAST REVISION:			PROJECT NO. 7185
TC BY: BMM			

CONFIDENTIAL

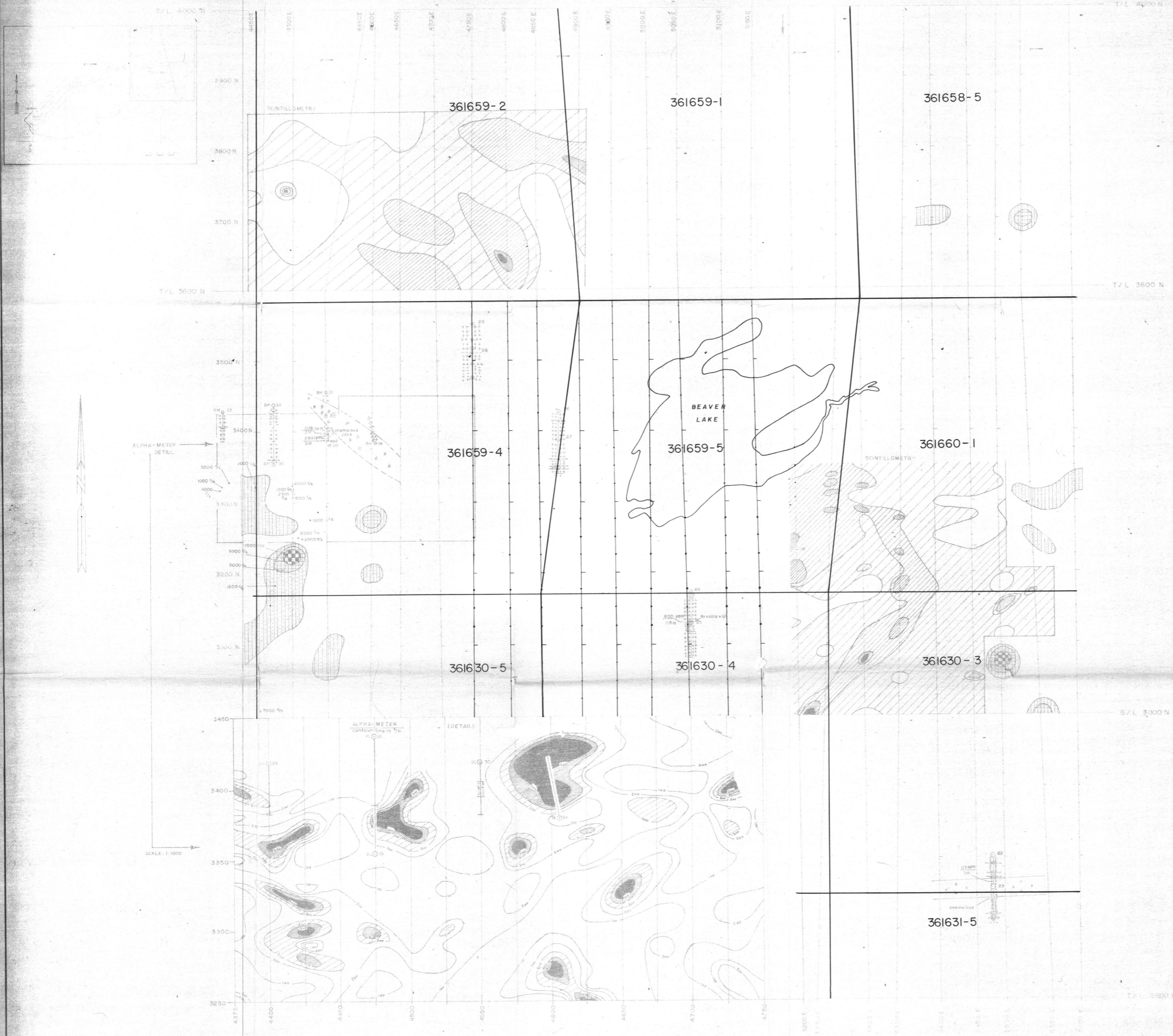

T/L 4000 N

T/L 3600 N

T/L 3600 N

S/L 3000 N

T/L 2500 N

LEGEND

GEOLOGY

- GNEISS
- VOLCANICS
- GRANIT
- PEGMATITE
- BRECCIATION

SCINTILLOMETRY (SPP II)

- 0-65 %
- 70-100 %
- 105-150 %
- 155-250 %
- > 250

ALPHA-METER (regional)

- 200-399 cph
- 400-699 cph
- > 699 cph

ALPHA-METER (detail)

- CONTOURLINES in %

- RADIOACTIVE BOULDERS with RADIOACTIVITY (SPP II)

Ministère des Richesses Naturelles, Québec
 SERVICE DE LA
 DOCUMENTATION TECHNIQUE
 Date: 25 SEP 1978
 No. CM: 34787

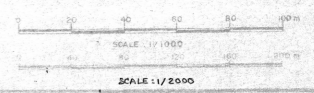

URANERZ EXPLORATION & MINING LTD.

PROJECT: BEAVER-ZORAN/DTISH WEST 71-65
 BEAVER LAKE AREA
 COMPILATION OF SURVEY RESULTS
 QUARTERLY REPORT SEPT 78

SEP 78 1978
 15

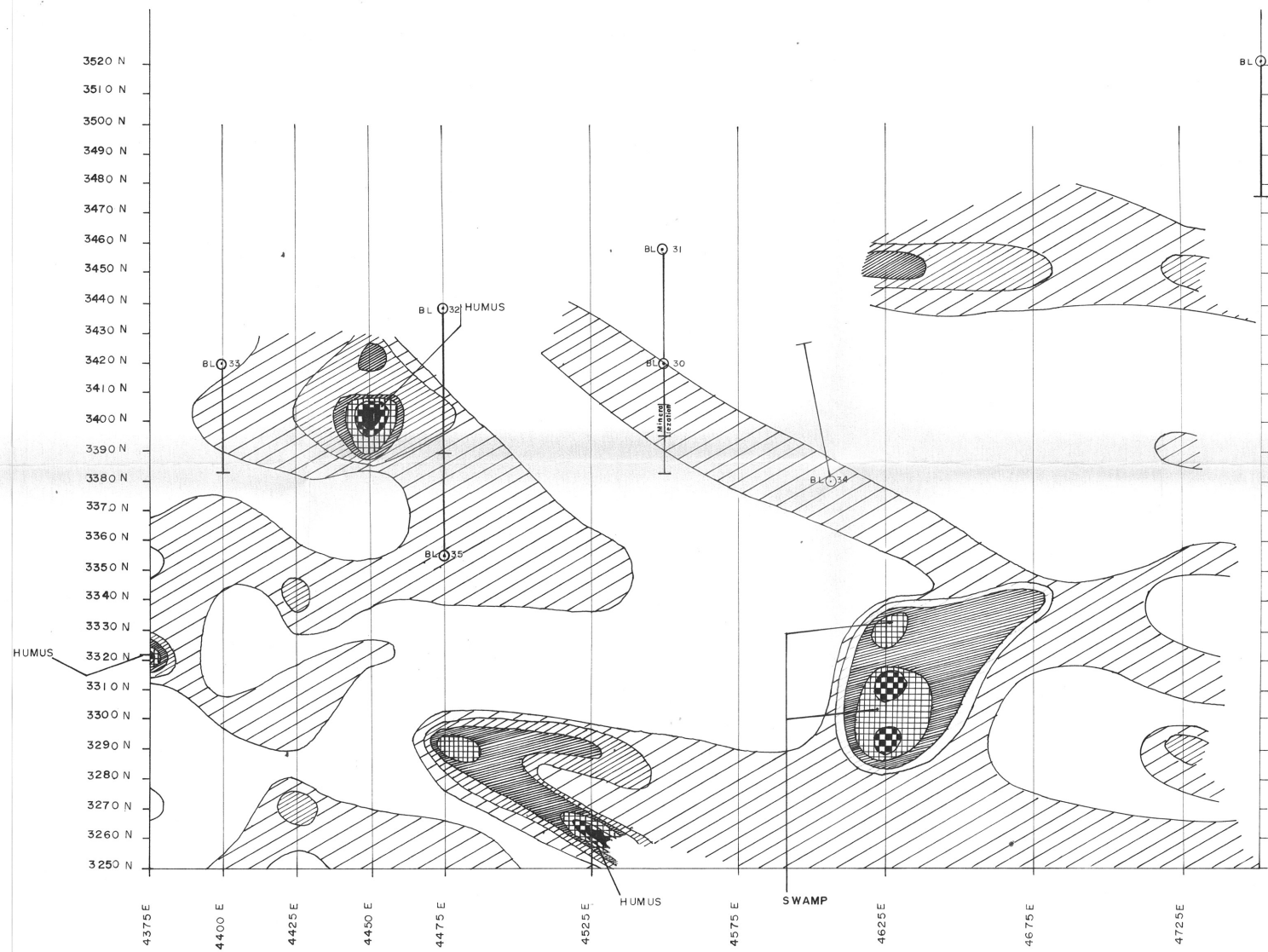
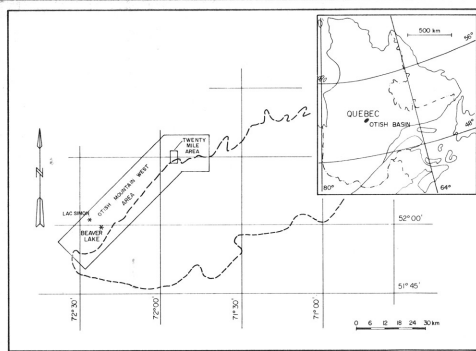

LEGEND

- 0-2 ppm
- 2-5 "
- 5-10 "
- 10-25 "
- 25-60 "
- 60-150 "
- 150-300 "

Ministère des Richesses Naturelles, Québec
 SERVICE DE LA
 DOCUMENTATION TECHNIQUE
 Date: 25 SEP. 1978
 No GM: 34787

CONFIDENTIAL

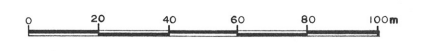

URANERZ EXPLORATION AND MINING LIMITED			
PROJECT : BEAVER-ZORAN/OTISH WEST 71-85 BEAVER LAKE AREA GEOCHEMISTRY - U - IN SOIL ASSESSMENT REPORT			
COMP.: W.G	DATE: SEPT 78	REP./RAP. No: 7185-16	MAP/CARTE No: 2
DRAWN/DESS.: S.C	DATE: SEPT 78	SCALE/ECH.: 1/1000	PROJ. No.: 71-85
REVISION:			FILE/DOSS. No.: M05-138
T.C. TO BONN.	N.T.S. REF.		

CONFIDENTIAL

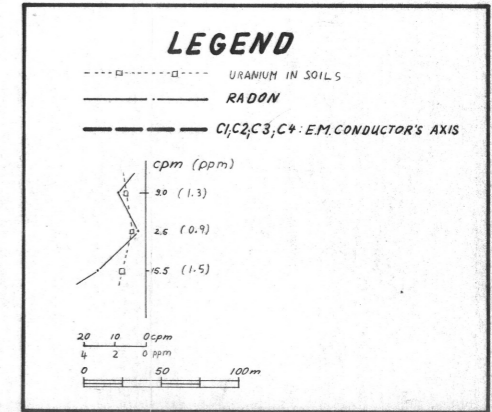
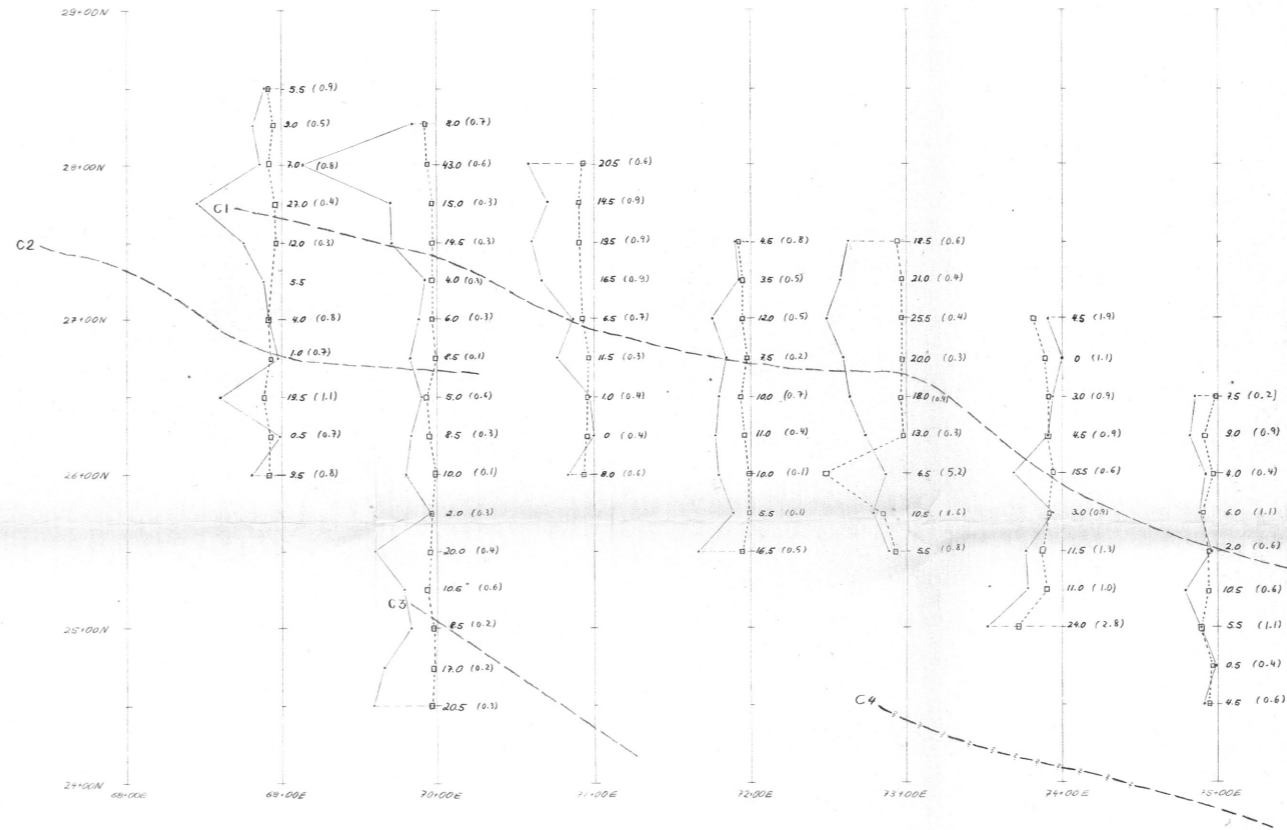
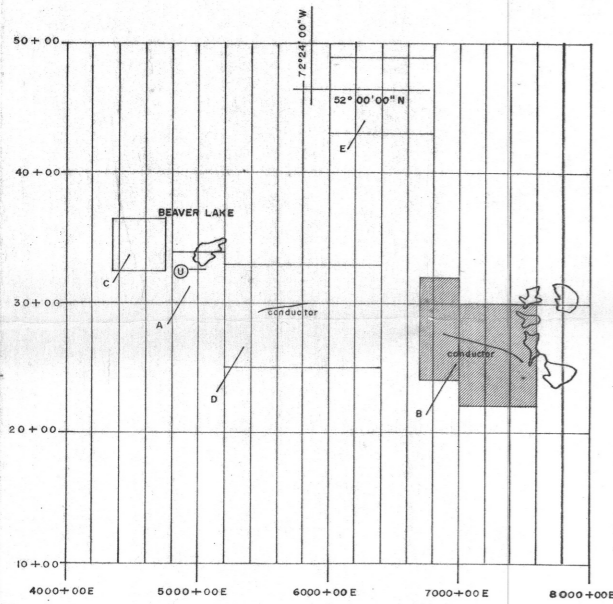
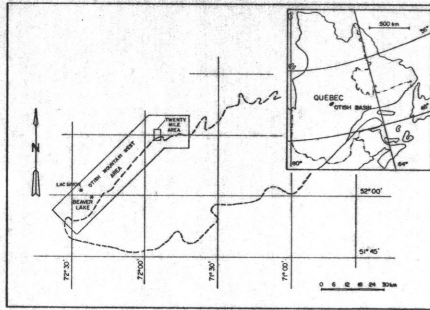

INSTRUMENT: EGA RADON DETECTOR RD 200

Ministère des Richesses Naturelles, Québec
 SERVICE DE LA
 DOCUMENTATION TECHNIQUE
 Date: 25 SEP. 1978
 No GM: 34787

APPENDIX B

URANERZ EXPLORATION AND MINING LIMITED

BEAVER-ZORAN/OTISH WEST 71-85
 BEAVER LAKE GRID, AREA B
 EMANOMETER SURVEY
 & URANIUM IN SOILS
 ASSESSMENT REPORT

COMP: M.L.	DATE: OCT 78	REP./RAP. No: 7185-16	MAP/CARTE No: 7
DRAWN/DESS: S.C.	DATE: OCT 78	SCALE/ÉCH: 1:2000	PROJ. No: 7185
T.C. TO BORN:	N.E.S. REF:		FILE/DOSS. No: MQ5-122

CONFIDENTIAL

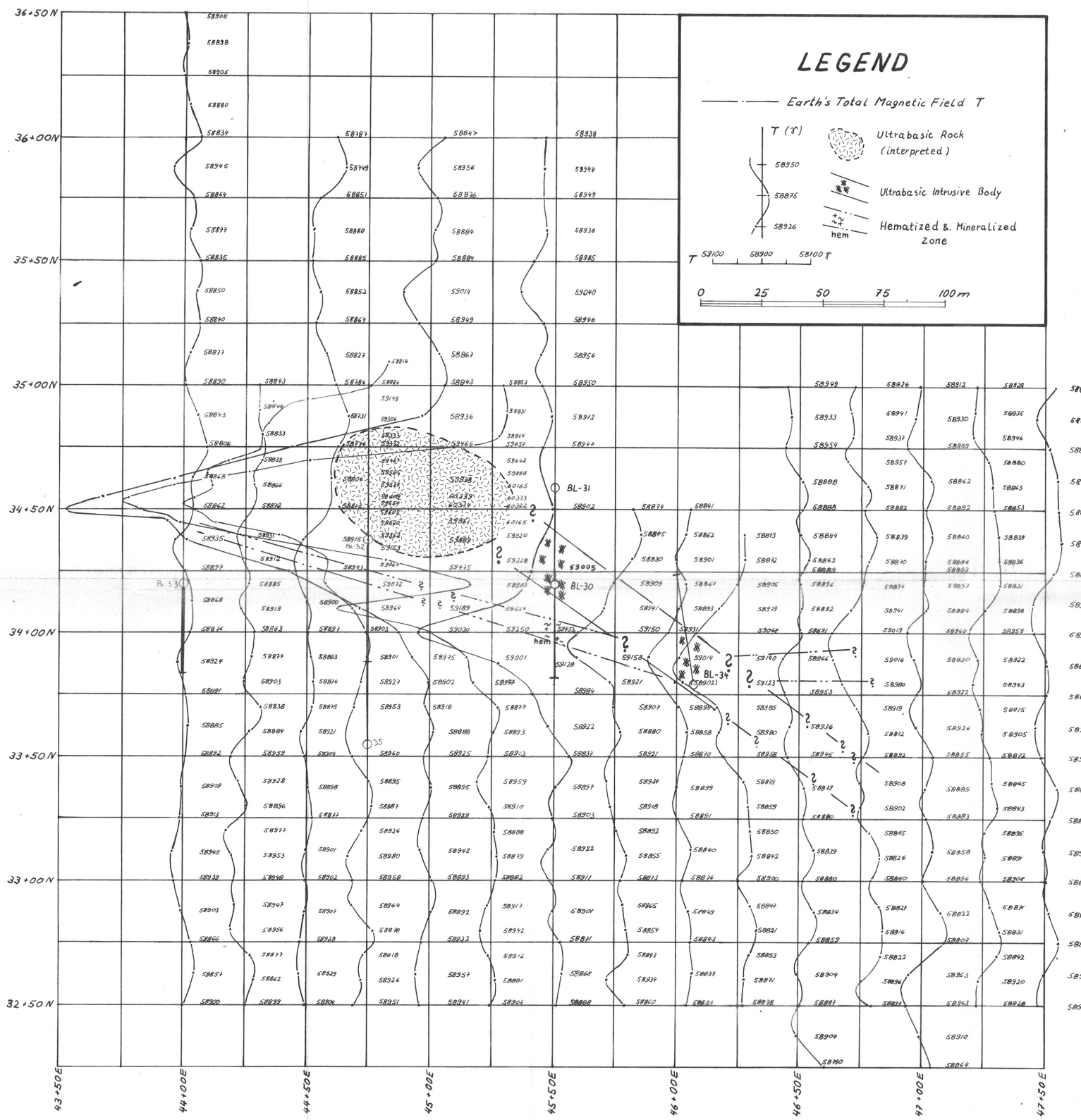

LEGEND

— Earth's Total Magnetic Field T

T (γ)

58950
58975
58926

0 25 50 75 100m

- Ultrabasic Rock (interpreted)
- Ultrabasic Intrusive Body
- Hematized & Mineralized Zone

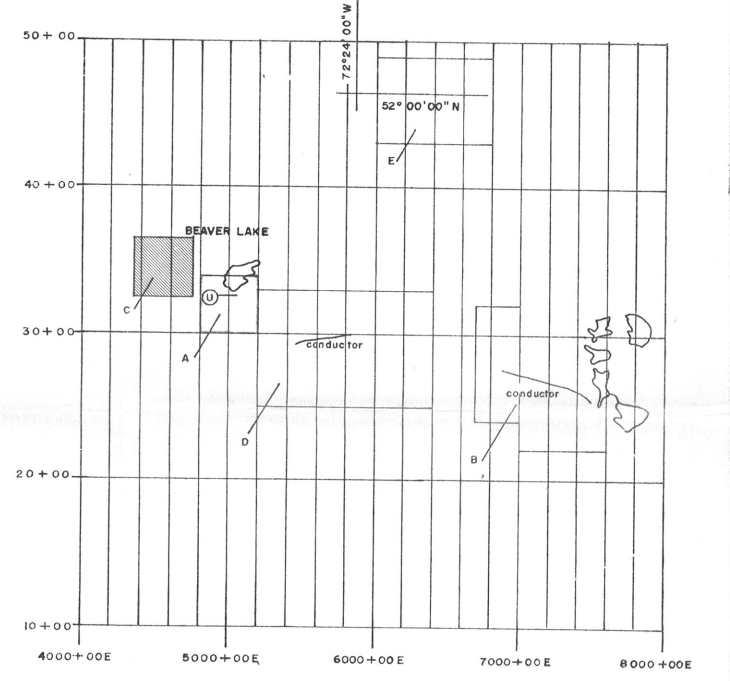
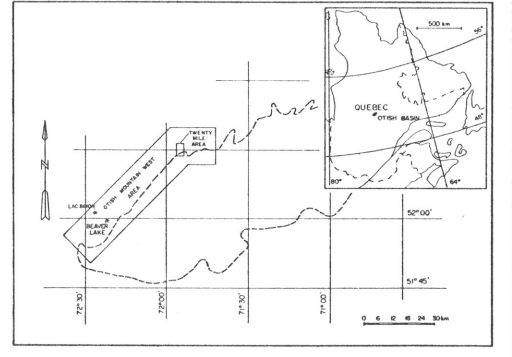

Ministère des Ressources Naturelles, Québec
 SERVICE DE LA
 DOCUMENTATION TECHNIQUE
 Date: 25 SEP. 1978
 No GM: 34787

APPENDIX B

URANERZ EXPLORATION AND MINING LIMITED			
BEAVER-ZORAN/OTISH WEST 71-85 BEAVER LAKE GRID, AREA C			
MAGNETOMETER SURVEY ASSESSMENT REPORT			
COMP. M.L.	DATE: OCT 78	REP. RAP. No: 7185-16	MAP. CARTE No: 3
DRAWN/DESS. S.C.	DATE: OCT 78		
REVISION		SCALE/ECH. 1/1000	PROJ. No: 71-85
T.C. TO BONN	N.T.S. REF.		FILE/DOSS. No: M05-118

CONFIDENTIAL

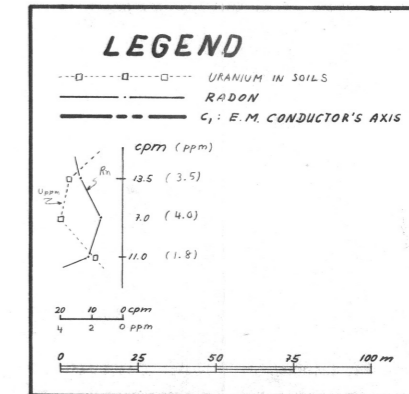
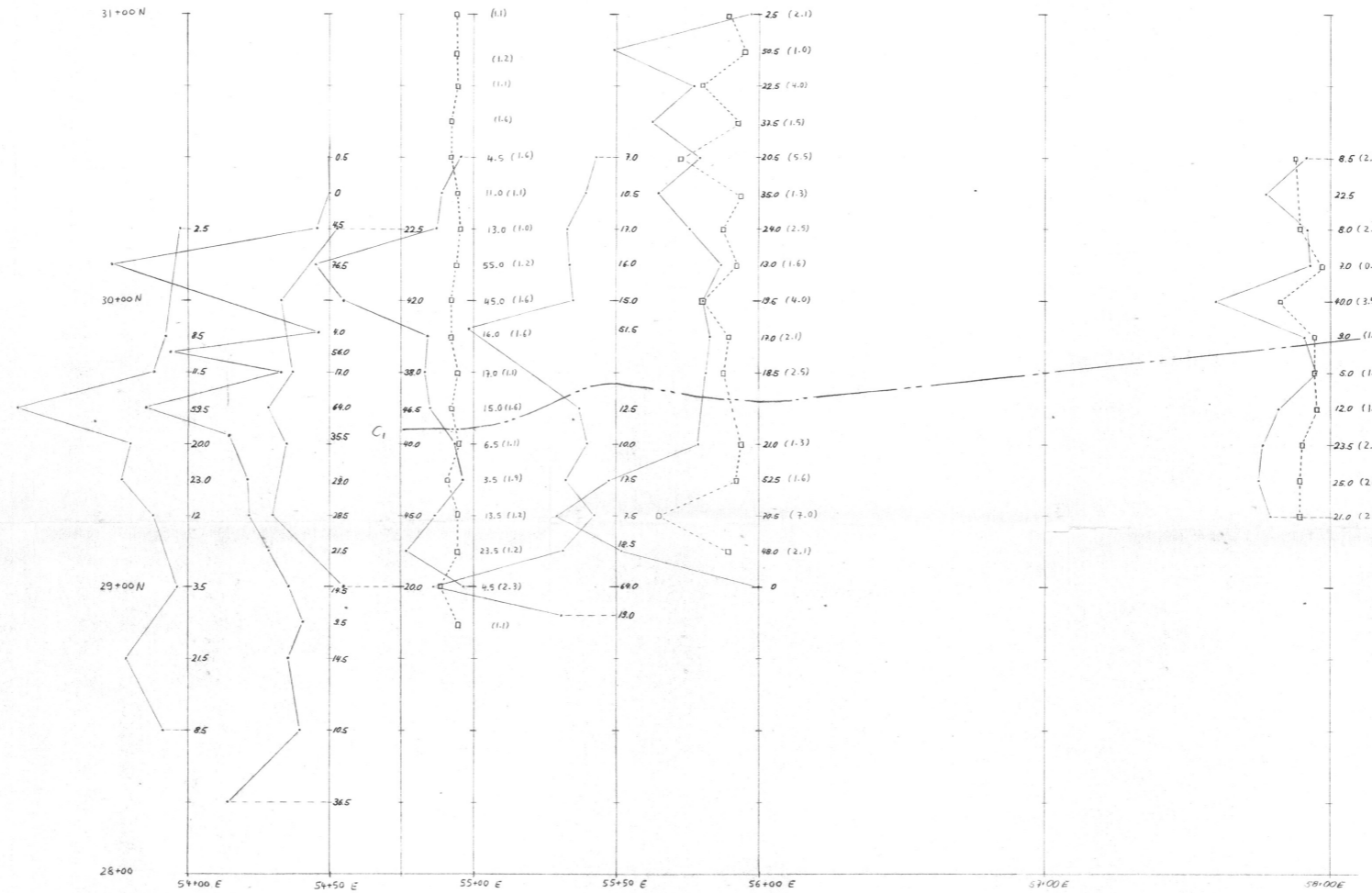
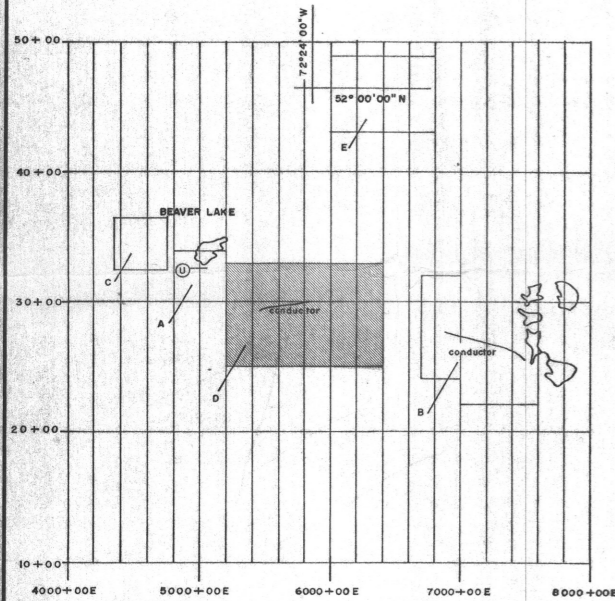
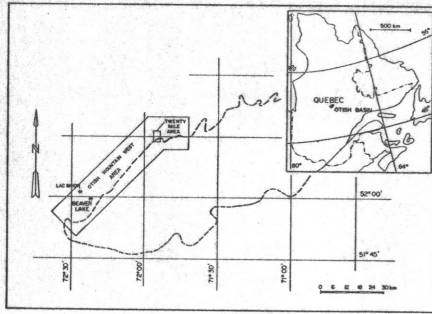

Ministère des Ressources Naturelles, Québec
 SERVICE DE LA
 DOCUMENTATION TECHNIQUE
 Date: 25 SEP 1979
 No GM: 34787

APPENDIX B

URANERZ EXPLORATION AND MINING LIMITED			
BEAVER-ZORAN/OTISH WEST 71-85 BEAVER LAKE GRID, AREA D EMANOMETER SURVEY & URANIUM IN SOILS ASSESSMENT REPORT			
COMP. M.L.	DATE: OCT 78	REP. RAP. No. 7185-16	MAP/CARTE No. 5
DRAWN/DESS. S.C.	DATE: OCT 78	SCALE/ECH: 1/1000	PROJ. No.: 71-85
T.C. TO BOM:	M.T.S. REP.		FILE/DOSS. No.: MQ5-120

CONFIDENTIAL

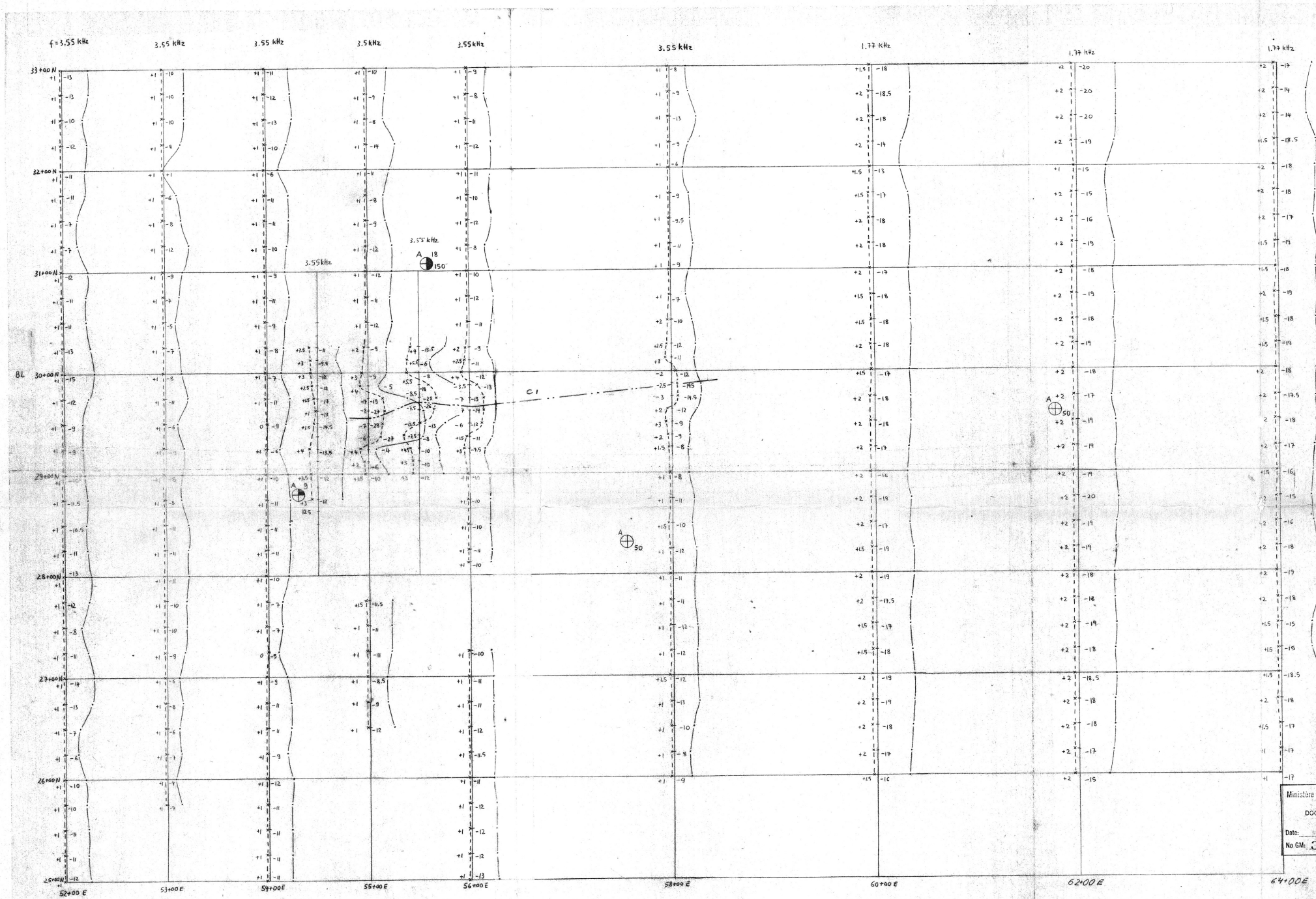
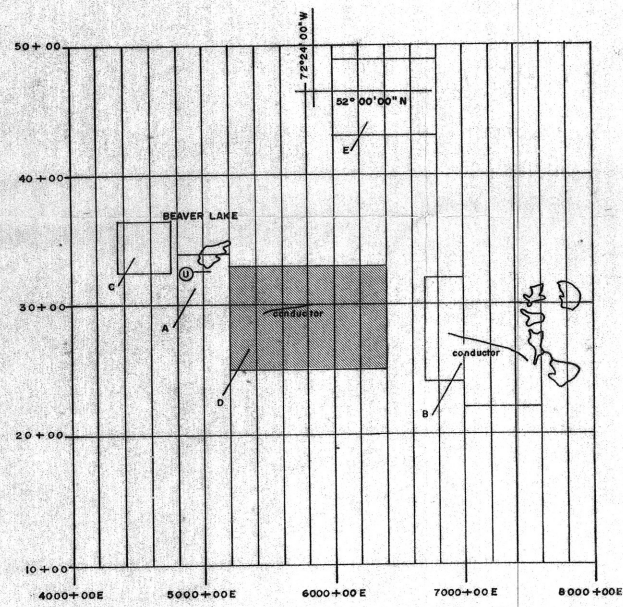
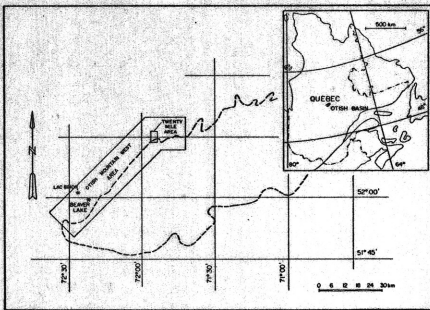

LEGEND

Horizontal Loop E.M. Survey
 $a = 50 \text{ m}$, $f = 3.55 \text{ kHz}$, 1.77 kHz
 Inphase I
 Quadrature Q - - - - -

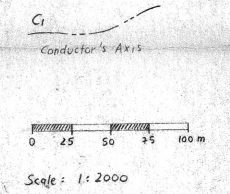
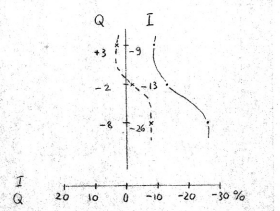

**AIRBORNE MK VI INPUT SURVEY
 LEGEND:**

- 6 CHANNEL INPUT ANOMALY
- ◐ 5 CHANNEL INPUT ANOMALY
- ◑ 4 CHANNEL INPUT ANOMALY
- ◒ 3 CHANNEL INPUT ANOMALY
- ⊕ 2 CHANNEL INPUT ANOMALY

Ministère des Richesses Naturelles, Québec
 SERVICE DE LA DOCUMENTATION TECHNIQUE
 25 SEP. 1978
 Date: 25 SEP. 1978
 No GM: 04787

ANOMALY LETTER: A
 APARENT CONDUCTIVITY - WIDTH: 175
 CHANNEL 2 AMPLITUDE (P.P.M.): 175

APPENDIX B

URANERZ EXPLORATION AND MINING LIMITED

**BEAVER-ZORAN/OTISH WEST 71-85
 BEAVER LAKE GRID, AREA D**

**H.E.M SURVEY
 ASSESSMENT REPORT**

COMP. M.L.	DATE: OCT 78	REP./MAP No. 7185-16	MAP/CARTE No. 4
DRAWN/DESS. S.C.	DATE: OCT 78	SCALE/ECH. 1:2000	PROJ. No. 71-85
REVISION:			FILE/DOSS. No. MQ5-119
T.C. TO BONN.	N.T.S. REF.		

CONFIDENTIAL

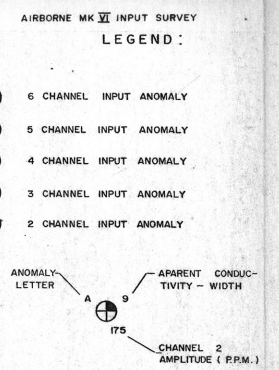
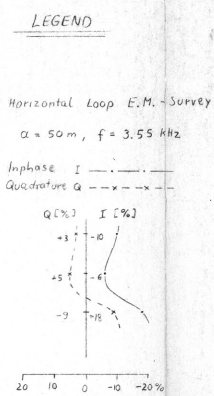
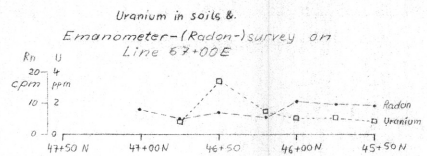
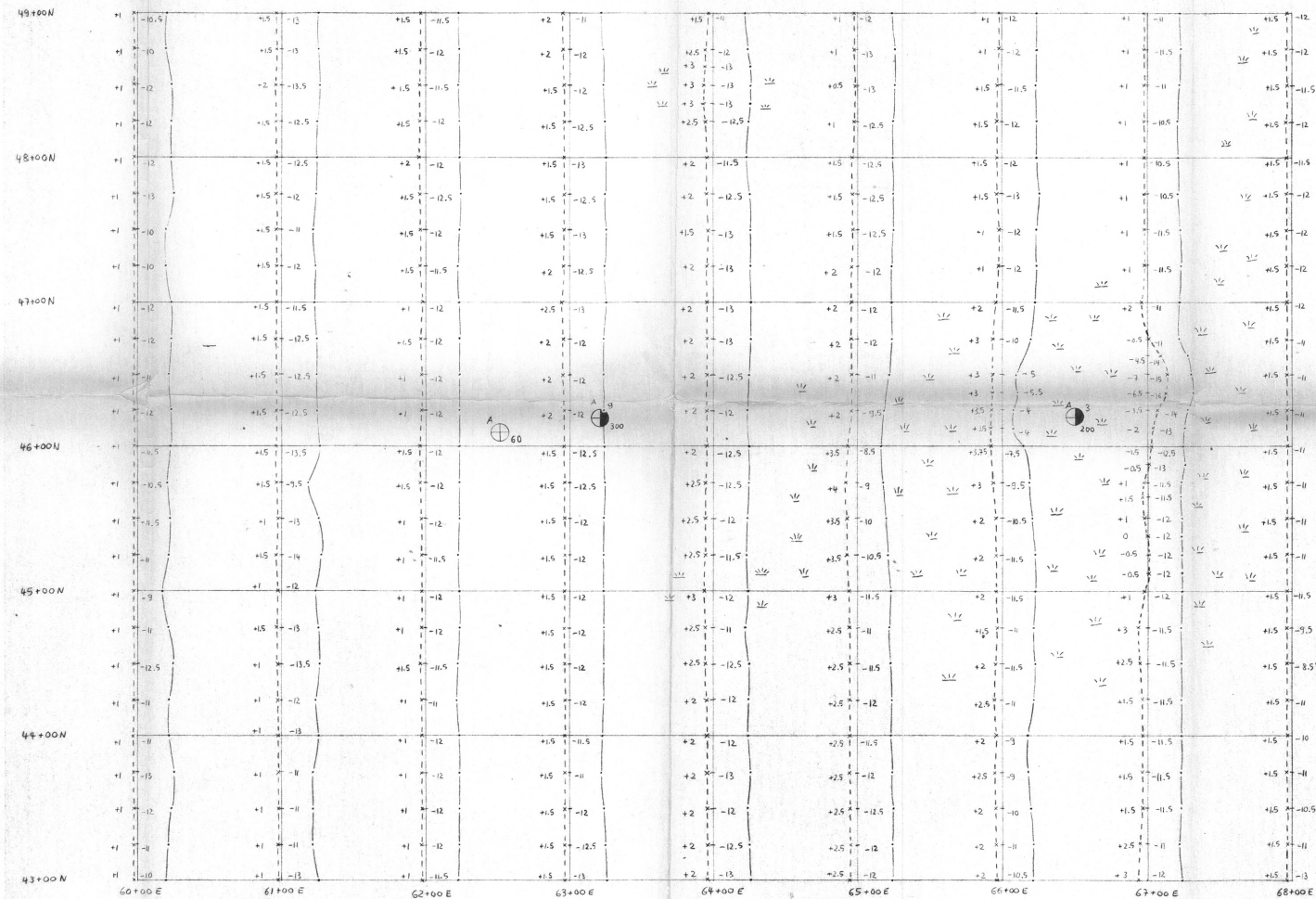
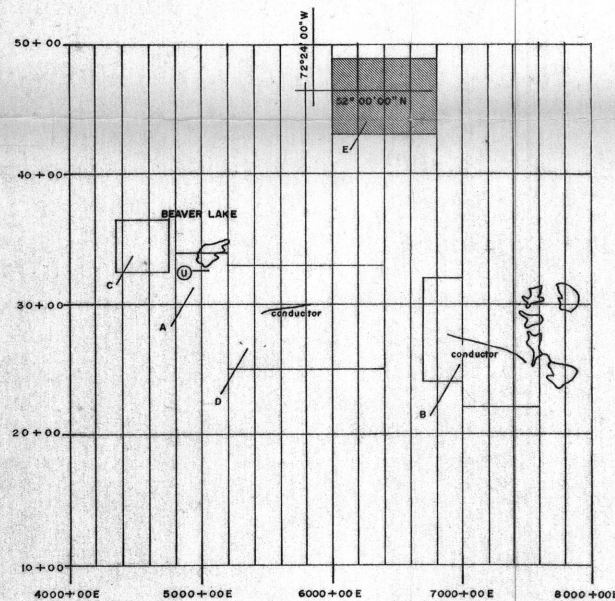
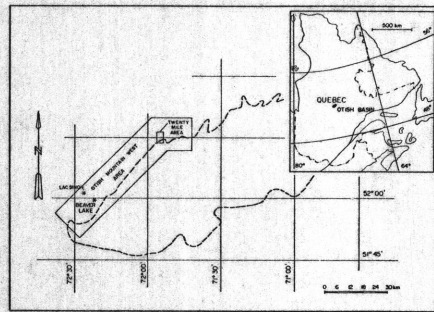

Ministère des Richesses Naturelles, Québec
 SERVICE DE LA DOCUMENTATION TECHNIQUE
 Date: 25 SEP. 1978
 No GM: 34767

Instrument:
 APEX MAX. MIN. II E.M. SYSTEM

APPENDIX B

URANERZ EXPLORATION AND MINING LIMITED

BEAVER-ZORAN / OTISH WEST 71-85
 BEAVER LAKE GRID, AREA E
 H.E.M. B EMANOMETER SURVEY
 & URANIUM IN SOILS
 ASSESSMENT REPORT

COMP. M.L.	DATE: OCT 78	REP./RAP. No. 7185-16	MAP/CARTE No. 6
DRAWN/DESS. S.C.	DATE: OCT 78	SCALE/ÉCH. 1:2000	PROJ. No. 71-85
REVISION:			FILE/DOSS. No. 1005-121
T.C. TO BONN.	N.T.S. REF.		

CONFIDENTIAL