

GM 27092

DIAMOND DRILL LOG

Documents complémentaires

Additional Files



Licence



Licence

Cette première page a été ajoutée
au document et ne fait pas partie du
rapport tel que soumis par les auteurs.

Énergie et Ressources
naturelles

Québec 

Hole No. W.S. 1

DIAMOND DRILL LOG

Western Quebec Mines Co. Ltd.

Company

Suite: 400, 621 Craig St. W. Montreal 101, Quebec

Address

DIAMOND DRILLING BY (Co. Name) St. Louis-Bergeron Diamond Drilling Co. Ltd.

(A-90753-2)

CLAIM NO. (Miner's Certificate No.) 1451 Claim Nos. 2 to and

Lost 61, Range 9, Barraute Township, Abitibi East

LOCATION 24 + 10' South 15° West of No. 1 Post Cl.

DIP-COLLAR -50° STRIKE South

200 ft. 52° LENGTH 996.0 feet

400 ft. 47° ELEVATION

600 ft. 45° LATITUDE

800 ft. 35° DEPARTURE

Date Started April 27th 1971 Date Finished June 2nd, 1971

LOGGED BY: R.L. Alexander

Ministère des Richesses Naturelles, Québec
SERVICE DE LA
DOCUMENTATION TECHNIQUE

Date: 9 - AOU 1971

No GM: 27092

From	To	DESCRIPTION	Sample No.	Length Feet	ANALYSES			
					Au			
0	42	CASING						
42	67.5	METADIORITE, grey-green, medium grained, nearly massive, altered, flaky appearance, no discernible foliation angle, some white to buff carbonate ribs.						
67.5	105.5	METADIORITE, light grey-green highly altered with white to brown carbonate and ankerite (?) intermixed and as veinlets, some dark micaceous and chloritoid material, odd speck of pyrite and pyrrhotite.						
		67.5 - 72.5	7501	5.0	Nil			
		72.5 - 77.5	7502	5.0	Tr.			
		77.5 - 82.0	7503	4.5	Nil			
		82.0 - 86.5	7504	4.5	Tr.			
		86.5 - 91.0	7505	4.5	Nil			
		91.0 - 96.0	7506	5.0	Nil			
		96.0 - 100.5	7507	4.5	Tr.			
		100.5 - 105.5	7508	5.5	Tr.			
105.5	116.5	METADIORITE, as above, whiter mostly carbonate, weak silification, nearly massive.						
		114 - 116.5 weak sulphides						
		105.5 - 110.4	7509	4.9	Tr.			
		110.4 - 115.2	7510	4.8	Nil			

PROPERTY Western Quebec, Barraute Twp., Quebec (Swanson)

HOLE No. WS-1

DIAMOND DRILL LOG

PAGE No. 1

From	To	DESCRIPTION	Sample No.	Length Feet	ANALYSES			
					Au			
116.5	142.0	SCHIST, grey-green to white, foliation and shearing 30° - 60° to core axis, contorted highly altered, carbonate chloritic serpentine - talcose, dioritic texture, (possibly peridotite?), crushed appearance some weak finely disseminated sulphides (pyrite and pyrrhotite)						
		115.2 - 120	7511	4.8	Tr			
		120 - 125	7512	5.0	Tr			
		125 - 130, 0.2 'quartz at 129'	7513	5.0	.01			
		130 - 134.3 more sheared	7514	4.3	.01			
		134.3 - 139.2	7515	4.9	Tr			
		139.2 - 144.2	7516	5.0	Tr			
142.	173.8	CARBONATE-TALCOSE SCHIST, light grey to white, with small fragments or metacrysts of dark green talc or serpentine, prophyritic to "dalmatian" appearance, schistosity 40-50° to core axis occasionally minor finely disseminated pyrite.						
		144.2 - 149.1	7517	4.9	N11			
		149.1 - 154	7518	4.9	N11			
		154 - 159	7519	5.0	Tr			
		159 - 163.8	7520	4.8	Tr			
		163.8 - 168.8, 167.9-168.4 Quartz	7524	5.0	N11			
		168.8 - 173.8, 2 quartz veinlets	7525	5.0	N11			

PROPERTY _____ Western Quebec, Barrabute Twp. Quebec (Swanson) _____

HOLE No. WS-1

DIAMOND DRILL LOG

PAGE No. 2

From	To	DESCRIPTION	Sample No.	Length Feet	ANALYSES			
					Au			
173.8	183.5	MARIPOSITE SCHIST, carbonated and 30 % quartz veinlets and grains, light grey to white with green mica (mariposite)						
		178.4 bleb of tourmaline (?) acicular, dirty green.						
		173.8 - 178.9	7526	5.1	Nil			
		178.0 - 183.5	7527	4.6	Tr.			
183.5	197	TRACHYTE, porphyritic rhyolite with quartz metacrysts and weak sericite to micaceous material, weak to moderate disseminated pyrite cubes, considerable fracturing						
		183.5 - 188.5	7521	5.0	Tr.			
		188.5 - 193.9	7522	5.4	Tr.			
		193.9 - 197	7523	3.1	Tr.			
197	198.9	MARIPOSITE SCHIST, see above section	7528	1.9	Nil			
198.9	220.7	CARBONATE-TALCOSE SCHIST, schisted, sheared to 204.2 ft.						
		204.2 - 206.2 porphyritic or dalmatian, as blebs or metacrysts						
		209 - 220.7 porphyritic or dalmatian, last 6 inches shows green carbonate (fuchsite) metacrysts.						
		198.9 - 204.2	7529	5.3	Nil			
		204.2 - 209	7530	4.8	Nil			
		209 - 213.5	7531	4.5	Nil			

PROPERTY Western Quebec, Barraute, Twp. Que. (Swanson)

HOLE No. WS-1

DIAMOND DRILL LOG

PAGE No. 3

From	To	DESCRIPTION	Sample No.	Length Feet	ANALYSES			
					Au			
		213.5 - 218.6	7532	5.1	Nil			
		218.6 - 223.7 part mariposite schist.	7533	5.1	Nil			
220.7	246	MARIPOSITE SCHIST, bright green, as above, some green carbonate, quartz ribs and crystals, contorted to crenulated, shearing and schistosity, 45° to parallel to core axis, a few short sections with disseminated Pyrite						
		233 - 234 oxidized fracture zone						
		223.7-228.5	7534	4.8	Nil			
		228.5-233.1	7535	4.6	Nil			
		233.1-238	7536	4.9	Nil			
246	252.3	TALCOSE-MICA SCHIST, grey to white, considerable quartz contorted shearing or schistosity 45° to parallel to core axis.						
252.3	271.3	QUARTZ-MICA SCHIST, grey green, some sections more massive or "dioritic" in appearance, sheared sections more chloritic to talcose, schistosity, crenulated & contorted.						
		256.5 - 261 weak pyrite, siliceous sheared.	7537	4.5	Tr			
271.3	282.4	CARBONATE, chloritic-talc blebs, prophyritic like, schistosity 45° to core, white to light grey with green tinge.						
		277.4 - 282.4 sheared quartz ribs	7538	5.0	Tr.			

PROPERTY Western Quebec, Barraute Twp. Que. (Swanson)

HOLE No. WS-1

DIAMOND DRILL LOG

PAGE No. 4

From	To	DESCRIPTION	Sample No.	Length Feet	ANALYSES			
					Au			
282.4	287	PORPHYRY, quartz feldspar, light grey to white, some thin seams of chlorite to mica						
287	289	BASIC DYKE, altered, brownish fine grained chilled edges, disseminated pyrite cubes.	7539	2.0	Tr			
289	290.8	CARBONATE TALCOSE SCHIST, "dalmatian-like"						
290.8	296.2	RHYOLITE (?) buff to grey, few chloritic blebs and seams, 2% pyrite finely disseminated and cubes, a few quartz ribs.	7540	5.4	.005			
296.2	305	CARBONATE ZONE, light grey to buff tinge, fine grey green metacrysts of talcose mica, gives porphyritic appearance, siliceous to weakly quartzitic.						
305	305.8	SYENITE, reddish brown very fine grained a few pyrite specks.	7541	0.8	Tr			
305	314.7	CARBONATE ZONE, darker grey, possibly more talc-serpentinization, still "porphyritic"						
		308.9 - 312.9 weakly oxidized slips at each end, contorted, weakly brecciated with quartz-carbonate ribs.						

PROPERTY Western Quebec, Barraute Twp., Quebec (Swanson)

HOLE No. Ws-1

DIAMOND DRILL LOG

PAGE No. 5

From	To	DESCRIPTION	Sample No.	Length Feet	ANALYSES			
					Au			
314.7	346	DIORITE(?), highly, altered, dark grey, carbonated, granular to nearly massive, weakly talcose to serpentized, frequent carbonate ribs some with quartz, 40 - 55° to core axis, weakly contorted, odd fine pyrite speck, last foot gradational contact.						
346.	358.	QUARTZ-FELDSPAR GNEISS, light buff to creamy, gneissosity and banding 45° - 20° to core axis, as well as quartz-carbonate ribs, slightly crenulated, some sericite. 346 - 1" brecciated Slip 346.8 - 347.5 brecciated with quartz carbonate ribs. 354 - 358 increasing green alteration with metacrysts of mariposite and fuchsite (?) (green carbonate)						
358	376.2	MARIPOSITE SCHIST, green, carbonated and quartzose, crenulated quartz, and carbonate veinlets, schistosity 45° - parallel to core axis. 358 - 363 a few fine pyrite specks 363 - 368 " 368 - 373 " 373 - 376.2 "	7545 7546 7547 7548	5.0 5.0 5.0 3.2	Tr Tr 0.005 0.005			

PROPERTY Western Quebec, Barraute Twp. Quebec (Swanson)

HOLE No. WS-1

DIAMOND DRILL LOG

PAGE No. 6

From	To	DESCRIPTION	Sample No.	Length Feet	ANALYSES			
					Au			
376.2	377.8	Quartz vein with some feldspar, dense, minor fine sulphide specks, contacts about 30° to core axis.						
377.8	379.2	Quartz-Feldspar Porphyry, grey to buff, dense, very fine grained 1% fine Pyrite cubes.						
		376.2 - 379.2 - sampled	7542	3.0	.005			
379.2	383	MARIPOSITE SCHIST, - FRACTURE OR BRECCIA ZONE, quartz and carbonate ribs and lenses with fragments 35-40° to core axis, weak finely disseminated pyrite.	7549	3.8	0.005			
383	408	CARBONATE-TALCOSE SCHIST, grey, "dioritic texture" schistosity 30 - 50° to core axis, with some sericite, considerable ribs and lenses of carbonate, some quartz, generally paralalled to schistosity but crenulated, weak fine pyrite, lower contact a fracture zone 60° to core axis.						
		383 - 388	7550	5.0	Tr			
		388 - 393	7551	5.0	0.005			
08	415.2	METADIORITE, grey green, foliation and banding with paralalled quartz veinlets at 45 - 55° to core axis.						
		413 - 415.2 odd Pyrite speck	7552	2.2	Nil			

PROPERTY Western Quebec, Barraute Twp., Quebec (Swanson)

HOLE No. WS-1

DIAMOND DRILL LOG

PAGE No. 7

From	To	DESCRIPTION	Sample No.	Length Feet	ANALYSES			
					Au			
415.2	422.5	TRACHYTE, sericitic with minute quartz, metacrysts, light buff to cream colored, dense, hard, foliation to weak banding 45 - 55° to core (altered tuff??) some silicification weak pyrite as minute blebs and disseminated, contacts 50° to core and few quartz veinlets.						
		415.2 - 416.2 fracture zone						
		416.2 - 417.2 dioritic fragment						
		415.2 - 417.2 sampled	7553	2.0	N11			
		417.2 - 422.5 "	7554	5.3	0.005			
422.5	433.8	METAVOLCANIC, (andesitic?) light grey-green very fine grained, feldspathized and weakly silicified, a few buff-white feldspar and quartz ribs and threads, weak pyrite as small cubes and disseminated						
		428.8-433.8 sampled	7555	5.0	Tr			
433.8	435.3	RHYOLITE, light buff to cream colored, some fracturing, upper foot, with fair pyrite, finely disseminated, some chalcopyrite.	7556	1.5	0.21			
		433.9-0.1' quartz with fair sphalerite, some chalcopyrite+pyrite, a few galena blebs.						
435.3	440	QUARTZ FELDSPAR PORPHYRY, light buff to white, very fine grained to dense, minute metacrysts, frequent sericitic slips, contacts 45° to core axis, weak to fair fine pyrite and marcasite.	7557	4.7	0.01			

PROPERTY Western Quebec, Barraute Twp., Quebec (Swanson)

HOLE No. WS-1

DIAMOND DRILL LOG

PAGE No. 8

From	To	DESCRIPTION	Sample No.	Length Feet	ANALYSES			
					Au			
40	456	METAVOLCANIC, (andesite?) light grey-green buff tinge, similar to 422.5-433.8, more sericitic some slips, a few small amygdules of quartz and/or feldspar, scant fine pyrite.						
		440 - 443 fair fine pyrite along slips and quartz, threads, scantily disseminated	7558	3.0	.005			
56	457.5	ALTERED CONTACT ZONE, 40 - 50° to core axis, grey green with buff tinge, sericitic, siliceous banded 40-50°, some fractures weak pyrite as blebs and cubes	7559	1.5	Tr			
57.5	460.7	RHYOLITE, buff with grey-green tinge, banded 40 - 50° to core axis, sericitic, fair pyrite as thin seams and blebs	7560	3.2	0.005			
60.7	471	METAVOLCANIC (andesite) sericitic, weakly feldspathic, grey-green with buff tinge, some quartz and feldspar ribs and threads with slight crenulation, weak to fair pyrite/marcasite.						
471	471.7	QUARTZ-FELDSPAR PORPHYRY, white with minute metacrysts, no visible sulphides	7561	0.7	0.005			
471.7	502.1	METAVOLCANIC (andesite?) light greenish grey, sericitic, weakly feldspathized, a few quartz ribs with some sections of scant pyrite as blebs and disseminated.						

PROPERTY Western Quebec, Barraute Twp. Quebec (Swanson)

HOLE No. WS-1

DIAMOND DRILL LOG

PAGE No. 9

From	To	DESCRIPTION	Sample No.	Length Feet	ANALYSES			
					Au			
		487 - 489 brecciated, more quartz & pyrite						
		496 - 499 " " " " "						
502.1	531.8	METADIORITE, grey-green, medium grained, nearly massive, odd quartz and feldspar thread and rib, slightly sericitic & feldspathic, scant pyrite as cubes & blebs						
		526.5 - 531.8 carbonated and more feldspathized.						
531.8	561.5	METAVOLCANIC, light greenish grey, buff tinge, very fine grained, frequent threads ribs and patches of quartz with some carbonate and feldspar, sericitic, weakly feldspathic, scant to weak fine pyrite.						
561.5	568.9	BRECCIA ZONE, mostly quartz and feldspar sericitic, some rock fragments, zone at 40 - 45° to core axis.						
		562.4 - 566 considerable quartz 3-4% pyrite/marcasite	7543	3.6	0.01			
		566 - 568.9 less quartz and pyrite	7544	2.9	Tr			
568.9	612.7	METADIORITE, grey-green, fine to medium grained, nearly massive, some sericite, a few quartz and carbonate threads and ribs, a few sections with increased pyrite as cubes						
		609 - 612.7 more altered, distinct foliation 45 - 55° to core axis						

PROPERTY Western Quebec, Barraute, Twp., Quebec (Swanson)

HOLE No. WS-1

DIAMOND DRILL LOG

PAGE No. 10

From	To	DESCRIPTION	Sample No.	Length Feet	ANALYSES				
					Au				
612.7	655.0	METAVOLCANIC, agglomeritic-tuffaceous? and brecciated, very light to light greenish grey, bleached appearance, some very dense and silicified, banded about 45 - 55° to core axis, weak pyrite as threads, blebs and some dissemination							
		652 - 655 odd pyrite speck and cube, 653 - 654 several threads of pyrite.	7562	3.0	Nil				
655	660.5	TRACHYTE, dense nearly white with cream to buff tinge, minute white metacrysts, fractured with thin sericite to talc-like coating, odd pyrite speck, some along fractures.	7563	5.5	Tr				
660.5	669.8	METAVOLCANIC, agglomeritic-tuffaceous see 612.7 - 655.							
		660.5 - 663 scant pyrite	7564	2.5	Tr				
		665 - 669.8 alteration change, darker grey, less sericite and bleaching.							
669.8	690	METAVOLCANIC, darker grey, some small fragments & agglomeritic-tuffaceous, weakly sericitic as threads, and banded 45 - 60° to core axis, partly sheared, some short brecciated zones, scant disseminated pyrite specks and cubes.							

PROPERTY Western Quebec, Barraute Twp. Quebec (Swanson)

HOLE No. WS-1

DIAMOND DRILL LOG

PAGE No. 11

From	To	DESCRIPTION	Sample No.	Length Feet	ANALYSES			
					Au			
690	696	METAVOLCANIC, contact zone ? lighter grey with faint green tinge (mariposite) and sercite a few small fragments and ghost like outlines, agglomerate to trachyte, porphyritic appearance with minute brown specks or metacrysts peppered throughout faint foliation 50 - 55° to core axis.	7565	6.0	Nil			
696	699.3	FELDSPAR PORPHYRY, very fine grained light grey to white, weakly sericitic, very siliceous to quartz groundmass, resembles trachyte but no flow structure and granular, two small quartz ribs, a few disseminated specks and cubes of pyrite, upper contact 75° and lower 55° to core axis.	7566	3.3	Tr			
699.3	701.3	METAVOLCANIC see 690-696, odd pyrite speck and cube.	7567	2.0	Nil			
701.3	704.1	METAVOLCANIC, agglomerate - tuff see (669.8 - 690), lower contact 50° to core axis.						
704.1	721.7	METAVOLCANIC, andesite to dacite, light greenish grey, very fine grained to aphanitic, partly bleached, feldspathized, weakly agglomeratic, several quartz and carbonate threads, short breccia zones, scant disseminated pyrite.						

PROPERTY Western Quebec, Barraute Twp., Quebec Swanson

HOLE No. WS-1

DIAMOND DRILL LOG

From	To	DESCRIPTION	Sample No.	Length Feet	ANALYSES			
					Au			
		719 -721.7 brecciated, partly bleached and feldspathized, with several fragments of feldspar porphyry, scant pyrite.	7568	2.7	Nil			
721.7	723.2	Granitic dyke, white, very fine grained, nearly massive, faint foliation and parallel sericitic slips at 45 - 55° to core axis, faintly porphyritic with minute metacrysts, scant disseminated pyrite, contacts at 55° to core axis.	7569	1.5	Tr			
723.2	725.2	METAVOLCANIC, altered, bleached and brecciated, scant pyrite.	7570	2.0	Nil			
725.2	731.1	FELDSPAR-QUARTZ PORPHYRY, fine metacrysts, similar to 721.7 - 723.2, more massive, less frac- tures, very light grey to white with buff tinge from weak sericite, faint foliation parallel to contacts at 55° to core axis	7571	5.9	Tr			
731.1	748.4	METAVOLCANIC, andesitic-basaltic, dark to light greyish green, carbonatized with threads blebs and short breccia zones, short zones agglomeratic, odd quartz threads odd pyrite speck and thread. 735 - 736 dark grey, feldspar porphyry fragment, upper contact 30° and lower 150° to core axis.						
		747 - 748.4 scant pyrite	7572	1.4	0.01			

PROPERTY Western Quebec, Barraute Twp. Quebec (Swanson)

HOLE No. Ws-1

DIAMOND DRILL LOG

PAGE No. 13

From	To	DESCRIPTION	Sample No.	Length Feet	ANALYSES				
748.4	749.8	SYENITE, fine to medium grained, massive reddish brown to green tinge, fair amount of ferro magnesian minerals (20%) gives porphyritic appearance, fair finely, disseminated pyrite and as threads contacts 55 - 60° to core axis.	7573	1.4	0.005				
749.8	757.0	META-ANDESITE, grey green, weakly carbonatized several quartz and carbonate threads and ribs.							
		749.8 - 755 light pyrite in threads and disseminated, pyrite stronger between 752 - 754	7574	5.2	0.005				
757.0	783	METAPERIDOTITE, fine to medium grained light to dark grey, nearly massive frequent slips, with carbonate, some quartz ribs, highly carbonatized and talcose. 774 - 778 banded 60° to core axis 780.8 - 782 andesite fragment 780.8 - 783 sampled							
			7575	2.2	Nil				
783	786.9	QUARTZ-FELDSPAR PORPHYRY, light grey, green tinge of ferromagnesian minerals fine to medium grained, a few slips, odd pyrite speck.	7576	3.9	Tr.				
786.9	788.0	META-ANDESITE, dark grey green, aphanitic, massive contacts 45° to core axis.							

PROPERTY Western Quebec, Barraute Twp. Quebec (Swanson)

HOLE No. WS-1

DIAMOND DRILL LOG

PAGE No. 14

From	To	DESCRIPTION	Sample No.	Length Feet	ANALYSES			
788	996.0	METAPERIDOTITE, talcose, carbonated with some serpentine, especially along the frequent fractures, light to dark grey, nearly massive, fine to coarse grained, some short breccia zones, frequent ribs & threads of carbonate and some quartz, varying degrees of alteration throughout, very scant pyrite disseminated and threads.						
		883 - 0.3' carbonate						
		894.5 - 896.3 carbonate & quartz						
		989.5 - 989.8 carbonate & quartz						
	996.0	Feet - END OF HOLE #WS-1.						
		Note:-B casing to 60 feet recovered 22 ft. A casing to 68 feet, all recovered. Hole cemented twice from 300 feet to casing at 42 feet.						

PROPERTY Western Quebec, Barraute Twp. Quebec (Swanson)

HOLE No. WS-1

DIAMOND DRILL LOG

PAGE No. 15

BARRAUTE TWP

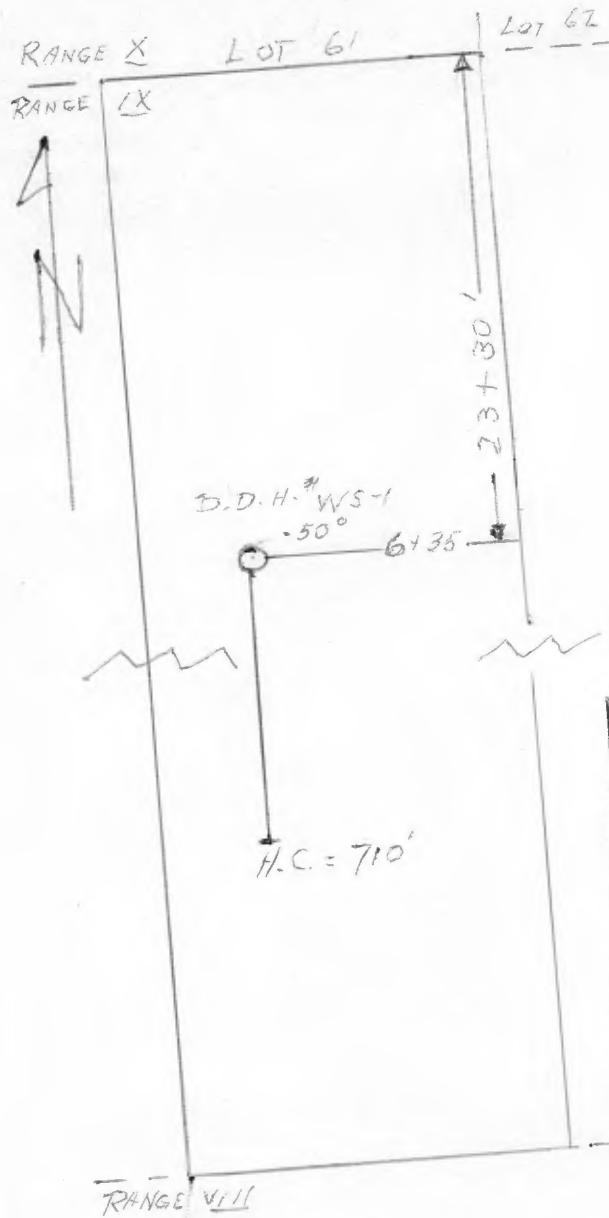

Ministère des Richesses Naturelles, Québec
SERVICE DE LA
DOCUMENTATION TECHNIQUE
Date: 9 - AOU 1971
No GM: 27092

SKETCH OF D.D.H. # WS-1
COLLAR LOCATION No Scale.
R.L.A.
JUL 13/71