

GM 16448-D

SAMPLING RECORD, NEMISCAU PROPERTY

Documents complémentaires

Additional Files



Licence



Licence

Cette première page a été ajoutée
au document et ne fait pas partie du
rapport tel que soumis par les auteurs.

Énergie et Ressources
naturelles

Québec 

→ Canadian Nickel Co. Ltd. Carter 1815

FORM 285-A

THE INTERNATIONAL NICKEL CO. OF CANADA, LIMITED

PROPERTY: NEMISCAU AREA: ANOM. 10-1

SAMPLING RECORD

SHEET NO. 1

CLAIM #1 - LIC. 202438 - POST #1 - 46° T. Az - 930' FROM B.H.

CO-ORDINATES

HOLE NO. 24051 DEPTH 70.0 ANGLE 45° STRIKE N ELEVATION

1450 S 4+00 E

DEPTH FEET	FORMATION	SAMPLE NO.	LENGTH FT.	ANALYSIS			LENGTH FEET	PROGRESSIVE TOTALS		
				COPPER %	NICKEL %	CU. & NI %		FEET X PER CENT		
								COPPER	NICKEL	Total PM's
0.0	Collar									
10.0	Overburden - sand + boulders - Ex. casing									
10.5	Gr. - bio.									
16.0	Gn. - Sil. bio. - felds. with qtz. + felds. str. - banded at start (near gr. m.) sl. chl. in parts. few scattered garnets - fold 45° to core axis.									
21.0	MVVW - meta sed. mass. quartz 1/2% Po + Py.	F235006	5.0	Nil	Nil					Nil
26.0	MVVW - scatt. spks. - SULP. pred. Py.	F235007	5.0	Nil	Nil					Nil
31.0	MVVW - scatt. spks. diss. SULP.	F235008	5.0	Nil	Nil					Nil
37.0	MVVW - v. sl. scatt. SULP.	F235009	6.0	Nil	Nil					Nil
38.8	MVW - chloritic - 3% SULP. 2% Po, 1% Py.	F235010	1.8	Nil	Nil			Pd. .004	Pt. .005	.009
40.0	Ms. Pt. SULP. with graphite - 95% Po. with scatt. spks. Py.	F235011	1.2	Nil	.04	.04				trace
45.0	MVW - qtz. quartz - 5% SULP. 4% Po, 1% Py.	F235012	5.0	Nil	.01	.01				Nil
46.3	MVW - do. 10% SULP. 9% Po. 1 1/2% Py.	F235013	1.3	Nil	.01	.01				Nil
51.3	MVW - do. - 5% SULP. - 2 1/2% Po, 1 1/2% Py.	F235014	5.0	Nil	.01	.01				Nil
55.0	MVW - do. - 3% SULP. - 2% Po. 1% Py. - partly gneissic fold @ 45°	F235015	3.7	Nil	Nil					Nil
58.2	MVW - Sch. graphitic in part. 45° to core axis. 15% SULP. - 13% Po, 2% Py	F235016	3.2	Nil	.01	.01				Nil

PUBLIC

Ministère des Richesses Naturelles

SERVICE DES GITES MINÉRAUX

No. GM-16448-D

THE INTERNATIONAL NICKEL CO. OF CANADA, LIMITED

PROPERTY NEMISLAU AREA: ANOM. 10-1

SAMPLING RECORD

SHEET NO. 2

HOLE NO. 24051 DEPTH 70.0 ANGLE 45° STRIKE N ELEVATION

CO-ORDINATES
17505 4+00E

DEPTH FEET	FORMATION	SAMPLE NO.	LENGTH FT.	ANALYSIS			LENGTH FEET	PROGRESSIVE TOTALS		
				COPPER	NICKEL	CU. & NI.		FEET X PER CENT		
				%	%	%		COPPER	NICKEL	CU. & NI. TOTAL P.M.'S
60.0	MVW - qtz. & chlor. sch. bands & sulph. streaks. - 8% Sulp. 5% Po, 2% Py, 1% Zns. Few spks. C.P.	F235017	1.8	NIL	.02	.02	Zn .24			NIL
63.2	MVW - meta- sed - wkly sh'd. 7% Sulp. - 5% Po, 2% Py.	F235018	3.2	NIL	NIL		Zn			NIL
66.7	MVW - qtz. chl. felds. band 3%	F235019	3.5	NIL	NIL		NIL			NIL
70.0	MVW - Metased. gneiss in part. 3% Sulp. - 1 1/2 % Po - 1/4 Py.	F235020	3.3	NIL	.01	.01			Au. .003	.003
END OF HOLE										
SIZE OF HOLE - EX.										
STARTED - JULY 15, 1963										
COMPLETED - JULY 17, 1963										
DRILLED BY: CANADIAN NICKEL										
Packsack										
All casing pulled										
Hole not relogged.										
Logged by R.D. Moss.										

THE INTERNATIONAL NICKEL CO. OF CANADA, LIMITED

PROPERTY: NEMISCAU AREA: ANOM. 10-1

SAMPLING RECORD

SHEET NO. _____

CLAIM #1 LIC. # 20293B - Post #1 - 46° T. Az. - 930° FROM B.N.

CO-ORDINATES

HOLE NO. 24051 DEPTH 70.0 ANGLE 45° STRIKE N. ELEVATION _____

1450 S 4+00 E

DEPTH FEET	FORMATION	SAMPLE NO.	LENGTH FT.	ANALYSIS			LENGTH FEET	PROGRESSIVE TOTALS		
				COPPER	NICKEL	CU. & NI.		FEET X PER CENT		
				%	%	%		COPPER	NICKEL	CU. & NI.
0.0	Collar									
10.0	Casing									
16.0	Metased.									
37.0	MVW - Gynke									
38.8	MVW - Gynke									
40.0	Ms - Bx SULP.									
55.0	MVW - Metased.									
58.2	MW - sch. graphitic									
63.2	MVW - metased.									
66.7	Pegmatite									
70.0	MVW - Metased.									
END OF HOLE										
SIZE OF HOLE - EX										
STARTED - JULY 15, 1963										
COMPLETED - JULY 17, 1963										
DRILLED BY: CANADIAN NICKEL										
PACKSACK										
ALL CASING PULLED										
HOLE NOT PLUGGED										
LOGGED BY: R.D. MASS.										

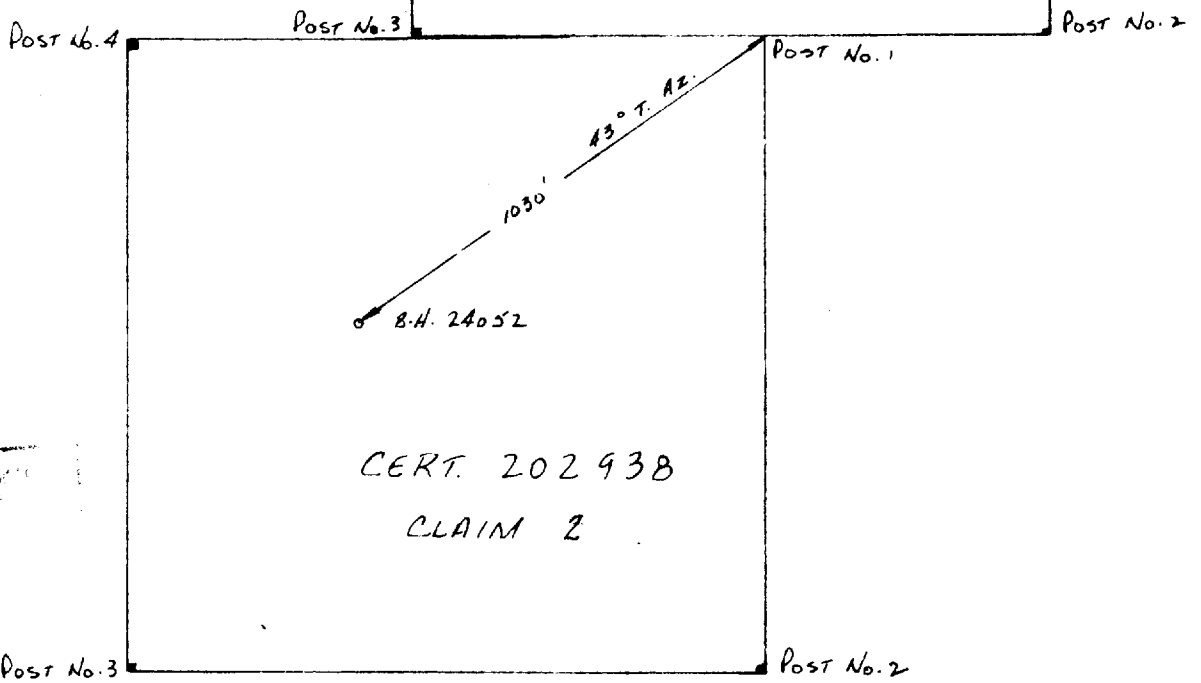
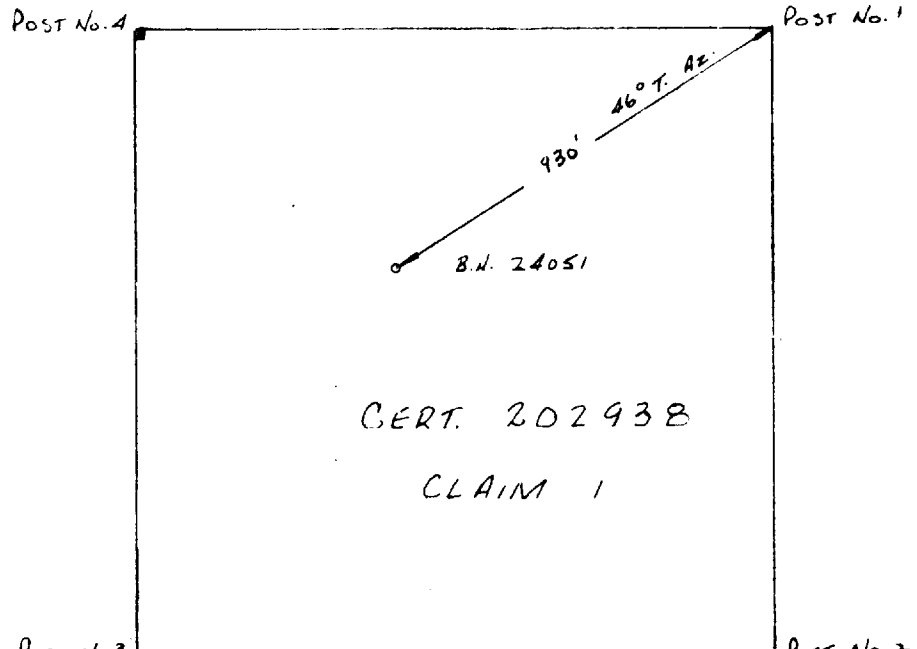
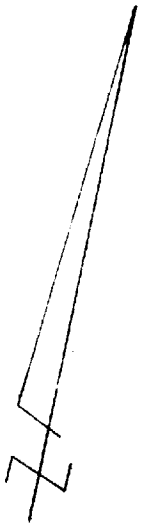

TRAIL

Province des Richesses Naturelles Québec
 DÉPARTEMENT DES MINES
 16448-D

LOCATION SKETCH
 of DRILL HOLES: 24051, 24052
 LOCATED ON CERT. 202938 CLS. 1 & 2
 PROJ. TWP. 1815
 SCALE: 1 INCH = 400 FEET.