

ENLARGED PLAN OF 200 SCALE MAP SHEET #1
SHOWING BREAKDOWN TO 100 AND 50 SCALE MAP SHEETS.
SCALE: - 1" = 2000'

NOTE: - ALL MAP SHEETS ARE STANDARD "U" SIZE.
35" X 23" + 1/2" MARGIN.

EXAMPLE OF MAP CODE FOR LOWER RIGHT HAND
CORNER OF MAP SHEETS: - A MAP IN 1000 SC. BLOCK "A",
200 SC. SHEET 3, 100 SC. SHEET "C" AND BEING A
50 SC. SHEET IN THE SOUTHWEST CORNER OF 100 SC.
SHEET "C" WOULD BE DESIGNATED AS -
A-1-C-3.

PUBLIC

11" X 17"

Ministère des Richesses Naturelles, Québec
5 AVR 1963
SERVICE DES GITES MINÉRAUX
No GM- 12949

CANADIAN JOHNS-MANVILLE CO. LTD.
MATHESON MUNRO MINE ONTARIO
TOWNSHIP LAYOUT PLAN
FOR 1000, 200, 100 AND 50 SCALE
MAP SHEETS.

SCALE	DATE 1962
DRAWN F.J.E.	PROV. of QUE.
TRACED J.K.L.	
APPROVED F.J.E.	

CARPENTIER TWP.

QUEBEC TOWNSHIP LAYOUT PLAN FOR 1000 AND 200 SCALE MAP SHEETS.
SCALE: - 1" = 1 MILE.

ADJOINS SHEET N° D-6



ADJOINS SHEET N° C-11

PUBLIC

36x24

Ministère des Richesses Naturelles, Québec

5 AVR 1963

SERVICE DES GITES MINÉRAUX

No GM- 12949

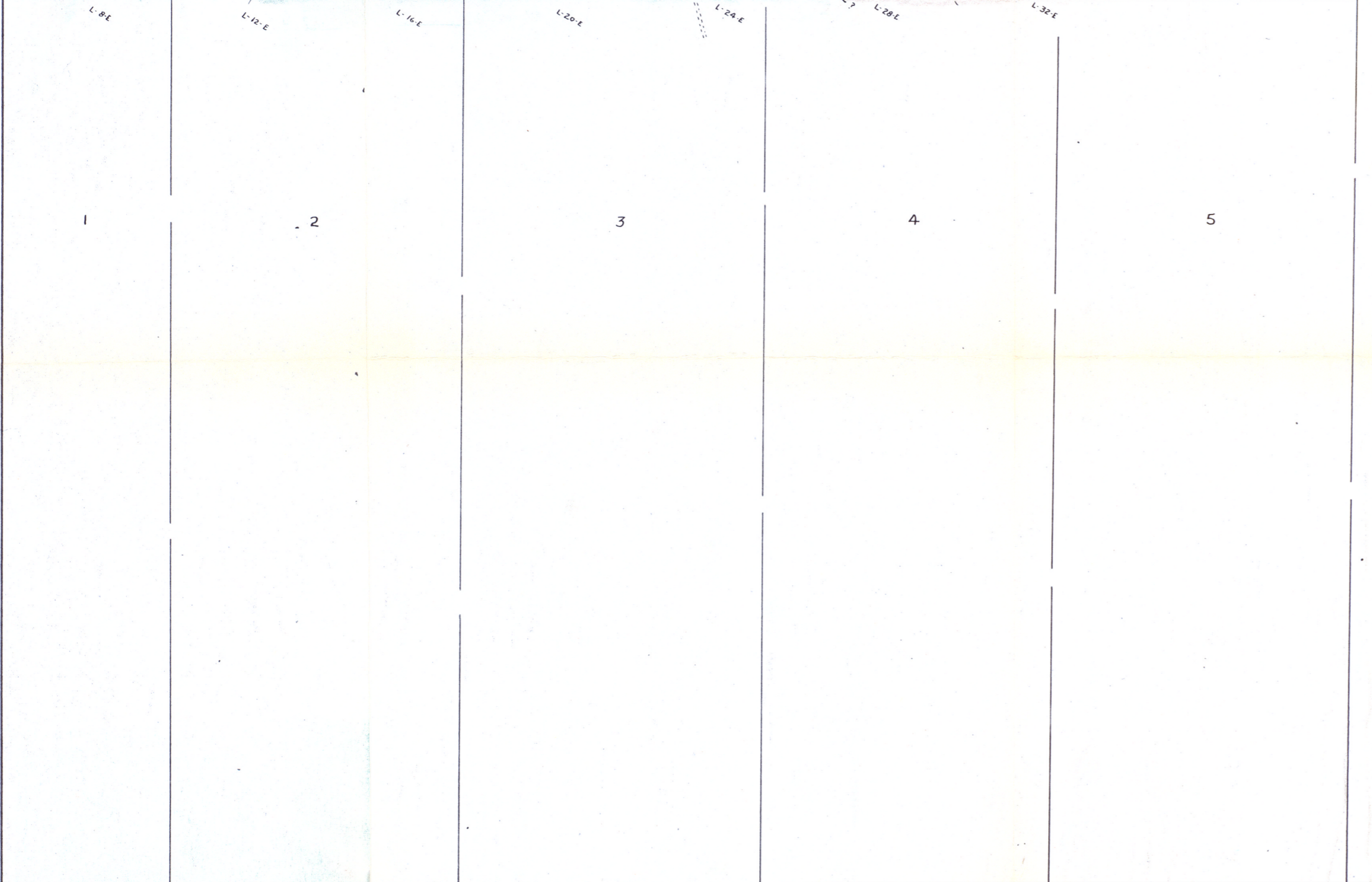
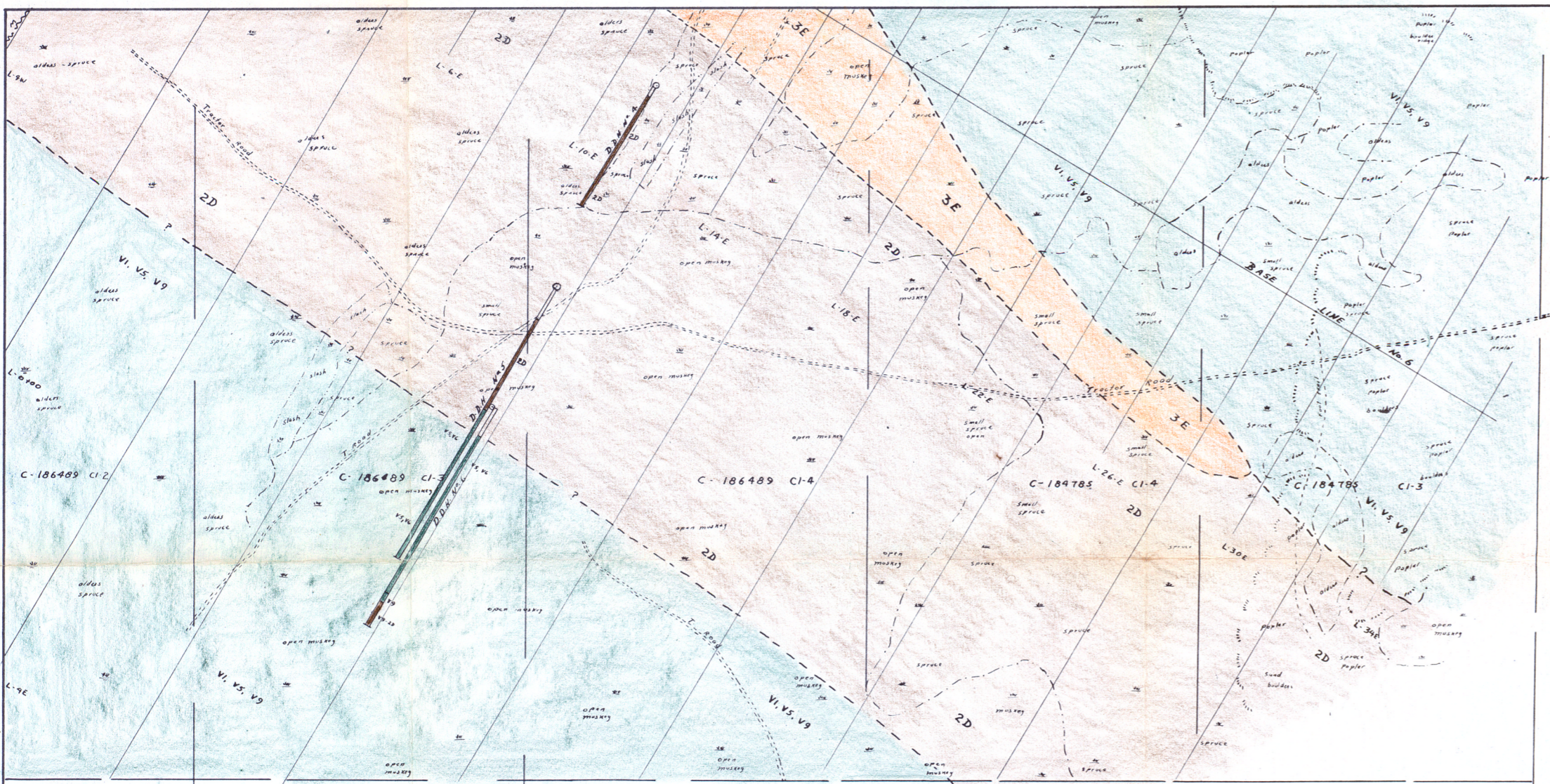

R. IV.

PUBLIC

36x24

Ministère des Richesses Naturelles, Québec

5 AVR 1963

SERVICE DES GITES MINÉRAUX

No GM- 12949

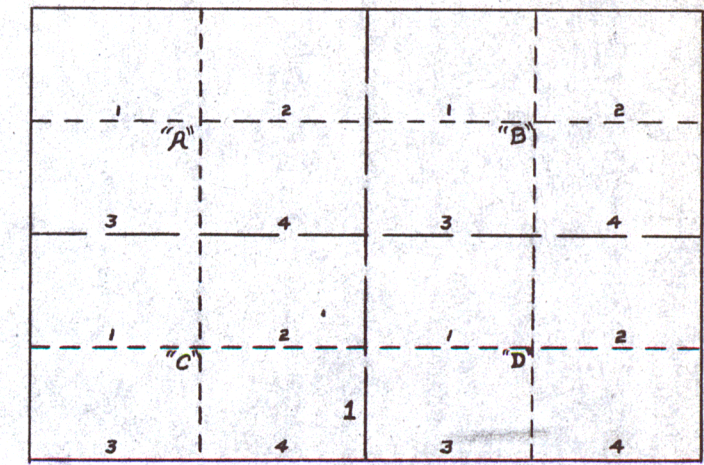
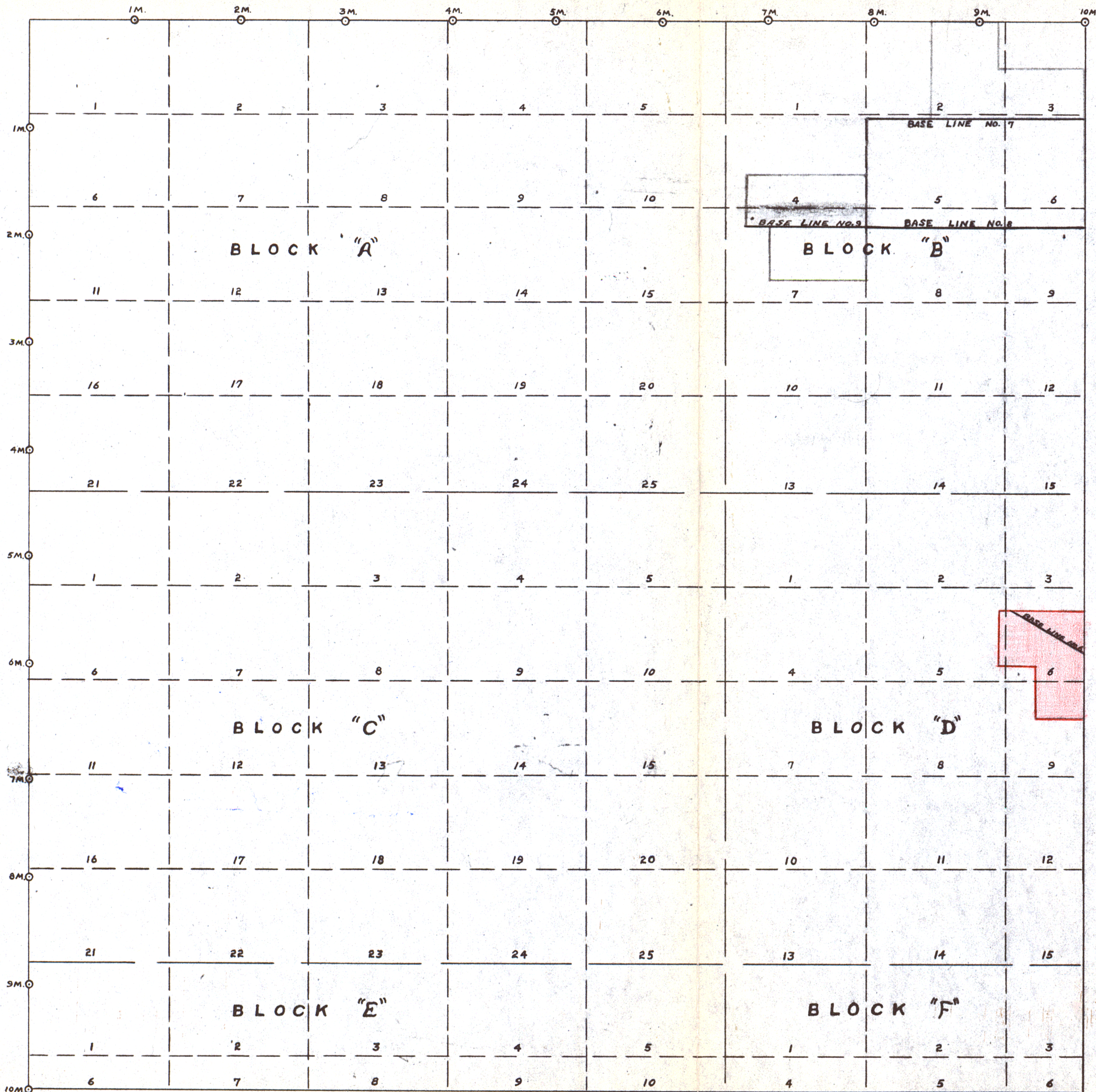
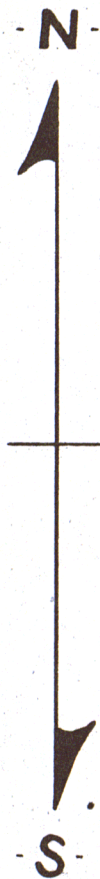

ENLARGED PLAN OF 200 SCALE MAP SHEET #1
SHOWING BREAKDOWN TO 100 AND 50 SCALE MAP SHEETS.
SCALE:- 1" = 2000'

NOTE:- ALL MAP SHEETS ARE STANDARD "U" SIZE.
35" X 23" + 1/2" MARGIN.

EXAMPLE OF MAP CODE FOR LOWER RIGHT HAND
CORNER OF MAP SHEETS:- A MAP IN 1000 SC. BLOCK "A",
200 SC. SHEET 1, 100 SC. SHEET "C" AND BEING A
50 SC. SHEET IN THE SOUTHWEST CORNER OF 100 SC.
SHEET "C" WOULD BE DESIGNATED AS -
A-1-C-3.

PUBLIC

Ministère des Richesses Naturelles, Québec
5 AVR 1963
SERVICE DES GITES MINÉRAUX
No GM- 12949

11" X 17"

CANADIAN JOHNS-MANVILLE CO. LTD.
MATHESON MUNRO MINE ONTARIO
TOWNSHIP LAYOUT PLAN
FOR 1000, 200, 100 AND 50 SCALE
MAP SHEETS
SCALE _____ DATE 1962
DRAWN F.J.E. PROV. of QUE.
TRACED J.K.L.
APPROVED F.J.E.

BARRAUTE TWP.

QUEBEC TOWNSHIP LAYOUT PLAN FOR 1000 AND 200 SCALE MAP SHEETS.
SCALE:- 1" = 1 MILE.

56

PUBLIC

Ministère des Richesses Naturelles, Québec
5 AVR 1963
SERVICE DES GITES MINÉRAUX
No GM-12949

11" X 24"

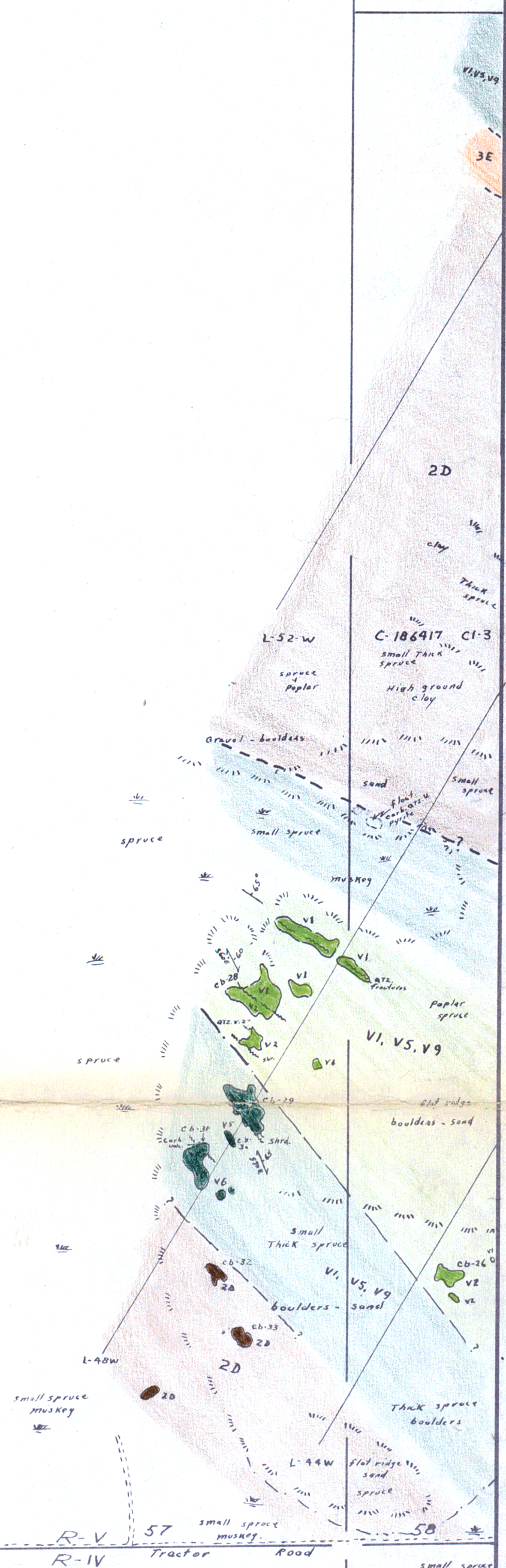

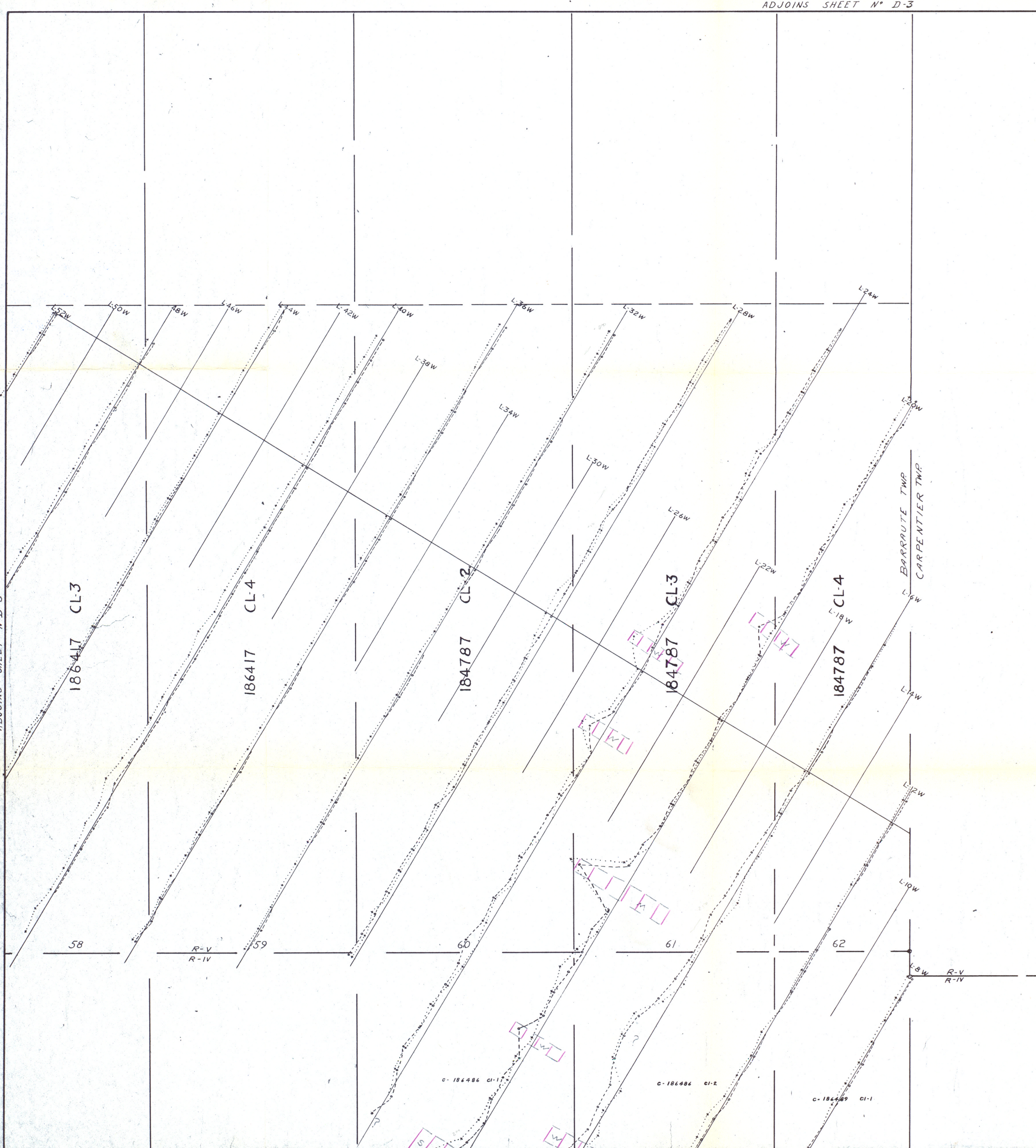

ADJOINS SHEET N° D-5

ADJOINS SHEET N° C-6 CARPENTIER

Ministère des Richesses Naturelles, Québec
 5 AVR 1963
 SERVICE DES GITES MINÉRAUX
 No GM-12949

PUBLIC

24" X 36"

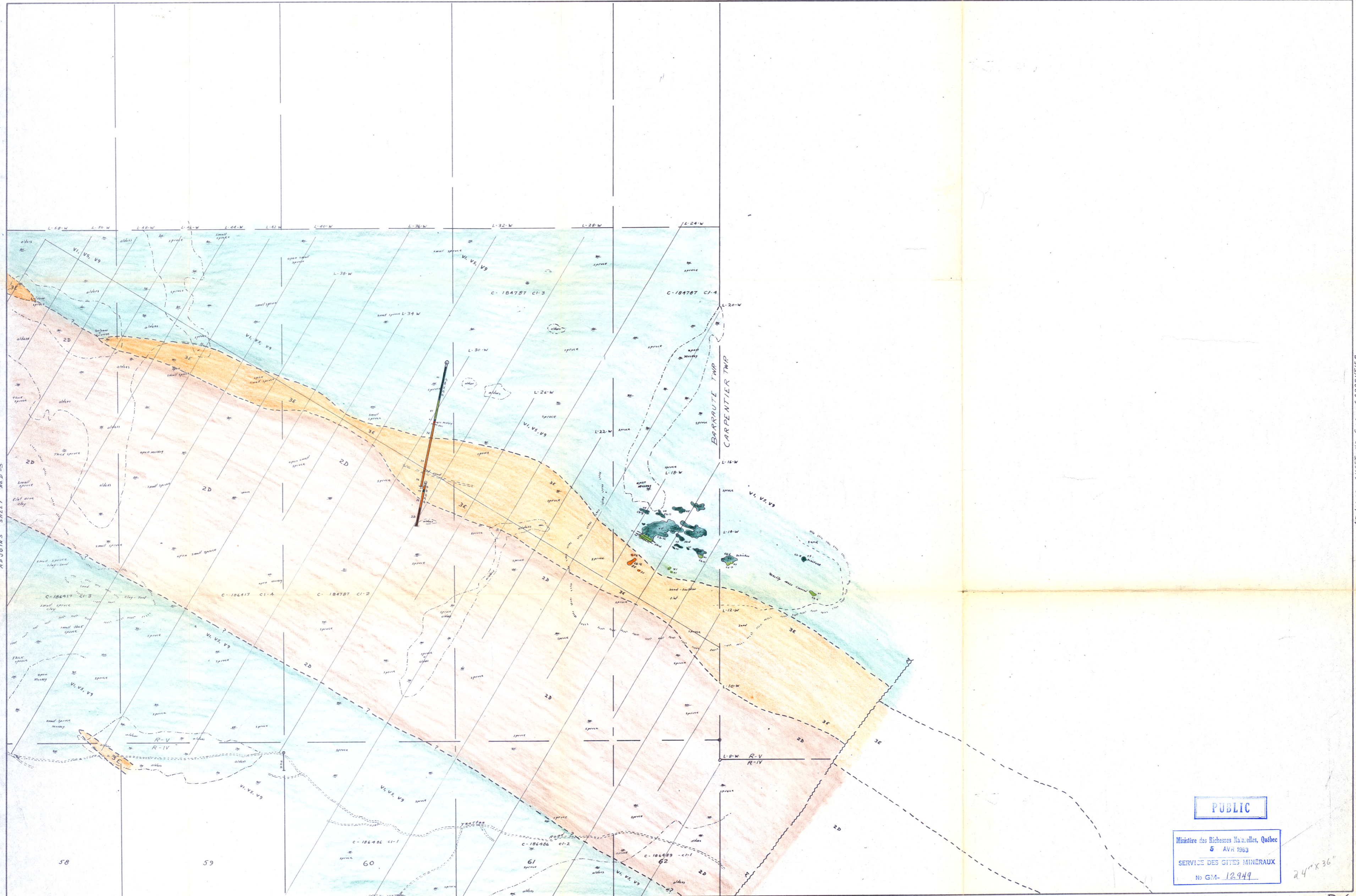

ADJOINS SHEET No. D-5

ADJOINS SHEET No. C-6 CARPENTIER

58

59

60

61

62

PUBLIC

Ministère des Richesses Naturelles, Québec
 5 AVR 1963
 SERVICE DES GITES MINÉRAUX
 No GM- 12949

24"x36"

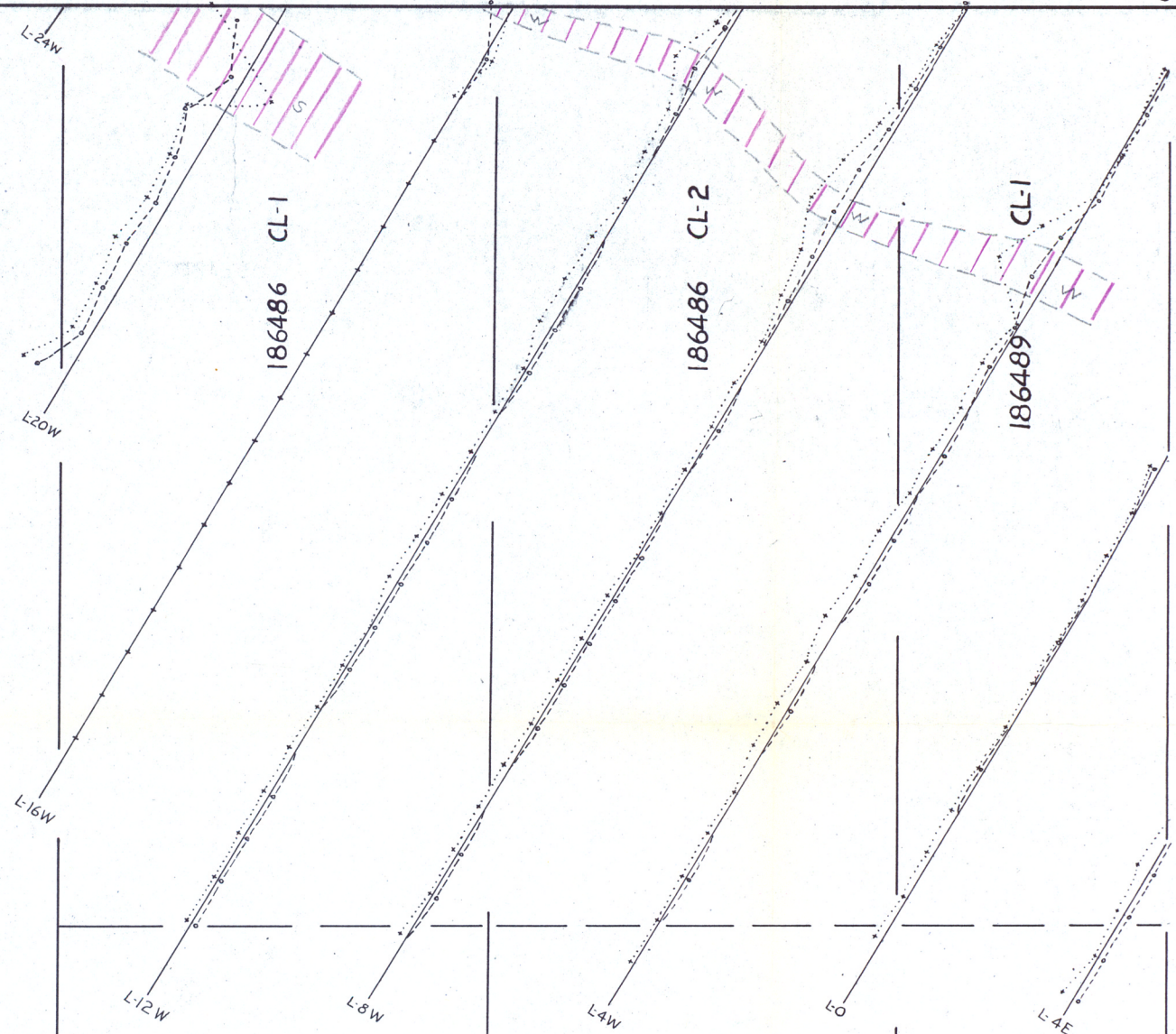

ADJOINS SHEET N° D-8

ADJOINS SHEET N° C-11 CARPENTIER

58

59

60

61

62

RIV
R-III

Ministère des Richesses Naturelles, Québec
 5 AVR 1963
 SERVICE DES GITES MINÉRAUX
 N° GM- 12949

PUBLIC

24" x 36"

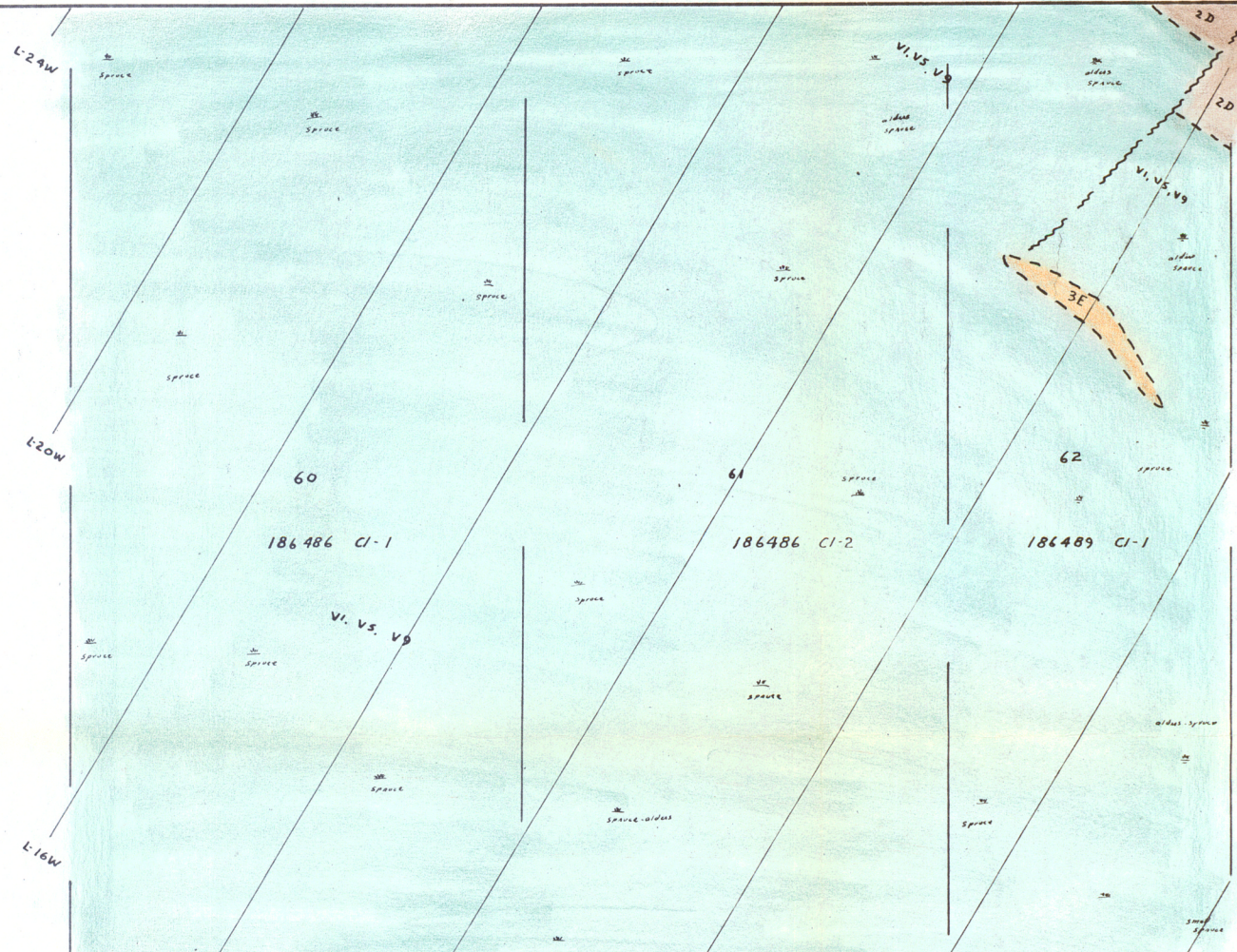

R-IV

BARRAUTE TWP
CARPENTIER TWP

R-IV
R-III

PUBLIC

Ministère des Richesses Naturelles, Québec
 5 AVR 1963
 SERVICE DES GITES MINÉRAUX
 No GM-12949

ADJOINS SHEET No. D-6

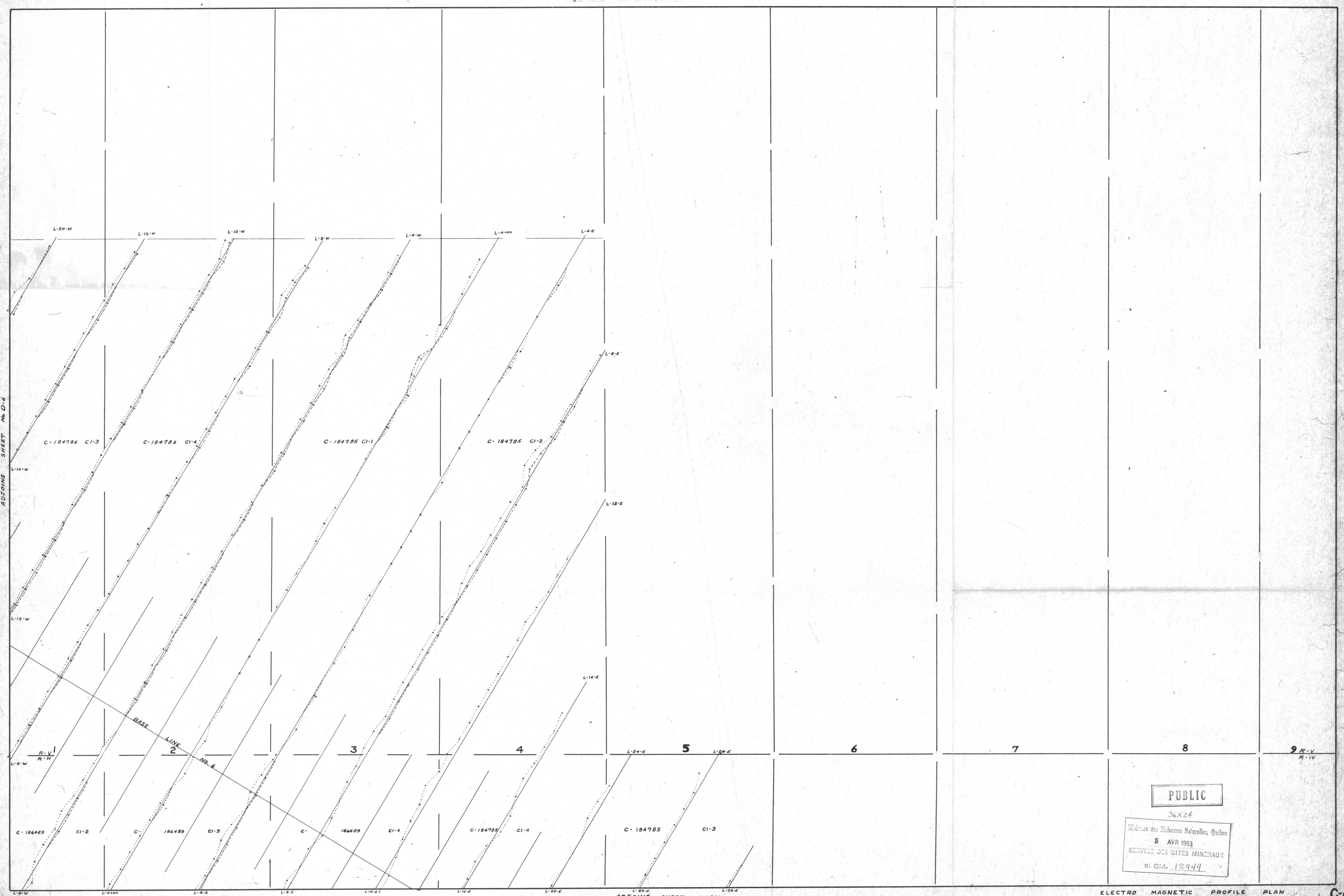

PUBLIC

36X24

Ministère des Richesses Naturelles, Québec
 5 AVR 1963
 SERVICE DES CITES MINÉRAUX
 No GM- 12949

ADJOINS SHEET No. C-11

ELECTRO MAGNETIC PROFILE PLAN 1" = 200' C-6

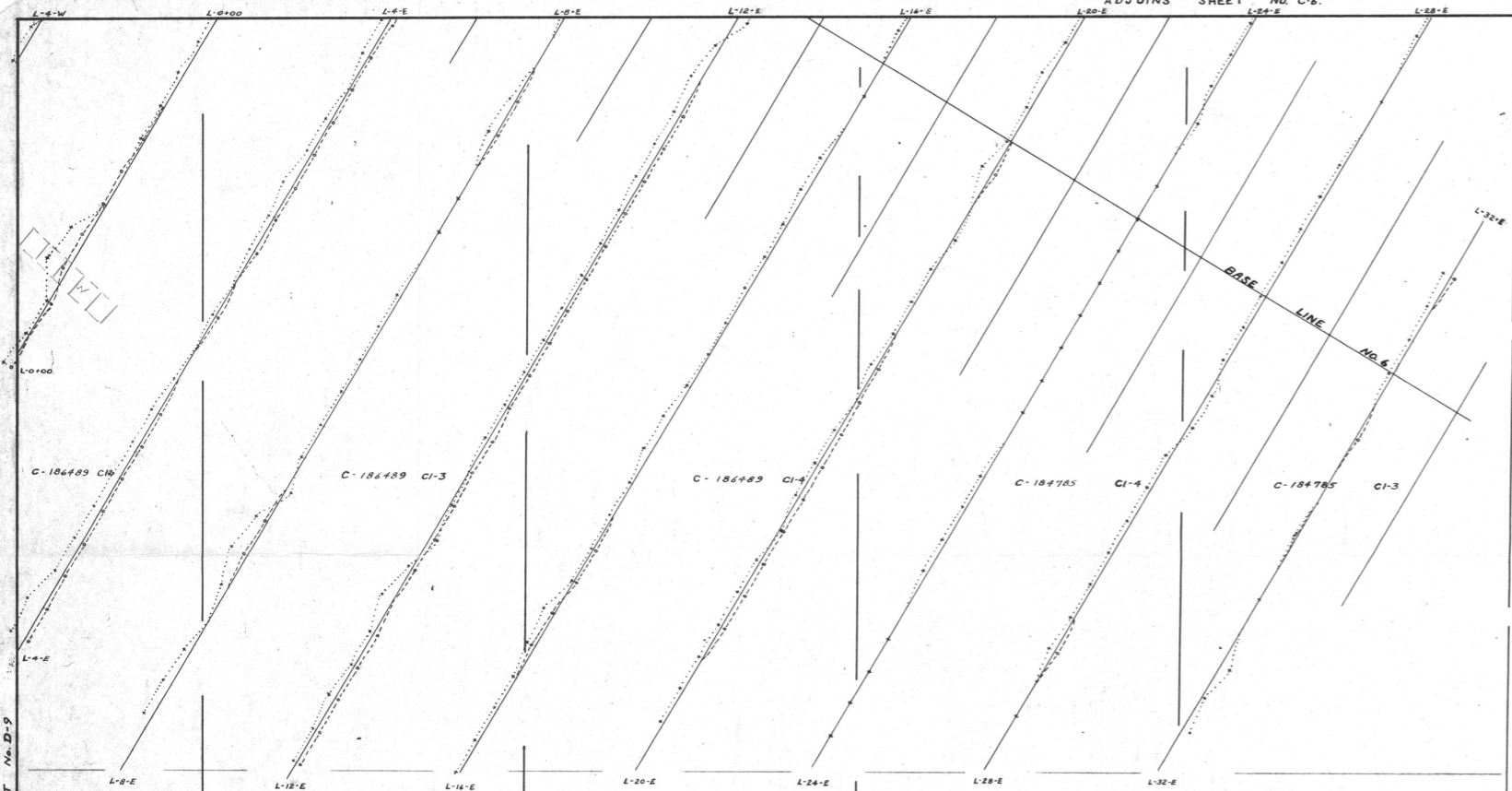

ADJOINS SHEET No. D-9

1 2 3 4 5 6 7 8 9

R. IV.

PUBLIC

3624
 Ministère des Richesses Naturelles, Québec
 5 AVR 1963
 SERVICE DES GITES MINÉRAUX
 No GM-12949

ADJOINS SHEET NO. D-6.

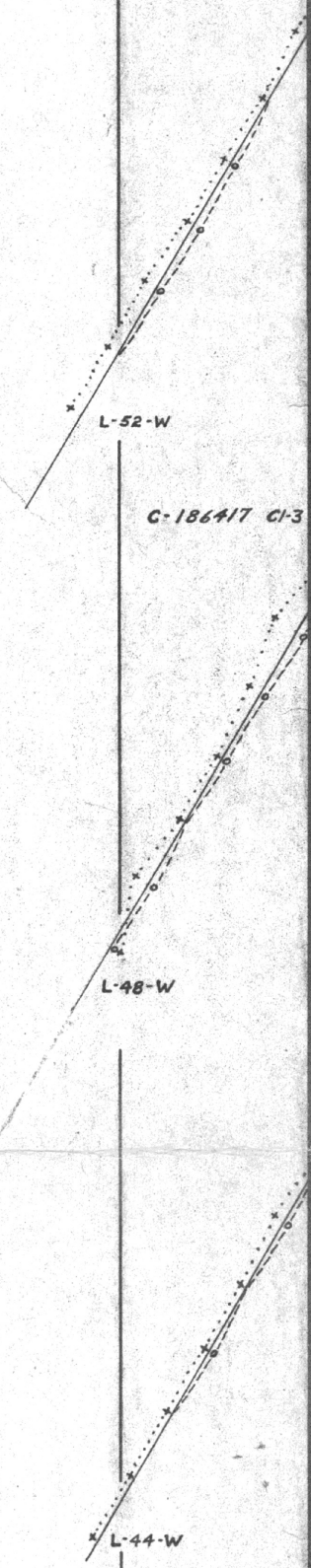

56

R-V 57
R-IV

58

PUBLIC

Ministère des Richesses Naturelles, Québec
 5 AVR 1963
 SERVICE DES GITES MINÉRAUX
 No GM- 12949

11" X 24"