

Ministère des Richesses Naturelles, Québec
 SERVICE DE LA
 GÉOLOGIE TECHNIQUE
 8546-B
 24X11

**SKETCH SHOWING
 DRAG-FOLDING**
 in the
MALARTIC SYNCLINE

Scale: One mile to the inch.

- Granodiorite, syenite & porphyry
- Albite granodiorite.
- Blake River Volcanics.
- Dioratic belt.
- Magnetic Volcanics.

Sources of information G.S.C. Preliminary Map 43-6A
 and Surveys by Koulomzine, Geoffroy, Brossard & Co.

PUBLIC

MINISTÈRE DES MINES, QUÉBEC
SERVICE DES GITES MINÉRAUX
No. G.M. 9546-B
59739

COMPOSITE PLAN SHOWING THE RESULTS OF THE
MAGNETOMETER SURVEYS, DIAMOND DRILLING & UNDERGROUND WORKINGS
DONE AT THE PROPERTIES OF

WESTERN ^{Western} QUEBEC MINES CO. LTD. & SNOWSHOE GOLD MINES LTD.

VASSAN TWP. N. W. QUEBEC

COMPILED BY

KOULOMZINE, GEOFFROY, BROSSARD & CO.

Scale: 300 feet to the inch

APRIL-MAY 1947

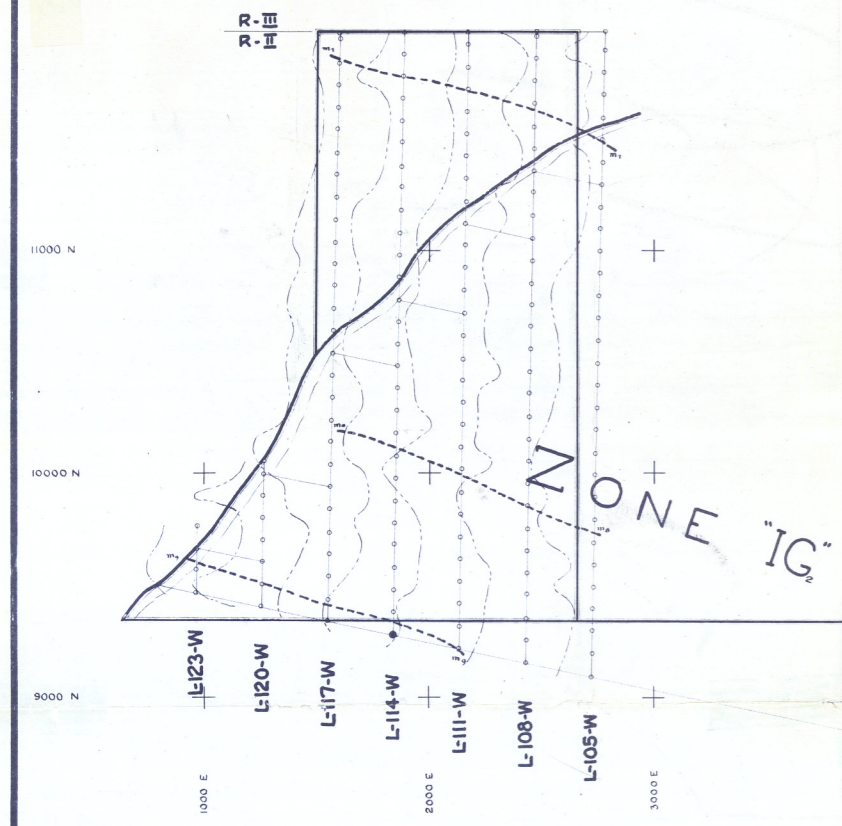

~ LEGEND ~

- Magnetic base station
 - Measurement stations along picket lines
 - Magnetic profile SCALE: 500 gammas to the inch
 - Magnetic profile SCALE: 1000 gammas to the inch
 - Magnetic profile SCALE: 2000 gammas to the inch
 - Magnetic profile SCALE: 5000 gammas to the inch
 - NOTE: 1 gamma = 1/100 000 gauss, C.G.S. unit
 - Magnetically indicated contacts and anomalies
 - Underground workings
 - Diamond drill holes
 - Property boundaries
 - Shore line
 - Quartz veins. Visible gold
 - Acid dykes
 - Basic dykes
 - Porphyries
 - Albite
 - Granodiorite
 - Shearings
 - Coarse lava flows
 - Greenstone & basic volcanics
 - Assay values: \$5.00 or over
 - Assay values: from \$2.00 to \$5.00
- NOTE: Gold in \$ per ton at \$35.00 per ounce

