

DUNCAN RANGE IRON MINES LIMITED

GEOLOGICAL MAP

SHEET No 3  
MINERAL EXPLORATION LICENSE 137  
DUNCAN LAKE AREA  
UNGAVA DISTRICT  
QUEBEC  
CANADA

QUEBEC DEPARTMENT OF MINES  
MINERAL DEPOSITS BRANCH  
No. 93 - 7492

SCALE: 1 inch = 400 feet

LEGEND

- Boulder
- Basic granite
- Granitic gneiss
- Gneiss, minor iron formation
- Iron formation
- Basaltic tuff
- Basaltic dike
- Tuff
- Strike, dip and dip direction
- Strike and dip, top contour
- Dike, top and plunge
- Section, full size
- Section, reduced
- Section, zone
- Section, name
- Elevation boundary
- Check dam?



1/4



2/4

MINERAL EXPLORATION LICENSE 137  
DUNCAN LAKE AREA  
UNGAVA DISTRICT  
QUEBEC  
CANADA

QUEBEC DEPARTMENT OF MINES  
MINERAL DEPOSITS BRANCH  
No. 93 - 7492

SCALE: 1 inch = 400 feet

LEGEND

- Boulder
- Basic granite
- Granitic gneiss
- Gneiss, minor iron formation
- Iron formation
- Basaltic tuff
- Basaltic dike
- Tuff
- Strike, dip and dip direction
- Strike and dip, top contour
- Dike, top and plunge
- Section, full size
- Section, reduced
- Section, zone
- Section, name
- Elevation boundary
- Check dam?

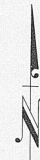

3/4



4/4

H. S. ...  
June 15, 1955



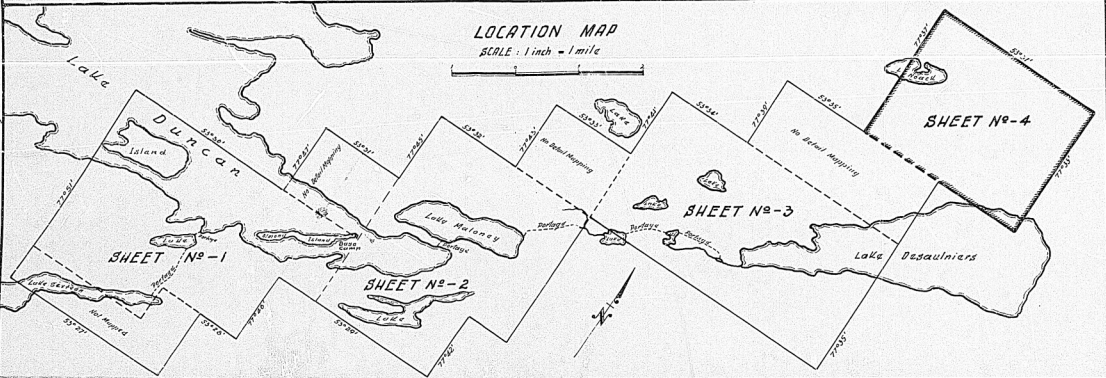

# DUNCAN RANGE IRON MINES LIMITED

## GEOLOGICAL MAP

SHEET N° 4  
MINERAL EXPLORATION LICENSE 137

QUEBEC DEPARTMENT OF MINES  
15<sup>th</sup> Aout 1959  
MINERAL DEPOSITS BRANCH  
No G.M. 7692

DUNCAN LAKE AREA  
UNGAVA DISTRICT  
QUEBEC  
CANADA  
SCALE 1 inch = 400 feet

### LEGEND

- Diabase
- Quartz vein
- Basic gneiss
- Granite
- Greywacke, minor iron formation
- Iron formation
- Quartzite, dark, minor till
- Tuff, minor flow
- Strike, dip and top direction
- Strike and dip, top unknown
- Drag fold and plunge
- Synclinal fold axis
- Schistosity
- Shear zone
- Outcrop area
- Mass flow, slump
- Effer boundary
- Chip sample 5

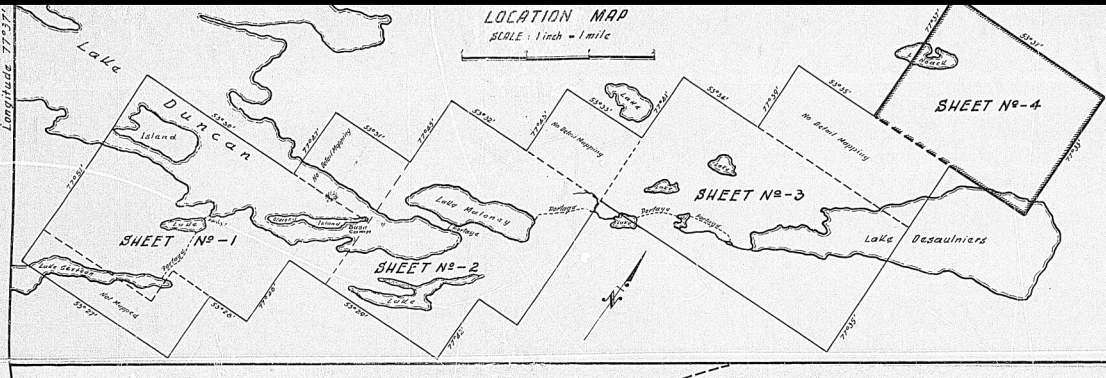

# DUNCAN RANGE IRON MINES LIMITED

## GEOLOGICAL MAP

SHEET N° 4  
MINERAL EXPLORATION LICENSE 137

QUEBEC DEPARTMENT OF MINES  
15<sup>th</sup> Aout 1959  
MINERAL DEPOSITS BRANCH  
No G.M. 7692

DUNCAN LAKE AREA  
UNGAVA DISTRICT  
QUEBEC  
CANADA  
SCALE 1 inch = 400 feet

### LEGEND

- Diabase
- Quartz vein
- Basic gneiss
- Granite
- Greywacke, minor iron formation
- Iron formation
- Quartzite, dark, minor till
- Tuff, minor flow
- Strike, dip and top direction
- Strike and dip, top unknown
- Drag fold and plunge
- Synclinal fold axis
- Schistosity
- Shear zone
- Outcrop area
- Mass flow, slump
- Effer boundary
- Chip sample 5



W. J. Douglas, Geologist  
November 18, 1959



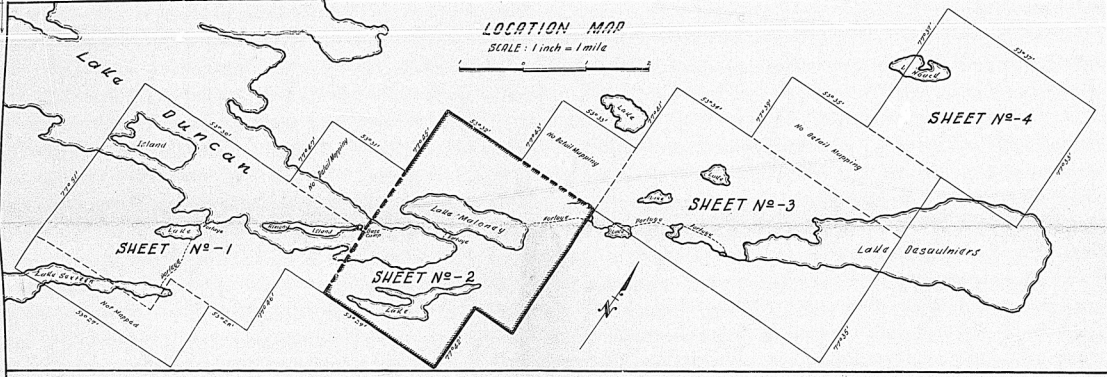

QUEBEC DEPARTMENT OF MINES  
15 JAN 1955  
MINERAL DEPOSITS BRANCH  
7692

# DUNCAN RANGE IRON MINES LIMITED

## GEOLOGICAL MAP

SHEET No 2  
MINERAL EXPLORATION LICENSE 137

DUNCAN LAKE AREA  
UNGAVA DISTRICT  
QUEBEC  
CANADA

SCALE: 1 inch = 400 feet

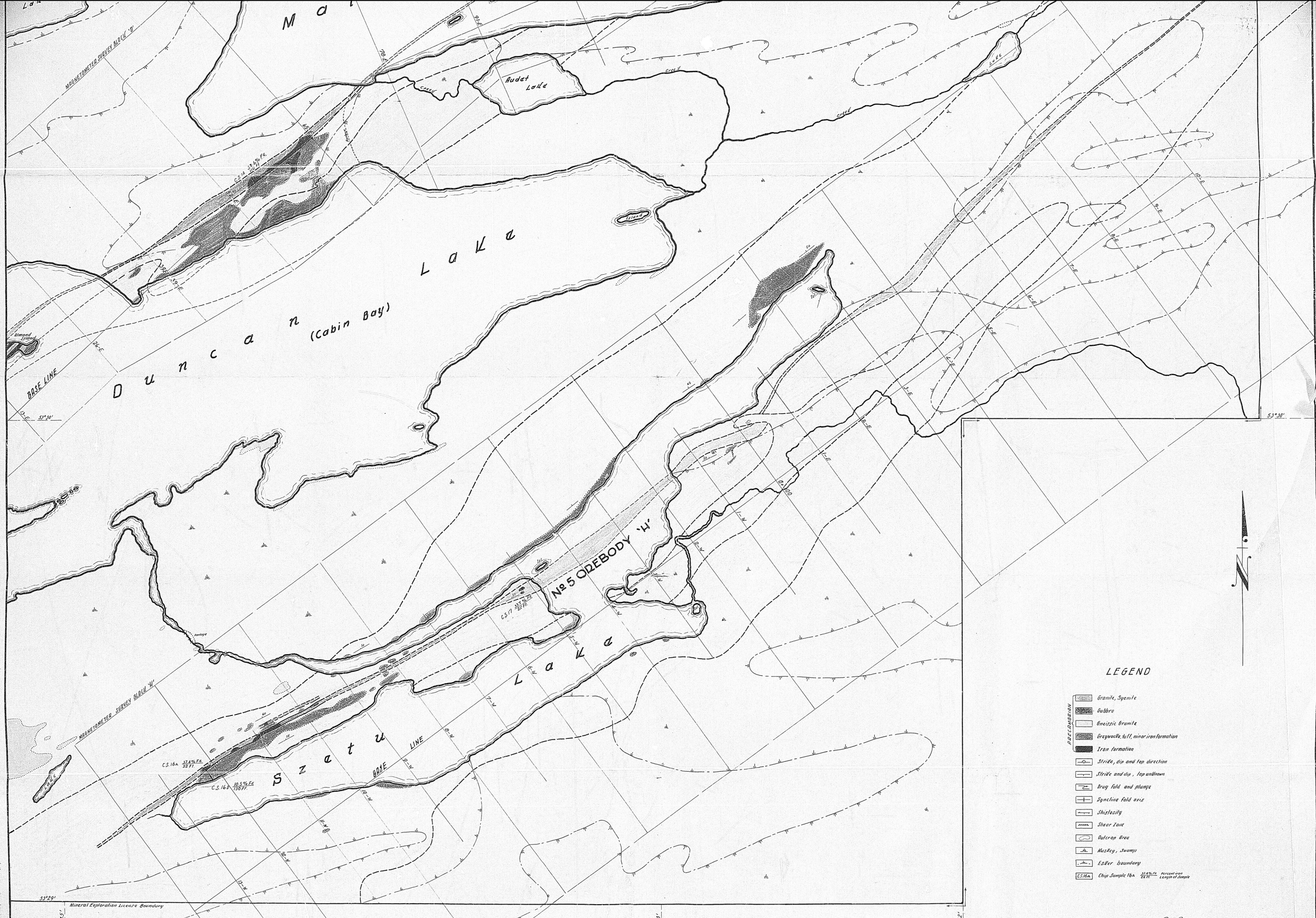
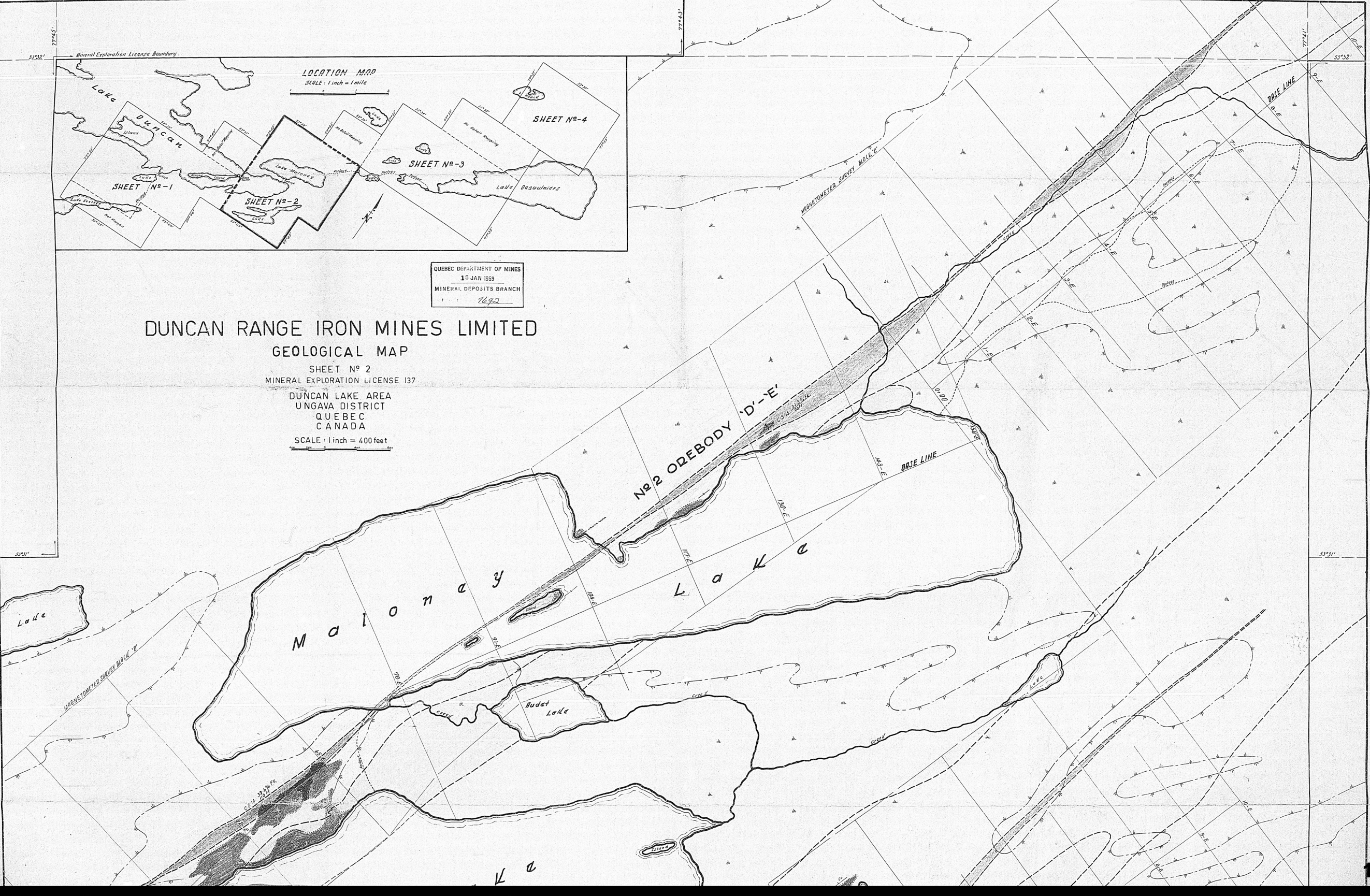

### LEGEND

- Granite, Syenite
- Gabbro
- Gneissic granite
- Gneissic till, minor iron formation
- Iron formation
- Strike, dip and top direction
- Strike and dip, top unknown
- Drag fold and plunge
- Syncline fold axis
- Shear fault
- Steep zone
- Outcrop tree
- Muddy, swampy
- Lake boundary
- Chip Sample No. 10722, 10723, 10724

H. A. Hughes, Geologist  
November 13, 1955



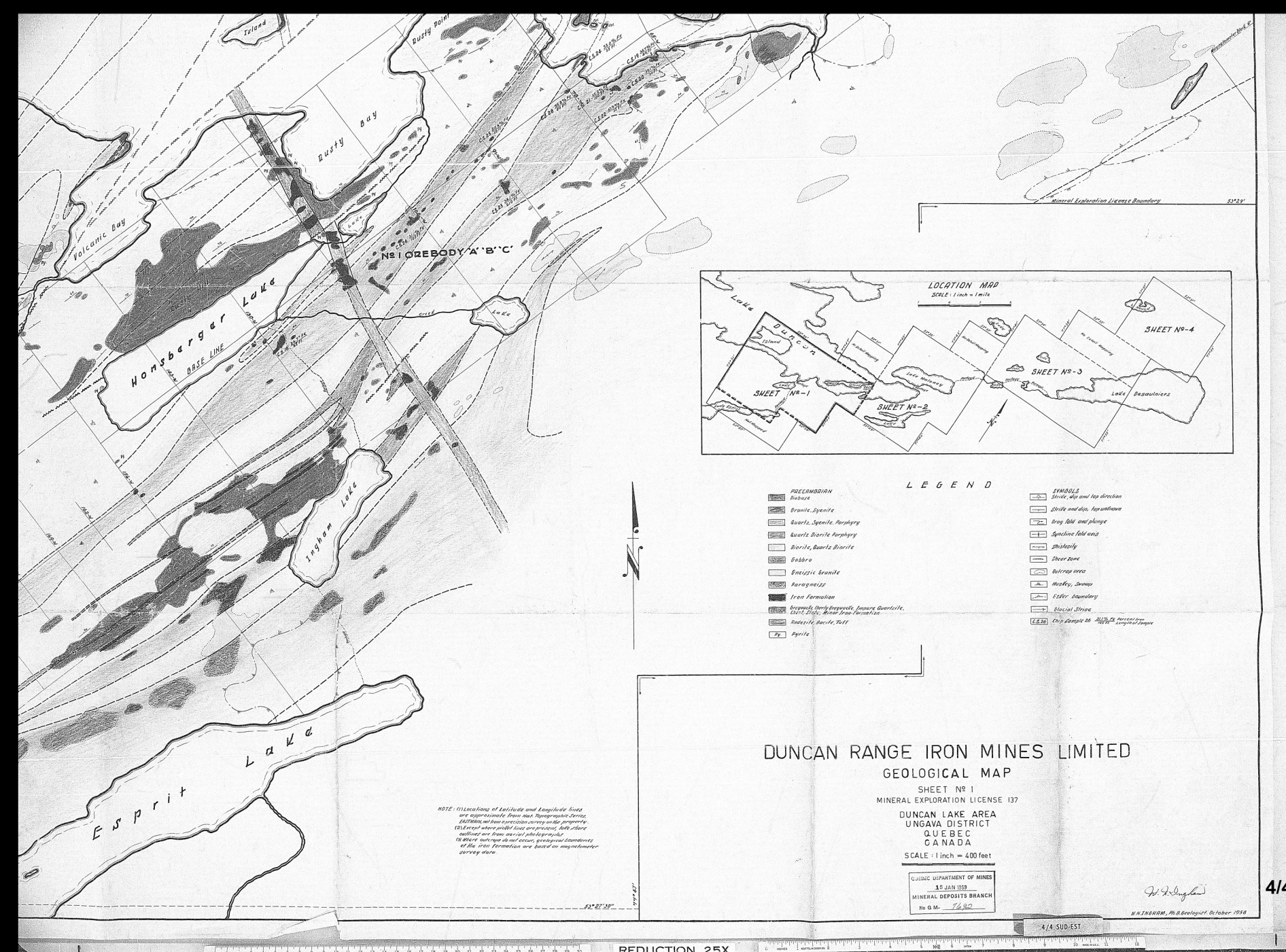
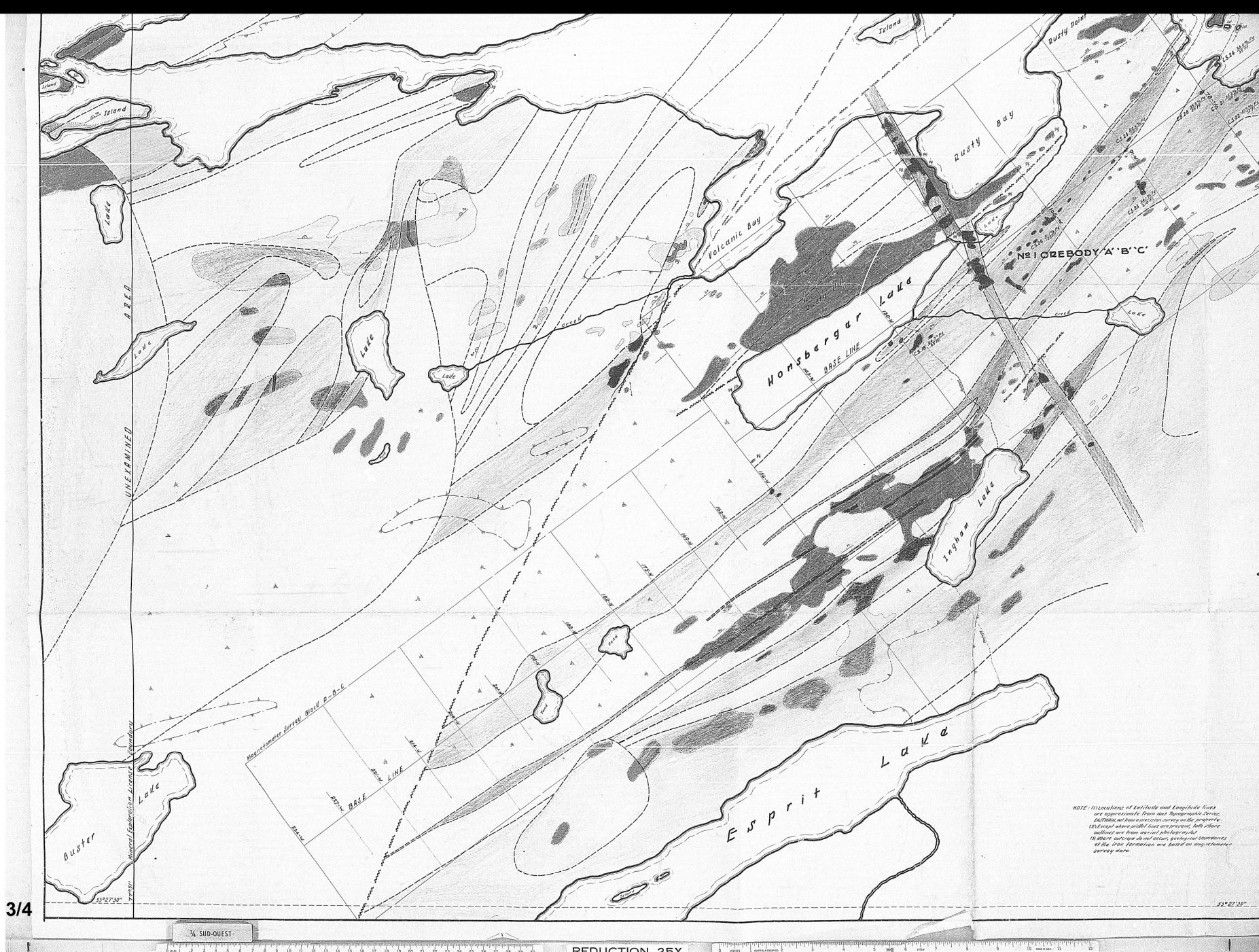
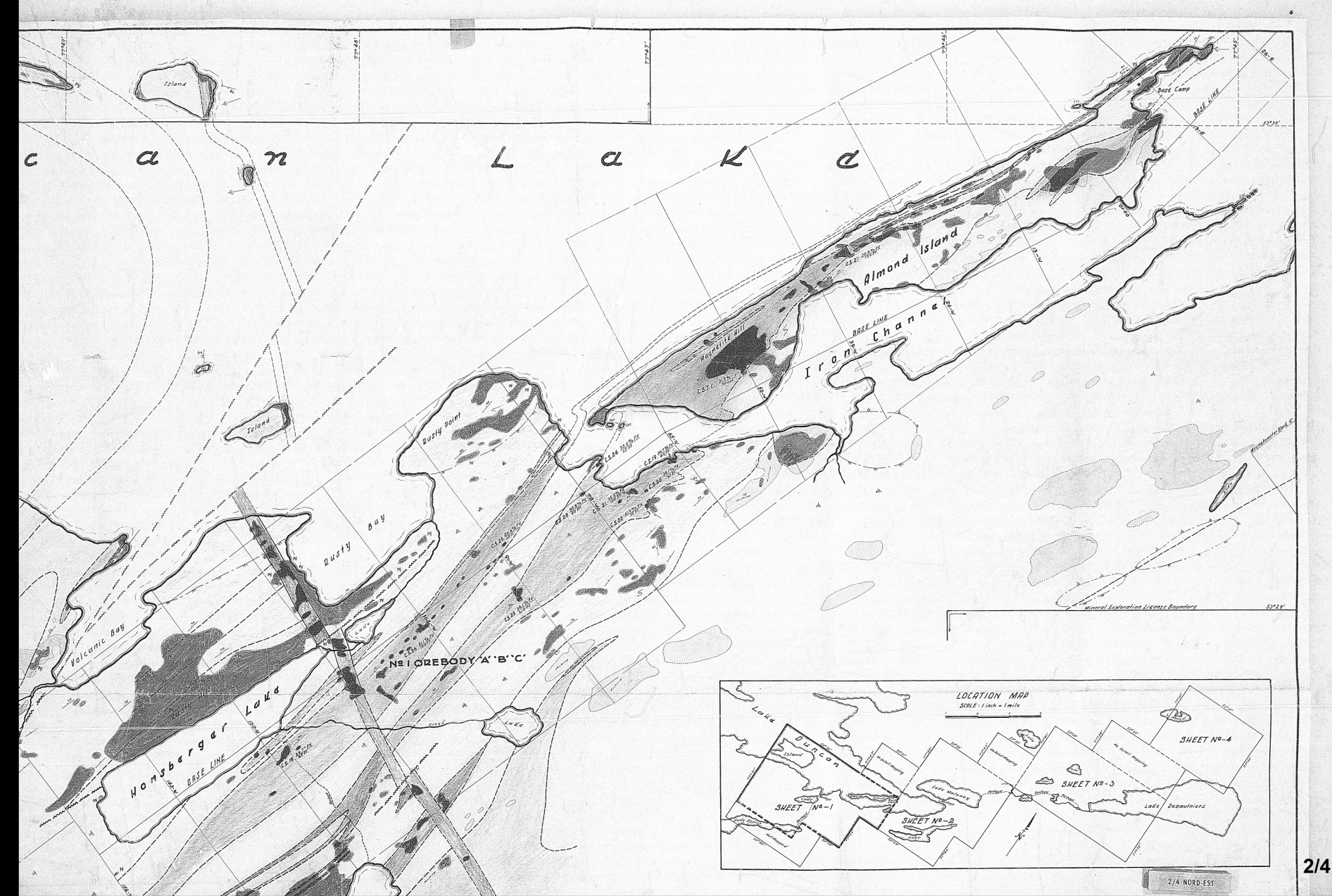
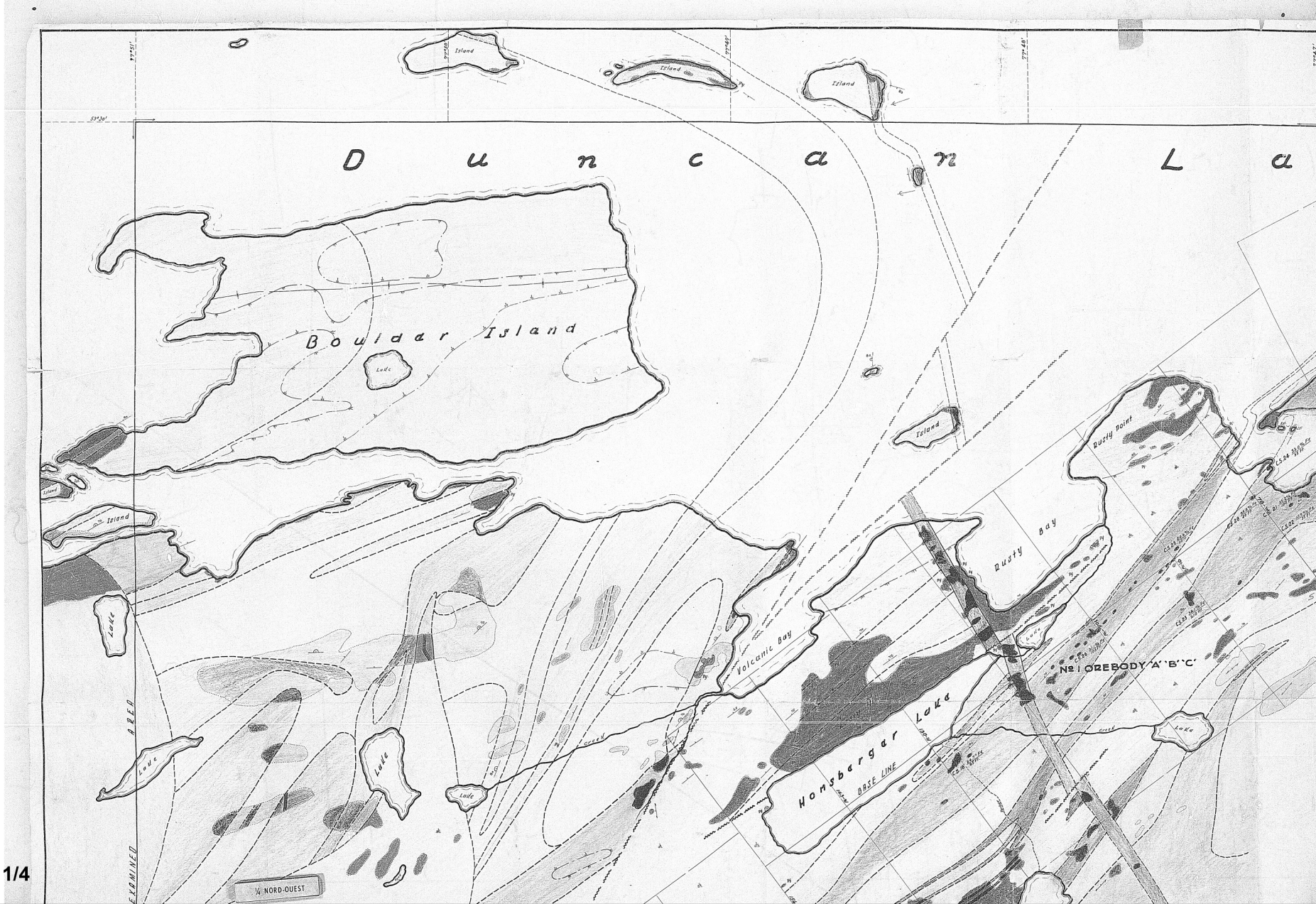



DUNCAN RANGE IRON MINES CAN RANGE IRON MINES LIMITED

GENERALIZED GEOLOGICAL PLAN SHOWING IRON ORE BODIES NO 1 TO NO 5

MINERAL EXPLORATION LICENSE 137  
DUNCAN LAKE AREA  
UNGAVA DISTRICT  
QUEBEC  
CANADA  
SCALE: 1 inch = 1/4 mile

GENERALIZED GEOLOGICAL PLAN SHOWING IRON ORE BODIES NO 1 TO NO 6

MINERAL EXPLORATION LICENSE 137  
DUNCAN LAKE AREA  
UNGAVA DISTRICT  
QUEBEC  
CANADA  
SCALE: 1 inch = 1/4 mile

QUEBEC DEPARTMENT OF MINES  
19 JAN 1959  
MINERAL DEPOSITS BRANCH  
No. G.M. 7692

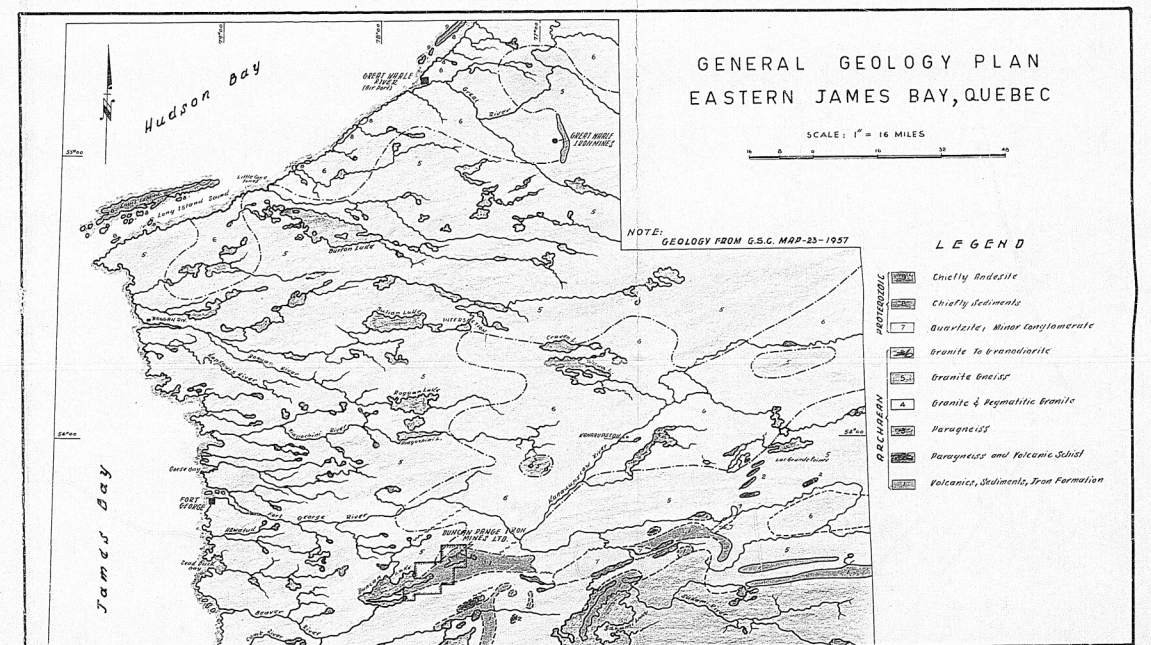
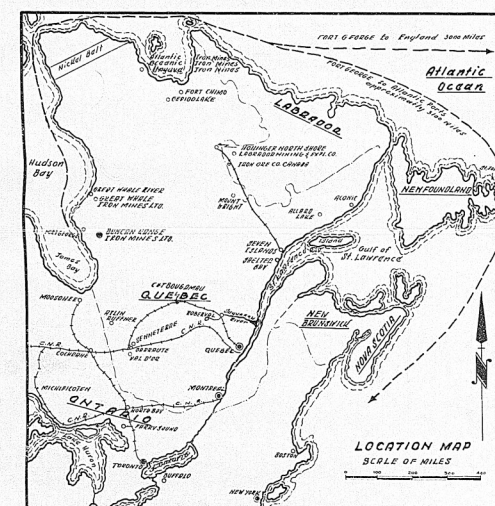
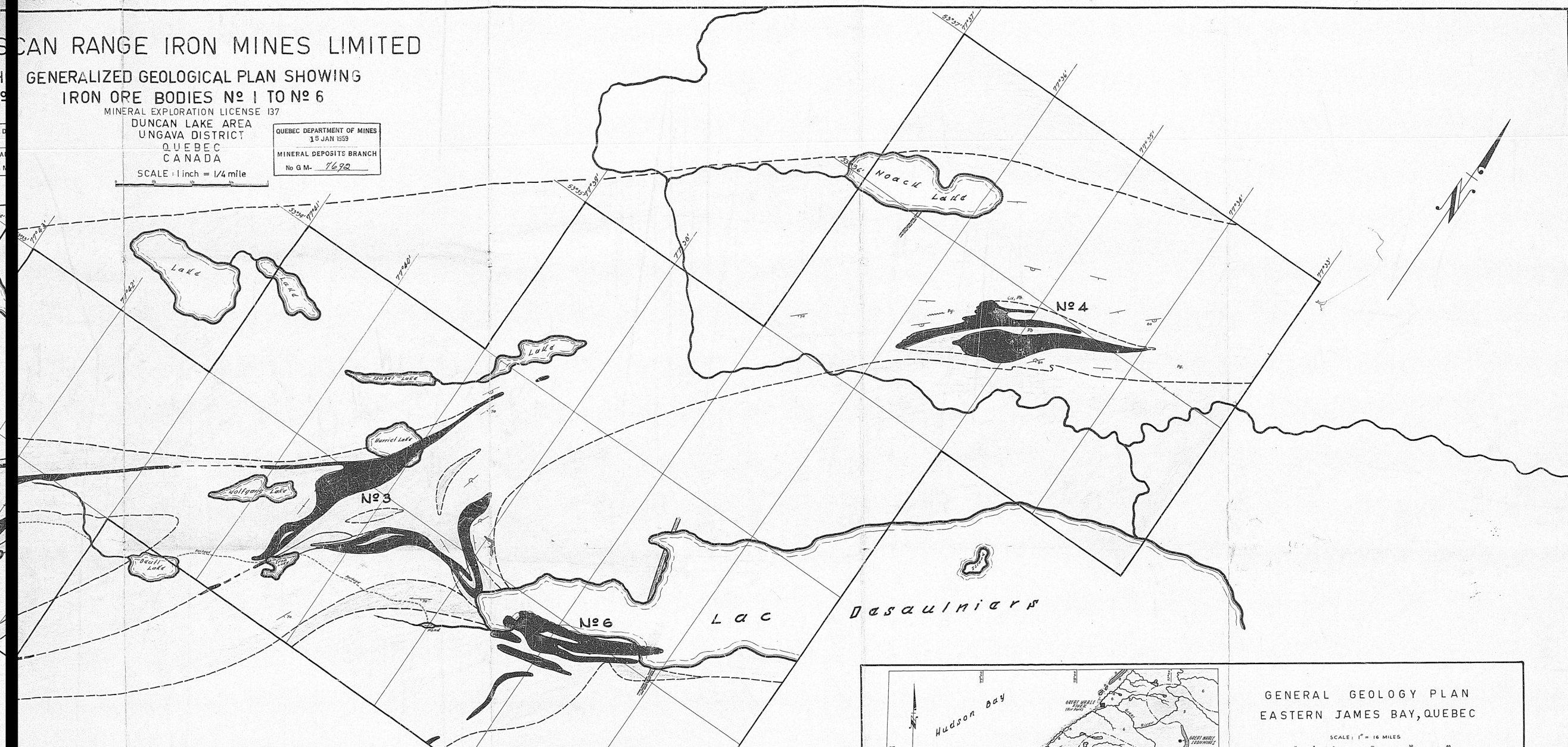
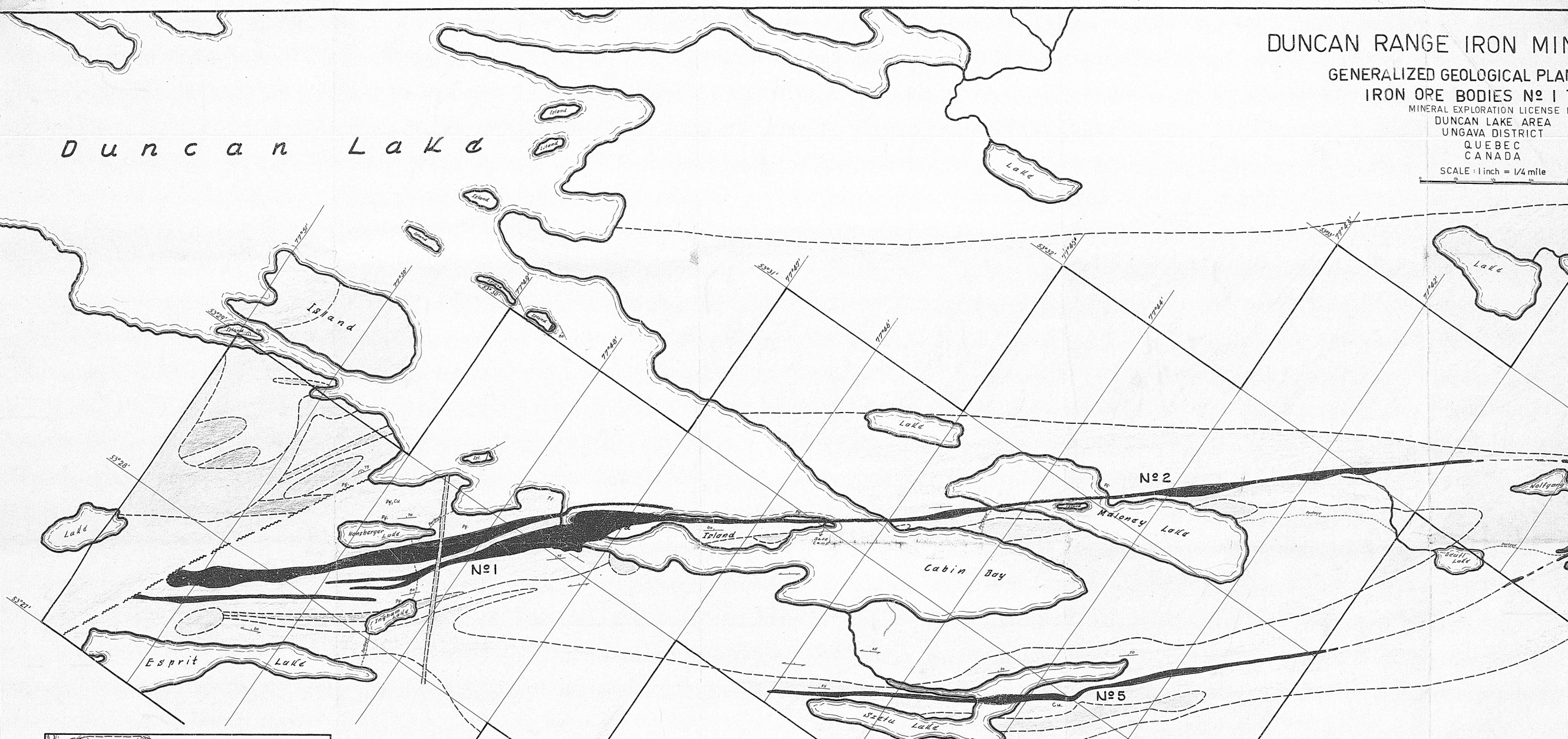

LEGEND

- PRECAMBRIAN
- Dabase
- Granite, Spinel, Biotite
- Dolomite
- Granite Gneiss
- Amphibolite
- Iron Formation
- Dolomite
- Volcanics
- SYMBOLS
- Strike, Dip and Top Direction
- Strike and Dip, Top unknown
- Schistosity
- Shear Zone or Fault
- NE 4 Iron Ore Body
- Gr. Gneiss
- Cu. Copper
- Fl. Lead

OREBODY	Length in feet	Maximum width in feet	Sp. Gr Factor: 92	Total width sampled	Number of Samples	Number of Tests	Average Grade of Iron Ore	Silica in concentrate	Percent recovery	Vertical distance between samples
NE 1	North Band 14,000	700	4.00	6,08,000	220	26.0%	62.76	11.07	88.87	0.047
	South Band 10,000	600	5.40	5,40,000	1020	34.6%	66.73	6.10	92.29	0.020
NE 2	West Shoot 2,300	150	3.14	3,14,000	110	33.6%	65.72	7.25	97.07	0.018
	Centre Shoot 3,000	200	6.50	6,50,000	90	31.3%	67.91	4.80	97.89	0.016
NE 3	North Band 7,200	400	1.90	39,00,000	no outcrop					
	West Limb 7,400	200	1.90	1,90,000	71	33.1%	70.16	2.60	97.82	0.025
NE 4	North Limb 5,000	300	1.10	1,10,000	238	28.9%	67.44	5.10	95.43	0.032
	South Limb 6,000	110	1.90	1,90,000	275	32.4%	65.56	5.31	95.63	0.022
NE 5	Centre Section 4,000	150	6.10	6,10,000	20	33.7%	69.04	3.08	99.51	0.026
	East Section 1,600	100	1.60	1,60,000	no outcrop					
NE 6	West Division 6,000	800	5.00	5,00,000	1550	33.6%	62.39	8.46	96.86	0.025
	Total of Average 75,600	645'	3,157,300	4014'	27	32.0%	66.00%	6.42%	94.27%	0.024%

Average Ratio of Concentration 2:1 feed ore to max is 60 percent