

**NEWMONT EXPLORATION LTD**

SURVEY: **MAXMIN II ÉNERGIE ET RESSOURCES**  
PROFILES      SECTEUR MINES

DATE: 27 JUN 1989

BY: **GEOSIG Inc.** Bureau régional Val d'Or  
EXPERTS-CONSEILS EN GÉOPHYSIQUE  
TÉL. (418) 658-3312

Executed by: R. St-Pierre 02-89  
G. Couture, Y. Salm  
Interpreted by: E. Gauthier 03-89  
R. St-Pierre  
Drawn by: Geosig Inc. 03-89  
Geodes Inc. 04-89  
Approved by: E. Gauthier 03-89

**CABER PROJECT**  
CENTER BLOC

Map # 4393      Lat. 49°50'      SCALE: 1 : 5 000  
Project # 56-11      Long. 78°50'      0 100 200 300m  
NTS: 32 F/13



Ministère de l'Énergie et des Ressources  
Service de la Géoinformation  
Date: 8 JUIN 1989  
No G.M. 48704

LEGEND

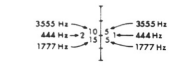
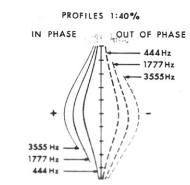

SHALLOWER OVERBURDEN  
OFTEN CORRESPOND WITH AREAS  
OF HIGHER ELEVATION

- ROAD
- WINTER ROAD
- CLAIM POST (OBSERVED)
- CLIFF
- SLOPE
- TOPOGRAPHIC HIGH
- SWAMP
- OUTCROPPING AREA

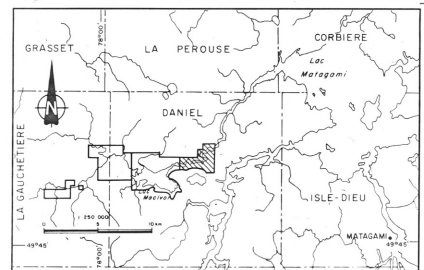
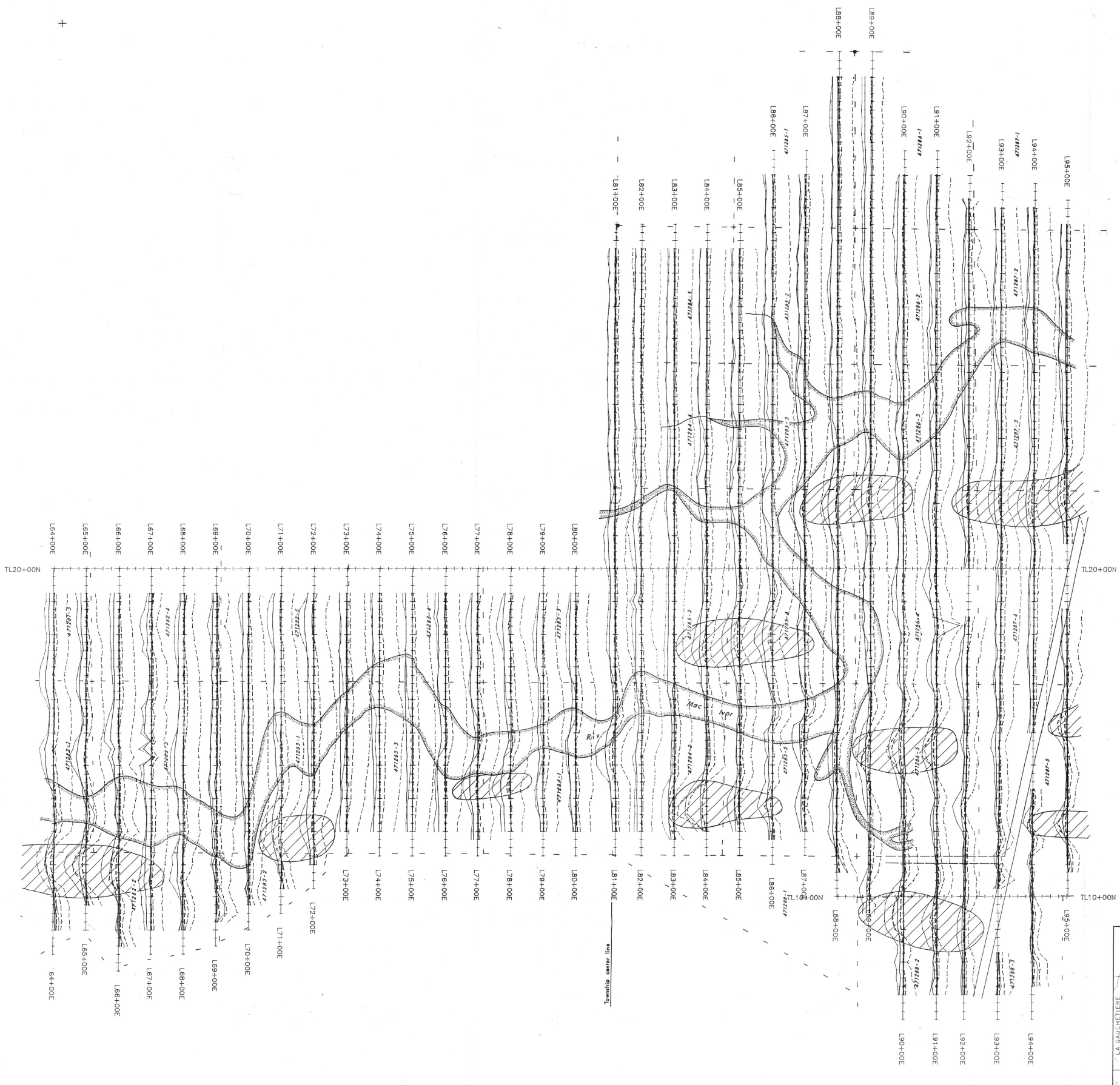

<b>NEWMONT EXPLORATION LTD</b>	
SURVEY: <b>MAXMIN II</b> - ÉNERGIE ET RESSOURCES SECTEUR MINES	
PROFILES 27 JUIN 1989	
By: <b>GEOSIG Inc.</b>	Bureau régional Val d'Or
EXPERTS-CONSEILS EN GÉOPHYSIQUE TÉL: (418) 859-3512	
Executed by: R. St-Pierre 02-89 G. Couchar, Y. Sain	
Interpreted by: E. Goucher 03-89 R. St-Pierre	
Drawn by: Geosig Inc. 03-89 Géodés Inc. 04-89	
Approved by: E. Goucher 03-89	
Revised by:	
Map # 4364	Lat: 49°30'      SCALE: 1 : 5 000
Project # 56-11	Long: 78°00'      0      100      200      300m
	NTS: 32 F/13

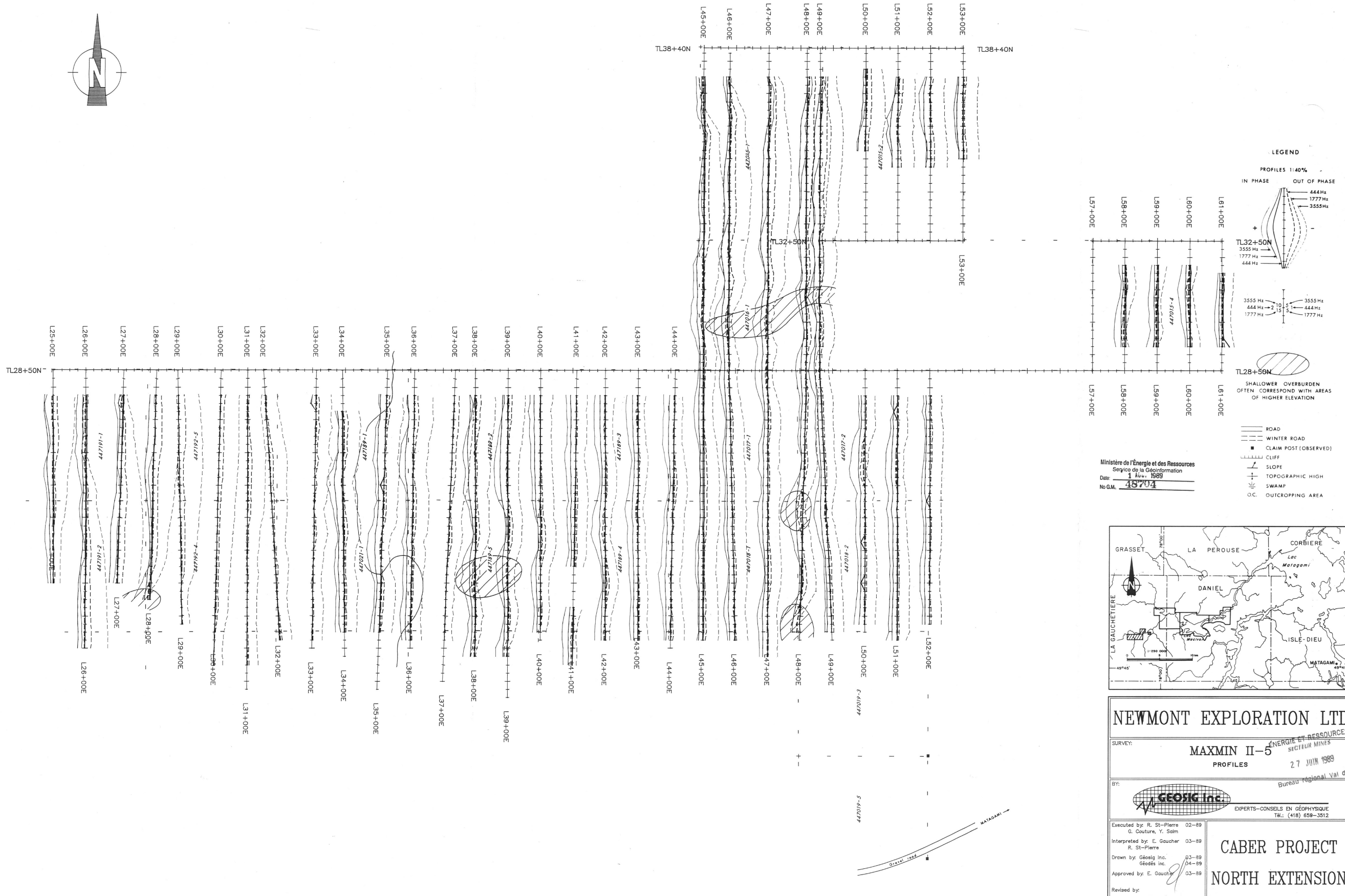
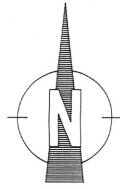

Ministère de l'Énergie et des Ressources  
 Service de la Géoinformation  
 Date: 1 Nov. 1989  
 No.G.M. 48704

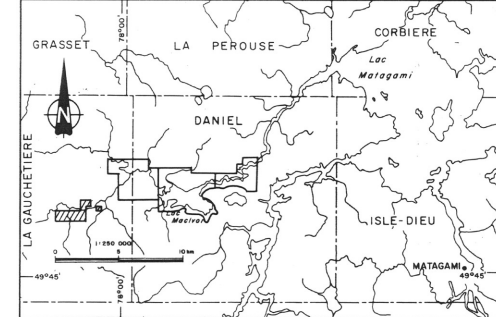

<b>NEWMONT EXPLORATION LTD</b>	
SURVEY:	<b>MAXMIN II-5</b>
	ÉNERGIE ET RESSOURCES SECTEUR MINES
	PROFILES 27 JUIN 1989
BY:	Bureau régional Val d'Or
EXPERTS-CONSELS EN GÉOPHYSIQUE Tél.: (418) 659-3512	
<b>CABER PROJECT NORTH EXTENSION</b>	
Map # 4389	Lat: 49°50'
Project # 56-11	Long: 78°00'
	NTS: 32 E/16
SCALE: 1 : 5 000	
0 100 200 300m	

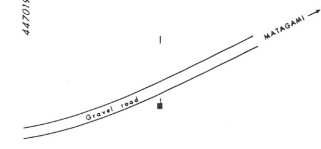

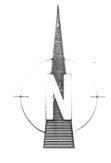
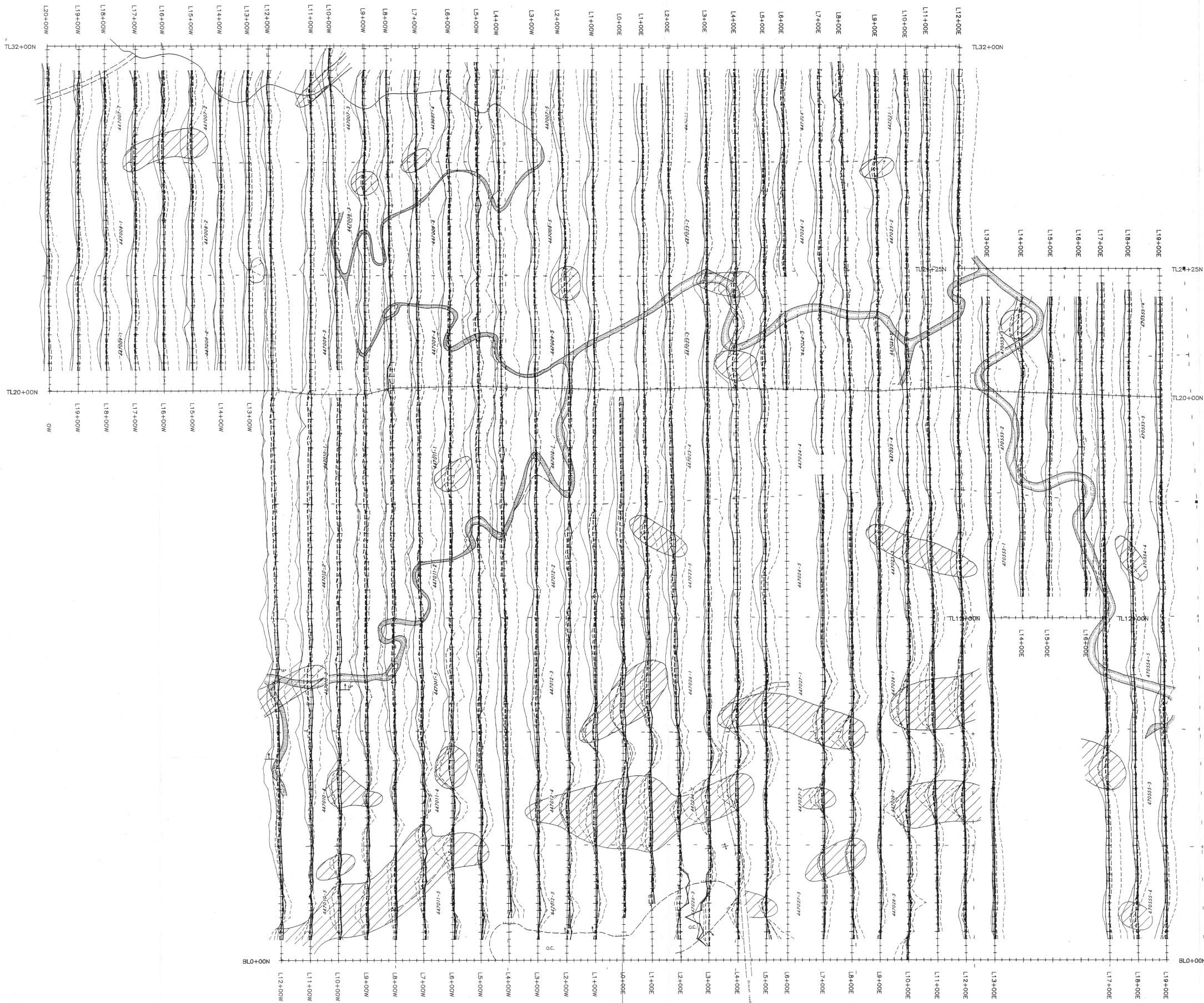

**LEGEND**

PROFILES 1:40%

IN PHASE

- 444 Hz
- 1777 Hz
- 3555 Hz

OUT OF PHASE

- 444 Hz
- 1777 Hz
- 3555 Hz

3555 Hz

- 444 Hz
- 1777 Hz

3555 Hz

- 444 Hz
- 1777 Hz

SHALLOWER OVERBURDEN  
OFTEN CORRESPOND WITH AREAS  
OF HIGHER ELEVATION

ROAD

WINTER ROAD

CLAIM POST (OBSERVED)

CLIFF

SLOPE

TOPOGRAPHIC HIGH

SWAMP

OC. OUTCROPPING AREA

Ministère de l'Énergie et des Ressources  
Service de la Géoinformation  
Date: 1 10 1989  
No GM: 48704

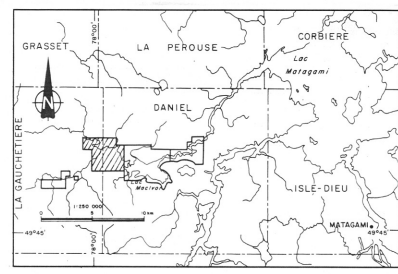

**NEWMONT EXPLORATION LTD**

SURVEY: **MAXMIN II-5** ÉNERGIE ET RESSOURCES  
SICILEUR MINES

PROFILES 2-7 JUIL 1989

Bureau régional Val d'Or

**GEOSIG inc.**  
EXPERTS-CONSEILS EN GÉOPHYSIQUE  
Tél: (418) 659-3512

Executed by: St-Pierre 02-89  
G. Ducharme 02-89  
Interpreted by: Gaucher 03-89  
R. St-Pierre 03-89  
Drawn by: Jeong 03-89  
Sédes 04-89  
Approved by: G. Gaucher 03-89  
Revised by:

**CABER PROJECT  
WEST BLOCK**

Map # 4391 Lat: 49°50' SCALE: 1 : 5 000  
Project # 56-11 Long: 78°00' 0 100 200 300  
NTS: 32 E/16

LA GAUCHETIERE TWP.  
DANIEL TWP.

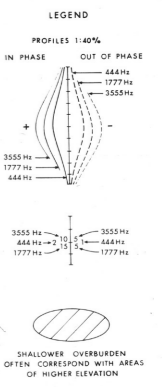
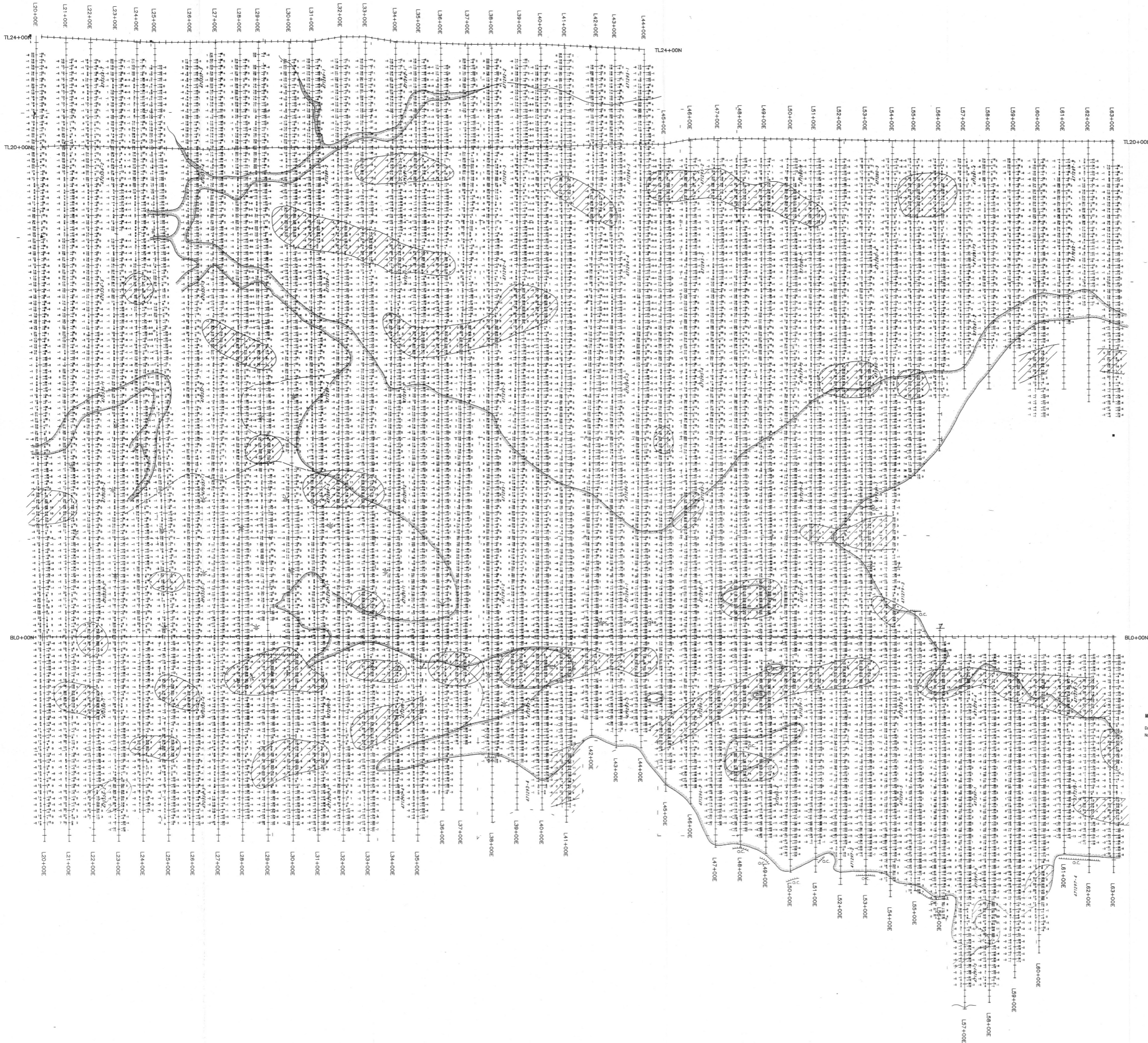

Ministère de l'Énergie et des Ressources  
Service de l'Information  
Date: 1 JUIN 1989  
N.G.M. 48704

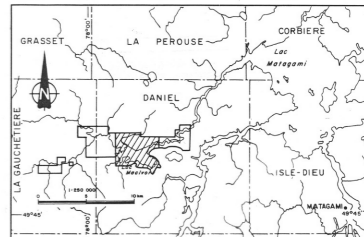

**NEWMONT EXPLORATION LTD**

SURVEY: **MAXMIN II**  
READ/ÉCRISSEUR  
2-7 JUIN 1989

BY: **GEOSIG Inc.**  
BUREAU régional Val d'or  
EXPERTS-CONSILS EN GÉOPHYSIQUE  
TÉL. (418) 659-3512

Executed by: R. St-Pierre 02-89  
G. Gauthier, Y. Sam  
Interpreted by: E. Gauthier 03-89  
R. St-Pierre  
Drawn by: Geosig Inc. 03-89  
Geosig Inc.  
Approved by: E. Gauthier 03-89

**CABER PROJECT**  
**CENTER BLOC**

Map # 4394      Lat. 49°50'      SCALE: 1 : 5 000  
Project # 56-11      Long. 78°30'      0      100      200      300m  
NTS: 32 F/13



Ministère de l'Énergie et des Ressources  
Service de la Géoinformation  
Date: 1 JUIN 1989  
No. GM: 43732

### LEGEND

- PROFILES 1:40%
- IN PHASE    OUT OF PHASE
- 444 Hz
  - 1777 Hz
  - 3555 Hz
- 3555 Hz  
1777 Hz  
444 Hz
- 3555 Hz  
444 Hz → 2 TO 5  
1777 Hz
- SHALLOWER OVERBURDEN  
OFTEN CORRESPOND WITH AREAS  
OF HIGHER ELEVATION
- ROAD
  - WINTER ROAD
  - CLAIM POST (OBSERVED)
  - CLIFF
  - SLOPE
  - TOPOGRAPHIC HIGH
  - SWAMP
  - OC. OUTCROPPING AREA

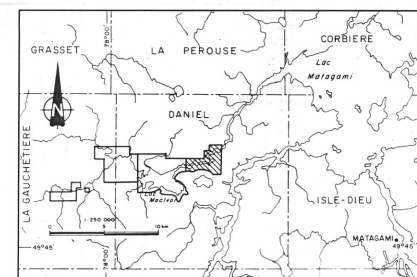

## NEWMONT EXPLORATION LTD

SURVEY: **MAXMIN II-5** ÉNERGIE ET RESSOURCES  
SECTEUR MINES

READING: 27 JUIN 1989

BY: **GEO SIG Inc.** BUREAU REGIONAL Val d'Or  
EXPERTS-CONSILS EN GÉOPHYSIQUE  
Tél.: (418) 859-3512

Executed by: R. St-Pierre 02-89  
G. Couture, Y. Salm  
Interpreted by: E. Goucher 03-89  
R. St-Pierre  
Drawn by: GeoSig Inc. 03-89  
Osodés Inc. 04-89  
Approved by: E. Goucher 03-89  
Revised by:

## CABER PROJECT EAST BLOCK

Map # 4363    Lat: 49°30'    SCALE: 1 : 5 000  
Project # 56-11    Long: 78°00'    0    100    200    300m  
NTS: 32 F/13

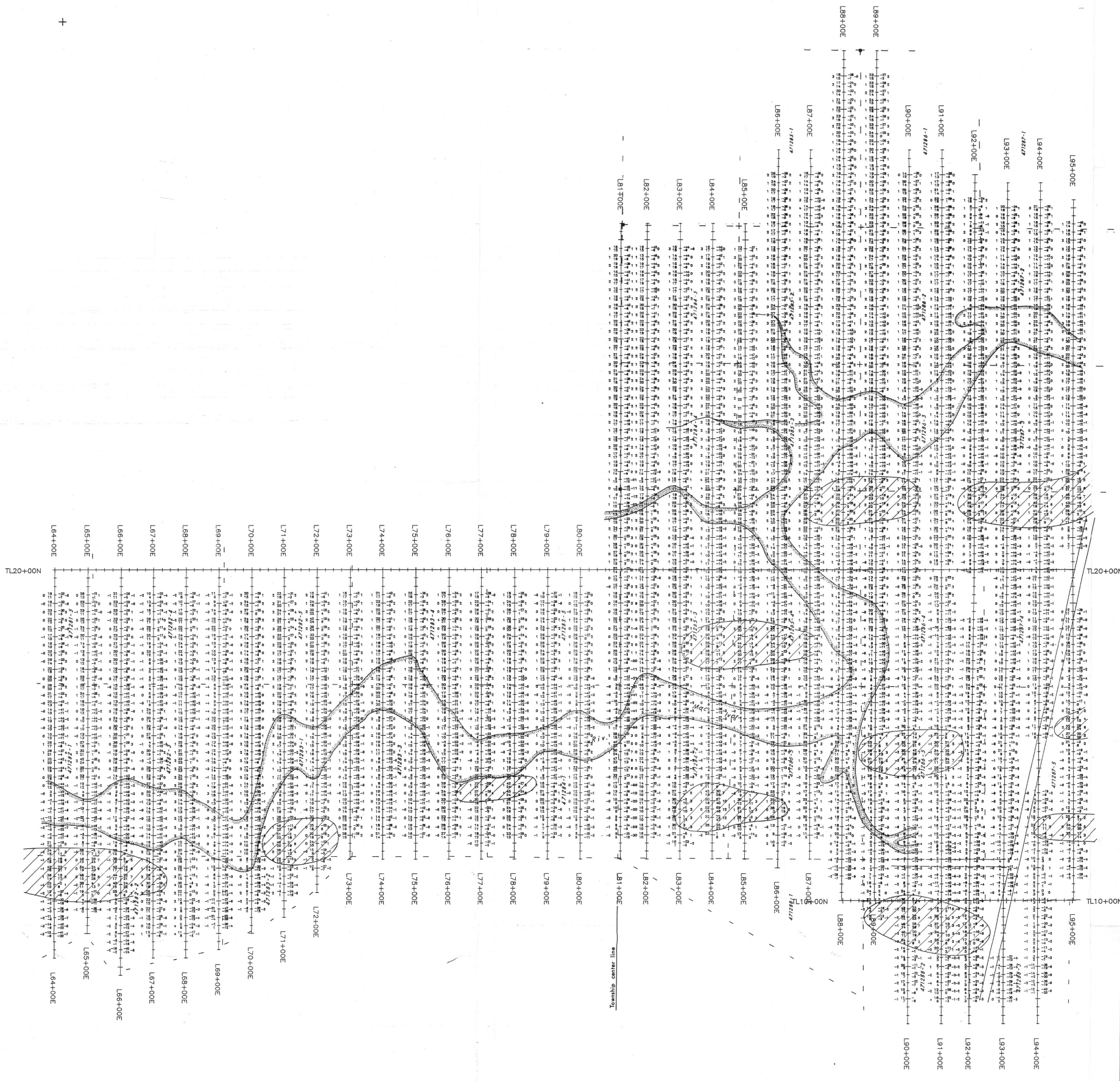

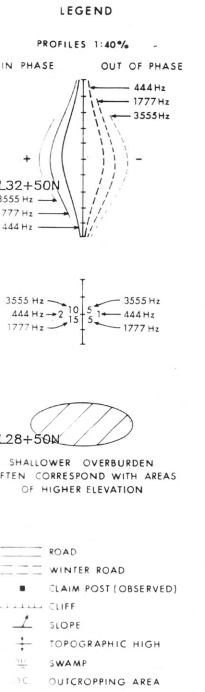
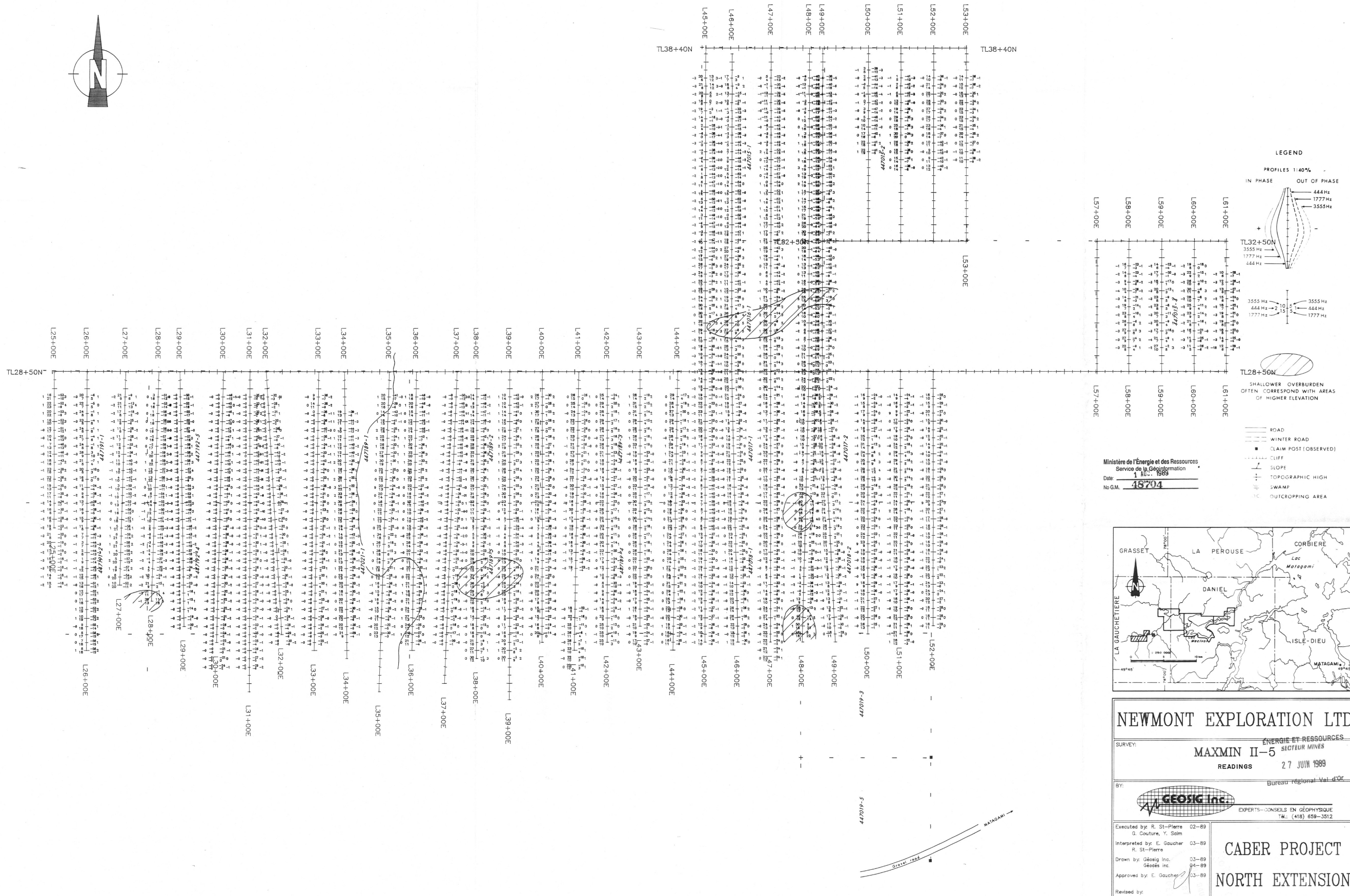

Ministère de l'Énergie et des Ressources  
 Service de l'Information Géographique  
 Date: 48704  
 No.G.M.

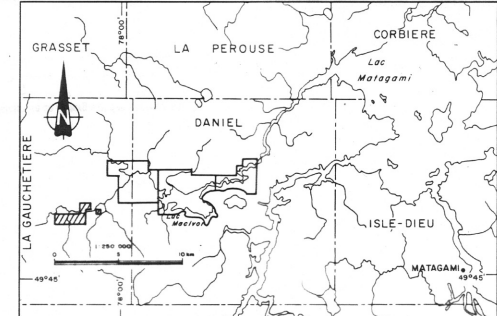

**NEWMONT EXPLORATION LTD**  
 ÉNERGIE ET RESSOURCES  
 SURVEY: **MAXMIN II-5** SECTEUR MINES  
 READINGS: 27 JUIN 1989  
 Bureau régional Val d'Or

By: **GEOSIG Inc.**  
 EXPERTS-CONSEILS EN GÉOPHYSIQUE  
 Tél.: (418) 859-3512

Executed by: R. St-Pierre 02-89  
 G. Couture, Y. Salm  
 Interpreted by: E. Gaucher 03-89  
 R. St-Pierre  
 Drawn by: Géosig Inc. 03-89  
 Géosig Inc.  
 Approved by: E. Gaucher 03-89  
 Revised by:

**CABER PROJECT**  
**NORTH EXTENSION**

Map # 4390 Lat. 49°50' SCALE  
 Project # 56-11 Long. 78°50' 0 100 300m  
 NTS: 32 2 16

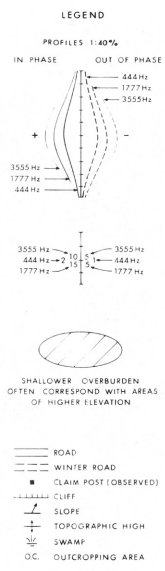
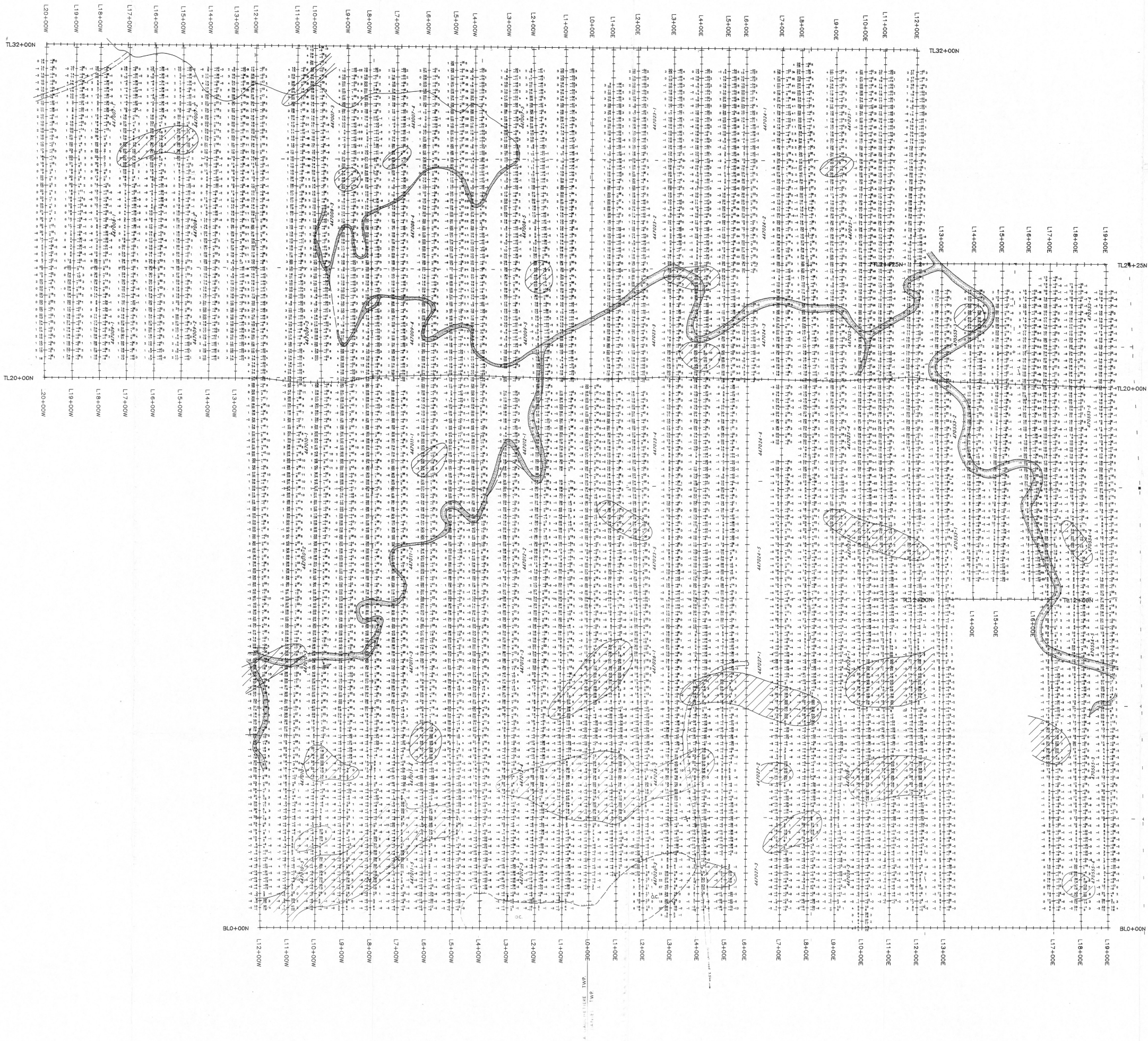

Ministère de l'Énergie et des Ressources  
Service de la Géoinformation  
Date: 1 AOUT 1989  
No GM: 45704

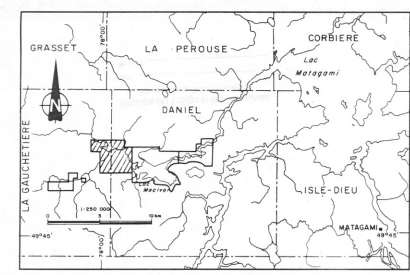

**NEWMONT EXPLORATION LTD**

SURVEY: **MAXMIN II** ENERGIE ET RESSOURCES  
SECTEUR MINES  
READINGS: 27 JUIN 1989  
Bureau régional Val d'Or

**GEOSIG Inc.**  
EXPERTS-CONSEILS EN GÉOPHYSIQUE  
TÉL. (418) 659-3512

Executed by: R. St-Pierre 02-89  
G. Gauthier, Y. Sain 03-89  
Interpreted by: E. Daucher 03-89  
R. St-Pierre 04-89  
Drawn by: Géosig Inc. 03-89  
Géodés Inc. 04-89  
Approved by: S. Gauthier 03-89

**CABER PROJECT  
WEST BLOCK**

Map # 4392  
Project # 56-11

Lat: 49°50'  
Long: 78°00'  
NTS: 32 E/16

SCALE: 1 : 5 000  
0 100 200 300m